

Replacement Requirement for Wire Harness for Rear-View Mirror/Front Door or Front Main Wire Harness: Rework Signal Line for Mirror Camera (22/26)

- Model Line: **911 (992 I)**
- Model Year: **As of 2020 up to 2025**
- Equipment: **ParkAssist, including Surround View (M-no. KA6)**
- Concerns: **Plug contacts of the signal line for the mirror camera on the new mirror wire harness/front door/front main wire harness**
- Cause: **In the event of unfavorable specific component tolerances on the plug contacts of the signal line for the mirror camera, complaints may occur in the camera view after installation of one of the wire harnesses listed below.**
- **Wire harness for rear-view mirror**
 - **Front door wire harness (bodyshell)**
 - **Front main wire harness**
- Action: If the specified wire harnesses need to be replaced, rework the mirror camera signal line of the new wire harness.
- For work procedure, see:
- Replacement requirement for wire harness for rear-view mirror: ⇒ *Technical Information 'Replacing plug contact on new wire harness for rear-view mirror'*
 - Replacement requirement for front door wire harness (bodyshell): ⇒ *Technical Information 'Rework plug contacts on front door wire harness (bodyshell)'*
 - Replacement requirement for front main wire harness: ⇒ *Technical Information 'Replace plug contact on front main wire harness for passenger compartment'*

Required tools

- Tool:
 - **VAS 6720 - Antenna line repair set**

Required parts

Part Information:	Part No.	Designation	Number
	...*	⇒ Plug contact, female (5 pieces)	1 piece(s)
	...*	⇒ Plug contact, male (5 pieces)	1 piece(s)

**Information**

*The plug contacts required for this Technical Information (TI) are currently not yet available via Porsche AG (PAG) (status March 2026). Until availability, the required contacts must be removed from the repair kit **VAS 6720 – repair kit for antenna lines**.

Material: **Required materials** (usually already available in the Porsche Center)

Part No.	Designation	Quantity
...	⇒ Fabric tape, approx. 19 mm wide – e.g. TESA 51026	As required
...	⇒ Cable tie – Commercially available	As required

Replacing plug contact on new wire harness for rear-view mirror**Information**

The action is carried out on the **new** wire harness **before** installation.
Example illustration of the **new** wire harness when installed.

- Work Procedure: 1 Replace plug contact ⇒ *Example illustration of plug contact for rear-view mirror wire harness -1-* (at the door connection point) of the **new** signal line.
For work procedure, see: ⇒ *Workshop Manual '912841C8 Repairing antenna cable'*
- 2 Install **new** electric wire harness for rear-view mirror.

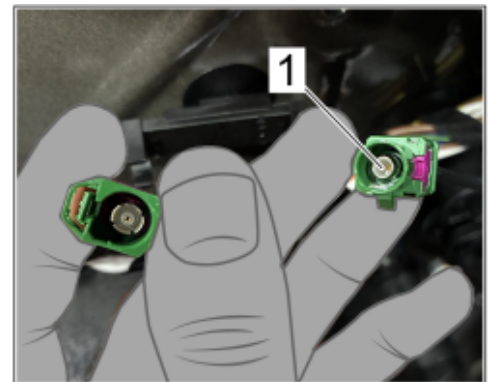

Example illustration of plug contact for rear-view mirror wire harness

Reworking plug contacts on the new front door wire harness (bodyshell)



Information

The action is carried out on the **new** wire harness **before** installation.
 Example illustration of the **new** wire harness when installed.

- Work Procedure: 1 Replace plug contact ⇒ *Example illustration of connection point for front door signal line -2- of the signal line (at the door connection point).*
 For work procedure, see: ⇒ *Workshop Manual '912841 Repairing antenna line'*

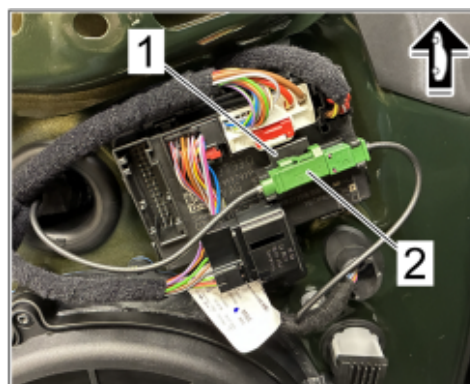

Example illustration of connection point for front door signal line

- 2 Replace plug contact ⇒ *Example illustration of plug contacts for signal lines in the passenger compartment -1- of signal line (at the place in the passenger compartment).*
 For work procedure, see: ⇒ *Workshop Manual '912841 Repairing antenna line'*
- 3 Install **new** electric wire harness on front door (bodyshell).

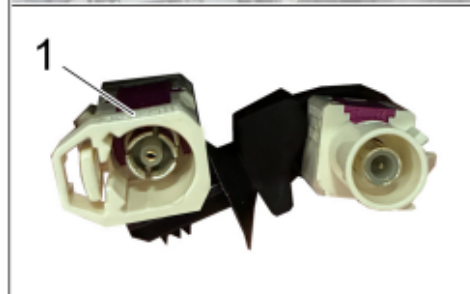
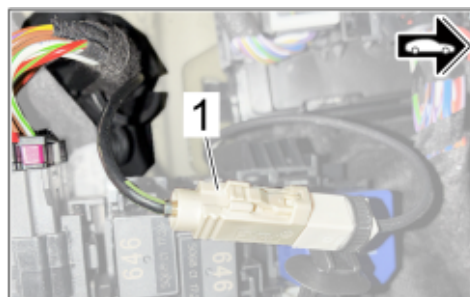

Example illustration of plug contacts for signal lines in the passenger compartment

Replacing plug contacts on the front passenger compartment main wire harness and on the assistance systems control unit (ZFAS)**Information**

The action is carried out on the **new** wire harness **before** installation.
Example illustration of the **new** wire harness when installed.

- Work Procedure: 1 Replace plug contact ⇒ *Example illustration of plug contact for signal line in passenger compartment -1-* (coming at the connection point from the passenger compartment area) of signal line.
For work procedure, see: ⇒ *Workshop Manual '912841 Repairing antenna line'*

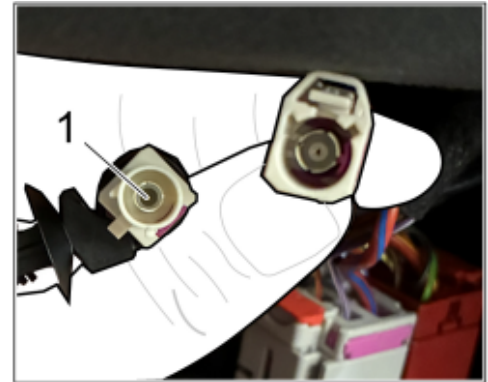

Example illustration of plug contact for signal line in passenger compartment

- 2 Replace all plug contacts ⇒ *Example illustration of signal lines on assistance systems control unit (ZFAS) -1-* of the signal lines from the control unit for assistance systems (ZFAS).
For work procedure, see: ⇒ *Workshop Manual '912841 Repairing antenna line'*
- 3 Install a corresponding **new** main wire harness for section front left/right.

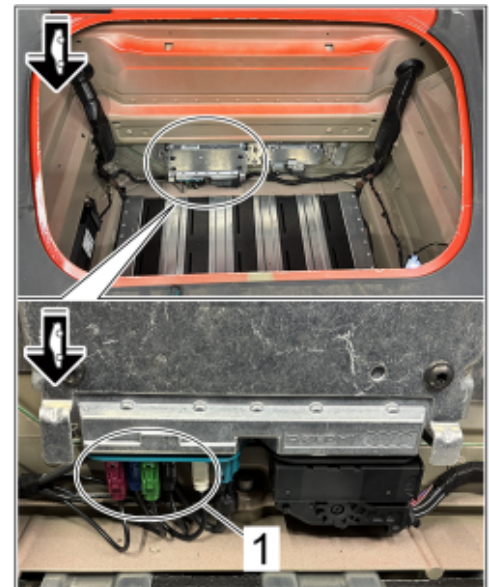

Example illustration of signal lines on assistance systems control unit (ZFAS)

Labor position and PCSS encryption

Labor position:

APOS	Labor operation	I No.
97434945	Rework wire harness for rear-view mirror	
97324945	Rework new wire harness for front left door	
97324946	Rework new wire harness for front right door	
97094945	Rework new main wire harness for front section	

PCSS encryption:

Location (FES5)	97430	Wire harness for rear-view mirror
Damage type (SA4)	1057	Crimp faulty

PCSS encryption:

Location (FES5)	97320	Door wire harness
Damage type (SA4)	1057	Crimp faulty

PCSS encryption:

Location (FES5)	9709	Main wire harness
Damage type (SA4)	1057	Crimp faulty

Important Notice: Technical Bulletins issued by Porsche Cars North America, Inc. are intended only for use by professional automotive technicians who have attended Porsche service training courses. They are written to inform those technicians of conditions that may occur on some Porsche vehicles, or to provide information that could assist in the proper servicing of a vehicle. Porsche special tools may be necessary in order to perform certain operations identified in these bulletins. Use of tools and procedures other than those Porsche recommends in these bulletins may be detrimental to the safe operation of your vehicle, and may endanger the people working on it. Properly trained Porsche technicians have the equipment, tools, safety instructions, and know-how to do the job properly and safely. Part numbers listed in these bulletins are for reference only. The work procedures updated electronically in the Porsche PIWIS diagnostic and testing device take precedence and, in the event of a discrepancy, the work procedures in the PIWIS Tester are the ones that must be followed.

© 2026 Porsche Cars North America, Inc.