

Replacement Requirement for Wire Harness for Rear-View Mirror/Front Door or Front Main Wire Harness: Rework Signal Line for Mirror Camera (22/26)

- Model Line: **Cayenne (9YA/9YB)**
- Model Year: **As of 2018**
- Equipment: ParkAssist, including Surround View (M-no. KA6)
- Concerns: **Plug contacts of the signal line for the mirror camera on the new mirror wire harness/front door/front main wire harness**
- Cause: **In the event of unfavorable specific component tolerances on the plug contacts of the signal line for the mirror camera, complaints may occur in the camera view after installation of one of the wire harnesses listed below.**
- **Wire harness for rear-view mirror**
 - **Front door wire harness (bodyshell)**
 - **Front main wire harness**
- Action: If the specified wire harnesses need to be replaced, rework the mirror camera signal line of the new wire harness.
- For work procedure, see:
- Replacement requirement for wire harness for rear-view mirror: ⇒ *Technical Information 'Replacing plug contact on new wire harness for rear-view mirror'*
 - Replacement requirement for front door wire harness (bodyshell): ⇒ *Technical Information 'Attach new signal line to new front door wire harness (bodyshell)'*
 - Replacement requirement for front main wire harness: ⇒ *Technical Information 'Replace plug contact on front main wire harness (door connection point on vehicle side)'*

Required tools

- Tools:
- **VAS 6720 - Antenna line repair set**
- Additionally required tool for replacing the front door wire harness (bodyshell):**
- Cable pull-in aid, commercially available **or** welding wire with bent ends

Required parts

Part Information:	Part No.	Designation	Number
	...*	⇒ Plug contact, female (5 pieces)	1 piece(s)

...*	⇒ Plug contact, male (5 pieces)	1 piece(s)
...	⇒ Spacer/cable holder	2 pieces
Additional parts required for replacement of front door wire harness (bodysell):		
9J1998045A	⇒ Repair kit for antenna line 6m	1 piece(s)
...	⇒ Spacer/cable holder	2 pieces

**Information**

*The plug contacts required for this Technical Information (TI) are currently not yet available via Porsche AG (PAG) (status March 2026). Until availability, the required contacts must be removed from the repair kit **VAS 6720 – repair kit for antenna lines**.

Materials: **Required materials** (usually already available in the Porsche Center)

Part No.	Designation	Quantity
...	⇒ Fabric tape, approx. 19 mm wide – e.g. TESA 51026	As required
...	⇒ Cable tie – Commercially available	As required

Replacing plug contact on new wire harness for rear-view mirror**Information**

The action is carried out on the **new** wire harness **before** installation.
Example illustration of the **new** wire harness when installed.

- Work Procedure: 1 Replace plug contact ⇒ *Example illustration of plug contact for rear-view mirror wire harness -1-* (at the door connection point) of the **new** signal line.
For work procedure, see: ⇒ *Workshop Manual '912841C8 Repairing antenna cable'*
- 2 Install **new** electric wire harness for rear-view mirror.

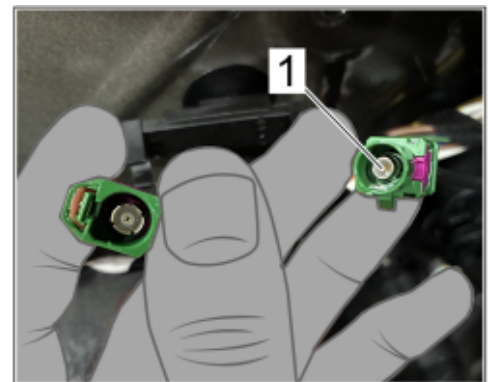

Example illustration of plug contact for rear-view mirror wire harness

Attach new signal line to new front door wire harness (bodyshell)



Information

The action is carried out on the **new** wire harness **before** installation.
Example illustration of the **new** wire harness when installed.

- Work Procedure: 1 Remove fabric tape on the grommets ⇒ *Example illustration of electric wire harness for front door -1-* on the **new** wire harness.



Example illustration of electric wire harness for front door

- 2 Disconnect grommet ⇒ *Example illustration of electric plug connection at the door connection point (door side) -1-* from electric plug connection at the door connection point ⇒ *Example illustration of electric plug connection at the door connection point (door side) -2-* and ⇒ *Example illustration of electric plug connection at the door connection point (door side) -3-* loosen the cable tie.

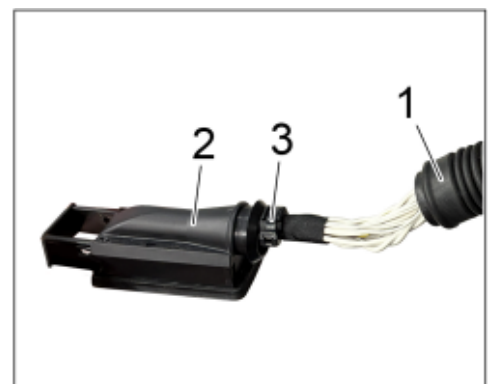

Example illustration of electric plug connection at the door connection point (door side)

- 3 Cut the **new** signal line to approx. **1.5 m** and route it along the **new** electric wire harness ⇒ *Example illustration of the electric wire harness of the door connection point to the rear-view mirror camera connection point -1-* from the connection point of the rear-view mirror ⇒ *Example illustration of the electric wire harness of the door connection point to the rear-view mirror camera connection point -3-* camera to the plug at the door connection point ⇒ *Example illustration of the electric wire harness of the door connection point to the rear-view mirror camera connection point -2-*.

**Information**

Make sure that the plug contact fitted on the signal line is at the rear-view mirror camera connection point.

The existing plug contact must not be fitted on the door connection point plug.

- 4 Release connector housing for door connection point ⇒ *Example illustration of connector housing for door connection point -1-* in ⇒ *Example illustration of connector housing for door connection point -Arrow direction-* and pull it out of the mounting housing ⇒ *Example illustration of connector housing for door connection point -2-*.

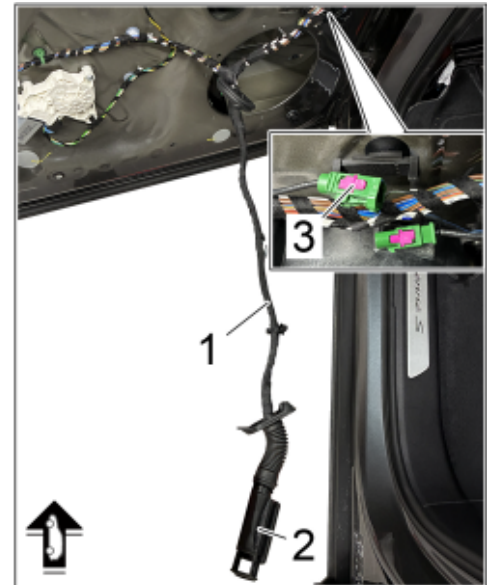

Example illustration of the electric wire harness of the door connection point to the rear-view mirror camera connection point



Example illustration of connector housing for door connection point

- 5 Disassemble connector housing and pull it out of the
 ⇒ *Example illustration of signal line in plug at door connection point -3-* plug contact of the signal line.
 - 5.1 Open outer section ⇒ *Example illustration of signal line in plug at door connection point -1-* of connector housing slightly in ⇒ *Example illustration of signal line in plug at door connection point -Arrow direction-*.
 - 5.2 Push out inner section ⇒ *Example illustration of signal line in plug at door connection point -2-* of connector housing.
 - 5.3 Pull out plug contact ⇒ *Example illustration of signal line in plug at door connection point -3-* of the signal line.

- 6 Cut off **new** signal line (on door connection point connector housing side) to sufficient length and crimp **new** plug contact.
 For work procedure, see: ⇒ *Workshop Manual '912841C8 Repairing antenna cable'*

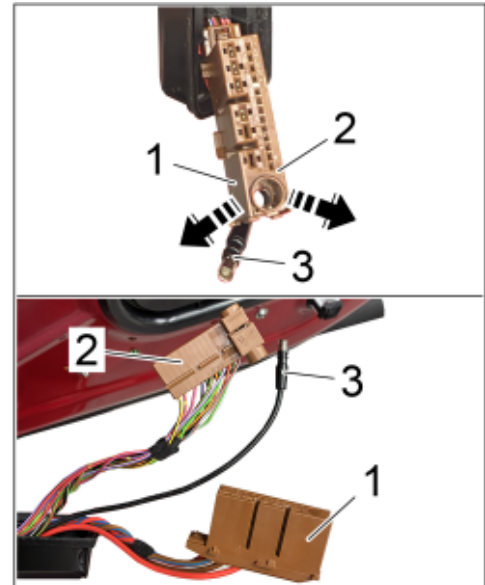

Example illustration of signal line in plug at door connection point



Information

When crimping and routing the new signal line, ensure that the line is installed without tension and without mechanical preloads.

- 7 Fasten connector housing for door connection point in the mounting housing using a **new** plug contact
⇒ *Example illustration of electric plug connection at the door connection point (door side) -2-*. Attach **new** cable tie ⇒ *Example illustration of electric plug connection at the door connection point (door side) -3-*.
- 8 Disconnect the previous signal line at a suitable point and connect it to the electric wire harness.

**Information**

If fabric tape has been opened or removed from the electric wire harness in the area below the grommet, re-attach it.
⇒ *Fabric tape*

- 9 Open cable holder ⇒ *Example illustration of electric wire harness for front door -1-* and wrap the signal line tightly around the wire harness ⇒ *Example illustration of electric wire harness for front door -2-* using fabric tape. Then wrap the grommets tightly with ⇒ *Example illustration of electric wire harness for front door -3-* fabric tape again to the wire harness and ⇒ *Example illustration of electric wire harness for front door -1-* attach the cable holders.

Ensure that no moisture can penetrate into the wire harness.

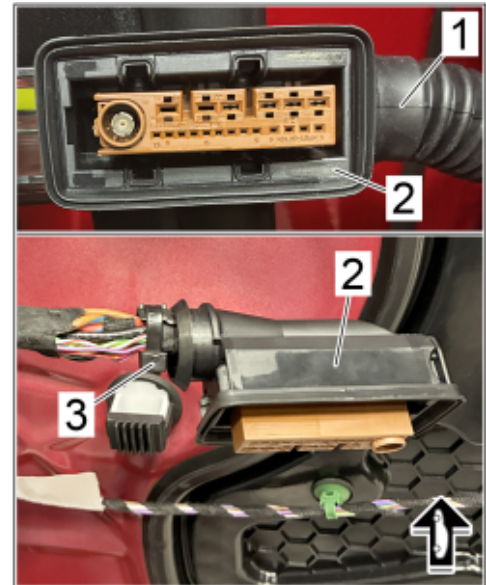

Example illustration of electric plug connection at the door connection point (door side)



Fabric tape



Example illustration of electric wire harness for front door

10 Install **new** electric wire harness on front door (bodyshell).

Replace plug contact on front main wire harness (door connection point on vehicle side)**Information**

The action is carried out on the **new** wire harness **before** installation.
Example illustration of the **new** wire harness when installed.

- Work Procedure: 1 Loosen connector housing of door connection point
⇒ Example illustration of electric plug connection at the door connection point (vehicle side) -1- on the **new** electric wire harness and pull off in ⇒ Example illustration of electric plug connection at the door connection point (vehicle side) -Arrow direction-.

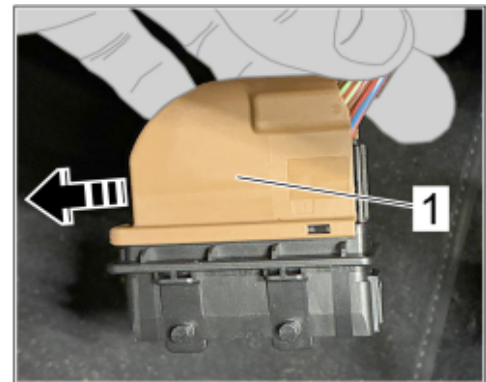

Example illustration of electric plug connection at the door connection point (vehicle side)

- 2 Release plug contact of the signal line ⇒ Example illustration of signal line at door connection point -1-, pull ⇒ Example illustration of signal line at door connection point -2- it out of the connector housing and replace it with a **new** plug contact.
For work procedure, see: ⇒ Workshop Manual '912841C8 Repairing antenna cable'
- 3 Install a corresponding **new** main wire harness for section front left/right.



Example illustration of signal line at door connection point

Labor position and PCSS encryption

Labor position:

APOS	Labor operation	I No.
97434945	Rework wire harness for rear-view mirror	
97324945	Rework new wire harness for front left door	
97324946	Rework new wire harness for front right door	
97094947	Rework new main wire harness for front section	

PCSS encryption:

Location (FES5)	97430	Wire harness for rear-view mirror
Damage type (SA4)	1057	Crimp faulty

PCSS encryption:

Location (FES5)	97320	Door wire harness
Damage type (SA4)	1057	Crimp faulty

PCSS encryption:

Location (FES5)	9709	Main wire harness
Damage type (SA4)	1057	Crimp faulty

Important Notice: Technical Bulletins issued by Porsche Cars North America, Inc. are intended only for use by professional automotive technicians who have attended Porsche service training courses. They are written to inform those technicians of conditions that may occur on some Porsche vehicles, or to provide information that could assist in the proper servicing of a vehicle. Porsche special tools may be necessary in order to perform certain operations identified in these bulletins. Use of tools and procedures other than those Porsche recommends in these bulletins may be detrimental to the safe operation of your vehicle, and may endanger the people working on it. Properly trained Porsche technicians have the equipment, tools, safety instructions, and know-how to do the job properly and safely. Part numbers listed in these bulletins are for reference only. The work procedures updated electronically in the Porsche PIWIS diagnostic and testing device take precedence and, in the event of a discrepancy, the work procedures in the PIWIS Tester are the ones that must be followed.

© 2026 Porsche Cars North America, Inc.