

Volterra™ ZSL™ Park Brake Valve Pressure Switch Replacement

Date: April 20, 2026

Bulletin Name: ZSL-IB-004

Model: Volterra™ ZSL™ Side Loader

Model Years: 2024 – April 10, 2026

Purpose:

McNeilus Truck and Manufacturing provides instructions for installing an updated park brake valve pressure switch. The updated pressure switch has a higher pressure activation and reset values which reduces the delay experienced with the previous pressure switch and addresses an unintended door alarm.

Notice:

- This bulletin should be read and understood in its entirety before performing this update procedure.
- All procedures outlined must be performed by skilled service personnel.
- Parts can be purchased from your McNeilus dealer service network at 888-686-7278. Customer will supply own labor, tools and equipment.
- Confirm all parts are present before starting the procedure.

SAFETY NOTICE

Perform your company's Lockout/Tagout procedure. If your company does not have a Lockout/Tagout procedure, follow OSHA 1910.147 and 1910.146 Confined Space as appropriate.

SAFETY NOTICE

Use appropriate Personal Protective Equipment (PPE) as required by your company.

Parts, Tools, and Equipment Required:

Customer to supply:

- Loctite® 567 or 242 (follow package instructions for application)

Parts Required

Item	Part Number	Description	Qty.
1	A001J487	SWITCH, PRESS, NC, 20PSI	1

Procedure:

Lockout/Tagout

1. Confirm chassis parking brake is applied and wheels are chocked.
2. Confirm ignition is OFF.
3. Remove key from vehicle ignition and maintain in personal possession.
4. Shut off toggle switch next to the 24V Emergency/Service Disconnect Switch (Figure 1).
5. Wait 10 seconds.
6. Turn 24V Emergency/Service Disconnect Switch to OFF (Figure 1).
7. Perform your company's lockout/tagout procedures.

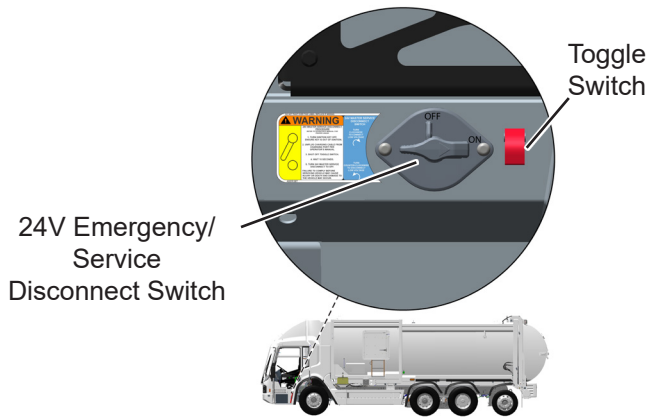

Figure 1: Shows ZFL for illustrative purposes only.

Pressure Switch Installation

- Loosen and remove screws and flat washers from the perimeter of back-of-cab (inside) panel. See Figure 2. Retain screws and flat washers for reinstallation.

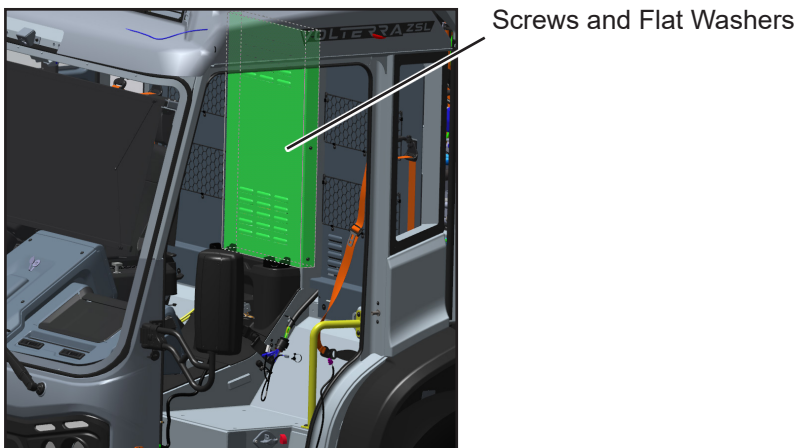

Figure 2 - Back-of-cab (inside) panel

- Access the park brake valve assembly. See Figure 3.

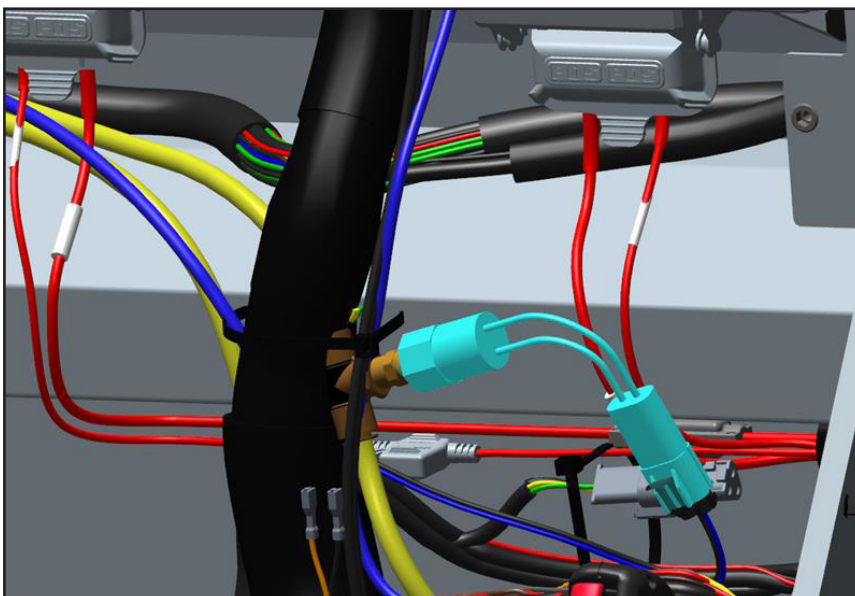

Figure 3 - Pressure switch location

- Disconnect pressure switch connector from cab harness connector X2136. See Figure 4.

11. Loosen and remove pressure switch from park brake valve signal line tee fitting. See Figure 4.
Discard the switch.

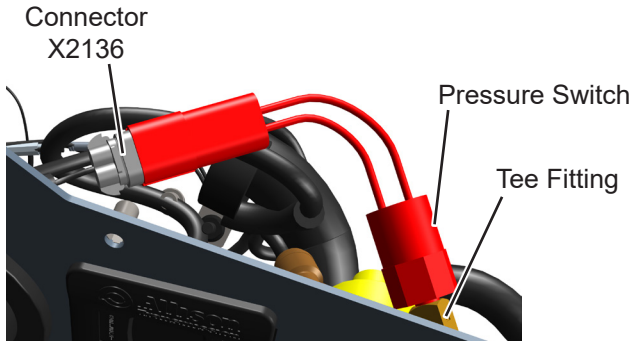

Figure 4

12. Apply Loctite® 567 (following package instructions) to threads of pressure switch (A001J487) and install switch in tee fitting where old switch was removed. See Figure 5. Tighten pressure switch hand-tight plus 2 – 3 turns.
13. Connect pressure switch connector to cab harness connector X2136. See Figure 5.

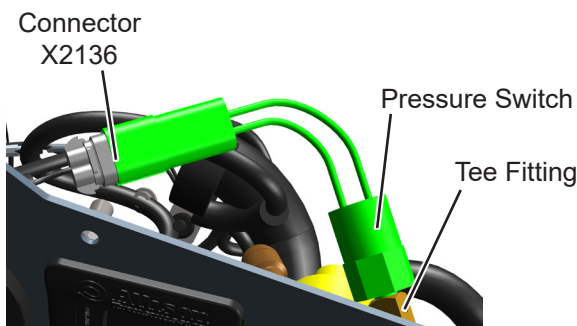

Figure 5

14. Reposition the back of cab panel on (inside) back of cab wall.
15. Apply Loctite® 242 (following package instructions) to threads of screws removed in Step 8 and reinstall screws and flat washers around perimeter of the panel. See Figure 6. Final tighten of screws to 75 in.-lbs.

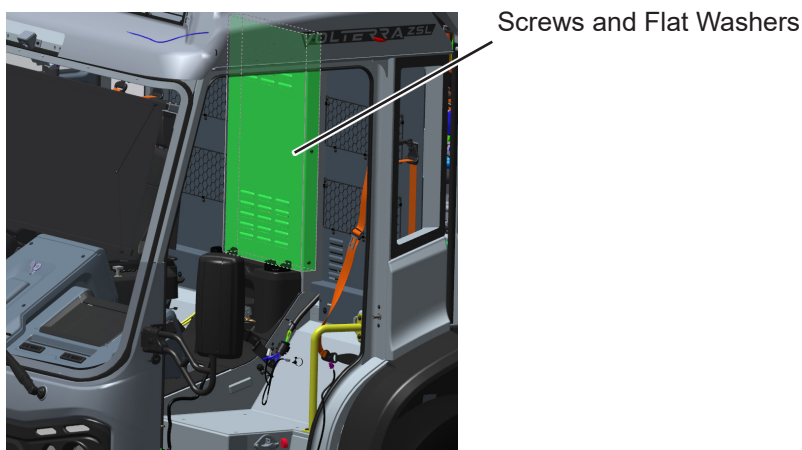

Figure 6

16. Turn the 24V Emergency/Service Disconnect Switch to ON and remove your company's Lockout/Tagout procedure. If your company does not have a Lockout/Tagout procedure, follow OSHA 1910.147 and 1910.146 Confined Space as appropriate and wheel chocks.
17. Return vehicle to service. Procedure is complete.