

REFERENCE:	TSB: 23-018-26 GROUP: 23 - Body	Date:	May 21, 2026	REVISION:	—
VEHICLES AFFECTED:	2025 - 2026 (DT) RAM 1500 Pickup This bulletin applies to vehicles built on or after May 26, 2025 (MDH 0526XX) and on or before February 11, 2026 (MDH 0211XX) equipped with Blind Spot And Cross Path Detection (Sales Code XAN) and one of the following: <ul style="list-style-type: none"> • Accent Color Premium Power Mirrors (Sales Code GT4). • Black Base Power Mirrors (Sales Code GT6). • Chrome Premium Power Mirrors (Sales Code GU4). • Black Premium Power Mirrors (Sales Code GUK). 			MARKET APPLICABILITY: <input checked="" type="checkbox"/> NA <input type="checkbox"/> MEA <input type="checkbox"/> SA <input type="checkbox"/> IAP <input type="checkbox"/> EE <input type="checkbox"/> CH NOTE: This bulletin applies to the North America markets.	
CUSTOMER SYMPTOM:	Customers may comment on the following: <ul style="list-style-type: none"> • Wind noise or whistle noise heard from the driver door mirror area while driving. 				
CAUSE:	Mirror access cover deformation				

REPAIR SUMMARY:

This bulletin involves replacing the left-hand door mirror access cover.

CLAIMS DATA:

Labor Operation No:	Labor Description	Skill Category	Labor Time
23-04-21-91	Mirror, Access Cover - Replace (0 - Introduction)	6 - Electrical and Body Systems	2.4 Hrs.
Failure Code	ZZ	Service Action	

SPARE PARTS:

NOTE: There are several left-hand mirror assembly options. Please order by VIN to obtain the correct mirror access cover.

Qty	Part No.	Description	Notes
1 (AR)	68744863AB	Mirror, Access Cover	Equipped With Temperature Sensor
1 (AR)	68744861AB	Mirror, Access Cover	Equipped With Temperature Sensor and Logo Lamp

DIAGNOSIS:

If the customer describes any of the symptoms listed above in the customer symptom section, perform the Repair Procedure.

SPECIAL TOOLS/EQUIPMENT:

Description	Ref. No.	Notes
Trim Stick	C-4829A	Essential Tool
Tape	NPN	

REPAIR PROCEDURE:

1. Locate the mirror access cover on the underside of the driver door mirror [Fig. 1](#).



Fig. 1
Mirror Access Cover Location

-
- 1 - Mirror Access Cover
 - 2 - Mirror Access Cover Insert Slot

- Using a trim stick, loosen the mirror access cover from the mirror assembly [Fig. 2](#).



Fig. 2
Loosen Access Cover

1 - Use Trim Stick To Loosen Cover At Insert Slot

- Pull the mirror access cover away from the mirror to gain access to the outside ambient temperature sensor [Fig. 3](#).



Fig. 3
Access Cover

4. Flip the mirror access cover and grab the outside ambient temperature sensor, twist counter-clockwise and pull to remove [Fig. 4](#).

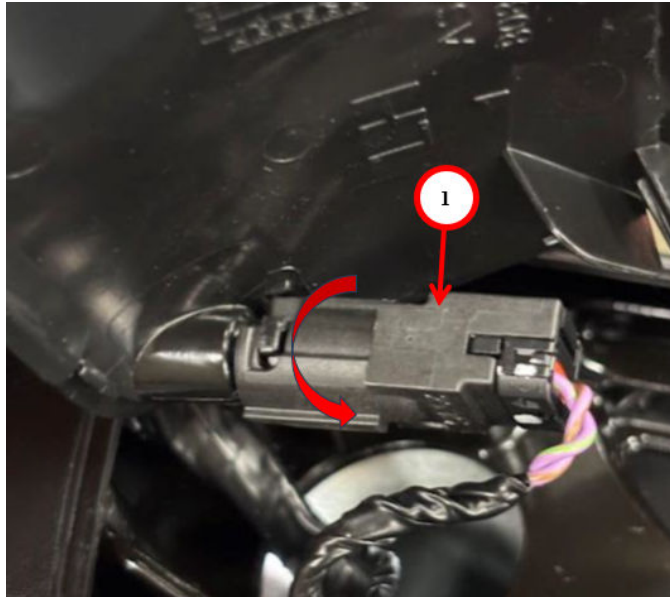
**Fig. 4**

Remove Outside Ambient Temperature Sensor

1 - Outside Ambient Temperature Sensor

5. If equipped, push in the tab on the logo lamp to remove it from the access cover [Fig. 5](#).

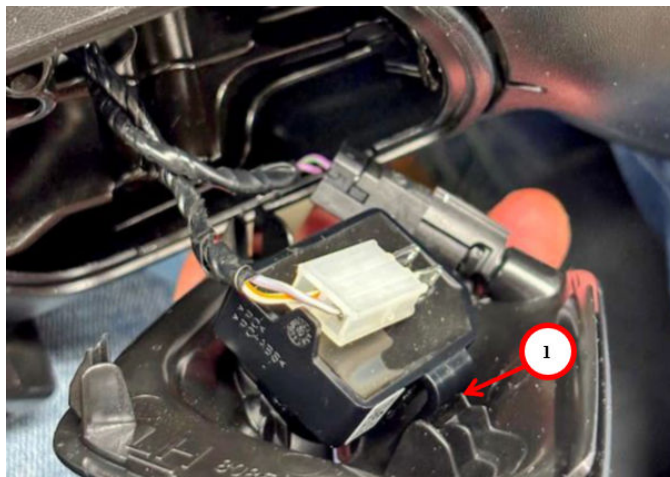
**Fig. 5**

Removed LOGO Lamp From Access Cover

1 - Logo Lamp Tab

6. **DISCARD** the mirror access cover.
7. Position a **NEW** mirror access cover for installation.

8. If equipped, place the logo lamp into the access tab. Depress the lamp until an audible click is heard [Fig. 6](#).

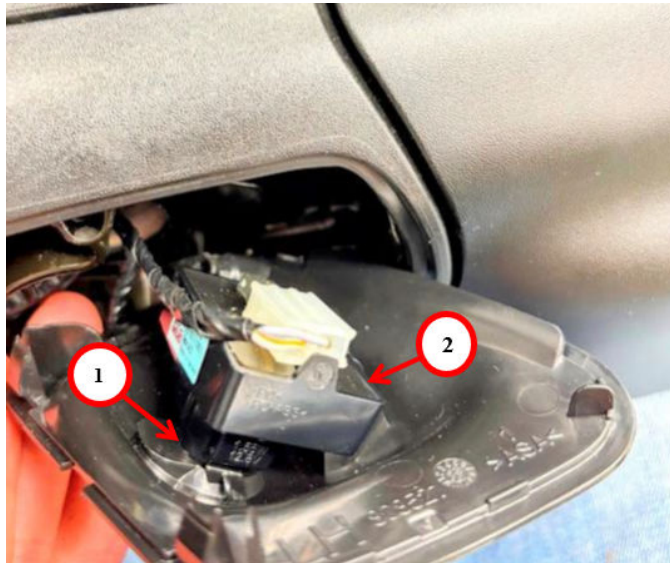

Fig. 6
Install Logo Lamp

1 - Position Logo Lamp To Mirror Access Cover Tab
2 - Logo Lamp

NOTE: Ensure that the lip goes under the A-surface hole before snapping into place.

9. Install the outside ambient temperature sensor to the mirror access cover. Twist clockwise to lock into place [Fig. 7](#).

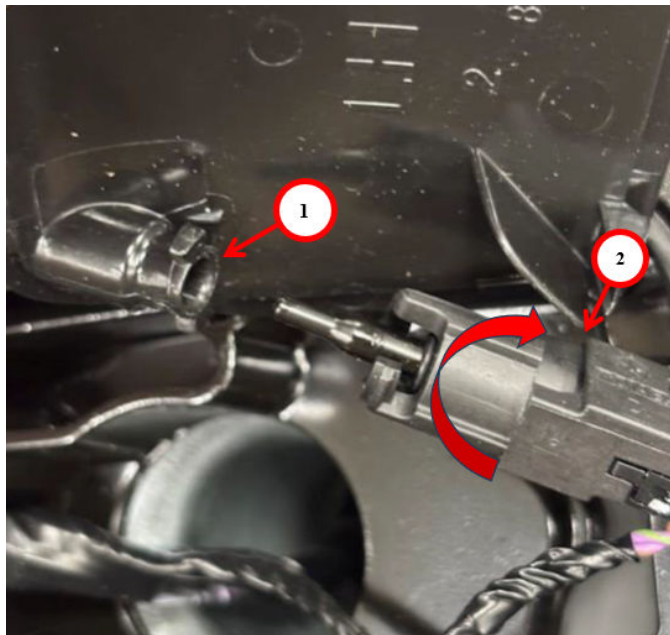

Fig. 7
Install Outside Ambient Temperature Sensor

1 - Outside Ambient Temperature Sensor Installation Port
2 - Outside Ambient Temperature Sensor

10. Line up the mirror access cover lip to the bottom edge of the outer base of the mirror assembly [Fig. 8](#).



Fig. 8

Mirror Access Cover To Mirror Alignment

11. After the ribs align, push down and slide towards the insert hole side [Fig. 9](#).



Fig. 9

Mirror Access Cover Installation

12. Push down on the insert clip side of access cover until you hear an audible pop Fig. 10.



Fig. 10
Properly Installed Mirror Access Cover

NOTE: Ensure the front lip is under the base cover before pushing down.

13. Inspect the mirror access cover installation. Confirm the access cover is properly seated, flush, and not loose. Verify that the outside ambient temperature sensor tip is visible through the sensor hole in the access cover.

POLICY:

Reimbursable within the provisions of the warranty.

This bulletin is supplied as technical information only and is not an authorization for repair. No part of this publication may be reproduced, stored in a retrieval system, or transmitted, in any form or by any means, electronic, mechanical, photocopying, or otherwise, without written permission of FCA US LLC.