



Replace the Front Hood Node

This instruction refers to other documents that are necessary to do the procedure.

Situation

Update the location of the front hood node to the wheel arch to assure proper hood lift.

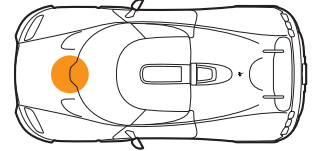

Action

Replace the front hood node with an improved version.

PPE	REFERENCE	QUANTITY
Protective gloves	–	1 pair
Safety goggles	–	1

PARTS	REFERENCE	QUANTITY
Access Panel Wheelarch Foam RH	1056869	1
Adapter Harness for Front Hood Node	1093469	1
Front Hood Node Assy	1093068	1
Front Hood Node Bracket	1093027	1
Screw Flanged Button head M4x20	1034399	2
Snaploc Coupling plate	170-199-5021	3
Snaploc Stud	170-199-5020	3
Washer Flat	1036117	2

TOOLS	SPECIFICATION	QUANTITY
Drill bit	4,0 mm	1
Front Hood Node Hole Template 1	1093025	1
Front Hood Node Hole Template 2	1093026	1
General mechanical tools	–	–
Thin brush	–	–

CONSUMABLES	REFERENCE	QUANTITY
A/C isolation tape	130-873-9014	2x 150 mm
Bedding Compound Black	130-183-1020	–
Black Adhesive	130-114-1022	–
CRC Ceramic Paste	130-183-4002	–
Isopropanol, 99%	–	–
Loctite 243	130-174-0552	–





CONSUMABLES	REFERENCE	QUANTITY
Tesa fleece tape 15x19	3718-012	–
Wire tape	170-112-0002	–

Remove

1. Open the front hood with the key fob or from the center console. If the 12 V is set to off, open the front hood manually, refer to [WOM-00748](#).
2. Disconnect the 12 V system, refer to [WOM-00489](#).
3. Cut the black glue adhesive around the access panel of the wheel arch.
4. Remove 4x T25 bolts **A** from the access panel of the wheel arch.

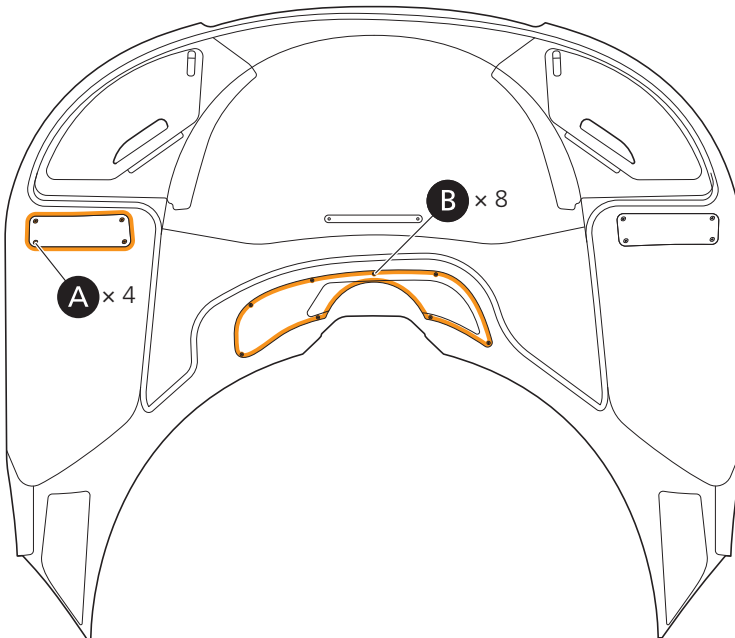

5. Remove the access panel of the wheel arch.
6. Remove and discard the foam from the access panel of the wheel arch.

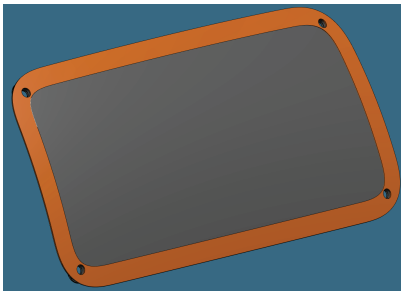

7. Use isopropanol to remove the remaining glue from the surface of the access panel.
8. Remove 8x T20 bolts **B** and washers from the access panel of the front hood.
9. Disconnect the connector X141 from the front hood node.



- Remove 3x T10 bolts **C** from the bracket that is attached to the access panel of the front hood.

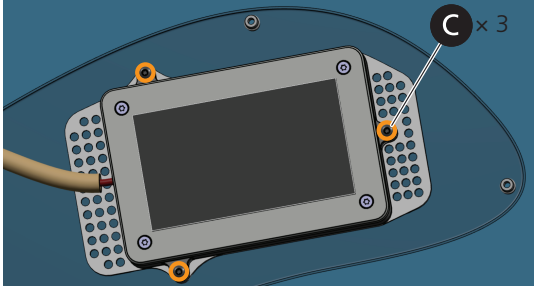

- Remove the front hood node.
- Put on the personal protective equipment.
 - PPE:** Protective gloves
 - PPE:** Safety goggles

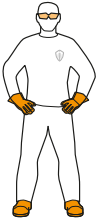

Prepare the Access Panel Wheel-Arch

- Put the access panel into the templates.
 - Tool:** 1093025, 1093026



- Drill 2x 4mm holes in the access panel, refer to the holes in the template.



- Remove the templates.
- Attach the bracket to the access panel with 2x T20 bolts.
 - Part:** 1093027, 1034399



5. Use a marker to put marks around the bracket to help with the grinding process.

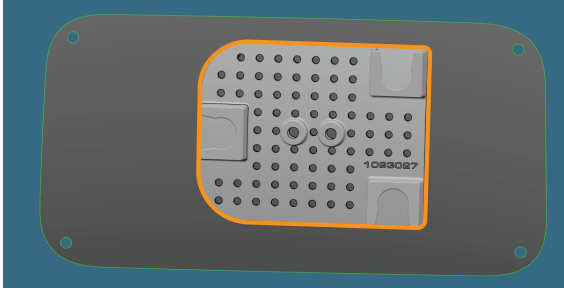

6. Remove 2× T20 bolts together with the bracket.
7. Attach masking tape at a distance of 1-2 mm from the bracket marks on the access panel.
8. Use sandpaper to make the surface in the marked area on the access panel rough.
9. Use sandpaper to make the surface of the bracket that will be bonded to the panel rough.
10. Remove the masking tape from the access panel.
11. Use a cloth with isopropanol to clean the surfaces from dust.
12. Apply a large quantity of glue to the rough surface of the bracket.

Consumable: 130-114-1022

Note

Apply a large quantity of glue. Some glue must come out from the sides and through the holes of the bracket.



13. Install 2× T20 bolts and washers to the access panel and hold them. This helps you get the bracket in the correct position.
Part: 1036117
14. Install the bracket to the access panel.
15. Tighten 2× T20 bolts.
Torque: 1 Nm
16. Use handy wipes to remove glue that came out from the sides and through the holes of the bracket.
17. Let the glue cure for 24 hours.





Route the Adapter Harness to the RH Access Panel of Wheel Arch

1. Route the new adapter harness **A** in the front hood.

Part: 1093469

- 1.1 Make sure that the connectors X393 and X391 are on the front-hood wash-pipe access panel side.
- 1.2 Make sure that the connector X141 is on the wheel-arch access panel side.

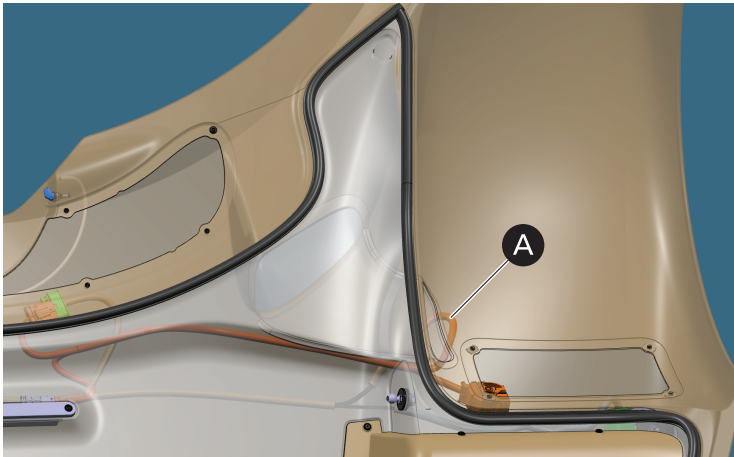

2. Connect the connector X391 from the adapter harness to the front hood harness.
3. Connect the connector X393 from the adapter harness to the lamp.
4. Wind AC isolation tape **B** around the connected connectors X393 and X391.

Part: 130-873-9014

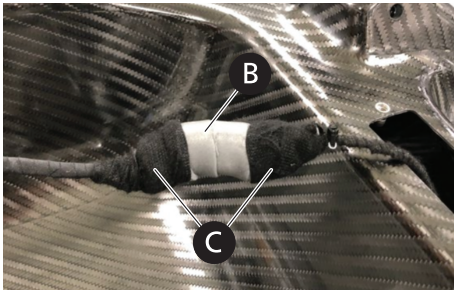

5. Safety the ends of the AC tape with protection tape **C**.

Part: 3718-012

6. Use wire tape to attach the adapter harness to the front hood harness.

Part: 170-112-0002





Install

1. Install 3× snaplocks **A** to the new front hood node.

Part: 170-199-5020, 1093068

Threadlocker: Loctite 243

Torque: 1 Nm

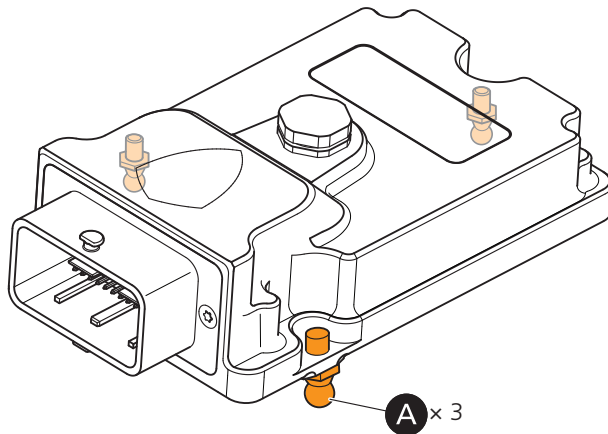

2. Attach 3× snaplocks coupling plate **B** to the bracket.

Part: 170-199-5021

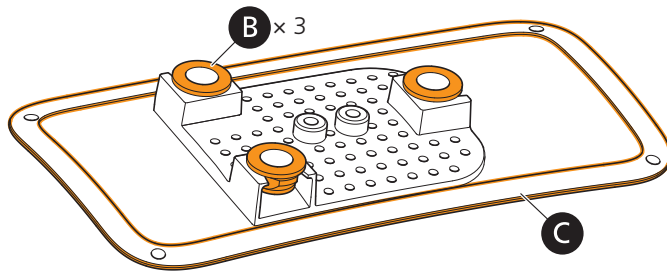

3. Attach the front hood node to the bracket on the access panel of the wheel arch with the snaplocks.
4. Use a cloth with isopropanol to clean the contact surfaces on the wheel-arch access panel.
5. Put the new foam **C** on the contact surface on the wheel-arch access panel.

Part: 1056869

6. Connect the connector X141 to the new front hood node.





7. Install the access panel of the wheel arch with 4x T25 bolts **D**.

Consumable: CRC Ceramic Paste

Torque: 3 Nm

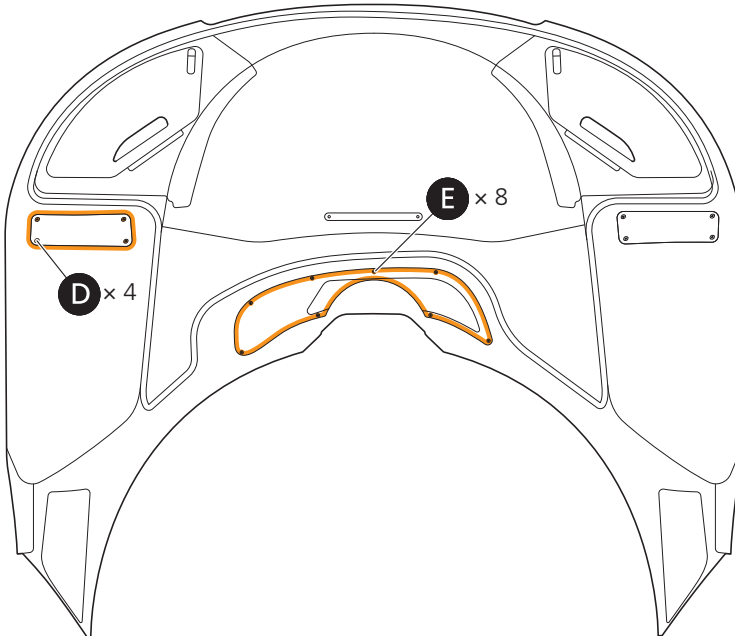

8. Seal the joints around the access panel of the wheel arch with black glue adhesive, refer to [SER-00021](#).

9. Install the access panel of the front hood with 8x T20 bolts **E** and washers.

Threadlocker: Loctite 243

Torque: 2 Nm

10. Do a PDM1 configuration, refer to [WOM-00640](#).

11. Calibrate the hoods and doors, refer to [WOM-00651](#)

12. Do a PDM1 – IMU calibration, refer to [WOM-00641](#).

13. Use a thin brush or equivalent to put compound on the heads of bolts on the access panel of the wheel arch. Do not paint the compound. Touch the brush to the bolts to put compound on them. Then move the brush away. Do this action again until the bolts have a thin layer of compound.

Consumable: 130-183-1020

14. Let the compound cure for 24 hours.





Warranty Information

If the repair is covered by the warranty terms, refer to Koenigsegg Warranty Process.

OPERATION

KWO178520

PART NO

Refer to the invoiced kit number.

Parts to be Returned

PARTS	REFERENCE	QUANTITY
Front Hood Node Assy	1044905	1

