



Nodes Sealing Update

This document contains two model specific instructions with two different kits. Before you start the work, make sure that you use the correct instruction and have the correct kit. Refer to the information in the heading on the pages that follow.

Situation

Electronic nodes may not be sealed according to our standard.

Action

Install the new nodes with improved sealing.





Nodes Sealing Update

This instruction refers to other documents that are necessary to do the procedure.

PARTS	REFERENCE	QUANTITY
Door Node Assy LH	1092204	1
Door Node Assy RH	1092203	1
Front Hood Node Assy	1098228	1
PCB box 110x70 assy front bumper	1098095	1
Rear Hood Node Assy	1098419	1
Stud Threaded SnapLoc	1076856	9

TOOLS	SPECIFICATION	QUANTITY
General mechanical tools	–	–

CONSUMABLES	REFERENCE	QUANTITY
Loctite 243	130-174-0552	–

Door Node

This instruction is applicable to the RH and LH side. The illustrations show the LH side.

1. Open the doors with the key fob or with the door button.
2. Disconnect the 12 V system, refer to [WOM-00082](#).
3. For Jesko, remove the door pocket, refer to [WOM-00149](#).
4. For Jesko U.S, remove the door armrest, refer to [WOM-00617](#).
5. Remove the interior door handle, refer to [WOM-00148](#).
6. Remove the lower door panel, refer to [WOM-00145](#).
7. Remove 4x T25 bolts **A** from the door handle support.

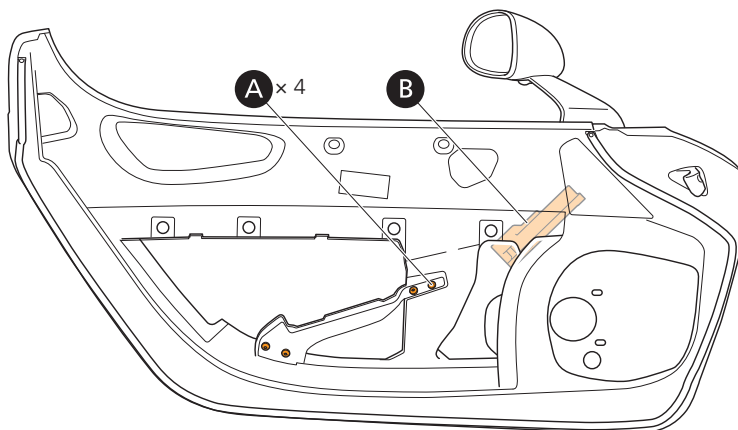
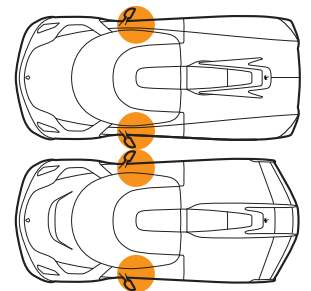

8. Remove the door handle support.
9. Disconnect the connector from the door node **B**.
 - Connector X145 on the LH side.
 - Connector X1145 on the RH side.





10. Remove 3x T25 bolts **C** that attach the door node **B** to the bracket.

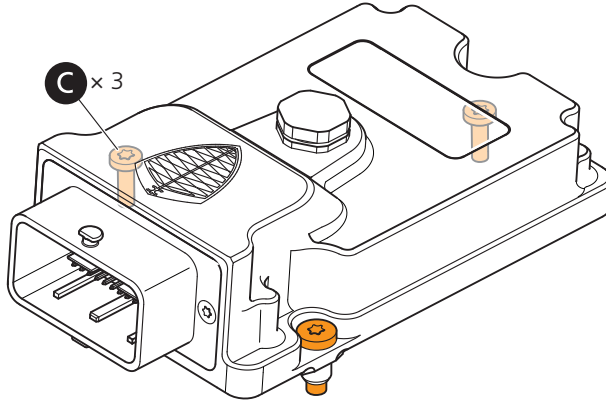

11. Remove the door node **B**.

12. Install in the reverse order with the new door node.

Part: 1092204 (LH), 1092203 (RH)

ITEM	THREADLOCKER	TORQUE
A	–	6 Nm
C	Loctite 243	2 Nm

Front Bumper and Front Hood Modules

1. Open the front hood with the key fob or from the center console.
2. Disconnect the 12 V system, refer to [WOM-00082](#).
3. Loosen the front wheel nuts, refer to [WOM-00083](#).
4. Lift and put the vehicle on jack stands, refer to [WOM-00092](#).
5. Remove the front wheels, refer to [WOM-00083](#).
6. Remove the front compartment plate, refer to:
 - Jesko Attack, [WOM-00132](#)
 - Jesko Absolut, [WOM-00091](#).
7. Remove the front splitter, refer to [WOM-00126](#).
8. Remove the front bumper, refer to [WOM-00127](#).
9. Find the front bumper module, refer to [WOM-00265](#).
10. Disconnect the connector X131 from the front bumper module.

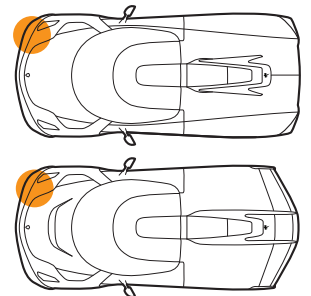
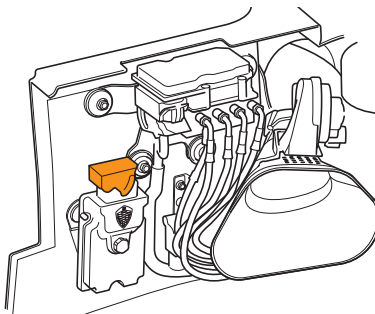

11. Release the front bumper module from the snap-locks.
12. Find the front hood module, refer to [WOM-00265](#).





13. Disconnect the connector X192 from the front hood module.

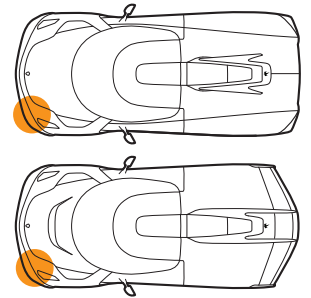
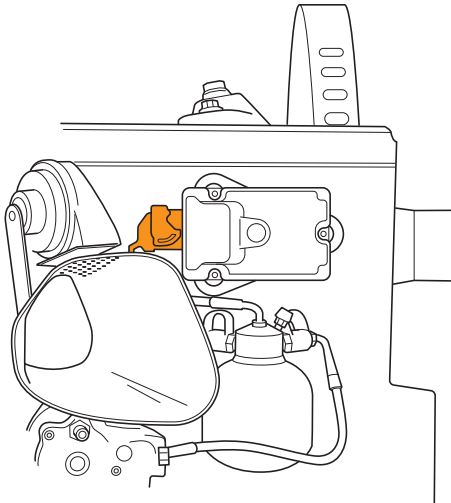

14. Release the front hood module from the snap-locks.

15. Install 3× snap-locks **A** on each module:

- new front bumper module
- new front hood module.

Part: 1076856, 1098095, 1098228

Torque: 2 Nm

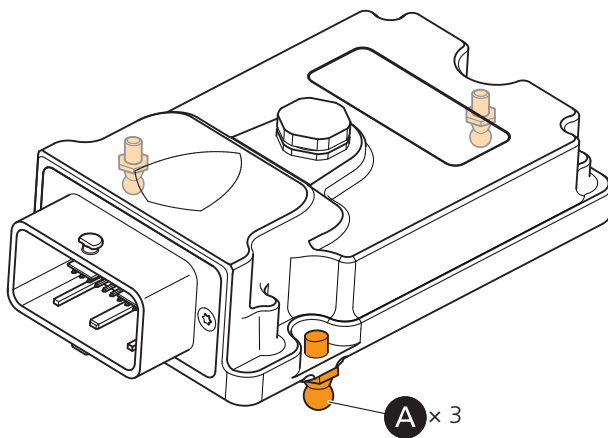

16. Install in the reverse order with the new front bumper and front hood modules.

Rear Hood Module

1. Open the rear hood with the key fob or from the center console. If the 12 V is set to off, open the rear hood manually, refer to [WOM-00223](#).
2. Disconnect the 12 V system, refer to [WOM-00082](#).
3. Remove the rear hood latch, refer to [WOM-00301](#).
4. Find the rear hood module, refer to [WOM-00265](#).
5. Remove the rear hood module, refer to [WOM-00438](#).

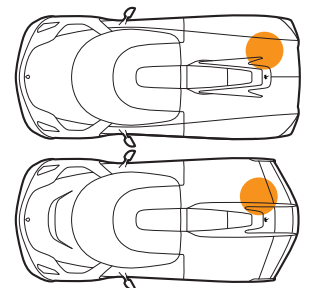



6. Install 3x snap-locks **A** to the new rear hood module.

Part: 1076856, 1098419

Torque: 2 Nm

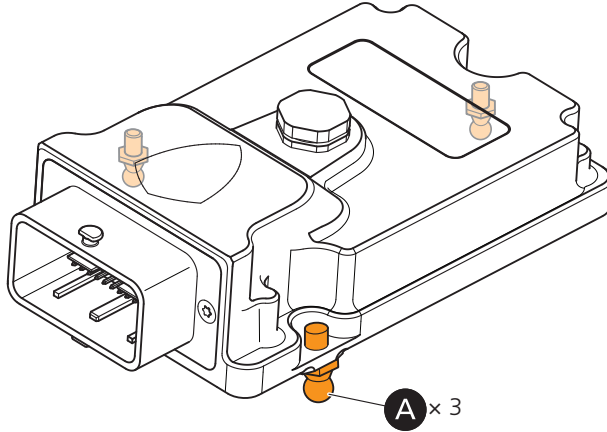

7. Install in the reverse order with the new rear hood module.

Calibrate

Calibrate the hoods and doors, refer to **WOM-00328**

Note

Dealers do not have access to the **Calibration** menu. For support, submit a KATS ticket to contact Koenigsegg.

Warranty Information

If the repair is covered by the warranty terms, refer to Koenigsegg Warranty Process.

OPERATION

KWO216570

PART NO

Refer to the invoiced kit number

DISCARDED

Any discarded parts mentioned in the TSB must be returned or destroyed according to the Dealer Warranty Manual.

Parts to be Returned

PARTS	REFERENCE	QUANTITY
Door Node Assy LH	1092204	1
Door Node Assy RH	1092203	1
Front Hood Node Assy	180-398-0005-AA	1
PCB box 110x70 assy front bumper	1006091	1
Rear Hood Node Assy	180-398-0007-AA	1





Nodes Sealing Update

This instruction refers to other documents that are necessary to do the procedure.

PARTS	REFERENCE	QUANTITY
Door Node Assy LH	1092204	1
Door Node Assy RH	1092203	1
PCB box 110x70 assy front bumper	1098095	1
Rear Hood Node Assy	1098419	1
Stud Threaded SnapLoc	1076856	6

TOOLS	SPECIFICATION	QUANTITY
General mechanical tools	–	–

CONSUMABLES	REFERENCE	QUANTITY
Loctite 243	130-174-0552	–

Door Node

This instruction is applicable to the RH and LH side. The illustrations show the LH side.

1. Open the doors with the key fob or with the door button.
2. Disconnect the 12 V system, refer to [WOM-00489](#).
3. Remove the door armrest, refer to [WOM-00507](#).
4. Remove the interior door handle, refer to [WOM-00503](#).
5. Remove the lower door panel, refer to [WOM-00506](#).
6. Remove 4x T25 bolts **A** from the door handle support.

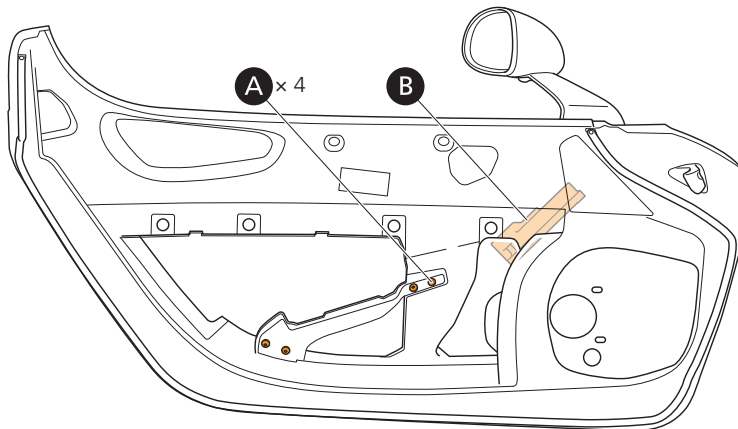
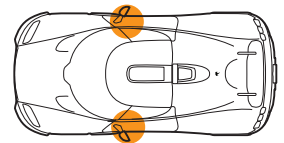

7. Remove the door handle support.
8. Disconnect the connector from the door node **B**.
 - Connector X145 on the LH side.
 - Connector X1145 on the RH side.





- Remove 3x T25 bolts **C** that attach the door node **B** to the bracket.

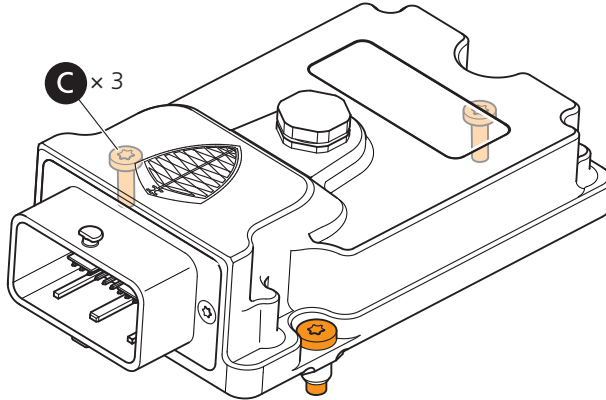

- Remove the door node **B**.
- Install in the reverse order with the new door node.

Part: 1092204 (LH), 1092203 (RH)

ITEM	THREADLOCKER	TORQUE
A	–	6 Nm
C	Loctite 243	2 Nm

Front Bumper Node

- Open the front hood with the key fob or from the center console. If the 12 V is set to off, open the front hood manually, refer to [WOM-00748](#).
- Disconnect the 12 V system, refer to [WOM-00489](#).
- Remove the luggage compartment plate, refer to [WOM-00497](#).
- Remove the front splitter, refer to [WOM-00596](#).
- Loosen the front wheel nuts, refer to [WOM-00490](#).
- Lift and put the vehicle on jack stands, refer to [WOM-00492](#).
- Remove the front wheels, refer to [WOM-00490](#).
- Remove the front bumper, refer to [WOM-00581](#).
- Disconnect the connector X131 from the front bumper node.

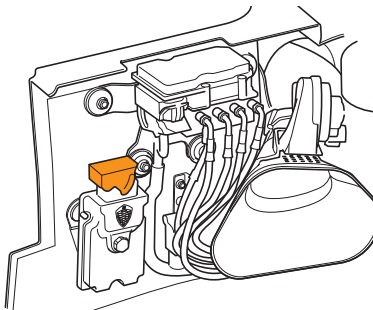
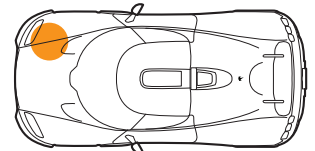

- Release the front bumper node from the snap-locks.





11. Install 3× snap-locks **A** to the front bumper node.

Part: 1076856, 1098095

Torque: 2 Nm

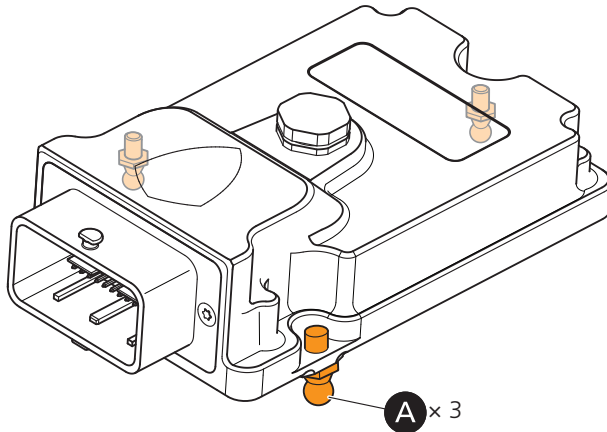

12. Install in the reverse order with the new front bumper node.

Rear Hood Node

1. Open the rear hood with the key fob or from the center console. If the 12 V is set to off, open the rear hood manually, refer to [WOM-00645](#).
2. Disconnect the 12 V system, refer to [WOM-00489](#).
3. Remove the rear-hood node access-panel, refer to [WOM-00708](#).
4. Disconnect the connector X113 from the rear-hood node.
5. Release the rear-hood node from the snap-locks.
6. Install 3× snap-locks **A** to the new rear-hood node.

Part: 1076856, 1098419

Threadlocker: Loctite 243

Torque: 2 Nm

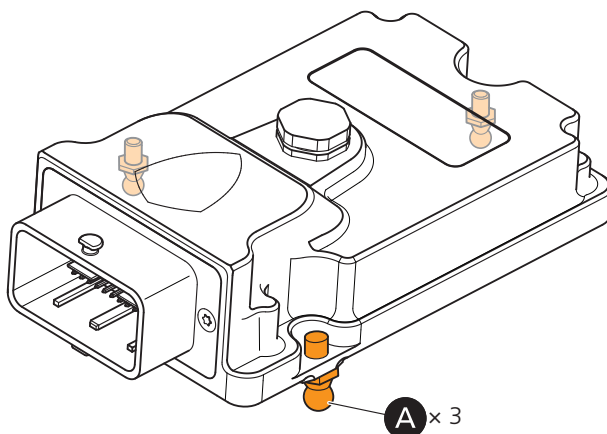
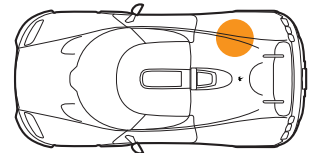

7. Install in the reverse order with the new rear-hood node.





Calibrate

Calibrate the hoods and doors, refer to [WOM-00651](#)

Note

Dealers do not have access to the **Calibration** menu. For support, submit a KATS ticket to contact Koenigsegg.

Warranty Information

If the repair is covered by the warranty terms, refer to Koenigsegg Warranty Process.

OPERATION

KW0542357

PART NO

Refer to the invoiced kit number

DISCARDED

Any discarded parts mentioned in the TSB must be returned or destroyed according to the Dealer Warranty Manual.

Parts to be Returned

PARTS	REFERENCE	QUANTITY
Door Node Assy LH	1092204	1
Door Node Assy RH	1092203	1
PCB box 110x70 assy front bumper	1006091	1
Rear Hood Node Assy	180-398-0007-AA	1

