



Mitsubishi Motors North America, Inc.

TECHNICAL SERVICE BULLETIN

SUBJECT:

HOOD FLUTTER MY 2022 OUTLANDER

No: TSB-26-42A-002

Version: 1

Reason for change: Production dates, repair instructions, and extended warranty coverage updated

Date: April 30, 2026

TO: Mitsubishi Motors US and Puerto Rico Dealer Principals, General Managers, Sales Managers, Service Managers, Service Advisors, Parts Managers, Technicians and Warranty Administrators

AFFECTED VEHICLES

MY 2022 Outlander:

Produced between: 2/08/2021 - 11/12/2021

VIN range for 2-wheel drive: JA4J3VA84NZ045789 - JA4J3TA82NZ051515

VIN range for 4-Wheel drive: JA4J4TA82NZ001193- JA4J4UA82NZ051534

COMPLAINT

NOTE THAT MMNA HAS EXTENDED THE NEW VEHICLE LIMITED WARRANTY TO COVER 100% OF THE COST OF THE HOOD REPLACEMENT REPAIR FOR ALL OWNERS OF AFFECTED VEHICLES THROUGH OCTOBER 31, 2027, SUBJECT TO THE CONDITIONS SET OUT IN THIS TSB. EXCLUDED FROM THE WARRANTY EXTENSION IS ANY FAILURE OF A HOOD RESULTING FROM DAMAGE, ABUSE, ALTERATION, MODIFICATION, COLLISION OR CRASH, VANDALISM AND/OR OTHER IMPACT OR OUTSIDE SOURCES.

Hoods of certain 2022 Mitsubishi Outlander vehicles are defective because they flutter and bounce while driving.

Dealerships should only perform hood replacements if there is a customer complaint of hood flutter.

CAUSE

Insufficient hood reinforcement

REMEDY

All vehicles equipped with a NON REINFORCED hood will require the engine hood to be replaced with the updated reinforced hood design.

Prior TSBs for adjustments or weatherstrip replacement **DO NOT** eliminate the need for a reinforced hood replacement.

Weather stripping installation, hood latch and hood bumper adjustments are NOT standalone repairs; adjustments are to be performed after the updated reinforced hood replacement.

VEHICLE IDENTIFICATION & VISUAL INSPECTION

1. Verify VIN and production date.
2. The Service Advisor and/or the Technician must confirm via repair history in the Superscreen that the reinforced hood replacement wasn't previously performed.
3. Inspect underside of hood for the following visual inspection:

NON-REINFORCED hood: No bolt heads visible → Hood replacement is required.

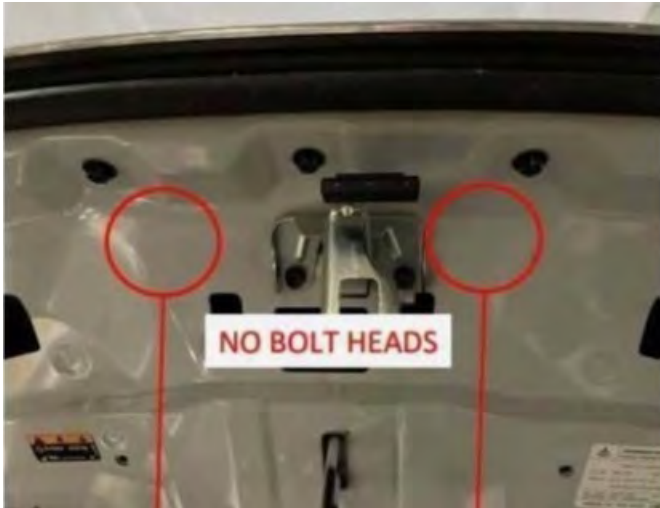

REINFORCED hood: Bolt heads visible → Hood replacement is **not required.**

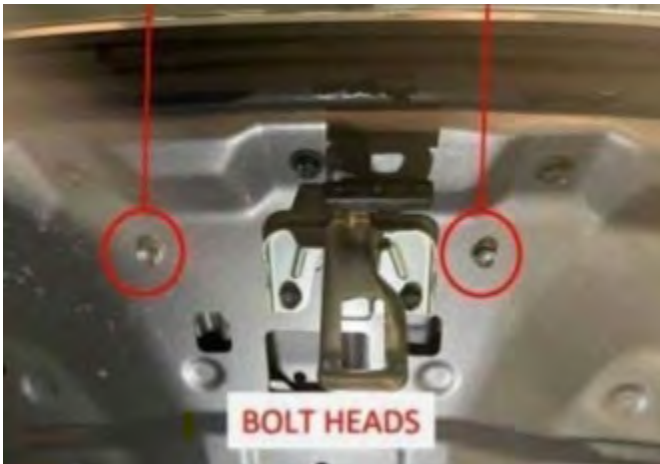

IMPORTANT:

Any 2022 Outlander with a NON-reinforced hood **MUST** receive an updated reinforced hood, regardless of any previous repairs performed at a Mitsubishi dealership for hood flutter issues including hood replacements with a NON-reinforced hood.

HOOD REPLACEMENT

REMOVAL AND INSTALLATION

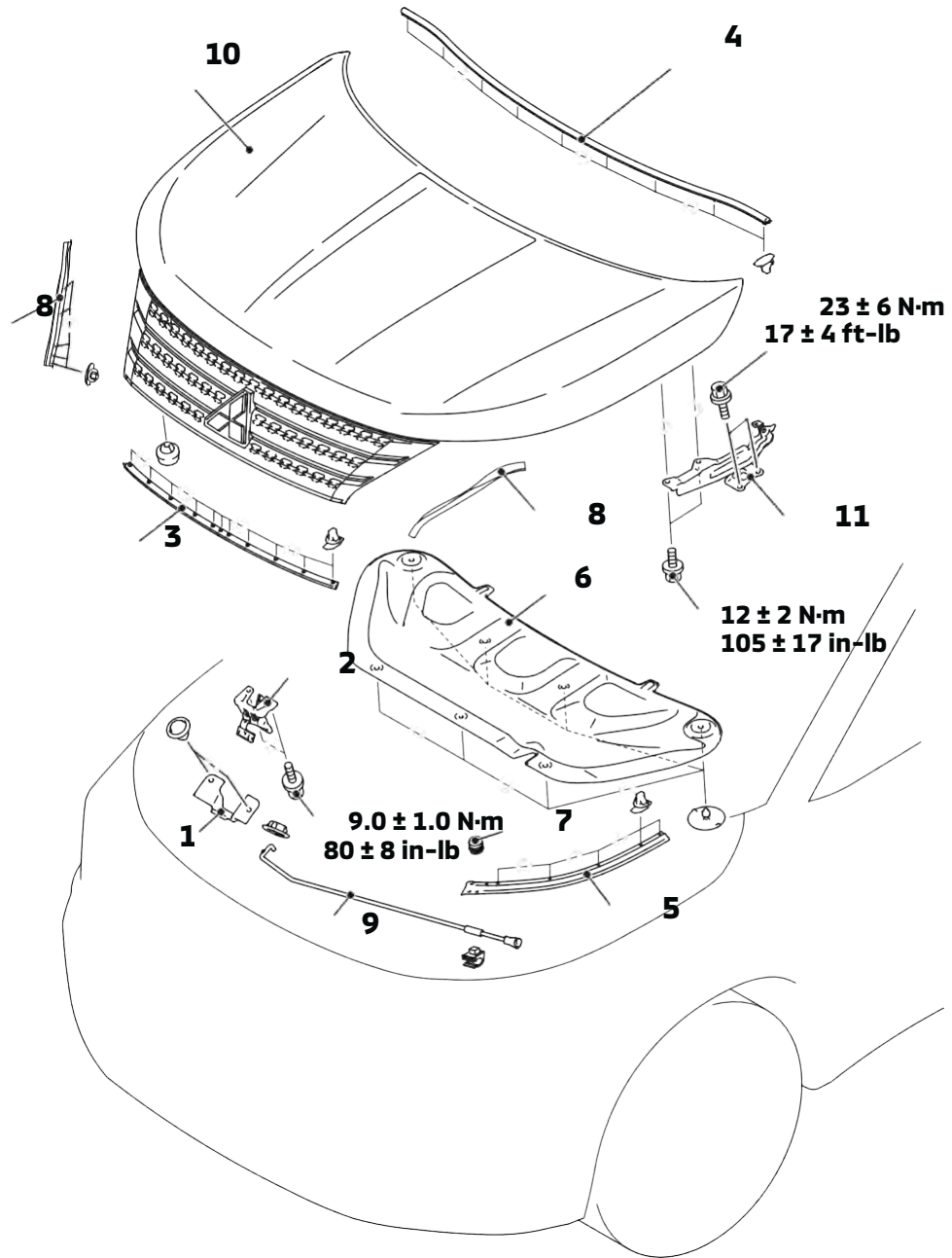

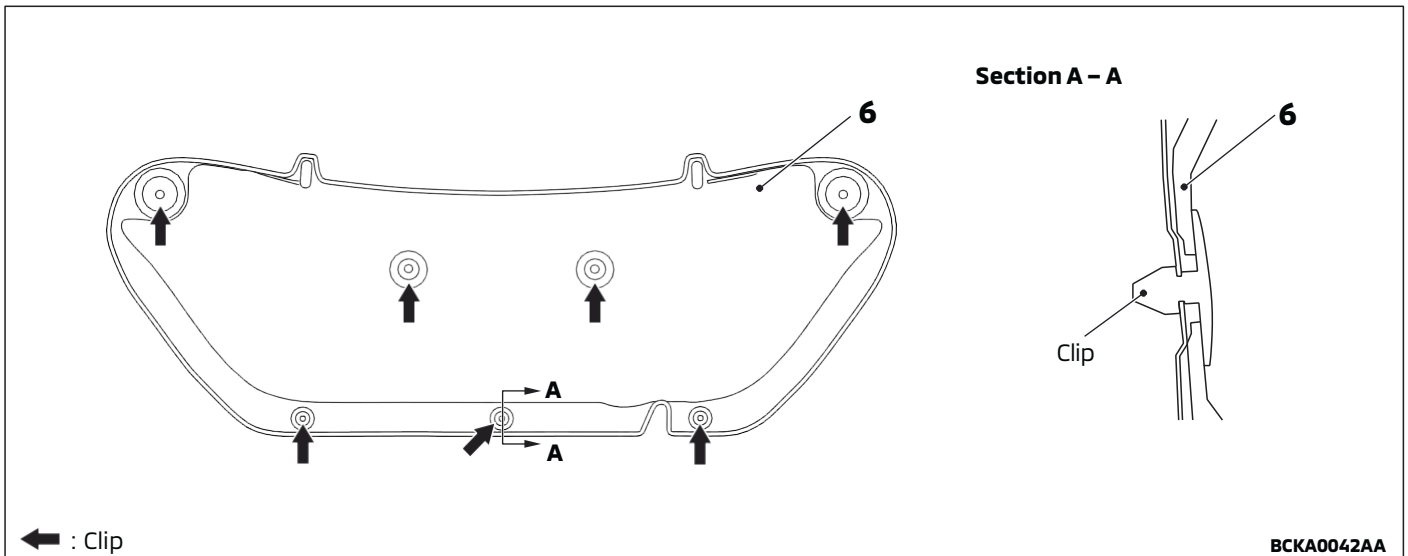

	Removal step
1.	Secondary lever cover
2.	Secondary lever
3.	Hood front weatherstrip
4.	Hood rear weatherstrip
5.	Hood front side weatherstrip
6.	Hood insulator
7.	Hood damper
8.	Hood grille weatherstrip
9.	Hood support rod
10.	Hood
11.	Hood hinge

Post-installation Operation

- Clearance Check of the Hood (Refer to page 5).
- Adjustment of the Hood Level and Hood Striker Engagement (Refer to page 5).
- Adjustment of Hood Height (Refer to page 6).
- Placement of the A/C and Emission Labels (Refer to page 6).

ADJUSTMENT OF CLEARANCE OF THE HOOD

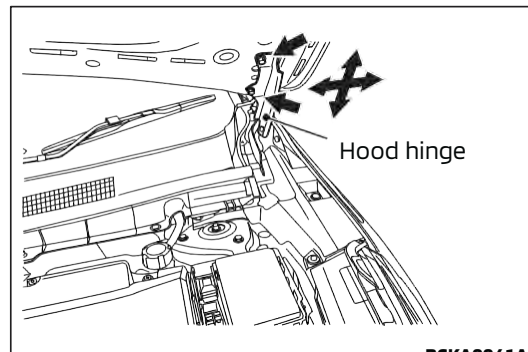

1. Loosen the hood hinge mounting bolts but do not remove them. Move the hood hinge back/forth and left/right to align the clearance between the hood and body.
2. After the adjustment, tighten the hood hinge mounting bolts specified torque.

Tightening torque:
 $12 \pm 2 \text{ N}\cdot\text{m}$ ($106 \pm 17 \text{ in}\cdot\text{lb}$)

ADJUSTMENT OF HOOD LEVEL AND HOOD STRIKER ENGAGEMENT

Remove the hood latch cover (Refer to REMOVAL AND INSTALLATION).

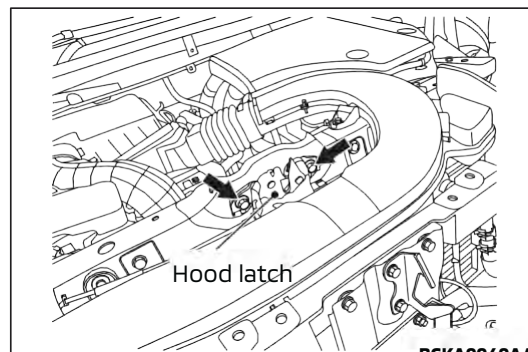

1. Loosen the hood latch mounting bolts but do not remove them. Move the hood latch up/down and left/right to align the hood level and adjust the hood striker engagement.
2. After the adjustment, tighten the hood latch mounting bolts specified torque.

Tightening torque:
 $21 \pm 1 \text{ N}\cdot\text{m}$ ($15.5 \pm 0.7 \text{ ft}\cdot\text{lb}$)

Install the hood latch cover (Refer to REMOVAL AND INSTALLATION).

ADJUSTMENT OF HOOD HEIGHT

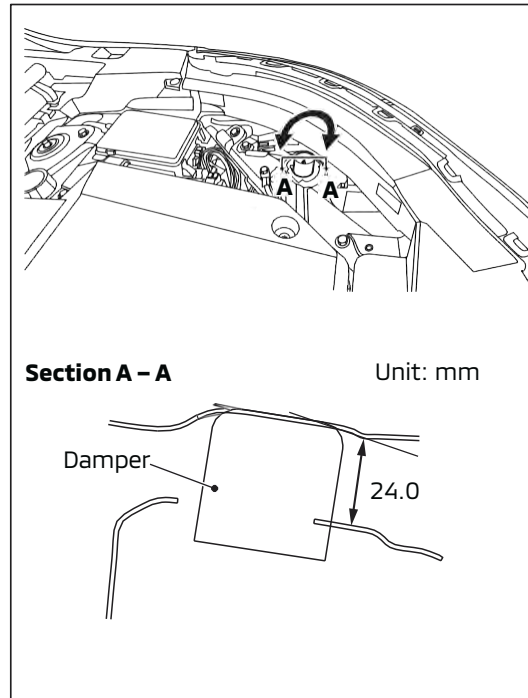

DF2002FPAC00USA

Turn the damper to the dimension shown in the figure to adjust the hood height. If the hood height is still not even, turn the damper again until the height is even. The damper height is altered by roughly 4 mm (0.2 inch) when the damper is rotated once.

NOTE:

If a rattling noise is heard due to the vibration of the hood when the vehicle is being driven, adjust the damper height until the damper is seated on the hood.

DF2002FQAA00USA

Placement of the A/C and Emission Labels

A/C Refrigerant label



Emission Label

PARTS

Part Name	Part Number	Quantity
W/STRIP, HOOD FR END	65820W000P	1
W/STRIP, HOOD GRILL SIDE LH	65849W010P	1
W/STRIP, HOOD GRILL SIDE RH	65848W010P	1
HOOD ASSY (Reinforced)	65100W080P	1
W/STRIP, HOOD FR END	65820W020P	1
CLAMP, HOOK LOCKING (as needed)	65722A000P	1
LABEL, EMISSION (2WD) OR	14805W070P	1
LABEL, EMISSION (4WD)	14805W080P	1
LABEL, A/C REFRIGERANT CAUTION	7430C070	1

WARRANTY

Extended Warranty coverage is extended for 18 months starting 05/01/2026

Warranty bulletin: WB2026-008

Disclaimer

NOTE: The information contained in this document is intended for use by trained professional technicians with the knowledge to properly and perform diagnosis and repairs on Mitsubishi vehicles, using Mitsubishi Motors approved tools and equipment. It informs service technicians about conditions that could occur in certain vehicles and provides information that could assist in proper vehicle diagnosis, service, or repair. It does not indicate that a defect is present in any vehicle referenced in this document nor does it imply that the described repairs are covered under warranty. DO NOT assume that a symptom or condition, or a described cause of a symptom or condition, affects any particular vehicle or groups of vehicles, or that a described repair applies to any particular vehicle or groups of vehicles. There can be multiple causes resulting in the same or similar symptoms or conditions described in this document and trained professional service technicians must use their diagnostic skills to make evaluations on a case-by-case basis. The information contained in this document does not guarantee warranty coverage nor does it extend the vehicle's warranty in any way.