



# FIELD KIT

## Vermeer MV Solutions, Inc.

Trenchless  
Piedmont, South Carolina 29673 USA

FIELD CAMPAIGN KIT #: VMV000108 Rev. 1      DATE: 2026 March 10  
For Dealer Reference: Service Bulletin #: SMV2026-001 Rev. 1

### Boom Raise Cylinder Pins and Retaining Clips Update Kit

CAMPAIGN TYPE:	Mandatory – Product Compliance
CAMPAIGN CATEGORY:	<b>DEALER INSTALLATION ONLY</b>
	Kit and Bulletin

MACHINE/ ATTACHMENT MODEL(S):	SERIAL NUMBERS:		Kit Version
	Included	Excluded	
ECO200	See attached listing on page 5 of this bulletin for specific VIN.	None	VMV01
ECO50	See attached listing on page 5 of this bulletin for specific VIN.		
ECO75	See attached listing on page 6 of this bulletin for specific VIN.		
ECO80	See attached listing on page 7 of this bulletin for specific VIN.		
MEGA	See attached listing on page 7 of this bulletin for specific VIN.		
V1200	See attached listing on page 8 of this bulletin for specific VIN.		
V1200HD	See attached listing on page 8 of this bulletin for specific VIN.		

MACHINE/ ATTACHMENT MODEL(S):	SERIAL NUMBERS:		Kit Version
	Included	Excluded	
V500	See attached listing on page 8 of this bulletin for specific VIN.		
V500HD	See attached listing on page 8 of this bulletin for specific VIN.		
V500LE	See attached listing on page 8 of this bulletin for specific VIN.		
V500LEHD	See attached listing on page 9 of this bulletin for specific VIN.		
V800	See attached listing on page 10 of this bulletin for specific VIN.		
VSK100	See attached listing on page 12 of this bulletin for specific VIN.		
VSK100D	See attached listing on page 11 of this bulletin for specific VIN.		
VSK100XT	See attached listing on page 12 of this bulletin for specific VIN.		
VSK1200	See attached listing on page 14 of this bulletin for specific VIN.		
VSK1600	See attached listing on page 14 of this bulletin for specific VIN.		
VSK2000	See attached listing on page 14 of this bulletin for specific VIN.	None	VMV01
VSK2200	See attached listing on page 15 of this bulletin for specific VIN.		
VSK2600	See attached listing on page 15 of this bulletin for specific VIN.		
VSK30	See attached listing on page 15 of this bulletin for specific VIN.		
VSK3000	See attached listing on page 15 of this bulletin for specific VIN.		
VSK50	See attached listing on page 16 of this bulletin for specific VIN.		
VSK500	See attached listing on page 16 of this bulletin for specific VIN.		

VSK70	See attached listing on page 17 of this bulletin for specific VIN.		
VSK80	See attached listing on page 18 of this bulletin for specific VIN.		
VSK800	See attached listing on page 19 for specific VIN.		
VX100	See attached listing on page 19 of this bulletin for specific VIN.		
VX1200	See attached listing on page 20 of this bulletin for specific VIN.		
VX30	See attached listing on page 20 of this bulletin for specific VIN.	None	VMV01
VX50	See attached listing on page 21 of this bulletin for specific VIN.		
VX70	See attached listing on page 28 of this bulletin for specific VIN.		
VX75	See attached listing on page 29 of this bulletin for specific VIN.		
VX80	See attached listing on page 31 of this bulletin for specific VIN.		
VX800	See attached listing on page 31 of this bulletin for specific VIN.		

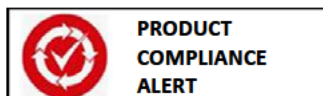

**Revision:**

- The kit instructions are being revised to provide additional instructions for units that may require longer pins for completion of the kit.
- The service bulletin is being revised to provide reimbursement instructions for units that require longer pins.

The remainder of this bulletin is provided for reference as originally published on December 4, 2025.

**Purpose: BOOM CAN FALL UNEXPECTEDLY.** During manufacturing, the incorrect boom raise cylinder retainer clips may have been installed. The retaining clips can become displaced during operation and the boom may fall. Death or serious injury is possible if the boom falls and strikes or crushes an operator or crew member. Machine or property damage is also possible.

VMV000108 has been created to provide the necessary parts and instructions to install replacement retaining clips.

**Special tools and conditions:**

- n/a



**WARNING:** Use the following shutdown procedure before attempting to do any of the work described in this kit.

**Shutdown Procedure**

1. Stow boom in the most rear position according to Figure A and use appropriate shutdown procedures per your model type. Follow your operators and maintenance book for shutdown procedures.



**WARNING:** Pressurized fluid can penetrate body tissue and result in death or serious injury. Leaks can be invisible. Keep away from any suspected leak. Relieve pressure in the hydraulic system before searching for leaks, disconnecting hoses, or performing any other work on the system. If you must pressurize the system to find a suspected leak, use an object such as a piece of wood or cardboard rather than your hands. When loosening a fitting where some residual pressure may exist, slowly loosen the fitting until oil begins to leak. Wait for leaking to stop before disconnecting the fitting. Fluid injected under the skin must be removed immediately by a surgeon familiar with this type of injury.

**Serial Number List**

ECO200 AFFECTED MACHINES – VMV010108			
MODEL	VIN	MODEL	VIN

ECO50 AFFECTED MACHINES – VMV010108

MODEL	VIN	TRUCK VIN	MODEL	VIN	TRUCK VIN
[REDACTED]					
*The truck VINs that are missing were not available in manufacturing records					

ECO75 AFFECTED MACHINES – VMV010108					
MODEL	VIN	TRUCK VIN	MODEL	VIN	TRUCK VIN
[REDACTED]					



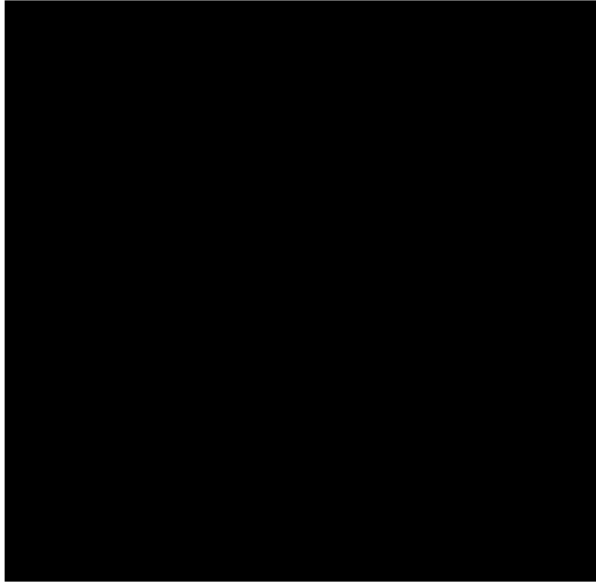

V1200 AFFECTED MACHINES – VMV010108					
MODEL	VIN	TRAILER VIN	MODEL	VIN	TRAILER VIN
[REDACTED]					

\*The trailer VINs that are missing were not available in manufacturing records

V1200HD AFFECTED MACHINES - VMV010108					
MODEL	VIN	TRAILER VIN	MODEL	VIN	TRAILER VIN
[REDACTED]	[REDACTED]	[REDACTED]	[REDACTED]	[REDACTED]	[REDACTED]
[REDACTED]	[REDACTED]	[REDACTED]	[REDACTED]	[REDACTED]	[REDACTED]
[REDACTED]	[REDACTED]	[REDACTED]	[REDACTED]	[REDACTED]	[REDACTED]
[REDACTED]	[REDACTED]	[REDACTED]	[REDACTED]	[REDACTED]	[REDACTED]

\*The trailer VINs that are missing were not available in manufacturing records

V500 AFFECTED MACHINES – VMV010108					
MODEL	VIN	TRAILER VIN	MODEL	VIN	TRAILER VIN
[REDACTED]	[REDACTED]	[REDACTED]	[REDACTED]	[REDACTED]	[REDACTED]
[REDACTED]	[REDACTED]	[REDACTED]	[REDACTED]	[REDACTED]	[REDACTED]
[REDACTED]	[REDACTED]	[REDACTED]	[REDACTED]	[REDACTED]	[REDACTED]
[REDACTED]	[REDACTED]	[REDACTED]	[REDACTED]	[REDACTED]	[REDACTED]

[REDACTED]	[REDACTED]	[REDACTED]	[REDACTED]	[REDACTED]	[REDACTED]
[REDACTED]	[REDACTED]	[REDACTED]	[REDACTED]	[REDACTED]	[REDACTED]
[REDACTED]	[REDACTED]	[REDACTED]	[REDACTED]	[REDACTED]	[REDACTED]

\*The trailer VINs that are missing were not available in manufacturing records

V500HD AFFECTED MACHINES – VMV010108					
MODEL	VIN	TRAILER VIN	MODEL	VIN	TRAILER VIN
[REDACTED]	[REDACTED]	[REDACTED]	[REDACTED]	[REDACTED]	[REDACTED]
[REDACTED]	[REDACTED]	[REDACTED]	[REDACTED]	[REDACTED]	[REDACTED]
[REDACTED]	[REDACTED]	[REDACTED]	[REDACTED]	[REDACTED]	[REDACTED]
[REDACTED]	[REDACTED]	[REDACTED]	[REDACTED]	[REDACTED]	[REDACTED]

\*The trailer VINs that are missing were not available in manufacturing records

V500LE AFFECTED MACHINES – VMV010108					
MODEL	VIN	TRAILER VIN	MODEL	VIN	TRAILER VIN
[REDACTED]	[REDACTED]	[REDACTED]	[REDACTED]	[REDACTED]	[REDACTED]

V500LEHD AFFECTED MACHINES – VMV010108					
MODEL	VIN	TRAILER VIN	MODEL	VIN	TRAILER VIN
[REDACTED]					







VSK100D AFFECTED MACHINES – VMV010108			
MODEL	VIN	MODEL	VIN

VSK100XT AFFECTED MACHINES – VMV010108			
MODEL	VIN	MODEL	VIN

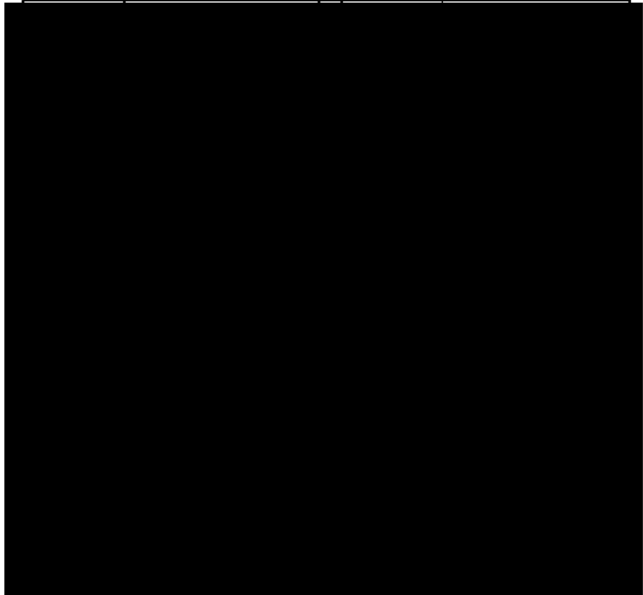



VSK100XT AFFECTED MACHINES – VMV010108			
MODEL	VIN	MODEL	VIN

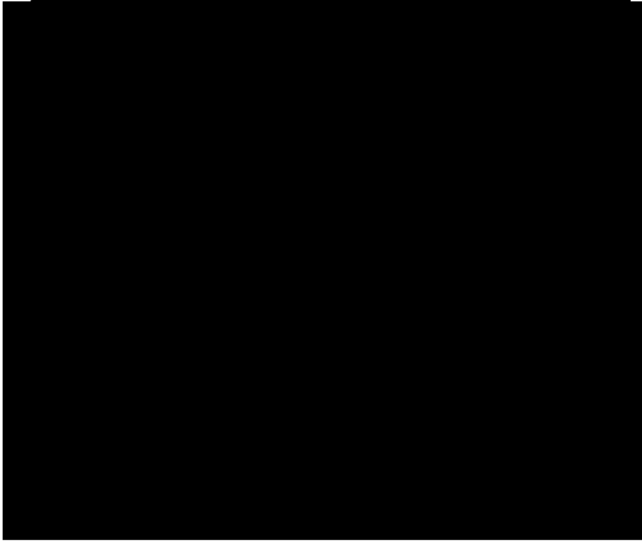



VSK1200 AFFECTED MACHINES – VMV010108			
MODEL	VIN	MODEL	VIN

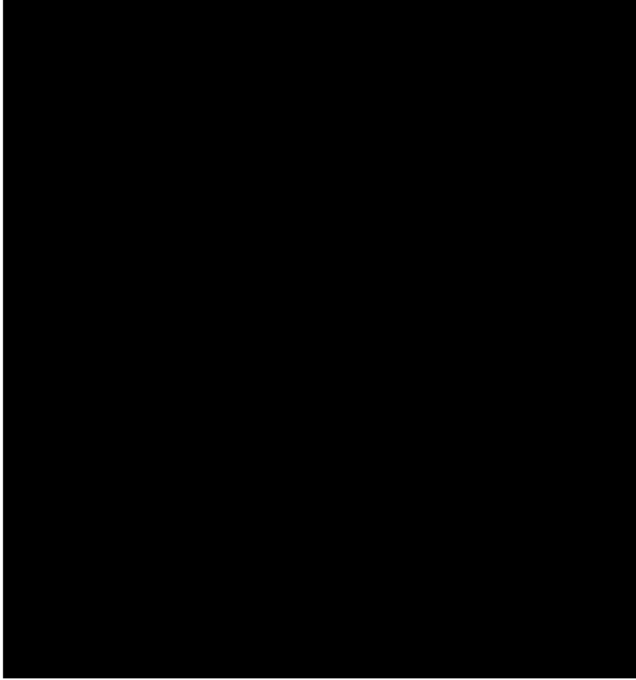

VSK1600 AFFECTED MACHINES – VMV010108			
MODEL	VIN	MODEL	VIN



VSK2000 AFFECTED MACHINES – VMV010108			
MODEL	VIN	MODEL	VIN



VSK2200 AFFECTED MACHINES – VMV010108			
MODEL	VIN	MODEL	VIN

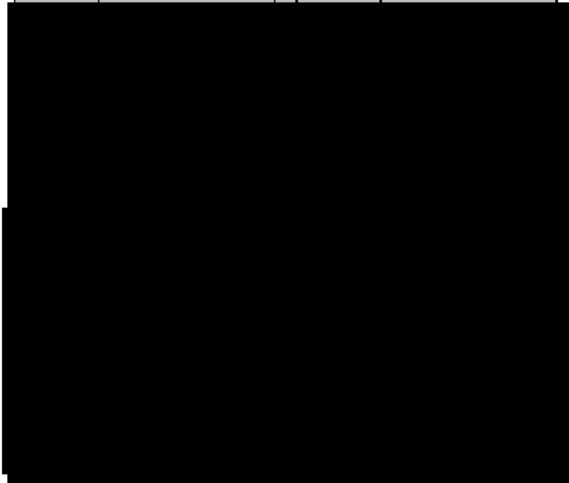

VSK2600 AFFECTED MACHINES – VMV010108			
MODEL	VIN	MODEL	VIN

VSK30 AFFECTED MACHINES – VMV010108			
MODEL	VIN	MODEL	VIN

VSK3000 AFFECTED MACHINES – VMV010108			
MODEL	VIN	MODEL	VIN

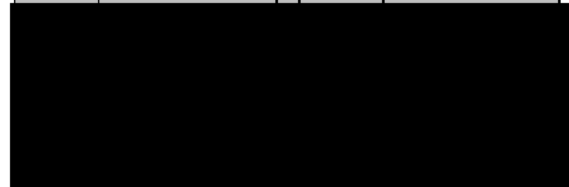

V300D AFFECTED MACHINES – VMV010108			
MODEL	VIN		

VSK50 AFFECTED MACHINES – VMV010108			
MODEL	VIN	MODEL	VIN

VSK500 AFFECTED MACHINES – VMV010108			
MODEL	VIN	MODEL	VIN

VSK70 AFFECTED MACHINES – VMV010108			
MODEL	VIN	MODEL	VIN

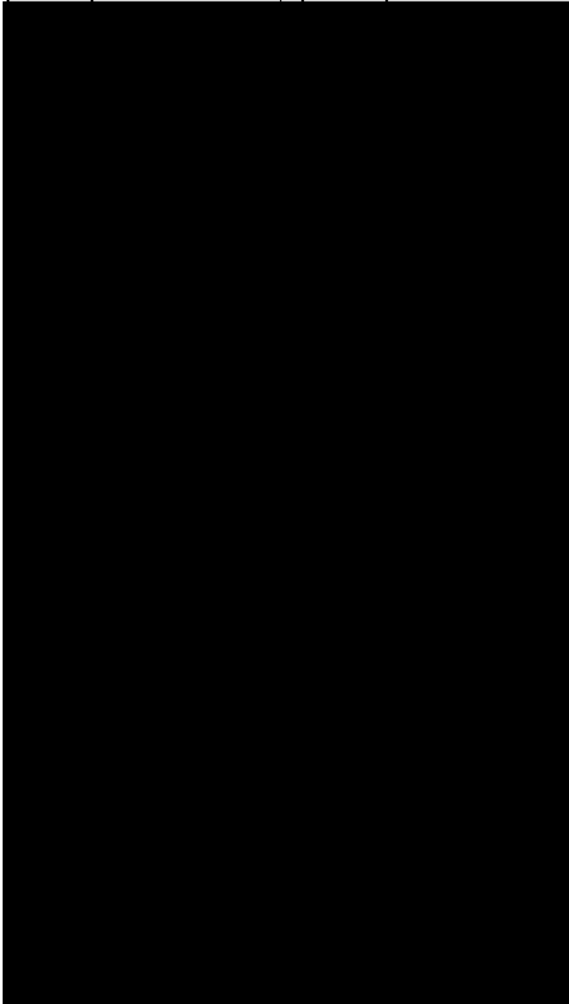

VSK70 AFFECTED MACHINES – VMV010108			
MODEL	VIN	MODEL	VIN
[REDACTED]			

VSK80 AFFECTED MACHINES – VMV010108			
[REDACTED]	[REDACTED]	[REDACTED]	[REDACTED]
[REDACTED]	[REDACTED]	[REDACTED]	[REDACTED]
[REDACTED]	[REDACTED]	[REDACTED]	[REDACTED]
[REDACTED]	[REDACTED]	[REDACTED]	[REDACTED]



VX1200 AFFECTED MACHINES – VMV010108					
████	████	████	████	████	████
████	██████████				

VX30 AFFECTED MACHINES – VMV010108					
████	████	██████████	████	████	██████████
████	██████████		████	██████████	██████████
████	██████████				

\* The trailer VINs that are missing were not available in manufacturing records























**Shutdown Procedure:**

The following instructions cover several machine models. Refer to the Shutdown Procedure in the Operator's Manual for machine model being worked on. Follow the Shutdown Procedure for the appropriate model machine.

**Procedure 1:**

1. Position ladder so that you will maintain steady balance and keep three points of contact.
2. Stowe boom and proceed without removing the pin.
3. Remove existing clips from the base boom rod side pin.
4. Pin stick out should measure .875 on each side (see figure A) and ensure clearance of washer and cotter pins. (see figure B) then proceed to step 5. If pin stick out on both sides are not adequate for the washers and cotter pins order pin 8041990 and install it prior to moving to step 5.
5. Install pin if needed (ensure it is 8041990, 4.5" long) and install washers and cotter pins according to Figure B at the boom raise/lower cylinder rod side pin location shown below.

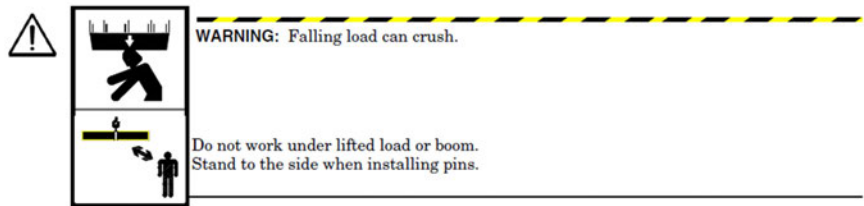

Figure A

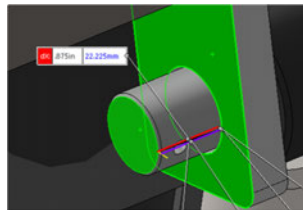
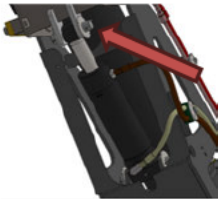
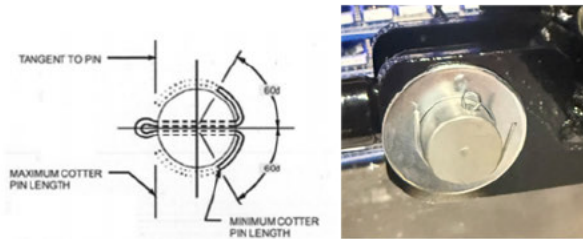
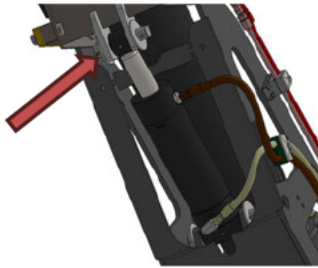

Figure B



6. Grease the rod pin point before operation.



7. Remove Figure 1 \ 1.1 \ 1.2 and place in the manual storage box so unit owner can place with existing parts manual.

UNIT OWNER COPY:  
Insert in parts manual  
for future reference.

Figure 1

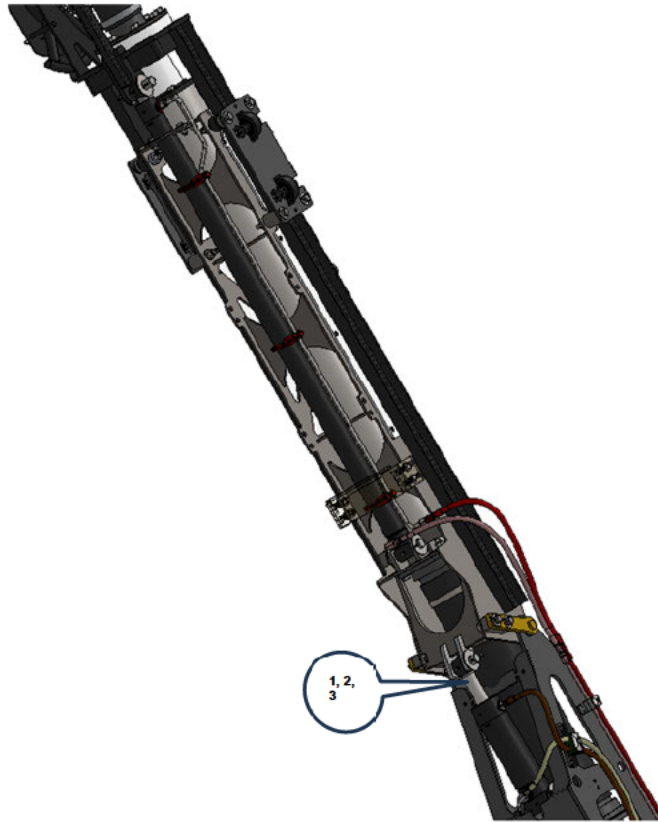
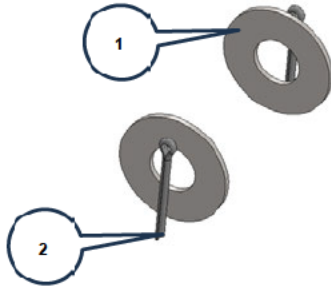
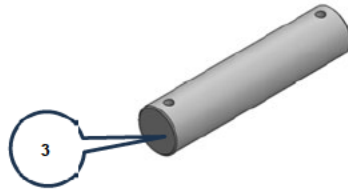

Figure 1.1



<b>Figure 1.1 parts list</b>			
REF. NO.	PART NO.	DESCRIPTION	VMV01 QTY.
1	U200170	WASHER FLAT 1.000	2
2	U320070	P N,COTTER .188X2.000	2
Kit includes all items in Figure 1 parts list.			

Figure 1.2



<b>Figure 1.2 parts list</b>			
REF. NO.	PART NO.	DESCRIPTION	MANUAL QTY.
3	8041990	BOOM PIVOT CYLINDER ROD PIN	1
Kit includes all items in Figure 1 parts list.			