

## Service

|                     |   |
|---------------------|---|
| <b>Chassis ID</b>   | <b>Path</b>   |
|                     | 4323/Technical service bulletins//Cable, Gear Selector, Replacement |
| <b>Model</b>        | <b>Identity</b>   |
| MD6                 | 194316405   |
| <b>Publish date</b> | <b>ID/Operation</b>   |
| 3/12/2026           | M-432-002A  |

# Cable, Gear Selector, Replacement

M-432-002A

(February 2026)

## Valid for

Mack MMD model vehicles equipped with 2500 series Allison transmissions.

## Case description

Mack Trucks has identified that MMD model vehicles equipped with a 2500 series transmission may produce a buzzing or chirping noise in the cab. This is due to the transmission shift cable transmitting vibrations from the powertrain components. A new shift cable and mounting bracket have been developed to resolve the issue. Follow the instructions below to install the updated parts.

## Parts

| Part Number | Description                | Quantity |
|-------------|----------------------------|----------|
| 24841832    | Shifter and Cable kit      | 1        |
| 24819220    | Transmission Cable bracket | 1        |

## Repair Procedure

1. Secure the vehicle for service.
2. Follow Impact Operation [43027-2 Cable, Gear Selector, Replacement](#) to remove the transmission shift cable and gear selector.
3. Once the shift cable is removed, remove the screws from the transmission shift cable bracket.

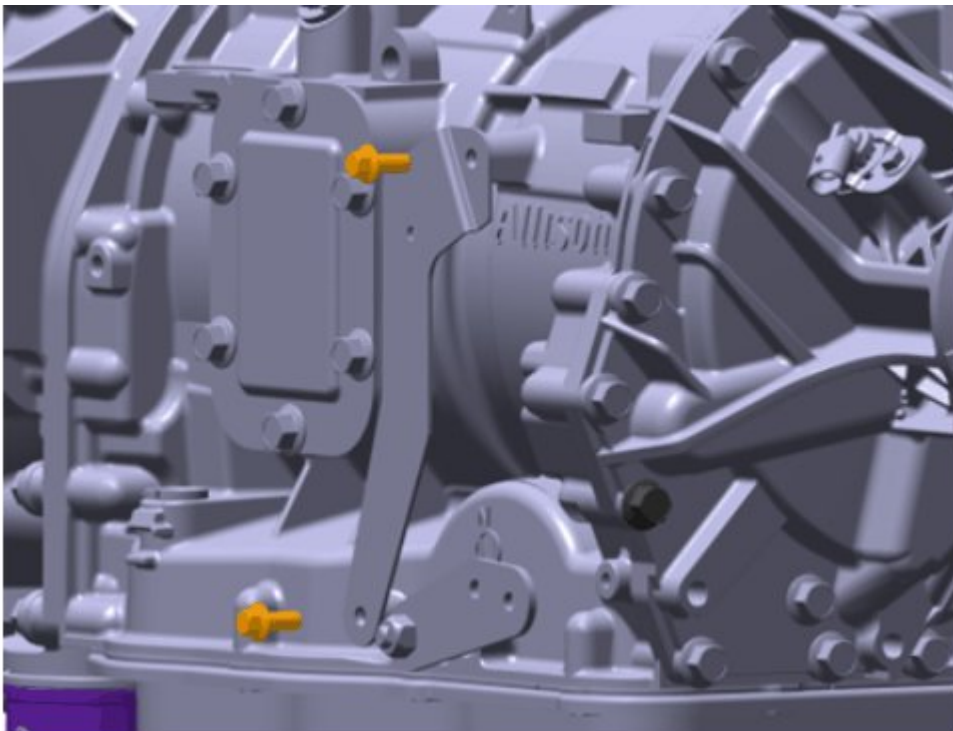

Copyright to this documentation belongs to the Volvo Group. No reproduction, copying, change, amendment or other similar disposal is entitled without prior written consent by the Volvo Group

The information contained herein is current at the time of its original distribution, but is subject to change. The reader is advised that printed copies are uncontrolled.

4. Remove the bracket.

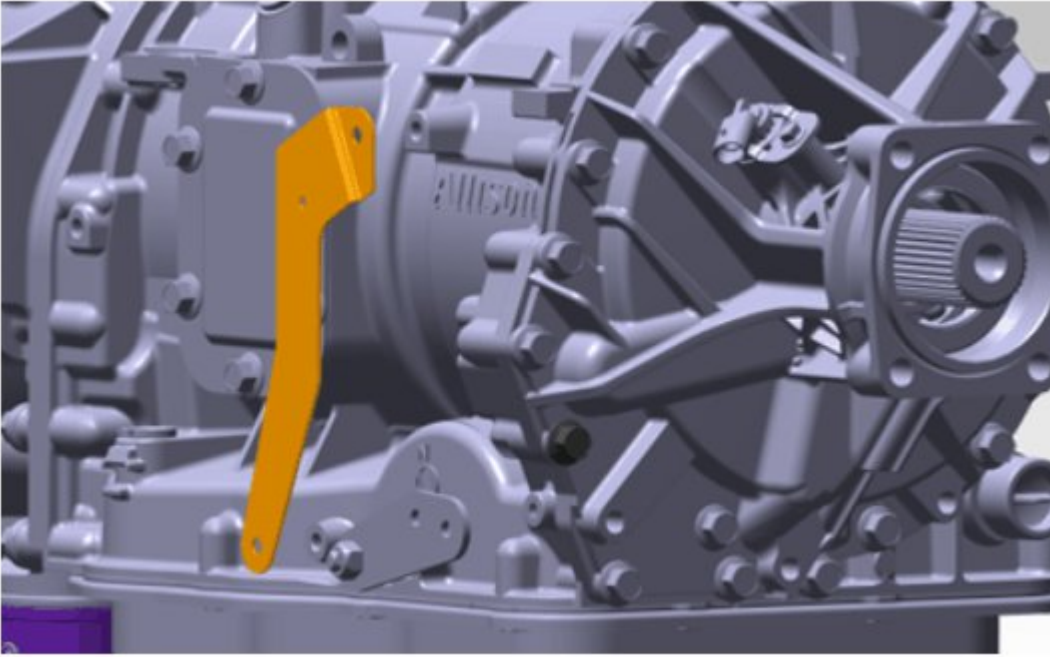

5. Install the new shift cable bracket and assemble the new shift cable.

| Tightening torque |  |
|-------------------|--|
|-------------------|--|

|                             |                         |
|-----------------------------|-------------------------|
| Shift Cable Bracket, screws | 24 ±4 Nm (18 ±3 lbf-ft) |
|-----------------------------|-------------------------|

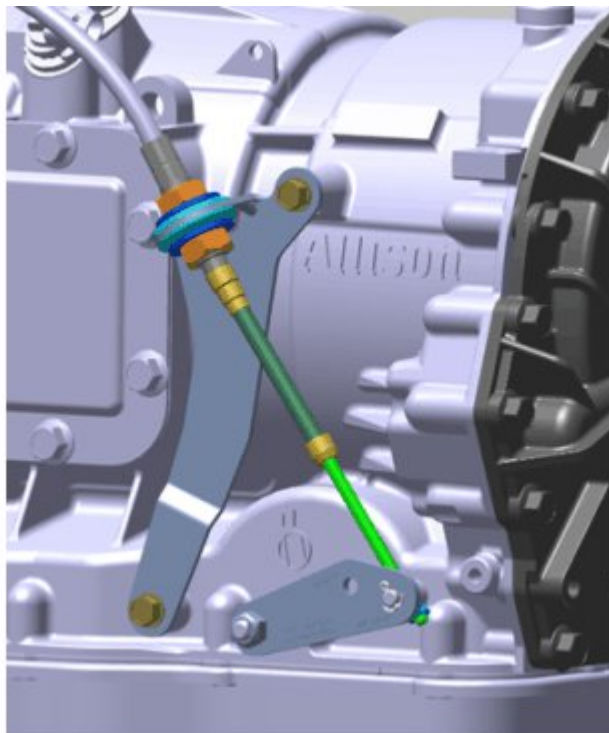

6. Install the bottom jam nut first. Set the position to provide adequate barrel threads (at the end of the cable) for adjustment.

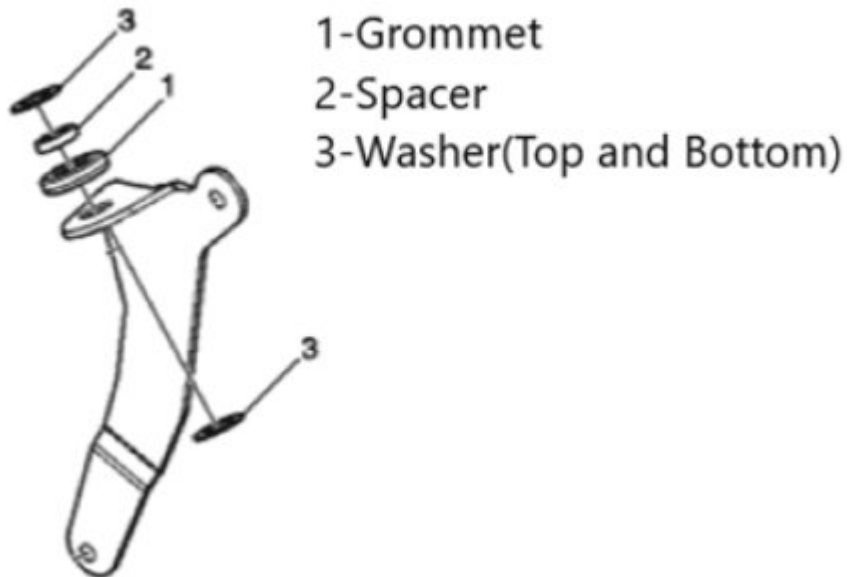

7. Once set, tighten the top jam nut against the spacer.

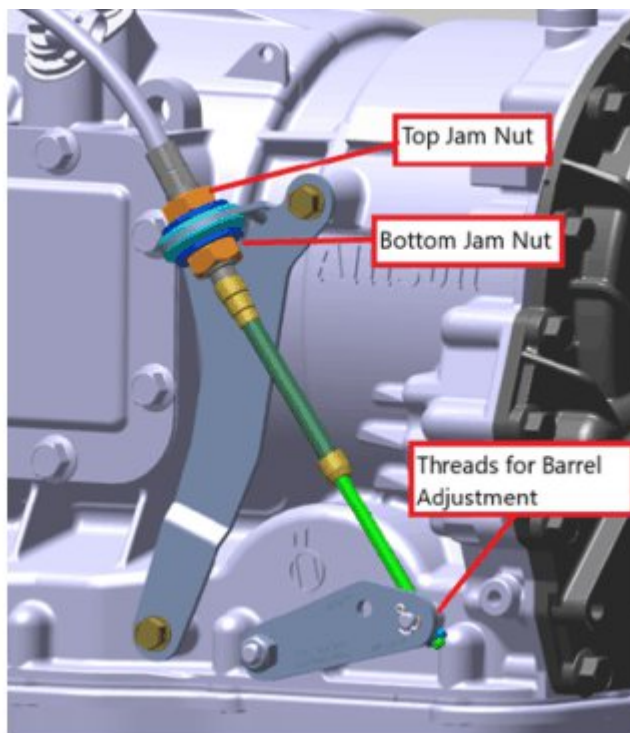

8. Follow Impact Operation [43027-2 Cable, Gear Selector, Replacement](#) to install the new gear selector and to adjust the shift cable.
9. Release trucks.

## Issued by

Technical Service