

Service

Chassis ID	Path
	3757/Technical service bulletins//Reversing Camera Harness, Repair
Model	Identity
VN (4)	194286386
Publish date	ID/Operation
3/12/2026	V-375-001

Reversing Camera Harness, Repair

V-375-001

(March 2026)

Valid for

Volvo VN(4) model trucks built from to present.

Case description

Volvo Trucks has identified that VN(4) model vehicles equipped with a rear-of-cab reversing camera may experience damage to the camera harness due to water and/or contamination ingress. Water and/or contamination ingress can cause the camera harness to corrode, leading to poor connections and camera malfunctions. If a corroded camera harness is found, follow this Technical Service Bulletin to install a reversing camera overlay harness to avoid replacing the entire cab floor harness.

Parts

The truck's cab length will determine which camera overlay harness part number to use.

230cm Cab Length		
Part Number	Description	Quantity
23921199	Reversing camera overlay harness	1

290cm Cab Length		
Part Number	Description	Quantity
23921231	Reversing camera overlay harness	1

320cm Can Length		
Part Number	Description	Quantity
23921238	Reversing camera overlay harness	1

Only Order if Truck is Equipped with a Chassis Camera Ethernet Switch (CCES)		
Part Number	Description	Quantity
23921338	Reversing camera overlay harness	1

Repair Procedure

1. Park the vehicle on a level surface.
2. Apply the parking brake
3. Place the gear lever in neutral.
4. Install the wheel chocks.

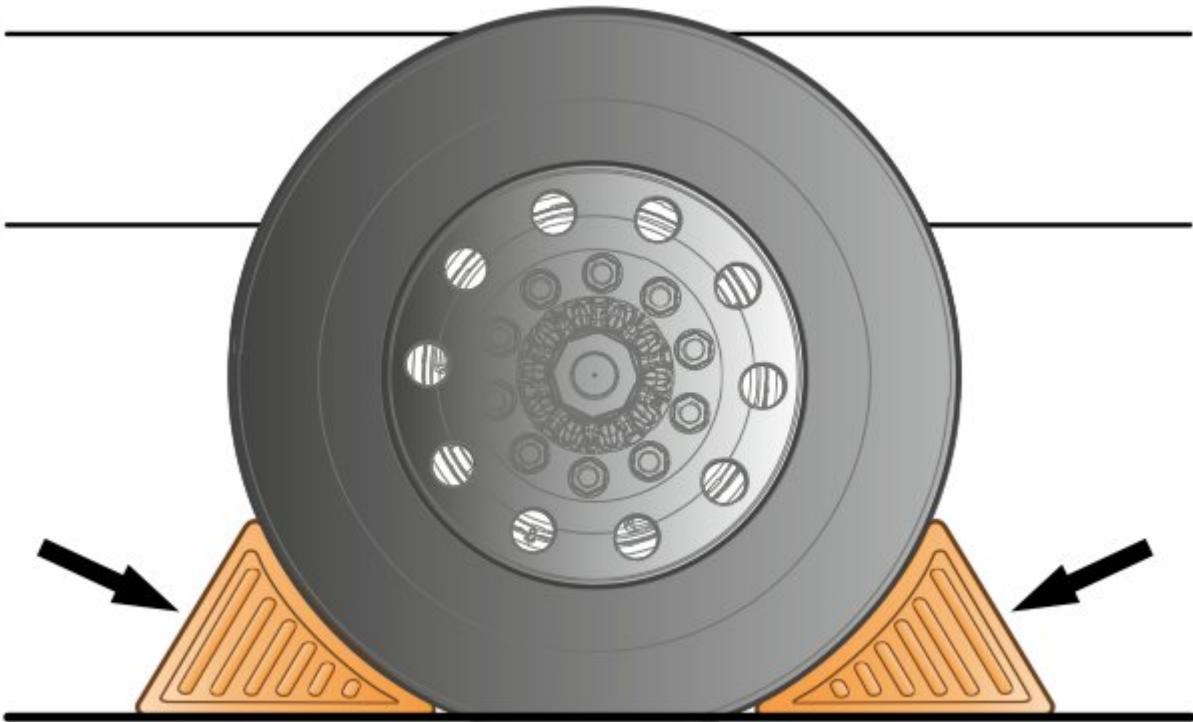

5. Unlatch the fairing.

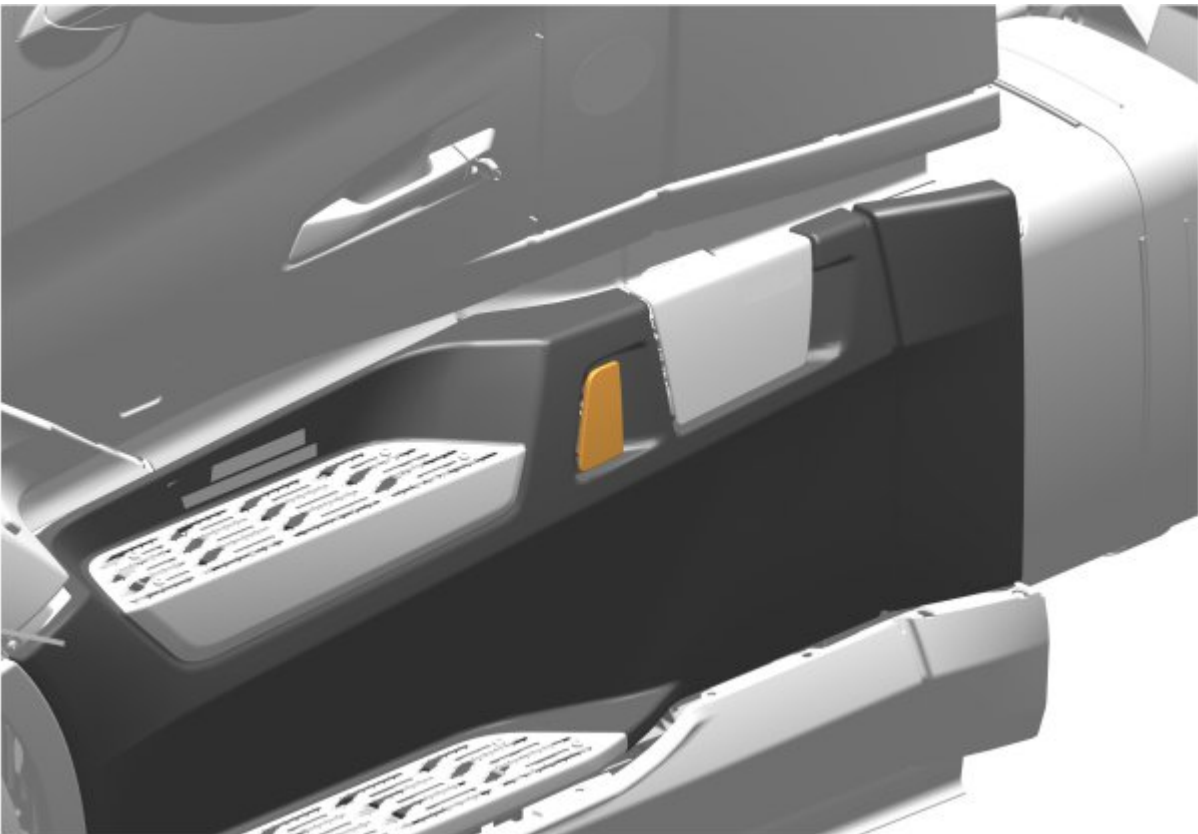

6. Remove the tether.
7. Remove the fairing.

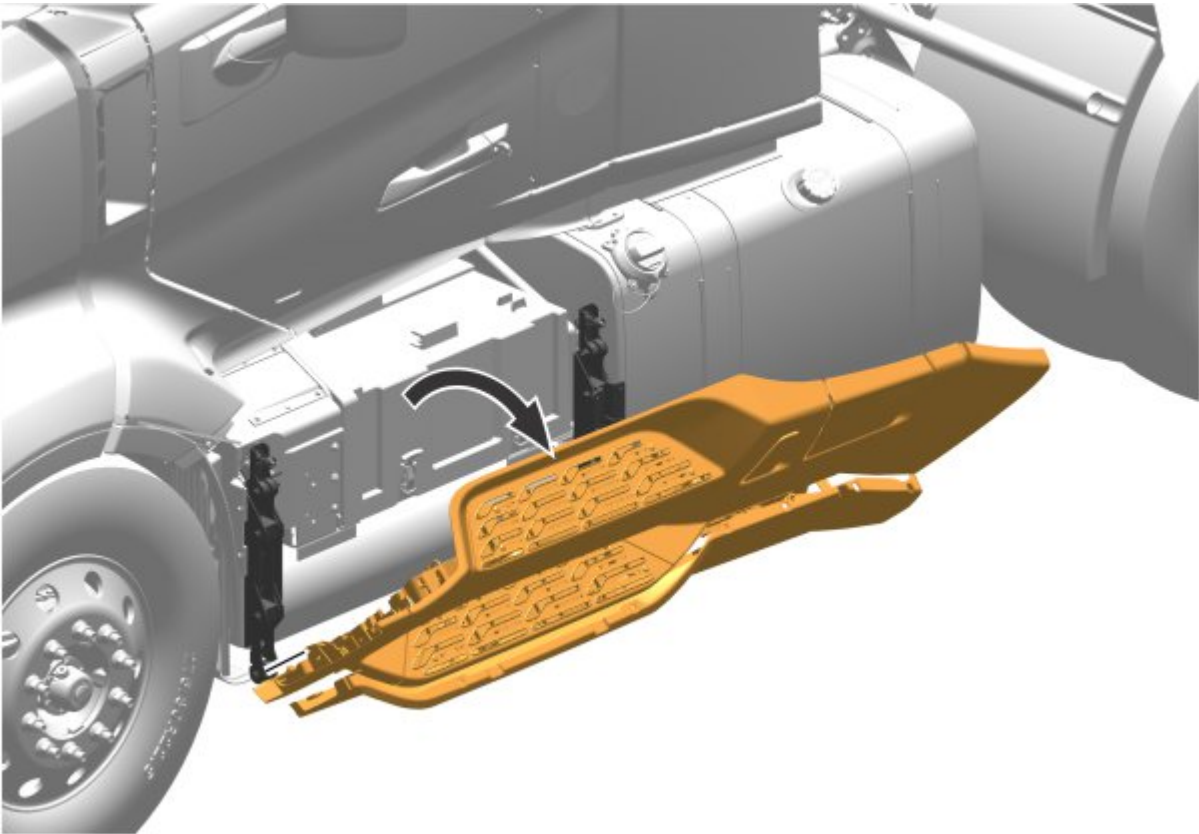

8. Decommission the low-voltage system.

Note: See header link for more information. [31025-1 Low Voltage System, Decommissioning](#)

9. Follow the Impact operation [85164-2 Trim Panel \(Rear, Lower\), Replacement](#) to remove the interior panels to access the cab floor harness. Pause once all interior panels have been removed.

Important Note
If the truck is equipped with a Chassis Camera Ethernet Switch (CCES), removing the camera housing cover is not necessary unless you are also replacing the CCES-to-camera jumper harness.

10. Remove the cable tie.
11. Remove cover.

Note: Use a suitable tool.

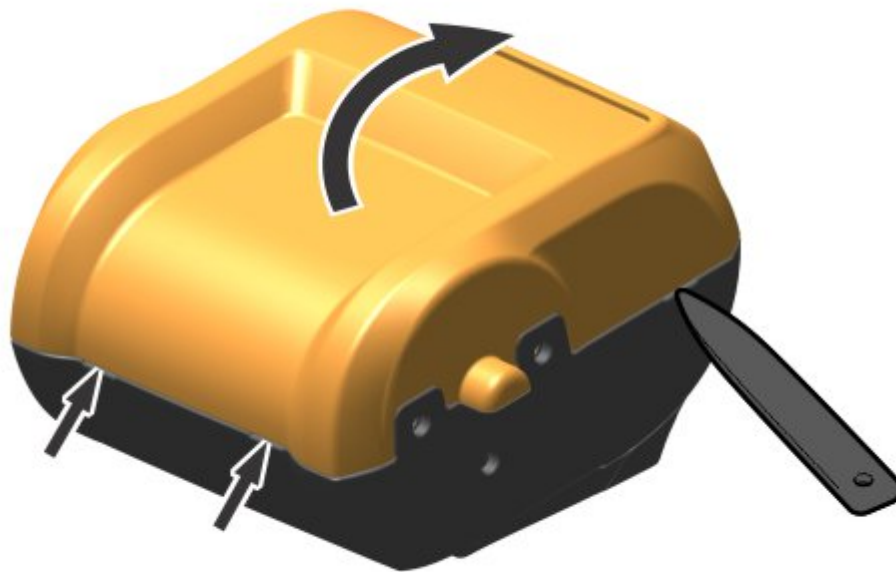
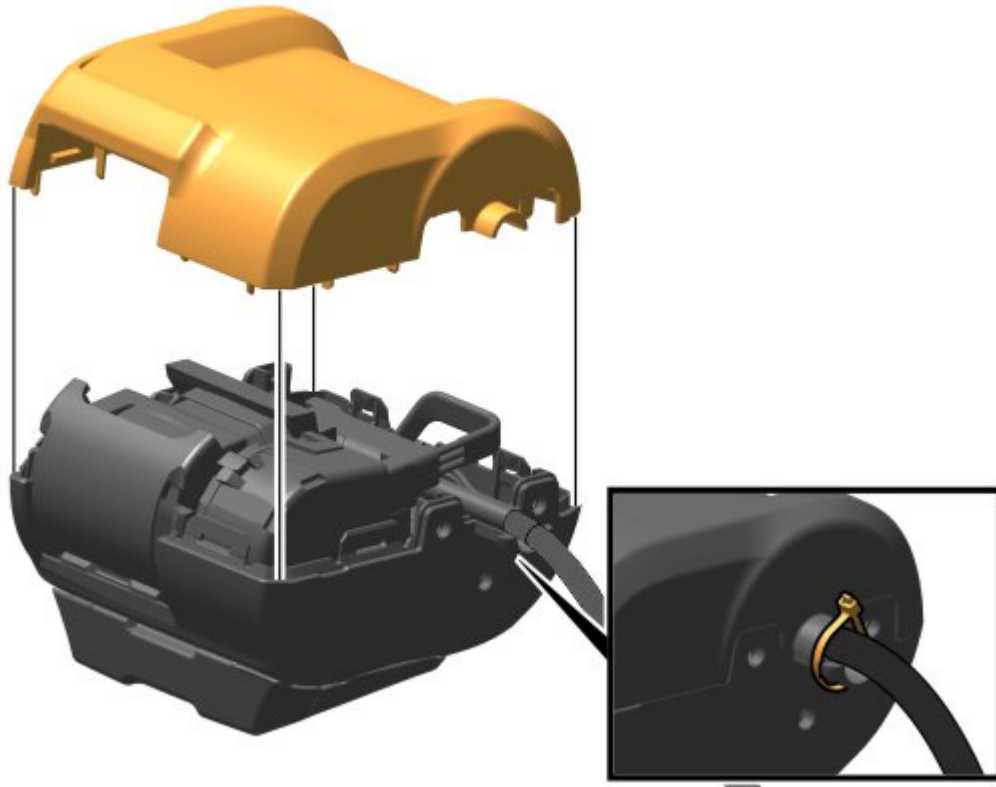

12. Disconnect the connector.
13. Move aside the wiring harness.

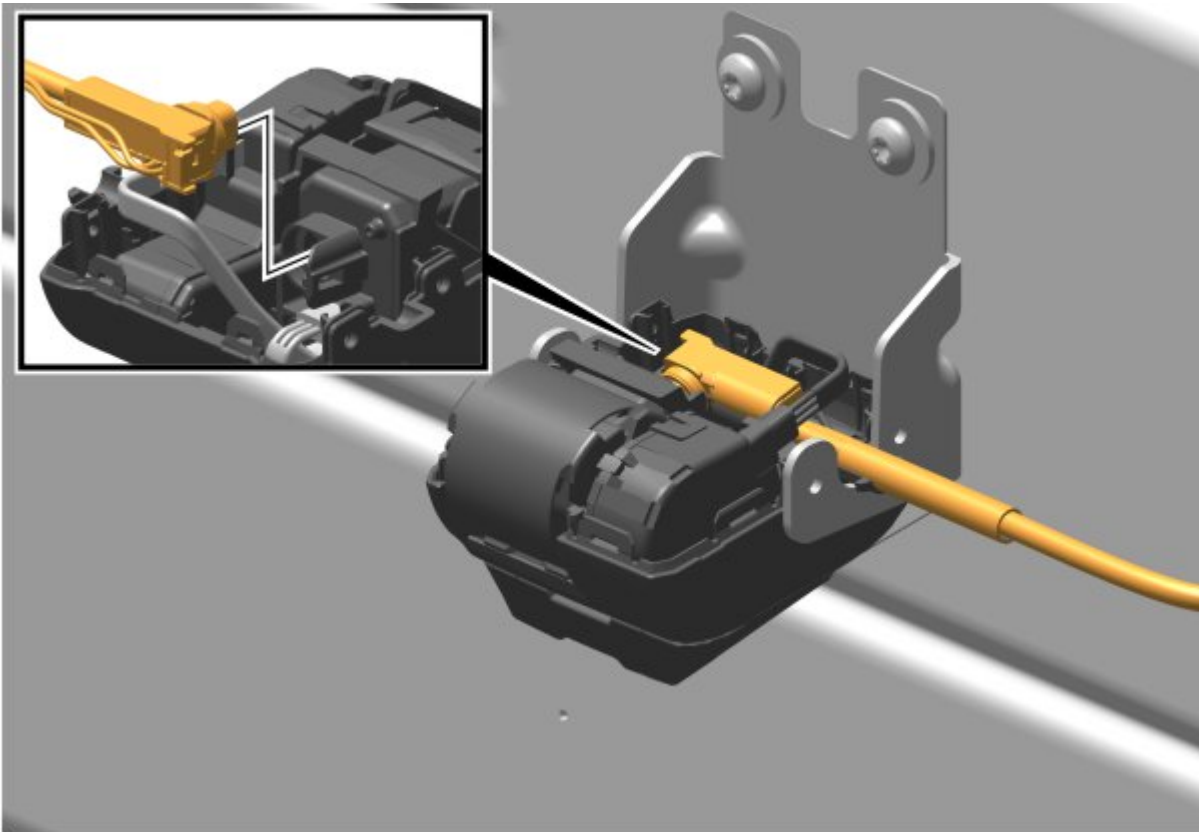

14. If equipped with a Chassis Camera Ethernet Switch (CCES), remove and discard the jumper harness installed between CCES and the floor wiring harness (truck side).

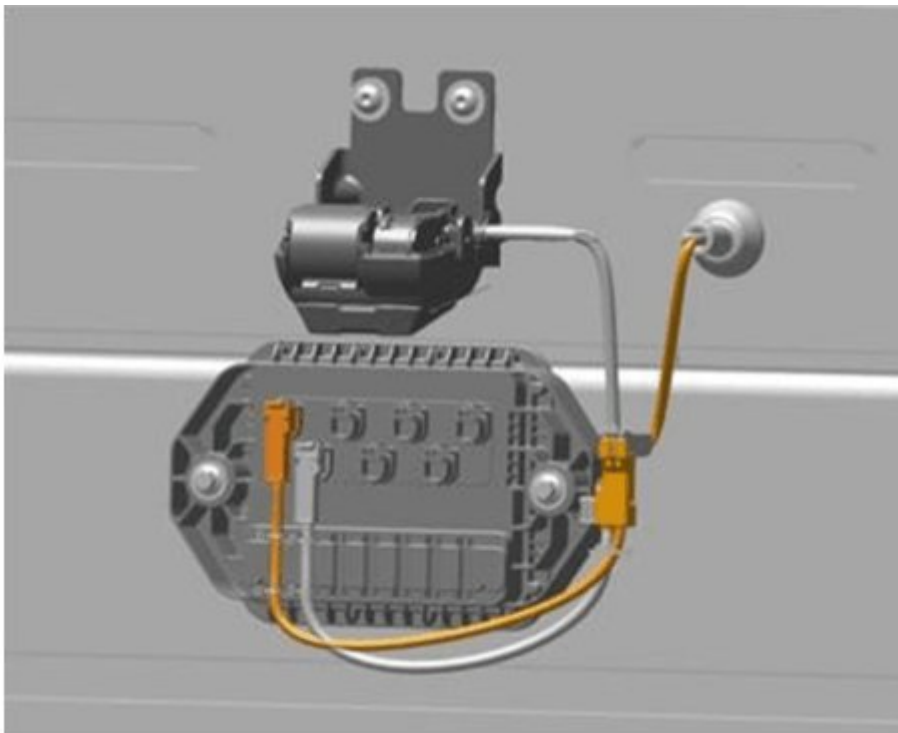

15. Push the harness and grommet into the cab.

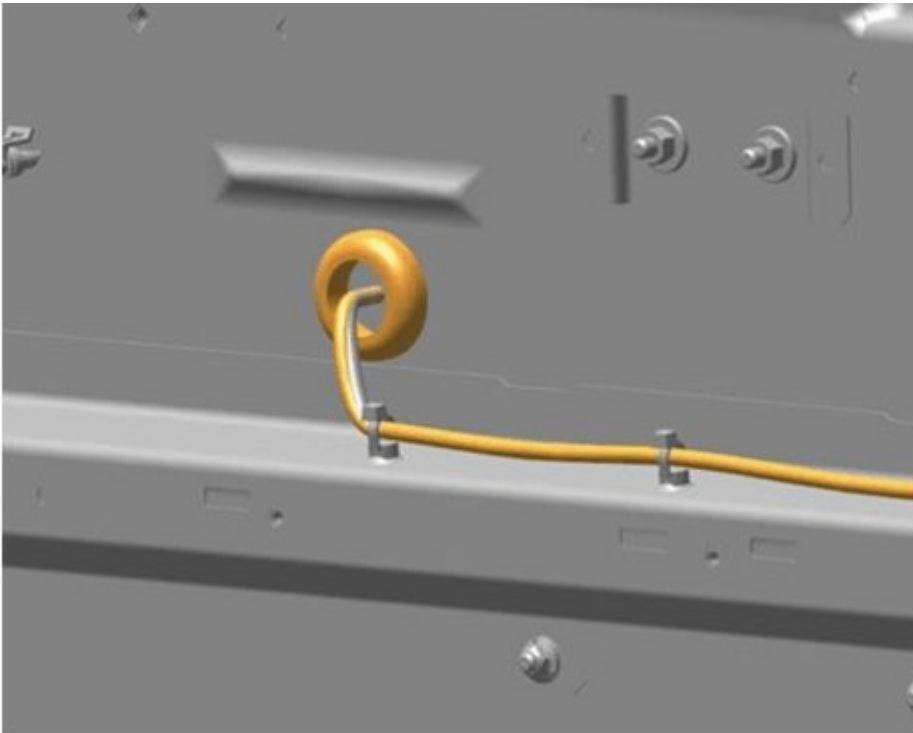

16. Inside the cab, cut the camera harness leg off the main cab harness between the two cable ties, removing the camera connector and grommet. Tape up and secure the cut end of the harness.

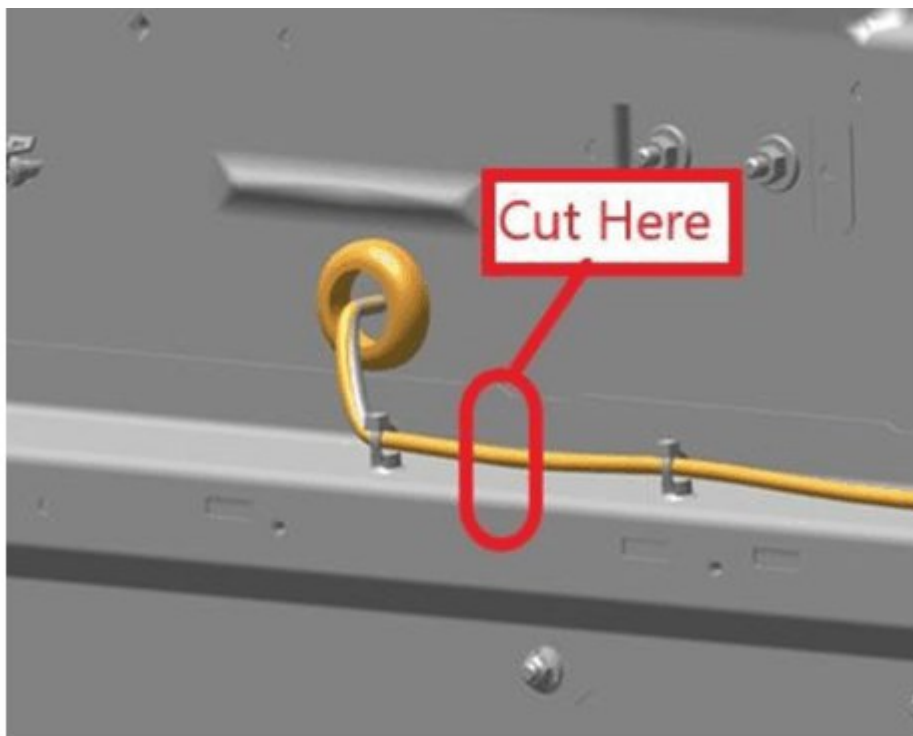

17. Insert the camera connector of the overlay harness into the hole from inside the cab and install the grommet (Part of the new harness). See the parts information for the overlay harness part number, which is determined by cab length.

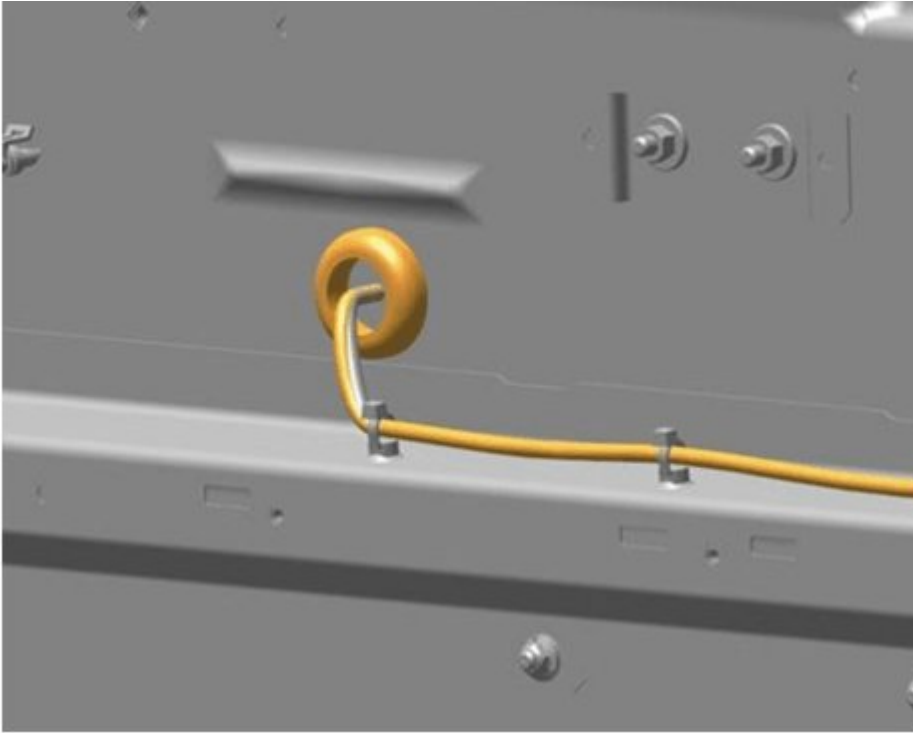

18. Connect the camera connector. (Outside)

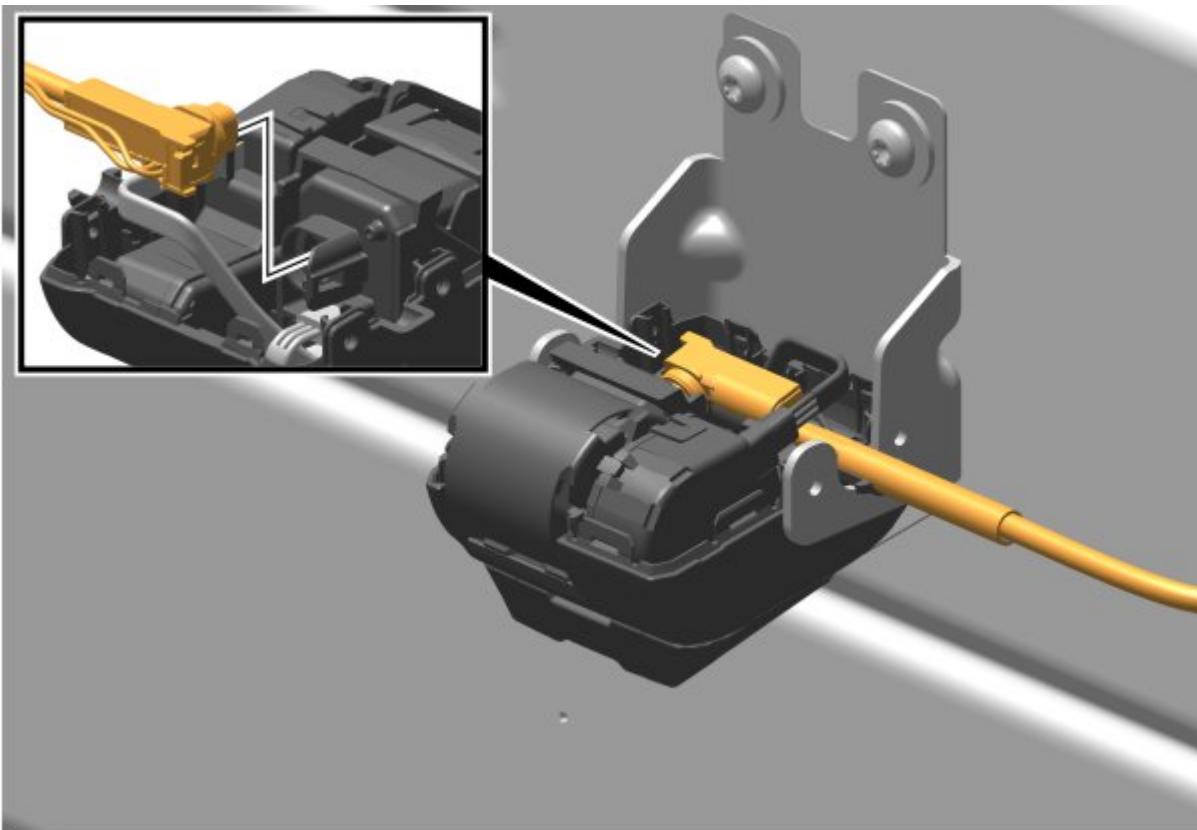

19. Install the camera housing cover and install a new cable tie.

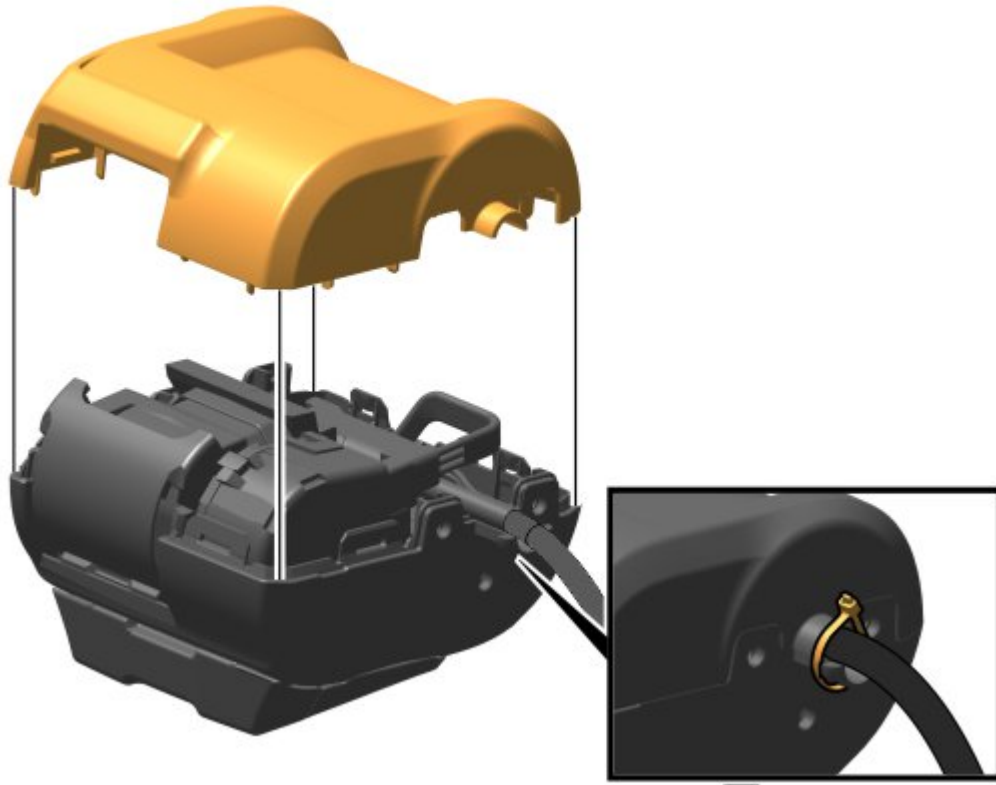

20. If equipped with a Chassis Camera Ethernet Switch (CCES), install a new jumper harness (P/N 23921338) to connect the overlay harness to the CCES.

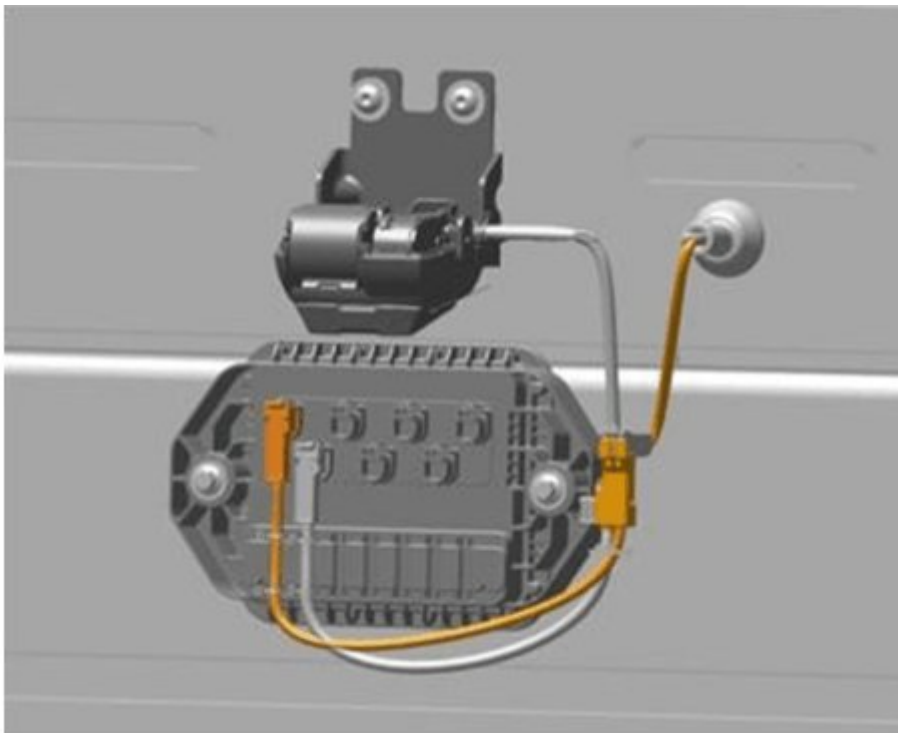

21. Route the harness following the existing cab harness. The Ethernet cable and white wire will go to the driver's B-pillar, and the yellow wire will go to the passenger's B-pillar.
 22. Once routed, locate the connectors located at the B-pillar behind the driver's door.

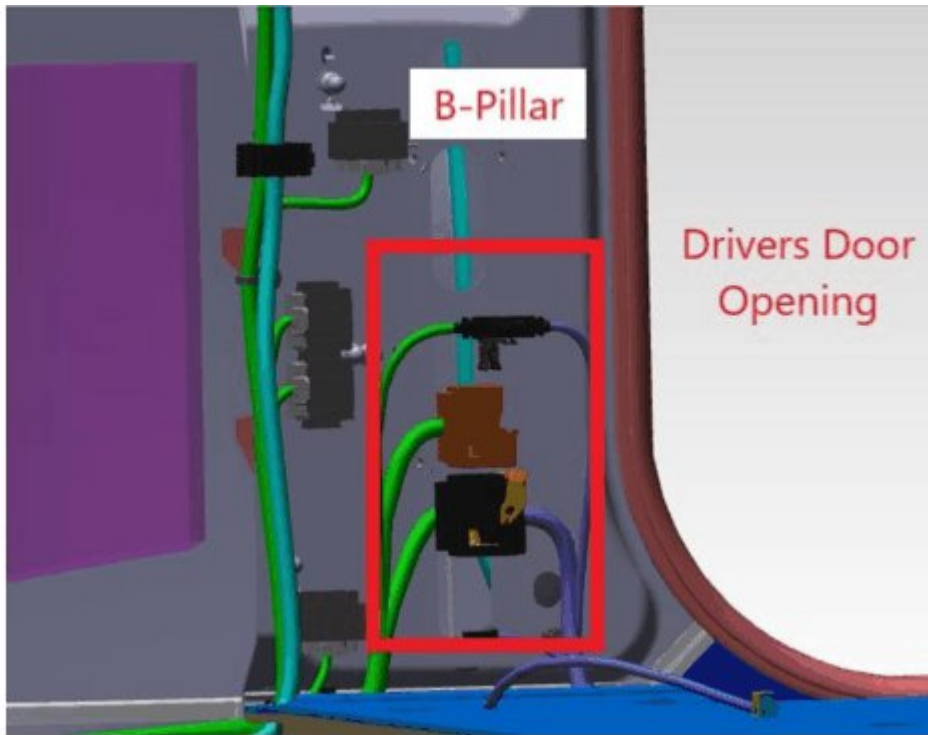

23. Locate the camera Ethernet cable connector.
24. Disconnect the connector. This connector will no longer be used. Move it aside and secure it out of the way with a cable tie.

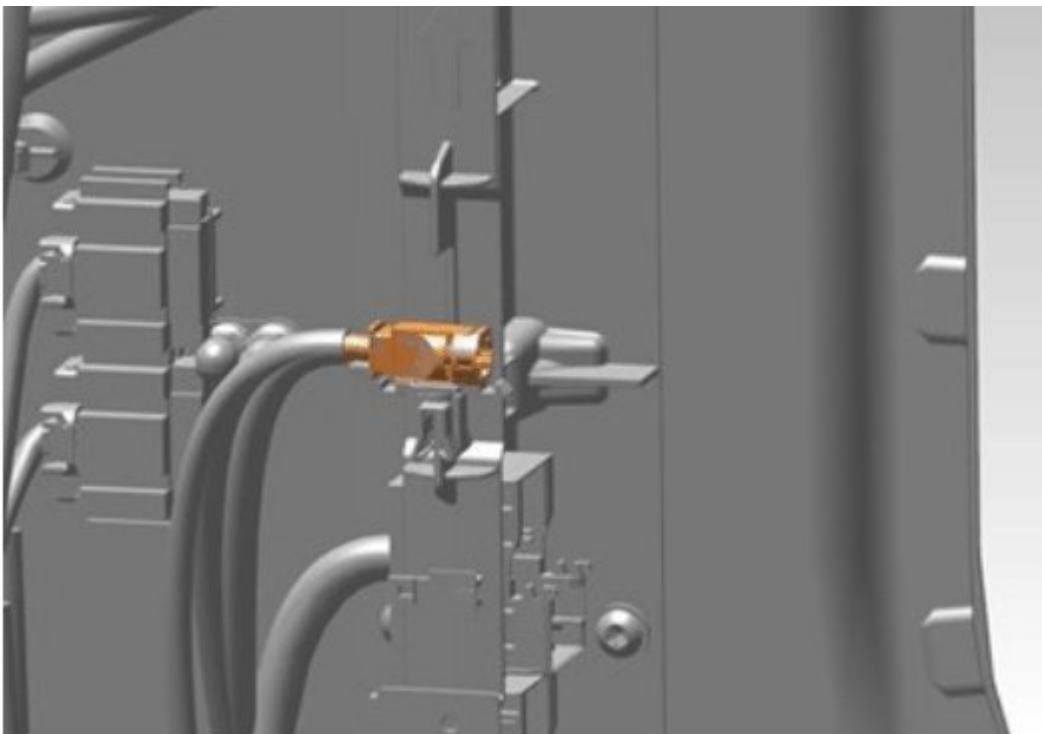

25. Connect the overlay harness Ethernet connector.

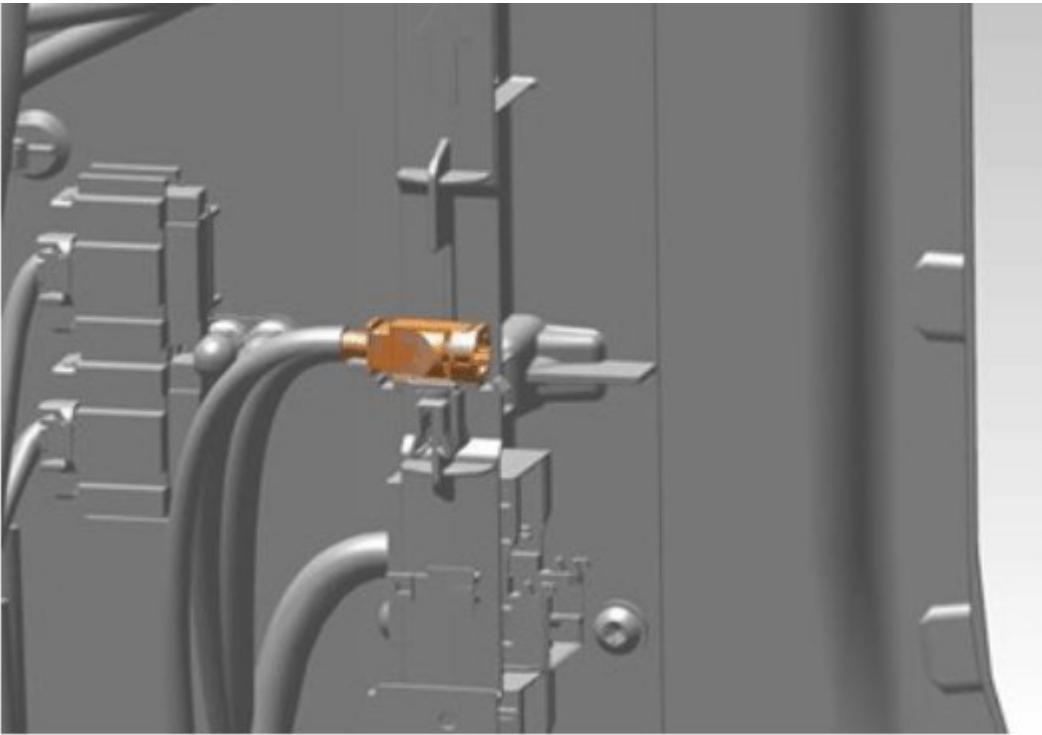

26. Locate the ground splice block (ID 1.36) mounted behind the driver's seat on the left B-pillar.

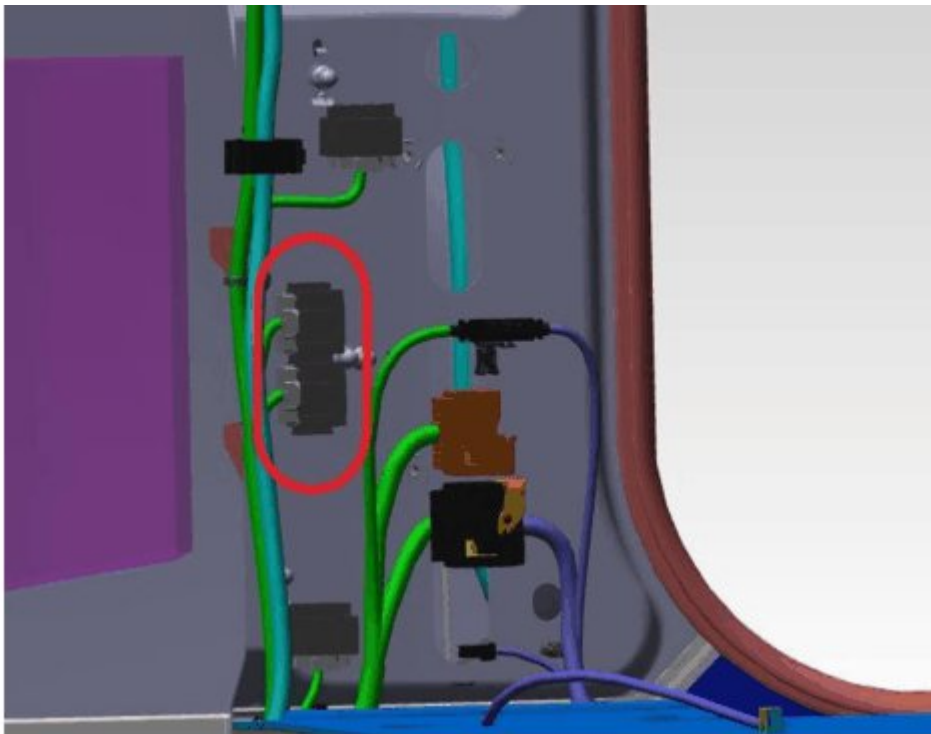

Important Note

Follow the instructions in the -2 Cable Repair, Example document to disassemble the connector.
--

27. Remove white ground wire from connector A, terminal 3.
 28. Cut the terminal pin off the removed wire and secure the wire out of the way with a cable tie.
 29. Insert the white ground wire from the overlay harness into connector A, terminal 3.
 30. Locate the connector XC105 mounted behind the passenger seat on the right B-pillar.

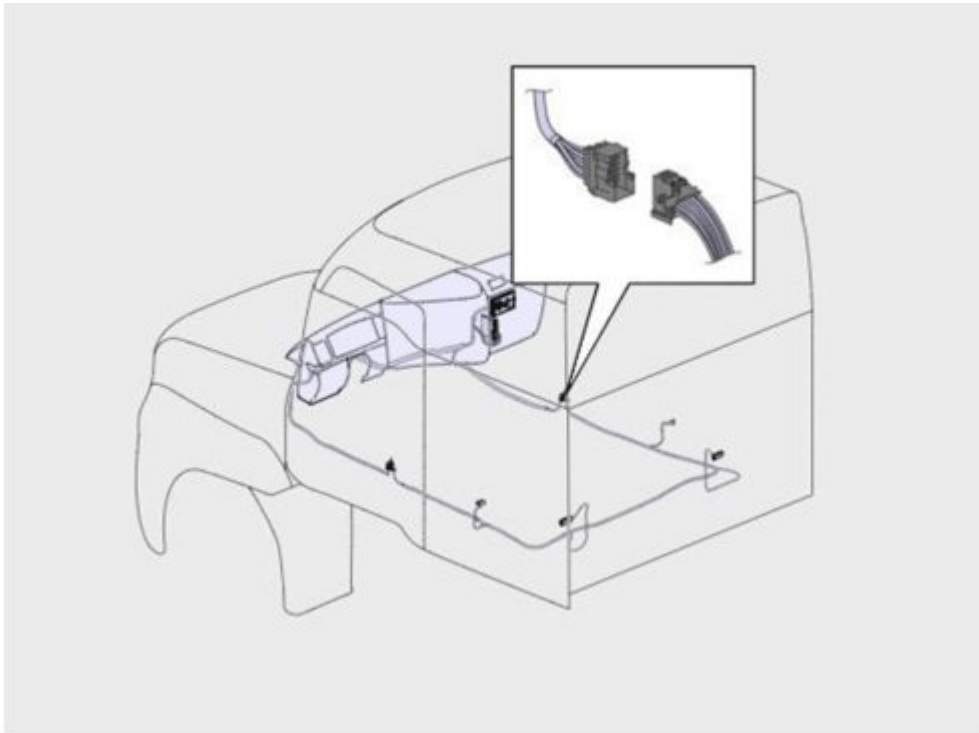

Important Note

Follow the instructions in the -2 Cable Repair, Example document to disassemble the connector.
--

31. Remove the yellow power wire from terminal 17 of XC105 (XC105:17).

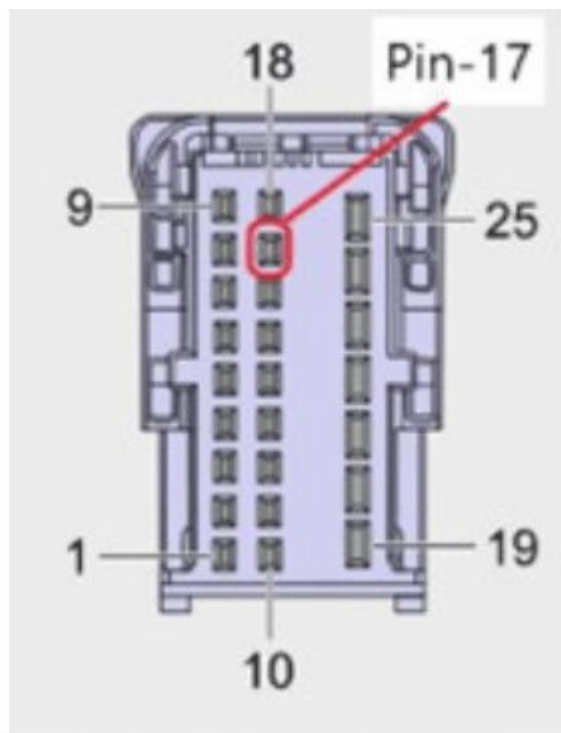

32. Cut the terminal pin off the removed wire and secure the wire out of the way with a cable tie.
33. Insert the new yellow power wire terminal from the overlay harness into connector XC105, terminal 17 (XC105:17).

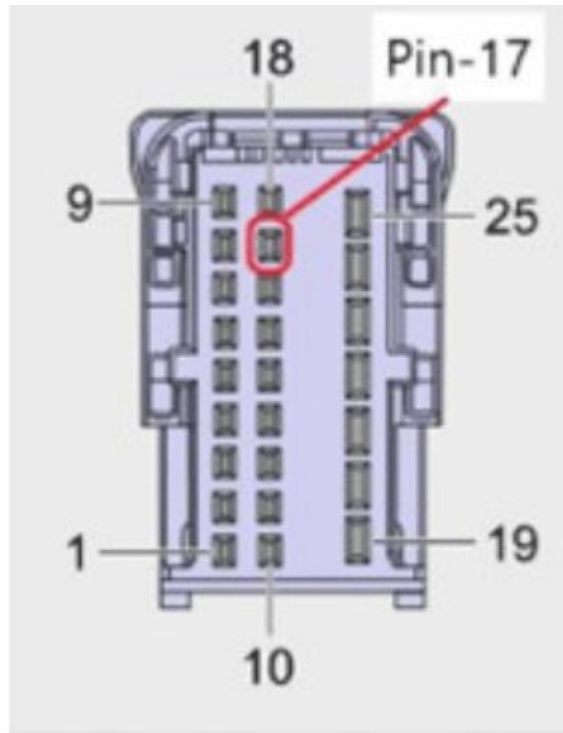

34. Secure the overlay harness to the existing cab harness with cable ties.
35. Follow the Impact operation [85164-2 Trim Panel \(Rear, Lower\), Replacement](#) to install the removed interior panels. Start where you paused at step 9.
36. Commission the low-voltage system.

Note: See header link for more information. [31003-1 Low Voltage System, Commissioning](#)

37. Install the fairing.
38. Install the tether.

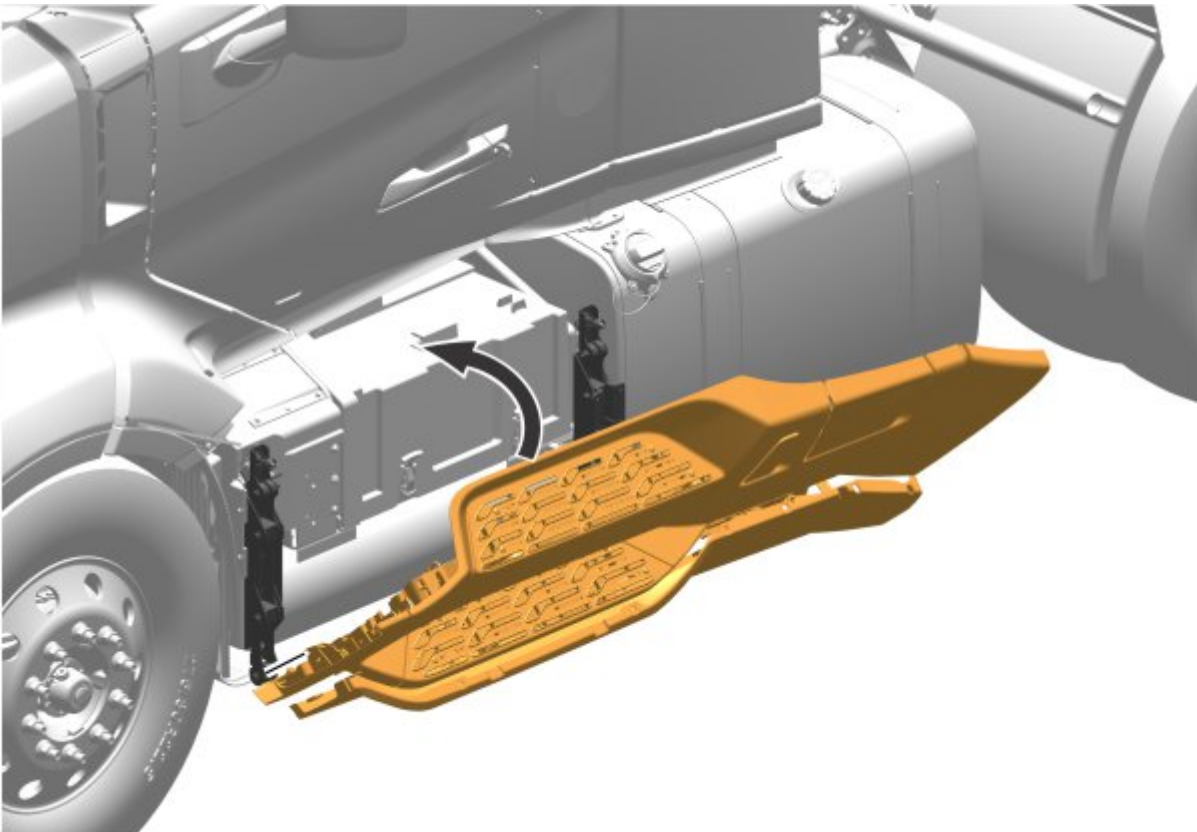

39. Latch the fairing.
- Copyright to this documentation belongs to the Volvo Group. No reproduction, copying, change, amendment or other similar disposal is entitled without prior written consent by the Volvo Group

The information contained herein is current at the time of its original distribution, but is subject to change. The reader is advised that printed copies are uncontrolled.

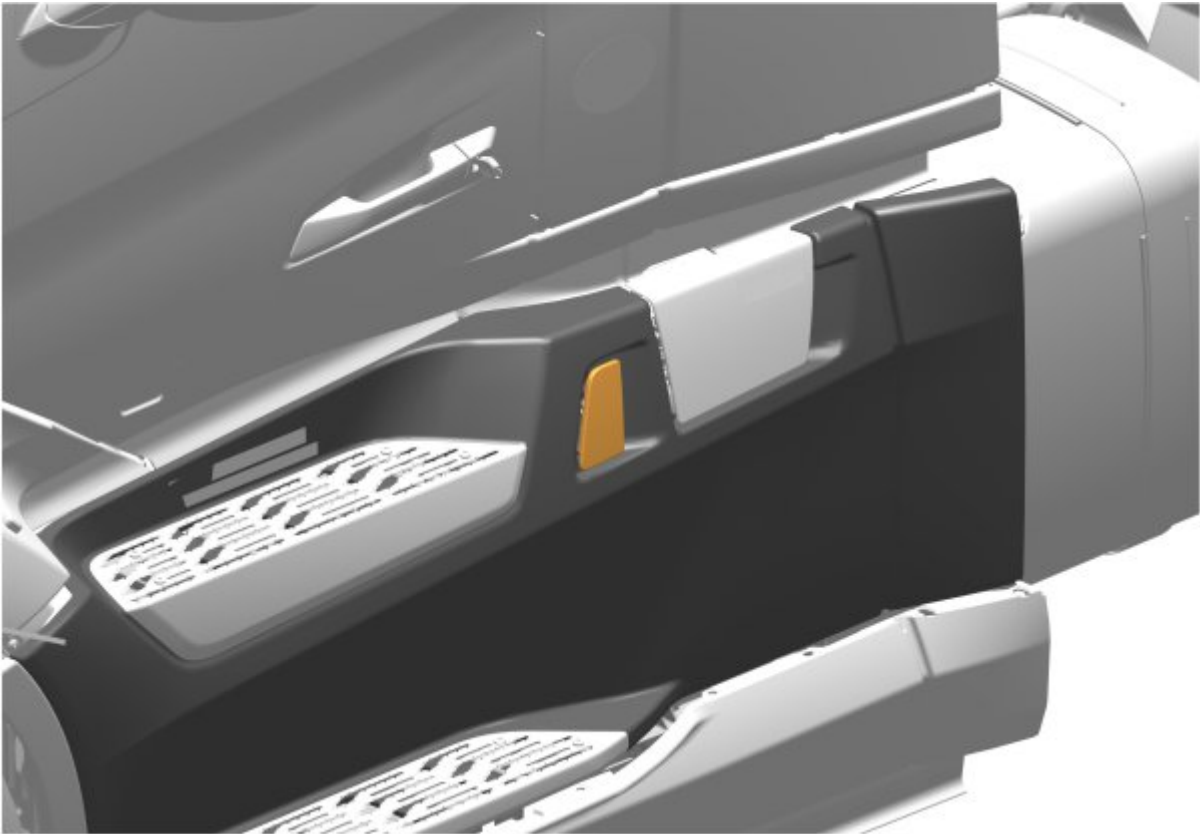

40. Remove the wheel chocks.

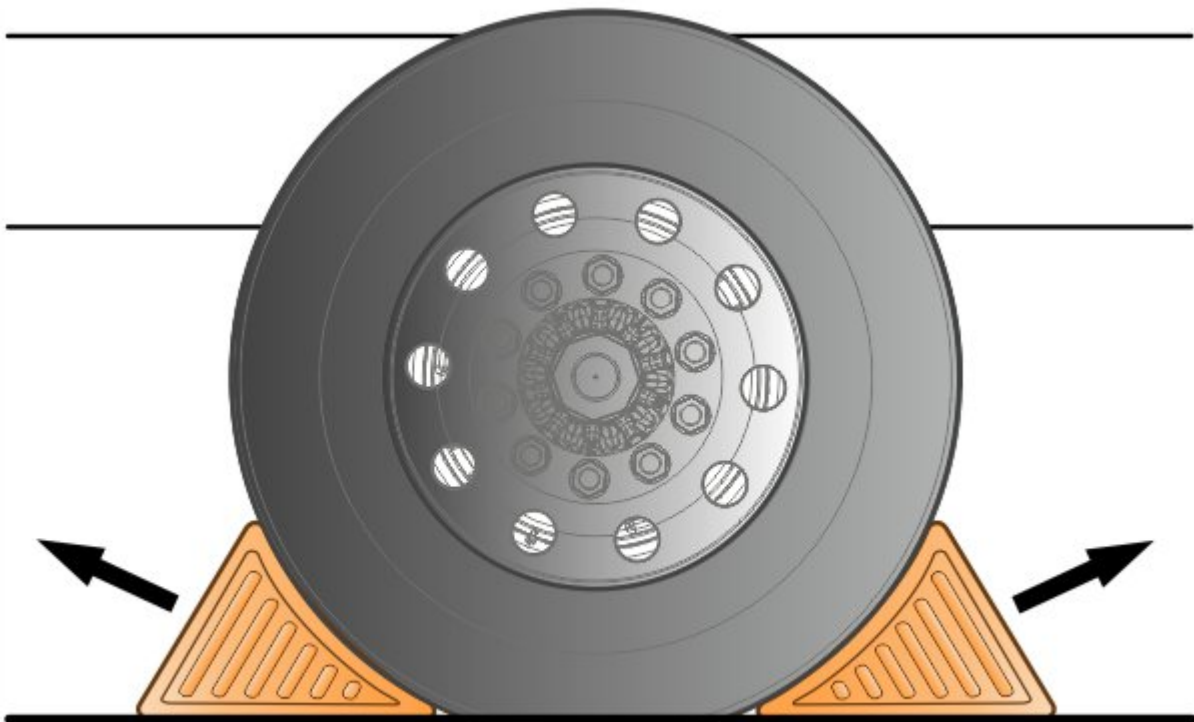

41. Release the truck.

Issued by

Technical Service

Copyright to this documentation belongs to the Volvo Group. No reproduction, copying, change, amendment or other similar disposal is entitled without prior written consent by the Volvo Group

The information contained herein is current at the time of its original distribution, but is subject to change. The reader is advised that printed copies are uncontrolled.

Volvo Trucks North America engages in a continuous program of testing and evaluating to provide the best possible product. Volvo Trucks North America, however, is not committed to, or liable for updating existing chassis.