



GROUP	MODEL
ELE	2027MY Telluride (LQ2a)
NUMBER	DATE
415	March 2026

TECHNICAL SERVICE BULLETIN

SUBJECT: **REAR OCCUPANT ALERT LOGIC IMPROVEMENT (SA643)**

This bulletin provides the procedure to upgrade the Rear Occupant Alert (ROA) system software on certain 2027MY Telluride (LQ2a) vehicles produced from December 03, 2015, through February 03, 2026. If movement of objects in the rear seating area is detected under certain conditions after the ignition is turned off, the affected vehicles may unnecessarily sound the horn for approximately 25 seconds and send a text message to Kia Connect enrollees. Follow the procedure outlined in this publication to upgrade the ROA system software using the Kia Diagnostic System (KDS) and perform the required ROA Detection Performance Parameter Update to improve the precision of rear occupant detection after the ignition is turned off. Refer to [SST081](#) for software upgrade instructions using Kia Diagnostic System (KDS) tablet and VCI-II or VCI-III and confirm the Upgrade Event Number/Name, ROM ID Information, and Manual Mode passwords (if applicable) on the applicable vehicle.

This software upgrade may also be available via an Over-the-Air (OTA) update on vehicles with an 'active' Kia Connect subscription.



NOTICE

A Service Action is a repair program without customer notification that is performed during the warranty period. Any dealer requesting to perform this repair outside the warranty period will require DPSM approval.

Repair status for a VIN is provided on KDealer+ (Service → Warranty Coverage → Warranty Coverage Inquiry → Campaign Information). Not completed Recall / Service Action reports are available on KDealer+ (Consumer Affairs → Not Completed Recall → Recall VIN → Select Report), which includes a list of affected vehicles.

This issue number is [SA643](#).

A printed copy is for reference only; publication information can be updated at any time. Always refer to KGIS for the latest information. After logging in kdealer.com, the newest technical publications are listed in 'Service Releases' and has the latest service information that has been released.

Refer to [TSB SST081](#) for instructions to upgrade the 'ROA' system:

❗ IMPORTANT

The software update may also be available via **Over-The-Air (OTA)** upgrade feature through an 'active' Kia Connect account for customers. An OTA software upgrade may not be available at the time a TSB publication is released. Dealers can confirm OTA availability by checking for OTA release notes on the Kia Owners Portal: [OTA Software Update Release Notes](#). If the affected vehicle had the latest software installed via OTA, no further action is required by the dealer.

Note: An OTA installed software is time-stamped for each VIN.

❗ IMPORTANT

- **Verify that the KDS tablet has the most current software installed.**
- **After the upgrade is complete, perform the 'ROA Detection Performance Parameter Update.'**

To correct this condition, the specified system module should be reprogrammed using KDS as described in this bulletin in 'Auto Mode'.

Upgrade Event Name
942.LQ2a ROA Operation Logic Improvement
943. LQ2a ROA_FR Operation Logic Improvement

📄 NOTICE

- Confirm a fully charged battery (12.3 volts or higher is necessary) is used or utilize a fully charged jump starter box connected to the battery.
- **Ensure the KDS GDS is sufficiently charged at 60% or higher prior to reflash.**
- All ECU upgrades must be performed with the ignition set to the 'ON' position unless otherwise stated.
- **Damaged VCI II units should not be used and promptly replaced.**
- Be careful not to disconnect the VCI-II connected to the vehicle during the ECU upgrade procedure.
- **DO NOT start the engine during ECU upgrade.**
- DO NOT turn the ignition key 'OFF' or interrupt the power supply during ECU upgrade.
- **When the ECU upgrade is completed, turn the ignition 'OFF' and wait 10 seconds before starting the engine.**
- ONLY use approved ECU upgrade software designed for the correct application.

[Connect the negative \(-\) terminal to the battery as shown below.](#)



SUBJECT:

REAR OCCUPANT ALERT LOGIC IMPROVEMENT (SA643)**ROM ID Information Table:****NOTICE**

Before attempting an ECU upgrade on any Kia model, make sure to first determine whether the applicable model is equipped with an immobilizer  security system. Failure to follow proper procedures may cause the PCM to become inoperative after the upgrade and any claims associated with this repair may be subject to chargeback.

IMPORTANT

It is recommended to **ALWAYS** check the Electronic Parts Catalog (EPC) to locate the ECU Part Number respective to Auto/Manual Mode ROM IDs. **DO NOT** reference the parts label affixed to the ECU.

Upgrade Event #942

Model	System	IMMO 	ECU P/No.	ROM ID	
				Previous	New
Telluride (LQ2a)	ROA (Master)	Yes	95740 P8000 95740 P8010	25510 26110	26210

To verify the vehicle is affected, be sure to check the Calibration Identification of the vehicle's ECM ROM ID and reference the Information Table as necessary.

Upgrade Event #943

Model	System	IMMO 	ECU P/No.	ROM ID	
				Previous	New
Telluride (LQ2a)	ROA (Slave)	Yes	95745 P8000	25510 26110	26210

To verify the vehicle is affected, be sure to check the Calibration Identification of the vehicle's ECM ROM ID and reference the Information Table as necessary.



SUBJECT: **REAR OCCUPANT ALERT LOGIC IMPROVEMENT (SA643)**

Software Information:

The required software must be installed by selecting the **'Auto Mode'** ECU Upgrade option.

Note: In some case, the 'Manual Mode' installation option may be required **ONLY** if the 'Auto Mode' function fails or is otherwise noted above.

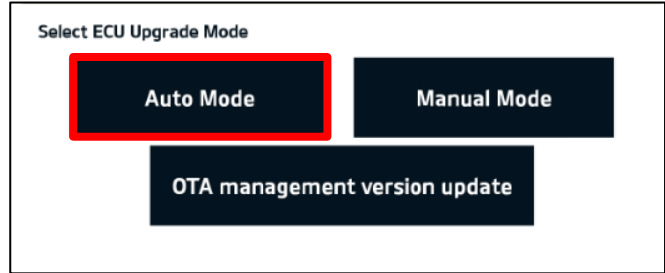

NOTICE

If the automatic upgrade fails, turn the ignition 'OFF' for about 10 seconds then place it back in the 'ON' position to reset the control unit BEFORE performing the manual upgrade.

'Manual Mode' passwords.

Event No.	Menu	Password
942	LQ2a ROA : 95740-P8000/10	8010
943	LQ2a ROA_FR : 95745-P8000	5475

IMPORTANT

After completing the upgrade, perform the ROA Detection Performance Parameter Update as described on pages 5 and 6.

UPGRADE EVENT:

Select the applicable **'ROA'** system module and the Event Group.

- **942.LQ2a ROA Operation Logic Improvement**
- and**
- **943. LQ2a ROA_FR Operation Logic Improvement**

Verify the affected vehicle Calibration Identification of the applicable ECU ROM ID and reference the Information Table on page 3 as necessary.

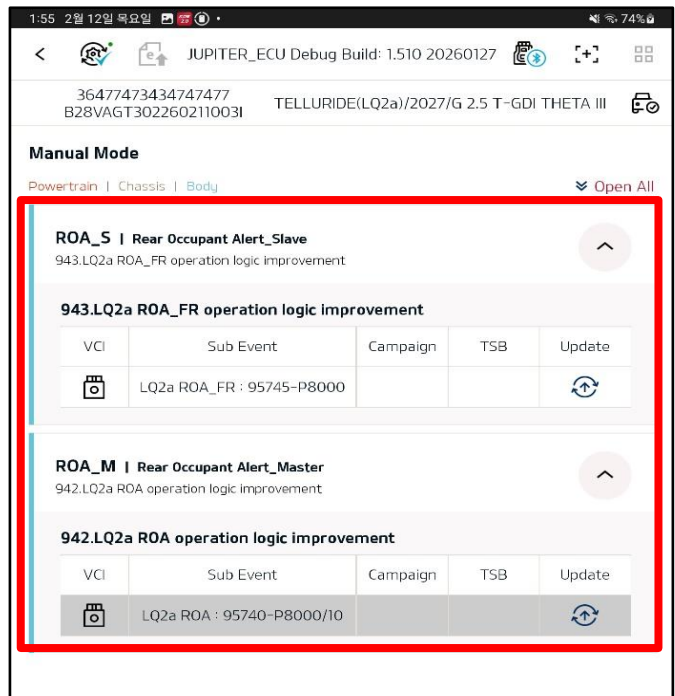

SUBJECT:

REAR OCCUPANT ALERT LOGIC IMPROVEMENT (SA643)

ROA Detection Performance Parameter Update:

NOTICE

The update will not proceed if the ROA software version or part number do not match.

Information

The current ROA SW version does not meet the required version for this function.
Please update to version 26210 or higher and try again.

OK

Information

The current ROA part number is not supported for this function.
Please check the ECU specifications and try again.

OK

1a. Using the KDS, select 'Expert Diagnosis'.

1b. Select 'S/W Management'.



SUBJECT:

REAR OCCUPANT ALERT LOGIC IMPROVEMENT (SA643)

- 2a. Select 'ROA_M - Rear Occupant Alert_Master'.
- 2b. Select 'ROA Detection Performance Parameter Update'.

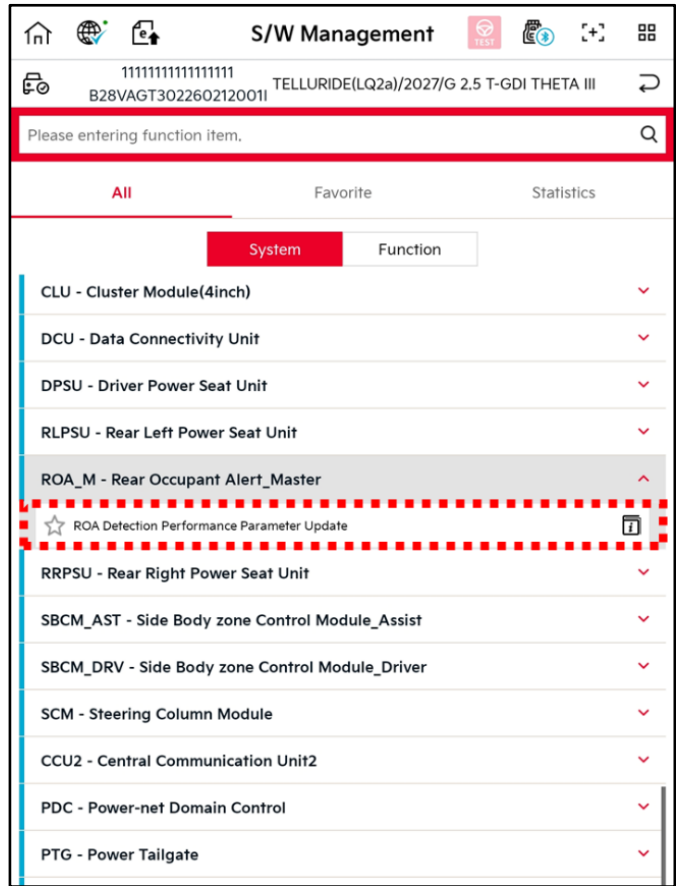

- 3a. To perform the **ROA Detection Performance Parameter Update**, confirm:
 - 1. Engine stopped
 - 2. Ignition 'ON'
 - 3. ROA Software version 26210 or higher

3b. Select 'OK'.

4. Confirm normal operation.

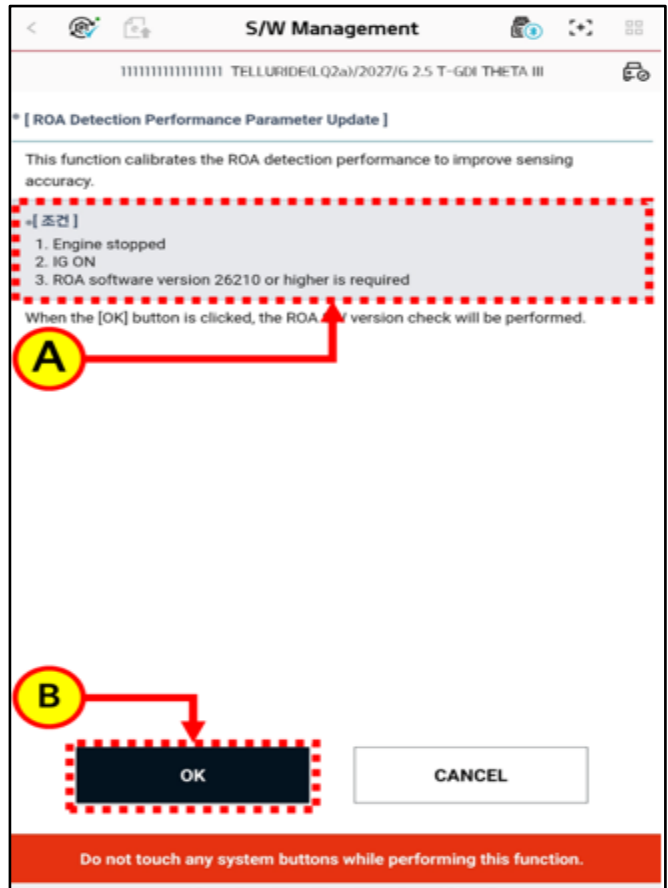



SUBJECT: REAR OCCUPANT ALERT LOGIC IMPROVEMENT (SA643)

AFFECTED VEHICLE RANGE:

Model	Production Date Range
Telluride (LQ2a)	December 03, 2015 to February 03, 2026

REQUIRED TOOL:

Tool Name	Part Number	Figure	Location	Comments
Kia Diagnostic System (KDS)	N/A		SHOP	KDS + VCI
VCI-II Connector	N/A			Connect Directly to KDS Using Included Ethernet Cable

WARRANTY INFORMATION:

N Code: N99 C Code: C99

Claim Type	Causal P/N	Qty.	Repair Description	Labor Op Code	Op Time	Replacement P/N	Qty.
V	95740 P8000	0	(SA643) ROA SW Logic Improvement + ROA Detection Performance Parameter Update	260A11R0	0.5 M/H	N/A	0

Note: When substitute transportation is provided, manually enter sublet code 'X2' for rental expense reimbursement or one roundtrip rideshare expense.

NOTICE

VIN inquiry data for this repair is provided for tracking purposes only. Kia retailers should reference **SA643** when accessing the KDealer+ system.

