

# RSB-64-26-001-1: Gap at Front of Wireless Charging Mat

Rivian is launching a technical service bulletin for some model year 2025-2026 R1T and R1S vehicles. These vehicles may have been built with a visible gap at the front of the wireless charging mat, resulting in a perceived quality issue. Upon customer complaint of a gap at the front of the wireless charging mat, Rivian will modify or replace components as necessary.

<b>Document Type</b>	Technical Service Bulletin
<b>Date</b>	February 18, 2026
<b>Affected Region(s)</b>	USA, Canada
<b>Affected Model(s)</b>	R1T, R1S
<b>Model Year(s)</b>	2025-2026
<b>Approximate Build Dates</b>	May 2024-December 2025
 Refer to the TSB Guide Dashboard to determine if this document applies to a specific vehicle.	
<b>Vehicle System</b>	64 - Interior

## Required Parts

Part Number	Quantity	Engineering Name	Service Name/Notes
N/A	As needed	McMaster-Carr 8762K891	1/4 inch thick felt tape

**!** **Attention:** The parts listed in this table are only for unique steps that are called out in this bulletin. Some sections of this bulletin might refer to Service Manual procedures which require additional parts. Always review the bulletin and all potentially related Service Manual procedures before ordering parts and beginning work.

## Potentially Required Parts

Part Number	Quantity	Engineering Name	Service Name/Notes
PT01200500-A	1	MAT TRAY UPPER CONSOLE ASSY	Mat, Center Console, Upper
PT01200501-A	1	MAT TRAY LOWER CONSOLE	Mat, Center Console, Front
PT01200499-A	1	MAT CONSOLE SLIDING TRAY	Mat, Center Console Tray
N/A	As needed	N/A	3M 9490LE Double Coated Tape
Refer to the parts catalog for part number and inventory information.	1	N/A	Trim, Center Console, Front

- !** **Attention:** The parts listed in this table are only for unique steps that are called out in this bulletin. Some sections of this bulletin might refer to Service Manual procedures which require additional parts. Always review the bulletin and all potentially related Service Manual procedures before ordering parts and beginning work.

## Inspection and Component Replacement

1. Inspect for a gap in the highlighted area.

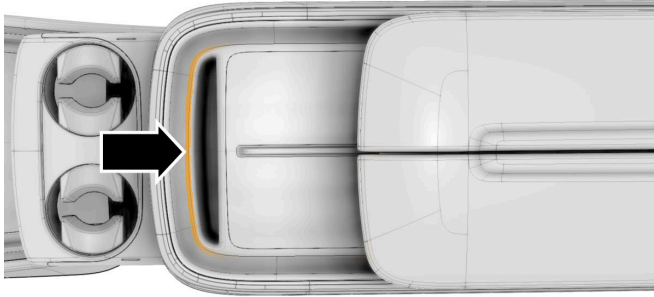

If a gap is present: Continue to the next step.

If no gap is present: This bulletin is not applicable. Discontinue this procedure.

2. Remove: Module, Wireless Charging (refer to service manual procedure 781032010).



**Note:** For the purposes of this bulletin, RiDE is not required for this step.

3. Cut 3 lengths of 10 mm x 15 mm (0.4 inch x 0.6 inch) felt tape.  
4. At the rear of the component: Apply one length of tapes as shown.

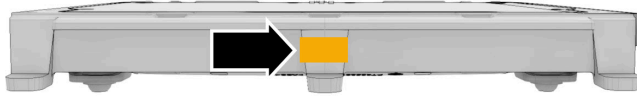

5. At the rear of the component: On both sides of the component: Apply one length of tape as shown.

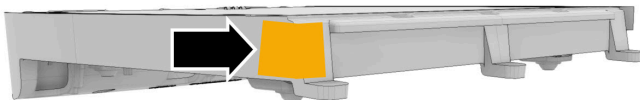

6. At the front of the component: On both sides of the component: Using wire cutters: Remove:

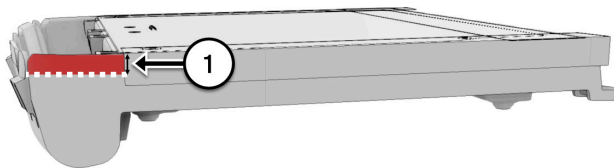

1	6 mm (0.24 inch)
---	------------------

7. Inspect:

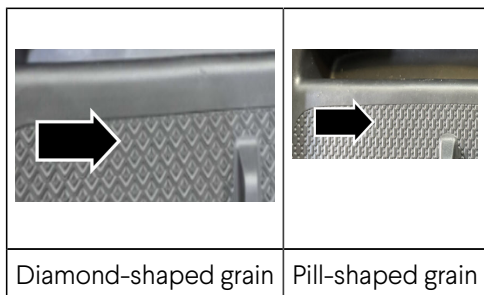
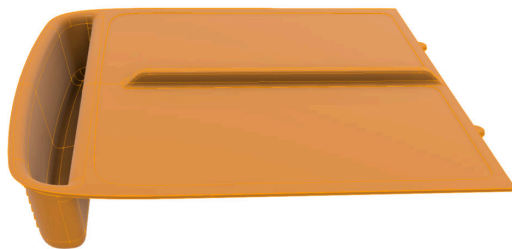

If the grain on the component is diamond-shaped: Replace the component(s). Continue to the next step.

If the grain on the component is pill-shaped: Reuse the existing component.

8. If the component was replaced in the previous step: Inspect and replace the highlighted components using the same criteria as the previous step.

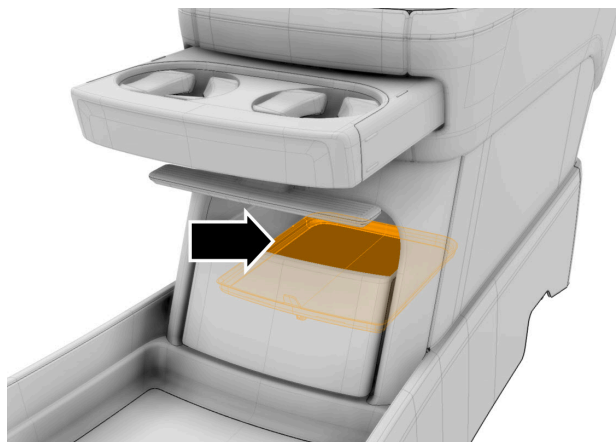

9. Reinstall the component(s). Repeat the inspection in step 1.

If a gap is present: Continue to the next step.

If no gap is present: No additional work is required.

10.

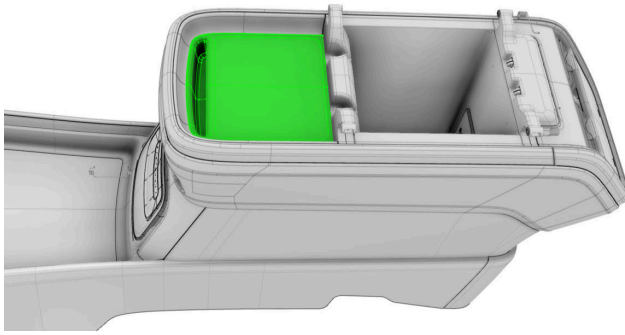

11. Cut 2 lengths of 30 mm x 11 mm (1.2 inch x 0.4 inch) double coated tape.

12. Make sure the component and tape are at least 50°F (10°C).

13. At the front of the component: Apply the tape as shown.

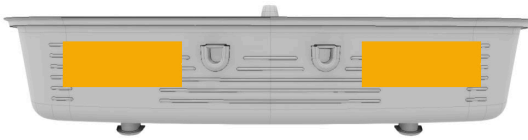

14. Reinstall:

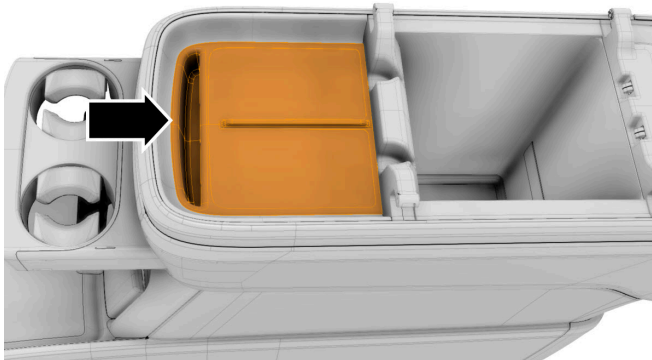

15. Repeat the inspection in step 1.

If a gap is present: Continue to the next step.

If no gap is present: No additional work is required.

16. Using ServiceOS: Determine the manufacturing date of the vehicle.

If the manufacturing date is before approximately September 3, 2024: Replace: Trim, Center Console, Front (refer to service manual procedure 643728010).

If the manufacturing date is after approximately September 3, 2024: No additional improvement is possible. Escalate for diagnostic assistance.

## Labor Codes

Labor Code	Description
RSB642600100	RSB-64-26-001 not applicable
RSB642600101	Modify wireless charger, apply felt tape
RSB642600102	Modify wireless charger, apply felt tape, apply double-coated tape
RSB642600103	Modify wireless charger, apply felt tape, apply double-coated tape, replace front center console trim