

WINNEBAGO			Revel / Ekko Alternator Retrofit		
Classification		Issue Date		Number	
Technical Service Bulletin		2/19/2026		7SB002-26-01A	
Models Affected:					
Revel/Ekko with Balmar Alternators					

This Technical Service Bulletin provides guidance for replacing or retrofitting the alternator on certain Winnebago Revel and Ekko motorhomes equipped with Balmar alternators. Due to higher-than-normal alternator failure rates, some owners may request a proactive retrofit. This bulletin outlines the recommended steps to support a smooth, efficient, and customer-focused service experience.

Recommended Actions:

- Identify whether the alternator replacement is due to a failure or a customer-requested retrofit. For failures, follow the standard warranty process. For retrofit requests, continue with the steps below.
- Order the alternator retrofit kit on a Non-Warranty Standard or Non-Warranty Rush order. Select Ship Via and Pick Type based on when the service is scheduled. Normal freight charges apply and are not reimbursed. Refer to the Parts Information section for kit numbers.
- Complete the retrofit once parts are received. Contact Technical Service with any retrofit questions.
- Submit a warranty claim for the alternator retrofit kit only. Use Claim Type: Warranty Claim, Service Authorization Number: **74G0219C**, TIC Code: **6627H5**. In the comments field, enter: **7SB002-26-01A**. Do not add labor operations or additional expenses.
- Submit the claim for approval. Approved claims will be reimbursed as a complete component with a 15% markup.
- All claims must be submitted and have a WRO acceptance number within 60 days of the repair completion date.
- Normal warranty parts retention applies.

Parts Information:

Quantity	Winnebago Parts Kit Number	Winnebago Parts Kit Description	Model
1	354721-01-704	ALT RETRO KIT W/O REG & HARN	MB 3.0L 6CYL
1	354721-01-705	ALT RETRO KIT W/O REG & HARN	MB 2.0L 4CYL
1	361041-01-702	ALT RETRO KIT W/O REG & HARN	FORD TRANSIT

Warranty Claim Information:

Claim Type	Part Number	TIC Code	Authorization Number
Warranty Claim	Refer to Parts Information	6627H5	74G0219C

FINAL CLAIMS MUST BE SUBMITTED BY 12/31/2026.

If You Need Assistance:

If dealer technical assistance is needed, please contact the Winnebago Motorhome Technical Service Department at (866) 653-4329 or by e-mail at: techservice@winnebagoind.com.

Nations Replacement Alternator Kit

Ekko Ford Transit Chassis



Contents of Ford Transit Nations Alternator Kit 361041-01-702

Disclaimer: Read the entire instructions carefully before starting the procedure. If you have any questions, please contact the Winnebago Motorhomes Technical Service Department by calling 1-866-653-4329 or by email: techservice@wgo.net . This document is confidential and is intended for dealer use only.



Temp Sensor Removal Balmar Alternator

Use a 10mm socket and a phillips screwdriver to remove temp sensor. Use 13mm socket to remove battery cable from alternator. **Make sure house battery is shut off to avoid shorting of cable.**

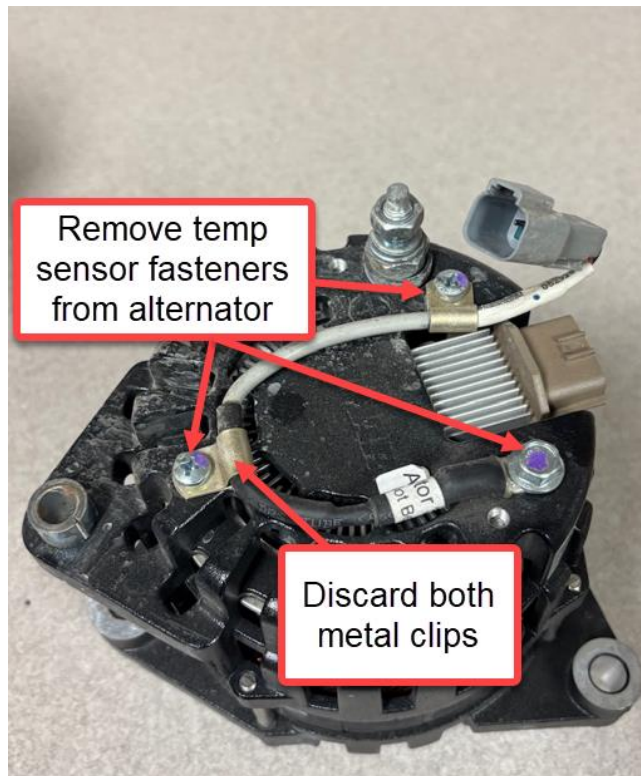

Temp sensor eyelet review.

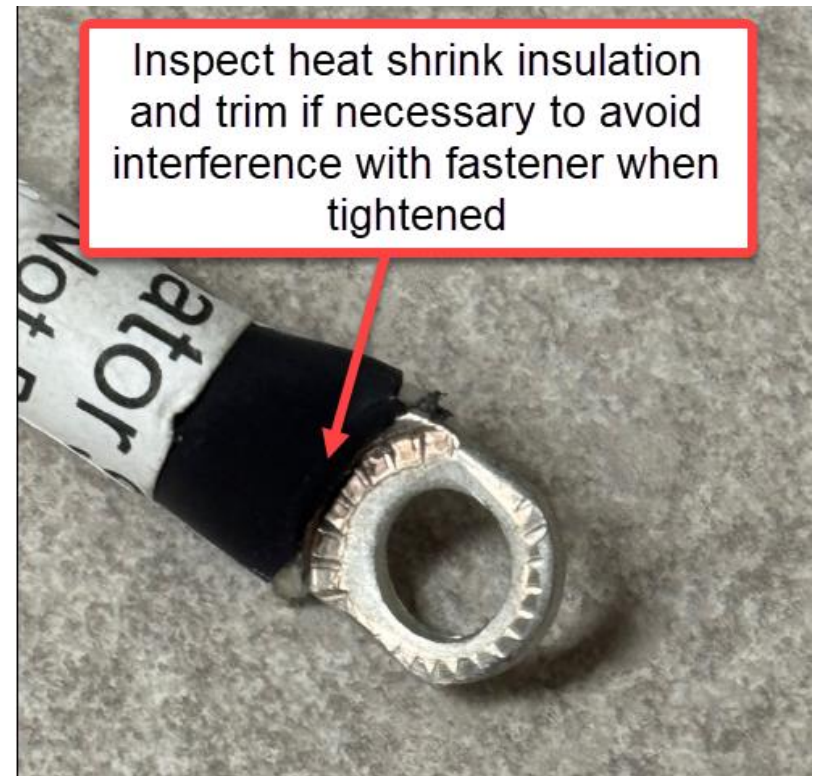

Prepping Alternator for Temp Sensor Install

Use 8mm socket to remove through bolt to install temp sensor.

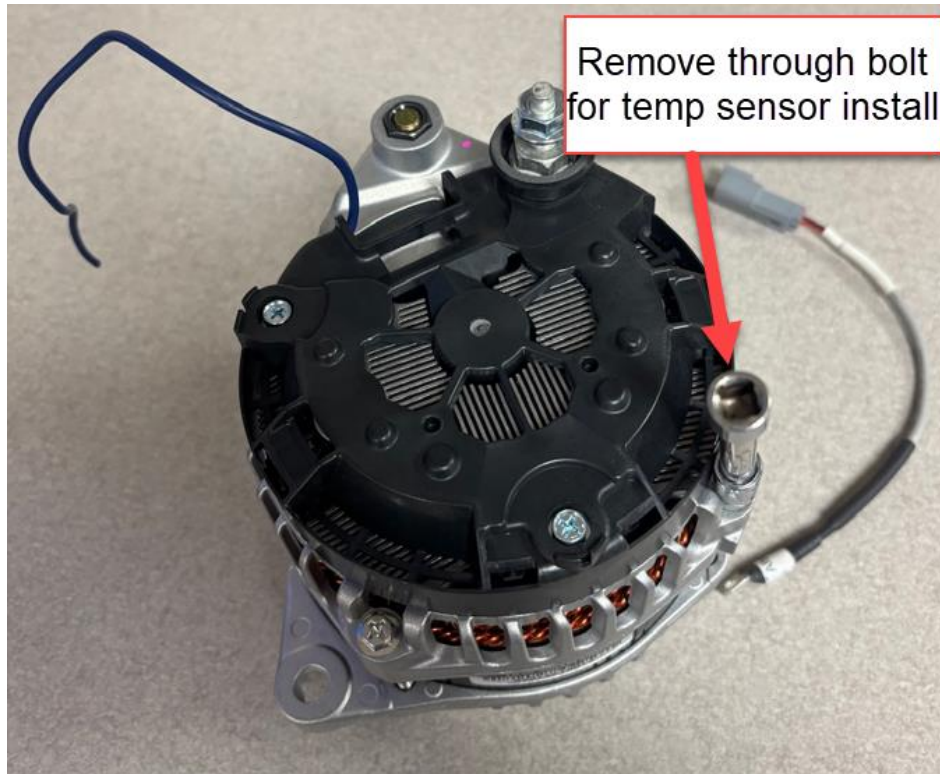

Install bolt/temp sensor and use 8mm socket to resecure.

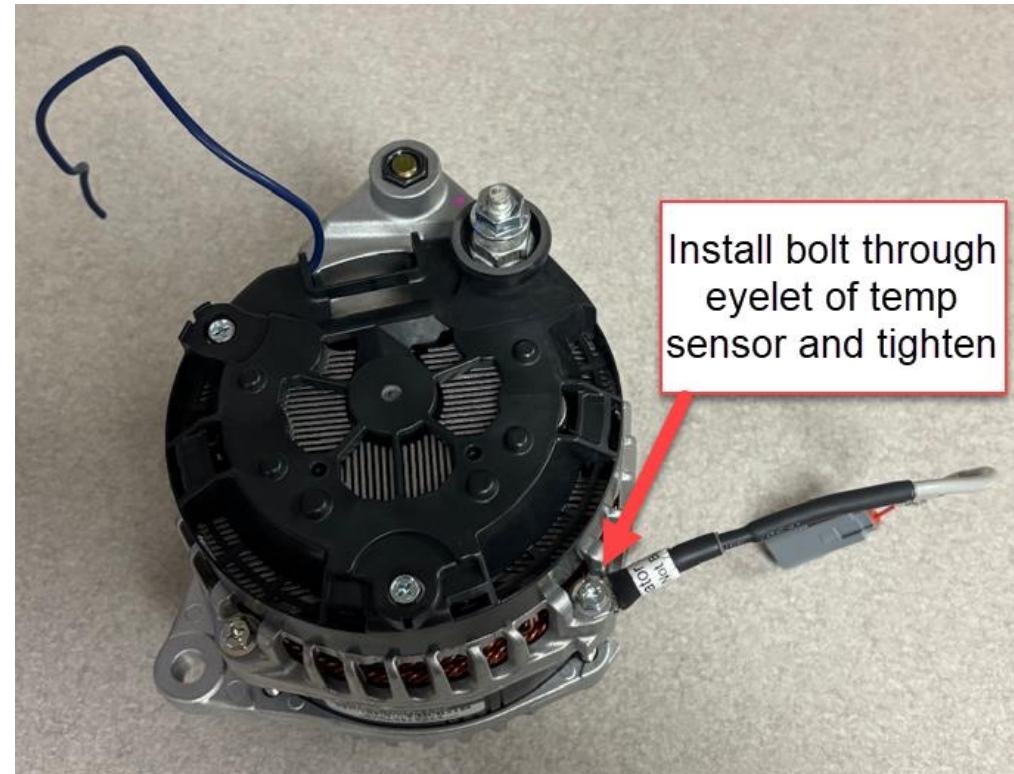

Temp Sensor Installation-Larger Eyelet

Early vendor harness the sensor is hardwired to the main harness. Left photo is larger eyelet.



Trim outside edge of eyelet to fit on alternator housing.



Temp Sensor Installation

Review final install of eyelet to make sure insulation of sensor is not pinched.



Final Look of Temp Sensor Install

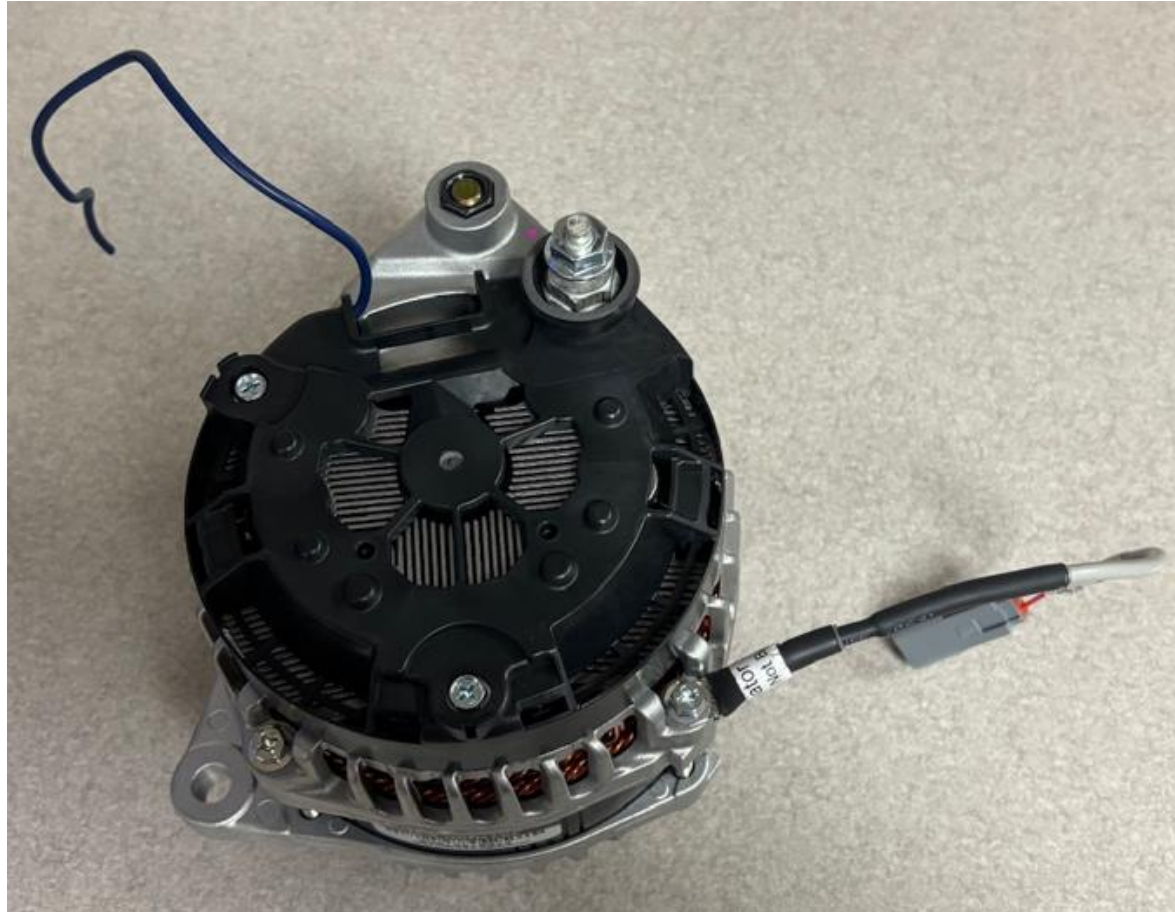

Field Flash Wire installation

Cut old field flash plug from wire loom.

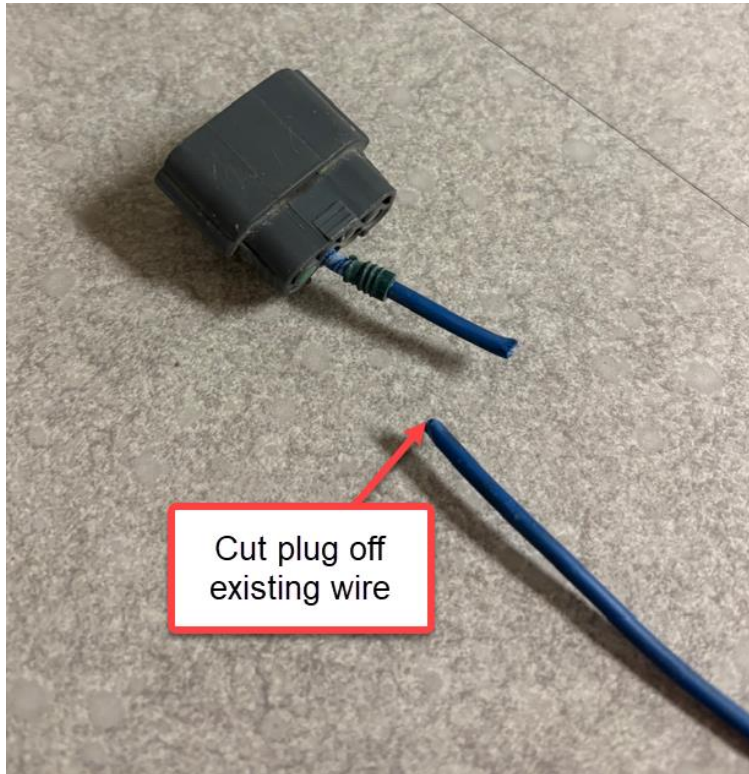

Installation of Nations field flash wire.

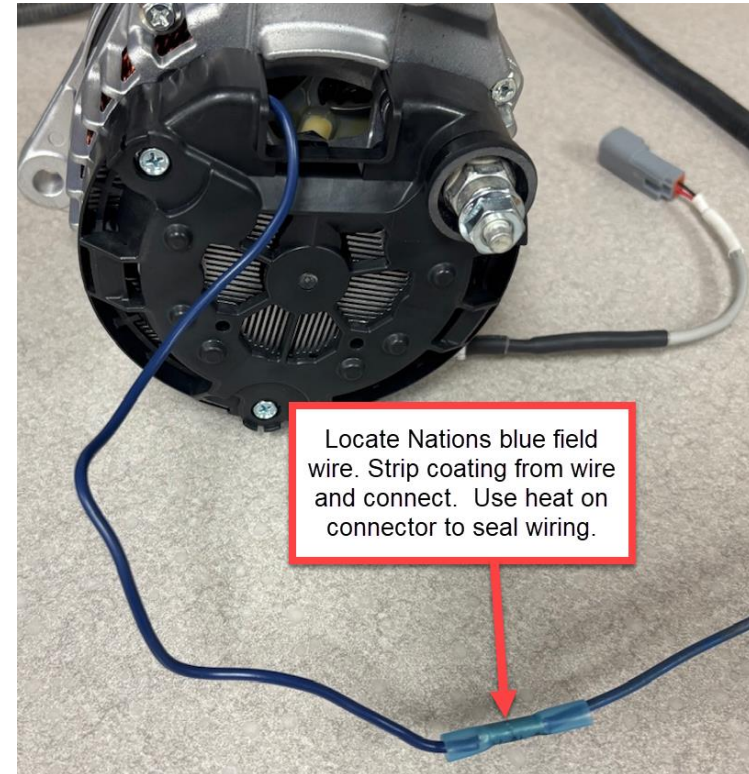

Alternator Attachment

Install alternator, new belt and secure positive cable using 13mm socket. **Torque 13mm cable nut to 13-15FT pounds.** Turn on battery and test system.



Start engine and open Lithionics App. Confirm current tile (circled below) has a green value. **If tile does not show correct value call Tech Service 866.653.4329.**



Nations Replacement Alternator Kit

Revel/Ekko 6-Cylinder Mercedes Benz Engines

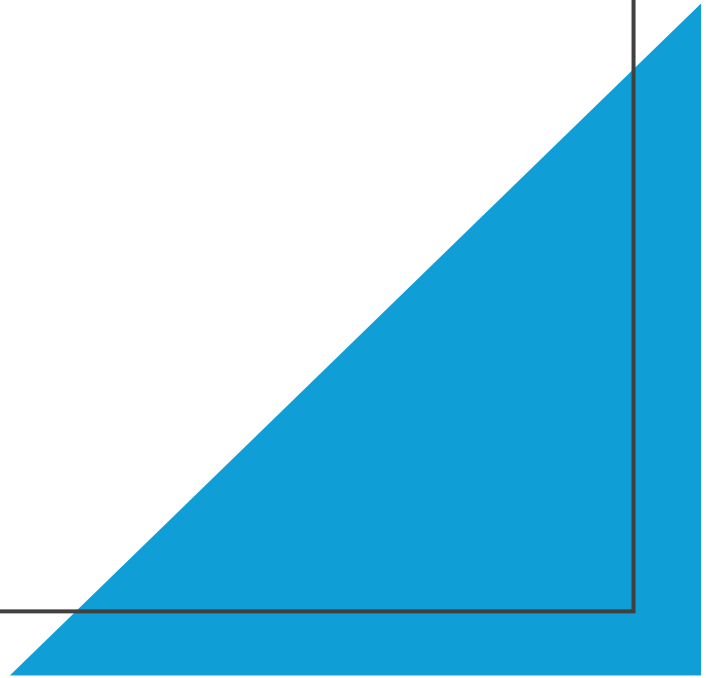

Parts Required for Mercedes Benz 6-Cylinder Nations Alternator Kit 354721-01-704

Disclaimer: Read the entire instructions carefully before starting the procedure. If you have any questions, please contact the Winnebago Motorhomes Technical Service Department by calling 1-866-653-4329 or by email: techservice@wgo.net . This document is confidential and is intended for dealer use only.



Temp Sensor Removal Balmar Alternator

Use a 10mm socket and a phillips screwdriver to remove temp sensor. Use 13mm socket to remove battery cable from alternator. **Make sure house battery is shut off to avoid shorting of cable.**

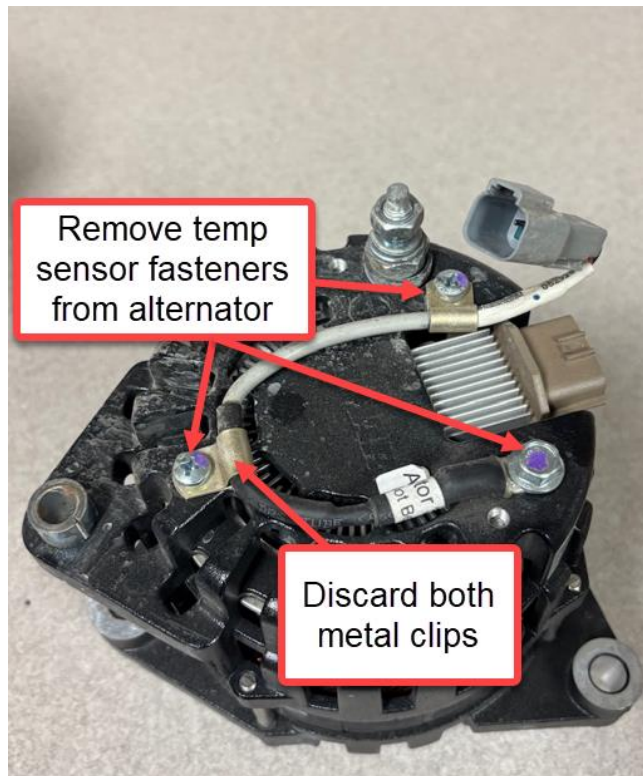

Temp sensor eyelet review.

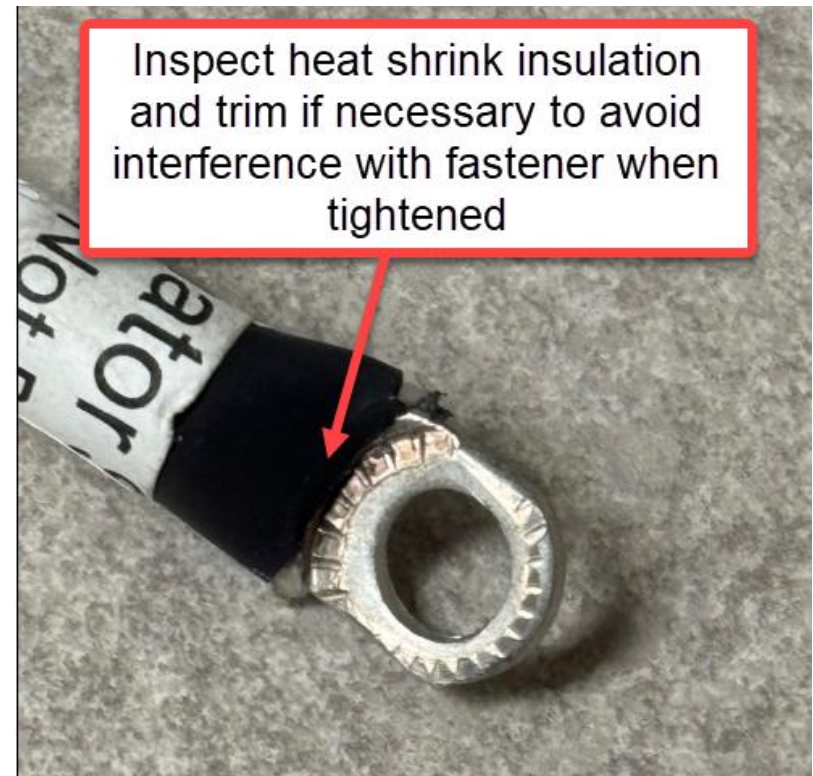

Prepping Alternator for Temp Sensor Install

Use 8mm socket to remove nuts to gain access to alternator through bolt for temp sensor install.

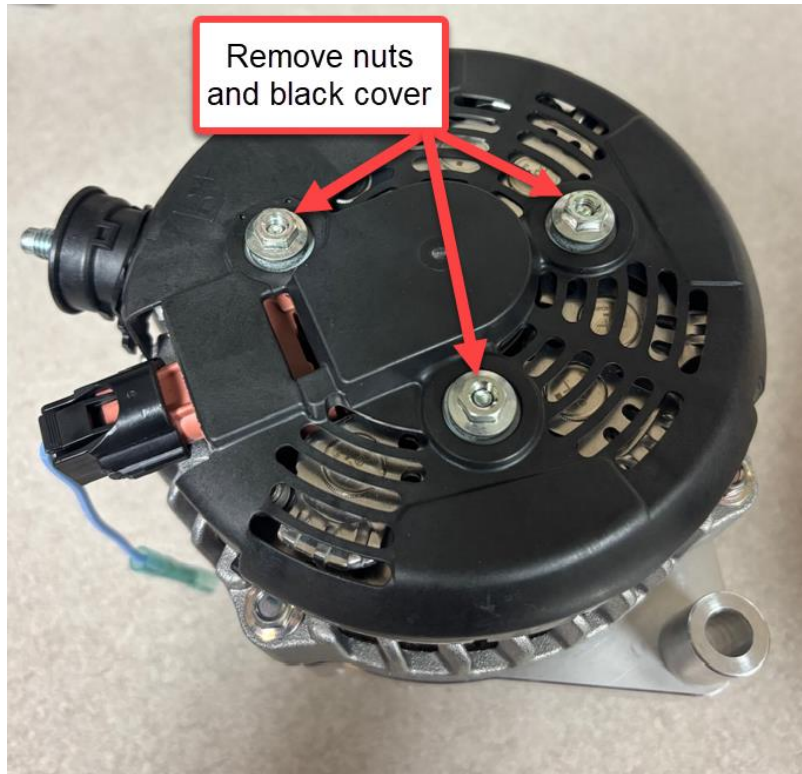

Use 8mm socket to remove through bolt to install temp sensor.

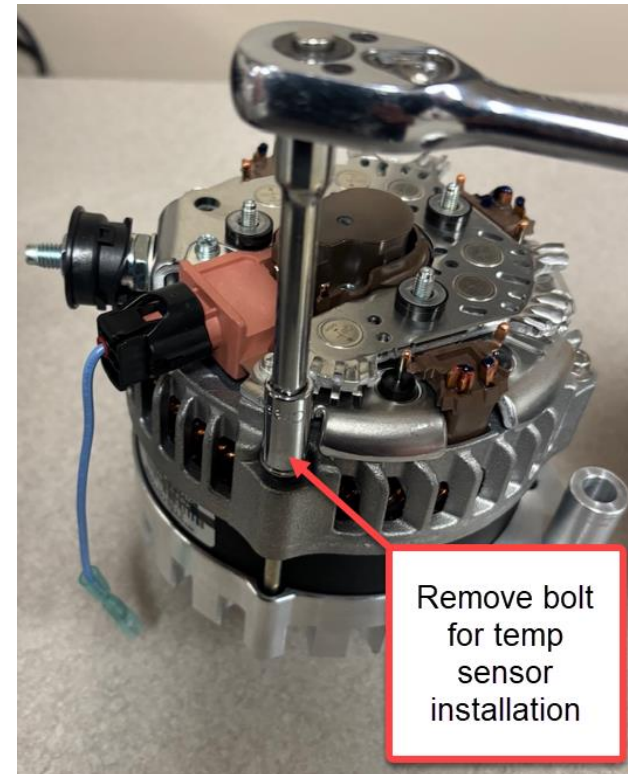

Temp Sensor Installation

Use 8mm socket to tighten through bolt for installation of temp sensor. Reinstall black plastic cover.

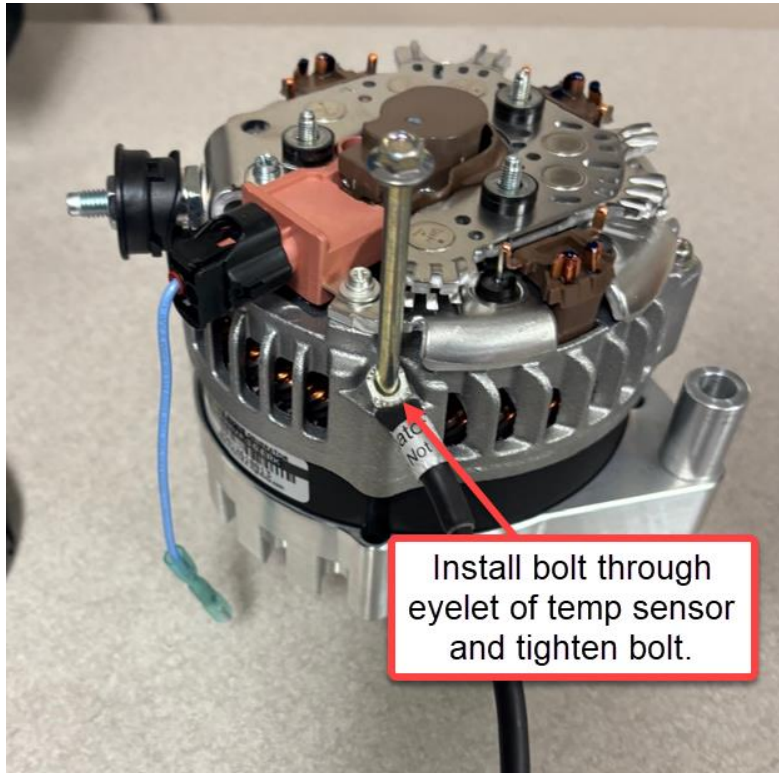

Review final Insall of eyelet to make sure insulation of sensor is not pinched.



Temp Sensor Installation-Larger Eyelet

Early vendor harness the sensor is hardwired to the main harness. Left photo is larger eyelet.



Trim outside edge of eyelet to fit on alternator housing.



Final look of Temp Sensor Install



Field Flash Wire installation

Cut old field flash plug from wire loom.

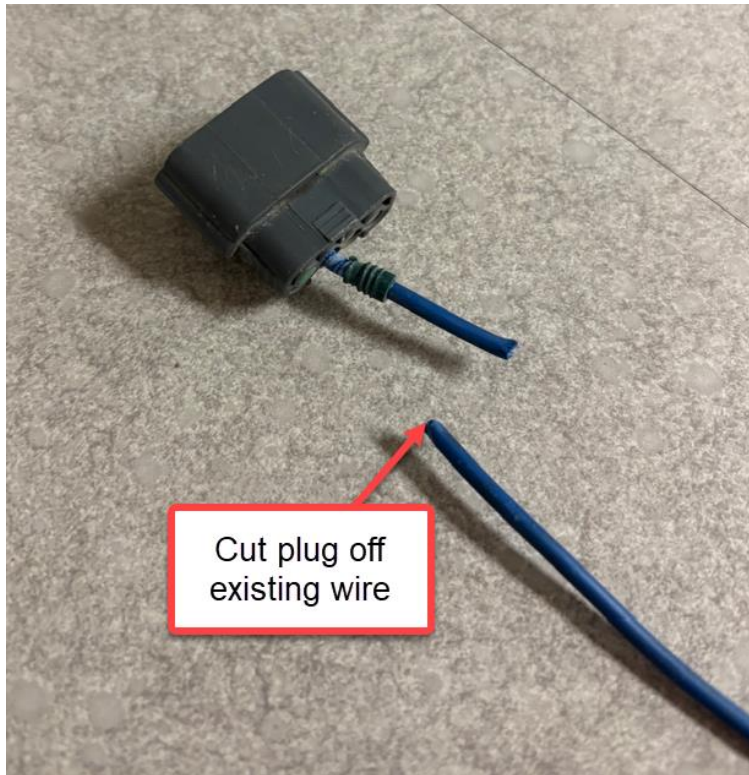

Installation of Nations field flash plug.



Alternator Attachment

Install alternator, new belt and secure positive cable using 13mm socket. **Torque 13mm cable nut to 13-15FT pounds.** Turn on battery and test system.



Start engine and open Lithionics App. Confirm current tile (circled below) has a green value. **If tile does not show correct value call Tech Service 866.653.4329.**



Nations Replacement Alternator Kit

Revel 4-Cylinder Mercedes Benz Engines

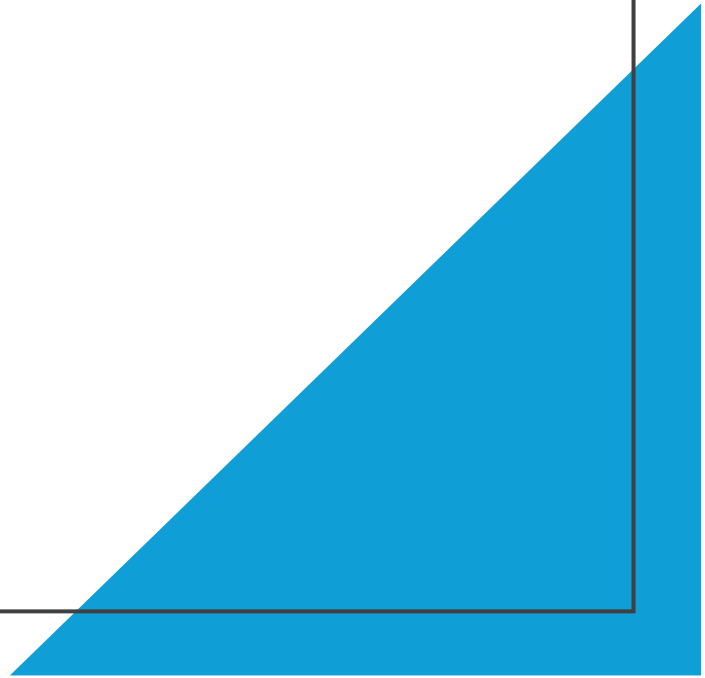

Parts Required for Mercedes Benz 4-Cylinder Nations Alternator Kit

MB 4 Cylinder Nations Alternator

354721-01-705

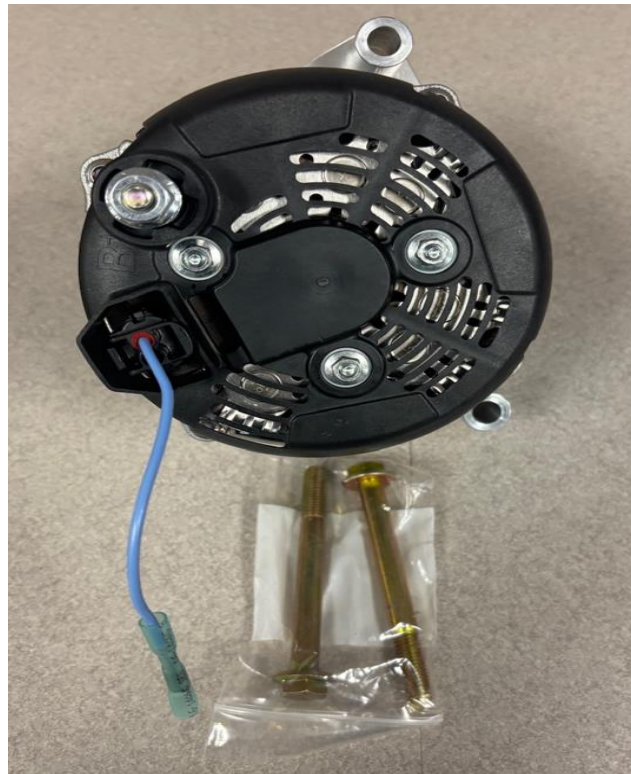

Disclaimer: Read the entire instructions carefully before starting the procedure. If you have any questions, please contact the Winnebago Motorhomes Technical Service Department by calling 1-866-653-4329 or by email: techservice@wgo.net. This document is confidential and is intended for dealer use only.

Mercedes Benz Belt

356000-01-000



Temp Sensor Removal Balmar Alternator

Use a 10mm socket and a phillips screwdriver to remove temp sensor. Use 13mm socket to remove battery cable from alternator. **Make sure house battery is shut off to avoid shorting of cable.**

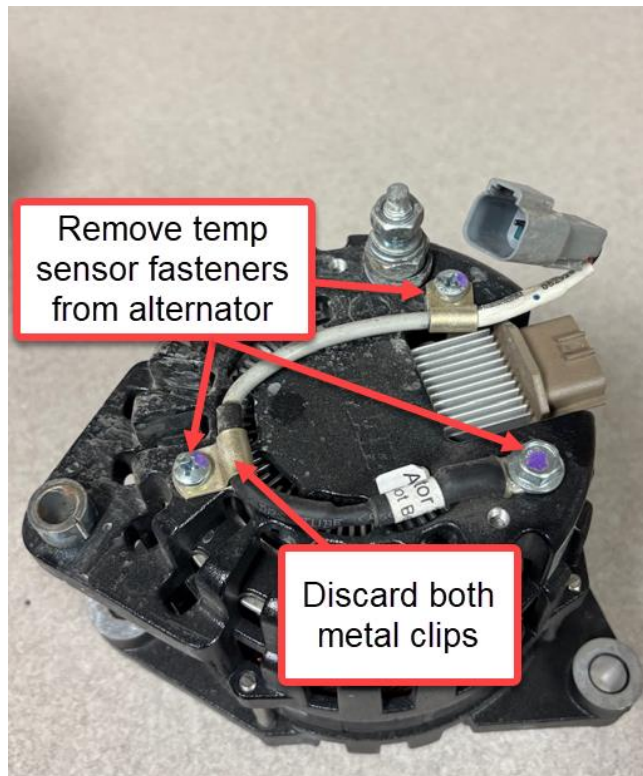

Temp sensor eyelet review.

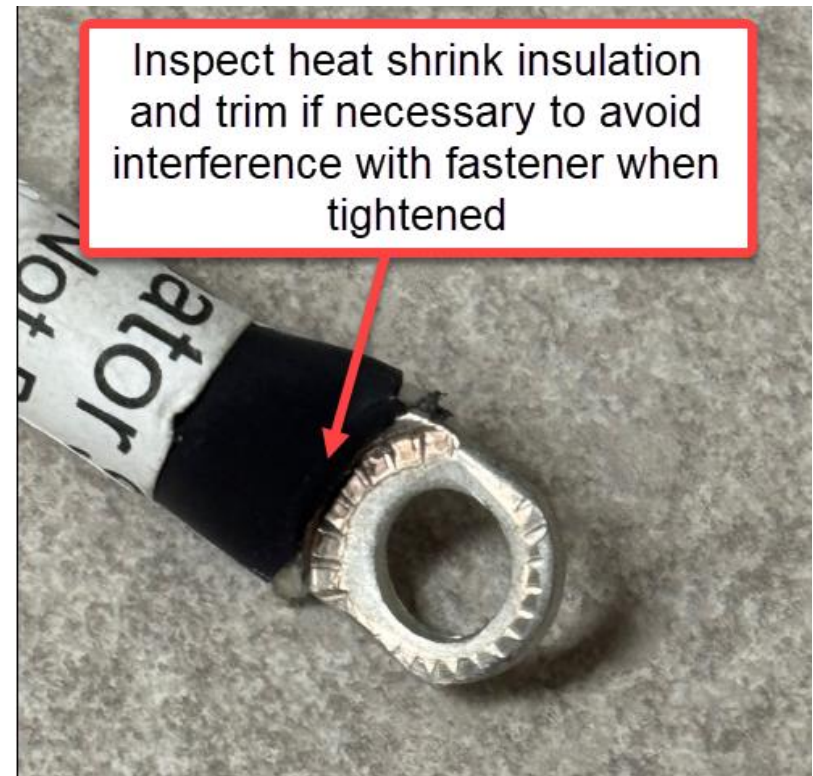

Prepping Alternator for Temp Sensor Install

Use 8mm socket to remove nuts to gain access to alternator through bolt for temp sensor install.

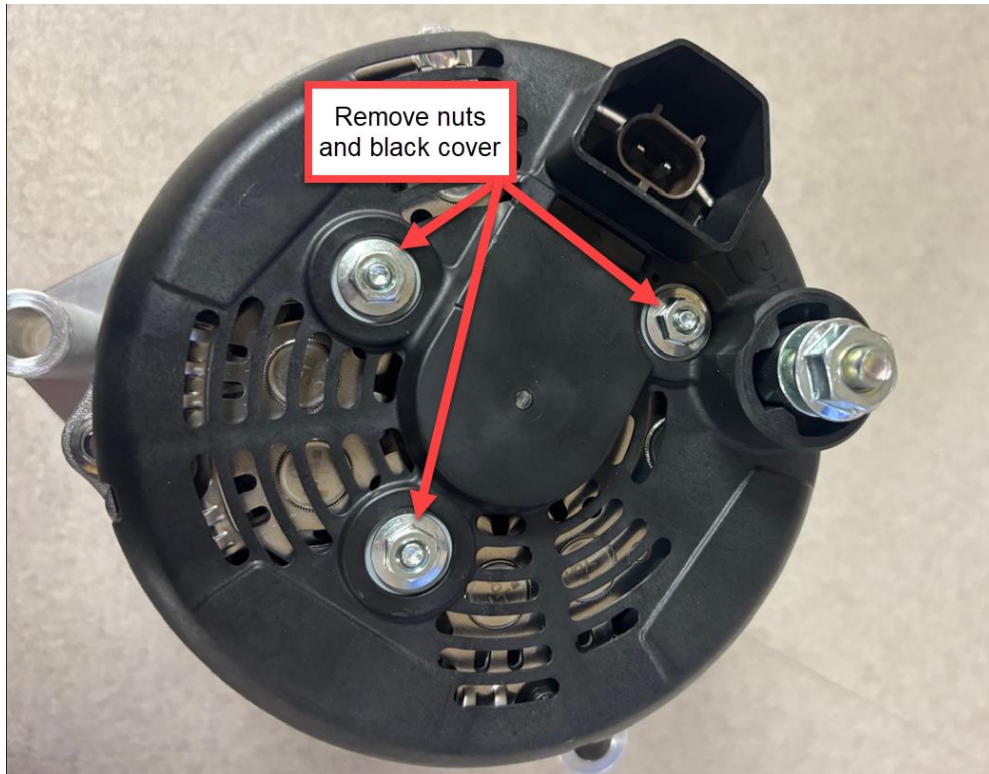

Use 8mm socket to remove through bolt to install temp sensor.

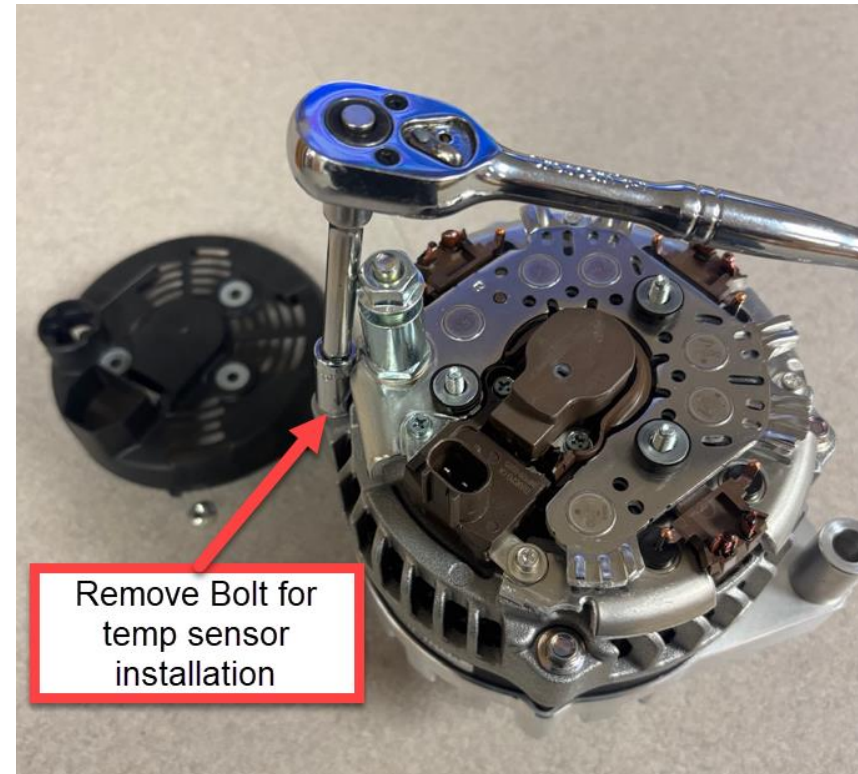

Temp Sensor Installation

Use 8mm socket to tighten through bolt for installation of temp sensor. Reinstall black plastic cover.

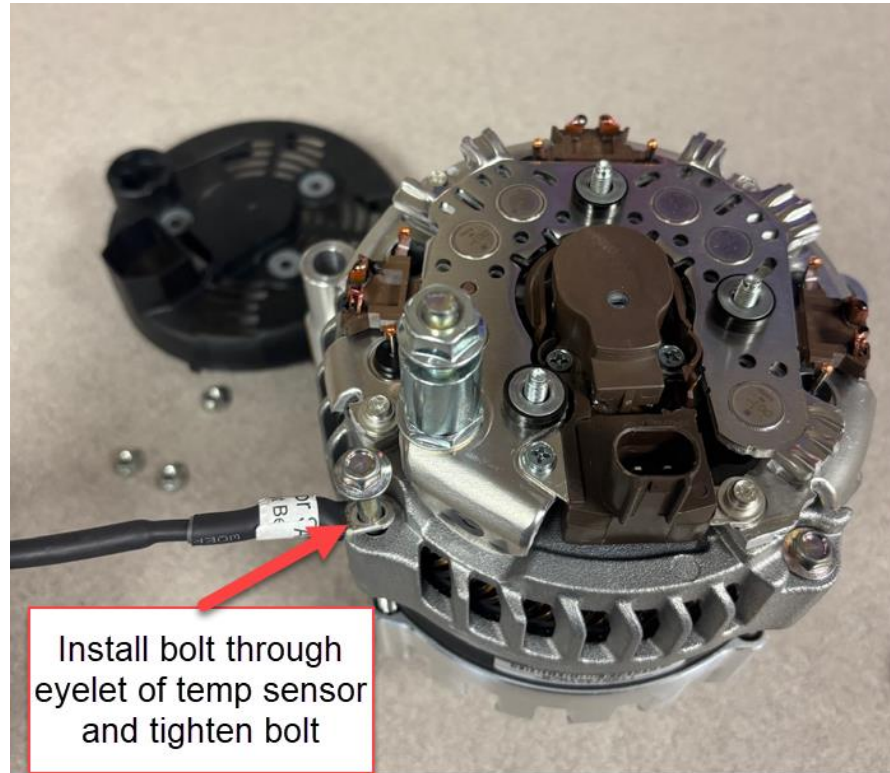

Review final install of eyelet to make sure insulation of sensor is not pinched.

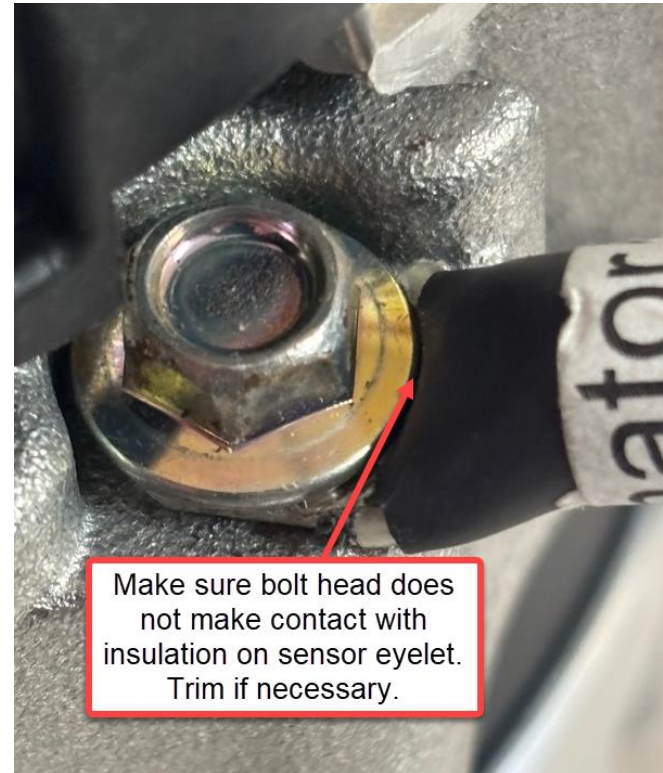

Temp Sensor Installation-Larger Eyelet

Early vendor harness the sensor is hardwired to the main harness. Left photo is larger eyelet.



Trim outside edge of eyelet to fit on alternator housing.



Final look of Temp Sensor Install



Field Flash Wire installation

Cut old field flash plug from wire loom.

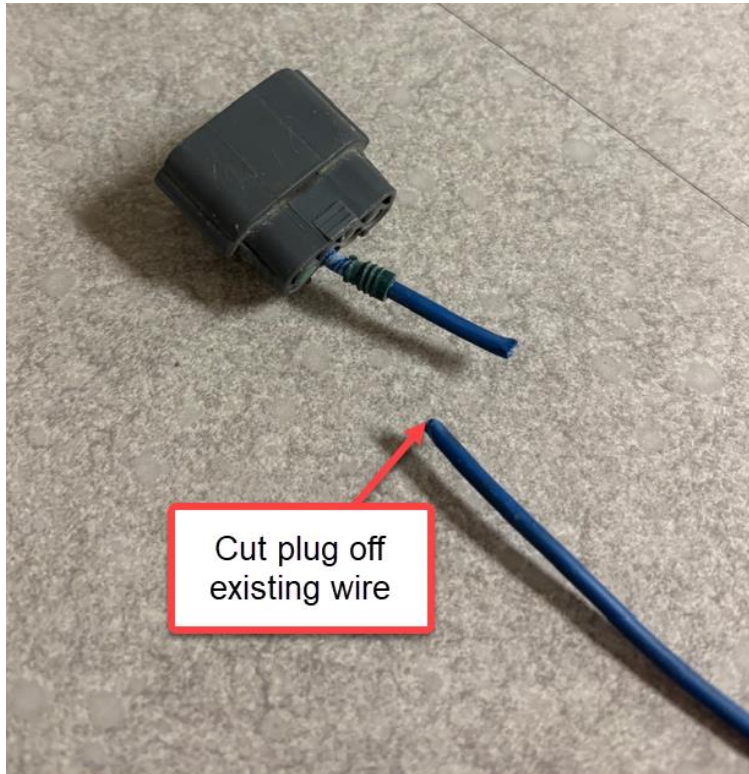

Installation of Nations field flash plug.



Alternator Attachment

Install alternator, new belt and secure positive cable using 13mm socket. **Torque 13mm cable nut to 13-15FT pounds.** Turn on battery and test system.



Start engine and open Lithionics App. Confirm current tile (circled below) has a green value. **If tile does not show correct value call Tech Service 866.653.4329.**

