

Newmar Corporation

PO Box 30
Nappanee, IN 46550



WHEN YOU KNOW THE DIFFERENCE.

TSB 620
Aug. 25, 2025

TECHNICAL SERVICE BULLETIN

AFFECTED MODELS

2025 – 2026 :: Northern Star, Ventana, Dutch Star, New Aire, Mountain Aire, London Aire, Essex, King Aire

DESCRIPTION

There is a possible condition where the exterior entrance door handle mechanism can bypass the inside linkage causing a lock-out situation whereby the door cannot be opened from the exterior.

ISSUE

The Trimark door handle should be inspected and the Trimark TSB 102 should be performed before an unintentional lockout occurs.

UNITS AFFECTED

Please refer to the attached population list for Newmar units and VINs that may be affected.

CORRECTIVE ACTION

Follow the attached Trimark TSB bulletin instructions to inspect and/or retrofit the entrance door handle. If a kit is required, purchase through Newmar Parts department. If a lockout occurs before the TSB is performed, contact your Service Account Manager for the Trimark troubleshooting guide, which should allow the customer/dealer inside the coach without permanent damage to the Trimark lockset. **Submit a picture of the door serial number with completed claim using the normal Newmar process.** Ignore the Dealer Reimbursement card at the end of the bulletin. Do not send directly to Trimark.

PARTS NEEDED

Item Description	Quantity	Newmar Part #
Kit Retrofit Rotary Latch	1	039235

FLAT RATE CODE: TSB 620 **LABOR TIME:** .33hr.

NOTE

Do not keep or redistribute/sell the lockset handle that is being removed and replaced on this bulletin, as it must be destroyed. As part of filing this claim, you are verifying the part has been destroyed and scrapped.

IMPORTANT: Please read this bulletin in its entirety prior to beginning any diagnosis or repairs.

NOTICE: Any technical information published in this bulletin is intended for use only by a qualified, Newmar-authorized service technician. Newmar is not responsible for the misuse of this information.

Technical Service Bulletin

TSB102



Purpose: There is a possible condition where the exterior entrance door handle mechanism can bypass the inside linkage causing a lock-out situation whereby the door cannot be opened from the exterior handle.

PTL Engineering Inc. Entrance Door Model 3000

TriMark Corporation 030-0900 Motor Home Entrance Door Hardware

OEMs: Newmar, Winnebago, Entegra, Tiffin, Dynamax, Forest River, Foretravel, Thor Motor Coach, Farber Specialty Vehicles and Wakarusa Coach

Models Affected: This Campaign affects certain 2025 and 2026 model motor homes that were manufactured after August 14, 2024. [See Appendix A for affected 2025 and 2026 Coaches with PTL door serial #068849 through #072552.](#)

Any questions regarding this Service or TSB instructions, please call TriMark Corporation at 1-641-394-1045.

Kit Includes:

- Technical Service Bulletin
- Reimbursement Card
- L Bracket & 2 Fasteners
- Red Vinyl Cap (provided as spare)
- Inside Handle Assembly
- 3 Torx Head Screws (provided as spare)
- Plastic Cap



Tools Required:

- Phillips 2-Bit Screwdriver
- T-20 torx driver
- Torque wrench/driver
- 5/16" standard socket (bracket)
- 2-1/2 - 3" Extender
- 7/16" deep well socket (acorn nut)
- Flat blade screwdriver or plastic flat tool

[TSB Step by Step Guide](#)



[Live Installation Video](#)



PLEASE READ INSTRUCTIONS THOROUGHLY BEFORE STARTING

Note: The information in this bulletin is intended for use only by skilled technicians who have the proper tools, equipment, and training to correctly and safely maintain the vehicle. These procedures should not be attempted by "do-it-yourselfers". You should not assume this bulletin applies to your vehicle or that your vehicle has the condition described, to determine whether this information applies, contact your authorized dealer, who has the Model, VIN and Customer Information.

Technical Service Bulletin

TSB102

Confirm your door serial number is within #068849 through #072552

Similar to the sticker shown, if your coach serial number is within the range mentioned above, please proceed to Step 1. If your coach door serial number is outside of this range, you can disregard these TSB instructions.

With the door fully open, you can locate the door serial number label on the hinge side, behind the screen door.



Step 1: Inspect the Black Plastic Plug on the door edge to see if there are holes on the top. If there are, the door hardware has already been upgraded, please disregard these TSB instructions.

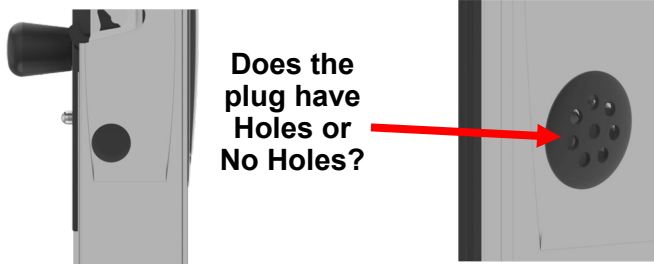

Step 4: Remove the (3) Torx Head Screws from the inside plate assembly and set aside for reuse later.

If applicable, remove the vinyl cap from the inside handle lock knob and set aside for reuse later.



Step 2: Carefully remove the Black Plastic Plug with a flat blade screwdriver or plastic flat tool.

Be careful not to scratch the door paint when removing.

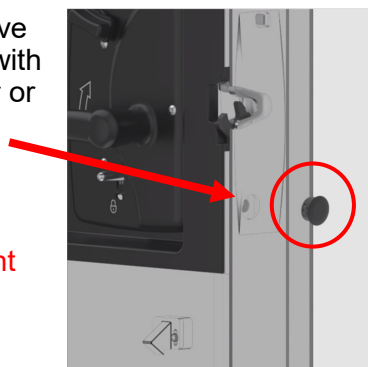

Step 3: Remove the Acorn Nut from the Connecting Rod located in the nut adjusting hole using a 7/16" deep well socket.

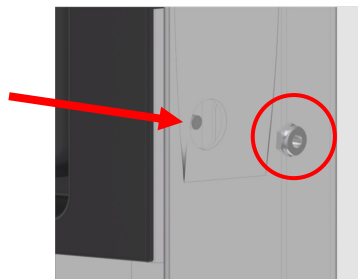

Step 5: While carefully supporting the outside assembly, remove the inside handle assembly from the door, sliding the connecting rod away from the door edge. Continue to support the outside handle through step 11e, noting it may have to shift some in order to align the two together.

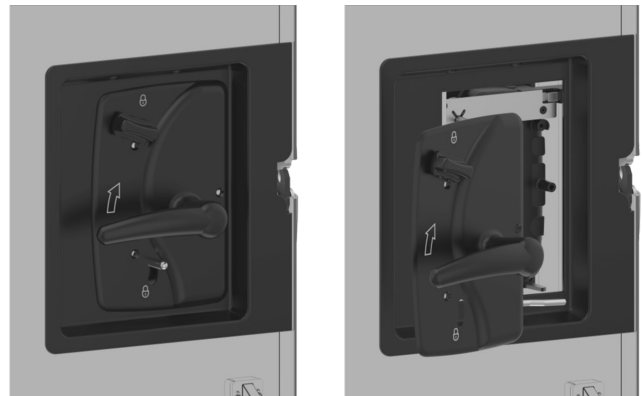

Note: The information in this bulletin is intended for use only by skilled technicians who have the proper tools, equipment, and training to correctly and safely maintain the vehicle. These procedures should not be attempted by "do-it-yourselfers". You should not assume this bulletin applies to your vehicle or that your vehicle has the condition described, to determine whether this information applies, contact your authorized dealer, who has the Model, VIN and Customer Information.

Technical Service Bulletin

TSB102

Step 6: Verify the part number stamped on the inside release as **21396** and the date code is between (32U through 52U) or (01V through 24V). If it is, continue to Step 7.

If the part number or the date code is something other than **21396** and date code is not in the range listed above, this door is not included in this campaign, follow Step 10b and reassemble the existing door hardware.



Part Number and Date Code

Inspect the end of the Connecting Rod. If there is a “-” mark on the threaded end, proceed to Step 7. If there is a “X” mark or a “-” AND a “.” on the threaded end the hardware has already been updated, skip to Step 10b and reassemble the existing door hardware. No hardware from the kit will be needed.



Viewing the rod end requires fine attention to detail

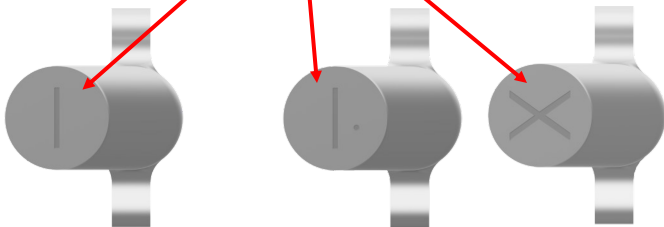

Proceed to Step 7

Skip to Step 10b

Step 7: Remove Bezel from door and set aside for later use.

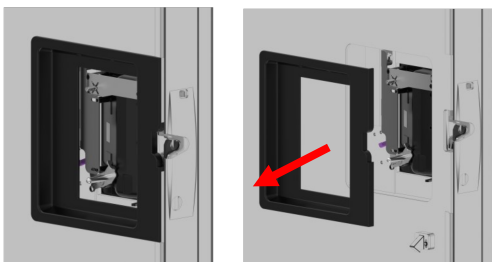

Step 8a: While supporting the outside handle, slightly shift the outside assembly out of the door about 1/2-3/4” to make room for the removal of the bracket fasteners.

Step 8b: Using a 5/16” socket with a 2 1/2 - 3” extender, remove the bracket fasteners and set aside for later use. (Two extra fasteners are provided in the event one is lost).

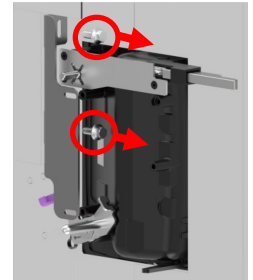

Remove old bracket.

Step 9a: Align the new bracket with the bracket mounting holes in the door and the outside assembly mounting holes, while the outside assembly is aligned with the paint lines. **This is a critical step.**

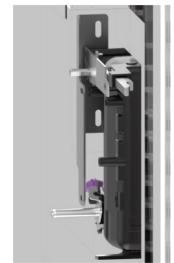

Step 9b: (Using the old bracket fasteners, unless lost, use new) Install the upper fastener first only turning 2-3 rotations. Then start the lower fastener. Once both are installed a few rotations, check paint alignment and tighten until snug.

Step 9c: Loosen but DO NOT REMOVE the (4) Phillip head screws on the power actuator plate. Slide power actuator/ plate towards the outside edge of the door. Tighten down the (4) screws.

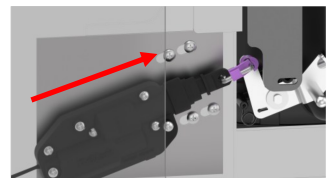

Step 10a: Remove the Acorn Nut on the new system. Replace the new inside system, carefully sliding the Connecting Rod all the way through the nut adjusting hole.

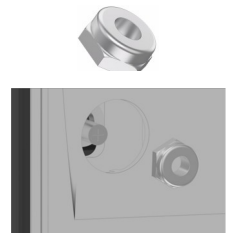

Step 10b: Reassemble the acorn nut **finger tight** to the end of the rod to ensure the rod doesn't come loose through the trip lever, (the adjustment of the nut will occur at Step 13).

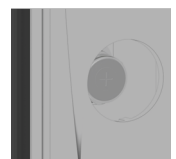

Note: The information in this bulletin is intended for use only by skilled technicians who have the proper tools, equipment, and training to correctly and safely maintain the vehicle. These procedures should not be attempted by “do-it-yourselfers”. You should not assume this bulletin applies to your vehicle or that your vehicle has the condition described, to determine whether this information applies, contact your authorized dealer, who has the Model, VIN and Customer Information.

Technical Service Bulletin

TSB102

Step 10c: Slide bezel around inside handle making sure the alignment tabs are towards the top of the door.



Step 11b: Make sure the Upper Lock Knob engages with the “D” shaped shaft on the exterior handle.

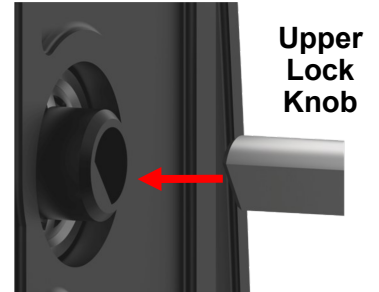

Step 11a: Lift the interior handle to make sure the system is seated properly, and the outside driving cam is behind the inside pivot plate, while pressing the inside and outside together.

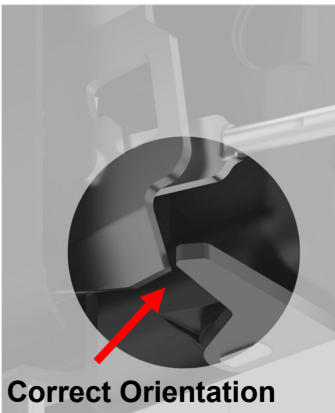

Correct Orientation



Incorrect Orientation

Step 11c: Reinstall the (3) Torx Head Screws in the order listed to make sure everything is aligned correctly. Only install the screws 2-3 rotations.

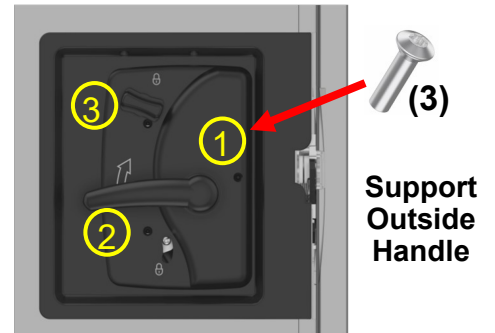

Support Outside Handle

Step 11d: Lift interior handle to ensure proper engagement.

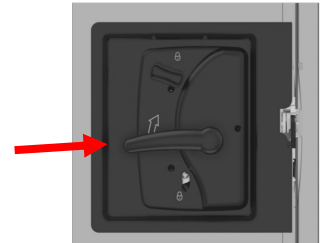

Step 11e: Once all 3 screws have been installed, then torque each screw to 13 in-lbs in the same order listed. If applicable, reinstall the vinyl cap on the inside handle lock knob.

Step 12a-d: With the door open, manually cycle the hardware from the exterior handle, inside release, and both lock knobs to ensure they function without binding.

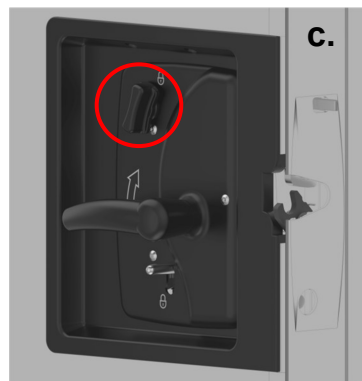
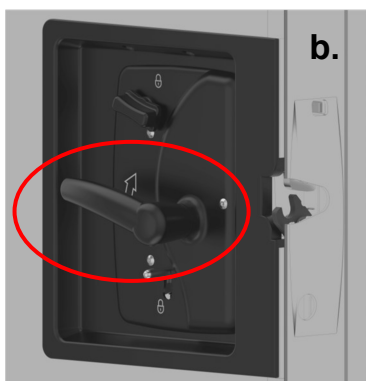
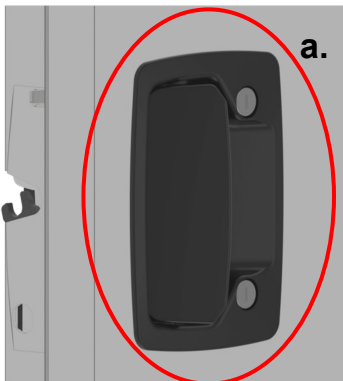

Note: The information in this bulletin is intended for use only by skilled technicians who have the proper tools, equipment, and training to correctly and safely maintain the vehicle. These procedures should not be attempted by “do-it-yourselfers”. You should not assume this bulletin applies to your vehicle or that your vehicle has the condition described, to determine whether this information applies, contact your authorized dealer, who has the Model, VIN and Customer Information.

Technical Service Bulletin

TSB102

Step 13: With the door open, begin Nut adjustment by pushing the inside Lower Lock Knob down into the locked position.

Lower Lock Knob



Step 14: Manually close the rotor of the latch while the hardware is still locked from Step 13.

Interior View

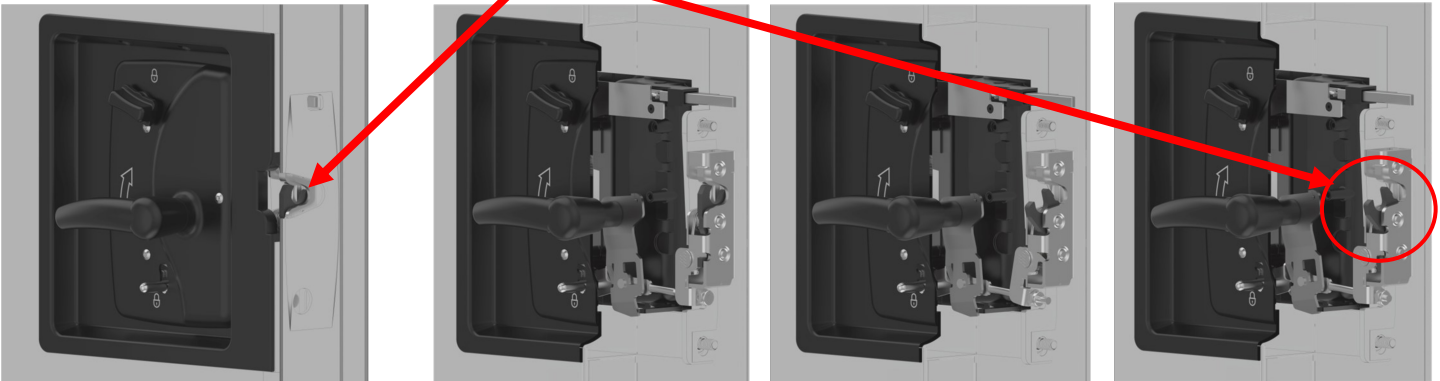

While locked, pull up on the inside handle and continue holding the inside handle up. Using a 7/16" deep well socket, manually (no power), turn the nut clockwise until the latch releases, being sure the nut is contacting the trip lever, and the nut driver is NOT contacting the trip lever. After the latch releases, let go of the inside handle and then turn the nut counterclockwise 1-1/4 to 1-1/2 turns.



Note: The information in this bulletin is intended for use only by skilled technicians who have the proper tools, equipment, and training to correctly and safely maintain the vehicle. These procedures should not be attempted by "do-it-yourselfers". You should not assume this bulletin applies to your vehicle or that your vehicle has the condition described, to determine whether this information applies, contact your authorized dealer, who has the Model, VIN and Customer Information.

Technical Service Bulletin

TSB102

Step 15a: Unlock the door.

With the door open, manually close the latch and open the latch from the inside handle. The latch should release before the inside handle reaches maximum travel.



Step 15b: With the door open, repeat this operation sequence for the outside handle. The latch should release before the outside handle reaches maximum travel.

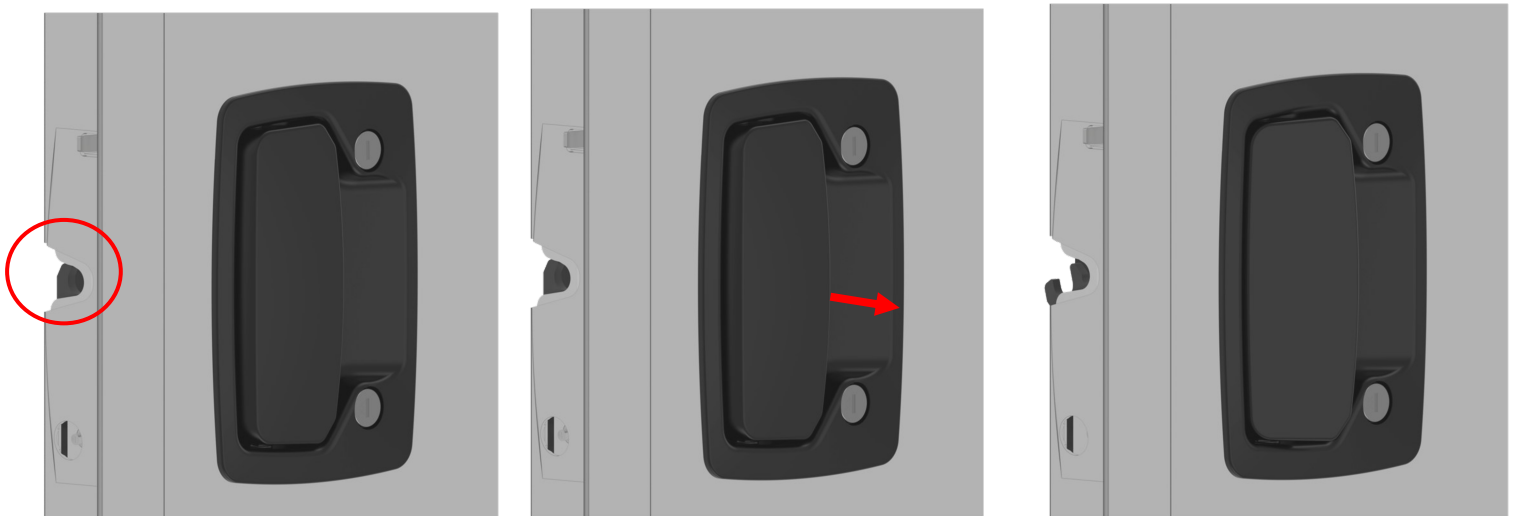

Note: The information in this bulletin is intended for use only by skilled technicians who have the proper tools, equipment, and training to correctly and safely maintain the vehicle. These procedures should not be attempted by “do-it-yourselfers”. You should not assume this bulletin applies to your vehicle or that your vehicle has the condition described, to determine whether this information applies, contact your authorized dealer, who has the Model, VIN and Customer Information.

Technical Service Bulletin

TSB102

Step 16: Similarly to the sequence in step 15, **with the door open**, manually close the latch and **lock** the Lower Lock Knob. Function the outside handle multiple times to make sure the outside handle does not open the latch. Then function the inside handle multiple times to make sure the inside handle does not open the latch.

Step 17: Install the new Black Plastic Cap with holes into the door edge provided in the kit. If the system didn't need to be replaced and you don't have a new cap, reinstall the existing cap and mark it with a silver Sharpie.



Step 19: Please dispose/scrap the Inside Handle Assembly, Bracket and Plastic Cap in accordance with local and state regulations.

Please complete the Dealer Reimbursement Card and return it to TriMark Corporation by 1) Mail or 2) handles@trimarkcorp.com

Note that **all fields are required** and **cards must be signed**.



Subject: TSB102 030-0900 TriMark Motor Home Entrance Door Hardware		Dealer Reimbursement Card	
Dealer Name: _____		City: _____	
Address: _____		State: _____ Zip: _____ Phone: _____	
Owner Name: _____		Unit Purchased at: _____	
(Dealer Name / City / State)			
Make: _____		Model Name: _____ Model No: _____	
VIN No: _____		Door Serial No: _____	
<input type="checkbox"/> Inspect, Retrofit and Reassemble		Date Code: _____ (i.e. 42U) Time Allowance = 0.33	
Shop Rate \$ _____/hour			
Service Manager: I have performed the necessary inspections, replacement and scrapping per the Retrofit Instructions TSB102 030-0900			
Name (print) _____		Signature _____	Date _____
Owner: I acknowledge that the necessary service was completed to my vehicle.			
Name (print) _____		Signature _____	Date _____

07/25-4

Any questions regarding this Service or TSB instructions, please call TriMark Corporation at 1-641-394-1045.

Step 18: Check the full functionality (opening and closing) of the entire handle assembly:

- Inside release
- Exterior release
- Inside deadbolt function with knob
- Interior lock knob
- Exterior lock with key
- Exterior deadbolt function with key and power lock with FOB and/or keypad



 **TriMark**[®]

500 Bailey Avenue
P.O. Box 350
New Hampton, IA 50659
Tel: (641) 394-3188
Fax: (641) 394-2392
www.trimarkcorp.com

TSB102
07/25-1a

Note: The information in this bulletin is intended for use only by skilled technicians who have the proper tools, equipment, and training to correctly and safely maintain the vehicle. These procedures should not be attempted by "do-it-yourselfers". You should not assume this bulletin applies to your vehicle or that your vehicle has the condition described, to determine whether this information applies, contact your authorized dealer, who has the Model, VIN and Customer Information.

Prod#	VIN Number	Year	Br	Tp	Description	Serial	Date In Production	Date Off Production
400308	4UZACHFC8SCWC9073	2025	NS	DP	PTL ENTRY/EXIT DOOR	69059	9/23/2024	10/3/2024
400317	4UZACHFC5SCWC9872	2025	NS	DP	PTL ENTRY/EXIT DOOR	69131	10/3/2024	10/23/2024
400330	4UZACHFC0SCWC6376	2025	NS	DP	PTL ENTRY/EXIT DOOR	69062	9/17/2024	10/2/2024
400332	4UZACHFC1SCWC9870	2025	NS	DP	PTL ENTRY/EXIT DOOR	68925	9/24/2024	10/14/2024
400335	4UZACHFC3SCWB9518	2025	NS	DP	PTL ENTRY/EXIT DOOR	69051	10/24/2024	11/6/2024
400339	4UZACHFC7SCVW7184	2025	NS	DP	PTL ENTRY/EXIT DOOR	69356	10/23/2024	11/6/2024
400342	4UZACHFC1SCWE9293	2025	NS	DP	PTL ENTRY/EXIT DOOR	70166	12/10/2024	12/19/2024
400343	4UZACHFC2SCWD2745	2025	NS	DP	PTL ENTRY/EXIT DOOR	69343	10/22/2024	11/4/2024
400344	4UZACHFC0TCWD4432	2026	NS	DP	PTL ENTRY/EXIT DOOR	69783	11/11/2024	11/21/2024
400345	4UZACHFC9SCWH1638	2025	NS	DP	PTL ENTRY/EXIT DOOR	70161	12/11/2024	1/8/2025
400346	4UZACHFC9SCWD4427	2025	NS	DP	PTL ENTRY/EXIT DOOR	69785	11/12/2024	11/21/2024
400347	4UZACHFC0SCWH1639	2025	NS	DP	PTL ENTRY/EXIT DOOR	70219	1/7/2025	1/16/2025
400348	4UZACHFC4SCWD2746	2025	NS	DP	PTL ENTRY/EXIT DOOR	69915	11/19/2024	12/5/2024
400349	4UZACHFC3SCWC9871	2025	NS	DP	PTL ENTRY/EXIT DOOR	70164	12/11/2024	1/7/2025
400350	4UZACHFC5SCWJ0436	2025	NS	DP	PTL ENTRY/EXIT DOOR	70448	1/30/2025	2/13/2025
400351	4UZACHFC8SCWD2748	2025	NS	DP	PTL ENTRY/EXIT DOOR	70289	1/9/2025	1/23/2025
400352	4UZACHFC3SCWJ0435	2025	NS	DP	PTL ENTRY/EXIT DOOR	70320	1/22/2025	2/3/2025
400353	4UZACHFC5TCWK1292	2025	NS	DP	PTL ENTRY/EXIT DOOR	70590	2/11/2025	2/24/2025
400354	4UZACHFC3TCWK1291	2025	NS	DP	PTL ENTRY/EXIT DOOR	70690	2/24/2025	3/6/2025
400355	4UZACHFC5TCWK1289	2025	NS	DP	PTL ENTRY/EXIT DOOR	70428	2/11/2025	2/20/2025
400356	4UZACHFC4SCWD6540	2025	NS	DP	PTL ENTRY/EXIT DOOR	70290	1/9/2025	1/22/2025
400357	4UZACHFC3TCWK3218	2025	NS	DP	PTL ENTRY/EXIT DOOR	70593	2/12/2025	2/25/2025
400358	4UZACHFC6SCWE1965	2025	NS	DP	PTL ENTRY/EXIT DOOR	70233	1/14/2025	1/28/2025
400359	4UZACHFC6SCWD2747	2025	NS	DP	PTL ENTRY/EXIT DOOR	70004	12/17/2024	1/13/2025
400360	4UZACHFC5TCWK3219	2025	NS	DP	PTL ENTRY/EXIT DOOR	70698	2/13/2025	2/25/2025
400361	4UZACHFC1TCWK1290	2025	NS	DP	PTL ENTRY/EXIT DOOR	70766	2/25/2025	3/10/2025
400362	4UZACHFC8TCWM1195	2025	NS	DP	PTL ENTRY/EXIT DOOR	70851	3/4/2025	3/13/2025
400363	4UZACHFC8SCWD6539	2025	NS	DP	PTL ENTRY/EXIT DOOR	70393	1/28/2025	2/6/2025
400364	4UZACHFC1SCWE4269	2025	NS	DP	PTL ENTRY/EXIT DOOR	70769	2/26/2025	3/10/2025
400365	4UZACHFCXTCWM3708	2026	NS	DP	PTL ENTRY/EXIT DOOR	71053	3/17/2025	3/27/2025
400366	4UZACHFC1TCWM1197	2025	NS	DP	PTL ENTRY/EXIT DOOR	70763	3/11/2025	3/20/2025
400367	4UZACHFCXTCWM1196	2026	NS	DP	PTL ENTRY/EXIT DOOR	71060	3/18/2025	3/31/2025
400368	4UZACHFCXSCWE9292	2025	NS	DP	PTL ENTRY/EXIT DOOR	71243	3/31/2025	4/10/2025
400369	4UZACHFCXTCWM6379	2026	NS	DP	PTL ENTRY/EXIT DOOR	71437	4/14/2025	4/29/2025
400371	4UZACHFC7TCWP0249	2026	NS	DP	PTL ENTRY/EXIT DOOR	71721	5/5/2025	5/16/2025
400372	4UZACHFC3TCWM6076	2026	NS	DP	PTL ENTRY/EXIT DOOR	71769	5/15/2025	5/30/2025
400373	4UZACHFC5TCWP0251	2026	NS	DP	PTL ENTRY/EXIT DOOR	71985	5/22/2025	6/5/2025
400374	4UZACHFC0TCWP2537	2026	NS	DP	PTL ENTRY/EXIT DOOR	71987	5/23/2025	6/5/2025
416438	4UZFHFE5SCWC9068	2025	VT	DP	PTL ENTRY/EXIT DOOR	69135	9/25/2024	10/15/2024
416449	4UZFHFE2SCWC6371	2025	VT	DP	PTL ENTRY/EXIT DOOR	68909	9/16/2024	9/30/2024
416450	4UZFHFE1SCWC9066	2025	VT	DP	PTL ENTRY/EXIT DOOR	68916	9/23/2024	10/3/2024
416456	4UZFHFE8SCWC7377	2025	VT	DP	PTL ENTRY/EXIT DOOR	69137	9/24/2024	10/15/2024
416463	4UZFHFE3SCWC9067	2025	VT	DP	PTL ENTRY/EXIT DOOR	68924	9/23/2024	10/14/2024
416464	4UZFHFE4SCWC6372	2025	VT	DP	PTL ENTRY/EXIT DOOR	69142	9/30/2024	10/16/2024
416467	4UZACHFE4SCWC9072	2025	VT	DP	PTL ENTRY/EXIT DOOR	68926	9/24/2024	10/14/2024
416469	4UZACHFE7SCWC6375	2025	VT	DP	PTL ENTRY/EXIT DOOR	69061	9/18/2024	10/2/2024
416470	4UZACHFE3SCWC6373	2025	VT	DP	PTL ENTRY/EXIT DOOR	68918	9/12/2024	9/30/2024
416474	4UZFHFE0SCWC6370	2025	VT	DP	PTL ENTRY/EXIT DOOR	68927	9/12/2024	9/25/2024
416478	4UZFHFE6SCWC7376	2025	VT	DP	PTL ENTRY/EXIT DOOR	69138	9/24/2024	10/15/2024
416479	4UZFHFE7SCWC9069	2025	VT	DP	PTL ENTRY/EXIT DOOR	69139	9/25/2024	10/16/2024

Prod#	VIN Number	Year	Br	Tp	Description	Serial	Date In Production	Date Off Production
416480	4UZFCHFE4SCWC9868	2025	VT	DP	PTL ENTRY/EXIT DOOR	69281	10/14/2024	10/28/2024
416481	4UZACHFE7SCWE4312	2025	VT	DP	PTL ENTRY/EXIT DOOR	69881	11/18/2024	12/4/2024
416482	4UZACHFE2SCWC9071	2025	VT	DP	PTL ENTRY/EXIT DOOR	69146	10/2/2024	10/22/2024
416483	4VZAT1D12SC095875	2025	VT	DP	PTL ENTRY/EXIT DOOR	69912	11/20/2024	12/9/2024
416484	4UZFCHFE4SCWD2754	2025	VT	DP	PTL ENTRY/EXIT DOOR	69324	10/23/2024	11/11/2024
416485	4UZFCHFEXSCWC7378	2025	VT	DP	PTL ENTRY/EXIT DOOR	69364	10/16/2024	10/30/2024
416486	4VZAT1D11SC095768	2025	VT	DP	PTL ENTRY/EXIT DOOR	69649	10/28/2024	11/11/2024
416489	4UZFCHFE4SCWD4424	2025	VT	DP	PTL ENTRY/EXIT DOOR	69639	10/30/2024	11/14/2024
416490	4UZFCHFE3SCWC9070	2025	VT	DP	PTL ENTRY/EXIT DOOR	69792	11/6/2024	11/20/2024
416491	4UZACHFE7TCWD4431	2026	VT	DP	PTL ENTRY/EXIT DOOR	69914	11/13/2024	12/2/2024
416492	4UZACHFE4SCWD6538	2025	VT	DP	PTL ENTRY/EXIT DOOR	70085	12/9/2024	12/19/2024
416493	4UZACHFEXTCWK1287	2025	VT	DP	PTL ENTRY/EXIT DOOR	70601	2/6/2025	2/20/2025
416494	4VZAT1D11RC095568	2025	VT	DP	PTL ENTRY/EXIT DOOR	70174	12/16/2024	1/10/2025
416495	4UZFCHFE6SCWD4425	2025	VT	DP	PTL ENTRY/EXIT DOOR	70173	12/16/2024	1/10/2025
416496	4UZFCHFEXSCWD6534	2025	VT	DP	PTL ENTRY/EXIT DOOR	70003	12/18/2024	1/14/2025
416497	4UZACHFE6TCWK3215	2025	VT	DP	PTL ENTRY/EXIT DOOR	70594	2/12/2025	2/25/2025
416498	4UZACHFEXTCWK3217	2025	VT	DP	PTL ENTRY/EXIT DOOR	70688	2/20/2025	3/4/2025
416499	4UZACHFE1TCWK1288	2025	VT	DP	PTL ENTRY/EXIT DOOR	70592	2/11/2025	2/24/2025
416500	4UZACHFE8TCWK3216	2025	VT	DP	PTL ENTRY/EXIT DOOR	70694	2/13/2025	2/26/2025
416501	4UZFCHFE0SCWD9345	2025	VT	DP	PTL ENTRY/EXIT DOOR	70285	1/8/2025	1/22/2025
416502	4UZFCHFE1SCWD6535	2025	VT	DP	PTL ENTRY/EXIT DOOR	70282	1/14/2025	1/28/2025
416503	4UZFCHFE9SCWE9291	2025	VT	DP	PTL ENTRY/EXIT DOOR	70322	1/16/2025	1/29/2025
416504	4UZFCHFE9SCWD9344	2025	VT	DP	PTL ENTRY/EXIT DOOR	70388	1/21/2025	2/3/2025
416505	4UZFCHFE3SCWD6536	2025	VT	DP	PTL ENTRY/EXIT DOOR	70287	1/13/2025	1/27/2025
416506	4UZACHFE0TCWJ7166	2025	VT	DP	PTL ENTRY/EXIT DOOR	70433	2/5/2025	2/19/2025
416507	4UZFCHFE8SCWD4426	2025	VT	DP	PTL ENTRY/EXIT DOOR	70321	1/22/2025	2/3/2025
416508	4UZACHFE2SCWE1964	2025	VT	DP	PTL ENTRY/EXIT DOOR	70323	1/27/2025	2/5/2025
416509	4UZACHFE7TCWM4395	2025	VT	DP	PTL ENTRY/EXIT DOOR	71053	3/13/2025	3/26/2025
416510	4UZFCHFE9SCWE6990	2025	VT	DP	PTL ENTRY/EXIT DOOR	70317	1/29/2025	2/11/2025
416511	4UZACHFE6TCWM6378	2025	VT	DP	PTL ENTRY/EXIT DOOR	71155	3/25/2025	4/9/2025
416512	4UZFCHFE9SCWF9299	2025	VT	DP	PTL ENTRY/EXIT DOOR	70446	2/3/2025	2/17/2025
416513	4UZACHFE4TCWM6377	2025	VT	DP	PTL ENTRY/EXIT DOOR	71141	3/26/2025	4/9/2025
416514	4UZFCHFE0SCWE6991	2025	VT	DP	PTL ENTRY/EXIT DOOR	70695	2/17/2025	2/26/2025
416515	4UZACHFE9TCWJ7165	2025	VT	DP	PTL ENTRY/EXIT DOOR	70697	2/17/2025	2/27/2025
416516	4UZACHFE7TCWJ7164	2025	VT	DP	PTL ENTRY/EXIT DOOR	70397	2/19/2025	3/3/2025
416517	4UZACHFEXTCWM6075	2026	VT	DP	PTL ENTRY/EXIT DOOR	71159	3/24/2025	4/2/2025
416518	4UZFCHFE7SCWD9343	2025	VT	DP	PTL ENTRY/EXIT DOOR	70964	3/6/2025	3/18/2025
416520	4UZFCHFE3TCWM6375	2026	VT	DP	PTL ENTRY/EXIT DOOR	71376	4/3/2025	4/16/2025
416521	4UZACHFE2TCWN6244	2026	VT	DP	PTL ENTRY/EXIT DOOR	71586	4/24/2025	5/7/2025
416522	4UZFCHFE1SCWF9300	2025	VT	DP	PTL ENTRY/EXIT DOOR	70958	3/10/2025	3/19/2025
416523	4UZACHFE2TCWM6376	2025	VT	DP	PTL ENTRY/EXIT DOOR	71142	3/27/2025	4/9/2025
416524	4UZFCHFE6SCWC9869	2026	VT	DP	PTL ENTRY/EXIT DOOR	71059	3/18/2025	3/31/2025
416525	4UZACHFE4TCWN6245	2026	VT	DP	PTL ENTRY/EXIT DOOR	71384	4/17/2025	5/5/2025
416527	4UZACHFE7TCWP5291	2026	VT	DP	PTL ENTRY/EXIT DOOR	71763	5/12/2025	5/22/2025
416528	4UZACHFE7TCWP2536	2026	VT	DP	PTL ENTRY/EXIT DOOR	71715	5/6/2025	5/19/2025
416530	4VZAT1D18SC095783	2026	VT	DP	PTL ENTRY/EXIT DOOR	71380	4/7/2025	4/22/2025
416531	4UZFCHFE0SCWE4268	2026	VT	DP	PTL ENTRY/EXIT DOOR	71491	4/17/2025	5/2/2025
416532	4UZFCHFE5SCWF9297	2026	VT	DP	PTL ENTRY/EXIT DOOR	71712	5/6/2025	5/16/2025
416539	4UZFCHFE7SCWF9298	2026	VT	DP	PTL ENTRY/EXIT DOOR	71711	5/13/2025	5/22/2025
416544	4UZFCHFE0SCWE9289	2026	VT	DP	PTL ENTRY/EXIT DOOR	71585	5/1/2025	5/15/2025

Prod#	VIN Number	Year	Br	Tp	Description	Serial	Date In Production	Date Off Production
416549	4UZFCHFE7TCWM3706	2026	VT	DP	PTL ENTRY/EXIT DOOR	71718	5/13/2025	5/23/2025
416550	4UZFCHFE0TCWM6074	2026	VT	DP	PTL ENTRY/EXIT DOOR	71720	5/14/2025	5/28/2025
502218	4UZFCFTG8SCWD0221	2025	LA	DP	PTL ENTRY/EXIT DOOR	69127	9/25/2024	10/16/2024
502221	4UZFCFTG8SCWE0098	2025	LA	DP	PTL ENTRY/EXIT DOOR	69641	11/4/2024	11/18/2024
502223	4UZFCFTG2SCWD3535	2025	LA	DP	PTL ENTRY/EXIT DOOR	69268	10/14/2024	10/28/2024
502224	4UZFCFTG7SCWC9142	2025	LA	DP	PTL ENTRY/EXIT DOOR	69038	9/23/2024	10/3/2024
502225	4UZFCFTGXSCWD0222	2025	LA	DP	PTL ENTRY/EXIT DOOR	69148	10/2/2024	10/23/2024
502227	4UZFCFTG9SCWD3533	2025	LA	DP	PTL ENTRY/EXIT DOOR	69278	10/14/2024	10/24/2024
502228	4VZVU1R19SC095850	2025	LA	DP	PTL ENTRY/EXIT DOOR	69054	10/15/2024	10/29/2024
502229	4UZFCFTG0SCWD3534	2025	LA	DP	PTL ENTRY/EXIT DOOR	69297	10/3/2024	10/24/2024
502230	4UZFCFTG4SCWD3536	2025	LA	DP	PTL ENTRY/EXIT DOOR	69361	10/16/2024	10/30/2024
502231	4UZFCFTG6SCWF9281	2025	LA	DP	PTL ENTRY/EXIT DOOR	69993	11/14/2024	12/10/2024
502233	4UZFCFTG4SCWD4458	2025	LA	DP	PTL ENTRY/EXIT DOOR	69352	10/22/2024	11/5/2024
502234	4UZFCFTG2SCWE9282	2025	LA	DP	PTL ENTRY/EXIT DOOR	70177	12/11/2024	1/8/2025
502237	4UZFCFTG2TCWD4461	2026	LA	DP	PTL ENTRY/EXIT DOOR	69522	10/28/2024	11/11/2024
502238	4VZVU1R17SC095880	2025	LA	DP	PTL ENTRY/EXIT DOOR	70135	12/4/2024	12/17/2024
502239	4UZFCFTG9SCWD6531	2025	LA	DP	PTL ENTRY/EXIT DOOR	69645	11/5/2024	11/19/2024
502240	4VZVU1R10SC095879	2025	LA	DP	PTL ENTRY/EXIT DOOR	69996	11/21/2024	12/11/2024
502241	4VZVU1R15SC095876	2025	LA	DP	PTL ENTRY/EXIT DOOR	69911	11/20/2024	12/9/2024
502242	4UZFCFTG6SCWE2318	2025	LA	DP	PTL ENTRY/EXIT DOOR	69646	11/12/2024	11/21/2024
502244	4VZVU1R17SC095894	2025	LA	DP	PTL ENTRY/EXIT DOOR	70087	12/16/2024	1/9/2025
502245	4UZFCFTG2SCWE0100	2025	LA	DP	PTL ENTRY/EXIT DOOR	70167	12/9/2024	12/19/2024
502247	4VZVU1R19SC095914	2025	LA	DP	PTL ENTRY/EXIT DOOR	70008	12/17/2024	1/13/2025
502249	4UZFCFTG4SCWG3409	2025	LA	DP	PTL ENTRY/EXIT DOOR	70123	12/18/2024	1/14/2025
502250	4VZVU1R13SC095956	2025	LA	DP	PTL ENTRY/EXIT DOOR	70757	2/26/2025	3/11/2025
502251	4VZVU1R10SC095915	2025	LA	DP	PTL ENTRY/EXIT DOOR	70389	1/22/2025	2/3/2025
502252	4UZFCFTG2SCWE9279	2025	LA	DP	PTL ENTRY/EXIT DOOR	70387	1/21/2025	1/30/2025
502253	4UZFCFTG4SCWE9283	2025	LA	DP	PTL ENTRY/EXIT DOOR	70445	2/3/2025	2/17/2025
502254	4UZFCFTG4SCWF9280	2025	LA	DP	PTL ENTRY/EXIT DOOR	70596	2/18/2025	3/3/2025
502255	4UZFCFTG0SCWG3407	2025	LA	DP	PTL ENTRY/EXIT DOOR	70591	2/11/2025	2/24/2025
502256	4UZFCFTG3SCWH6328	2025	LA	DP	PTL ENTRY/EXIT DOOR	70689	2/24/2025	3/5/2025
502258	4UZFCFTG0SCWD6823	2026	LA	DP	PTL ENTRY/EXIT DOOR	71058	3/18/2025	3/31/2025
502259	4UZFCFTG9SCWE4306	2026	LA	DP	PTL ENTRY/EXIT DOOR	71052	3/19/2025	4/1/2025
502260	4UZFCFTG2SCWG3408	2025	LA	DP	PTL ENTRY/EXIT DOOR	70853	3/5/2025	3/17/2025
502261	4VZVU1R1XSC095985	2025	LA	DP	PTL ENTRY/EXIT DOOR	71377	4/3/2025	4/17/2025
502262	4VZVU1R19SC095945	2025	LA	DP	PTL ENTRY/EXIT DOOR	71049	3/13/2025	3/26/2025
502263	4UZFCFTG7SCWE4305	2025	LA	DP	PTL ENTRY/EXIT DOOR	70954	3/12/2025	3/25/2025
502264	4UZFCFTG4TCWK1277	2026	LA	DP	PTL ENTRY/EXIT DOOR	71253	4/2/2025	4/15/2025
502265	4UZFCFTG5SCWJ1923	2026	LA	DP	PTL ENTRY/EXIT DOOR	71443	4/10/2025	4/25/2025
502266	4UZFCFTG1TCWN6147	2026	LA	DP	PTL ENTRY/EXIT DOOR	71445	4/14/2025	4/29/2025
502267	4VZVU1R12TC095979	2026	LA	DP	PTL ENTRY/EXIT DOOR	71439	4/15/2025	4/30/2025
502268	4UZFCFTG2TCWM6372	2025	LA	DP	PTL ENTRY/EXIT DOOR	71379	4/7/2025	4/22/2025
502269	4VZVU1R18TC095971	2026	LA	DP	PTL ENTRY/EXIT DOOR	71251	4/2/2025	4/16/2025
502270	4VZVU1R16TC095970	2026	LA	DP	PTL ENTRY/EXIT DOOR	70847	3/24/2025	4/3/2025
502271	4UZFCFTG6TCWK1278	2025	LA	DP	PTL ENTRY/EXIT DOOR	71245	3/31/2025	4/11/2025
502272	4UZFCFTG8TCWM6067	2025	LA	DP	PTL ENTRY/EXIT DOOR	71149	4/8/2025	4/23/2025
502273	4UZFCFTG5TCWN6149	2026	LA	DP	PTL ENTRY/EXIT DOOR	71382	4/9/2025	4/24/2025
502274	4UZFCFTGXTCWM6068	2026	LA	DP	PTL ENTRY/EXIT DOOR	71441	4/15/2025	5/1/2025
502275	4VZVU1R19TC095994	2026	LA	DP	PTL ENTRY/EXIT DOOR	71495	4/28/2025	5/8/2025
502276	4UZFCFTG3SCWE4429	2026	LA	DP	PTL ENTRY/EXIT DOOR	71584	5/1/2025	5/15/2025

Prod#	VIN Number	Year	Br	Tp	Description	Serial	Date In Production	Date Off Production
502279	4UZFCFG7TCWN6234	2026	LA	DP	PTL ENTRY/EXIT DOOR	71759	5/8/2025	5/21/2025
530816	4VZVU1R12SC095821	2025	KG	DB	PTL ENTRY/EXIT DOOR	68940	9/17/2024	10/2/2024
530821	4VZVU1R12SC095799	2025	KG	DB	PTL ENTRY/EXIT DOOR	69000	9/5/2024	9/18/2024
530823	4VZVU1R19SC095802	2025	KG	DB	PTL ENTRY/EXIT DOOR	68914	9/12/2024	9/30/2024
530824	4VZVU1R14SC095822	2025	KG	DB	PTL ENTRY/EXIT DOOR	69227	9/25/2024	10/15/2024
530825	4VZVU1R16SC095823	2025	KG	DB	PTL ENTRY/EXIT DOOR	69092	10/3/2024	10/23/2024
530826	4VZVU1R13SC095830	2025	KG	DB	PTL ENTRY/EXIT DOOR	69429	11/5/2024	11/21/2024
530827	4VZVU1R12SC095852	2025	KG	DB	PTL ENTRY/EXIT DOOR	69761	11/11/2024	11/20/2024
530828	4VZVU1R10SC095901	2025	KG	DB	PTL ENTRY/EXIT DOOR	70103	12/19/2024	1/15/2025
530830	4VZVU1R14TC095840	2026	KG	DB	PTL ENTRY/EXIT DOOR	69803	12/9/2024	12/18/2024
530831	4VZVU1R14SC095853	2025	KG	DB	PTL ENTRY/EXIT DOOR	69881	11/14/2024	12/4/2024
530832	4VZVU1R19SC095878	2025	KG	DB	PTL ENTRY/EXIT DOOR	70262	1/9/2025	1/22/2025
530833	4VZVU1R15SC095926	2025	KG	DB	PTL ENTRY/EXIT DOOR	70543	1/29/2025	2/11/2025
530834	4VZVU1R10SC095896	2025	KG	DB	PTL ENTRY/EXIT DOOR	70772	3/3/2025	3/24/2025
530835	4VZVU1R15TC095944	2026	KG	DB	PTL ENTRY/EXIT DOOR	70871	3/6/2025	3/18/2025
611620	4UZFCHFE7SCWC7368	2025	DS	DP	PTL ENTRY/EXIT DOOR	69053	9/24/2024	10/15/2024
611635	4VZAU1D10SC095838	2025	DS	DP	PTL ENTRY/EXIT DOOR	69997	11/21/2024	12/11/2024
611662	4UZFCHFE0SCWC7373	2025	DS	DP	PTL ENTRY/EXIT DOOR	68913	9/16/2024	10/1/2024
611667	4UZFCHFE2SCWC6368	2025	DS	DP	PTL ENTRY/EXIT DOOR	68917	9/23/2024	10/14/2024
611674	4UZFCHFE5SCWC6364	2025	DS	DP	PTL ENTRY/EXIT DOOR	69060	9/18/2024	10/2/2024
611677	4UZFCHFE2SCWC7374	2025	DS	DP	PTL ENTRY/EXIT DOOR	69665	10/21/2024	10/30/2024
611679	4UZFCHFE2SCWD6530	2025	DS	DP	PTL ENTRY/EXIT DOOR	69338	10/21/2024	11/4/2024
611684	4UZFCHFEXSCWB6686	2025	DS	DP	PTL ENTRY/EXIT DOOR	69271	10/15/2024	10/29/2024
611687	4UZACHFE6SCWE4267	2025	DS	DP	PTL ENTRY/EXIT DOOR	69880	11/14/2024	12/3/2024
611688	4UZFCHFE1SCWD2775	2025	DS	DP	PTL ENTRY/EXIT DOOR	69052	10/16/2024	10/29/2024
611695	4UZFCHFE2SCWC9867	2025	DS	DP	PTL ENTRY/EXIT DOOR	69136	10/3/2024	10/23/2024
611696	4UZFCHFE0SCWD2802	2025	DS	DP	PTL ENTRY/EXIT DOOR	69130	10/1/2024	10/21/2024
611697	4UZACHFE1SCWC7375	2025	DS	DP	PTL ENTRY/EXIT DOOR	69055	9/18/2024	10/2/2024
611703	4UZFCHFE9SCWC7372	2025	DS	DP	PTL ENTRY/EXIT DOOR	69140	9/25/2024	10/16/2024
611708	4UZFCHFE8SCWC9064	2025	DS	DP	PTL ENTRY/EXIT DOOR	69275	9/30/2024	10/24/2024
611709	4VZAU1D1XSC095846	2025	DS	DP	PTL ENTRY/EXIT DOOR	69274	10/14/2024	10/24/2024
611710	4UZFCHFE5SCWC7367	2025	DS	DP	PTL ENTRY/EXIT DOOR	68935	9/12/2024	9/30/2024
611711	4VZAU1D15SC095849	2025	DS	DP	PTL ENTRY/EXIT DOOR	69279	10/14/2024	10/28/2024
611712	4UZFCHFE7SCWC7371	2025	DS	DP	PTL ENTRY/EXIT DOOR	68911	9/17/2024	10/1/2024
611714	4VZAU1D1XSC095829	2025	DS	DP	PTL ENTRY/EXIT DOOR	69063	9/17/2024	10/2/2024
611715	4UZFCHFE9SCWC9056	2025	DS	DP	PTL ENTRY/EXIT DOOR	68912	9/16/2024	10/1/2024
611716	4UZFCHFE2SCWD2803	2025	DS	DP	PTL ENTRY/EXIT DOOR	69132	10/1/2024	10/23/2024
611717	4UZFCHFE6SCWC9855	2025	DS	DP	PTL ENTRY/EXIT DOOR	69270	10/15/2024	10/28/2024
611719	4UZFCHFE7SCWD2800	2025	DS	DP	PTL ENTRY/EXIT DOOR	69273	10/2/2024	10/24/2024
611720	4UZACHFE7SCWB0662	2025	DS	DP	PTL ENTRY/EXIT DOOR	69143	9/30/2024	10/21/2024
611721	4UZFCHFE0SCWC9057	2025	DS	DP	PTL ENTRY/EXIT DOOR	69147	10/2/2024	10/22/2024
611722	4UZFCHFE2SCWC9058	2025	DS	DP	PTL ENTRY/EXIT DOOR	69362	10/16/2024	10/29/2024
611724	4UZFCHFE8SCWC9856	2025	DS	DP	PTL ENTRY/EXIT DOOR	69282	10/14/2024	10/28/2024
611725	4UZFCHFE4SCWC9854	2025	DS	DP	PTL ENTRY/EXIT DOOR	69345	10/23/2024	11/5/2024
611726	4UZFCHFE2SCWD4423	2025	DS	DP	PTL ENTRY/EXIT DOOR	69353	10/21/2024	11/4/2024
611727	4UZFCHFE4SCWC9059	2025	DS	DP	PTL ENTRY/EXIT DOOR	69342	10/22/2024	11/5/2024
611728	4UZFCHFE4SCWD2799	2025	DS	DP	PTL ENTRY/EXIT DOOR	69788	11/6/2024	11/19/2024
611729	4UZFCHFE2SCWD2798	2025	DS	DP	PTL ENTRY/EXIT DOOR	69530	10/30/2024	11/13/2024
611730	4UZFCHFE3SCWC9859	2025	DS	DP	PTL ENTRY/EXIT DOOR	69326	10/29/2024	11/12/2024
611731	4UZACHFE9SCWB0663	2025	DS	DP	PTL ENTRY/EXIT DOOR	69675	10/24/2024	11/11/2024

Prod#	VIN Number	Year	Br	Tp	Description	Serial	Date In Production	Date Off Production
611732	4UZFCHFE9SCWD4418	2025	DS	DP	PTL ENTRY/EXIT DOOR	69647	11/11/2024	11/20/2024
611733	4UZFCHFE1SCWC9858	2025	DS	DP	PTL ENTRY/EXIT DOOR	69527	10/28/2024	11/12/2024
611734	4UZFCHFE7SCWD4417	2025	DS	DP	PTL ENTRY/EXIT DOOR	69638	10/30/2024	11/14/2024
611736	4UZFCHFEXSCWC9860	2025	DS	DP	PTL ENTRY/EXIT DOOR	69357	10/24/2024	11/6/2024
611737	4UZFCHFE0SCWD2797	2025	DS	DP	PTL ENTRY/EXIT DOOR	69528	10/29/2024	11/13/2024
611738	4UZACHFE6SCWE9288	2025	DS	DP	PTL ENTRY/EXIT DOOR	69882	11/18/2024	12/4/2024
611739	4VZAU1D11SC095900	2025	DS	DP	PTL ENTRY/EXIT DOOR	70084	12/12/2024	1/8/2025
611741	4UZFCHFEXSCWC9857	2025	DS	DP	PTL ENTRY/EXIT DOOR	69640	11/4/2024	11/14/2024
611742	4VZAU1D12TC095843	2026	DS	DP	PTL ENTRY/EXIT DOOR	69644	11/5/2024	11/18/2024
611743	4UZFCHFE0SCWD4419	2025	DS	DP	PTL ENTRY/EXIT DOOR	69786	11/11/2024	11/21/2024
611744	4UZFCHFE6SCWD2755	2025	DS	DP	PTL ENTRY/EXIT DOOR	69794	11/6/2024	11/20/2024
611745	4UZFCHFE1SCWE9284	2025	DS	DP	PTL ENTRY/EXIT DOOR	69909	11/18/2024	12/5/2024
611746	4UZFCHFEXSCWE4309	2025	DS	DP	PTL ENTRY/EXIT DOOR	69642	11/4/2024	11/18/2024
611747	4UZFCHFE7SCWE0122	2025	DS	DP	PTL ENTRY/EXIT DOOR	70000	12/2/2024	12/12/2024
611750	4UZFCHFE7SCWD4420	2025	DS	DP	PTL ENTRY/EXIT DOOR	69913	11/13/2024	12/3/2024
611751	4UZFCHFE6SCWD6529	2025	DS	DP	PTL ENTRY/EXIT DOOR	70165	12/10/2024	1/7/2025
611752	4UZFCHFE0SCWF9286	2025	DS	DP	PTL ENTRY/EXIT DOOR	70083	12/9/2024	12/19/2024
611754	4UZFCHFEXSCWD2757	2025	DS	DP	PTL ENTRY/EXIT DOOR	69995	11/20/2024	12/10/2024
611755	4UZFCHFE0SCWD4422	2025	DS	DP	PTL ENTRY/EXIT DOOR	69998	11/21/2024	12/11/2024
611756	4UZFCHFE8SCWD2756	2025	DS	DP	PTL ENTRY/EXIT DOOR	69647	11/12/2024	12/2/2024
611758	4UZFCHFE7SCWE4266	2025	DS	DP	PTL ENTRY/EXIT DOOR	70082	12/5/2024	12/18/2024
611759	4UZFCHFE3SCWE9285	2025	DS	DP	PTL ENTRY/EXIT DOOR	70079	12/5/2024	12/17/2024
611761	4VZAU1D1XSC095930	2025	DS	DP	PTL ENTRY/EXIT DOOR	70434	1/29/2025	2/12/2025
611762	4UZFCHFE2SCWF9287	2025	DS	DP	PTL ENTRY/EXIT DOOR	70163	12/11/2024	1/7/2025
611764	4UZFCHFE6SCWE4310	2025	DS	DP	PTL ENTRY/EXIT DOOR	70168	12/9/2024	12/18/2024
611765	4UZFCHFE6SCWF9289	2025	DS	DP	PTL ENTRY/EXIT DOOR	70086	12/12/2024	1/9/2025
611766	4UZACHFE5TCWJ7163	2025	DS	DP	PTL ENTRY/EXIT DOOR	70435	2/5/2025	2/19/2025
611769	4UZFCHFE1SCWD9337	2025	DS	DP	PTL ENTRY/EXIT DOOR	70090	12/17/2024	1/13/2025
611770	4UZFCHFE1SCWE1962	2025	DS	DP	PTL ENTRY/EXIT DOOR	70283	1/15/2025	1/29/2025
611771	4UZACHFE8SCWH6329	2025	DS	DP	PTL ENTRY/EXIT DOOR	70386	1/16/2025	1/30/2025
611772	4UZFCHFE1SCWG3413	2025	DS	DP	PTL ENTRY/EXIT DOOR	70288	1/13/2025	1/24/2025
611773	4UZFCHFEXSCWE1961	2025	DS	DP	PTL ENTRY/EXIT DOOR	70279	1/14/2025	1/28/2025
611774	4VZAU1D15SC095947	2025	DS	DP	PTL ENTRY/EXIT DOOR	70765	2/20/2025	3/5/2025
611775	4UZFCHFE5SCWD9339	2025	DS	DP	PTL ENTRY/EXIT DOOR	70385	1/16/2025	1/30/2025
611776	4UZFCHFE3SCWD9338	2025	DS	DP	PTL ENTRY/EXIT DOOR	70284	1/15/2025	1/28/2025
611778	4UZFCHFE3SCWE1963	2025	DS	DP	PTL ENTRY/EXIT DOOR	70486	1/30/2025	2/13/2025
611779	4UZFCHFE7TCWJ7154	2025	DS	DP	PTL ENTRY/EXIT DOOR	70437	2/6/2025	2/20/2025
611780	4UZFCHFE3SCWG3414	2025	DS	DP	PTL ENTRY/EXIT DOOR	70319	1/23/2025	2/4/2025
611781	4VZAU1D1XSC095958	2025	DS	DP	PTL ENTRY/EXIT DOOR	70959	3/4/2025	3/20/2025
611782	4UZFCHFE8SCWD6533	2025	DS	DP	PTL ENTRY/EXIT DOOR	70392	1/28/2025	2/6/2025
611783	4UZFCHFE0SCWH6332	2025	DS	DP	PTL ENTRY/EXIT DOOR	70429	2/4/2025	2/18/2025
611785	4UZFCHFE1SCWD9340	2025	DS	DP	PTL ENTRY/EXIT DOOR	70486	1/30/2025	2/13/2025
611786	4UZFCHFE7SCWE9287	2025	DS	DP	PTL ENTRY/EXIT DOOR	70443	2/3/2025	2/17/2025
611787	4UZFCHFE0SCWE6988	2025	DS	DP	PTL ENTRY/EXIT DOOR	70430	2/4/2025	2/18/2025
611788	4UZFCHFE7SCWE6986	2025	DS	DP	PTL ENTRY/EXIT DOOR	70432	2/5/2025	2/19/2025
611791	4UZFCHFE2SCWE6989	2025	DS	DP	PTL ENTRY/EXIT DOOR	70692	2/25/2025	3/6/2025
611792	4UZFCHFE9SCWH6331	2025	DS	DP	PTL ENTRY/EXIT DOOR	70595	2/17/2025	2/27/2025
611793	4UZFCHFE9SCWE6987	2025	DS	DP	PTL ENTRY/EXIT DOOR	70600	2/19/2025	3/4/2025
611794	4UZFCHFE9TCWK1285	2026	DS	DP	PTL ENTRY/EXIT DOOR	70848	3/19/2025	4/3/2025
611795	4UZFCHFE7TCWK3214	2025	DS	DP	PTL ENTRY/EXIT DOOR	70768	2/26/2025	3/10/2025

Prod#	VIN Number	Year	Br	Tp	Description	Serial	Date In Production	Date Off Production
611796	4UZFCHFE2SCWJ0465	2025	DS	DP	PTL ENTRY/EXIT DOOR	70691	2/24/2025	3/6/2025
611797	4UZFCHFE4SCWJ0466	2025	DS	DP	PTL ENTRY/EXIT DOOR	70855	2/27/2025	3/12/2025
611798	4UZFCHFE8SCWE9265	2025	DS	DP	PTL ENTRY/EXIT DOOR	70760	2/26/2025	3/11/2025
611799	4UZFCHFE9SCWD4421	2025	DS	DP	PTL ENTRY/EXIT DOOR	70965	3/3/2025	3/19/2025
611800	4UZFCHFE7SCWH6330	2025	DS	DP	PTL ENTRY/EXIT DOOR	71054	3/17/2025	3/27/2025
611801	4UZFCHFE6SCWG3410	2025	DS	DP	PTL ENTRY/EXIT DOOR	70852	3/5/2025	3/17/2025
611802	4UZFCHFE9SCWF9285	2025	DS	DP	PTL ENTRY/EXIT DOOR	70761	3/6/2025	3/18/2025
611803	4UZFCHFE3TCWK3212	2026	DS	DP	PTL ENTRY/EXIT DOOR	71037	3/18/2025	3/31/2025
611804	4UZFCHFE5TCWM3705	2026	DS	DP	PTL ENTRY/EXIT DOOR	70957	3/10/2025	3/19/2025
611805	4UZFCHFE3TCWK1282	2025	DS	DP	PTL ENTRY/EXIT DOOR	70952	3/4/2025	3/24/2025
611806	4UZFCHFE3SCWF9296	2025	DS	DP	PTL ENTRY/EXIT DOOR	70933	3/12/2025	3/24/2025
611807	4UZFCHFE8SCWG3411	2025	DS	DP	PTL ENTRY/EXIT DOOR	71048	3/13/2025	3/25/2025
611808	4UZFCHFE5TCWK1283	2025	DS	DP	PTL ENTRY/EXIT DOOR	70960	3/10/2025	3/20/2025
611809	4UZFCHFE9SCWG3412	2025	DS	DP	PTL ENTRY/EXIT DOOR	70951	3/11/2025	3/24/2025
611810	4UZFCHFE5TCWK3213	2026	DS	DP	PTL ENTRY/EXIT DOOR	71161	3/24/2025	4/2/2025
611811	4VZAU1D19TC095984	2026	DS	DP	PTL ENTRY/EXIT DOOR	71489	4/17/2025	5/2/2025
611812	4UZFCHFE4TCWM8295	2026	DS	DP	PTL ENTRY/EXIT DOOR	71492	4/22/2025	5/6/2025
611813	4UZFCHFE8TCWN6237	2026	DS	DP	PTL ENTRY/EXIT DOOR	71381	4/9/2025	4/24/2025
611814	4UZFCHFE7TCWM6072	2026	DS	DP	PTL ENTRY/EXIT DOOR	7115	3/27/2025	4/10/2025
611815	4UZFCHFE5TCWM1193	2026	DS	DP	PTL ENTRY/EXIT DOOR	71151	3/25/2025	4/8/2025
611816	4UZFCHFE9SCWJ0438	2026	DS	DP	PTL ENTRY/EXIT DOOR	70846	3/25/2025	4/3/2025
611817	4UZFCHFE6TCWM8296	2026	DS	DP	PTL ENTRY/EXIT DOOR	71244	4/8/2025	4/23/2025
611818	4UZFCHFE3TCWM1192	2026	DS	DP	PTL ENTRY/EXIT DOOR	71050	3/20/2025	4/1/2025
611819	4UZFCHFE1TCWM6374	2026	DS	DP	PTL ENTRY/EXIT DOOR	71254	4/2/2025	4/15/2025
611820	4UZFCHFE8SCWJ0437	2026	DS	DP	PTL ENTRY/EXIT DOOR	71158	3/20/2025	4/2/2025
611821	4UZFCHFE1TCWD4429	2026	DS	DP	PTL ENTRY/EXIT DOOR	71247	4/1/2025	4/11/2025
611822	4UZFCHFE1TCWM3703	2025	DS	DP	PTL ENTRY/EXIT DOOR	71250	4/2/2025	4/16/2025
611823	4VZAU1D13TC096015	2026	DS	DP	PTL ENTRY/EXIT DOOR	71583	4/30/2025	5/14/2025
611825	4UZACHFE0TCWN6243	2025	DS	DP	PTL ENTRY/EXIT DOOR	71491	4/16/2025	5/2/2025
611826	4VZAU1D11SC095962	2026	DS	DP	PTL ENTRY/EXIT DOOR	71145	3/27/2025	4/10/2025
611827	4UZFCHFE3TCWM3704	2025	DS	DP	PTL ENTRY/EXIT DOOR	70845	3/24/2025	4/3/2025
611829	4UZFCHFE0TCWK1286	2026	DS	DP	PTL ENTRY/EXIT DOOR	71152	3/26/2025	4/8/2025
611830	4UZFCHFE9TCWM6073	2026	DS	DP	PTL ENTRY/EXIT DOOR	71249	4/2/2025	4/15/2025
611831	4UZFCHFE9TCWN6238	2026	DS	DP	PTL ENTRY/EXIT DOOR	71713	5/6/2025	5/19/2025
611832	4UZFCHFE1TCWN6239	2026	DS	DP	PTL ENTRY/EXIT DOOR	71440	4/16/2025	5/1/2025
611833	4UZFCHFE8TCWM8297	2025	DS	DP	PTL ENTRY/EXIT DOOR	71252	4/7/2025	4/22/2025
611834	4VZAU1D17TC095983	2025	DS	DP	PTL ENTRY/EXIT DOOR	71438	4/15/2025	4/30/2025
611835	4UZACHFE9TCWP5284	2026	DS	DP	PTL ENTRY/EXIT DOOR	71764	5/12/2025	5/22/2025
611836	4UZACHFE9TCWM8299	2026	DS	DP	PTL ENTRY/EXIT DOOR	71494	4/24/2025	5/8/2025
611837	4UZFCHFE7TCWM1194	2026	DS	DP	PTL ENTRY/EXIT DOOR	71496	4/28/2025	5/8/2025
611838	4UZFCHFE2TCWM8294	2026	DS	DP	PTL ENTRY/EXIT DOOR	71500	4/28/2025	5/13/2025
611839	4UZFCHFE3TCWP0241	2026	DS	DP	PTL ENTRY/EXIT DOOR	71716	5/1/2025	5/15/2025
611840	4UZFCHFE0TCWP0245	2026	DS	DP	PTL ENTRY/EXIT DOOR	71714	5/6/2025	5/19/2025
611841	4UZFCHFE5TCWP0242	2026	DS	DP	PTL ENTRY/EXIT DOOR	71723	5/7/2025	5/20/2025
611842	4UZACHFE3TCWP0248	2026	DS	DP	PTL ENTRY/EXIT DOOR	71760	5/8/2025	5/21/2025
611844	4UZFCHFE1TCWN6242	2026	DS	DP	PTL ENTRY/EXIT DOOR	71719	5/14/2025	5/28/2025
611845	4UZFCHFE9TCWN6241	2026	DS	DP	PTL ENTRY/EXIT DOOR	71771	5/8/2025	5/20/2025
611847	4VZAU1D18TC096026	2026	DS	DP	PTL ENTRY/EXIT DOOR	71717	5/13/2025	5/23/2025
611852	4UZFCHFE2TCWP0246	2026	DS	DP	PTL ENTRY/EXIT DOOR	71770	5/15/2025	5/30/2025
611858	4UZFCHFE0TCWP5283	2026	DS	DP	PTL ENTRY/EXIT DOOR	71908	5/21/2025	6/4/2025

Prod#	VIN Number	Year	Br	Tp	Description	Serial	Date In Production	Date Off Production
611859	4UZFHFE7TCWP0243	2026	DS	DP	PTL ENTRY/EXIT DOOR	71984	5/22/2025	6/4/2025
611860	4VZAU1D17TC095997	2026	DS	DP	PTL ENTRY/EXIT DOOR	71911	5/20/2025	6/2/2025
611862	4UZFHFE6TCWP2534	2026	DS	DP	PTL ENTRY/EXIT DOOR	71920	5/20/2025	6/3/2025
711638	4VZAT1D1XSC095817	2025	NA	DP	PTL ENTRY/EXIT DOOR	68937	9/18/2024	10/4/2024
711650	4UZACEFE8SCWC6321	2025	NA	DP	PTL ENTRY/EXIT DOOR	68911	9/16/2024	9/30/2024
711654	4UZACEFE9SCWC6361	2025	NA	DP	PTL ENTRY/EXIT DOOR	68938	10/2/2024	10/22/2024
711656	4UZACEFE0SCWB5118	2025	NA	DP	PTL ENTRY/EXIT DOOR	69360	10/22/2024	11/4/2024
711660	4VZAT1D18SC095931	2025	NA	DP	PTL ENTRY/EXIT DOOR	70440	2/5/2025	2/19/2025
711662	4UZACEFE4SCWB9351	2025	NA	DP	PTL ENTRY/EXIT DOOR	69064	9/17/2024	10/1/2024
711663	4UZACEFE0SCWC7365	2025	NA	DP	PTL ENTRY/EXIT DOOR	69133	10/1/2024	10/21/2024
711664	4UZACEFE9SCWC7364	2025	NA	DP	PTL ENTRY/EXIT DOOR	69134	9/24/2024	10/14/2024
711665	4UZACEFE0SCWC9052	2025	NA	DP	PTL ENTRY/EXIT DOOR	69280	10/24/2024	11/6/2024
711666	4UZACEFE9SCWE1958	2025	NA	DP	PTL ENTRY/EXIT DOOR	69797	11/12/2024	12/2/2024
711667	4VZAT1D12SC095858	2025	NA	DP	PTL ENTRY/EXIT DOOR	69796	11/11/2024	11/20/2024
711668	4UZACEFEXSCWE9258	2025	NA	DP	PTL ENTRY/EXIT DOOR	70008	12/3/2024	12/12/2024
711669	4UZACEFE0SCWE4263	2025	NA	DP	PTL ENTRY/EXIT DOOR	69883	11/19/2024	12/9/2024
711670	4VZAT1D17TC095842	2026	NA	DP	PTL ENTRY/EXIT DOOR	69654	11/4/2024	11/14/2024
711671	4UZACEFE2SCWE4264	2025	NA	DP	PTL ENTRY/EXIT DOOR	70010	12/4/2024	12/16/2024
711672	4UZACEFE8SCWE9260	2025	NA	DP	PTL ENTRY/EXIT DOOR	70171	12/17/2024	1/10/2025
711673	4UZACEFE1SCWE9259	2025	NA	DP	PTL ENTRY/EXIT DOOR	70170	12/19/2024	1/14/2025
711674	4UZACEFE7SCWE4308	2025	NA	DP	PTL ENTRY/EXIT DOOR	70292	1/13/2025	1/27/2025
711675	4UZACEFE4SCWF9283	2025	NA	DP	PTL ENTRY/EXIT DOOR	70394	1/15/2025	1/29/2025
711676	4UZACEFE2SCWF9282	2025	NA	DP	PTL ENTRY/EXIT DOOR	70452	2/3/2025	2/13/2025
711677	4UZACEFE6SCWF9284	2025	NA	DP	PTL ENTRY/EXIT DOOR	70396	1/27/2025	2/5/2025
711678	4UZACEFEXSCWE9261	2025	NA	DP	PTL ENTRY/EXIT DOOR	70395	1/28/2025	2/6/2025
711679	4UZACEFE1SCWE9262	2025	NA	DP	PTL ENTRY/EXIT DOOR	70439	1/30/2025	2/12/2025
711680	4VZAT1D14SC095957	2025	NA	DP	PTL ENTRY/EXIT DOOR	70966	3/10/2025	3/19/2025
711681	4UZACEFE4TCWJ7153	2025	NA	DP	PTL ENTRY/EXIT DOOR	70699	2/18/2025	3/3/2025
711682	4UZACEFE9TCWM3702	2026	NA	DP	PTL ENTRY/EXIT DOOR	71255	3/31/2025	4/11/2025
711683	4VZAT1D14TC095975	2026	NA	DP	PTL ENTRY/EXIT DOOR	71258	4/1/2025	4/16/2025
711684	4UZACEFE0TCWK1281	2025	NA	DP	PTL ENTRY/EXIT DOOR	70967	3/11/2025	3/24/2025
711685	4UZACEFE9TCWM1187	2025	NA	DP	PTL ENTRY/EXIT DOOR	71071	3/12/2025	3/25/2025
711686	4UZACEFE7TCWM3701	2025	NA	DP	PTL ENTRY/EXIT DOOR	70968	3/18/2025	3/27/2025
711687	4VZAT1D15SC095935	2026	NA	DP	PTL ENTRY/EXIT DOOR	71447	4/14/2025	4/30/2025
711688	4UZACEFE2TCWM6070	2026	NA	DP	PTL ENTRY/EXIT DOOR	71501	4/23/2025	5/6/2025
711689	4UZACEFE9TCWM6373	2026	NA	DP	PTL ENTRY/EXIT DOOR	71588	4/29/2025	5/13/2025
711690	4UZACEFE0TCWP0237	2026	NA	DP	PTL ENTRY/EXIT DOOR	71726	5/5/2025	5/16/2025
711691	4UZACEFE0TCWM1191	2026	NA	DP	PTL ENTRY/EXIT DOOR	71725	5/7/2025	5/19/2025
801647	4VZVU1R15SC095831	2025	EX	DP	PTL ENTRY/EXIT DOOR	69276	10/15/2024	10/29/2024
801649	4VZVU1R18SC095824	2025	EX	DP	PTL ENTRY/EXIT DOOR	69149	9/30/2024	10/21/2024
801654	4UZFACTFGXSCWE0099	2025	EX	DP	PTL ENTRY/EXIT DOOR	69531	10/30/2024	11/14/2024
801661	4UZFACTFG1SCWC6320	2025	EX	DP	PTL ENTRY/EXIT DOOR	68939	9/11/2024	9/25/2024
801662	4UZFACTFGXSCWD6537	2025	EX	DP	PTL ENTRY/EXIT DOOR	69653	10/29/2024	11/12/2024
801665	4UZFACTFG4SCWE2320	2025	EX	DP	PTL ENTRY/EXIT DOOR	69333	11/5/2024	11/19/2024
801666	4UZFACTFG9SCWC9143	2025	EX	DP	PTL ENTRY/EXIT DOOR	69150	10/1/2024	10/22/2024
801667	4UZFACTFG0SCWC7362	2025	EX	DP	PTL ENTRY/EXIT DOOR	69050	9/23/2024	10/14/2024
801668	4UZFACTFG6SCWD4459	2025	EX	DP	PTL ENTRY/EXIT DOOR	69358	10/23/2024	11/6/2024
801669	4VZVU1R14SC095867	2025	EX	DP	PTL ENTRY/EXIT DOOR	69798	11/12/2024	12/2/2024
801670	4VZVU1R16SC095871	2025	EX	DP	PTL ENTRY/EXIT DOOR	70901	11/21/2024	12/10/2024
801671	4VZVU1R18SC095872	2025	EX	DP	PTL ENTRY/EXIT DOOR	70089	12/4/2024	12/17/2024

Prod#	VIN Number	Year	Br	Tp	Description	Serial	Date In Production	Date Off Production
801672	4VZVU1R19TC095851	2026	EX	DP	PTL ENTRY/EXIT DOOR	69359	10/16/2024	10/30/2024
801673	4VZVU1R15SC095893	2025	EX	DP	PTL ENTRY/EXIT DOOR	69884	12/16/2024	1/10/2025
801675	4UZFCFTG8SCWE2319	2025	EX	DP	PTL ENTRY/EXIT DOOR	70169	12/10/2024	1/8/2025
801676	4VZVU1R12SC095897	2025	EX	DP	PTL ENTRY/EXIT DOOR	70286	1/10/2025	1/24/2025
801677	4UZFCFTG3SCWE7198	2025	EX	DP	PTL ENTRY/EXIT DOOR	70220	1/7/2025	1/16/2025
801679	4VZVU1R13SC095939	2025	EX	DP	PTL ENTRY/EXIT DOOR	70436	2/6/2025	2/19/2025
801680	4UZFCFTG0SCWE9278	2025	EX	DP	PTL ENTRY/EXIT DOOR	70441	2/12/2025	2/25/2025
801681	4UZFCFTG9SCWE9280	2025	EX	DP	PTL ENTRY/EXIT DOOR	70390	1/23/2025	2/4/2025
801682	4UZFCFTG4TCWK1280	2025	EX	DP	PTL ENTRY/EXIT DOOR	70770	2/24/2025	3/6/2025
801683	4UZFCFTG6TCWK3211	2025	EX	DP	PTL ENTRY/EXIT DOOR	70700	2/18/2025	2/27/2025
801685	4UZFCFTG8TCWK1279	2025	EX	DP	PTL ENTRY/EXIT DOOR	70868	2/27/2025	3/11/2025
801686	4UZFCFTG0SCWH1636	2025	EX	DP	PTL ENTRY/EXIT DOOR	70962	3/11/2025	3/20/2025
801687	4UZFCFTG4TCWK3210	2025	EX	DP	PTL ENTRY/EXIT DOOR	70771	3/4/2025	3/13/2025
801688	4UZFCFTG4TCWM6065	2026	EX	DP	PTL ENTRY/EXIT DOOR	71062	3/19/2025	3/31/2025
801689	4UZFCFTG0SCWE4307	2026	EX	DP	PTL ENTRY/EXIT DOOR	70963	3/27/2025	4/10/2025
801690	4UZFCFTG6TCWM6066	2026	EX	DP	PTL ENTRY/EXIT DOOR	71163	3/20/2025	4/8/2025
801691	4UZFCFTG0TCWM6371	2026	EX	DP	PTL ENTRY/EXIT DOOR	71061	3/13/2025	3/26/2025
801693	4VZVU1R16TC095967	2026	EX	DP	PTL ENTRY/EXIT DOOR	71162	3/25/2025	4/8/2025
801695	4UZFCFTG5TCWM8293	2026	EX	DP	PTL ENTRY/EXIT DOOR	71394	4/8/2025	4/23/2025
801696	4VZVU1R18TC095968	2026	EX	DP	PTL ENTRY/EXIT DOOR	71259	4/1/2025	4/11/2025
801697	4VZVU1R1XTC095969	2026	EX	DP	PTL ENTRY/EXIT DOOR	71260	4/2/2025	4/16/2025
801699	4UZFCFTG3TCWN6148	2025	EX	DP	PTL ENTRY/EXIT DOOR	71446	4/14/2025	4/29/2025
801700	4VZVU1R10TC095978	2026	EX	DP	PTL ENTRY/EXIT DOOR	71589	4/29/2025	5/15/2025
801701	4UZFCFTG8SCWE4426	2026	EX	DP	PTL ENTRY/EXIT DOOR	71724	5/5/2025	5/16/2025
905196	4VZVU1E1XSC095815	2025	MA	DP	PTL ENTRY/EXIT DOOR	69145	10/2/2024	10/22/2024
905199	4VZVU1E15SC095835	2025	MA	DP	PTL ENTRY/EXIT DOOR	69269	10/15/2024	10/28/2024
905201	4VZVU1E18SC095828	2025	MA	DP	PTL ENTRY/EXIT DOOR	69057	9/18/2024	10/3/2024
905225	4VZVU1E14SC095826	2025	MA	DP	PTL ENTRY/EXIT DOOR	68908	9/16/2024	9/30/2024
905227	4VZVU1E18SC095845	2025	MA	DP	PTL ENTRY/EXIT DOOR	69525	10/28/2024	11/11/2024
905228	4VZVU1E13SC095834	2025	MA	DP	PTL ENTRY/EXIT DOOR	69272	10/3/2024	10/23/2024
905229	4VZVU1E17SC095836	2025	MA	DP	PTL ENTRY/EXIT DOOR	69341	10/21/2024	11/4/2024
905230	4VZVU1E11SC095847	2025	MA	DP	PTL ENTRY/EXIT DOOR	69529	10/30/2024	11/13/2024
905231	4VZVU1E19SC095854	2025	MA	DP	PTL ENTRY/EXIT DOOR	697910	11/6/2024	11/19/2024
905233	4VZVU1E19SC095837	2025	MA	DP	PTL ENTRY/EXIT DOOR	69345	10/23/2024	11/5/2024
905234	4VZVU1E19TC095841	2026	MA	DP	PTL ENTRY/EXIT DOOR	69650	10/24/2024	11/6/2024
905235	4VZVU1E13SC095848	2025	MA	DP	PTL ENTRY/EXIT DOOR	69643	11/5/2024	11/18/2024
905236	4VZVU1E12SC095856	2025	MA	DP	PTL ENTRY/EXIT DOOR	69532	11/13/2024	12/3/2024
905237	4VZVU1E10SC095855	2025	MA	DP	PTL ENTRY/EXIT DOOR	69908	11/19/2024	12/5/2024
905238	4VZVU1E12SC095873	2025	MA	DP	PTL ENTRY/EXIT DOOR	69999	12/2/2024	12/11/2024
905240	4VZVU1E1XSC095832	2025	MA	DP	PTL ENTRY/EXIT DOOR	70216	12/18/2024	1/14/2025
905241	4VZVU1E17SC095898	2025	MA	DP	PTL ENTRY/EXIT DOOR	70282	1/14/2025	1/28/2025
905242	4VZVU1E14SC095857	2025	MA	DP	PTL ENTRY/EXIT DOOR	70391	1/27/2025	2/6/2025
905243	4VZVU1E19SC095868	2025	MA	DP	PTL ENTRY/EXIT DOOR	70450	1/30/2025	2/12/2025
905244	4VZVU1E13SC095929	2025	MA	DP	PTL ENTRY/EXIT DOOR	70764	2/20/2025	3/5/2025
905245	4VZVU1E11SC095928	2025	MA	DP	PTL ENTRY/EXIT DOOR	70431	2/5/2025	2/18/2025
905247	4VZVU1E19SC095899	2025	MA	DP	PTL ENTRY/EXIT DOOR	70318	1/28/2025	2/11/2025
905248	4VZVU1E10SC095869	2025	MA	DP	PTL ENTRY/EXIT DOOR	70589	2/11/2025	2/24/2025
905249	4VZVU1E16SC095844	2025	MA	DP	PTL ENTRY/EXIT DOOR	70696	2/17/2025	2/27/2025
905250	4VZVU1E13TC095964	2026	MA	DP	PTL ENTRY/EXIT DOOR	71051	3/19/2025	4/1/2025
905251	4VZVU1E11SC095881	2025	MA	DP	PTL ENTRY/EXIT DOOR	70767	2/25/2025	3/10/2025

Prod#	VIN Number	Year	Br	Tp	Description	Serial	Date In Production	Date Off Production
905252	4VZVU1E11SC095895	2025	MA	DP	PTL ENTRY/EXIT DOOR	71156	3/26/2025	4/9/2025
905253	4VZVU1E13SC095882	2025	MA	DP	PTL ENTRY/EXIT DOOR	70850	3/3/2025	3/12/2025
905254	4VZVU1E15SC095883	2025	MA	DP	PTL ENTRY/EXIT DOOR	70849	3/3/2025	3/13/2025
905255	4VZVU1E14SC095941	2025	MA	DP	PTL ENTRY/EXIT DOOR	70762	3/6/2025	3/18/2025
905256	4VZVU1E12SC095999	2025	MA	DP	PTL ENTRY/EXIT DOOR	71444	4/10/2025	4/25/2025
905257	4VZVU1E11TC095963	2026	MA	DP	PTL ENTRY/EXIT DOOR	70844	3/20/2025	4/2/2025
905258	4VZVU1E16SC095942	2025	MA	DP	PTL ENTRY/EXIT DOOR	70956	3/10/2025	3/19/2025
905259	4VZVU1E18SC095943	2025	MA	DP	PTL ENTRY/EXIT DOOR	70955	3/12/2025	3/25/2025
905260	4VZVU1E10SC095998	2025	MA	DP	PTL ENTRY/EXIT DOOR	71442	4/10/2025	4/25/2025
905262	4VZVU1E12TC095972	2026	MA	DP	PTL ENTRY/EXIT DOOR	71147	3/31/2025	4/10/2025
905263	4VZVU1E11TC095980	2026	MA	DP	PTL ENTRY/EXIT DOOR	71383	4/17/2025	5/2/2025
905264	4VZVU1E15TC095982	2026	MA	DP	PTL ENTRY/EXIT DOOR	71385	4/22/2025	5/5/2025
905265	4VZVU1E14TC095973	2026	MA	DP	PTL ENTRY/EXIT DOOR	71248	4/2/2025	4/15/2025
905266	4VZVU1E16TC095974	2026	MA	DP	PTL ENTRY/EXIT DOOR	71259	3/31/2025	4/11/2025
905267	4VZVU1E1XTC096013	2026	MA	DP	PTL ENTRY/EXIT DOOR	71582	4/30/2025	5/14/2025
905268	4VZVU1E13TC096001	2026	MA	DP	PTL ENTRY/EXIT DOOR	71493	4/23/2025	5/6/2025
905269	4VZVU1E11TC096014	2026	MA	DP	PTL ENTRY/EXIT DOOR	71722	5/7/2025	5/20/2025
905270	4VZVU1E1XSC095927	2026	MA	DP	PTL ENTRY/EXIT DOOR	71587	4/24/2025	5/7/2025
905271	4VZVU1E13TC095981	2026	MA	DP	PTL ENTRY/EXIT DOOR	71497	4/28/2025	5/8/2025
905272	4VZVU1E12SC095940	2026	MA	DP	PTL ENTRY/EXIT DOOR	71581	4/29/2025	5/13/2025
905274	4VZVU1E15TC095996	2026	MA	DP	PTL ENTRY/EXIT DOOR	71761	5/12/2025	5/21/2025