

ATTENTION: Mercedes-Benz Dealer Principals, General Managers, Sales Managers, Service Managers & Parts Managers

Service Campaign Notification

February 20, 2026

Campaign #	Description	Update Head-Up-Display Software - OTA
N/A	25P5497916	
<input checked="" type="checkbox"/> Over-the-Air ("OTA") Update		

Campaign Details

Total Population	8,507	Model(s)/ Platform(s)	E-Class (214)
Model Year(s)	2024-2026		
Issue	Mercedes-Benz AG, the manufacturer of Mercedes-Benz vehicles, has determined that on certain subject vehicles, the head unit software does not correspond with the latest series production configuration. The head-up display control unit will receive an update to improve the display's start-up routine and how information is presented.		
Remedy	MBUSA will conduct an OTA service campaign. Remote software updates are automatically downloaded and installed in the customer's vehicle free of charge and do not require a dealer visit.		
Launch Date	The vehicles will not be visible or flagged in VMI or EVA.		
Warranty Claim Notice	No Service Action is required by the Dealer for this Campaign.		

Please refer all customer inquiries to the Customer Care Center at 1-800-FOR-MERCEDES.



Dealers can check for a successful OTA update in VeDoc, or the customer can check using the Mercedes me connect App. Customers can continue to drive their vehicle. Sufficient battery voltage may be required for the OTA update to be initialized. If the vehicle has not been driven in four or more weeks, the ignition should be cycled to initialize the process.

Instructions to verify a successful OTA update in VeDoc:

Dealers can search the VIN in VeDoc (**Figure 1, A**), then click "Control Units" and "HUD Head-Up-Display" (**Figure 1, B and C**).

If the **Software Object Number** list (**Figure 1, D**) includes: "A214 902 30 09, A214 903 17 03, or A214 904 84 00," then the OTA update was successful.

The screenshot displays the VeDoc interface for a vehicle. At the top, there are search fields for 'Vehicle identification no. (FIN)' and 'Vehicle identification no. (VIN)', with a search button and navigation arrows. Below this is a menu bar with tabs for 'Identification', 'Major assemblies', 'Codes', 'SAA numbers', 'VPD and serial no.', 'Control units', 'Theft-relevant data', 'Navigation', 'FO texts', 'History', 'Sales data', 'Certification', 'Model plate', 'Equipment', 'Plant texts', and 'Orders of the relevant parts'. The 'Control units' tab is active, showing a table of components. One component, 'Hermes - Controlunit', is highlighted in blue. Below the table, there is a section for 'VEHICLE INFORMATION FOR CONTROL UNITS' and 'SOFTWARE AND COMPONENTS OF THE SELECTED CONTROL UNIT', which includes a table of software object numbers, versions, and IDs. The object number '000 902 45 89' is highlighted with a red 'D'.

Designation	Model	Diogenes name	Short des.	ID code	Version	Hardware object no.	Cal ID/ CVN	Flash	SCN p	Service	Serial number
PAS (Parkassistent)		PARK223	PAS			000 901 31 16		<input checked="" type="checkbox"/>	<input checked="" type="checkbox"/>	<input checked="" type="checkbox"/>	00090131160000337258100000074...
LED-LI Steuergerät	VPDPA	FHD206_FL	LEDFL			206 901 50 08		<input checked="" type="checkbox"/>	<input checked="" type="checkbox"/>	<input type="checkbox"/>	2069015008000512305210531
LED-RE Steuergerät	VPDPA	FHD206_FR	LEDFR			206 901 50 08		<input checked="" type="checkbox"/>	<input checked="" type="checkbox"/>	<input type="checkbox"/>	2069015008000512305180316
PMCU-FL passive massage control unit front left		PMCU_FL223	PMSVL			297 901 26 00		<input checked="" type="checkbox"/>	<input checked="" type="checkbox"/>	<input type="checkbox"/>	2979012600003CA2C77017508Q1...
PMCU-FR passive massage control unit front right		PMCU_FR223	PMSVR			297 901 26 00		<input checked="" type="checkbox"/>	<input checked="" type="checkbox"/>	<input type="checkbox"/>	2979012600003CA2C77017508Q1...
POS Steuergerät		POS223	POS			223 901 45 16		<input checked="" type="checkbox"/>	<input checked="" type="checkbox"/>	<input checked="" type="checkbox"/>	985012207511492222390145160003
ARWT Automatische Rückwandtür		PTCM223	PTCM			297 901 53 04		<input checked="" type="checkbox"/>	<input checked="" type="checkbox"/>	<input type="checkbox"/>	
Hermes - Controlunit	VPDPA	RAMSE5	RAMSE5			214 901 22 07		<input checked="" type="checkbox"/>	<input checked="" type="checkbox"/>	<input type="checkbox"/>	21490122070009ERB15HNAD323293000115
Rear Axle Steering	VPDPA	RAS223	RAS			223 901 76 07		<input checked="" type="checkbox"/>	<input type="checkbox"/>	<input type="checkbox"/>	22390176070002601223156092228E
GSL Gurtstraffer links		RBTMFL223	GSL			223 901 00 16		<input checked="" type="checkbox"/>	<input type="checkbox"/>	<input type="checkbox"/>	223901001600027230321150000008...
GSR Gurtstraffer rechts		RBTMFR223	GSR			223 901 01 16		<input checked="" type="checkbox"/>	<input checked="" type="checkbox"/>	<input type="checkbox"/>	223901011600027230321120000013...

Object number	Version	Software ID	App ID	App version	ZGS	SCN	Factory SCN
000 902 45 89						2149028204010070	2149028204010070
000 902 76 67							
000 902 77 67							

Figure 1 – Successful OTA update in VeDoc



Instructions to verify a successful OTA update in Mercedes-me connect App:

Using the Mercedes-me connect App on Android or Apple, the customer can check the status of the OTA update by going to the “Vehicle” icon and selecting “Over-the-Air Vehicle Updates” (Figure 2). A successful OTA update will show as “Installed” (Figure 3).

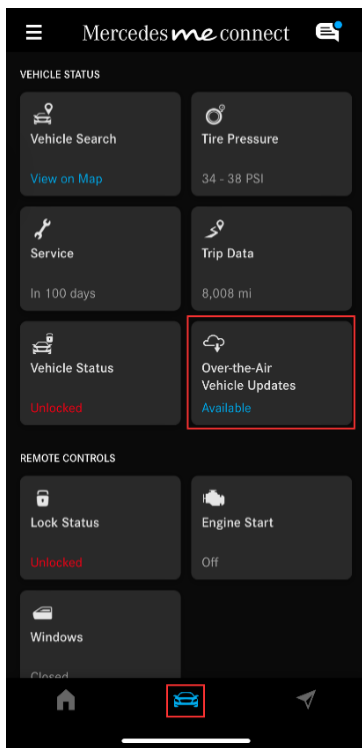

Figure 2 – Over-the-Air Vehicle

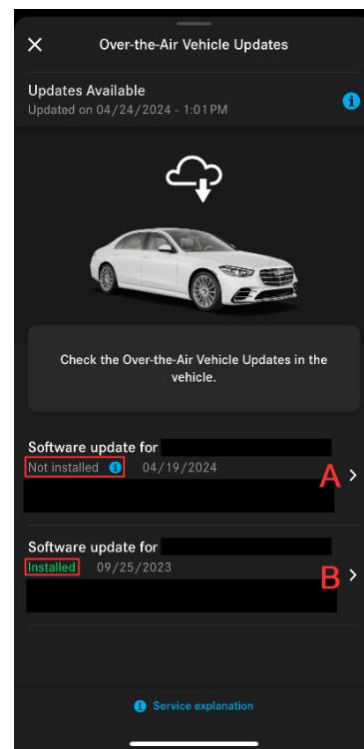

Figure 3 –

- A. Pending OTA Update
- B. Successful OTA Update

