



Technical Service Bulletin

GROUP	NUMBER
CAMPAIGN	25-01-080G-1
DATE	MODEL(S)
DECEMBER 2025	GV70 (JK1)

SUBJECT: DCU SOFTWARE UPDATE
(LIMITED COVERAGE CAMPAIGN L02G)

This TSB supersedes 25-01-080G to revise the Configuration of Ethernet Communication on Tablet procedure on page 4.

★ IMPORTANT

Retailers must perform this field action on all affected vehicles within 5 / 60,000 New Vehicle Limited Warranty (NVLW) prior to retail delivery to a guest and whenever an affected vehicle is in the shop for any maintenance or repair. See Warranty Information section for more details.





Access the "Vehicle Information" screen via WebDCS to verify "Warranty Start Date" and ensure the vehicle is within NVLW, observing mileage prior to any repair work.

Description: Certain GV70 (JK1) vehicles may exhibit a Data Communication Unit (DCU) software error due to the internal timer initialization logic not being implemented. The DCU module may shut down telematics services after one year. This bulletin provides instructions to perform a software update for the DCU module.

Applicable Vehicles:

Model Year	Model	Production Dates
2026	GV70 (JK1)	02/18/2025 – 09/10/2025

SST Information:

Tool Name	Tool Number	Figure	Remarks	Ordering Information
VCI 3	G0VPNNN006		VCI 3 comes with the 19-pin cable (P/N G1XDDCA020 included here for reference)	Website: https://genesisessentialtools.com/ Email: Genesistools@snapon.com Phone: 1-855-763-6630 Hours: 7 AM – 7 PM CST
19-Pin Cable	G1XDDCA020			
VCI 2	G1XDDMN002		If using VCI 2, the ECI Kit will be required to complete software updates.	
Ethernet Communication Interface (ECI) Kit	G0XDDMN052			

NOTE: VCI 2 can **NO** longer be ordered but can be used for the updates in this TSB.

Circulate To: General Manager, Service Manager, Parts Manager, Warranty Manager, Service Advisors, Technicians, Body Shop Manager, Fleet Repair

SUBJECT:

DCU SOFTWARE UPDATE (LIMITED COVERAGE CAMPAIGN L02G)

GDS Information:

Model	System	Event Number*	Description
GV70 (JK1)	DCU	1312	JK1 PE DCU LOGIC IMPROVEMENT (NA)

(*or use a later available event as listed in the GDS DCU Update screen if one is available.)

NOTE: The software update is subject to an OTA (Over-the-Air) option and may be completed by customers with active Genesis Connected Services subscriptions.

Warranty Information:

Model	Op. Code	Operation	Op. Time	Causal Part	Nature Code	Cause Code
GV70 (JK1)	50D280R0	DCU Software Update	0.4 M/H	96510-ARNA0	M73	ZZ3

NOTE 1: Submit claim on Claim Entry Screen as “Campaign” type.

NOTE 2: 5 / 60,000 New Vehicle Limited Warranty (NVLW) applies to the part(s) and repair procedure(s) outlined in this TSB. Prior to beginning any repair work, ensure the part(s) associated with the repair procedure are within NVLW, observing mileage and Warranty Start Date or date of first use. If the subject part(s) are out of warranty coverage, the retailer has the option to submit a PA Request for goodwill consideration on a case-by-case basis.

NOTE 3: If any part(s) not subject to this TSB are found in need of replacement while performing the repair procedure, and the affected part(s) are still under warranty, the retailer may submit a separate claim using the same repair order. If the part(s) not subject to this TSB are out of warranty coverage, the retailer has the option to submit a PA Request for goodwill consideration on a case-by-case basis.

NOTE 4: This TSB includes repair validation photos. Op times include VIN, mileage, and photo capture of the ECU Update “Success” result screen as outlined in the Digital Documentation Policy.

ROM ID Information:

Model	Event	System	ECU Part Number	ROM ID	
				Current	Latest
GV70 (JK1)	1312	DCU	96510-ARNA0	120.CA.011606.011606	120.NA.012054.01205
				120.CA.011870.011870	
				120.CA.011951.011951	

Service Procedure:

DIGITAL DOCUMENTATION

This TSB includes repair validation photos. Refer to the latest Warranty Digital Documentation Policy for requirements.

NOTICE

Perform the GDS ECU update in Auto Mode.

- If the ECU update fails in Auto Mode, perform the update in Manual Mode to recover.

NOTICE

Ensure the vehicle's battery charge is **above 11.0 Volts** and the tablet's battery charge is **above 30%** before performing a software update to avoid failure.

**Information**

- Turn **OFF** all lamps (do **NOT** leave head lamp switch in auto mode) and accessories.
- Perform update with the ignition switch in the **ON** position.
- Do **NOT** disconnect any cables connected to the vehicle or scan tool during the update.
- Do **NOT** start the engine during the update.
- Do **NOT** turn **OFF** the ignition switch during the update.

Configuration of Ethernet Communication on Tablet

VCI 2 Connection (must use ECI kit with USB-C cable attachment):

1. Connect the ECI DLC connector to the OBD connector of the vehicle.
2. Connect the VCI to the receiver module on the ECI cable.
3. Connect the ECI cable with the USB-C connector cable attachment to the tablet.

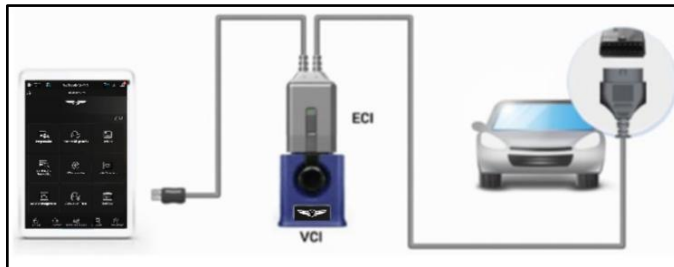

VCI 3 Connection (use VCI 3 cable):

1. Connect the 19-pin connector to the bottom of the VCI 3.
2. Connect the VCI to the OBD connector of the vehicle.
3. Connect the cable with the USB-C connector to the tablet.

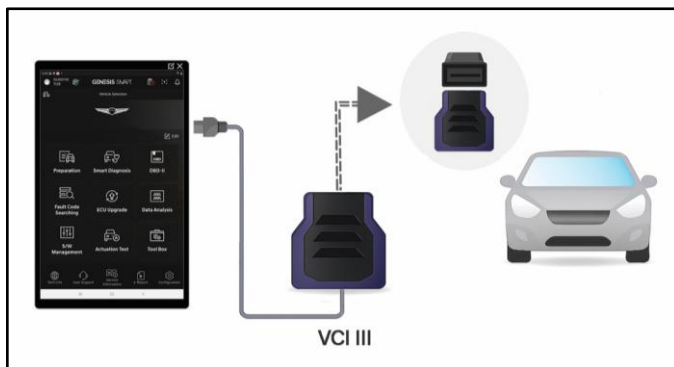

i Information

- If using VCI 2, please wait for the **Wi-Fi Direct** timer to complete to ensure the **Wi-Fi Direct** connection is established. Do **NOT** select **Bluetooth Only**.

The screenshot shows the 'Device Manager' section of the GDS application. On the left, a 'VCI_II_NGD24494 Connection' dialog is open, showing a transition from Bluetooth to Wi-Fi Direct. A red box highlights the text: 'Connecting to VCI II(VCI_II_NGD24494) via Wi-Fi Direct... 66 seconds remaining'. Below this, a 'Bluetooth Only' button is visible. On the right, the 'VCI Connection Information' panel shows 'Last Connected VCI(Wireless)' as 'VCI_II_NGD24494' with a 'Reconnect' button. The 'Firmware Version' section shows 'Current' as '03.23' and 'Latest' as '03.23', with an 'Update' button. A note at the bottom states: 'VCI Firmware update unavailable using STUI. Please update in GDS, under Configuration > Device Manager'. A red box highlights the Wi-Fi icon in the VCI connection information panel.

ECU Update Procedure

1. Enter the following digits exactly as shown for IP address, DNS address, Netmask and Default gateway.

Save and close.

IP address – 10.0.128.0

DNS address – 8.8.8.8

Netmask – 255.0.0.0

Default gateway – 10.0.128.0

***i* Information**

Ensure the following IP settings on your tablet matches the below before proceeding with the software update.

Select Ethernet device
eth0

Connection type
 DHCP
 Static IP

IP address
10.0.128.0

Netmask
255.0.0.0

DNS address
8.8.8.8

Default router
10.0.128.0

DISCARD SAVE

2. Perform the ECU update in **Auto Mode**.

***i* Information**

Refer to **TSB # 24-GI-016G**, “ECU Update Procedure for Tablet-Based Genesis Smart”, for additional information.

ECU UPGRADE 1.307

KMIKCDTC2PU012969 GV60(JW1 EV)/2023/74KW+160KW

SELECT ECU UPGRADE MODE

AUTO MODE

MANUAL MODE

OTA MANAGEMENT VERSION UPDATE

- Verify the ROM ID by selecting the **DCU** system to scan the vehicle's current ROM ID.

NOTICE

Check the current ROM ID version and compare it to the ROM ID Information table before attempting to perform the software update.

NOTICE

If the update fails, remove the power connector from the in-cabin fuse box for at least **5 seconds**. Reassemble and retry the update.

i Information

The screenshots within this service procedure refers to a GV70 Internal Engine Combustion (ICE) vehicle from Hyundai Motor Manufacturing Alabama factory, but is also applicable to the GV70 ICE vehicle from Hyundai Motor Company.

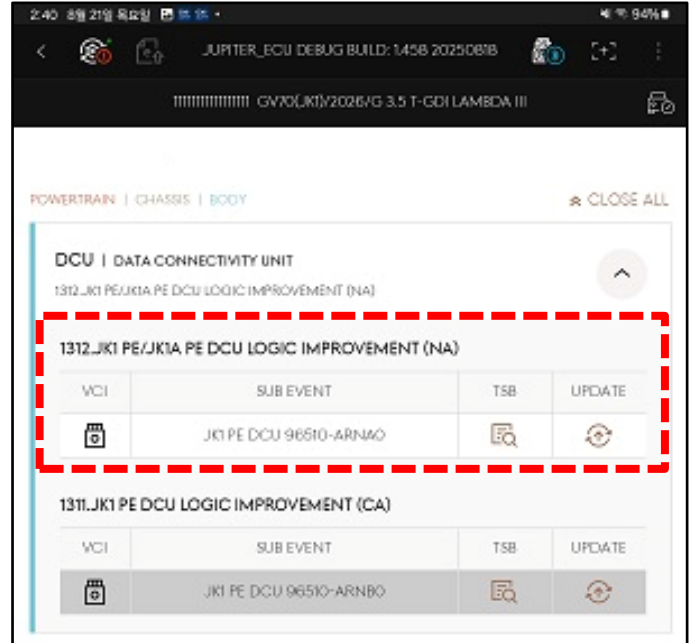

- Once the ECU update is 100% complete, follow the prompts on the screen to cycle the ignition **OFF** for at least **10 seconds** to reset the control unit (certain models may take up to **30 seconds**).

i Information

Use the **Refresh** button to reset the timer.

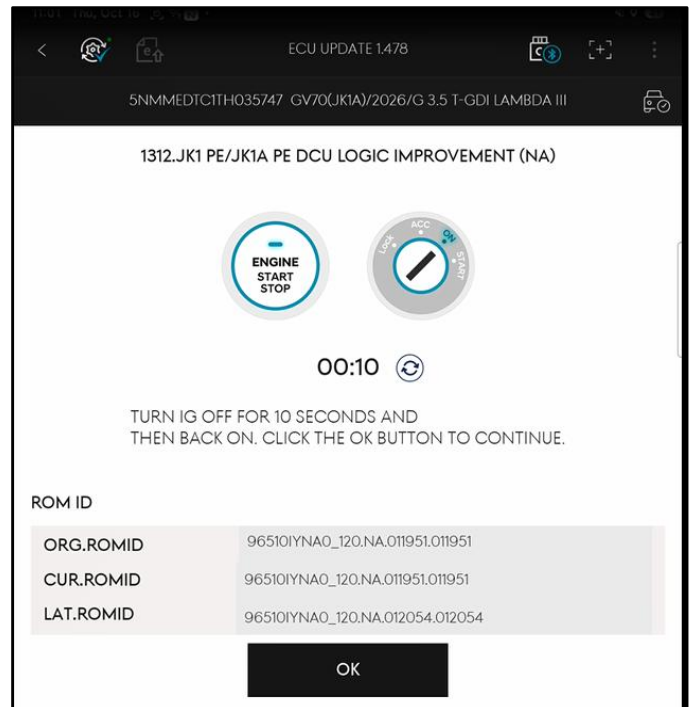

5. OTA initialization (A) should perform automatically:
 - If OTA initialization performs automatically, then proceed with the service procedure.
 - If the OTA initialization process fails, complete it manually under:
S/W Management > CCU_CCNF - Central Communication Unit (CCNF) > OTA Initialization (B).

Follow the instructions on the screen.

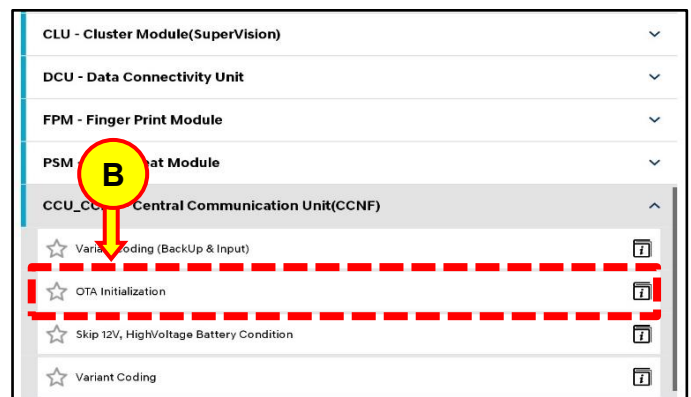
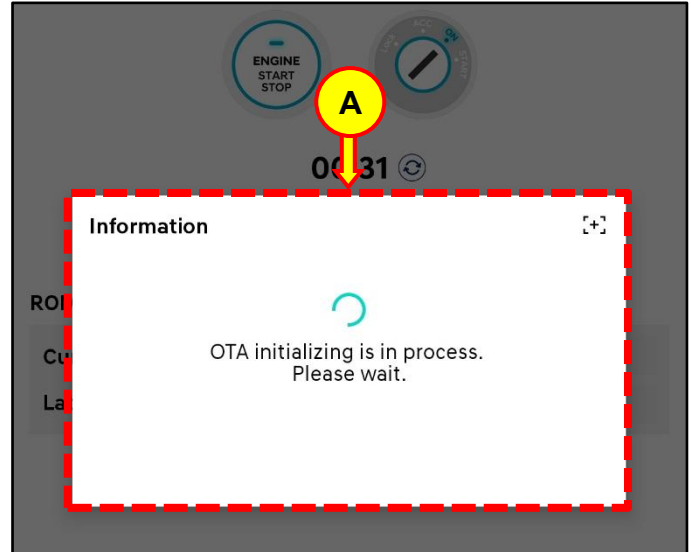

6. **DIGITAL DOCUMENTATION** 

Using the tablet or GDS screen capture function, take a screenshot of the ECU Update "Success" result screen.

Upload the photo to STUI.

NOTE: The VIN/Date/Time/Mileage photo imprint is **NOT** required for GDS screenshots.

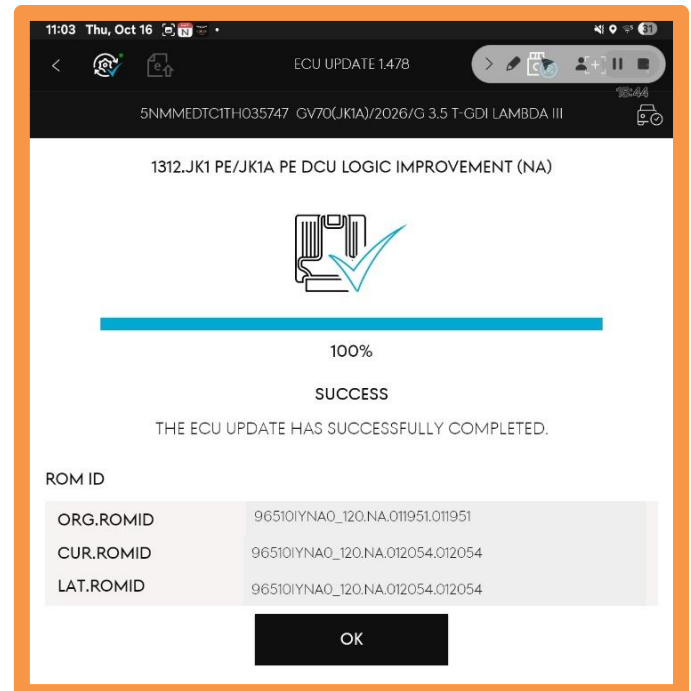

7. Perform an **All Systems Fault Code** search and erase DTC history that had incidentally occurred from the ECU update.

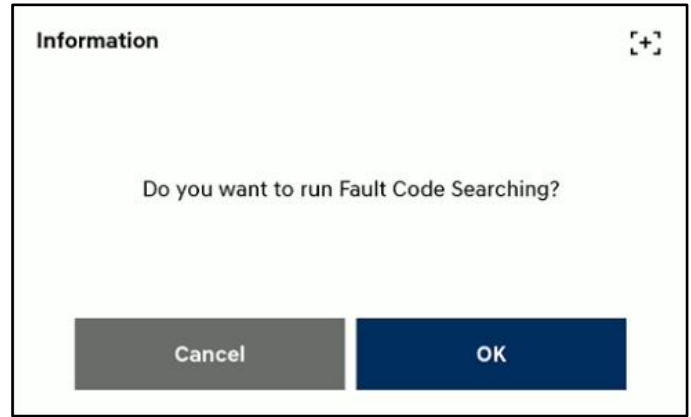

8. Start the engine to confirm proper operation of the vehicle.
9. The service procedure is now complete.

NOTICE

If the ECU update fails in Auto Mode, perform the update in Manual Mode using the password(s) below.

Manual Mode Password:

Event	ECU Menu	Password
1312	JK1 PE DCU 96510-ARNA0	2123