



CAN-AM ON-ROAD 2025-5 Canyon Saddle Bags Watertightness Improvement

Vehicle - Quality Bulletin

Can-Am On-Road

December 18, 2025
Bulletin 2025-5 | Version A
Campaign N° 2025-0005

Canyon Saddle Bags Watertightness Improvement

IMPORTANT

When receiving a vehicle for service:

- Always lookup the vehicle identification number (VIN) on the Knowledge Center to check for pending campaigns or alerts.
- Always connect the vehicle to the BRP diagnostic software (BUDS) to ensure all required updates are performed.
- Only vehicles displaying the symptoms outlined in this bulletin are eligible for repair. Claims on vehicles without these symptoms will be denied.

APPLICABILITY

| MODEL YEAR | MODEL | ADMISSIBLE UNITS |
|------------|-----------------------|--|
| MY25 | Canyon XT and Redrock | In Knowledge Center: <ul style="list-style-type: none"> • Enter the VIN • Select the <i>DOCUMENTS AND ARTICLES</i> tab • Select filters: • Warranty in <i>ARTICLE TYPE CATEGORIES</i> • Warranty Bulletin in <i>ARTICLE TYPES</i> |

PROBLEM

Moisture may infiltrate the inside of the saddlebag when exposed to rain.

SOLUTION

Install the neoprene washer kit and sealant to improve the watertightness of the saddlebags.

REQUIRED PARTS

Order the parts through the regular channel.

Neoprene Seal Kit (PN 219800636)

| DESCRIPTION | PART NUMBER | QTY |
|------------------------|-----------------|-----|
| Neoprene Washers Sheet | Included in kit | 1 |
| Stainless Washer | Included in kit | 2 |
| Panel Nut | Included in kit | 4 |
| Screw TBD | Included in kit | 4 |

Sealant Kit (PN 219800635)

| DESCRIPTION | PART NUMBER | QTY |
|--------------------------------|-----------------|-----|
| gasket hybrid sealant (3M 730) | Included in kit | 1 |

Some gasket hybrid sealant (3M 730) will be required to seal the corners.

CORRECTIVE ACTION

NOTE



- Do not mix removed screws as they will slightly vary in size.
- Be careful not to exceed tightening specification.

1. Remove saddlebag.
2. Open cover and open lower tray.

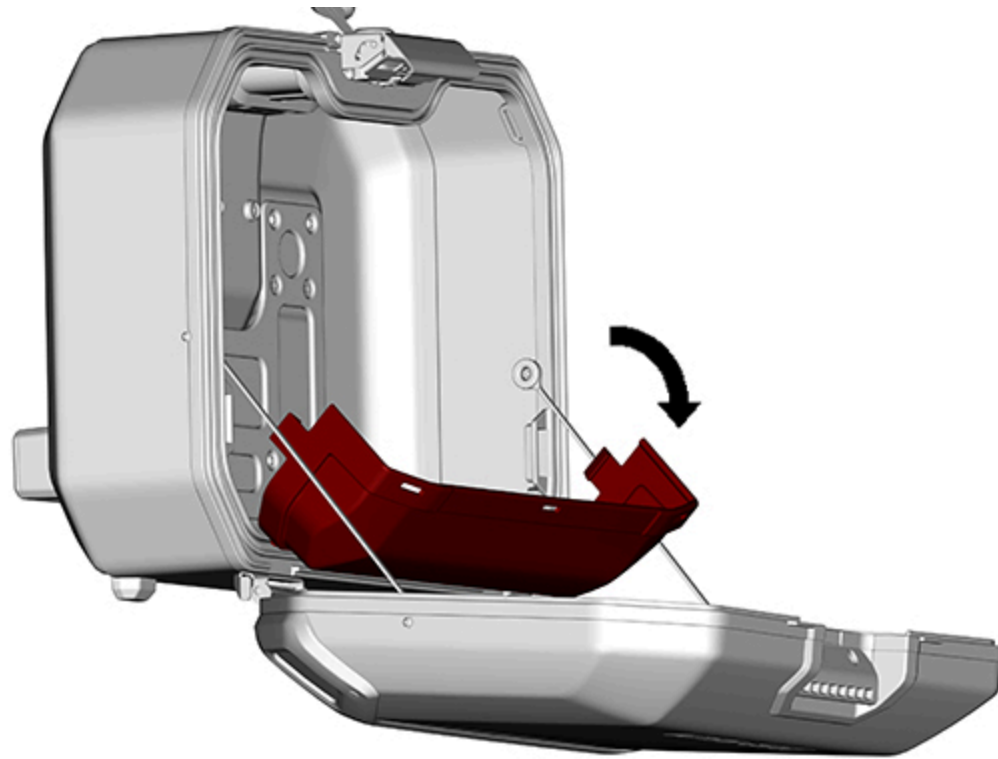

3. Remove and keep the support legs and retaining Ø4 X 12 Torx screws.

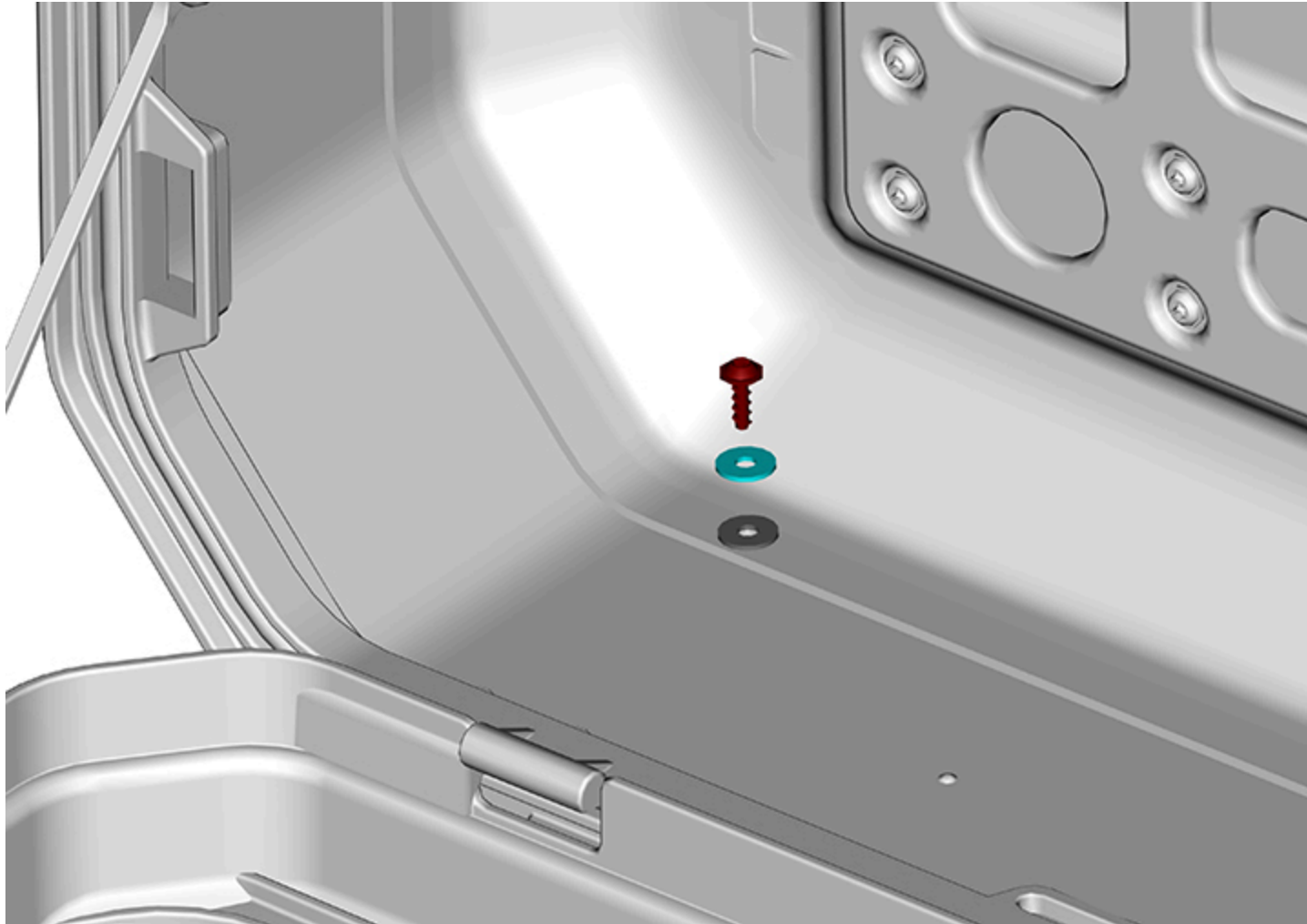

4. Clean surface with isopropyl alcohol.
5. From inside the saddlebag, glue a neoprene seal, install a stainless washer and reinstall the $\text{Ø}4 \times 12$ Torx screw and secure the support leg in place.

**NOTE**

Make sure to align the longest flat side of the support legs towards the rear wheel (opposite of the cover).

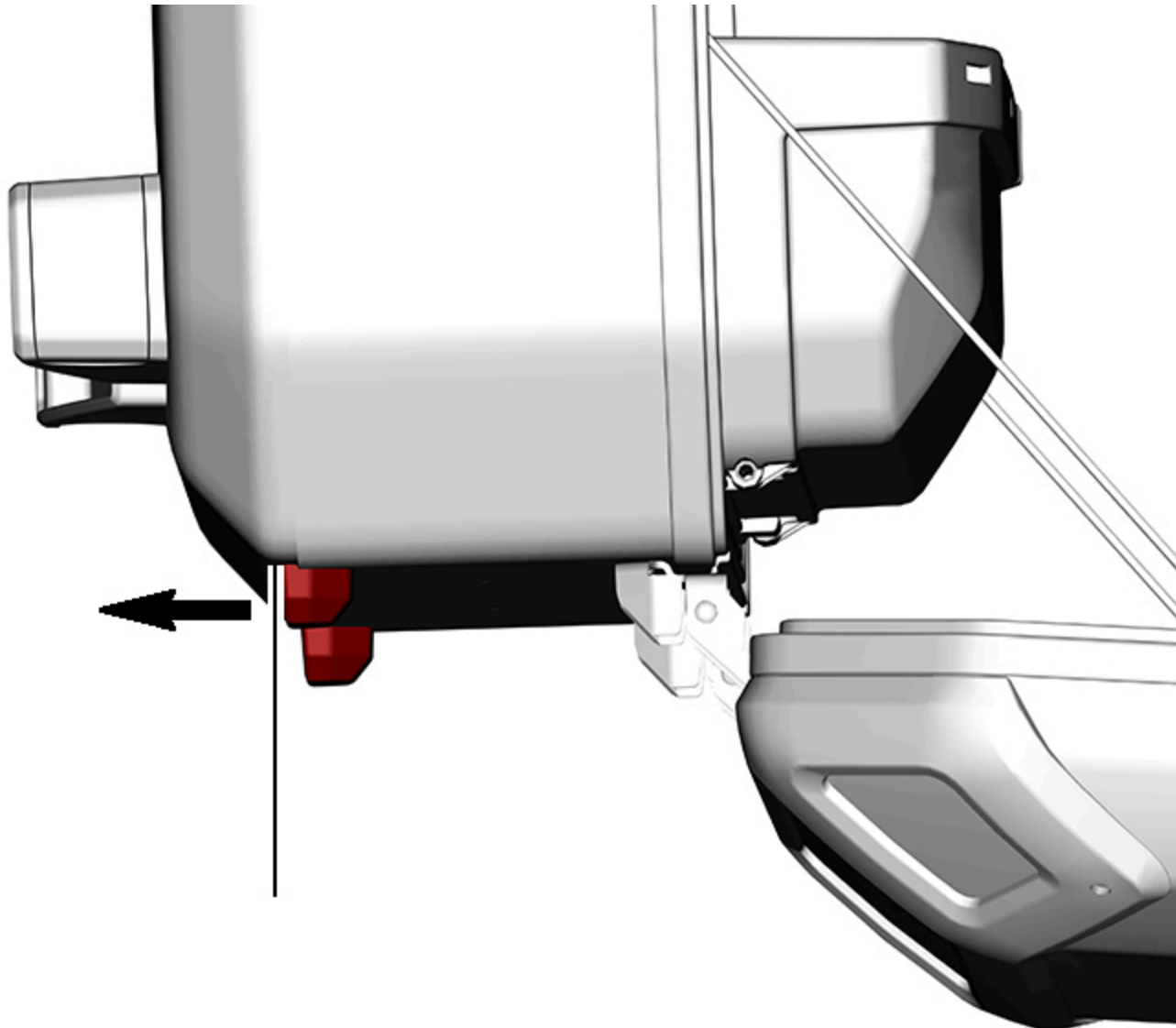

| TIGHTENING TORQUE | |
|--------------------------------------|--------------------------------|
| Support leg screw Ø4 X 12 Torx screw | 1.5 ± 0 N•m (13 ± 0 lbf•in) |

6. In the lower section remove and keep the 8 Ø4 X 16 Torx screws securing the two bumper stops.

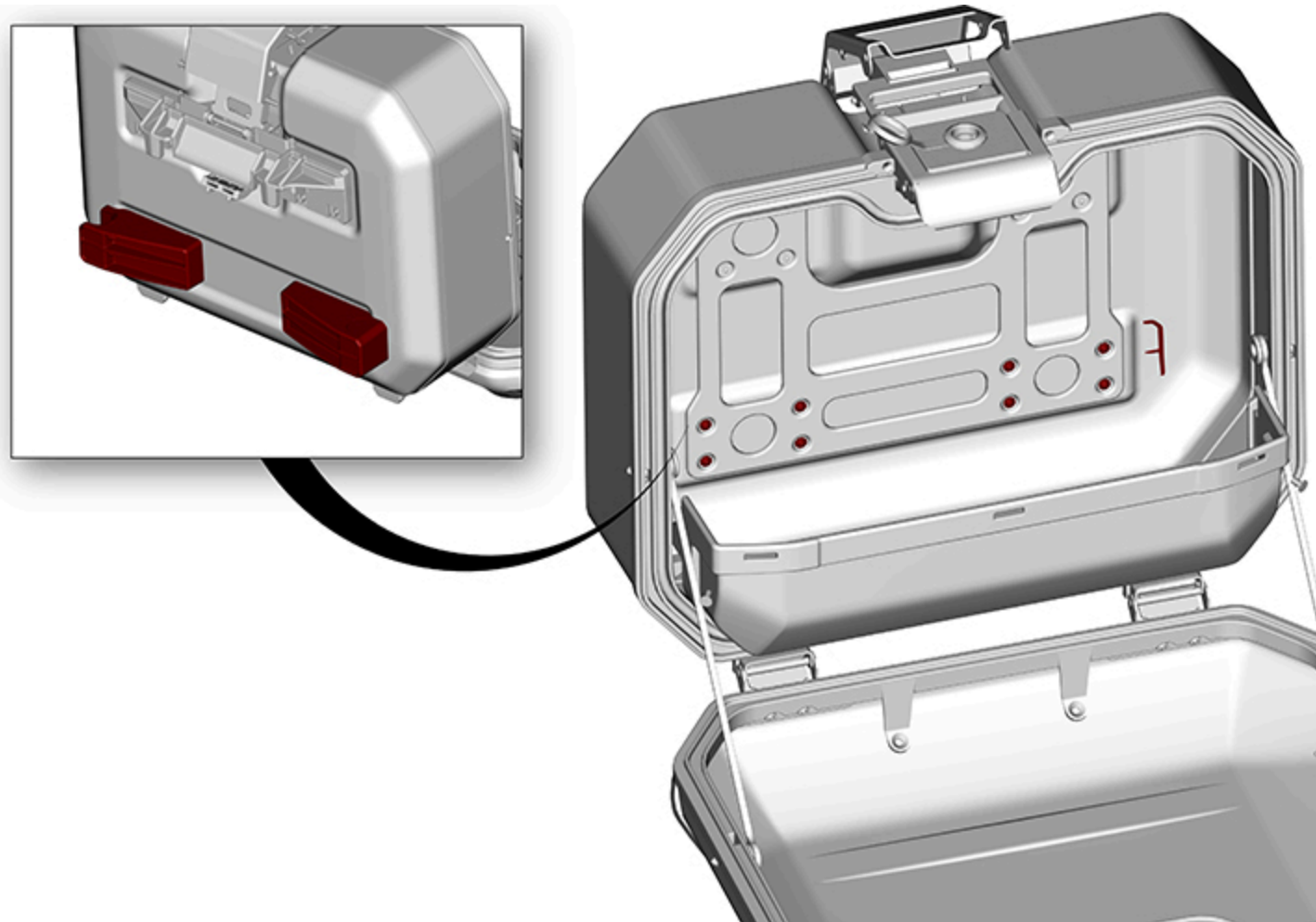

7. Clean surface with isopropyl alcohol.
8. Glue neoprene washers from outside the saddlebag.

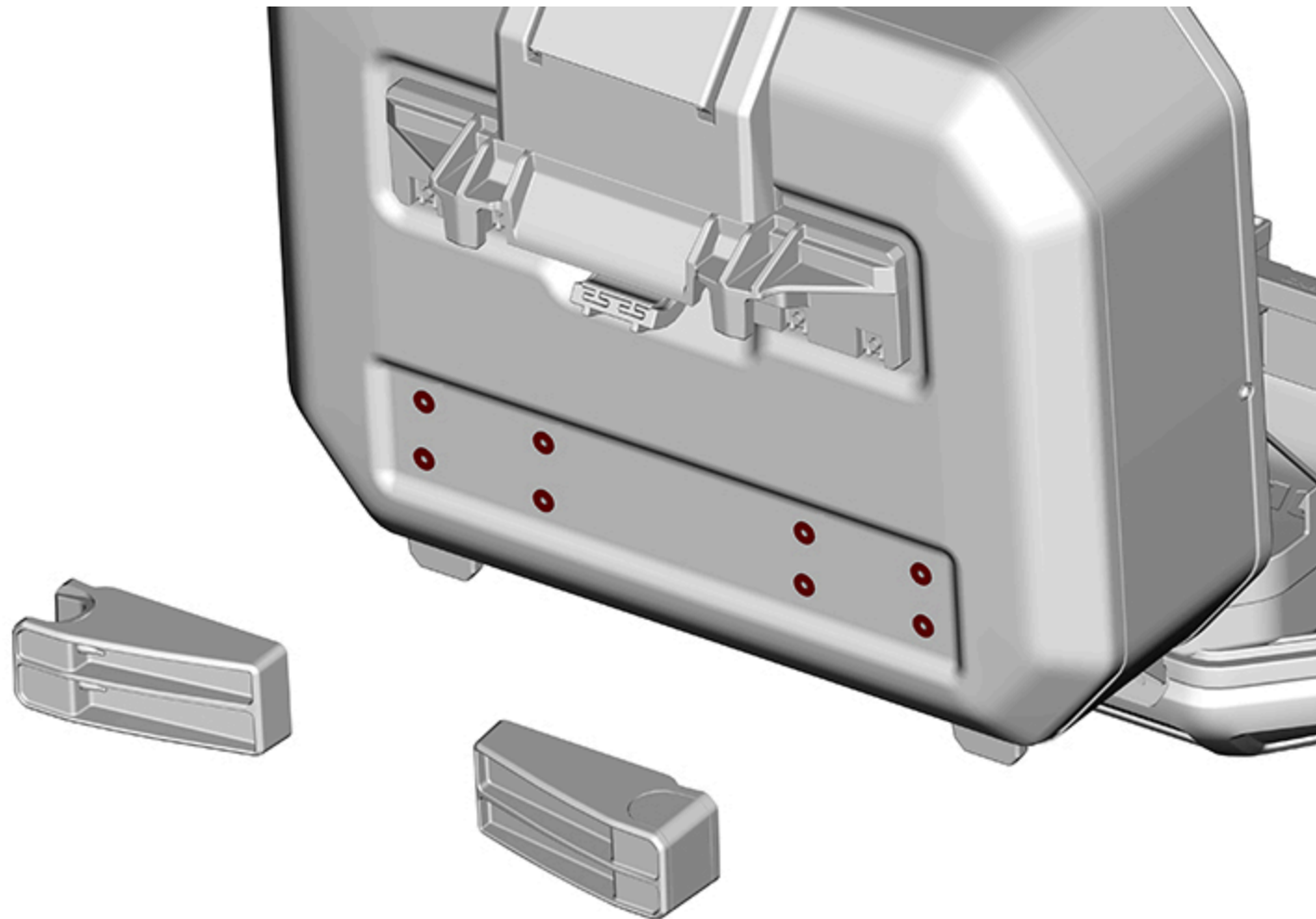

9. Reinstall the two bumper stops, and secure with $\varnothing 4 \times 16$ Torx screws. Tighten to specification.



NOTE

Make sure to install the bumper stop with the open recess towards the front of the vehicle.

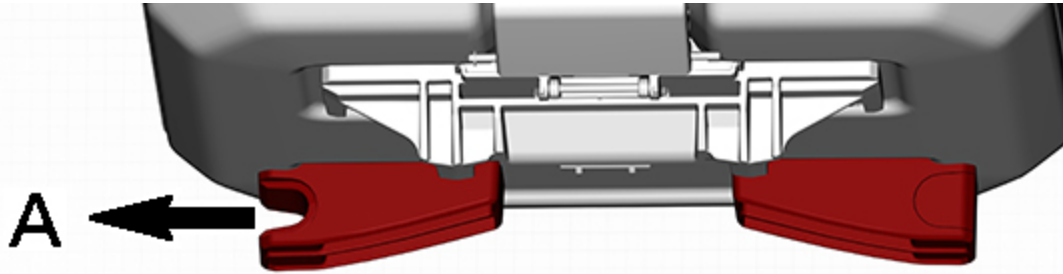

- A = Towards Front

| TIGHTENING TORQUE | |
|--------------------|--------------------------------|
| Ø4 X 16 Torx screw | 1.5 ± 0 N•m (13 ± 0 lbf•in) |

10. Close lower tray to ease access.



11. Remove and keep the central Ø5 X 9 Flat Head Torx screws from the reinforcement bracket.



12. Remove the 4 remaining Ø4 X 16 Torx screws from the reinforcement bracket.

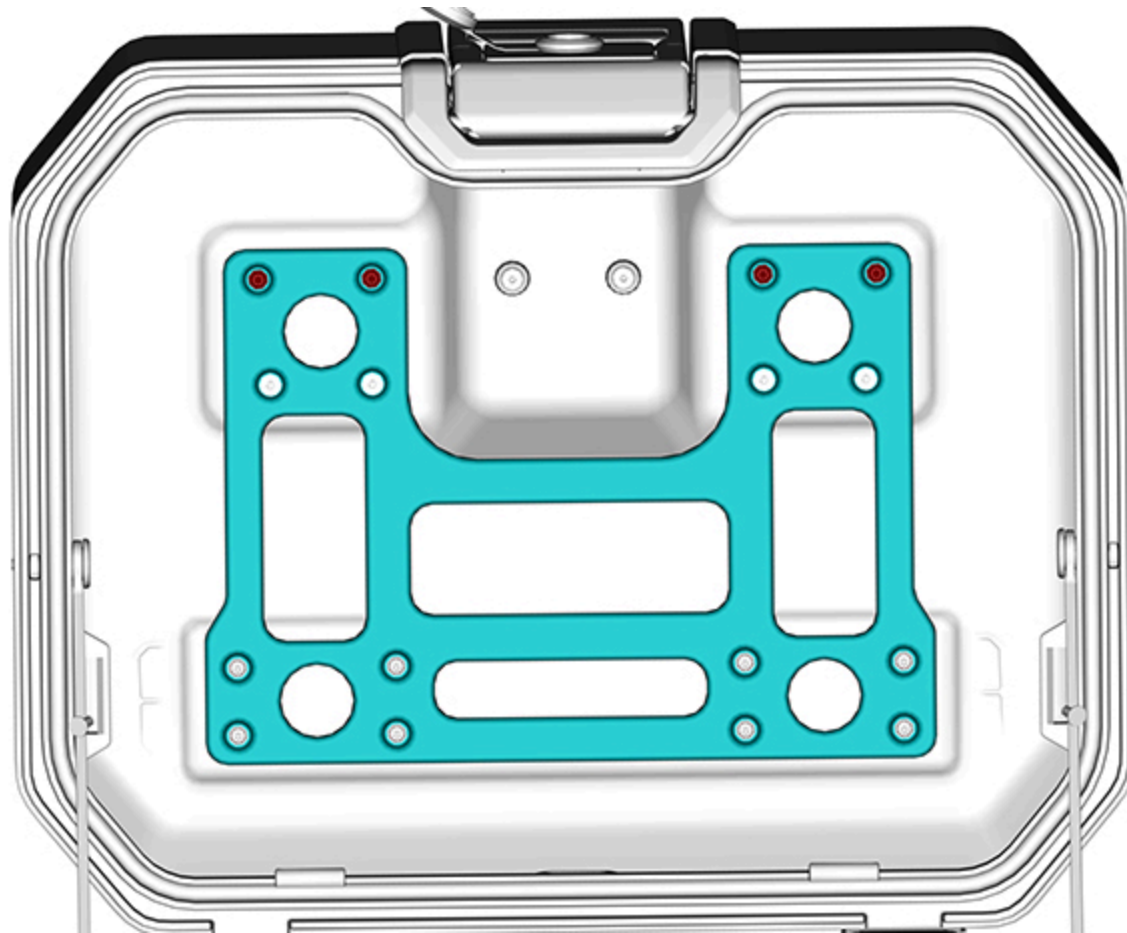

13. Remove the 2 M5 X 12 Flat Head Torx screws.

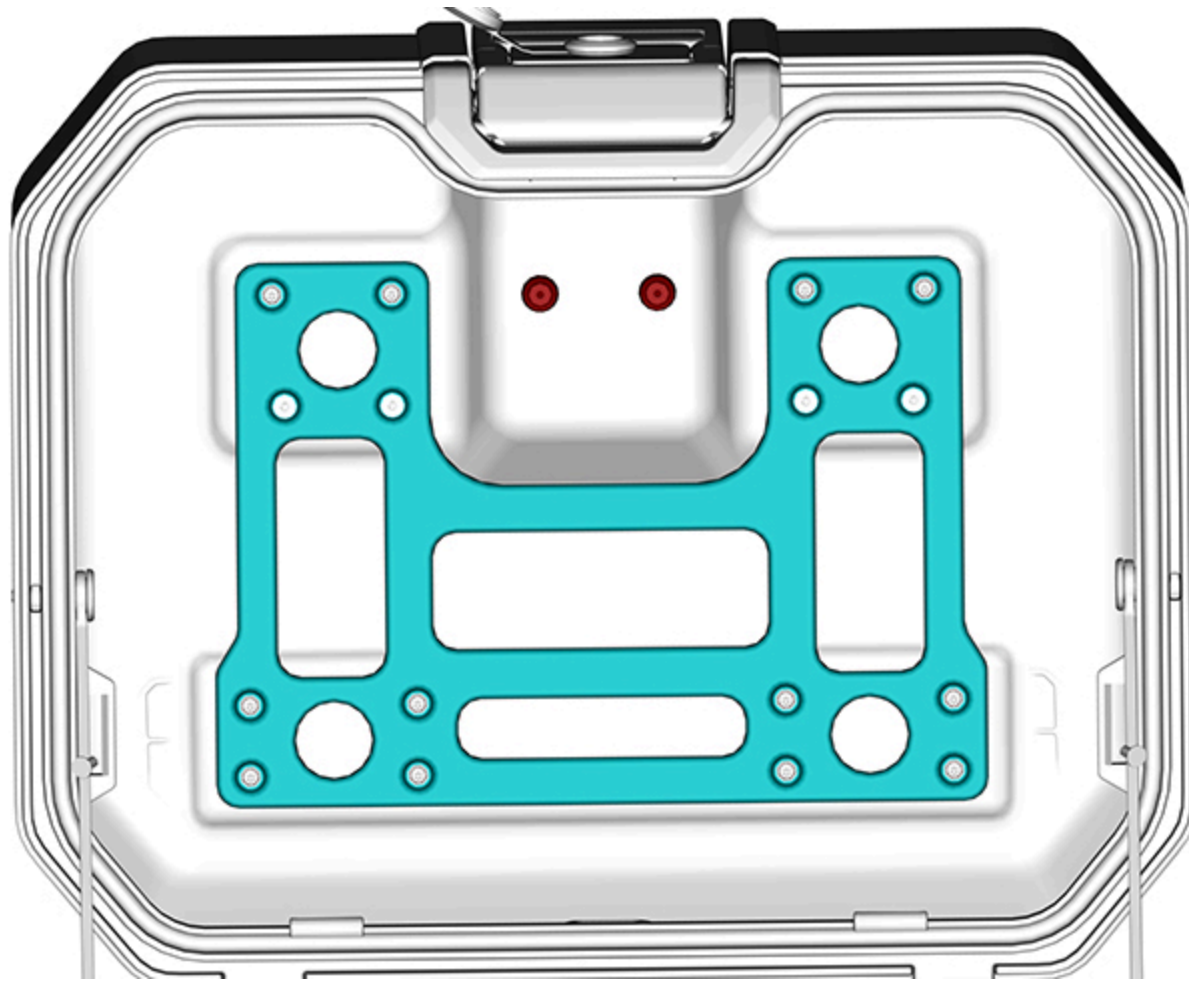

14. Remove the two Ø4 X 16 Torx screws from the inner latch support.

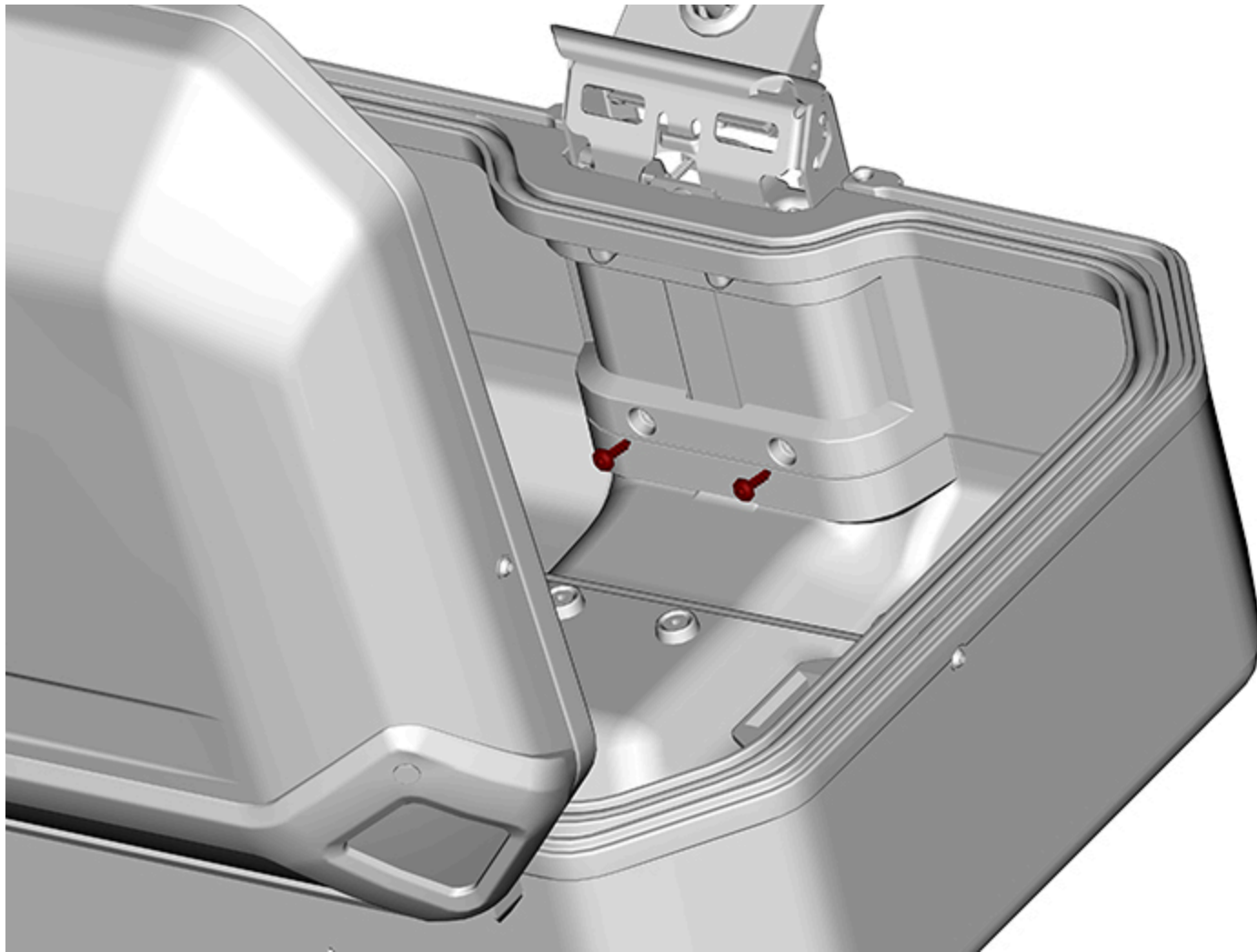

15. Remove the two upper handle Ø4 X 16 Torx screws and washers.

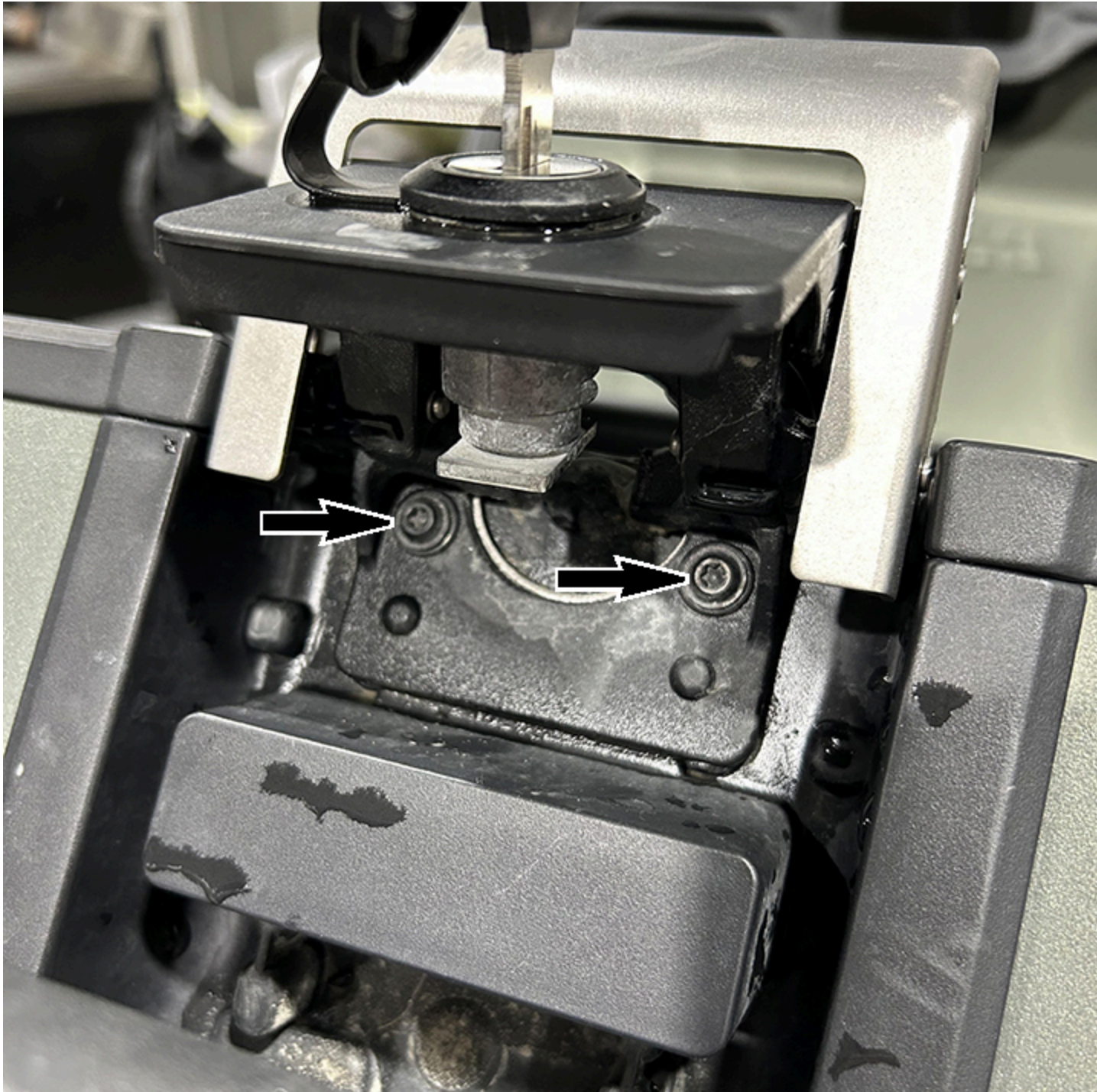

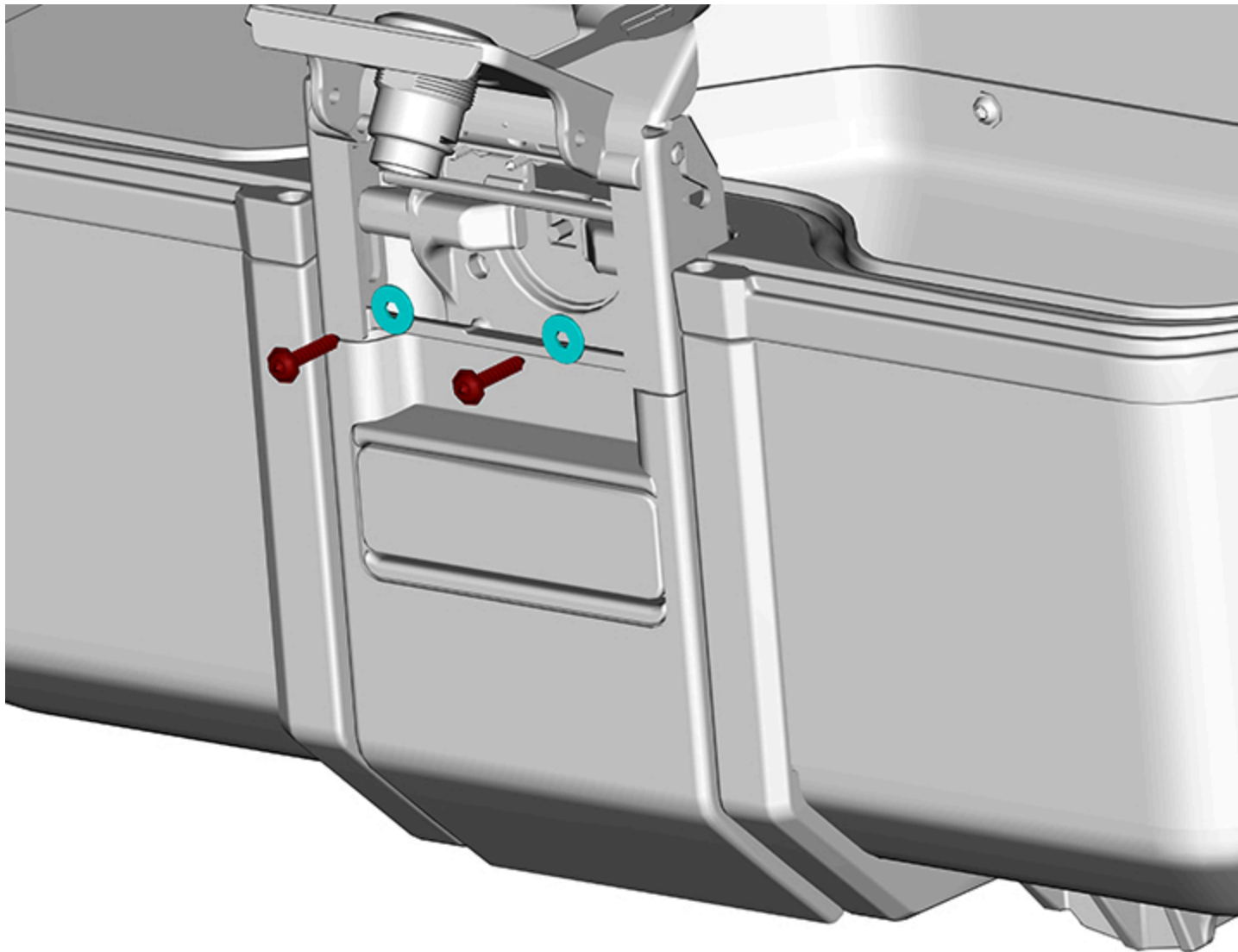

16. Remove the two screws near the handle.

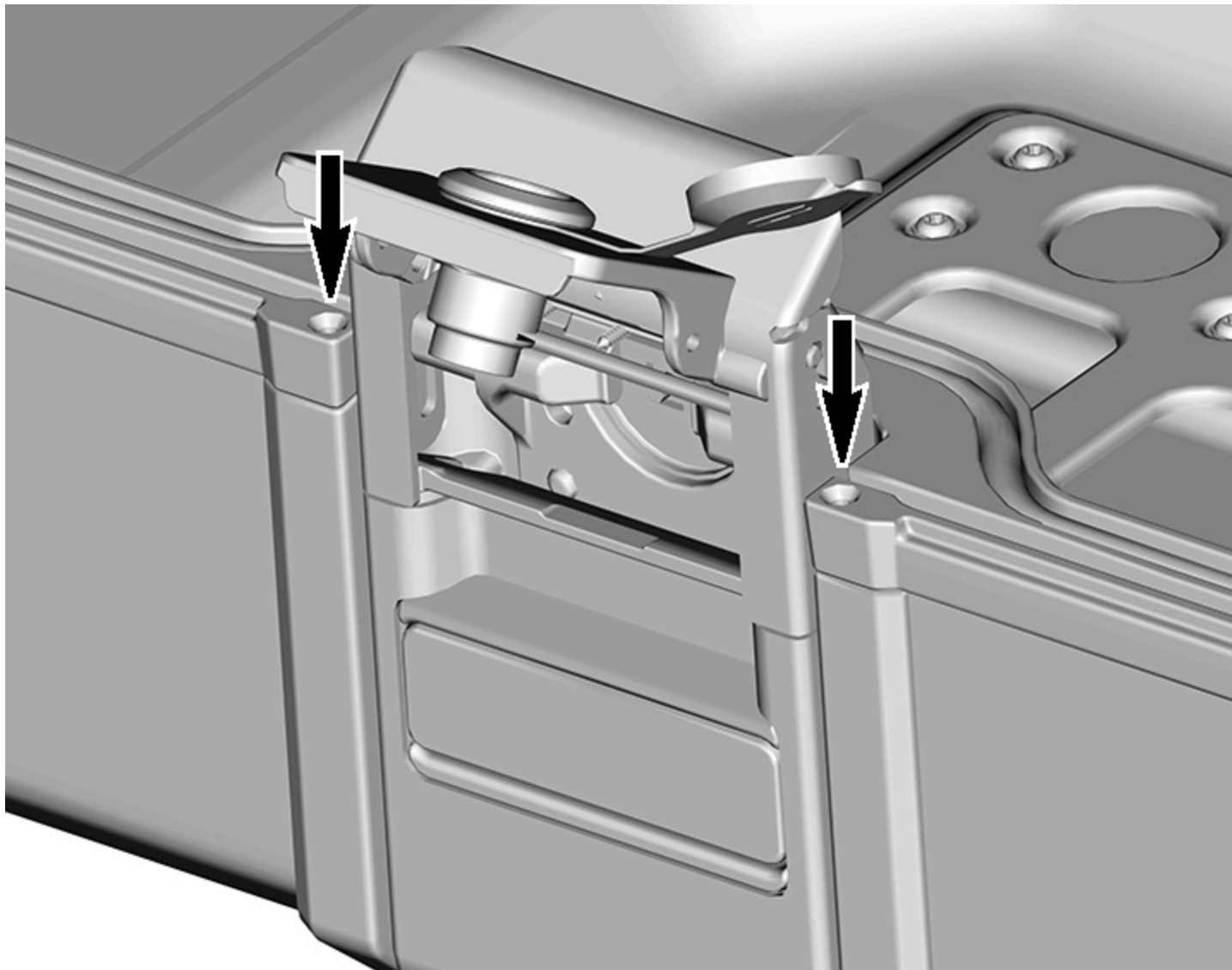



17. Remove the latch mechanism from the saddlebag by sliding it downwards.

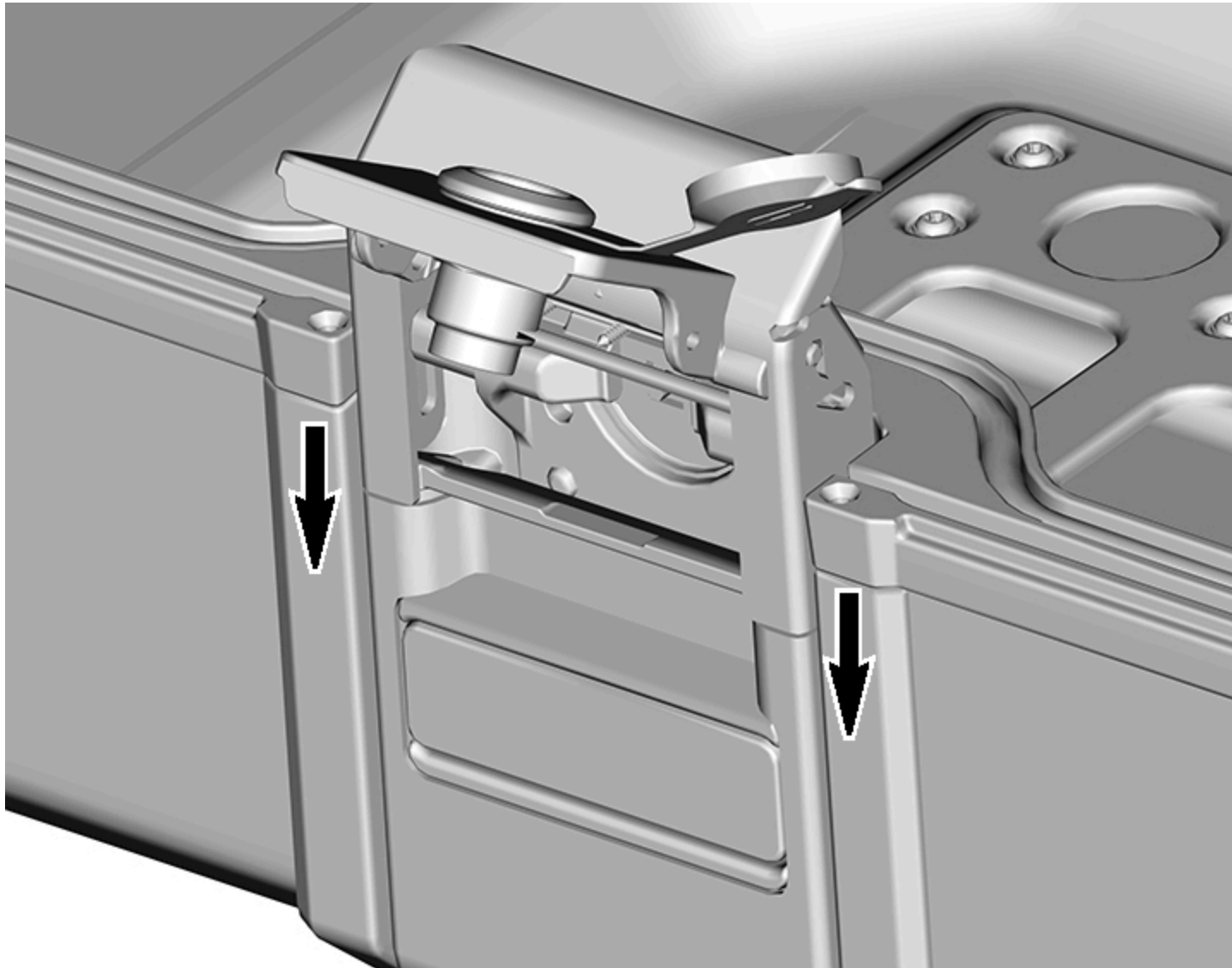

18. Clean surface with isopropyl alcohol and glue a neoprene seal at each of the 10 screw locations.

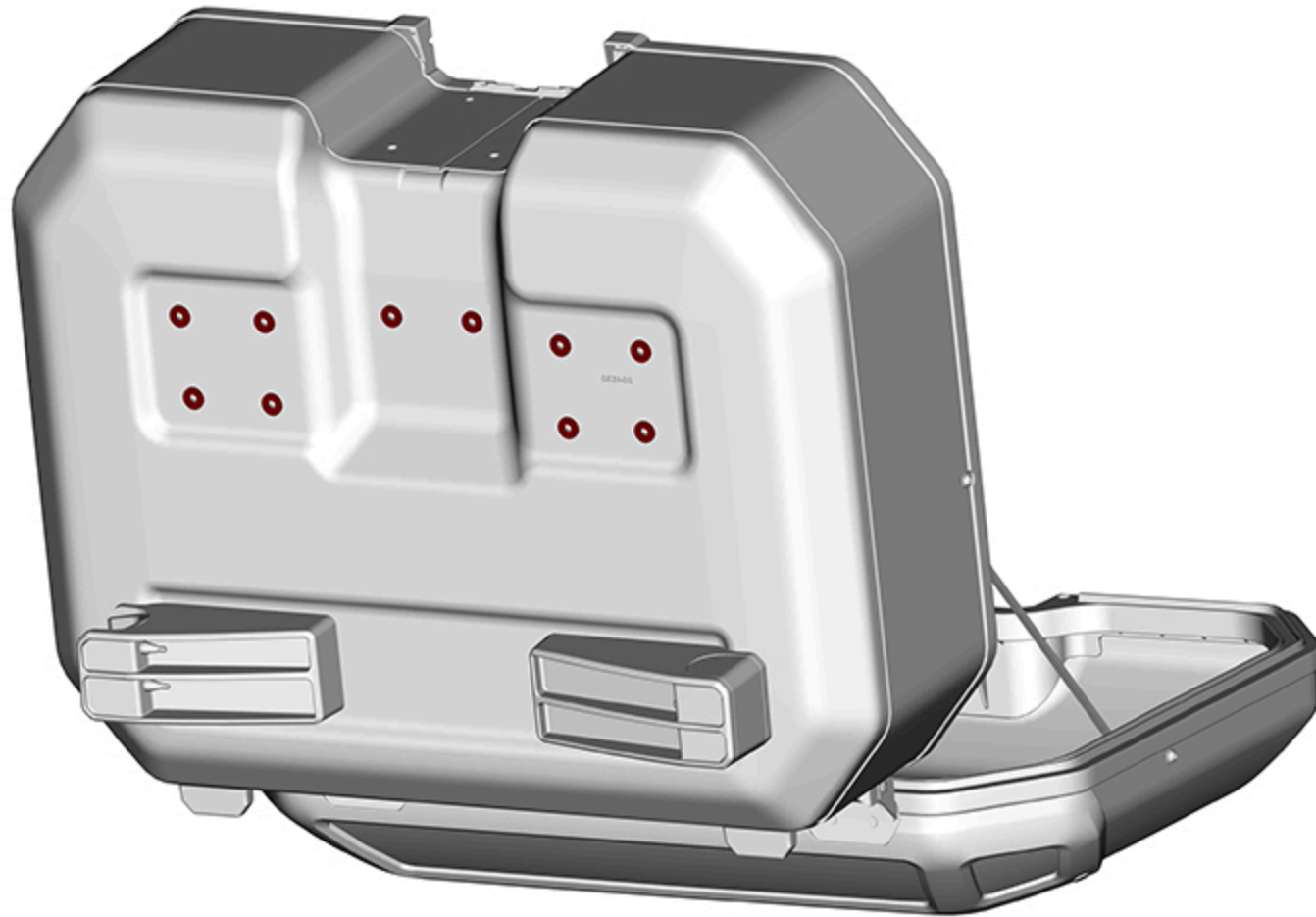

19. Install 4 new Panel nuts onto the latch mechanism.

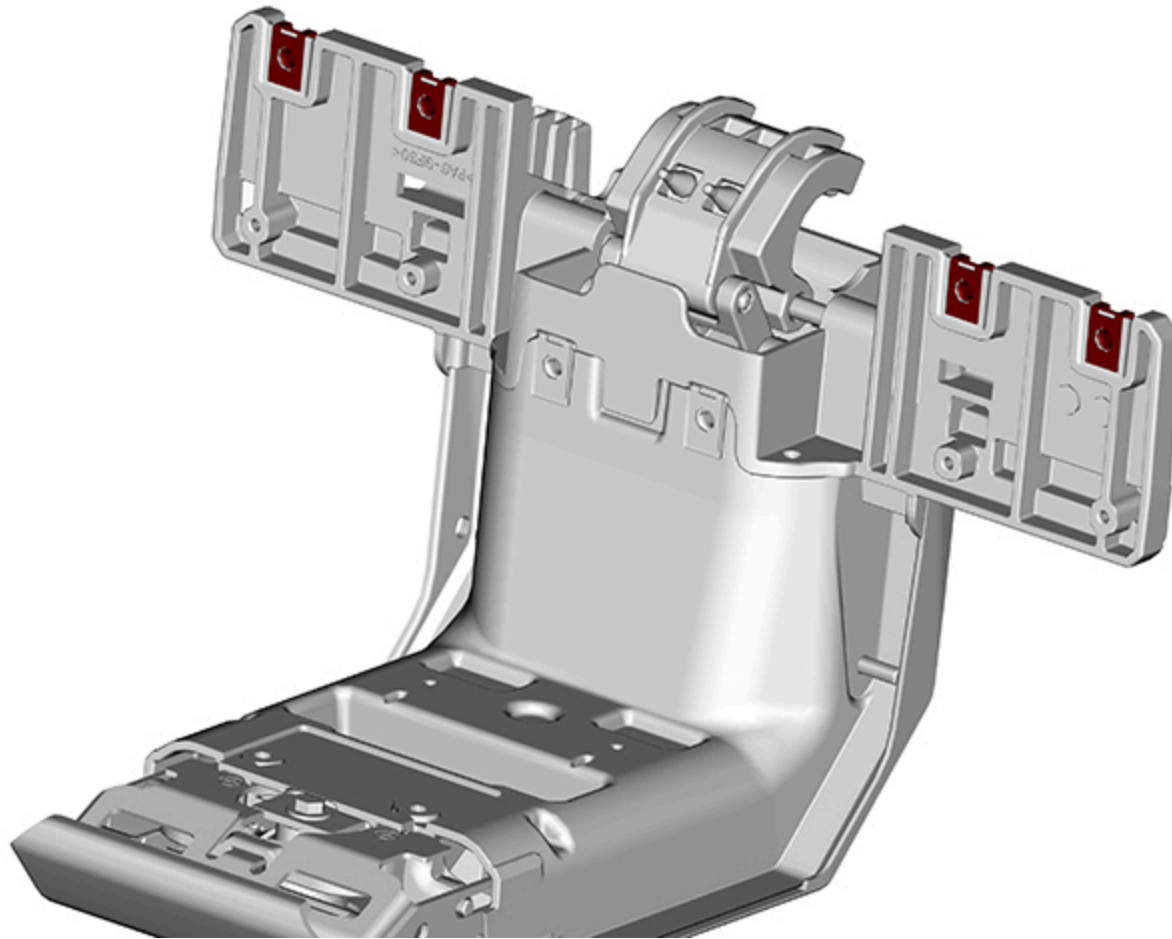

20. Slide the latch mechanism upwards back in place.
21. Reinstall the latch mechanism two near handle screws.

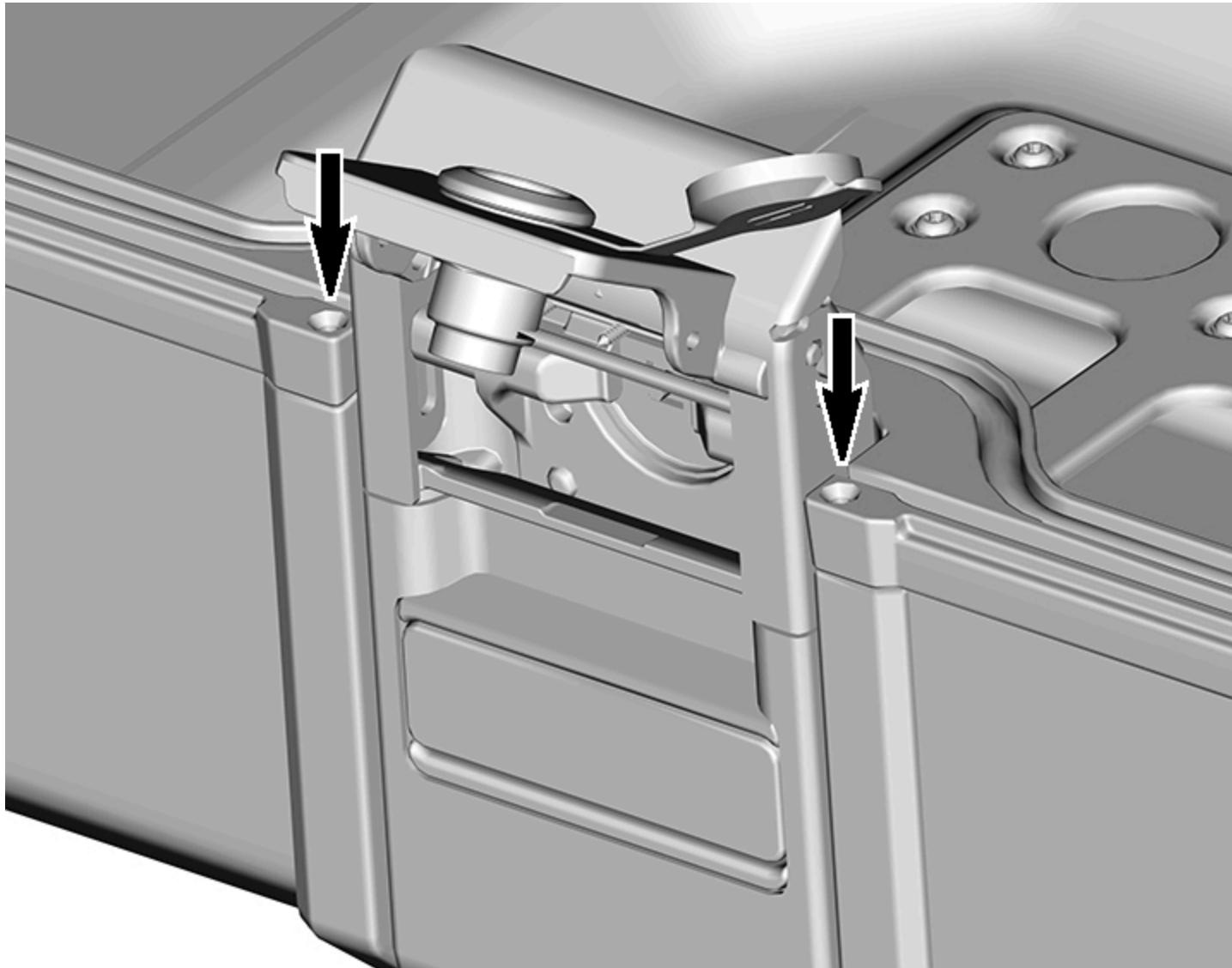

| TIGHTENING TORQUE | |
|------------------------|---------------------|
| Near handle screws (2) | Finger tighten only |

22. Reinstall the two upper handle Ø4 X 16 Torx screws (with washers).

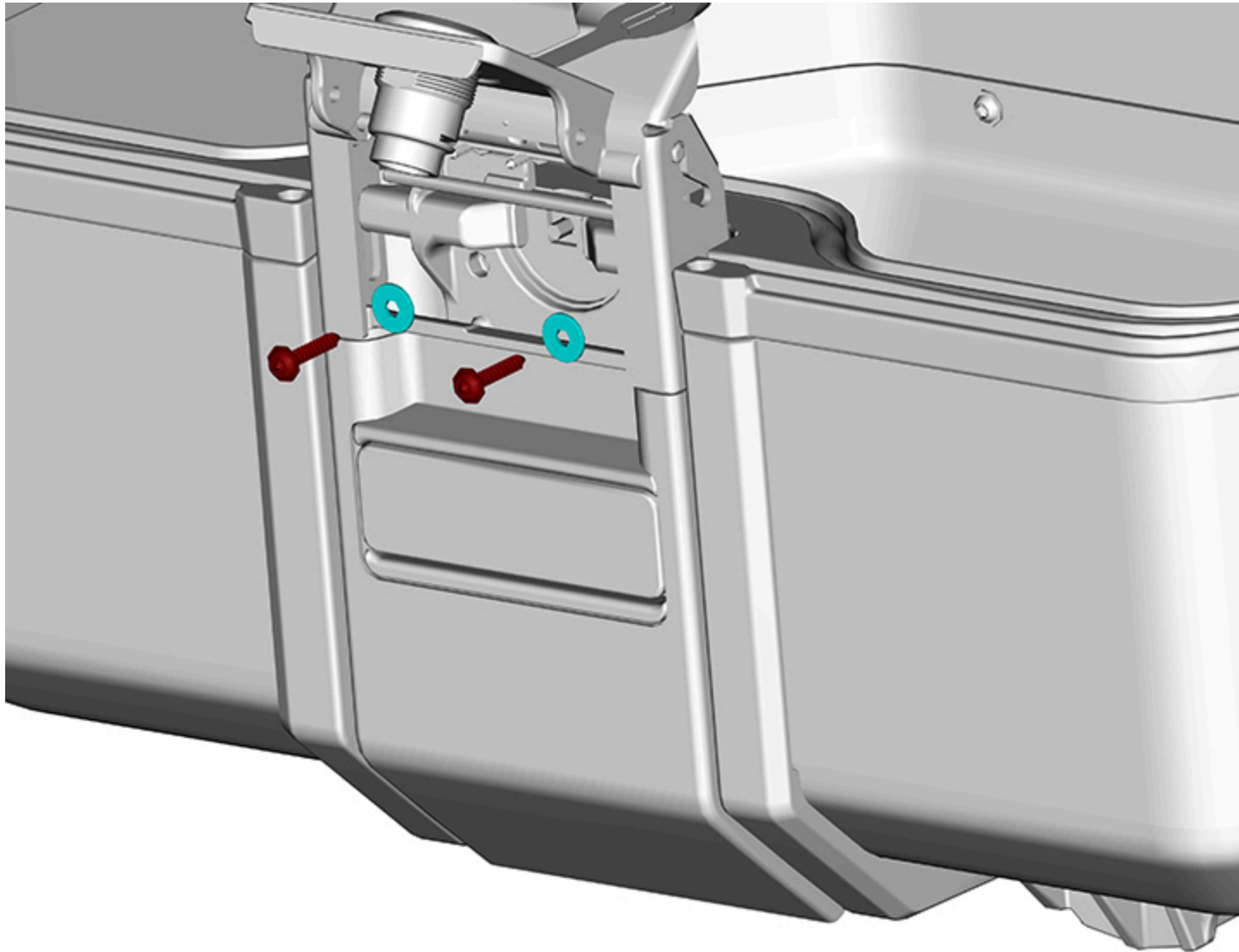

| TIGHTENING TORQUE | |
|---|----------------------------------|
| Upper handle Ø4 X 16 Torx screws (with washers) (2) | 1.5 ± 0.1 N•m (13 ± 1 lbf•in) |

23. Reinstall the two Inner latch support Ø4 X 16 Torx screws.

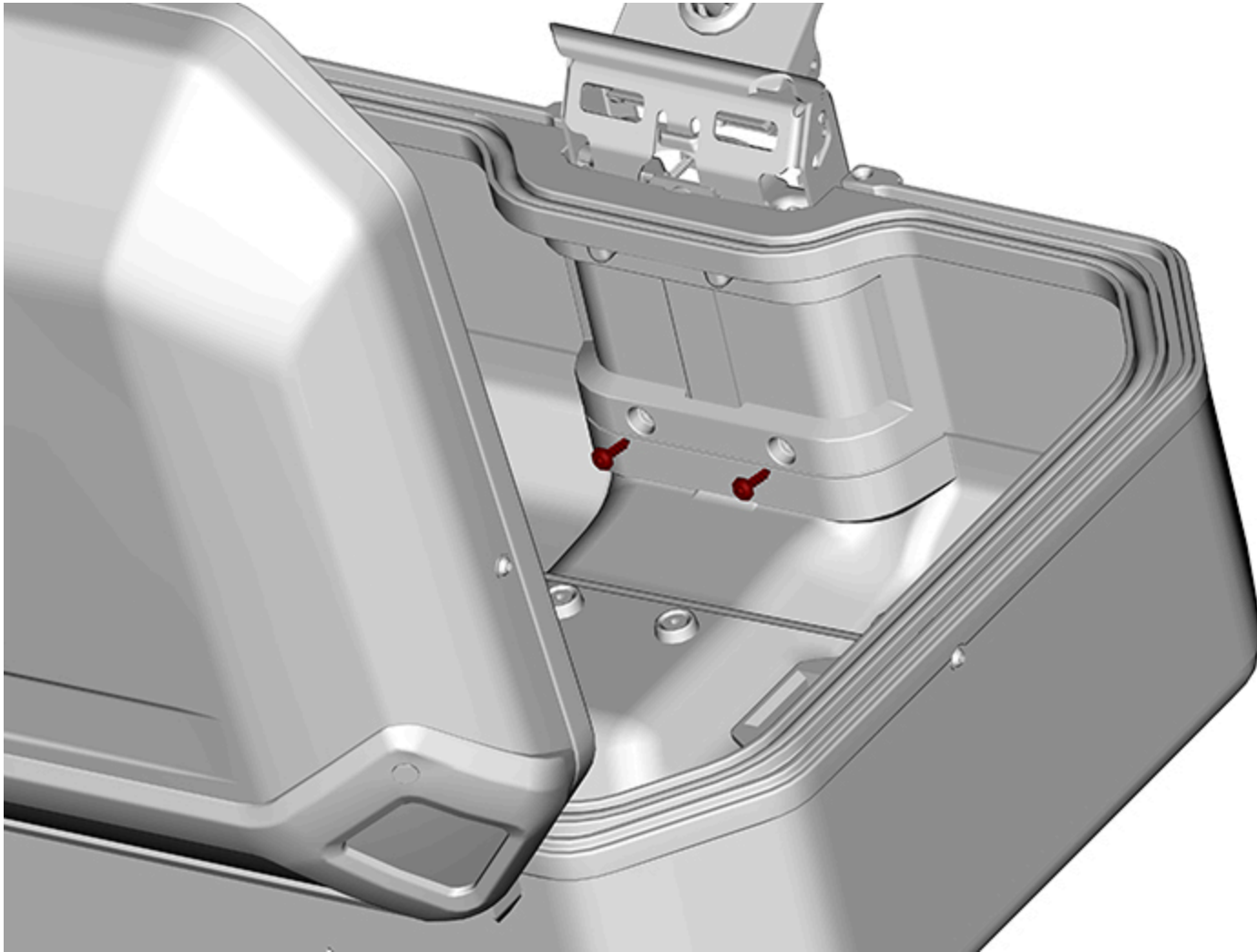

| TIGHTENING TORQUE | |
|---|---------------------|
| Inner latch support Ø4 X 16 Torx screws (2) | Finger tighten only |

24. Reinstall the Ø5 X 9 Flat Head Torx screws.



| TIGHTENING TORQUE | |
|-----------------------------|----------------------------------|
| Ø5 X 9 Flat Head Torx screw | 3.0 ± 0.1 N•m (27 ± 1 lbf•in) |

25. Reinstall Ø4 X 16 Torx screws.

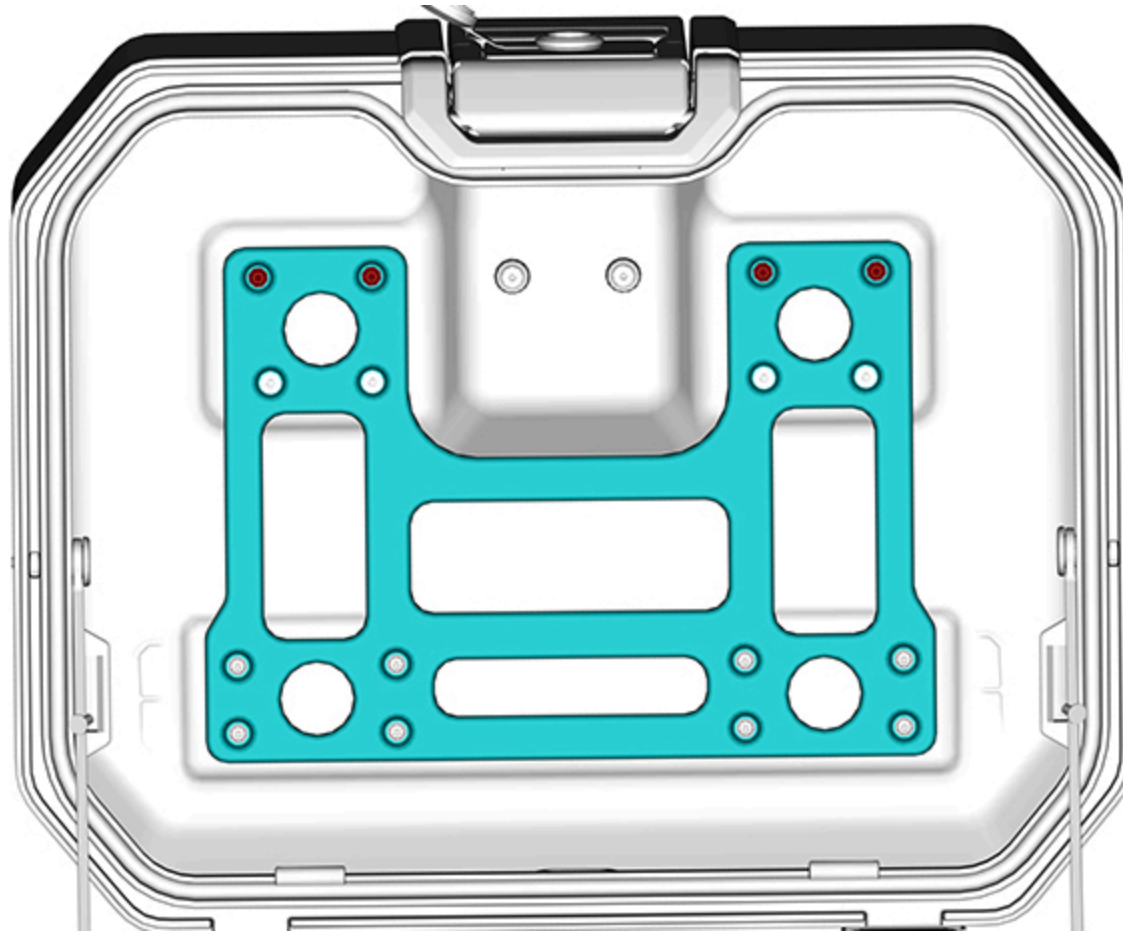

| TIGHTENING TORQUE | |
|--------------------|----------------------------------|
| Ø4 X 16 Torx screw | 1.5 ± 0.1 N•m (13 ± 1 lbf•in) |

26. Reinstall M5 X 12 Flat Head Torx screws.

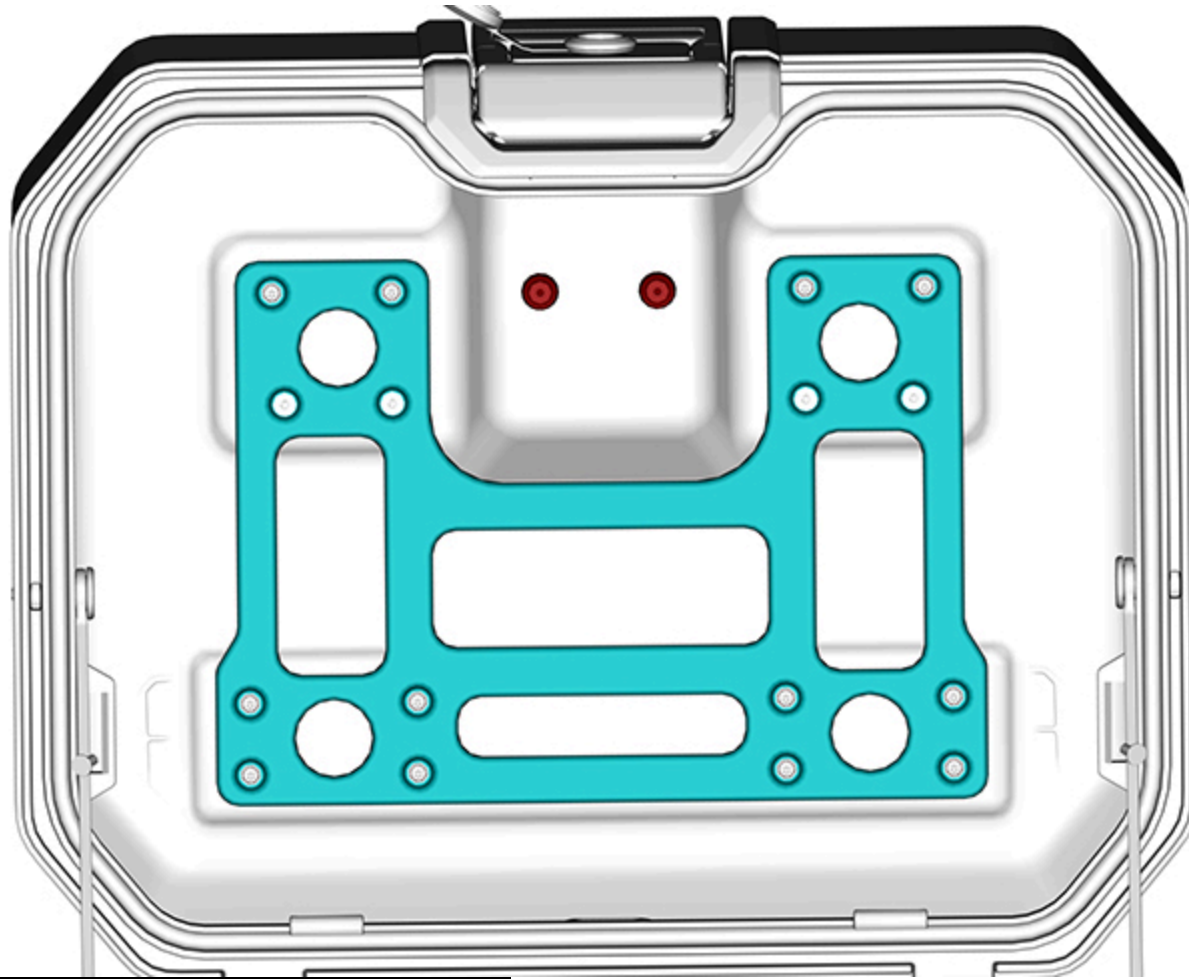

| TIGHTENING TORQUE | |
|-------------------------|----------------------------------|
| M5 X 12 Hexagonal screw | 1.5 ± 0.1 N•m (13 ± 1 lbf•in) |

27. Open lower tray again to ease access to the seam between the two halves of the saddlebag.

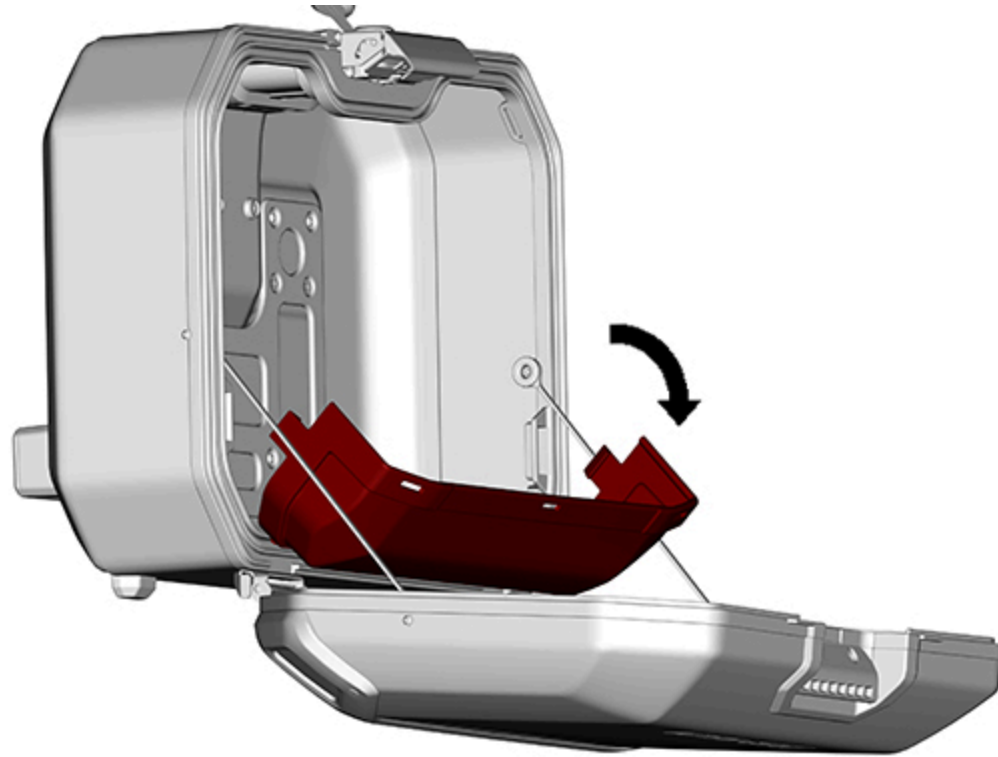

28. Clean the seam surface using isopropyl alcohol.
29. Apply a bead of sealant (3M 730) on all 4 corners of the seam between inner and outer halves of the saddlebag.

**NOTE**

The sealant should extend at least 25 mm (1 in) past the central section on each side.

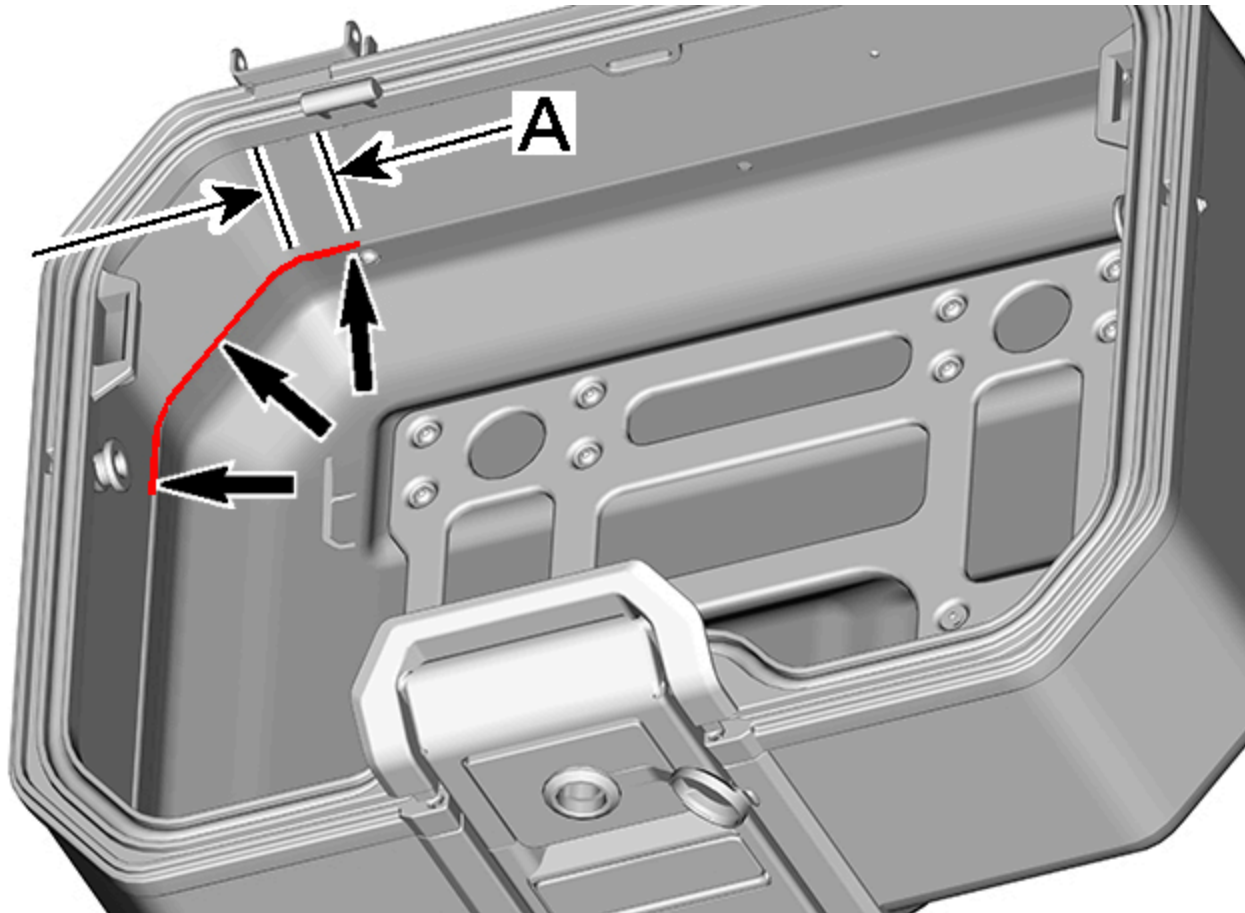

- A = 25mm (1 in) minimum

30. Close lower tray. Close cover. Reinstall saddlebag.

NOTICE

When closing the cover, make sure the straps are not twisted, they can be untwisted by turning around their pivot points. If the straps are twisted, they will tend to fold over the cover seal and prevent proper water tightness.



1

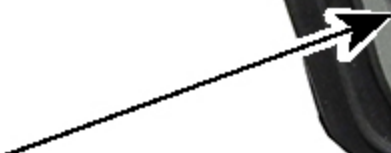

1. Avoid twisted strap

NOTICE



When removing saddlebag from the vehicle, release handle without opening the saddlebag to prevent water to drip inside. Some water may accumulate within the recess of the handle mechanism. This is not water intrusion inside the saddlebag.

WARRANTY

Submit a warranty claim using the following information.
For claiming procedure, refer to the online *Dealer/Distributor Warranty Guide*.

With BOSSWeb

| CLAIM DETAILS | |
|-------------------------------|---|
| Product Line | Roadster |
| Unit Model Year | 2025 |
| Campaign/Bulletin/Description | 5 / 2025-5 / CANYON saddle bags watertightnes |

| CLAIM DETAILS | |
|--|------------------|
| <div style="display: flex; justify-content: space-around; align-items: center;"> <div style="text-align: center;"> <p>*Action</p> <p>Inspect</p>  </div> <div style="text-align: center;"> <p>Repair</p>  </div> </div> | |
| Total Labor Time Paid | 1.2 hours |
| Expiration Date | October 31, 2028 |

With Warranty on Demand

| CLAIM DETAILS | |
|-----------------------|---|
| Claim Type | Unit Campaign |
| Serial Number | Enter Serial Number |
| Warranty Campaign | Select <i>Canyon saddle bags watertightness improvement / BULLETIN 2025-5 / 3WV-2025-0005</i> from the drop-down list |
| Date of Repair | Repair date |
| Total Labor Time Paid | 1.2 hours |
| Expiration Date | October 31, 2028 |

[PRINTABLE PDF VERSION.pdf](#)