

**WRF7 - Replacing Charging Cable and Updating Porsche Mobile Charger Software (Workshop Campaign)**

Vehicle Type: **Panamera 4 E-Hybrid (971)  
Cayenne E-Hybrid (9YA)**

Model Year: **As of 2019 up to 2020**

Concerns: **Charger (Porsche Mobile Charger)**

Cause: **A connection cable (domestic electrical system network connection) was installed for the Porsche Mobile Charger for the affected customers, which does not meet the required specifications.**  
As a result, the requirements necessary for certification are not met.

Action: Carry out the following work:

- Re-program the software of the Porsche Mobile Charger (Powerboard) with the latest PIWIS Tester software
- Attach new charging cable to the vehicle or submit it to the customer
- Assign the appropriate service provider to remove the charging cable (domestic power supply) for the customer and retrofit a socket

Minimum requirement: Release **43.600.000**



**Information**

Please note that the new charging cables are equipped with a temperature sensor. In order to use the new charging cable together with the Porsche Mobile Charger (ICCPD), a software update of the Porsche Mobile Charger (Powerboard) **must** be carried out. **Without** the new software, the charging cables are not functional.



**Information**

The service provider can, after consultation with the responsible Porsche Center, be commissioned independently by the relevant customer if necessary.

We recommend that the service provider carry out the activities as soon as possible or ideally on the same day as the work in the Porsche Center.

Please explicitly remind the customer in advance to bring along the Porsche Mobile Charger **to the appointment.**

Affected Vehicles: Only vehicles assigned to the campaign (see also PCSS Vehicle Information).

**Required parts****Information**

If the type of socket is known, only **one** appropriately suitable cable must be submitted to the customer. Otherwise, both cables can be subsequently submitted to the customer.

Part No.	Designation	Quantity
7PP971678FT	⇒ Charging cable for mains socket (NEMA 6-50)	1 piece
<b>and / or</b>		
7PP971678HG	⇒ Charging cable for mains socket (NEMA 14-50)	1 piece
WRF70000001*	Processing via service providers	1 piece

\*For the costs incurred by the service provider for the rework carried out by the customer during warranty processing in the warranty claim, **the part no. WRF70000001**, enter designation "**Processing via service provider**" as **an additional part**.

The invoice of the service provider must **without fail** be attached to the warranty claim.

**Required tools**

- Tools:
- **P90999 - PIWIS Tester 4** with test software version **43.600.000** (or higher) installed.
  - **Diagnostic adapter for high-voltage charging system**

**Re-program the Porsche Mobile Charger (Powerboard)****WARNING****Unsecured load**

- **An unsecured, incorrectly secured or incorrectly positioned charger can slip out of place and endanger occupants when braking, accelerating, changing direction or in the event of an accident.**
- ⇒ **Never transport the charger unsecured.**
- ⇒ **Stow the charger in the charging bag in the luggage compartment.**
- ⇒ **Always transport the charging bag in the luggage compartment, never in the passenger compartment (e.g. on or in front of the seats).**

Action: 1 Re-program the Porsche Mobile Charger (Powerboard).

- 1.1 Fasten previously ordered charging cable  
 ⇒ *Connecting diagnostic adapter -1-* to the **diagnostic adapter for high-voltage charging system** ⇒ *Connecting diagnostic adapter -2-* and connect the charging system to the charger (Porsche Mobile Charger) ⇒ *Connecting diagnostic adapter -3-*.
- 1.2 Connecting charging cable to power supply.

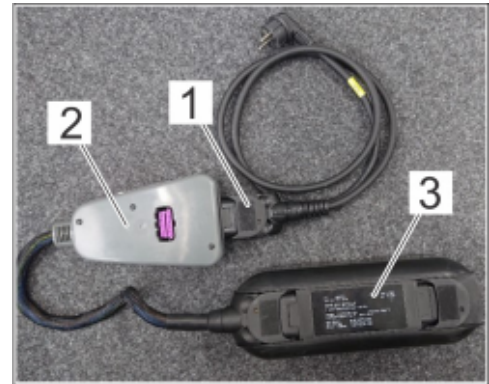

*Connecting diagnostic adapter*

- 1.3 Wait at least 3 minutes before connecting **P90999 - PIWIS Tester 4** to the vehicle communication module (VCI) via the **USB cable** and connect the communication module ⇒ *Connecting communication module (VCI) -1-* to the **diagnostic adapter for high-voltage charging system** ⇒ *Connecting communication module (VCI) -2-*.

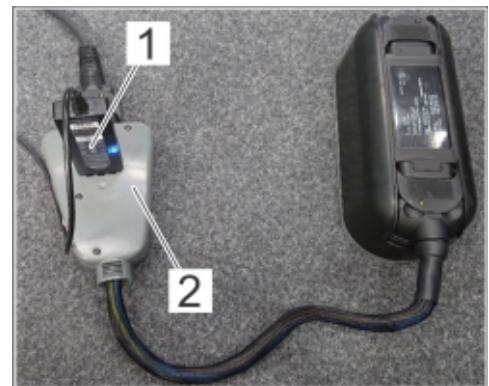

*Connecting communication module (VCI)*

- 1.4 On the PIWIS Tester start screen, call up the **'Diagnostics'** application.  
  
 The vehicle type is then read out, the diagnostic application is started and the control unit selection screen is populated.
- 1.5 On the **"Manual model line selection"** screen, select the **"External components"** model line and confirm with **"Next"**.
- 1.6 Select **'Universal charging cable'** and confirm with **'Next'**.
- 1.7 Select **'Automatic programming'** and follow further instructions.

1.8 **Re-program the Powerboard.**

The basic procedure for control unit programming is described in the Workshop Manual ⇒ *Workshop Manual '9X00IN Basic instructions and procedure for control unit programming using the PIWIS Tester'*.

**For specific information on programming the power board during this campaign, see the table below:**

Required PIWIS Tester software release:	<b>43.600.000</b> (or higher)
Type of control unit programming:	Control unit programming using the <b>'Automatic programming'</b> function of the Porsche Mobile Charger (Powerboard)
Programming sequence:	Read and follow the <b>information and instructions on the PIWIS Tester</b> during the guided programming sequence.  <b>Do not interrupt the programming and coding process.</b>  A backup documentation process for the re-programmed software releases starts after programming and coding.
Programming time (approx.):	<b>5 minutes</b>
Software release programmed during this campaign:	<b>0630</b>  When programming is complete, the software release can be read out of the charger (Porsche Mobile Charger) in the menu "Extended identifications" using the PIWIS Tester.
Procedure in the event of termination of control unit programming:	Repeat programming.
Procedure if error messages appear during the programming sequence:	⇒ <i>Workshop Manual '9X00IN Basic instructions and procedure for control unit programming using the PIWIS Tester - section on "Troubleshooting"</i> .

1.9 Remove the PIWIS Tester from the charger (Porsche Mobile Charger).

1.10 Disconnect the charging cable from the power supply and remove it from the diagnostic adapter.

1.11 Remove the PIWIS Tester from the charger (Porsche Mobile Charger).

2 Put charging cable (Porsche Mobile Charger) and ordered charging cable in the vehicle.

3 Enter the campaign in the warranty and maintenance logbook.

Replacing charging cable



**Information**

The new charging cable (for mains socket) is enclosed with the vehicle or handed over to the customer together with the updated Porsche Mobile Charger. The charger can be connected at the customer's home independently by the customer.

The **charging cable permanently installed in the domestic electronics (domestic power supply) must be removed and disposed of by a corresponding service provider.** After the latter has removed the permanently installed charging cable (domestic power supply), NEMA-5 socket (common mains socket) is installed at the same location by the same service provider. ⇒ *Overview of charging structures*

All costs can be invoiced using the procedure described.

For further information on invoicing, see: ⇒ *Technical Information '9X00IN Warranty processing'.*

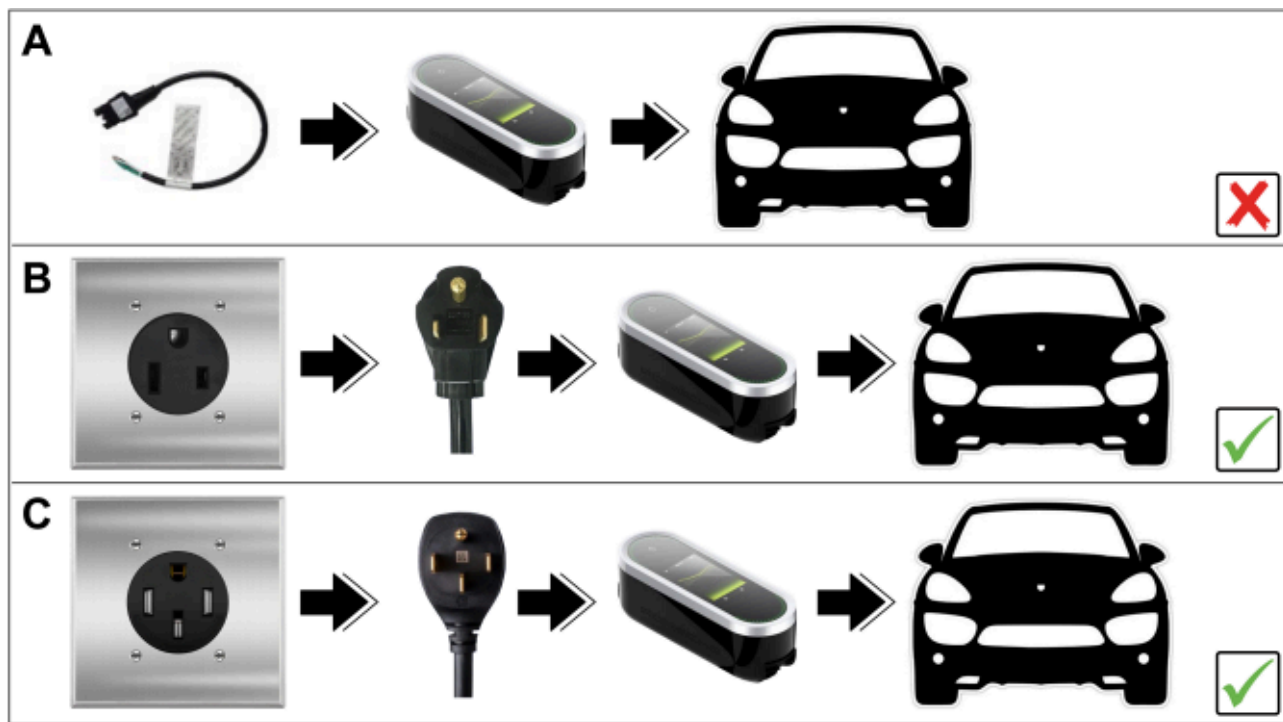

*Overview of charging structures*

- A – Charging structure **before** adjustment
- B – Charging structure **after** adjustment (NEMA 6-50)
- or
- C – Charging structure **after** adjustment (NEMA 14-50)

**Warranty processing****Information**

The stated labor time was determined specifically for carrying out this Campaign and includes all necessary preliminary work and rework. The labor time may differ from the labor times published in the Labor Operation List in PCSS.

Scope 1:

**Replacing charging cable and updating Porsche Mobile Charger software****Labor time:**

Replacing charging cable and updating Porsche Mobile Charger software

Labor time: **48 TU**

Includes: Connecting and disconnecting diagnostic adapter for high-voltage charging system  
Connecting and disconnecting PIWIS Tester  
Re-program the power board

**Required parts:**

7PP971678FT	Charging cable for mains socket (NEMA 6-50)	1 piece
<b>and / or</b>		
7PP971678HG	Charging cable for mains socket (NEMA 14-50)	1 piece
WRF70000001*	Service provider processing	1 piece

\*For the costs incurred by the service provider for the rework carried out by the customer during warranty processing in the warranty claim, **the part no. WRF70000001**, enter designation "**Processing via service provider**" as **an additional part**. The invoice of the service provider must **without fail** be attached to the warranty claim.

⇒ **Damage number WRF7 066 000 2**

**Important Notice:** Technical Bulletins issued by Porsche Cars North America, Inc. are intended only for use by professional automotive technicians who have attended Porsche service training courses. They are written to inform those technicians of conditions that may occur on some Porsche vehicles, or to provide information that could assist in the proper servicing of a vehicle. Porsche special tools may be necessary in order to perform certain operations identified in these bulletins. Use of tools and procedures other than those Porsche recommends in these bulletins may be detrimental to the safe operation of your vehicle, and may endanger the people working on it. Properly trained Porsche technicians have the equipment, tools, safety instructions, and know-how to do the job properly and safely. Part numbers listed in these bulletins are for reference only. The work procedures updated electronically in the Porsche PIWIS diagnostic and testing device take precedence and, in the event of a discrepancy, the work procedures in the PIWIS Tester are the ones that must be followed.

© 2025 Porsche Cars North America, Inc.