

**Sports Tailpipe – Silver (OP3) / Dark Bronze (OP6)**



**Information**

Models/vehicles not listed here are included in the supplements to the relevant EC type approval.



**Information**

Please give the customer a copy of the first pages of these Installation and Conversion Instructions, including the legal regulations.

Vehicle Type: **Panamera / Panamera 4 / Panamera 4 E-Hybrid / Panamera 4S E-Hybrid**  
including associated **Executive** variants

Model Year: **As of 2024**

- Engine Types:
- **CSZD** (basic engine – TV8 / D8Y) = 2.9-liter V6 biturbo = 260 kW (353 hp) ⇒ Panamera / Panamera 4
  - **DGPD** (basic engine – TV8 / D8Y) = 2.9-liter V6 biturbo = 260 kW (353 hp) – system power: 400 kW (544 hp) ⇒ Panamera 4 S E-Hybrid
  - **DGPE** (basic engine – TV8 / D8X) = 2.9-liter V6 biturbo = 224 kW (304 hp) – system power: 346 kW (470 hp) ⇒ Panamera 4 E-Hybrid

Restrictions: Sports tailpipe silver (OP3) is **NOT** released for Panamera 4S E-Hybrid / Panamera Executive 4S E-Hybrid!

Cause: **Retrofitting**



Figure 1

Notes: The tailpipes for the standard exhaust system on the vehicles specified above can be replaced by new sports tailpipes in silver (OP3) or dark bronze (OP6). ⇒ *Figure 1*

The sports tailpipes are also available straight from the factory for new vehicles by requesting the relevant individual equipment.

## Parts Info:

**ONLY** for basic vehicles:

**976.044.200**

⇒ Sports tailpipe – silver, set

**976.044.200.A**

⇒ Sports tailpipe – dark bronze, set

**ONLY** for E-Hybrid vehicles (OK3):

**976.044.201**

⇒ Sports tailpipe – silver, set

**976.044.201.A**

⇒ Sports tailpipe – dark bronze, set

## Parts List:

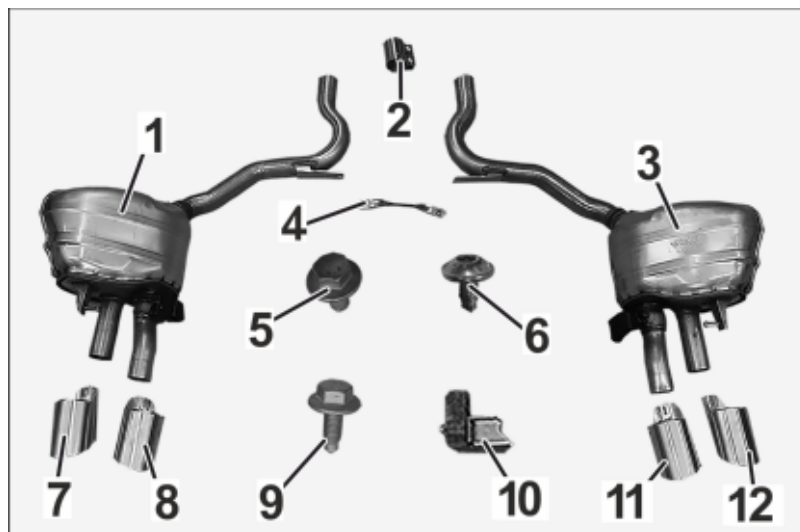

Figure 2

|                             |     |  |
|-----------------------------|-----|--|
| 976.253.601.FY <sup>1</sup> | 1 x | Rear silencer, left – Hybrid (OK3) ⇒ <i>Figure 2 -1-</i>   |
| 976.253.601.BY <sup>1</sup> | 1 x | Rear silencer, left (not shown)                            |
| PAB.111.220                 | 2 x | Clamping sleeve, 60 x 88 mm ⇒ <i>Figure 2 -2-</i>          |
| 976.253.600.FY <sup>1</sup> | 1 x | Rear silencer, right – Hybrid (OK3) ⇒ <i>Figure 2 -3-</i>  |
| 976.253.600.BY <sup>1</sup> | 1 x | Rear silencer, right (not shown)                           |
| PAE.253.521                 | 1 x | Strut ⇒ <i>Figure 2 -4-</i>                                |
| N.910.793.01                | 4 x | Hexagon-head bolt, M8 x 16 ⇒ <i>Figure 2 -5-</i>           |
| 9A7.008.019.00              | 4 x | Countersunk screw M6 x 12 ⇒ <i>Figure 2 -6-</i>            |
| 9A7.253.823.20 <sup>1</sup> | 1 x | Sports tailpipe – silver, outer left ⇒ <i>Figure 2 -7-</i> |
| 9A7.253.823.25 <sup>1</sup> | 1 x | Sports tailpipe – silver, inner left ⇒ <i>Figure 2 -8-</i> |

|                             |     |  |
|-----------------------------|-----|--|
| N.909.210.02                | 4 x | Hexagon-head bolt, M8 x 22 ⇒ <i>Figure 2 -9-</i>             |
| 9A7.253.245.10              | 2 x | Bracket (rear silencer) ⇒ <i>Figure 2 -10-</i>               |
| 9A7.253.824.25 <sup>1</sup> | 1 x | Sports tailpipe – silver, inner right ⇒ <i>Figure 2 -11-</i> |
| 9A7.253.824.20 <sup>1</sup> | 1 x | Sports tailpipe – silver, outer right ⇒ <i>Figure 2 -12-</i> |
| 976.253.823.A <sup>1</sup>  | 1 x | Sports tailpipe – dark bronze, outer left (not shown)        |
| 976.253.823.B <sup>1</sup>  | 1 x | Sports tailpipe – dark bronze, inner left (not shown)        |
| 976.253.824.B <sup>1</sup>  | 1 x | Sports tailpipe – dark bronze, inner right (not shown)       |
| 976.253.824.A <sup>1</sup>  | 1 x | Sports tailpipe – dark bronze, outer right (not shown)       |

<sup>1</sup> **ONLY** contained in respective set.



### Information

**ONLY** in the event of repairs / replacement:

Items **WITH** / **WITHOUT** a part number in the parts list can be found / ordered from the Porsche Electronic Parts Catalogue = PET.

Pay attention to model year and vehicle equipment (I-no.) in the standard catalogue.

Tool:

- P90999 - P90999 - PIWIS Tester 4**
- Nr.166 - Chain-type pipe cutters**
- Nr.166-1 - Ratchet-type pipe cutters**
- Nr.90 Pos.1 - Torque wrench**
- Transmission and gearbox jack**
- Body saw**

Assembly:

- 1 Preparatory work
  - 1.1 Drive the vehicle onto a vehicle lift and connect a battery charger. ⇒ *Workshop Manual '2X00INC9 Battery trickle charging'*
  - 1.2 Raise the vehicle. ⇒ *Workshop Manual '4X00INA2 Raising the vehicle'*



### CAUTION

#### Hot components

- **Burns**
- ⇒ **Allow hot components to cool down.**
- ⇒ **Wear personal protective equipment.**

- 1.3 Remove standard tailpipes. ⇒ *Workshop Manual '263519A1 Removing and installing tailpipe trim'*

Remove rear silencer. (See also: ⇒ *Workshop Manual '263355A3 Replacing rear silencer'*)

1.3.1 Remove the rear underbody cover. ⇒ *Workshop Manual '519419A2 Removing and installing rear underbody cover'*

1.3.2 Remove hexagon-head bolt (M8 x 16; 2 x) on strut between the rear silencers (⇒ *Figure 5 -1-*) and remove strut.

- 1 – Installation position of strut
- 2 – Disconnection point
- 3 – Body saw
- 4 – Multiple-tooth countersunk screw, M8 x 22 (rear-end cross strut)

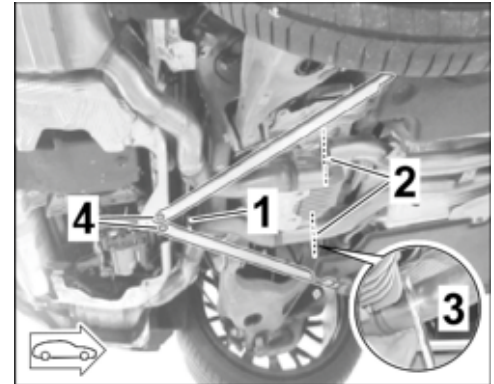

Figure 5

1.3.3 Remove hexagon-head bolts M8 (2 x) on rear-end cross strut (⇒ *Figure 5*). ⇒ *Workshop Manual '421319A3 Removing and installing struts (rear end)'*

1.3.4 Cut rear silencer at the connection point (marking on underside) using pipe cutters or **body saw**.

1.3.5 Release and disconnect plug connection for exhaust flap actuator (rear silencer on the left / right).



#### Information

- Before the rear silencer is released, the exhaust system must be supported with a transmission jack or held by another person.

1.3.6 Remove hexagon-head bolt M8 x 16 on rear silencer holder at the rear (on left / right).

1.3.7 Remove rear silencers (on left / right).

1.3.8 De-burr cut on inside and outside of front silencer.

If necessary, remove rust from exhaust pipe front silencer using suitable polishing agents and restore its round shape.

2 Replace rear silencers (left / right). (See also: ⇒ *Workshop Manual '263355A3 Replacing rear silencer'*)

2.1 Fit clamping sleeve,  $\varnothing 60 \times 88$  (2 x) on exhaust pipe for front silencer (on left / right).

2.2 Lift new rear silencer (left / right) into installation position and secure to the body using a hexagon-head bolt M8 x 22 (2 x).

#### Tightening torque 23 Nm (17 ftlb.)

2.3 Restore plug connection for exhaust flap actuator (rear silencer on the left / right).

- 2.4 Align the clamping sleeve ( $\varnothing$  60 x 88, 2 x) on the exhaust pipe on the front silencer/rear silencer (at the left/right) so that the clamping sleeve is not touching/rubbing at any point.  
⇒ *Figure 6*

- 1 – Clamping sleeve
- 2 – Hexagon nut M8

Tighten M8 hexagon nuts (2 x).  
**Tightening torque 33 Nm (24.3 ftlb.)**

- 2.5 Tighten multiple-tooth countersunk screws M8 (2 x) on the rear-end cross strut. ⇒ *Workshop Manual '421319A3 Removing and installing struts (rear end)'*

- 2.6 Loosely pre-install strut between the rear silencers using hexagon-head bolts M8 x 16 (2 x).

### 3 Installing Sports tailpipe

- 3.1 Slide the new sports tailpipes onto the relevant back silencer stub pipes as far as the screw point and preassemble by installing a new M6 x 12 pan-head screw **hand-tight**.



#### Information

If the (sports) tailpipes have to be moved to the right or left (in Z direction), this can only be done using the transverse strut between the rear silencers.

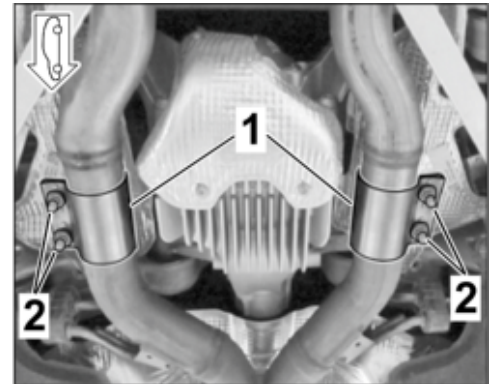

*Figure 6*

- 3.2 Check that the gap = "dimension Z" between the new sports tailpipes and exhaust system cover (rear bumper – left and right side of vehicle ⇒ *Figure 7 -Z-*) is symmetrically constant.

**Dimension Z** – symmetrical, constant all the way around with respect to exhaust system cover

**Dimension X** – equal projection (right side of vehicle)

Re-align sports tailpipes if necessary.



#### Information

The tailpipes are adjusted in X direction using the slots on the tailpipe cover.

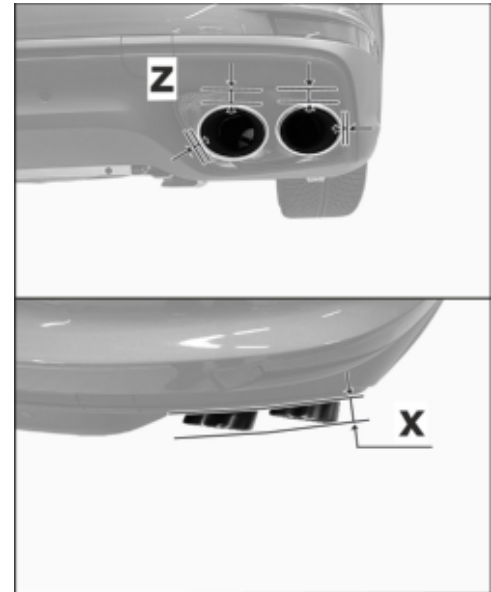

Figure 7

- 3.3 Check that the sports tailpipes have equal projection = "dimension X" with respect to the rear body panel (left and right side of vehicle ⇒ *Figure 7 -X-*). Re-align sports tailpipes if necessary.
- 3.4 Tighten lens-head screw, M6 x 12 on sports tailpipe cover.  
**Tightening torque 8 Nm (5.9 ftlb.) +/- 1 Nm (0.7 ftlb.)**

Coding: 4 Code/program sports tailpipes (OP3) / (OP6)

#### NOTICE

##### Voltage drop

- **Destruction of control unit**
  - **Damage to control unit**
  - **Fault entries in control unit**
  - **Control unit coding aborted**
  - **Malfunctions in the control unit, even during programming**
- ⇒ **Switch off the ignition and remove ignition key before disconnecting the control unit.**
- ⇒ **Make sure that the power supply is not interrupted during programming.**
- ⇒ **Connect a battery charger with a current rating of at least 90 A to the vehicle battery.**

## 4.1 Preparatory work – Coding

### NOTICE

**Control unit programming will be aborted if the WLAN connection is unstable.**

- **An unstable WiFi connection can interrupt communication between the PIWIS Tester and the vehicle communication module (VCI). As a result, control unit programming may be aborted.**
- ⇒ **During control unit programming, always connect the PIWIS Tester to the vehicle communication module (VCI) via the USB cable.**

4.1.1 Connect **P90999 - P90999 - PIWIS Tester 4** to the vehicle and switch it on.

4.1.2 Switch on ignition **AND** hazard warning lights on the vehicle.



### Information

The **PIWIS Tester** instructions take precedence since the description may be different with later Tester releases.

The procedure described here has been structured in general terms. Different text or additional information may appear on the **PIWIS Tester**.

4.1.3 Select the "Diagnostics" menu item on the PIWIS Tester.

4.1.4 If **P90999 - P90999 - PIWIS Tester 4** is connected correctly, a connection to the vehicle will be established: "Model series YA" is detected.

4.1.5 Press **F12** to go to the control unit search screen.

4.1.6 Question: "Should an FAP be created?" If "Yes", press **F12** to confirm.

4.1.7 Select "KD-FAP" in the next menu item and press **F8** to start.



### Information

The function is **ONLY** available when the Tester is online!

## 4.2 Enter the new vehicle equipment in the vehicle data using "PIWIS Online"

4.2.1 Select the function "Maintenance of vehicle data with PIWIS ONLINE" in the "Model series-specific tests and campaigns" menu item.

A message appears informing you that the "Actual" (vehicle) data and "Required" (PIWIS Online) data will be synchronized.

Press **F12** to continue.

4.2.2 Information "The vehicle data was synchronized with PIWIS Online. Significant differences were found" Press **F12** to confirm.

4.2.3 Look for the option "EXHAUST TAILPIPE" in the "Family" column.

Select "OP3 – SPORTS TAILPIPE COVERS SILVER" or "OP6 – SPORTS TAILPIPE COVERS DARK BRONZE" from the drop-down menu in the "Value" column. Press **F12** to continue

4.2.4 A table containing the coding value and the columns "new value" and "old value" is displayed in the overview. Press **F8** to continue.

4.2.5 Data is then written / saved. The following messages appear one after the other:

- Vehicle data is transferred to PIWIS Online.
- Vehicle data is written and transferred to the vehicle.
- Vehicle order written successfully.
- A check was performed in order to check whether control units have to be coded or programmed as a result of the changes that were made.

4.2.6 Press **F10** to open the log. Check that the selected vehicle equipment has been entered and close the log.

4.3 Code/program the new vehicle equipment.

4.3.1 Confirm the table containing a list of control units that must be coded/programmed, by pressing **F12**.

4.3.2 Individual data records will be loaded, depending on the number of control units to be coded/programmed.

Wait for information "Creating backup documentation. Please wait ..." and "Coding was completed successfully". Press **F12** to continue.

Repeat the process for other control units if necessary.

4.3.3 Wait for information "Adaptation of the control units is complete." Wait and check the coding status of the control units in the displayed table.

Continue by pressing **F12** to return to the control unit overview.

4.4 Read out the fault memory of all systems, work through any existing faults and erase the fault memory. ⇒ *Workshop Manual '421319A3 Fault memory for on board diagnostics'*

5 Follow-up actions

5.1 Switch off ignition and disconnect **P90999 - P90999 - PIWIS Tester 4**.

5.2 Disconnect the battery charger. ⇒ *Workshop Manual '2X00IN Battery trickle charging'*

5.3 Drive the vehicle off the vehicle lift.

26 35 32 05: – Tailpipes converted–

Labor time: **183 TU**

- Includes:
- Remove standard tailpipe (2 pc(s));
  - Change rear silencer;
  - Install new sports end pipe (4 pc(s));
  - Code new equipment in the vehicle data using PIWIS Tester.

**Important Notice:** Technical Bulletins issued by Porsche Cars North America, Inc. are intended only for use by professional automotive technicians who have attended Porsche service training courses. They are written to inform those technicians of conditions that may occur on some Porsche vehicles, or to provide information that could assist in the proper servicing of a vehicle. Porsche special tools may be necessary in order to perform certain operations identified in these bulletins. Use of tools and procedures other than those Porsche recommends in these bulletins may be detrimental to the safe operation of your vehicle, and may endanger the people working on it. Properly trained Porsche technicians have the equipment, tools, safety instructions, and know-how to do the job properly and safely. Part numbers listed in these bulletins are for reference only. The work procedures updated electronically in the Porsche PIWIS diagnostic and testing device take precedence and, in the event of a discrepancy, the work procedures in the PIWIS Tester are the ones that must be followed.

© 2025 Porsche Cars North America, Inc.