

Title: Vehicle Locked Electronic Control Units

Applicability: MY2025 Revero

Market Region: All

PURPOSE: Information regarding vehicle locked or “Latched” ECMs.

Several electronic control units (“ECUs”) found in the Karma Revero are configured in such a way that they are latched to a vehicle as assembled from assembly.

This means that these units cannot be used in diagnostics by swapping them to a similar build vehicle. Particularly the ECM on the MY25 will now be latched module after BL1030 and can not be swapped between vehicles.

The Hybrid Control Unit (HCU), found in the passenger side foot well under the foot plate, cannot be swapped to any other vehicle, this may alter the odometer on the “test” vehicle. Causing malfunction indicator to appear on the dash.

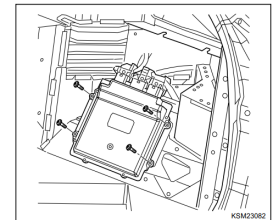
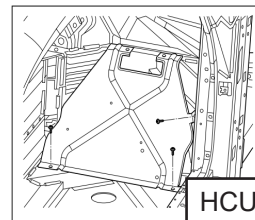

The electronic control module (“ECM” for the internal combustion engine) as mentioned above should not be test swapped to any other vehicle. (Fig 2) This should also create a MIL.

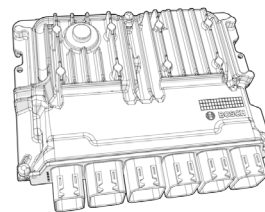

ECM



The Vehicle Control Module (“VCM”) should not be moved to any other vehicle as this has the key fobs tied to the vehicle, and integrated with the mobile app function. This will disable the keys and stop current mobile app function for the vehicle. The Central Infotainment Unit (“CIU”) should not be swapped over for any reason as it is vital for over the air updates and will create a mismatch of the component and vehicle.

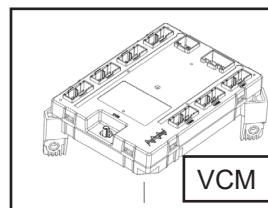

VCM

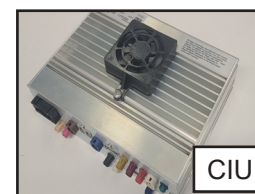

CIU

The ADAS Front Radar Module (“AFRM”) is similarly latched to a vehicle by the VIN and cannot be moved to another vehicle, it will not operate and create a MIL.



AFRM

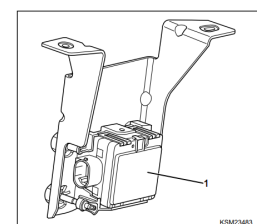

Karma Automotive Bulletins and service documents are intended for use by experienced and trained Technicians. If you lack the skills, tools, equipment and a suitable workshop for any procedure described in this document, we suggest you leave such repairs to a Karma retailer and service provider. See your service provider for advice on whether your vehicle may benefit from the information contained within this document. The information contained in the Karma Bulletin is accurate at the date of publication. However, Karma Automotive regularly updates technical information. Please check with your Karma Automotive Retailer and Karma Automotive service provider that the bulletin you intend to use contains the latest available information.