

**Volterra™ ZSL™ Side of Body Sign
Brackets Missing
Instructions for Bolt-on Bracket
Installation**

Date: November 12, 2025
Bulletin Name: ZSL-IB-001
Model: Volterra™ ZSL™ Side Loader
Model Year: 2025
Units Affected: Those missing side of body sign brackets, if required

Purpose

McNeilus Truck and Manufacturing, Inc. offers these instructions for the installation of side of body sign holder brackets, if required. The brackets are bolt on style to eliminate the need to weld on the Volterra™ ZSL™.

SAFETY NOTICE

Perform your company's Lockout/Tagout procedure. If your company does not have a Lockout/Tagout procedure, follow OSHA 1910.147 and 1910.146 Confined Space as appropriate.

SAFETY NOTICE

Use appropriate Personal Protective Equipment (PPE) as required by your company.

Tools and Equipment Required

Technician to supply

- 9/16" wrench, standard set of wrenches
- Tape measure
- Machinist's marker
- Electric drill and 3/8" drill bit

Parts Required

Purchase from McNeilus

Item	PN	Description	Qty.
1	1705402	BRACKET, SIGN ROADWAY, 31 INCH, BOLT-ON	6
2	1241565	SCREW (BOLT), FLANGE, HEX .38-16X1.50 G8 PO	12
3	N/A	SEALING WASHERS	12
4	1245080	WASHER, FLAT .44X1.25X.08 ZY HDN	12
5	0120177	NUT, HEX, LOCK DT .38-16 GC ZC	12

Procedure:

1. Move the ejector to the home position (all the way to the front of the body).
2. Raise the tailgate approximately 2.5-3 ft.

⚠ DANGER

Whenever the tailgate is in a raised position, it must be securely propped or blocked so it cannot fall on anyone. Serious personal injury or death will occur.

⚠ WARNING

Crush Hazard. Be sure all non-operator personnel are at least 20 feet (6 meters) away from all areas of the vehicle. Failure to comply may result in serious personal injury or death.

⚠ CAUTION

Do not **POWER DOWN** the tailgate against the props. Damage may occur to the props.

⚠ DANGER

Stand clear when the tailgate is in motion. Do not stand under or cross under the raised tailgate. Serious personal injury or death will occur.

3. Turn the vehicle ignition OFF and disconnect the low voltage battery. See instructions in the Operator's Manual.
4. Standing to the side of the tailgate, release the left and right tailgate prop retaining pins and swing the props down.
5. Position notched end of tailgate props over the body prop knobs.
6. Turn vehicle low voltage disconnect switch ON.
7. Turn vehicle ignition ON and lower the tailgate until the left and right tailgate props are fully seated on the body prop knobs.
8. Turn vehicle ignition OFF and disable vehicle using the low voltage battery disconnect switch procedure.
9. Perform your company's Lockout/Tagout procedure. If your company does not have a Lockout/Tagout procedure, follow OSHA 1910.147 and 1910.146 Confined Space as appropriate. Chock wheels and engage the service brake.
10. From the outside of the vehicle, measure and mark the distances as shown in Figure 1 and Figure 2. **All measurements are in inches.** NOTE: Some components are hidden for clarity.
 - Height measurement (h) is 25.08" from the top of the body (vehicle) to the top hole. Repeat this height measurement for each of the top hole locations for each bracket.
 - Use the bracket as a template, held at the top hole to mark the placement of the bottom hole.
 - Measure the location of each bracket according to the A, B, C measurements below.
 - Measurement (a) is from the tailgate to the first bracket location.
 - Measurement (b) is the second bracket location.
 - Measurement (c) is the third bracket location.

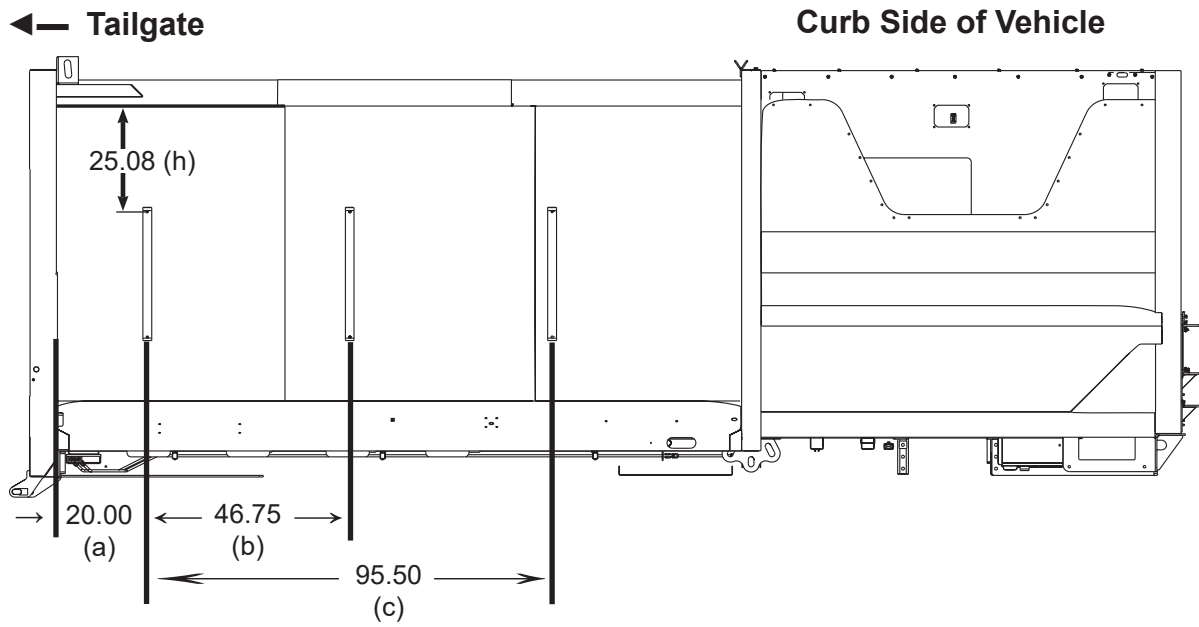

Figure 1

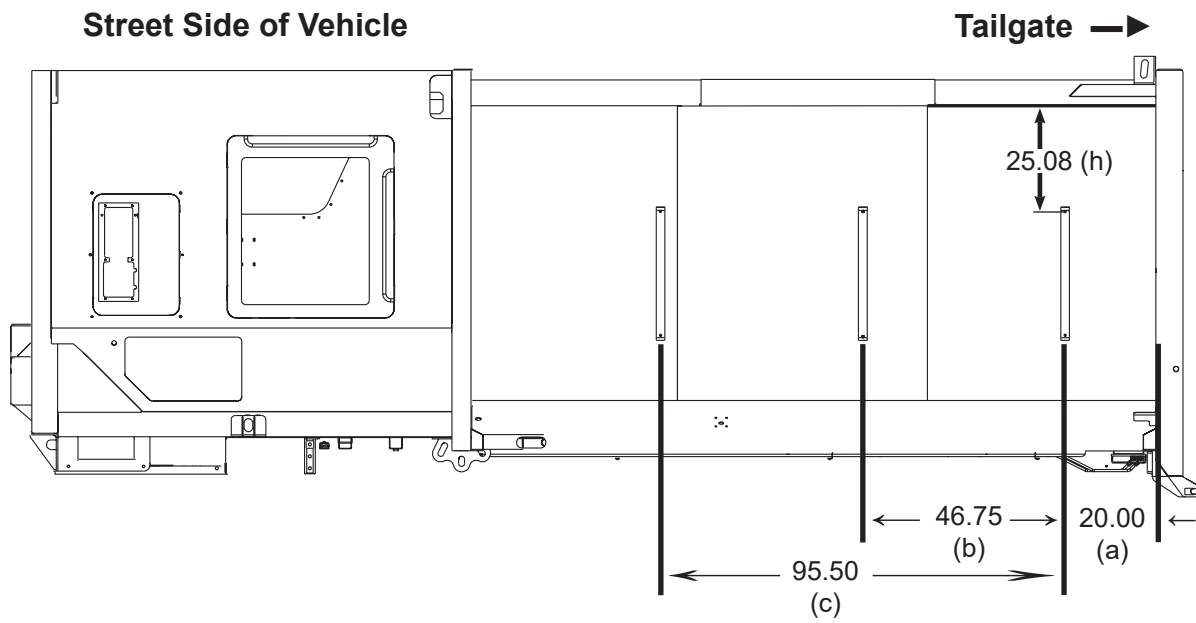

Figure 2

11. Drill each hole.

12. Insert the bolts (PN 1241565) and sealing washers (part number N/A) through the holes from the inside of the body outward. Access by entering the body through the tailgate.
13. On the outside of the body, install the bracket (PN 1705402), metal washer (PN 1245080), and nut (PN 0120177) on each bolt. See Figure 3 for hardware installation order.

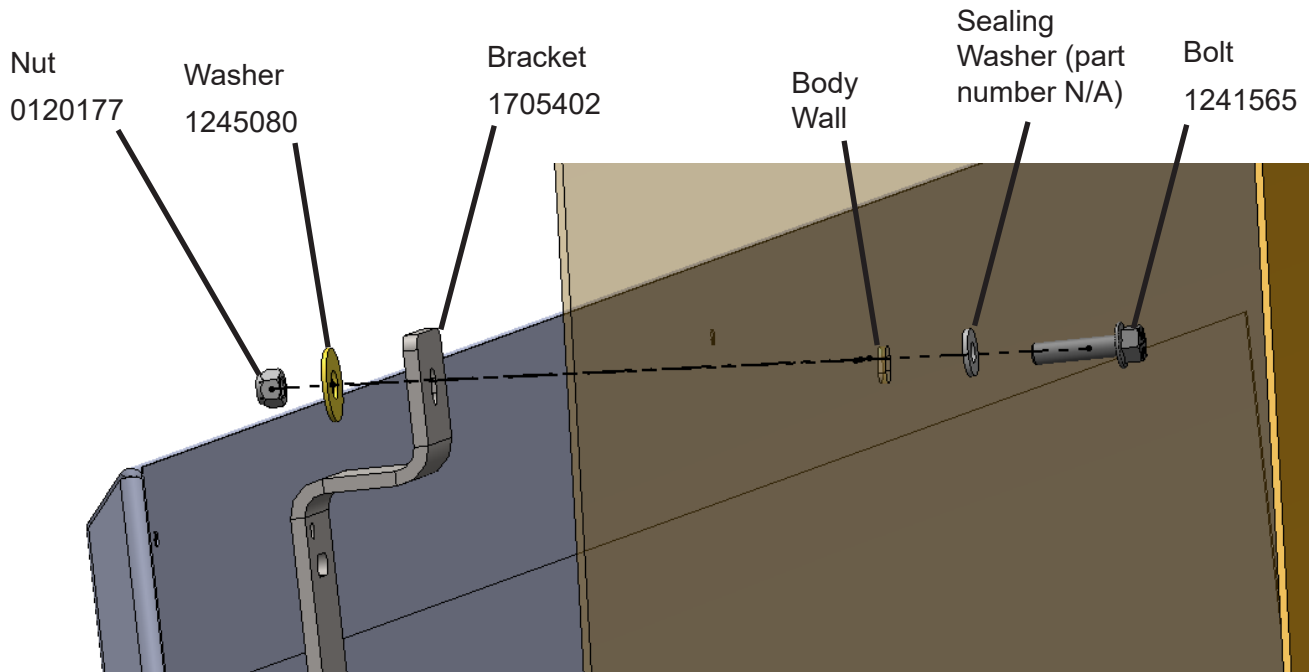

Figure 3

14. The bracket must be installed with the hole on the bend facing downward (Figure 4).

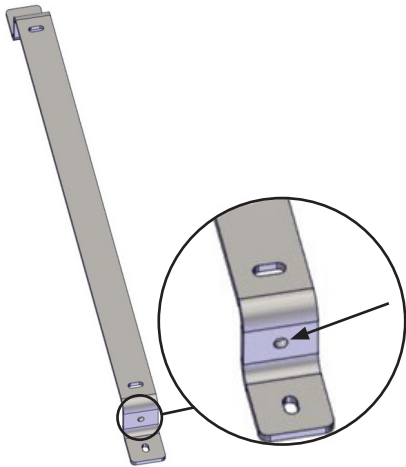

Figure 4

15. Tighten each set of hardware until tight. Repeat with each bracket and hardware on both sides of the vehicle body.
 - The bracket installation is complete.
16. If the signs are available, install each sign onto the brackets according to sign installation procedures.

 **WARNING**

Crush Hazard. Be sure all non-operator personnel are at least 20 feet (6 meters) away from all areas of the vehicle. Failure to comply may result in serious personal injury or death.

 **DANGER**

Stand clear when the tailgate is in motion. Do not stand under or cross under the raised tailgate. Serious personal injury or death will occur.

17. Remove your company's Lockout/Tagout procedure. If your company does not have a Lockout/Tagout procedure, follow OSHA 1910.147 and 1910.146 Confined Space as appropriate.
18. Open the tailgate as needed to provide the necessary clearance to disengage the prop from the body prop knobs.
19. Disable the refuse vehicle functions using the low voltage battery disconnect switch procedure.
20. Standing to the side of the tailgate, remove the prop from the body prop knob and swing the prop away from the chassis frame to the STORED position and install the retaining pin
21. Turn vehicle low voltage disconnect switch ON.
22. Start the vehicle.
23. Close the tailgate.
24. Return the vehicle to service.