

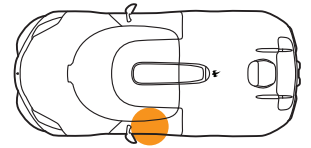

## Immobilizer Harness

*This instruction refers to other documents that are necessary to do the procedure.*

This instruction is applicable to the RH drive and LH drive vehicles. The illustrations show the LH drive version.



### Situation

The immobilizer cable may not be routed according to the standards and may be damaged or kinked. This can affect the communication to the immobilizer antenna.

### Action

Replace the immobilizer cable, if damaged, and make sure that the cable has the correct routing.

PARTS	REFERENCE	QUANTITY
Heat Shrink Tubing 4.0mm 4-1 Black WT 1mm	1076495	60 mm
Immobilizer key reader replacement harness	170-375-3301	1
Splice GHW 0.5-1.0mm <sup>2</sup>	170-399-2102	2

TOOLS	SPECIFICATION	QUANTITY
Crimp tool for 0.5-1.0mm <sup>2</sup> splices	–	1
General mechanical tools	–	–

CONSUMABLES	REFERENCE	QUANTITY
Buntband, Ty-Rap, Ståltunga 92mm	130-195-9004	1
Buntband, Ty-Rap, Ståltunga 203mm	130-195-9005	1
Htape-protect250	170-112-0002	–

### Prepare

1. Open the driver's door with the key fob or with the door button.
2. Disconnect the 12 V system, refer to [WOM-00007](#).

### Inspection

1. Do an inspection of the immobilizer cable **A** to make sure that:
  - The immobilizer cable **A** has no damages or kinks.
  - The cable is attached to the cable clip **B**.



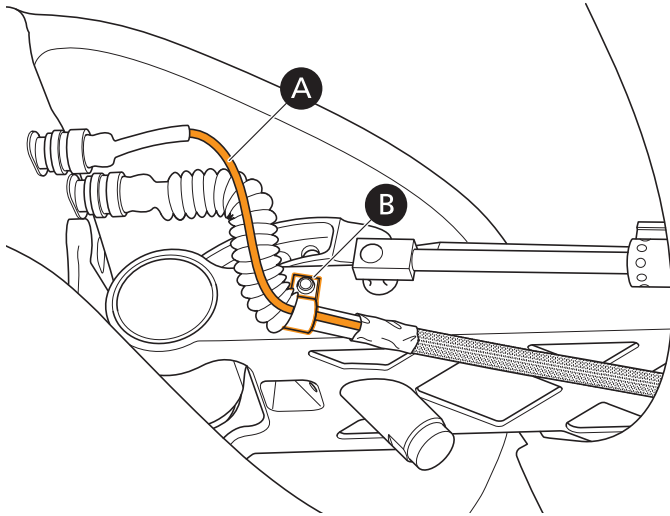

2. Continue with the procedure that is applicable:

- If the immobilizer harness **A** has visible damages or kinks. Continue with **Replace Harness**. Submit a KATS ticket to get the necessary repair kit.
- If the immobilizer harness **A** has no damages or kinks but is not attached to the cable clip **B**. Continue with **Attach Harness**.
- If the immobilizer harness **A** is attached to the cable clip **B** and has no damages or kinks. Continue with the section **Test the Immobilizer**.

### Replace Harness

Only do this procedure if the immobilizer cable has visible damages or kinks.

1. If the immobilizer cable is attached to the cable clip, loosen the H4 bolt **B** to cable from the clip.

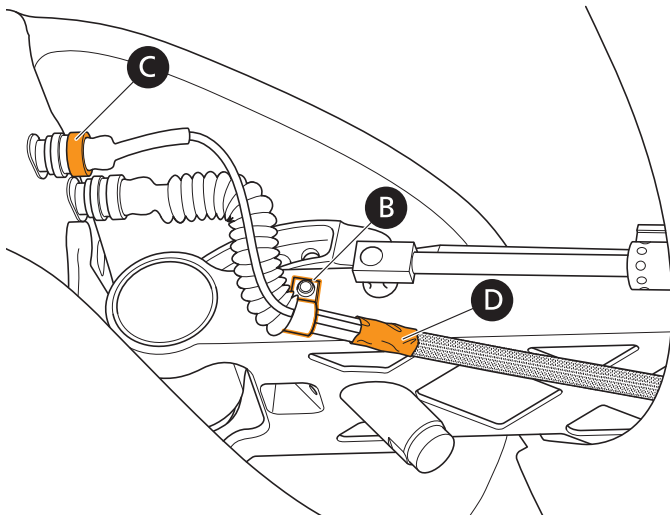

2. Disconnect the x426 connector **C** from the door.
3. If applicable, remove the tape around the cable braid **D**.





4. If applicable, open the cable braid to access the cables within.

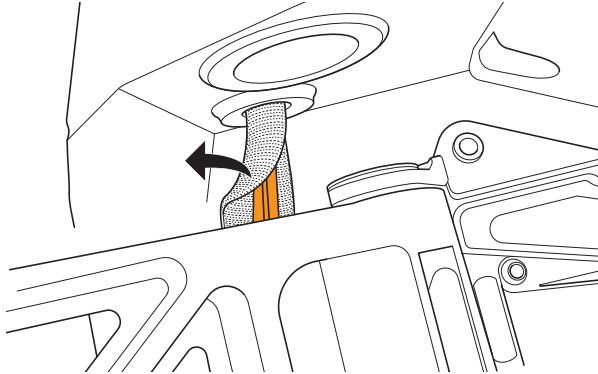

5. Carefully pull the immobilizer cable to the x426 connector out of the dashboard until it stops.  
6. Measure the immobilizer cable from the dashboard grommet and put a mark at 200 mm.



### CAUTION

Do not cut the two white wires within the immobilizer cable before you have identified the wire to pin A. Incorrectly connected wires can cause damage to the immobilizer system.

7. Start at the x426 connector and carefully remove the cable jacket to the 200 mm mark. Make sure that you do not cut the twisted white wires.

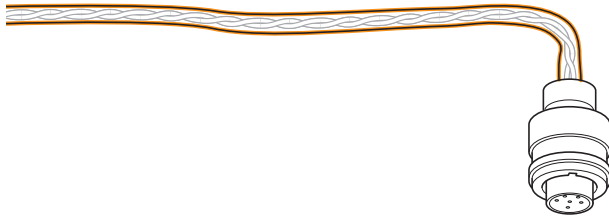

8. From the 200 mm mark, carefully remove 40 mm of the cable jacket. Make sure that you do not cut the twisted white wires.  
9. Do an inspection of the x426 connector and the white wires. Identify the white wire that is connected to the socket A.

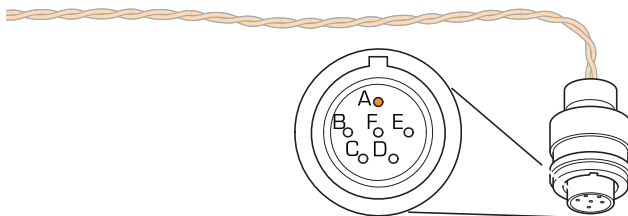

10. Put a mark on the wire that is connected to the socket A. The position of the mark must be between the 200 mm mark and the cable jacket.



### CAUTION

Do not cut the two white wires before you have identified the wire to pin A. Incorrectly connected wires can cause damage to the immobilizer system.

11. Cut the wires at the 200 mm mark.  
12. Discard the old connector with the cut wires.  
13. Make sure that the white wires are approximately 40 mm long, before the cable jacket.





14. Remove 5 mm of the insulation from the wire ends.
15. Put on 30 mm of the new heat shrink on each wire.

**Part:** 1076495



16. On the new replacement harness, remove 5 mm of the insulation from the wire ends.  
**Part:** 170-375-3301
17. On the replacement harness, identify the wire that is connected to socket A.
18. Connect the socket A wire ends with the new splice. Make sure that you use the correct crimp tool size.  
**Part:** 170-399-2102

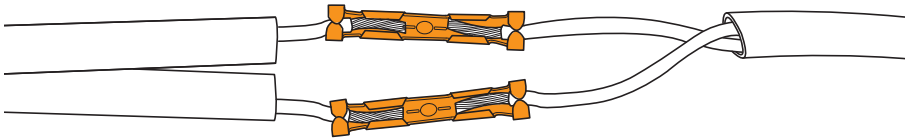

19. Connect the socket B wire ends with the new splice. Make sure that you use the correct crimp tool size.  
**Part:** 170-399-2102
20. Set the heat gun to 300 °C.
21. Put the heat shrinks around the splices and apply heat with the heat gun.
22. Attach protection tape around the cable jacket, wires and the heat shrinks.  
**Consumable:** 170-112-0002

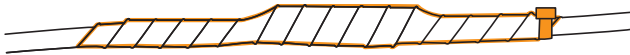

23. Attach the end of the protection tape with a zip-tie.  
**Consumable:** 130-195-9004
24. Connect the new x426 connector  to the door.
25. Push the immobilizer cable into the dashboard until it is aligned with the other cables.

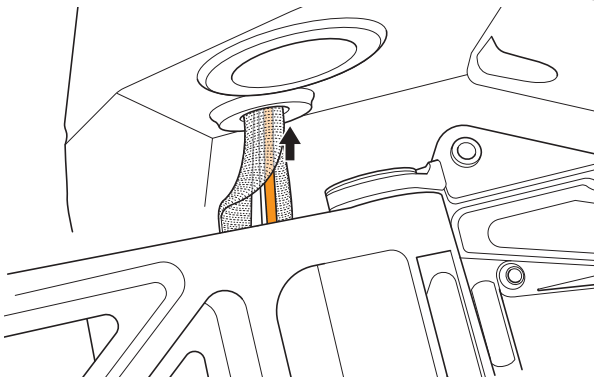

26. Make sure that the splices are within the dashboard.
27. Attach a zip tie around the cables before these go into the dashboard.  
**Consumable:** 130-195-9005



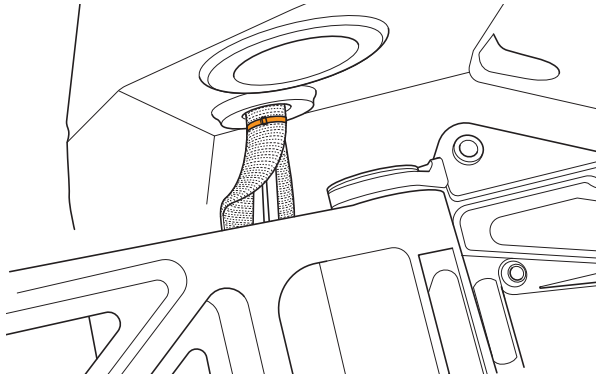

28. If applicable, put the cable braid around the cables.

29. If applicable, put tape around the cable braid **D**.

Consumable: 170-112-0002

### Attach Harness

1. Loosen the H4 bolt **B** that attach the cable clip.

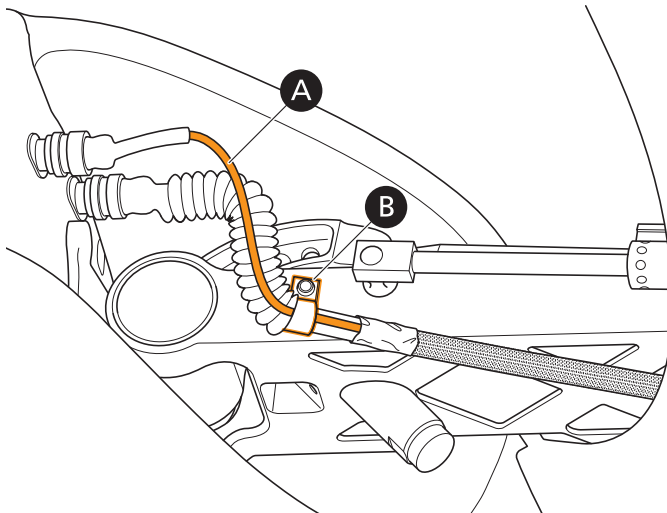

2. Put the immobilizer cable **A** along the door harness and attach it with the cable clip **B**.

3. Carefully tighten the H4 bolt **B**.

Torque: 4 Nm

### Test the Immobilizer

1. Make sure that **PASSIVE KEYLESS ENTRY** is set to **NO**.

1.1 In SmartCenter, press **SETUP**.

1.2 Press **<** or **>** to show **SETTINGS** screen.

1.3 Set **PASSIVE KEYLESS ENTRY** to **NO**.

2. Close and lock the doors with the key fob.

3. Hold the key fob, to the left of the door button on the driver's side. The rear side of the key fob is put against the door and the buttons point away from the Regera.



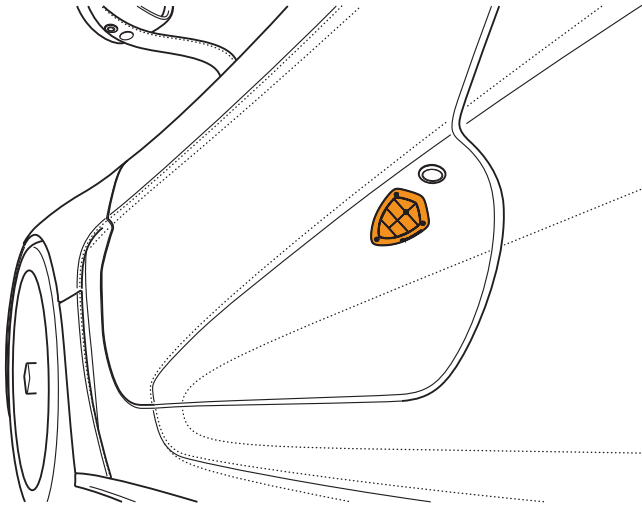

4. Push, hold and release the door button to unlock and open the door. Do not push any button on the key fob.
5. If the door unlocks the immobilizer antenna works correctly.
6. If you changed the **PASSIVE KEYLESS ENTRY** setting from **YES** to **NO**, make sure that you change it back to **YES**. Refer to step **1**.

### Warranty Information

If the repair is covered by the warranty terms, refer to Koenigsegg Warranty Process.

#### OPERATION

KWO439420, KWO672319, KWO747528

#### PART NO

Refer to the invoiced kit number

