



GROUP	MODEL
ELE	2025MY EV9 (MV1a)
NUMBER	DATE
383 (Rev 1, 10/24/2025)	April 2025

## TECHNICAL SERVICE BULLETIN

### SERVICE ACTION: SUNROOF LOGIC IMPROVEMENT & SUNROOF/REAR ROLLER BLIND INITIALIZATION (SA615)

SUBJECT:

#### NOTICE

**This bulletin has been revised to include additional information. New/revised sections of this bulletin are indicated by a black bar in the margin area.**

This bulletin provides information to upgrade the Roof Control Module 'RCM' system software on certain 2025MY EV9 (MV1a) vehicles produced from May 17, 2024 through June 6, 2025, which may exhibit an inoperative sunroof or rear roller blind due to a loss of motor position data during states of 'sleep' or 'low' power. To rectify this concern, follow the procedure outlined in this publication to apply the improved logic to the 'RCM' module and perform the sunroof and rear roller blind reinitialization. Refer to [SST081](#) for software upgrade instructions using Kia Diagnostic System (KDS) tablet and VCI-II and confirm the Upgrade Event Number/Name, ROM ID Information, and Manual Mode passwords (if applicable) on the applicable vehicle.



#### NOTICE

**A Service Action is a repair program without customer notification that is performed during the warranty period. Any dealer requesting to perform this repair outside the warranty period will require DPSM approval.**

Repair status for a VIN is provided on KDealer+ (Service → Warranty Coverage → Warranty Coverage Inquiry → Campaign Information). Not completed Recall / Service Action reports are available on KDealer+ (Consumer Affairs → Not Completed Recall → Recall VIN → Select Report), which includes a list of affected vehicles.

This issue number is SA615.

SUBJECT:

## SUNROOF LOGIC IMPROVEMENT AND SUNROOF/REAR ROLLER BLIND INITIALIZATION (SA615)

Refer to [TSB SST081](#) for instructions to upgrade the 'RCM' system:

To correct this condition, the specified system module should be reprogrammed using KDS as described in this bulletin in 'Manual Mode'.

### ❗ IMPORTANT

The 'RCM' system **MUST** be reprogrammed in **Manual Mode ONLY** using the KDS download as outlined in this bulletin. Refer to [TSB SST081](#) for instructions to upgrade the 'RCM' system.

**BOTH 'RCM' system Events #828 AND THEN #829 are REQUIRED to be installed IN ORDER.**

#### Upgrade Event Name

828.MV1a RCM Upgrade for Sunroof Operation Logic Improvement

829.MV1a RCM Upgrade for Sunroof Operation Logic Improvement

### 📄 NOTICE

- Confirm a fully charged battery (12.3 volts or higher is necessary) is used or utilize a fully charged jump starter box connected to the battery.
- **Ensure the KDS GDS is sufficiently charged at 60% or higher prior to reflash.**
- All ECU upgrades must be performed with the ignition set to the 'ON' position unless otherwise stated.
- **Damaged VCI II units should not be used and promptly replaced.**
- Be careful not to disconnect the VCI-II connected to the vehicle during the ECU upgrade procedure.
- **DO NOT start the engine during ECU upgrade.**
- **DO NOT turn the ignition key 'OFF' or interrupt the power supply during ECU upgrade.**
- **When the ECU upgrade is completed, turn the ignition 'OFF' and wait 10 seconds before starting the engine.**
- **ONLY** use approved ECU upgrade software designated for the correct application.

[Connect the negative \(-\) terminal to the battery as shown below.](#)

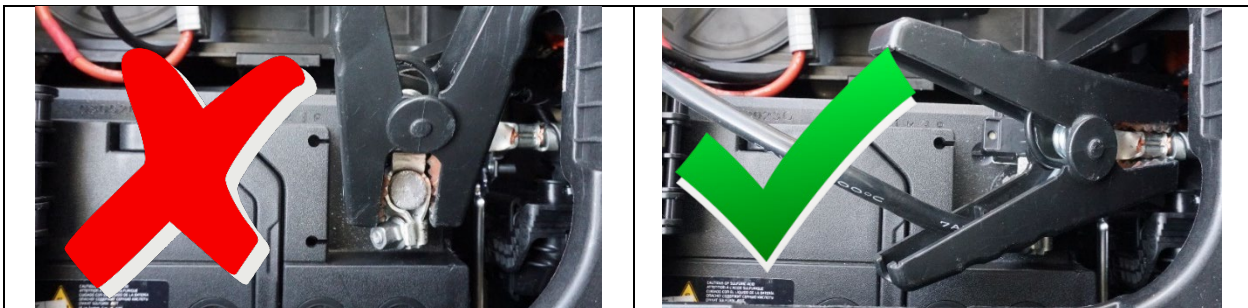

Printed document copy is for reference only; information may be updated at any time. Always refer to KGIS for the latest information.

SUBJECT:

## SUNROOF LOGIC IMPROVEMENT AND SUNROOF/REAR ROLLER BLIND INITIALIZATION (SA615)

### NOTICE

Before attempting an ECU upgrade on any Kia model, make sure to first determine whether the applicable model is equipped with an immobilizer  security system. Failure to follow proper procedures may cause the PCM to become inoperative after the upgrade and any claims associated with this repair may be subject to chargeback.

### CAUTION

Ensure a fully charged jump starter box is connected to the battery. Failure to attach a jump starter box to the battery while performing this software update can cause the RCM ECU to fail internally.

### IMPORTANT

It is recommended to ALWAYS check the Electronic Parts Catalog (EPC) to locate the ECU Part Number respective to Auto/Manual Mode ROM IDs. DO NOT reference the parts label affixed to the ECU.

### ROM ID INFORMATION TABLE:

#### Upgrade Event #828

Unit	System	IMMO 	ECU P/No.	ROM ID	
				Previous	New
1 (Sunroof)	RCM	Yes	816P0 XA000	2441 2461	2531

To verify the vehicle is affected, be sure to check the Calibration Identification of the vehicle's ECM ROM ID and reference the Information Table as necessary.

#### Upgrade Event #829

Unit	System	IMMO 	ECU P/No.	ROM ID	
				Previous	New
2 (Rear Roller Blind)	RCM	Yes	816P1 XA000	2441 2461	2531

To verify the vehicle is affected, be sure to check the Calibration Identification of the vehicle's ECM ROM ID and reference the Information Table as necessary.

### Manual Mode ECU Upgrade:

Event No.	Menu	Password
828	MV1a RCM (unit 1) : 816P0-XA000	4796
829	MV1a RCM (unit 2) : 816P1-XA000	7642



SUBJECT:

## SUNROOF LOGIC IMPROVEMENT AND SUNROOF/REAR ROLLER BLIND INITIALIZATION (SA615)

### Software Information:

#### ❗ IMPORTANT

The 'RCM' system **MUST** be reprogrammed in **Manual Mode ONLY** using the KDS download as outlined in this bulletin. Refer to [TSB SST081](#) for instructions to upgrade the 'RCM' system.

**BOTH 'RCM' system Events #828 AND THEN #829 are REQUIRED to be installed IN ORDER.**

The required software must be installed by selecting the **'Manual Mode'** ECU Upgrade option.

**Note:** In some case, the 'Manual Mode' installation option may be required **ONLY** if the 'Auto Mode' function fails or is otherwise noted above.

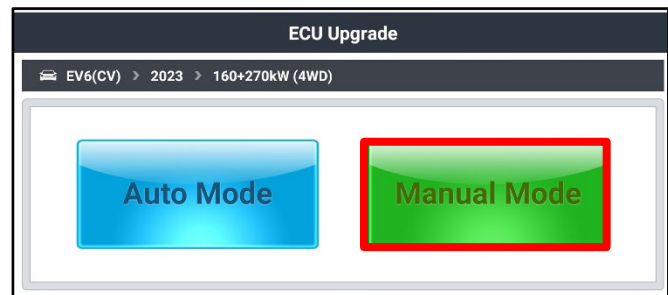

#### UPGRADE BOTH EVENTS:

Select the applicable **'RCM' system** module and the Event Group.

- **828.MV1a RCM Upgrade for Sunroof Operation Logic Improvement**
- AND THEN**
- **829.MV1a RCM Upgrade for Sunroof Operation Logic Improvement**

Verify the affected vehicle Calibration Identification of the applicable ECU ROM ID and reference the Information Table on page 3 as necessary.

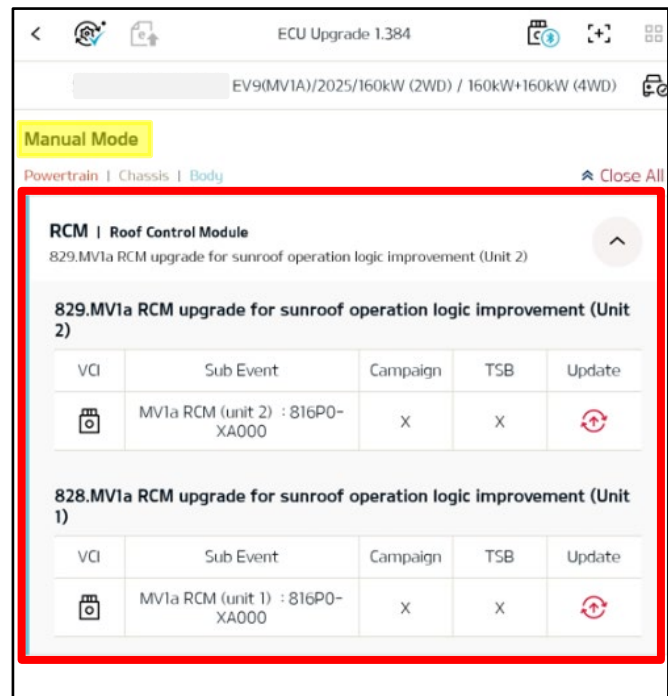

1. Proceed to the 'System Identification Procedure' on page 5 to confirm Unit 1 and Unit 2 software versions are identical.

SUBJECT:

# SUNROOF LOGIC IMPROVEMENT AND SUNROOF/REAR ROLLER BLIND INITIALIZATION (SA615)

## System Identification Procedure:

1. Select 'Expert Diagnosis'.

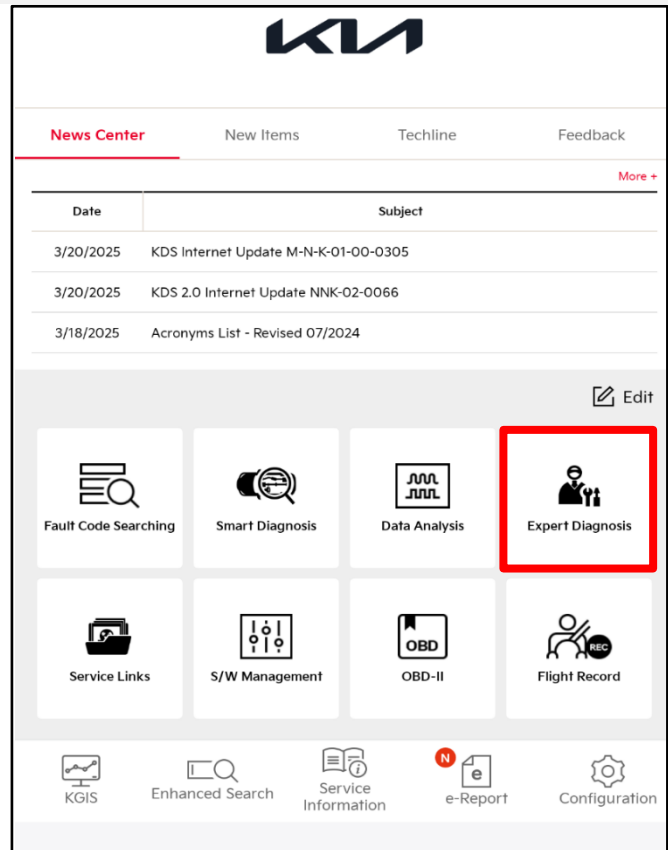

2. Select 'System Identification'.

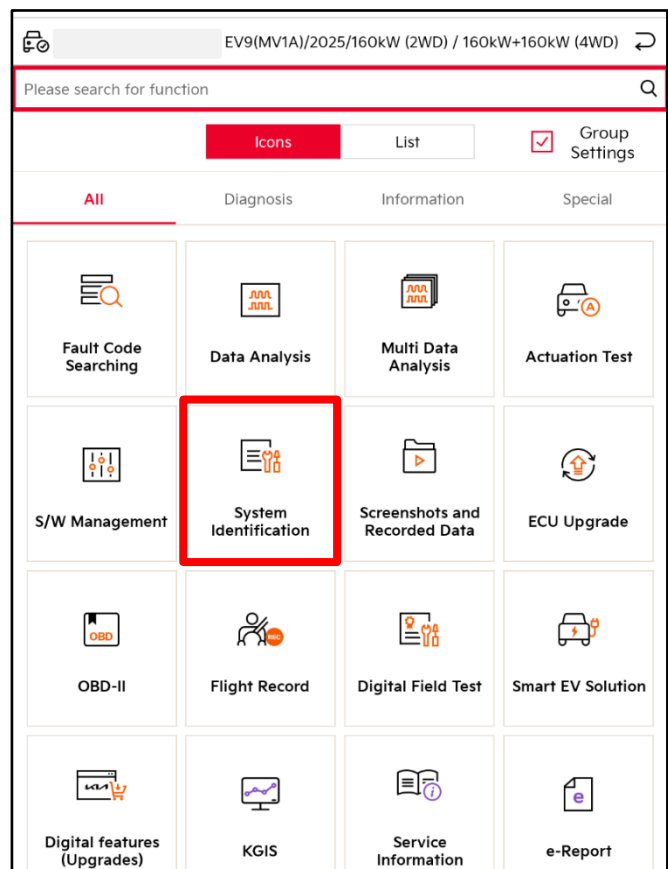

SUBJECT:

# SUNROOF LOGIC IMPROVEMENT AND SUNROOF/REAR ROLLER BLIND INITIALIZATION (SA615)

3a. Select 'RCM'.

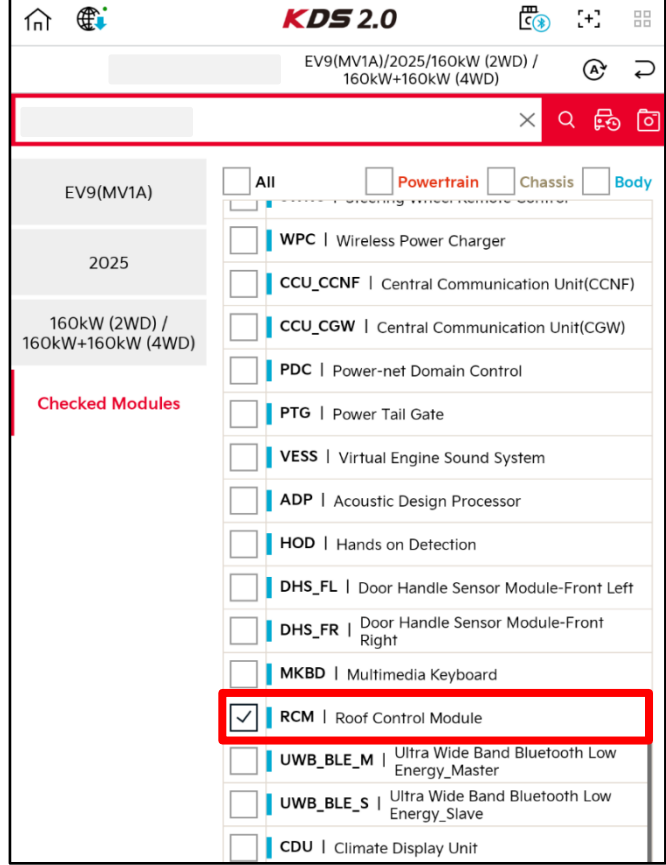

3b. Confirm 'S/W Unit 1 Version' and 'S/W Unit 2 Version' both display '2531'.

**Note: If Unit 1 and Unit 2 S/W versions do not match, turn the ignition 'OFF' for ten (10) seconds and then turn the ignition 'ON'. Wait five (5) minutes and repeat steps 1-3.**

4. Proceed to the 'Factory Mode Activate/Deactivate Procedure' on page 7.

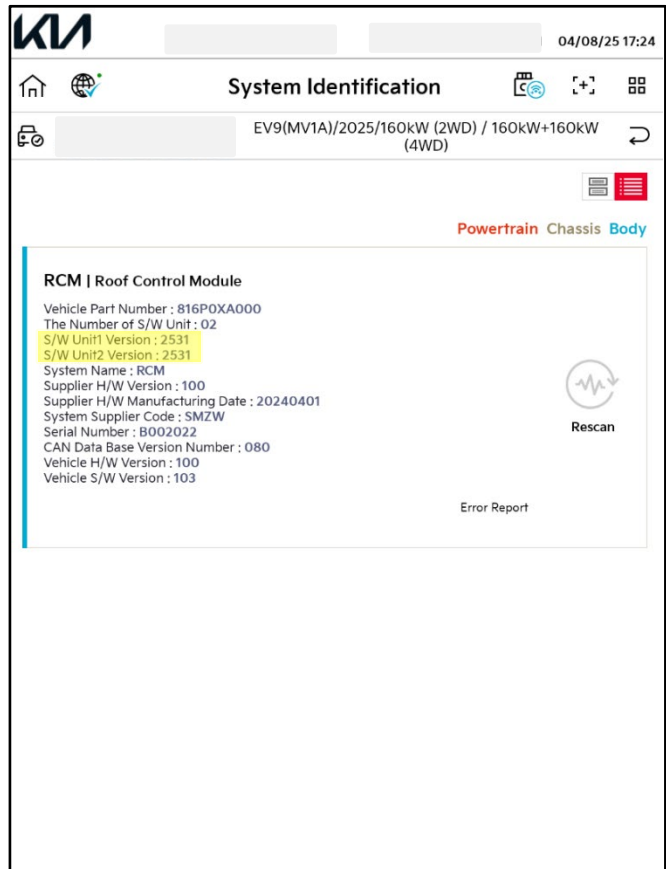

SUBJECT:

# SUNROOF LOGIC IMPROVEMENT AND SUNROOF/REAR ROLLER BLIND INITIALIZATION (SA615)

## Factory Mode Activate/Deactivate Procedure:

1. Select 'S/W Management'.

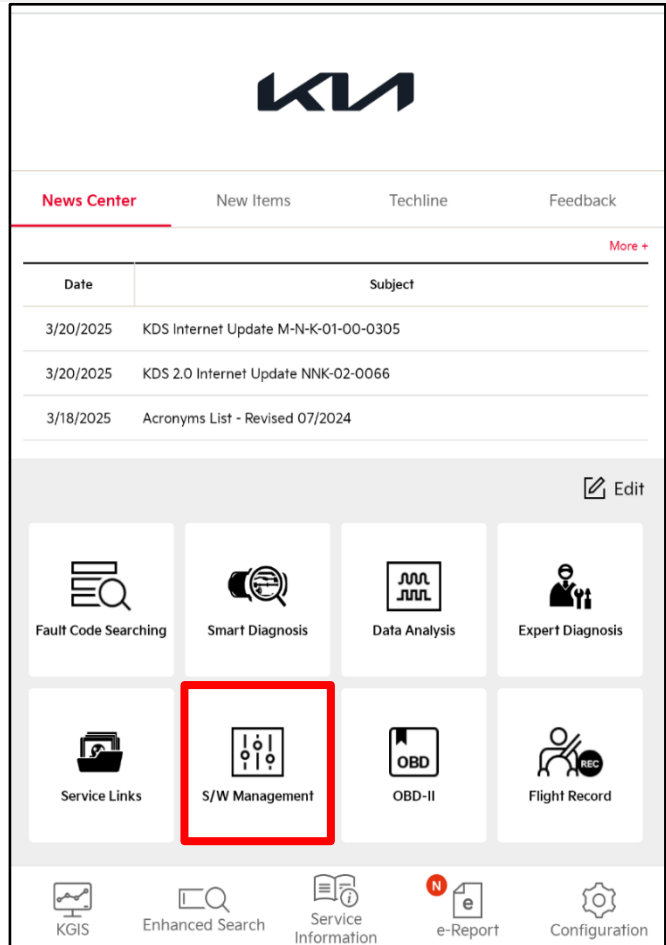

2a. Select 'RCM - Roof Control Module'.

2b. Select 'Activate/Deactivate Factory Mode'.

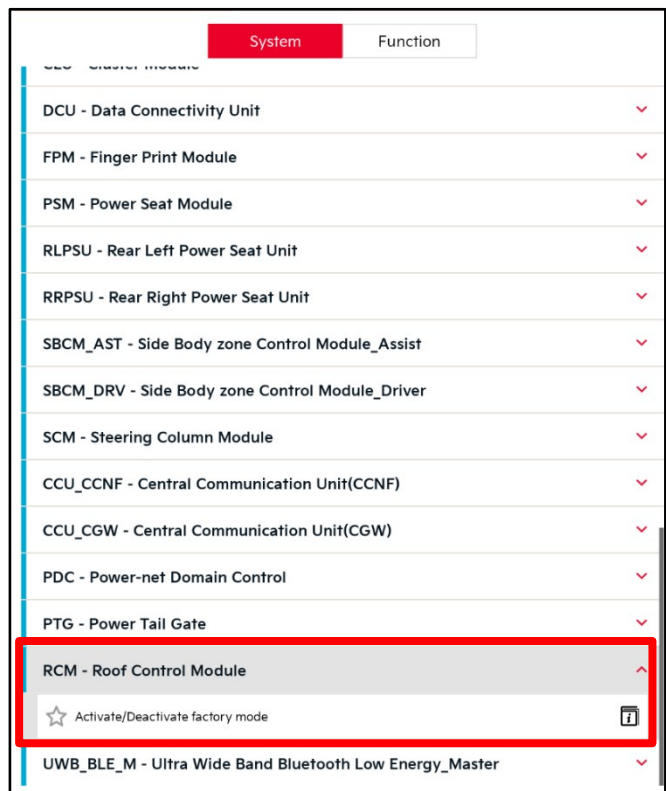

SUBJECT:

## SUNROOF LOGIC IMPROVEMENT AND SUNROOF/REAR ROLLER BLIND INITIALIZATION (SA615)

3. Select 'Run'.

Activate/Deactivate factory mode

Purpose	This function is to deactivate factory mode after module exchange.
Enable Condition	1.Engine stop(EV Not Ready) 2.IG ON or Power ON 3.Vehicle Speed : 0km/h
Concerned Component	-
Concerned DTC	C171304
Fail Safe	-
Etc	-

Close
Run

4. Select 'OK'.

• [ Activate/Deactivate factory mode ]

This function enables or disables factory mode after replacing modules.

•[ Condition ]

1. IG ON  
2. EV Not Ready

[OK] Button : Start additional functions

[Cancel] Button : End the optional function

OK
CANCEL



SUBJECT:

## SUNROOF LOGIC IMPROVEMENT AND SUNROOF/REAR ROLLER BLIND INITIALIZATION (SA615)

- 5a. Select 'C1'.
- 5b. Repeat steps 2b - 4.
- 5c. Select 'C2'.
- 5d. Repeat steps 2b - 4.
- 5e. Repeat steps 5a - 5e three (3X) times.
6. Proceed to the 'Sunroof Initialization Procedure' on page 10.

**S/W Management**

EV9(MV1A)/2025/160kW (2WD) / 160kW+160kW (4WD)

04/08/25 17:26

◀ [ Activate/Deactivate factory mode ] ▶

This function enables or disables factory mode after replacing modules.

Current status : Field mode

◀ [ Condition ] ▶

1. IG ON
2. EV Not Ready

[C1] Button : Factory mode enabled

[C2] Button : Factory mode disabled

[Cancel] Button : End the optional function

**C1**      **C2**      CANCEL

Do not touch any system buttons while performing this function.

S/W Ver.	NNK-02-0069	VCI Ver.	03.11
Res Ver.	NNK-02-0061	OS Ver.	Android 14

SUBJECT:

## SUNROOF LOGIC IMPROVEMENT AND SUNROOF/REAR ROLLER BLIND INITIALIZATION (SA615)

### Sunroof Initialization Procedure:

1. Turn the ignition 'ON'.
2. Close the sunroof completely (if opened).
3. Lightly press (half click) the sunroof switch (A) forward until the sunroof motor moves once, then release the sunroof switch.
4. Press (full click) and hold the sunroof switch (A) forward until the sunroof glass opens and closes.
5. Release the sunroof switch (A).
6. Confirm normal operation of the sunroof.
7. Proceed to the 'Rear Roller Blind Initialization Procedure' below.

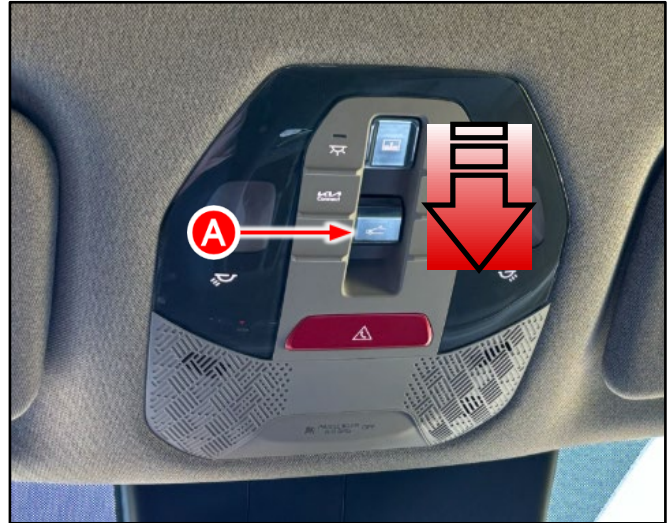

#### ⓘ IMPORTANT

**DO NOT** release the sunroof switch (A) until the operation has completed. If the switch is released prematurely, the initialization procedure will need to be restarted.

### Rear Roller Blind Initialization Procedure:

1. Turn the ignition 'ON'.
2. Close the sunshade completely (if opened).
3. Lightly press (half click) the roller blind switch (B) until the roller blind motor moves once, then release the roller blind switch.
4. Press (full click) and hold the roller blind switch (B) forward until the roller blind opens and closes.
5. Release the roller blind switch (B).
6. Confirm normal operation of the roller blind.

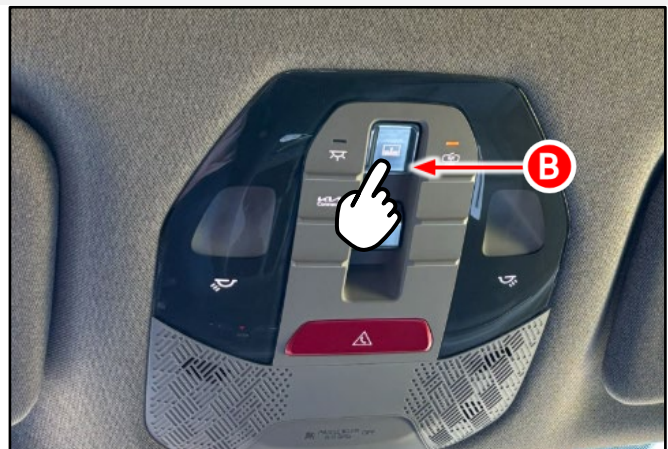

#### ⓘ IMPORTANT

**DO NOT** release the roller blind switch (B) until the operation has completed. If the switch is released prematurely, the initialization procedure will need to be restarted.

SUBJECT:

## SUNROOF LOGIC IMPROVEMENT AND SUNROOF/REAR ROLLER BLIND INITIALIZATION (SA615)

### AFFECTED VEHICLE RANGE:

Model	Production Date Range
EV9 (MV1a)	May 17, 2024 to June 6, 2025

### REQUIRED TOOL:

Tool Name	Part Number	Figure	Comments
Kia Diagnostic System (KDS)	N/A		KDS + VCI

### WARRANTY INFORMATION:

**N Code: N99 C Code: C99**

Claim Type	Causal P/N	Qty.	Repair Description	Labor Op Code	Op Time	Replacement P/N	Qty.
V	816PO XA000	0	(SA615) Sunroof Logic Improvement and Sunroof/Rear Roller Blind Initialization	250A13R0	0.6 M/H	N/A	0

**Note:** For Substitute Transportation policy, please refer to Service Policy and Procedures Manual (SPPM) 6.11 "Kia Substitute Transportation".

#### NOTICE

VIN inquiry data for this repair is provided for tracking purposes only. Kia retailers should reference SA615 when accessing the KDealer+ system.