



HYUNDAI

Technical Service Bulletin

GROUP CAMPAIGN	NUMBER 25-01-044H
DATE AUGUST 2025	MODEL(S) KONA ELECTRIC (SX2 EV)

SUBJECT: BDC SOFTWARE UPDATE (SERVICE CAMPAIGN TCWA)

*** IMPORTANT**

Dealers must perform this service campaign on all affected vehicles prior to customer retail delivery and whenever an affected vehicle is in the shop for any maintenance or repair.

Access the “Vehicle Information” screen via WebDCS to identify open campaigns.

Description: Some Kona Electric (SX2 EV) vehicles may experience battery drain due to faulty logic keeping the taillights illuminated while the vehicle is parked and turned off. Follow the procedures outlined in this TSB to update the Body Domain Controller (BDC) to the latest software.

Applicable Vehicles (Certain):

- 2024-2025MY Kona Electric (SX2 EV) vehicles produced from 04/29/2024 – 04/28/2025

SST Information:

Tool Name	Tool Number	Figure	Ordering Information
VCI 3	G0VHNNN06		Website: https://hyundaiesentialtools.com/ Email: Hyundaitools@snapon.com Phone: 1-855-763-9199 Hours: 7 AM – 7 PM CST
VCI 2	G1XDDMN001		

SUBJECT:

BDC OTA SOFTWARE UPDATE (SERVICE CAMPAIGN TCWA)

GDS Information:

System	Event Number	Description
BDC-BCM	1222	SX2/SX2 EV BDC LOGIC IMPROVEMENT

(*or use a later available event as listed in the GDS **BDC-BCM** update screen if one is available.)

NOTE 1: This software update is subject to an OTA (Over-the-Air) option and may be completed by customers with active Bluelink subscriptions.

Warranty Information:

Model	Op. Code	Operation	Op. Time	Causal Part	Nature Code	Cause Code
Kona Electric (SX2 EV)	50D066R0	BDC Software Update	0.6 M/H	95400-BF100	W11	ZZ3

NOTE 1: Submit claim on Claim Entry Screen as “Campaign” type.

NOTE 2: If a part is found in need of replacement while performing this campaign and the affected part is still under warranty, submit a separate claim using the same repair order. If the affected part is out of warranty, submit a Prior Approval request for goodwill consideration prior to performing the work.

NOTE 3: Op times include VIN, Mileage, and photo capture of the “ECU update complete” screen as outlined in the Digital Documentation Policy.

ROM ID Information:

Model	Event Number	System	ECU Part Number	ROM ID	
				Old	New
Kona Electric (SX2 EV)	1222	BDC-BCM	95400-BF100	3.00	3.20
			95400-BF110	3.10	

Service Procedure:

DIGITAL DOCUMENTATION

This TSB includes Repair validation photos. Refer to the latest Warranty Digital Documentation Policy for requirements.

NOTICE

You must initially perform the GDS ECU update in Auto Mode.

- If the ECU update starts but then fails in Auto Mode, perform the update in Manual Mode to recover.

NOTICE

Ensure the vehicle's battery charge is **above 11.0V** and the tablet's battery charge is **above 30%** before performing a software update to avoid the update from failing.

**Information**

- Turn off all lamps (do **NOT** leave head lamp switch in auto mode) and all accessories.
- Perform update with the ignition switch in the **ON** position.
- Do **NOT** disconnect any cables connected to the vehicle or scan tool during update.
- Do **NOT** start the engine during update.
- Do **NOT** turn off the ignition switch during update.

ECU Update Procedure

1. Perform the ECU update in **Auto Mode**.

After selecting Auto Mode, please scan the control unit's ROM ID.



Information

Refer to **TSB # 24-GI-012H**, “**ECU Update Procedure for Tablet-Based GDS-Smart**”, for additional information.

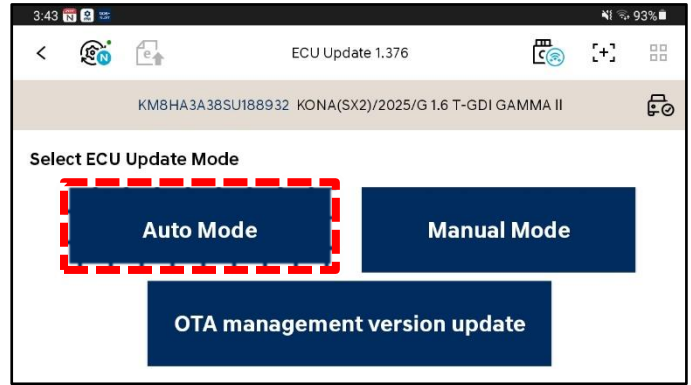

2. Select the **BDC-BCM** system to scan the vehicle's current ROM ID and then begin the update.

NOTICE

Check the current ROM ID version and compare it to the ROM ID Information table before attempting to perform the software update.

NOTICE

If the update fails, remove the power connector from the in-cabin fuse box or disconnect the negative (-) battery terminal for at least **5 seconds** and reassemble it to retry the update.

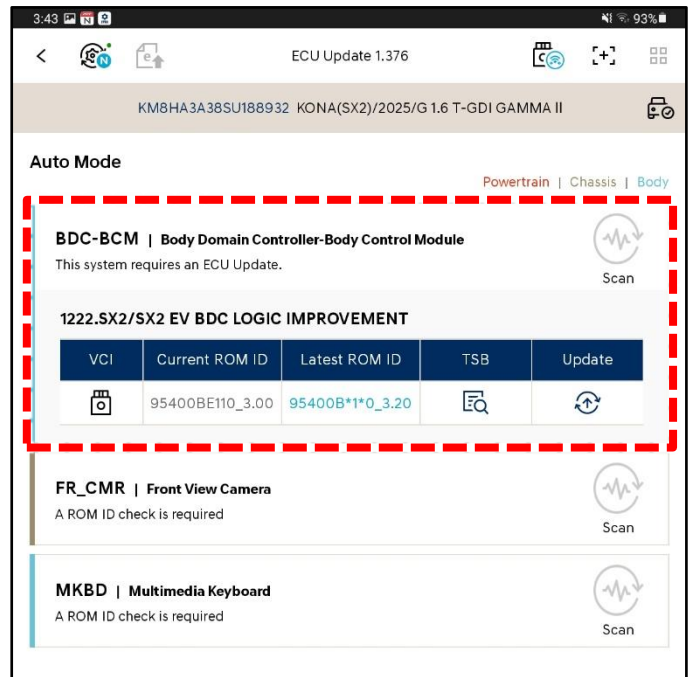

- After the ECU update process shows **100%** complete, follow the prompts on the screen to cycle the ignition for the prescribed time.



Information

Use the **Refresh** button to reset the timer.

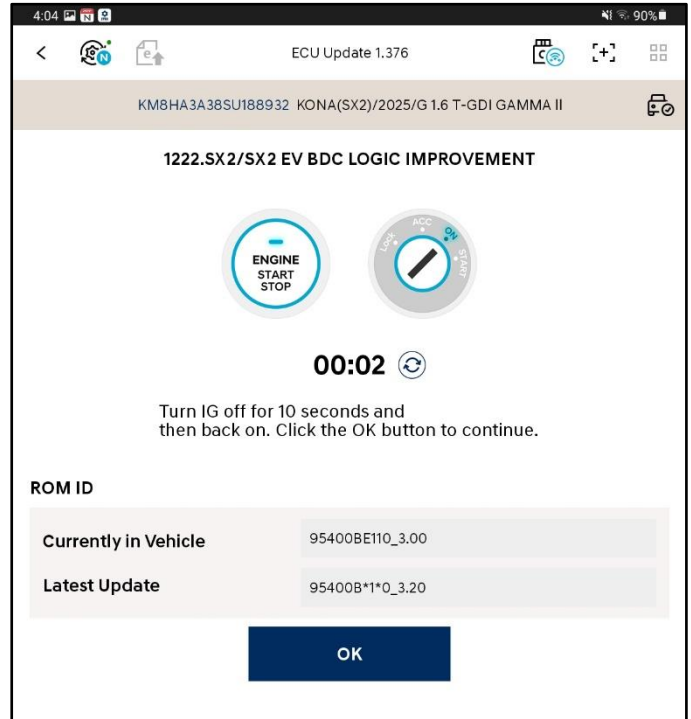

-

DIGITAL DOCUMENTATION



Take a screenshot of the ECU update complete screen using your tablet and upload to STUI.

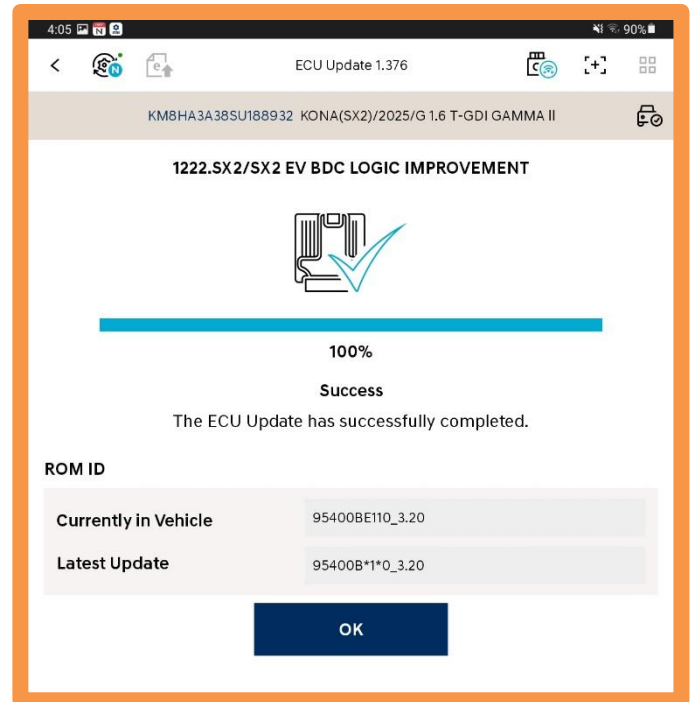

5. OTA initialization (A) should perform automatically:
 - If OTA initialization performs automatically, then proceed with the service procedure.
 - If the OTA initialization process fails, complete it manually under:
S/W Management > CCU_CCNF - Central Communication Unit (CCNF) > OTA Initialization (B).
 Follow the instructions on the screen.

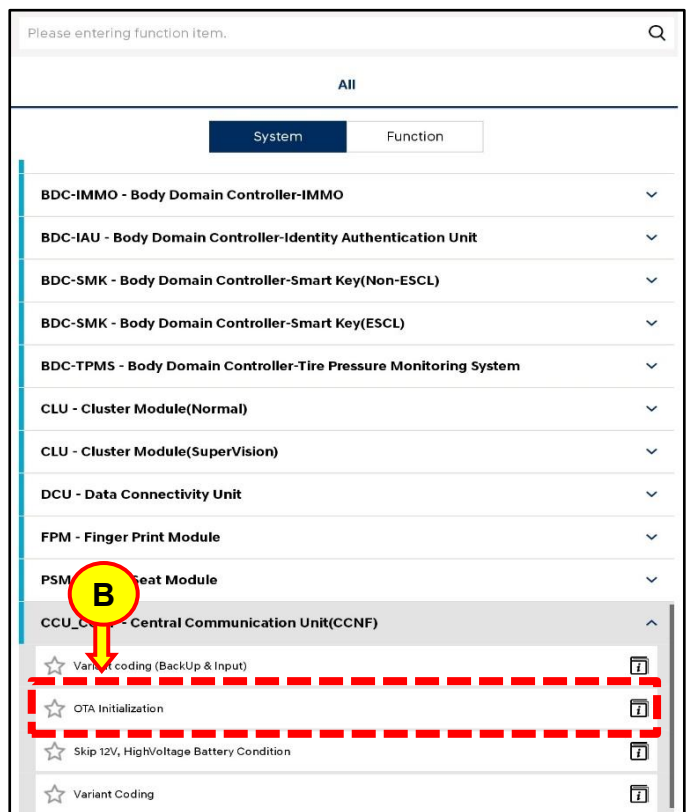
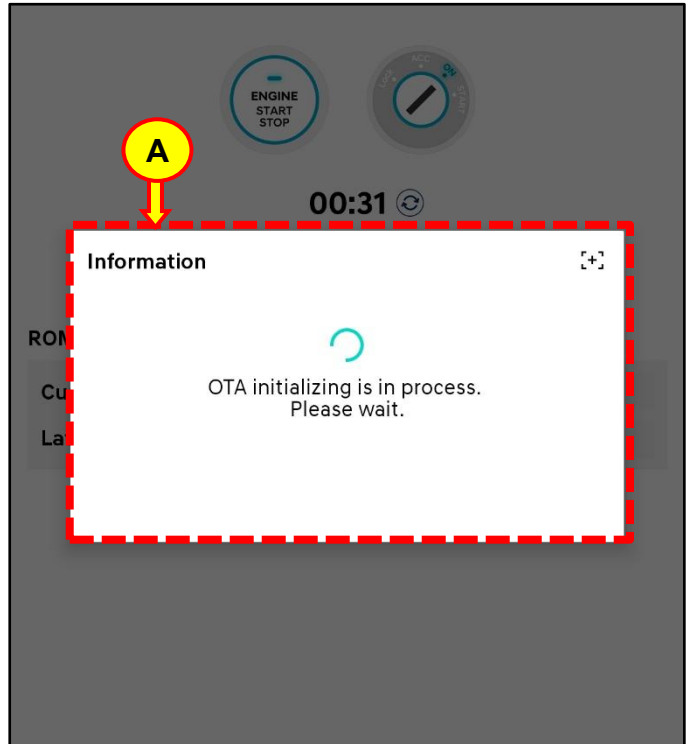

6. Perform an **All Systems Fault Code** search and erase DTC history that had incidentally occurred from the ECU update.

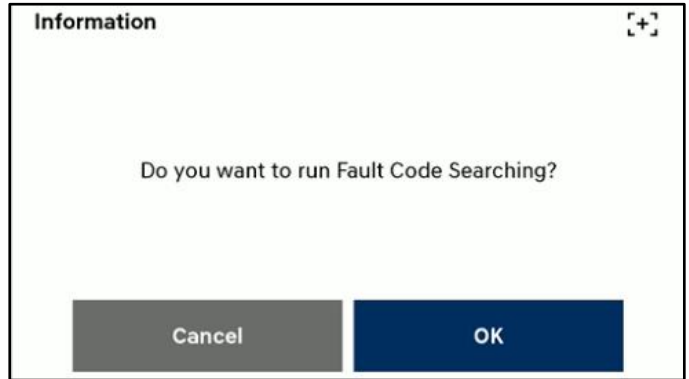

7. Disconnect the power connector (C) of the in-cabin fuse box, wait at least **5 seconds**, then reconnect it.

i Information

Alternatively, disconnect the negative (-) **12V** battery terminal, wait **5 seconds**, then reconnect it.

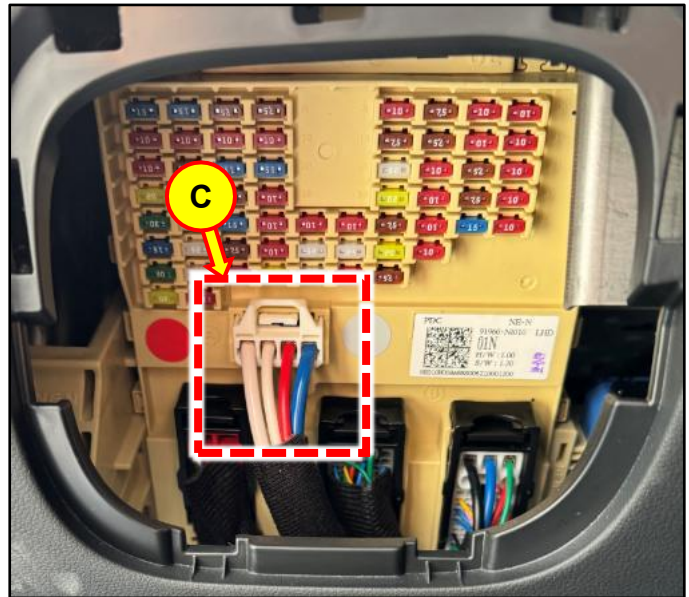

8. Place the vehicle in **Ready** mode to confirm proper operation of the vehicle.

NOTICE

If either ECU update fails in Auto Mode, perform the update in Manual Mode using the password(s) below.

Manual Mode Password:

Event Number	ECU Menu	Password
1222	SX2 EV BDC 95400-BF100/10	5400