

Search

[Help Center Home](#) / [Article](#)

07/15/2025

## 2015-2024 Scout Headlight Replacement and Adjustment

### Headlight Lamp Replacement

To remove and replace the headlight lamp bulb on your Indian Scout or Scout Sixty, do the following:

1. Remove the headlight retaining screw (1) with a Phillips socket.
  2. Lift the headlight upward and remove it from the base (2).
  3. Disconnect the wire harness (3).
  4. Remove the rubber boot from the rear of the headlight.
  5. Squeeze the bulb retainer (4) and move it away from the bulb. Remove the bulb.
  6. Install the new bulb (5) and secure the retainer. The bulb is [part number 4014860](#).
  7. Reinstall the rubber boot, making sure it seals around the bulb and headlight.
  8. Connect the wire harness.
  9. Reinstall the headlight to the base and tighten the screw. **Torque** to 36 in-lbs (4.1 Nm).
-

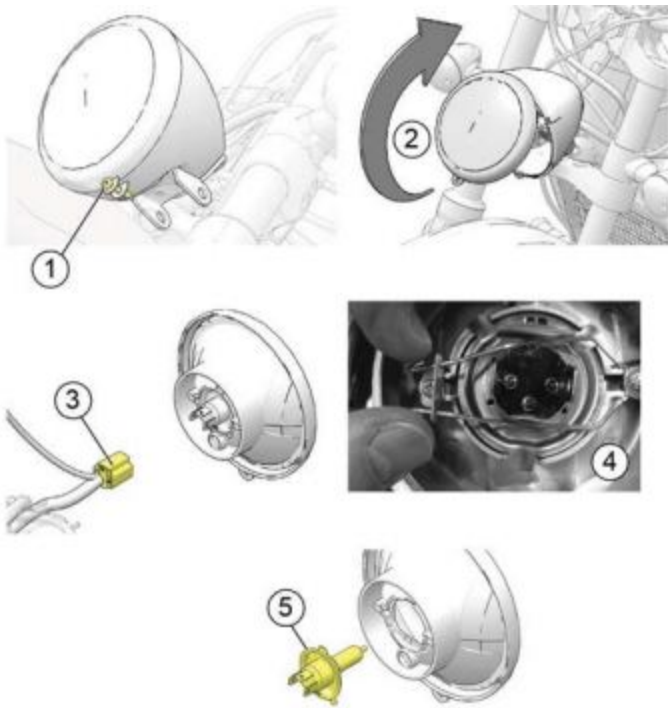

### **For Scout Bobber Models**

The headlight bulb (1) in a Scout Bobber, Scout Bobber Twenty or Scout Bobber Sixty can be serviced and removed from the back of the headlight bucket without disassembling the headlight lamp.

To replace a bulb, do the following:

1. Disconnect the wire harness (2).
  2. Remove the rubber boot from the rear of the headlight.
  3. Squeeze the bulb retainer (3) and move it away from the bulb. Remove the bulb.
  4. Install the new bulb (4) and secure the retainer.
  5. Reinstall the rubber boot, making sure it seals around the bulb and headlight.
  6. Connect the wire harness.
-

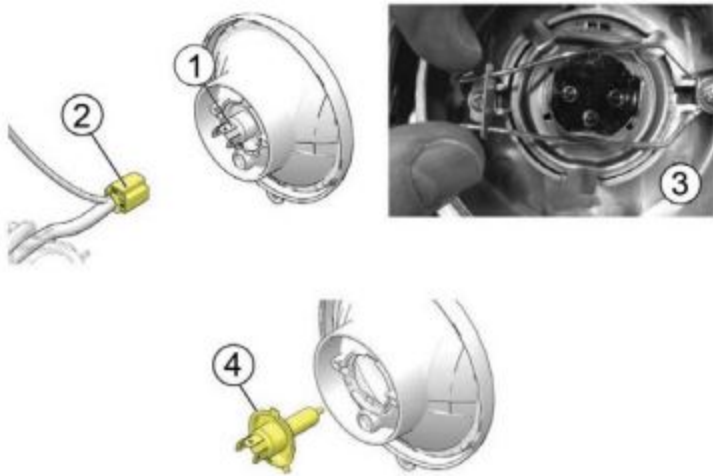

### **Headlight Aim Adjustment**

Adjust the headlight aim when there is a change in load (rider, cargo, accessories, etc.) and/or after a suspension adjustment. To inspect the aim on a Scout or Scout Sixty, follow these steps:

- 1.** Verify that tire pressure is at specification. The front tire should be at 36 psi (248 kPa). The rear tire should be 40 psi (276 kPa).
- 2.** Verify that the rear suspension ride height (preload) is at specification. The ride height should be 282mm on both shocks.
- 3.** Position the motorcycle on a level surface with the headlight 32 feet, 10 inches (10m) from a wall.
- 4.** With the operator and passenger (if applicable) on board, bring the motorcycle to the fully upright position.
- 5.** Start the engine and switch the headlight to low beam. Observe the headlight aim on the wall.
- 6.** Make any necessary adjustments to the headlight aim, per the diagram below.

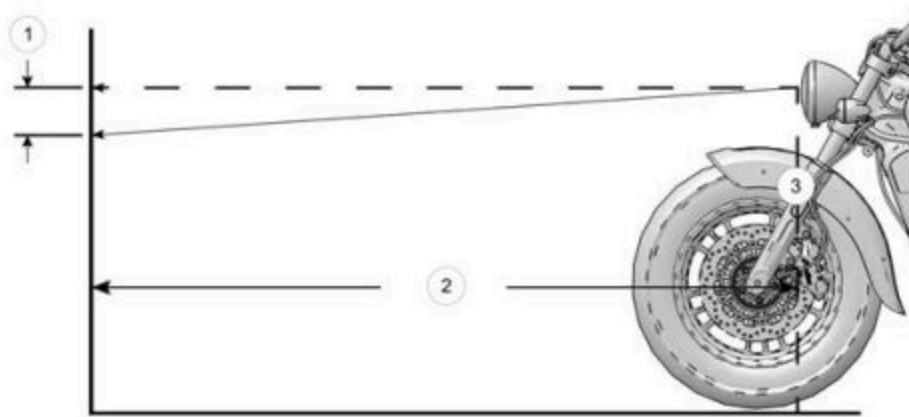

NUMBER	DESCRIPTION
①	Halogen headlights: 4 in. (10 cm) to top of highest intensity
	LED Headlights: 4 in. (10 cm) to top cut-off of beam
②	Measure distance = 32 ft. 10 in. (10.0 m)
③	Headlight Center

To adjust the headlamp vertically, loosen the housing mount fastener (1) with a 15mm socket and pivot the housing upward or downward. Tighten the fastener. **Torque** to 35 ft-lbs (47.5 Nm).

To adjust the headlamp horizontally, loosen the headlight mounting bolt (2) with a 10mm socket and pivot the headlight to the left or right. Tighten the bolt. **Torque** to 18 ft-lbs (24.4 Nm).

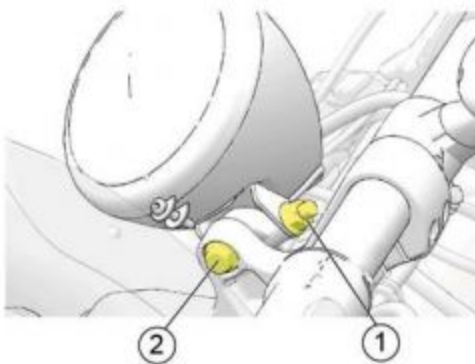

### For Scout Bobber Models

On LOW beam, the horizontal cut-off of the light beam (1) should be 4 inches (10 cm) lower than the center of the headlight bulb and centered straight ahead at 32 feet, 10 inches (10m).

To inspect the aim on a Scout Bobber, do the following:

**1.** Verify that the tire pressure is at specification. The front tire should be at 36 psi (248 kPa). The rear tire should be 40 psi (276 kPa).

2. Verify that the rear suspension ride height (preload) is at specification. The ride height should be 275mm on both shocks.
3. Position the motorcycle on a level surface with the headlight 32 feet, 10 inches (10m) from a wall.
4. With the operator and passenger (if applicable) on board, bring the motorcycle to the fully upright position.
5. Start the engine and switch the headlamp to low beam. Observe the headlight aim on the wall.
6. Make any necessary adjustments to the headlight aim.

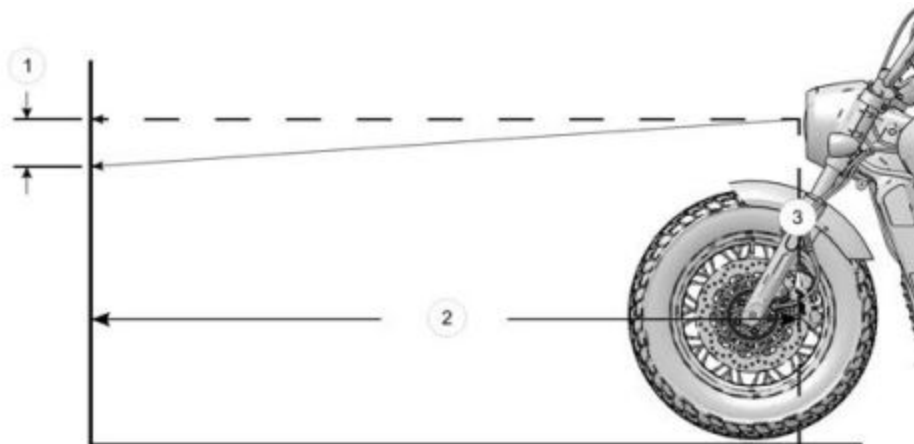

NUMBER	DESCRIPTION
①	4 in (10 cm) to top cut-off of beam
②	Measure distance = 32 ft 10 in (10.0 m)
③	Headlight Center

To adjust the headlamp vertically, loosen the housing mount fastener (1) with a 15mm socket and pivot the housing upward or downward. Tighten the fastener. **Torque** to 35 ft-lbs (47.5 Nm).

To adjust the headlamp horizontally, loosen the headlight mounting bolt (2) with a 10mm socket and pivot the headlight to the left or right. Tighten the bolt. **Torque** to 18 ft-lbs (24.4 Nm).

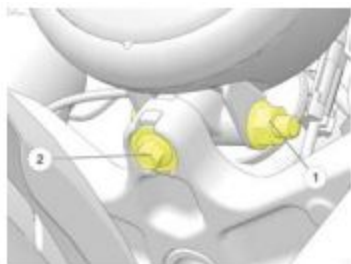

Inside the headlight assembly you also will find a smaller position bulb shown below. This can be replaced using the same procedure as the main headlight procedure detailed above. The position

bulb is required for compliance purposes in certain markets and helps provide visibility of the motorcycle in the event your headlight bulb is inoperable. Never operate your motorcycle without an operational headlight. When the motorcycle's ignition is in accessory mode, the position bulb will be illuminated while the headlight bulb remains off. To place your bike in accessory position, turn the key forward to the on position and then push the key inward and turn forward to the accessory position. The position bulb is [part number 4015261](#).



For more on maintenance procedures, consult your [Owner's Manual](#).  
To find replacement parts, view the [online parts catalog](#).  
To find an Indian Motorcycle Dealer near you, use the [Dealer Locator](#).

*Unless noted, trademarks are the property of Indian Motorcycle International, LLC  
© 2022 Indian Motorcycle International, LLC*

Was this article helpful?

- Yes, it answers my question
- No, it's missing information or visuals
- No, the instructions are unclear
- No, What are the next steps?
- No, I'm experiencing a technical error
- Other

---

\* [-] **How can we improve this article? We'd love to hear your suggestions**

---

Tell us what you would like to see in this article

Send

---

**Keyword(s)** [headlight](#) , [lamp](#) , [bulb](#) , [instruction](#) , [Scout](#) , [Bobber](#) , [remove](#) , [replace](#) ,

---

## HELPFUL LINKS

---

[Parts, Accessories and Apparel](#)  
[Owner's Manuals](#)  
[Indian Motorcycle Protection Plan](#)  
[Special Offers](#)  
[Recalls](#)  
[Indian Motorcycle Lubricants](#)

## CONTACT US

---

### **BY E-MAIL**

Send us an e-mail inquiry.

---

### **CLICK TO CALL**

---

### **BY DEALER**

Locate the nearest dealer in your area.

**SUBSCRIBE NOW**

**FIND A DEALER**

---

**US-ENGLISH**

**MOTORCYCLES**

**SHOPPING TOOLS**

**ASSISTANCE**

**OWNER RESOURCES**

**ABOUT US**

© 2025 Indian Motorcycle

[Site Map](#)

[Privacy](#)

[Your Privacy Choices](#) 

[Terms](#)

[Accessibility](#)

[Careers](#)

[Global Sites](#)

---