

REFERENCE:	TSB: 23-028-25 GROUP: 23 - Body	Date:	July 16, 2025	REVISION:	-
VEHICLES AFFECTED:	2025 - 2026 (B1) Jeep Renegade This bulletin applies to vehicles built on or after January 05, 2025 (MDH 0105XX) and on or before June 04, 2025 (MDH 0604XX).			MARKET APPLICABILITY: <input checked="" type="checkbox"/> NA <input type="checkbox"/> MEA <input checked="" type="checkbox"/> SA <input type="checkbox"/> IAP <input type="checkbox"/> EE <input type="checkbox"/> CH NOTE: This bulletin applies to North America and South America markets	
CUSTOMER SYMPTOM:	Customers may comment on the following: <ul style="list-style-type: none"> Loose front door applique. 				
CAUSE:	Burr in the trim clipping area				

This Technical Service Bulletin (TSB) has also been released as a Rapid Service Update (RSU) 25-133, date of issue July 16, 2025. All applicable RSU VINs have been loaded. To verify this RSU service action is applicable to the vehicle, use VIP or perform a VIN search in DealerCONNECT/Service Library. All repairs are reimbursable within the provisions of warranty.

REPAIR SUMMARY:

This bulletin involves inspecting and possibly replacing one or both front door appliques.

CLAIMS DATA:

Labor Operation No:	Labor Description	Skill Category	Labor Time
23-05-11-9B	Front Door Applique - Inspection (0 - Introduction)	6 - Electrical and Body Systems	0.2 Hrs.
23-05-11-9C	Front Door Applique – Inspect And Replace - One Side (0 - Introduction)	6 - Electrical and Body Systems	0.4 Hrs.
23-05-11-9D	Front Door Applique – Inspect And Replace - Both Sides (0 - Introduction)	6 - Electrical and Body Systems	0.8 Hrs.
Failure Code	ZY	Service Action	

SPARE PARTS:

Qty	Part No.	Description	Notes
1 (AR)	EMEA - 7099554	Applique - Direita / Right	
1 (AR)	EMEA - 7099555	Applique - Esquerda / Left	

DIAGNOSIS:

If a customer's VIN is listed in VIP or your RSU VIN list, perform the repair. If any vehicle not on the VIN list exhibits any of the symptom listed above in the customer symptom section, perform the Repair Procedure.

REPAIR PROCEDURE:

NOTE: Perform this procedure for both front doors.

1. Lower both front door windows.
2. Gently pull the left front door applique outwards [Fig. 1](#). Perform this same action on the right front door applique.

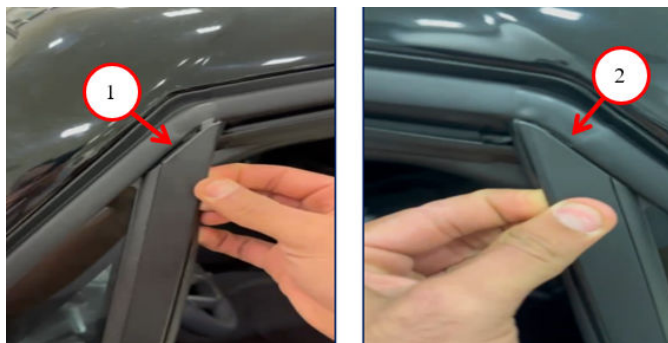

Fig. 1
Pull Door Applique Outward

1 - Loose Door Applique
2 - Properly Fit Applique

-
3. Does either front door appliques come off easily [Fig. 1](#)?
 - YES>>> Replace the affected front door applique. Proceed to [Step 4](#).
 - NO>>> This bulletin has been completed. Use Inspection LOP (23-05-11-9B) to close the active RSU.

4. Remove the door applique [Fig. 2](#).



Fig. 2
Remove Door Applique

1 - Remove Door Applique

5. Pull the trim away; fitting the door applique from top to bottom [Fig. 3](#).



Fig. 3
Insert Door Applique

1 - Trim
2 - Door Applique

6. Clip the door applique on top [Fig. 4](#).



Fig. 4
Clip Door Applique

1 - Clip door applique

7. Press the door applique to secure it to the clips [Fig. 5](#).



Fig. 5
Press Door Applique To Clips

1 - Clipping Door Applique

8. Install and press the trim back in place Fig. 6.



Fig. 6
Install Trim

9. Confirm the door applique is properly installed Fig. 7.



Fig. 7
Properly Installed Door Applique

NOTE: For SA market only, after applying this TSB, it is not necessary to send DID-I or DID-A.

POLICY:

Reimbursable within the provisions of the warranty.

This bulletin is supplied as technical information only and is not an authorization for repair. No part of this publication may be reproduced, stored in a retrieval system, or transmitted, in any form or by any means, electronic, mechanical, photocopying, or otherwise, without written permission of FCA US LLC.