

ADDRESSEES	: Owners and operators ABC Customer Care and parts Source
VEHICLE MODEL	: TD925 and TDX25
MANUAL CHAPTER	: 07.06 Steering system – Front axle steering
BULLETIN TYPE	: Service information
DATE	: July 11 th , 2025
SUBJECT	: Introduction of new components in front axle steering system
TERMS AND CONDITIONS	: This service bulletin does not entitle to any reimbursement.

INTRODUCTION

The purpose of this service bulletin is to inform you that VDL Van Hool will switch over to other components for the front axle steering system. This switch-over will be cut into production as from units 89249 (TDX25 Diesel) and 89558 (TDX25 E). Previous references may be used further, but for future orders only the new components will be supplied.

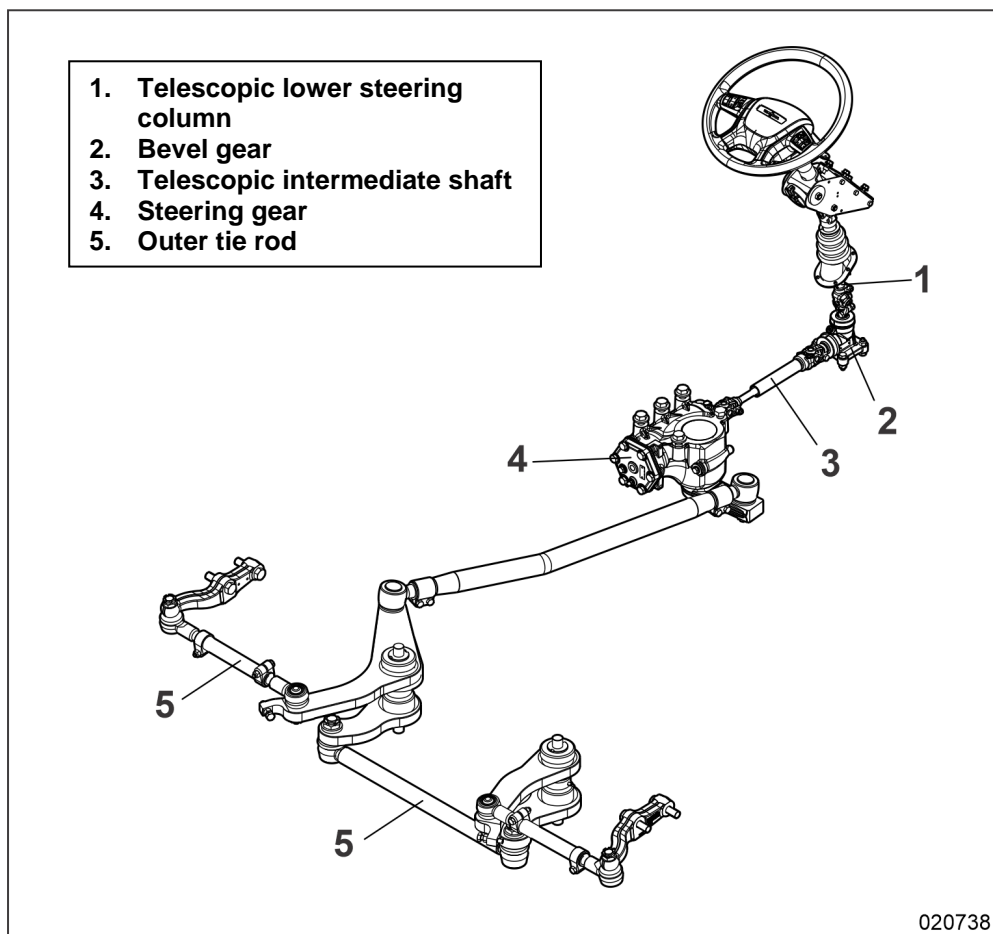

Figure 1: Front axle steering linkage

Continued on next page.

AFFECTED COMPONENTS

Component	Previous reference	New reference	Remark
Components replaced			
Steering gear	10962967	11921436	Fully interchangeable
Bevel gear	10598332	11921759	Fully interchangeable
Outer tie rod	10861014	11856638	Fully interchangeable
New components			
Telescopic intermediate shaft (between steering gear and bevel gear)	-	11922920	Incorporates two universal joints (one fixed, one removable)
Telescopic lower steering column	-	11502740	Incorporates two universal joints (one fixed, one removable).
Intermediate shaft components which are no longer supported by manufacturer			
Flexible joint (at output side of bevel gear side)	634203950	-	In case replacement is necessary, use telescopic intermediate shaft 11922920.
Fixed intermediate shaft (between steering gear and bevel gear)	10513058	-	In case replacement is necessary, use telescopic intermediate shaft 11922920.
Universal joint (at input side of steering gear)	11554246	-	In case replacement is necessary, use telescopic intermediate shaft 11922920.
Lower steering column components which are no longer supported by manufacturer			
Telescopic lower steering column	11175361	-	In case replacement is necessary, use telescopic intermediate shaft 11502740.
Universal joint (at input side of bevel gear)	11554246	-	In case replacement is necessary, use telescopic intermediate shaft 11502740.

HELP DESK

If there are any questions regarding this subject, please call ABC Customer Care & Parts Source toll-free for guidance on 1-877-427-7278.

DISCLAIMER

The procedures contained herein are not exclusive. VDL Van Hool cannot possibly know, evaluate, or advise the transportation industry of all conceivable ways in which a procedure may be undertaken or of the possible consequences of each such procedure. Other methods may be equally reasonable or even more effective, depending on the specific circumstances involved. Each carrier that uses the procedures herein must first thoroughly ensure that neither the safety of its employees or agents, nor the safety or usefulness of any products, will be jeopardized by any procedure selected.

Continued on next page.

INFORMATION HANDLING

Important supplements to and modifications of technical information not yet included in the manual, are communicated by means of service Bulletins.

VDL VAN HOOL CUSTOMER PORTAL

Consult the customer portal regularly for the latest service documentation. In addition to the maintenance manual, you will also find the operating manual and the spare parts catalogue of your vehicle on the customer portal. The customer portal is accessible through www.vdlvanhool.com/My VDL Van Hool, and only with a code (password) from VDL Van Hool. If you do not have a password yet, request it by using the link on the VDL Van Hool website.