

July 2, 2025

Version 4

Rear Wheel Area Screeching or Scraping

Supersedes 24-025, dated July 31, 2024, to revise the information highlighted in **yellow**.

AFFECTED VEHICLES

Year	Model	Trim Level	VIN Range
2022- 24	MDX (2WD)	ALL	ALL
2022- 24	MDX (4WD)	ALL	ALL
2025	MDX (2WD)	ALL	5J8YD...SL000001 thru 5J8YD...SL001024
2025	MDX (4WD)	ALL	5J8YE...SL000001 thru 5J8YE...SL003896

REVISION SUMMARY

Under AFFECTED VEHICLES, the information has been updated.

SYMPTOM

Screeching, squeaking, rubbing, or scraping from the rear wheel area.

POSSIBLE CAUSE

Rocks are getting caught between the rear brake disk and splash guard.

CORRECTIVE ACTION

Remove and install both sides of the rear brake splash guards.

PARTS INFORMATION

Part Name	Part Number	Quantity
Washer Bolt (12X49)	90160-TZ5-A01	8
Spindle Nut (AWD Models Only)	90305-S3V-A11	2
Left-Rear Splash Guard	43254-TYA-A01	1
Right-Rear Splash Guard	43253-TYA-A01	1
Caliper Mounting Bolt (12x30)	90103-SHJ-000	4

CLIENT INFORMATION: The information in this bulletin is intended for use only by skilled technicians who have the proper tools, equipment, and training to correctly and safely maintain your vehicle. These procedures should not be attempted by “do-it-yourselfers,” and you should not assume this bulletin applies to your vehicle, or that your vehicle has the condition described. To determine whether this information applies, contact an authorized Acura automobile dealer.

WARRANTY CLAIM INFORMATION

The normal warranty applies.

Operation Number	Description	Flat Rate Time	Defect Code	Symptom Code	Template ID	Failed Part Number
8131A5	Replace both rear brake splash guards.	1.1 hr	00401	04201	B24025A	43254-TYA-A00

Skill Level: Repair Technician

REPAIR PROCEDURE

1. Release the parking brake.
2. Raise the vehicle to a comfortable working height.

NOTE: When working with a Type S model with an electronic air suspension, be sure to set it to the leveling off mode to prevent unexpected operation.

[Electronic Air Suspension System Service Precautions](#)

3. Put the rear caliper in maintenance mode ([CLICK HERE](#)).

NOTE: Turn the vehicle OFF once in maintenance mode.

4. Remove both rear wheels.

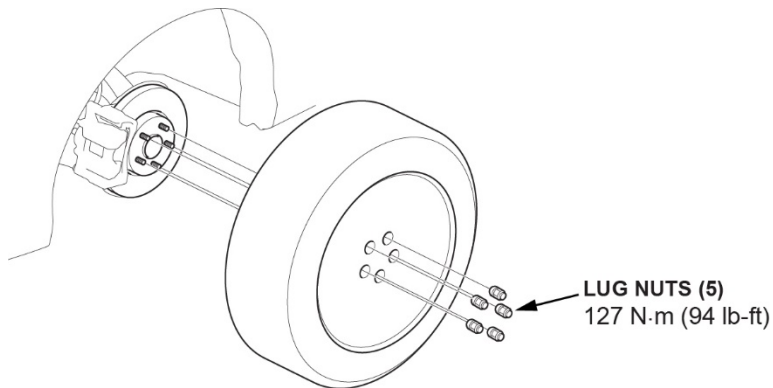

5. Remove the bolts from the rear brake brackets.

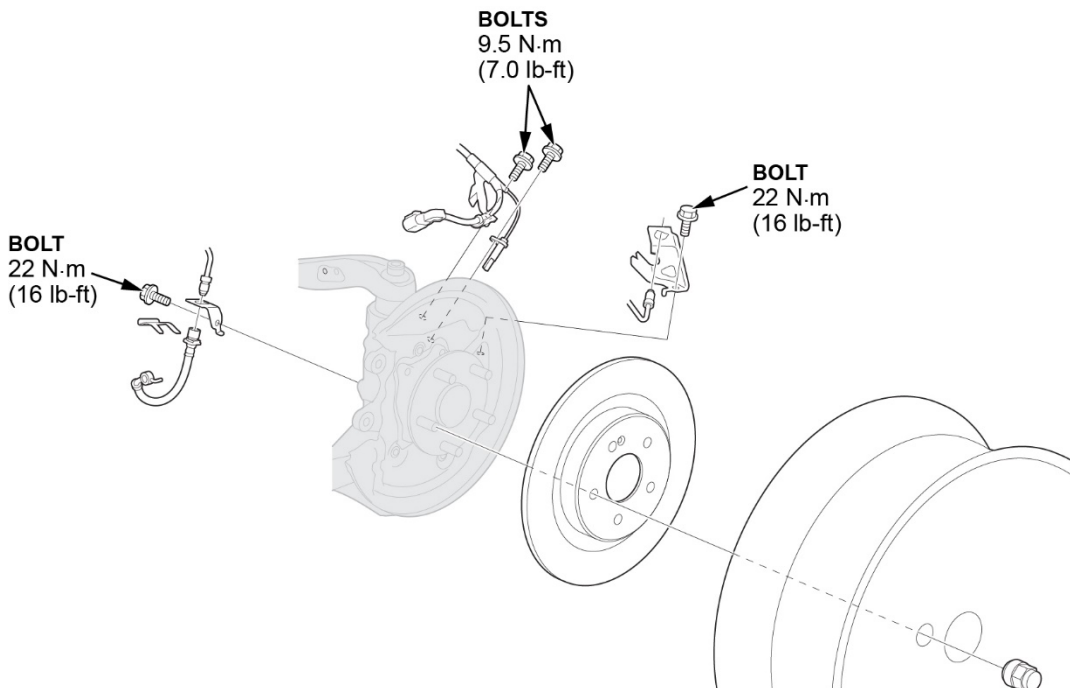

6. Remove the rear caliper and use a short piece of wire to hang the caliper assembly **108 N·m (80 lb-ft)**.
NOTE: To prevent damage **DO NOT** twist the brake hose excessively.



7. Remove the screw holding the rear disc, then remove the rear disc **9.5 N·m (7 lb-ft)**.



8. **AWD Only:** pry up on the stake on the spindle nut, then remove the spindle nut.

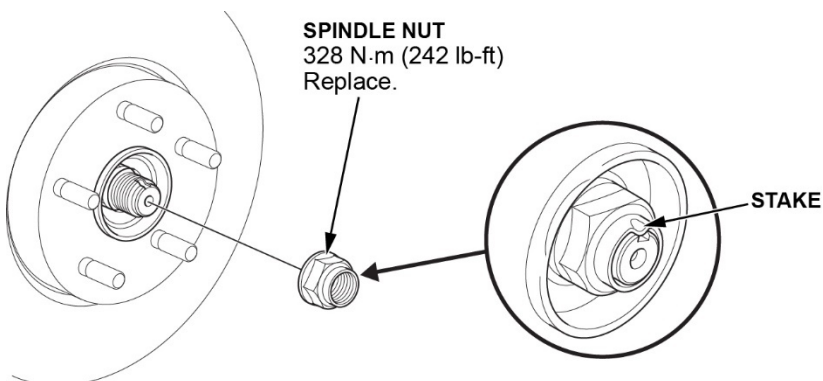

9. Remove the hub bearing unit and the splash guard.

NOTE: Keep the wheel bearing/encoder away from any magnetic field, as this can damage or erase the encoder.

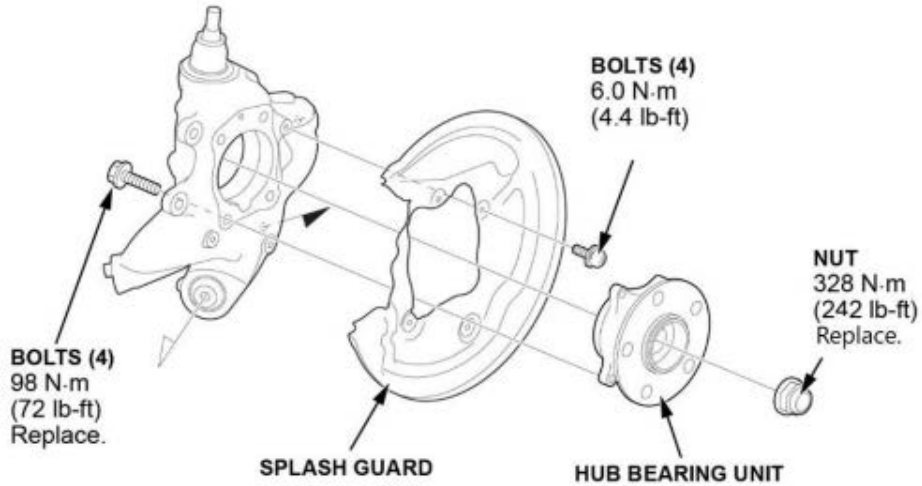

10. Install the new splash guard **6.0 N·m (4.4 lb-ft)**.

11. Install all parts in the reverse order of removal.

12. Repeat this process on the opposite side.