 <b>HYUNDAI</b> <b>Technical Service Bulletin</b>	<b>GROUP</b> <b>BODY ELECTRICAL</b>	<b>NUMBER</b> <b>25-BE-011H</b>
	<b>DATE</b> <b>MAY 2025</b>	<b>MODEL(S)</b> <b>IONIQ 5 (NEA EV)</b>
<b>SUBJECT:</b> INSIDE REAR COMBINATION LAMP INSPECTION AND REPLACEMENT		

**Description:** Certain 2025MY IONIQ 5 (NEA EV) vehicles may exhibit some or all inoperative LEDs on the inner rear combination lamp. The concerning LEDs, housed within the inner rear combination lamp assembly, are components of the auxiliary lamp circuit and do not affect brake or turn signal operation. Follow the procedure outlined in this TSB to inspect and, if necessary, replace the inner rear combination lamp assembly.



**Applicable Vehicles:**

- 2025MY IONIQ 5 (NEA EV) produced from 11/12/2024 - 05/14/2025

**NOTICE**

To avoid any potential damage to IONIQ vehicles, IONIQ repairs can only be performed at IONIQ certified dealers.

**SUBJECT:** INSIDE REAR COMBINATION LAMP INSPECTION AND REPLACEMENT**Parts Information:**

Model	Part Name	Part Number	Figure	Remarks
IONIQ 5 (NEA EV)	Lamp Assy-Center Garnish	92409-PI050		Qty: 1
		92409-PI150		

**Warranty Information:**

Model	Op. Code	Operation	Op. Time	Causal Part	Nature Code	Cause Code
IONIQ 5 (NEA EV)	50DV08R0	Inside Rear Combination Lamp Inspection and Replacement	0.5 M/H	92409 PI050	I14	ZZ3
	50DV08R1			92409 PI150		

**NOTE 1:** Submit claim on Claim Entry Screen as “Campaign” type.

**NOTE 2:** If a part is found in need of replacement while performing this TSB and the affected part is still under warranty, submit a separate claim using the same repair order. If the affected part is out of warranty, submit a Prior Approval request for goodwill consideration prior to performing the work.

**NOTE 3:** This TSB includes repair justification photos. Op times include VIN, Mileage, and repair justification photo(s) as outlined in the Digital Documentation Policy.

**NOTE 4:** The incident parts are subject to callback through the normal Warranty Technical Center (WTC) parts return process. Claim is subject to debit if the part is not returned.

**Service Procedure:**

**DIGITAL DOCUMENTATION**



This TSB includes repair justification photos. Refer to the latest Warranty Digital Documentation Policy for requirements.

**NOTICE**

Applying the recommended torque to all fasteners is essential to reduce potential issues from occurring after the service procedure.

1. Remove the key fob from the vehicle and ensure all doors are closed.

With the key fob in hand, stand behind the vehicle approximately **8 feet** away from the rear bumper (A).

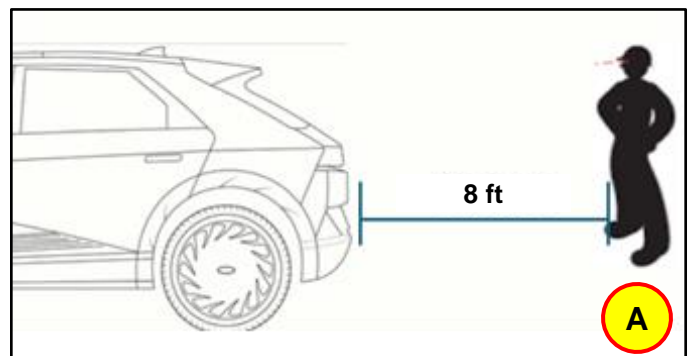

2. Press the lock button (B) on the key fob **15 times**, giving about a **1 second** pause in between each press.

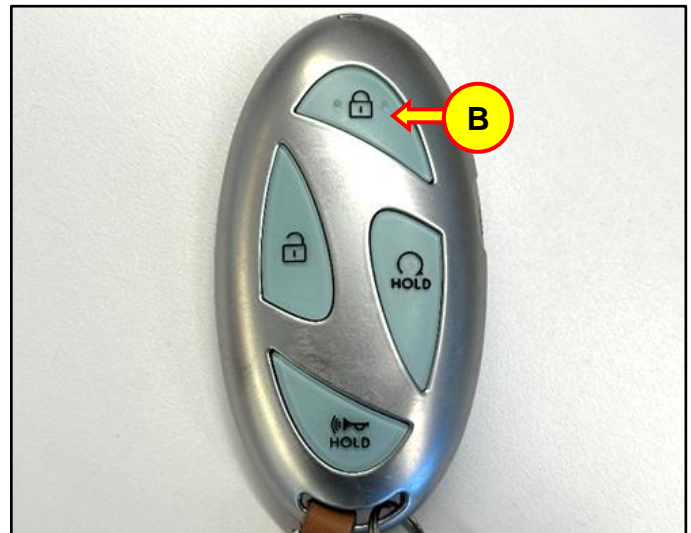

**SUBJECT:** INSIDE REAR COMBINATION LAMP INSPECTION AND REPLACEMENT

3. Each time the key fob lock button is pressed, the entire rear tail lamp will cycle **ON** and **OFF**. Pay close attention to the inside rear combination lamps ensuring all the LED lights are working as designed.

If the inside rear combination lamps are working as designed, but other concerns are present, this TSB does **NOT** apply. Diagnose and repair per the shop manual.

If the inside rear combination lamps are **NOT** working as designed, then proceed with the replacement procedure.

**NOTICE**

Before proceeding with replacement, submit repair justification photos as outlined in the Digital Documentation Policy.

**Example of Inside Rear Combination Lamp Working as Designed**



**Example of Inside Rear Combination Lamp NOT Working as Designed**



- 4.

**DIGITAL DOCUMENTATION**



Using STUI, take a photo of the malfunctioning tail lamp(s) housed in the Inside Rear Combination Lamp Assembly with the last 6 digits of the VIN and the date of repair on a piece of paper.

Upload the photo to STUI.



Inside Rear Combination Lamp Replacement

1. Use a small flathead screwdriver to remove the trunk handle cover.

Remove the **two** Phillips screws (A).

**NOTICE**

Use plastic trim removal tool to prevent damage.



2. Use a small flathead screwdriver and carefully pry the trunk switch outward. Disconnect the connector and remove the switch (B).

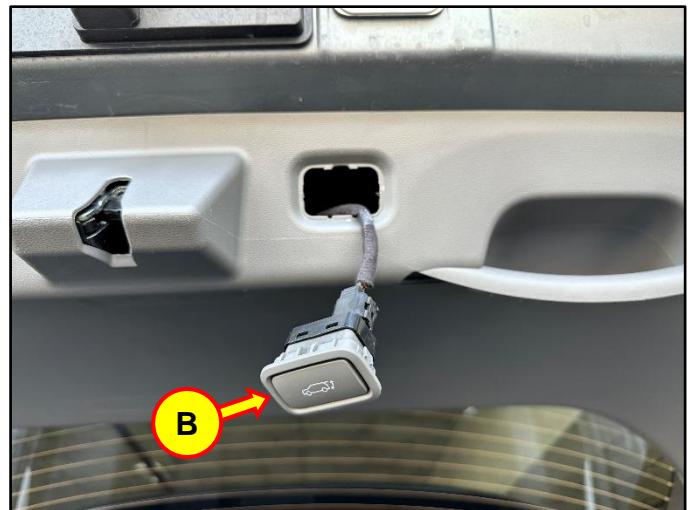

3. Remove the tailgate lower trim.

Use a panel removal tool and carefully pry the corner left and right side of the tailgate lower trim (C).



**SUBJECT:** INSIDE REAR COMBINATION LAMP INSPECTION AND REPLACEMENT

4. Carefully pry outward with the panel removal tool, then pull the lower trim away from the tail gate assembly and remove it.

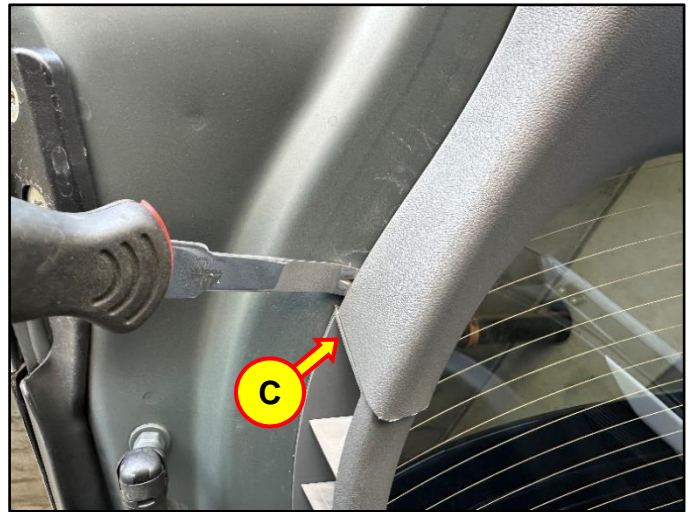

5. Disconnect the inside rear combination lamp connector (D).

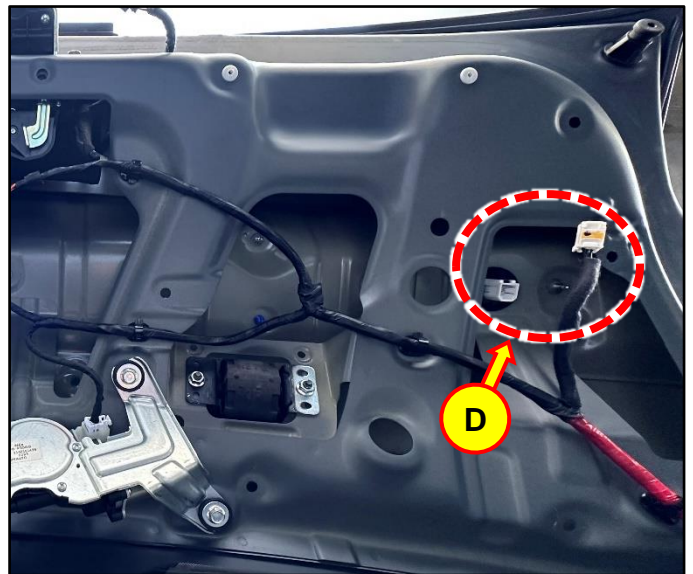

6. Remove the **nine 10 mm nuts** (E).

**Tightening Torque:**

lb-ft	1.8
lb-in	22
N.m	2.5

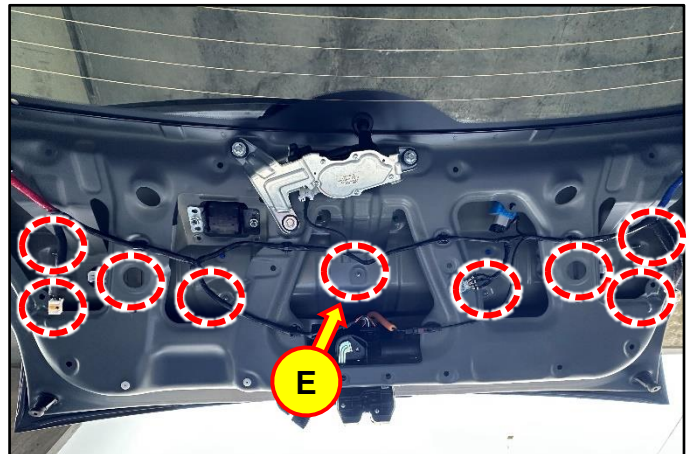

7. Carefully remove the inside rear combination lamp.

**NOTICE**

If the inside rear combination lamp does **NOT** come out easily, then use a flat tool and carefully push the plastic locking tab inward (F).

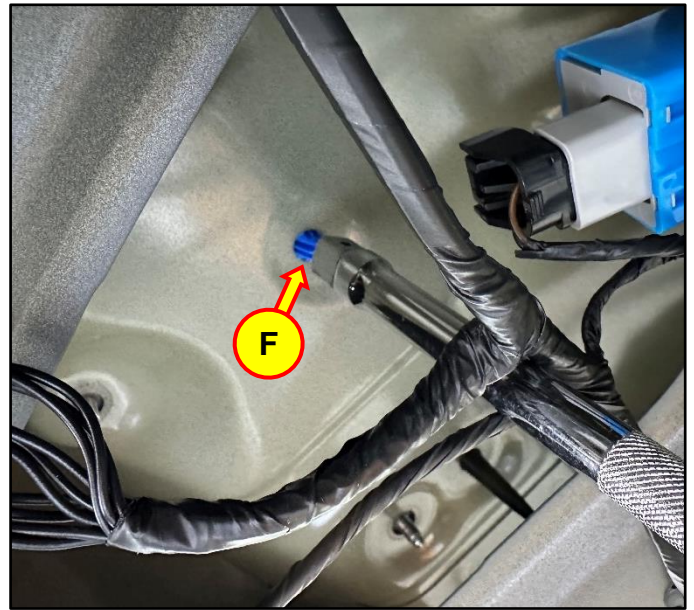

8. Reinstall all components in reverse order and inspect operation of tail lamps.
9. The service procedure is now complete.