

ATTENTION: Mercedes-Benz Dealer Principals, General Managers, Sales Managers, Service Managers & Parts Managers

Service Campaign Notification

May 2, 2025

Campaign #	Description	<h3>Update Electronic Ignition Lock Control Unit – Mercedes Me Connect OTA</h3>
N/A	25P5499123	
<input checked="" type="checkbox"/> Over-the-Air (“OTA”) Update		

Campaign Details

Total Recall Population	41,566	Model(s)/ Platform(s)	C-Class, CLE, EQE SUV, EQE, EQS SUV, EQS, GLC, GT, S-Class, SL (206, 236, 294, 295, 296, 297, 254, 192, 223, 232)
Model Year(s)	2023-2024		
Issue	Mercedes-Benz AG, the manufacturer of Mercedes-Benz vehicles, has determined that on certain subject vehicles, the ignition lock (EZS) control unit does not correspond with the latest series production configuration. The EZS control unit will receive an OTA software update which will improve the performance of hands-free access on the affected vehicles.		
Remedy	MBUSA will conduct an OTA service campaign. Remote software updates are automatically downloaded and installed in the customer’s vehicle free of charge and do not require a dealer visit.		
Launch Date	The vehicles will not be visible or flagged in VMI or EVA.		
Warranty Claim Notice	Please note the campaign will close after the warranty claim has been submitted. This change can take at least one-day to reflect in NetStar VMI.		

Please refer all customer inquiries to the Customer Care Center at 1-800-FOR-MERCEDES.



Dealers can check for a successful OTA update in VeDoc, or the customer can check using the Mercedes me connect App. Customers can continue to drive their vehicle. Sufficient battery voltage may be required for the OTA update to be initialized. If the vehicle has not been driven in four or more weeks, the ignition should be cycled to initialize the process.

Instructions to verify a successful OTA update in VeDoc:

Dealers can search the VIN in VeDoc (Figure 1, A), then click "Control Units" and "EZS (Figure 1, B and C). If the Software Object Number (Figure 1, D) is "206 902 93 12", then the OTA update was successful.

The screenshot shows the VeDoc interface with the following elements:

- Search Bar (A):** A search input field for VIN or FIH.
- Navigation (B):** A menu bar with tabs including "Control units".
- Control Unit List (C):** A table listing various control units. The "EZS" row is highlighted in green, indicating it is selected.
- Software Object Number (D):** A table below the main list showing the "Object number" as "206 902 93 12".

Designation	Model	Diogenes name	Short des.	ID code	Version	Hardware object numb	Cal ID/F CVN	Flashw	SCN pr	Service	Serial number
SIS-HR Steuergerät		DSM_MS_RR223	SISHR			206 901 75 06		<input checked="" type="checkbox"/>	<input type="checkbox"/>	<input type="checkbox"/>	20690175060000792623WKN000JB
FHS Steuergerät		DSM_VLM_D223	FHS			206 901 69 07		<input checked="" type="checkbox"/>	<input type="checkbox"/>	<input type="checkbox"/>	206901690700048GUA1231102110287
EPS Steuergerät elektrische Lenkung	VPDPAR	EPSZ23	EPS			206 901 30 12		<input checked="" type="checkbox"/>	<input type="checkbox"/>	<input type="checkbox"/>	20690130120000303409220
ESP Elektronisches Stabilitätsprogramm		ESP223	ESP			254 901 94 00	10FDA500	<input checked="" type="checkbox"/>	<input type="checkbox"/>	<input type="checkbox"/>	2549019400000032149001709351212233...
EZS		EZS223	EZS			206 901 26 12	A6999348	<input checked="" type="checkbox"/>	<input checked="" type="checkbox"/>	<input type="checkbox"/>	400017150323203212012201
TDS Tank-Steuergerät		FSCM_GEN6	TDS			000 901 04 07	C4E57C8D	<input checked="" type="checkbox"/>	<input checked="" type="checkbox"/>	<input checked="" type="checkbox"/>	0009010407000150036916103
GDO Garagentoröffner		GDO213	GDO			223 820 11 00		<input type="checkbox"/>	<input checked="" type="checkbox"/>	<input type="checkbox"/>	
ZGW Zentrales Gateway		GW223	ZGW			206 901 27 12		<input checked="" type="checkbox"/>	<input type="checkbox"/>	<input type="checkbox"/>	
HFA Hands Free Access		HFA223	HFA			223 905 36 09		<input type="checkbox"/>	<input checked="" type="checkbox"/>	<input type="checkbox"/>	2239053609000F534540897
LWR-M Leuchtwellenregulierung Master	VPDPAR	HUI_FL223	LRL			223 901 73 16		<input checked="" type="checkbox"/>	<input checked="" type="checkbox"/>	<input type="checkbox"/>	22390175160009E231125019113
LWR-S Leuchtwellenregulierung Slave	VPDPAR	HUI_FR223	LRR			223 901 75 16		<input checked="" type="checkbox"/>	<input type="checkbox"/>	<input type="checkbox"/>	22390173160009E231117004493
SCN HES (Handererkennungssensor)		HOSWD223	HES			000 901 14 22		<input checked="" type="checkbox"/>	<input checked="" type="checkbox"/>	<input type="checkbox"/>	00090114220001C3050691323000000000...
HU Head Unit	HEAD UNIT	HU7	HU			206 901 36 11		<input checked="" type="checkbox"/>	<input checked="" type="checkbox"/>	<input checked="" type="checkbox"/>	COM609PB010870
HUD Head-Up-Display		HUD206	HUD			254 901 71 00		<input checked="" type="checkbox"/>	<input type="checkbox"/>	<input type="checkbox"/>	25490171000009E2549003001002331730...

Object number	Version	Software ID	Container ID	Container version	ZGS	SCN	Factory SCN
206 902 93 12						206902860902ABRW	206902860902ABRW

Figure 1 – Successful OTA update in VeDoc



Instructions to verify a successful OTA update in Mercedes-me connect App:

Using the Mercedes-me connect App on Android or Apple, the customer can check the status of the OTA update by going to the “Vehicle” icon and selecting “Over-the-Air Vehicle Updates” (Figure 2). A successful OTA update will show as “Installed” (Figure 3).

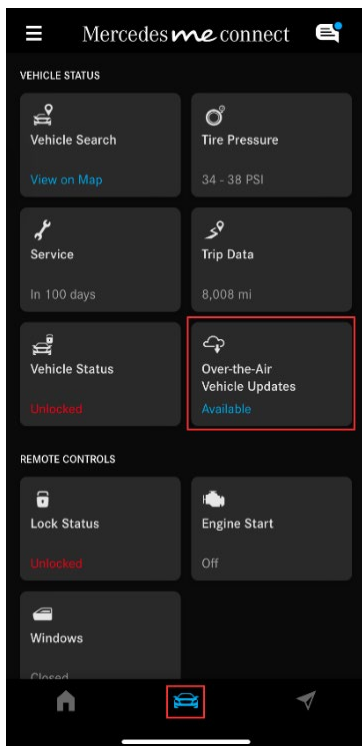

Figure 2 – Over-the-Air Vehicle

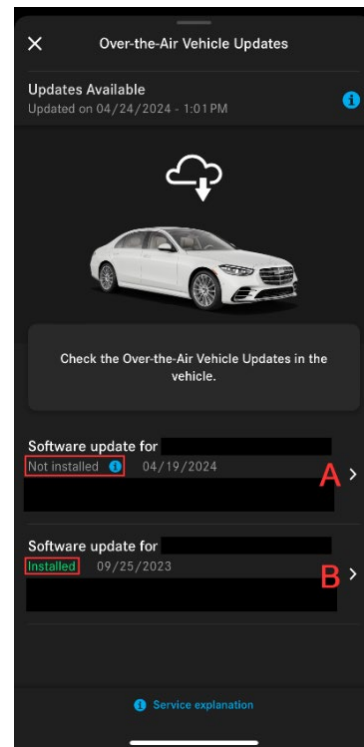

Figure 3 –

- A. Pending OTA Update
- B. Successful OTA Update

