



Technical Bulletin 251

06.2025

Contents

Item	Subject	Model Affected
251.1	Calibration Downloads and Failed Download Recovery	TF250-X, TF450-RC, TF250-E, TF450-E
251.2	Eccentric rear hub bearing seal	Speed Triple 1200 RS, Speed Triple 1200 RR, Speed Triple 1200 RR Breitling

Item: 251.1
Description: Calibration Downloads and Failed Download Recovery
Model Affected: TF250-X, TF450-RC, TF250-E, TF450-E

We would like to advise dealers that from TDT version 2025-07 calibration selection for the above models is now controlled by the Smart Scan VIN Query. Only the ECM calibrations applicable to the model and market variant detected by Smart Scan can be downloaded to motorcycles of the models specified above. A new diagnostic tool workflow to recover failed downloads has been released for the above models. The new workflow is detailed below.

Download Recovery

NOTICE

Triumph Diagnostic Tool features for the above model(s) are only available to approved Off Road motorcycle dealers.

1. If an ECM download fails for any reason, a red cross and the message Failed will be displayed on the affected ECM.

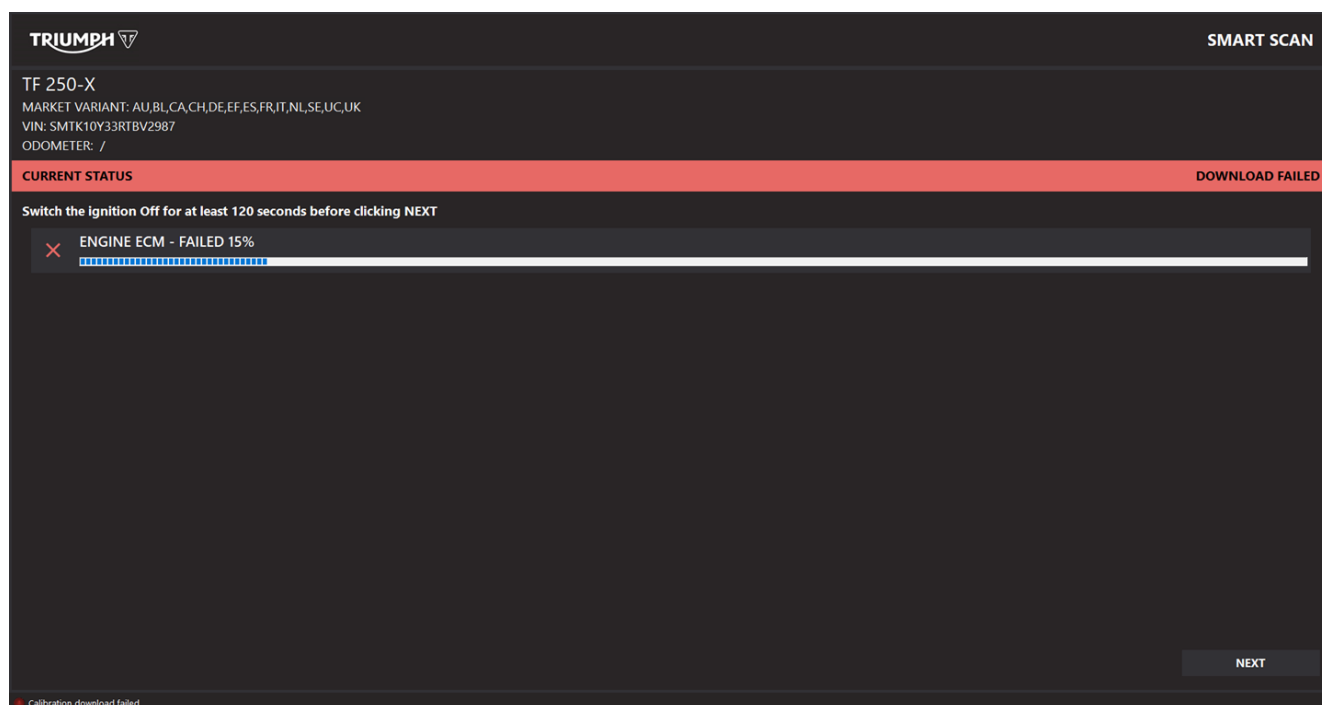

2. Follow the onscreen instructions and turn the motorcycle ignition Off for the required time period. On these models it is necessary to disconnect the Diagnostic Interface Adapter from the motorcycle to turn the ignition Off.
3. Check that the motorcycle battery is in good condition. It is recommended that a suitable battery charger remains connected to the motorcycle for the duration of the ECM download procedure.
4. Reconnect the Diagnostic Interface to the motorcycle to turn the ignition On. Ensure that the Diagnostic Interface is securely connected to the motorcycle before proceeding.

- Click **NEXT**. The tool will perform a rescan and an ECM Recovery Mode screen will be displayed.

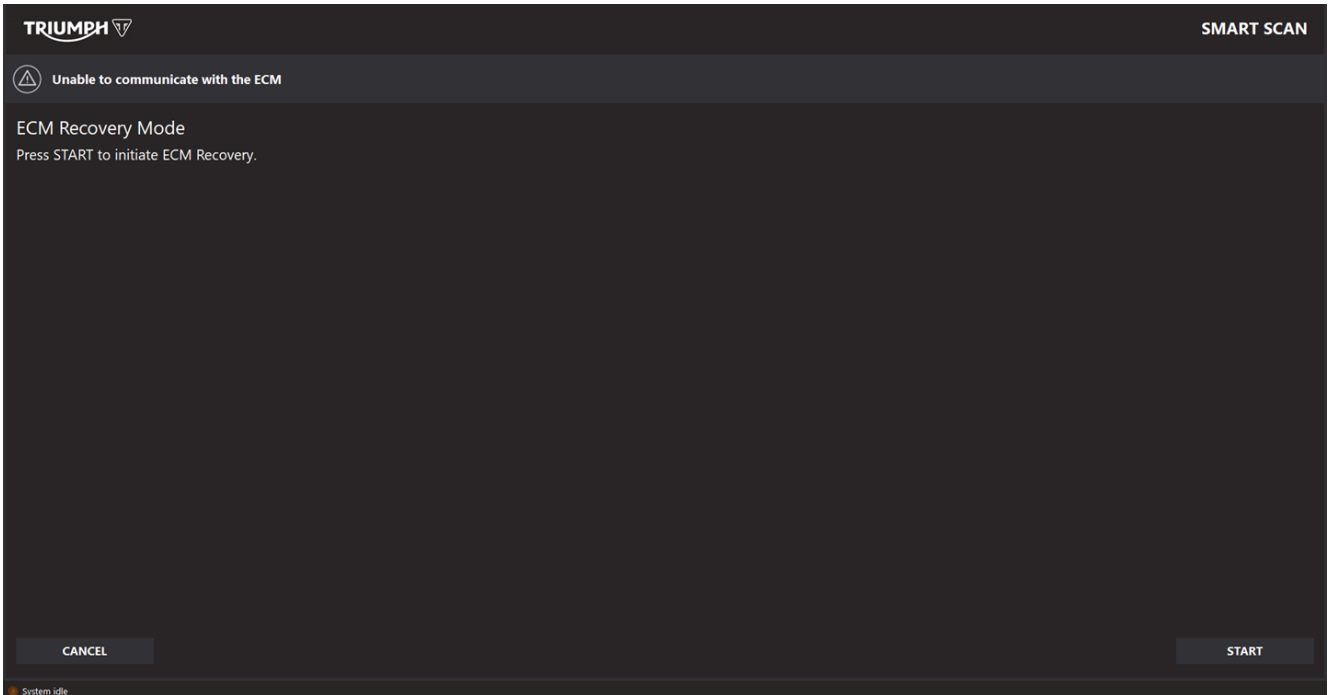

- Click **START** to initiate the ECM Recovery process. An interim download will be performed to recover the ECM and restore basic functionality.
- When the interim download is complete, click **NEXT** to continue. Smart Scan will identify the motorcycle based on the interim calibration and the VIN stored in the ECM. Check that the motorcycle is identified correctly and click **CONFIRM** to continue.

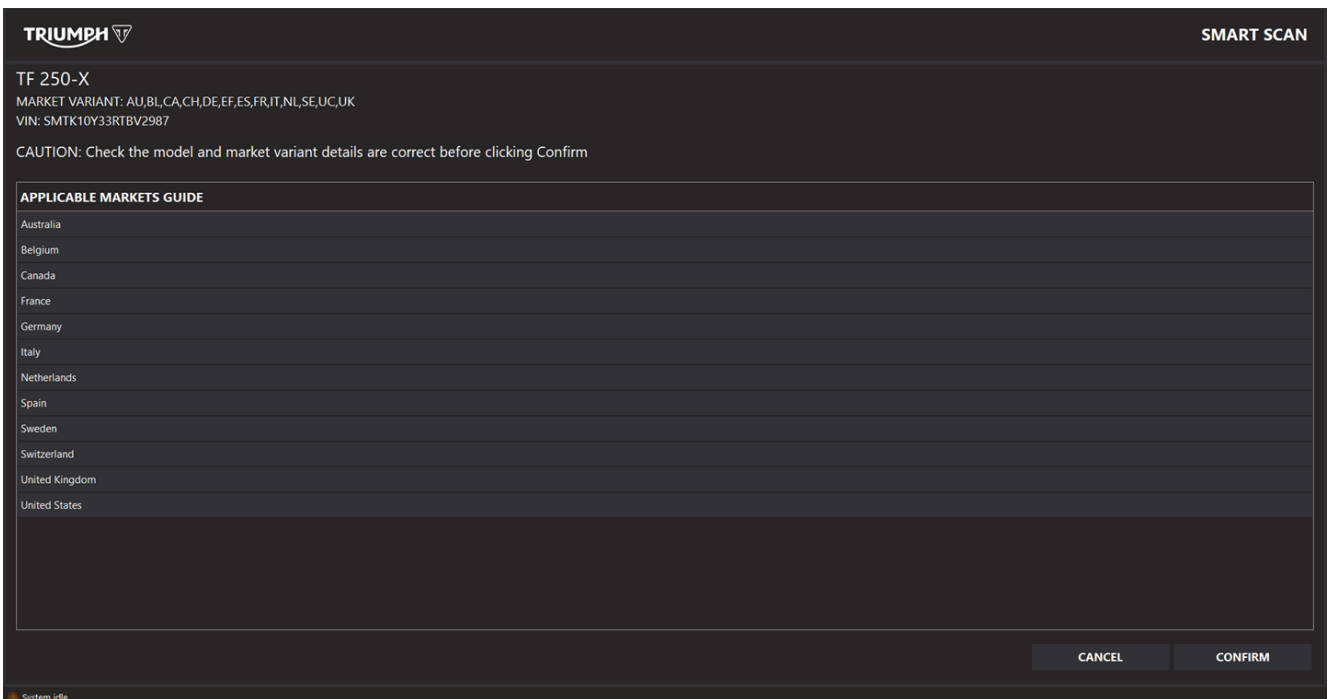

8. Smart Scan will highlight that an update is available for the Engine ECM. Continue with the download process as normal to download the calibration for the detected model.



Item: 251.2

Description: Eccentric rear hub bearing seal

Model Affected: Speed Triple 1200 RS, Speed Triple 1200 RR, Speed Triple 1200 RR Breitling

An eccentric rear hub bearing seal has been introduced for the above models.

The bearing seal is to be installed as part of the 20,000 miles (32,000 km) service interval.

The procedure for installing the bearing seal is described below.

WARNING

Make sure that the motorcycle is stabilised and adequately supported.

Do not support the motorcycle on any ancillary component, the exhaust system or any other non-structural parts of the motorcycle frame.

A correctly supported motorcycle will help prevent it from falling.

Failure to follow the advice above could result in serious injury or death.

NOTICE

Renew locking devices where specified, refer to Fixings.

Before tightening a fixing using a crow foot spanner adapter, refer to Use of Crow Foot Spanner Adapters with Torque Wrenches.

Observe all torque wrench tightening procedures, refer to Tightening procedure.

WARNING

Do not allow a brake component to hang unsupported on the brake hose or line.

Brake hoses or lines that are not supported may become damaged or bent.

Bent or damaged brake hoses or lines lead to reduced braking efficiency.

Failure to follow the advice above may lead to loss of motorcycle control, which could result in serious injury or death.

1. Remove the rear wheel as described in the Service Manual.
2. Remove the cush drive carrier as described in the Service Manual.
3. Remove the rear ABS wheel speed sensor as described in the Service Manual.

-
4. Supporting the rear brake caliper, remove the rear brake caliper fixings and slide the rear brake caliper off the brake disc.

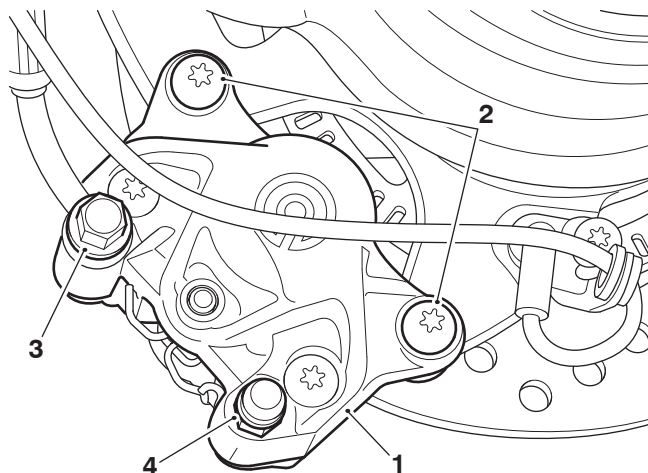

B01445

- 1. **Rear brake caliper**
- 2. **Fixings**
- 3. **Brake hose fixing**
- 4. **Bleed screw**

5. Pull the axle shaft through the eccentric rear hub to the right hand side.

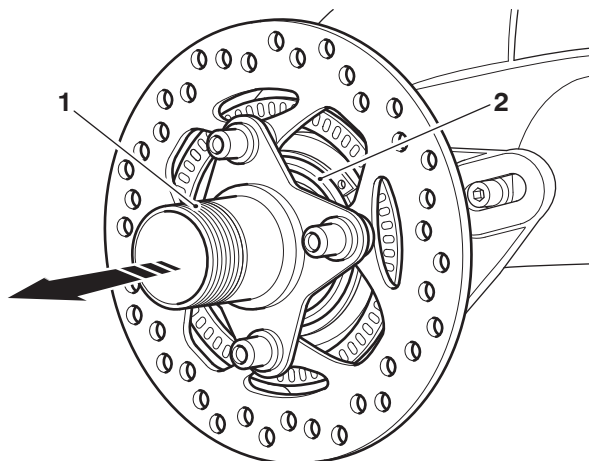

B01450

- 1. **Axle shaft**
- 2. **Eccentric rear hub**

NOTICE

The axle shaft has multiple sharp edges that could cause damage to the bearing seal on installation. When positioning the bearing seal to the axle shaft care must be taken to avoid the bearing seal contacting any sharp edges and damaging the seal.

NOTICE

When the bearing seal is fitted to the axle shaft there should be contact between the bearing seal outer face and the axle shaft.

6. Position the new bearing seal to the axle shaft as shown in the image below.

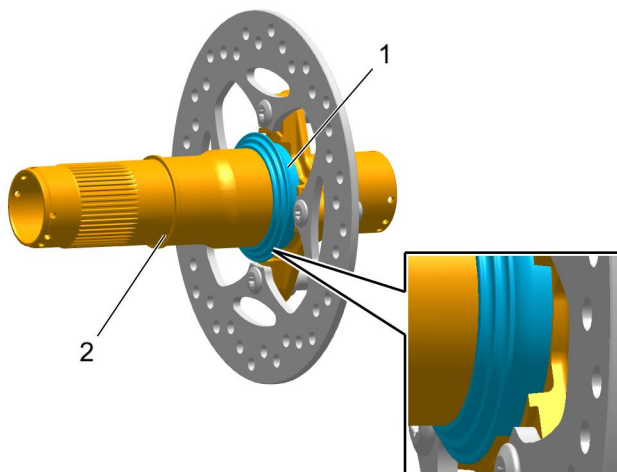

1. **Bearing seal**
2. **Axle shaft**
7. Apply a thin layer of general purpose grease (for example Triumph Performance RG2 (NLGI 2)) to the area shown in the image below.

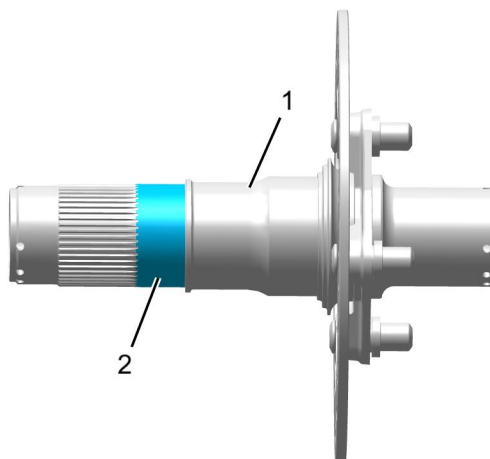

1. **Axle shaft**
2. **Grease area**

-
8. Fit the axle shaft into the eccentric rear hub from the right hand side.

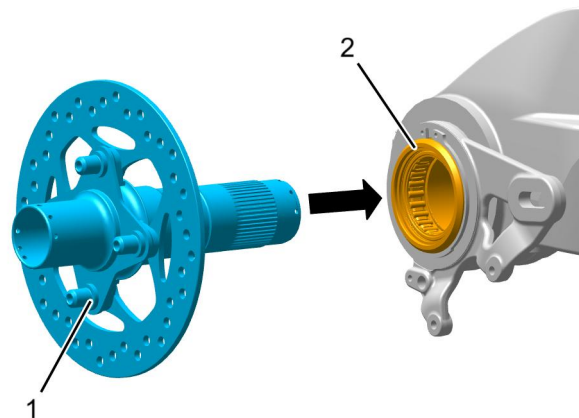

1. Axle shaft
2. Eccentric rear hub

NOTICE

When the axle shaft is fitted to the eccentric rear hub there should be no contact between the eccentric rear hub and the bearing seal inner face.

If there is contact between the eccentric rear hub and the bearing seal inner face the bearing seal is incorrectly seated on the axle shaft.

Return to step 6 to achieve the correct fitment of the bearing seal before proceeding.

9. Visually check that the bearing seal inner face is not in contact with the eccentric rear hub as shown in the image below.

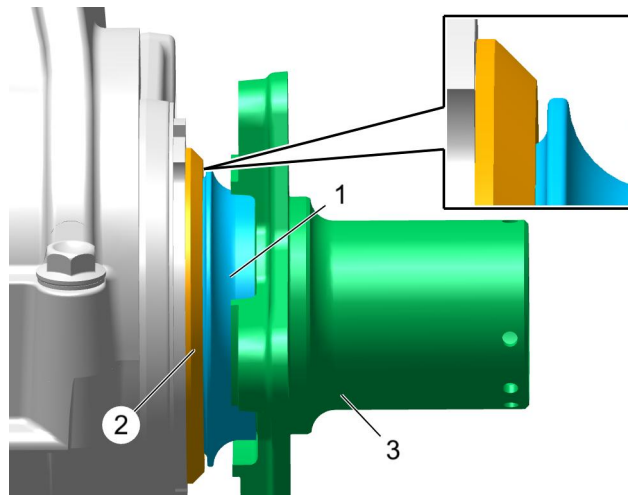

Brake disc removed for clarity

1. Bearing seal
2. Eccentric rear hub
3. Axle shaft

10. Position the rear brake caliper to the caliper carrier and install the fixings. Tighten the fixings to **28 Nm**.

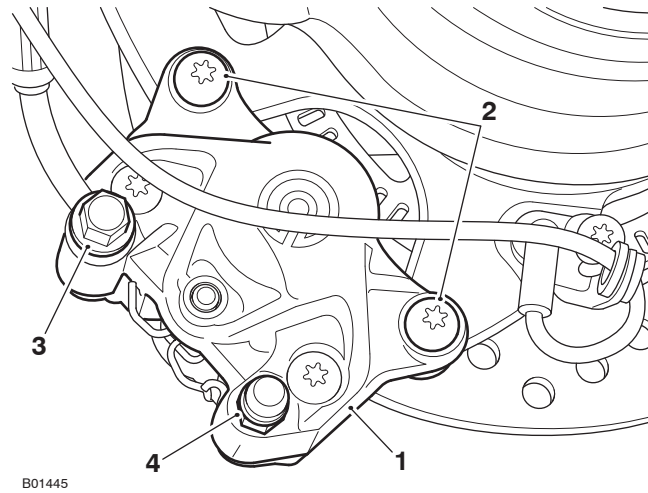

- 1. Rear brake caliper**
- 2. Fixings**
- 3. Brake hose fixing**
- 4. Bleed screw**

- 11. Fit the cush drive carrier as described in the Service Manual.
- 12. Fit the rear ABS wheel speed sensor as described in the Service Manual.
- 13. Fit the rear wheel as described in the Service Manual.