

2025 86 Pre-Delivery Service (PDS)

Service Category General

Section Pre-Delivery Service

Market USA

Toyota Supports
 ASE Certification 

Applicability

YEAR(S)	MODEL(S)	ADDITIONAL INFORMATION
2025	86	

REVISION NOTICE

April 22, 2025 Rev1:

- The Required Tools & Equipment and DCM Activation sections have been updated. Any previous printed versions of this bulletin should be discarded.

Introduction

Pre-Delivery Service (PDS) is a critical step in satisfying our new car customers. Customer feedback indicates the following areas deserve special attention when performing PDS:

- Careful inspection for paint chips/scratches and body dents/dings.
- Proper operation of electrical accessories (including interior light, clock, and radio reset).
- Interior cleanliness.
- Proper function of mechanical systems.

Customer retention and proper maintenance of vehicles are and have always been a major focus for Toyota. To help remind customers that regular service is essential to the proper maintenance of the vehicle, dealers are required to install a service reminder sticker before delivery. By doing this, customers will be reminded to return to your dealership for service. Your current service reminder sticker may be used. (See PDS Check Sheet item 8 of “Final Inspection and Cleaning.”)

This bulletin contains the PDS procedures that apply specifically to 2025 model year 86 vehicles.

Refer to [T-SB-0028-24](#), the universal *Check Sheet* that contains PDS steps that apply to all 2025 model year Toyota vehicles. To properly perform a complete PDS, you must complete all procedures contained in this TSB as well as the universal PDS Check Sheet.

In addition, if the vehicle is stored for over 30 days, refer to [T-SB-0013-25](#), *Long-Term Vehicle Storage Guidelines*.

2025 86 Pre-Delivery Service (PDS)

Table of Contents

- [Warranty Policy](#).....3
- [Warranty Information](#).....3
- [Required Tools & Equipment](#)3
- [DCC Fuse Installation](#)4
- [Front License Plate and Mounting Bracket Installation](#) *5
 - [Drilling Procedure](#)5
 - [Installation Procedure](#)7
- [Front and Rear Emergency Towing Eyelet Removal and Hole Cover Installation](#)9
- [Installation of Rubber Body Plugs](#)12
- [Tire Pressure Warning System \(TPWS\) Initialization](#).....13
- [DCM Activation](#)*13

*If applicable.

2025 86 Pre-Delivery Service (PDS)

Warranty Policy

If the need for additional repairs or adjustment is noted during PDS, the required service should be performed under warranty. Reimbursement will be managed under the warranty policy.

The Warranty Policy and Procedures Manual requires that you maintain the completed Check Sheet in the customer's file. If you cannot produce a completed form for each retailed vehicle upon TMS and/or Region/Distributor audit, the PDS payment amount will be subject to debit.

An additional Repair Order completed in conjunction with normal PDS MUST have time punch/flags for service. If multiple repairs are performed, separate time flags MUST be punched for each repair.

Warranty Information

OP CODE	DESCRIPTION	MODEL	TIME	OPF	T1	T2
001013	Pre-Delivery Service (PDS)	86	1.0	-	-	-

Required Tools & Equipment

REQUIRED EQUIPMENT	SUPPLIER	PART NUMBER	QTY
Techstream ADVi*	ADE	TSADVUNIT	1
Techstream Lite		TSLITEPDLR01	
Techstream Lite (Green Cable)		TSLP2DLR01	

*Essential SST.

NOTE

- Only ONE of the Techstream units listed above is required.
- GTS+ software version 2025.01.005.02 or later is required.
- Additional Techstream units may be ordered by calling Approved Dealer Equipment (ADE) at 1-800-368-6787 or by visiting *TIS – Diagnostics – Tools & Equipment – Techstream Order Portal*.

2025 86 Pre-Delivery Service (PDS)

DCC Fuse Installation

To minimize battery discharge during transportation and storage, the DCC fuse (30A) has been removed at the assembly plant and temporarily stored in the blank space of the relay block in the engine compartment. During PDS, reinstall the DCC fuse (30A) to its original location and confirm ALL related Diagnostic Trouble Codes (DTCs) are cleared.

Remove the DCC fuse (30A) from the blank space of the relay block in the engine compartment and install the DCC fuse (30A) in the relay block as shown.

NOTE

Park the vehicle on level ground before performing this procedure.

Figure 1.

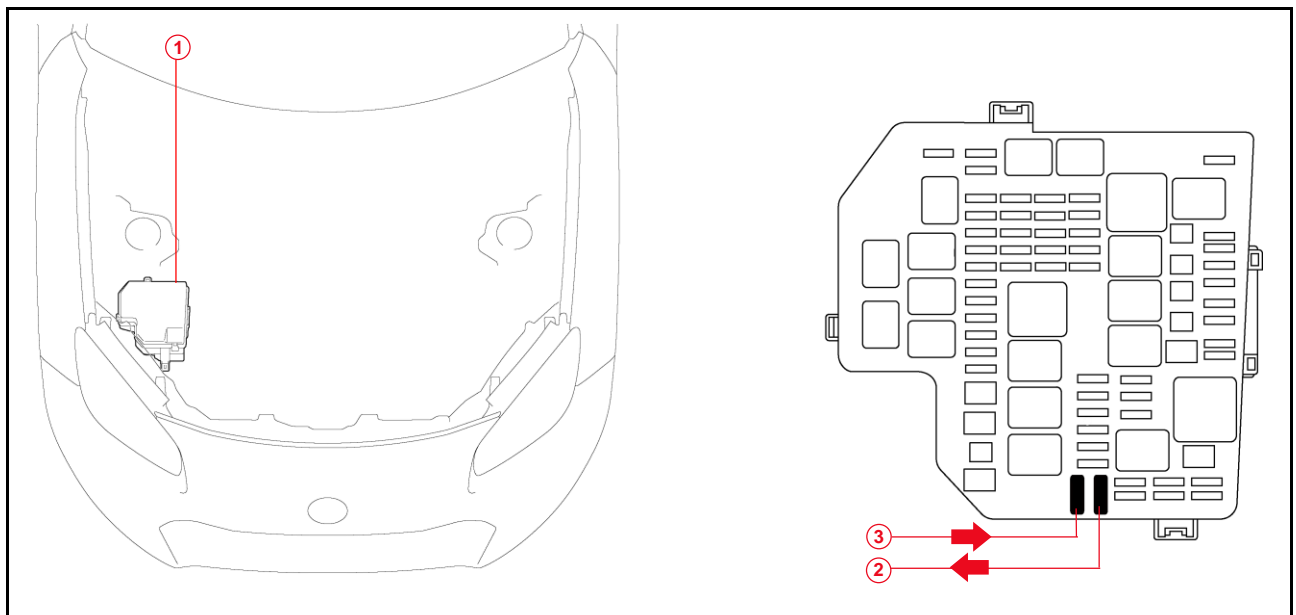

1	Relay Block
2	Remove the DCC Fuse (30A)
3	Install the DCC Fuse (30A)

NOTE

- With the DCC fuse (30A) removed, if ANY DTCs are detected when the ignition is turned on during transportation, use Global Techstream Software (GTS+) to clear ALL DTCs AFTER ensuring that there are NO malfunctions.
- While the vehicle is stored at the dealership, disconnect the negative (-) battery terminal to prevent battery discharge. Refer to [T-SB-0021-24](#), *Battery Inspection and Maintenance During PDS*, for battery maintenance information.

2025 86 Pre-Delivery Service (PDS)

Front License Plate and Mounting Bracket Installation

The front license plate mounting bracket set (front license plate mounting bracket, two bolts “1”, two bolts “2”, two J-nuts and two well nuts) are loaded in the luggage compartment at the assembly plant. Follow this procedure to install the front license plate bracket and front license plate in states where it is required by law.

Drilling Procedure

1. Set the center of the front license plate mounting bracket to the center of the intake cover, as shown in Figure 2.
2. Using the front license plate mounting bracket as a guide, make marks “A” and “B” on the front bumper cover as shown in Figure 2.

Figure 2.

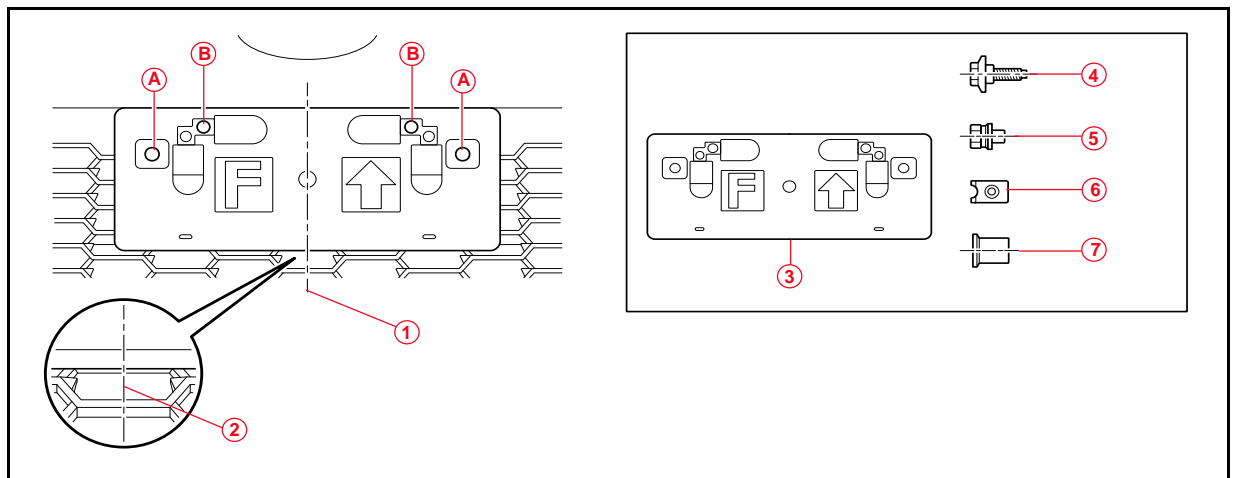

A	Mark A
B	Mark B
1	Front License Plate Mounting Bracket Center
2	Intake Cover Center
3	Front License Plate Mounting Bracket

4	Bolt 1
5	Bolt 2
6	J-nut
7	Well Nut

2025 86 Pre-Delivery Service (PDS)

Front License Plate and Mounting Bracket Installation (continued)

Drilling Procedure (continued)

- Remove the license plate mounting bracket and drill a hole with a diameter of 13 mm (0.51 in.) at each of the hole "A" marks in the front bumper cover.

NOTE

Holes "A" are used to install the well nuts and the front license plate mounting bracket to the front bumper cover.

- Drill a hole with 23 mm (0.91 in.) in diameter at each of the hole "B" marks in the front bumper cover.

NOTE

Holes "B" are used to prevent contact between the front bumper cover and bolts "2".

Figure 3.

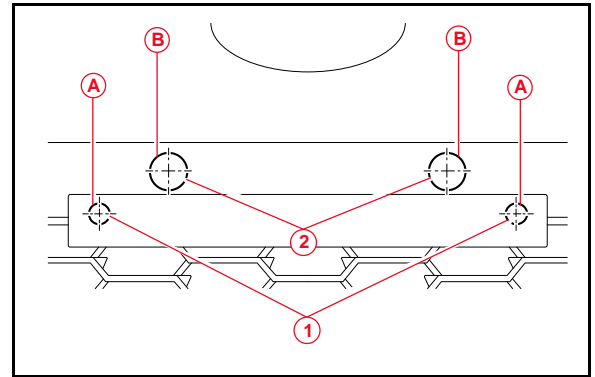

A	Hole A
B	Hole B
1	13 mm (0.51 in) in Diameter
2	23 mm (0.91 in) in Diameter

2025 86 Pre-Delivery Service (PDS)

Front License Plate and Mounting Bracket Installation (continued)

Installation Procedure

1. Install the two J-nuts to the front license plate mounting bracket as shown in Figure 4.

Figure 4.

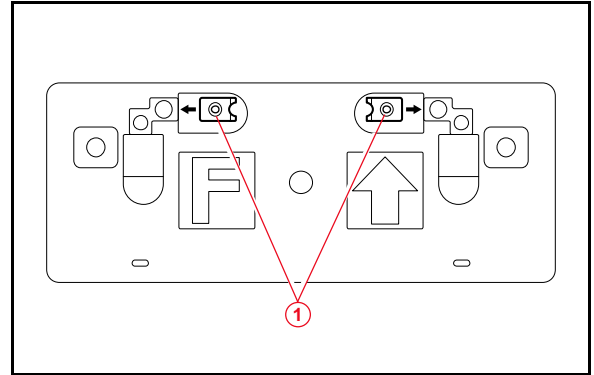

1	J-nuts
----------	---------------

2. Install the two well nuts to holes "A" in the front bumper cover, and then fit the two hooks at the bottom of the front license plate mounting bracket on the intake cover.

Figure 5.

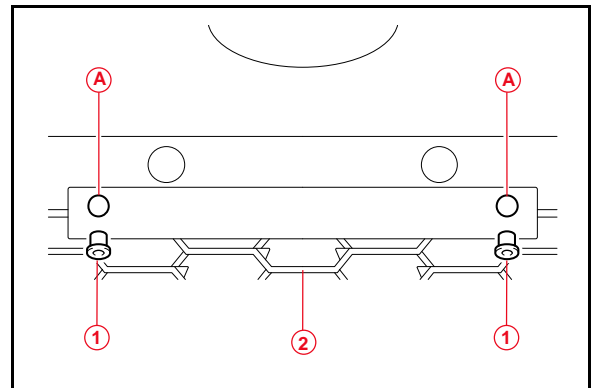

A	Hole A
1	Well Nuts
2	Intake Cover

2025 86 Pre-Delivery Service (PDS)

Front License Plate and Mounting Bracket Installation (continued)

Installation Procedure (continued)

- Align holes "A" in the front license plate mounting bracket with the well nuts, and then install the front license plate mounting bracket with the two bolts "1".

Torque: 1.1 N*m (11 kgf*cm, 10 in*lbf)

NOTICE

Do NOT overtighten the bolts.

- Install the front license plate to the front license plate mounting bracket using two bolts "2", as shown in Figure 6.

Figure 6.

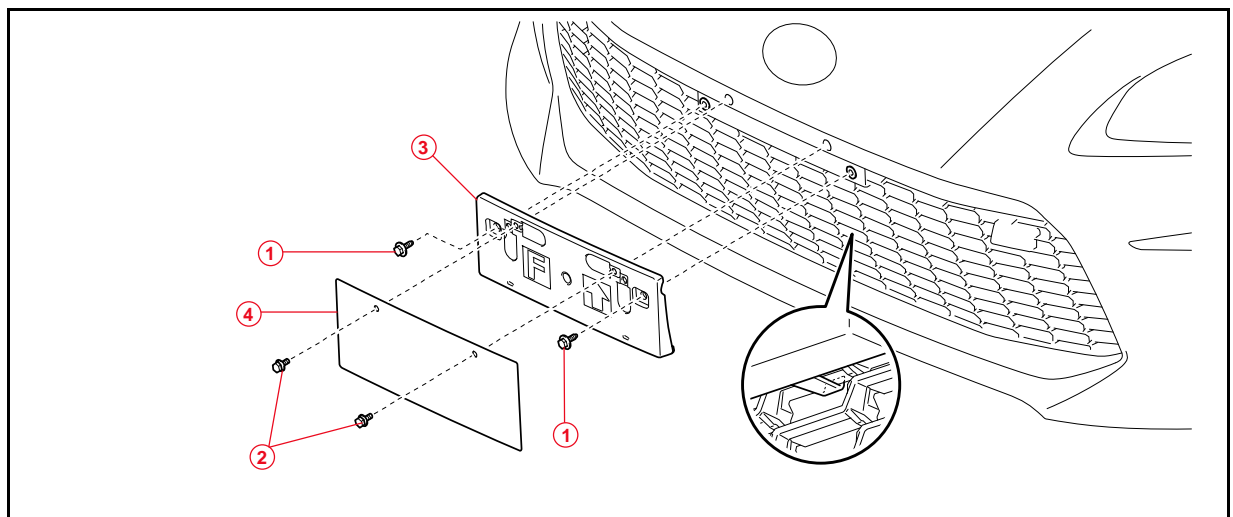

1	Bolt 1
2	Bolt 2

3	Front License Plate Mounting Bracket
4	Front License Plate

2025 86 Pre-Delivery Service (PDS)

Front and Rear Emergency Towing Eyelet Removal and Hole Cover Installation

1. Remove the front and rear emergency towing eyelets from the front and rear bumpers by turning them counterclockwise.

NOTE

If it is difficult to loosen the front emergency towing eyelet, use a steel bar.

Figure 7.

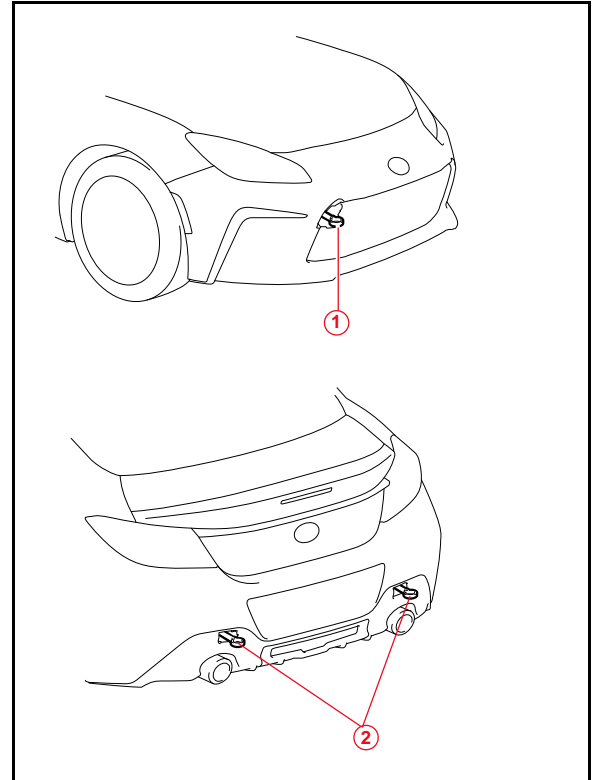

1	Front Emergency Towing Eyelet
2	Rear Emergency Towing Eyelets

2025 86 Pre-Delivery Service (PDS)

Front and Rear Emergency Towing Eyelet Removal and Hole Cover Installation (continued)

- Place one of the removed rear emergency towing eyelets into the luggage tray in the luggage compartment.

NOTE

Dispose of the other removed emergency towing eyelets.

Figure 8.

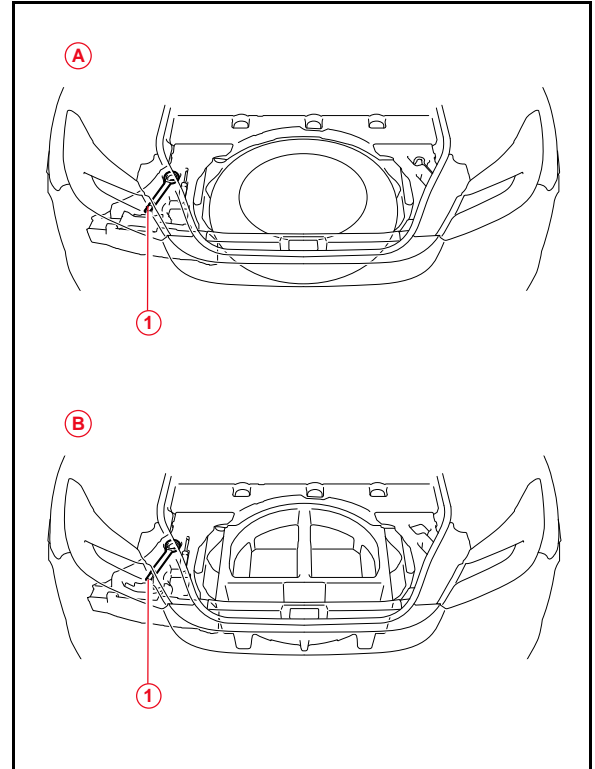

1	Emergency Towing Eyelet
A	Type A
B	Type B

2025 86 Pre-Delivery Service (PDS)

Front and Rear Emergency Towing Eyelet Removal and Hole Cover Installation (continued)

3. Install the front and rear emergency towing eyelet hole covers, which are stored in the glove box, onto the front and rear bumpers.
 - A. Insert the arrow-shaped part "A" of the front emergency towing eyelet hole cover (lower side) into the eyelet hole "B" as shown. Seat the tabs to secure the hole cover to the front bumper.
 - B. Insert the arrow-shaped part "C" of the front emergency towing eyelet hole cover (upper side) into the eyelet hole "D" as shown. Seat the tabs to secure the hole cover to the front bumper.
 - C. Insert the arrow-shaped part "A" of the rear emergency towing eyelet hole cover into the eyelet hole "B" as shown. Seat the tabs to secure hole cover to the rear bumper.

NOTE

Make sure the front emergency towing eyelet cover is installed in the front, and the rear emergency towing eyelet cover is installed in the rear.

Figure 9.

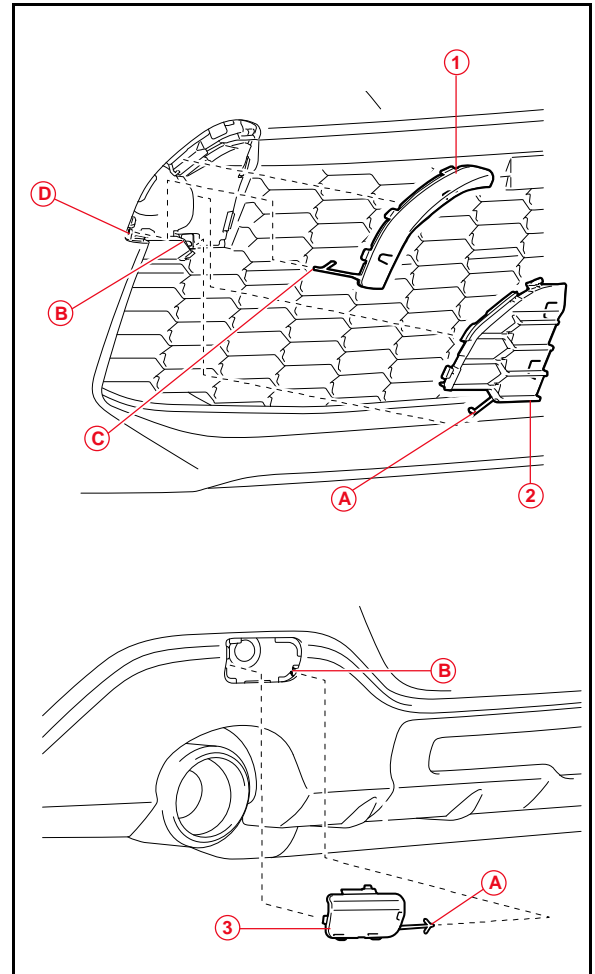

1	Front Emergency Towing Eyelet Hole Cover (Upper Side)
2	Front Emergency Towing Eyelet Hole Cover (Lower Side)
3	Rear Emergency Towing Eyelet Hole Cover
A	Arrow-shaped Part
B	Eyelet Hole
C	Arrow-shaped Part
D	Eyelet Hole

2025 86 Pre-Delivery Service (PDS)

Installation of Rubber Body Plugs

1. Confirm the number of plugs in the glove box. If two plugs are present, perform substep 2A ONLY. If four plugs are present, perform substep 2A AND substep 2B.
2. Install the plugs according to the instructions below by confirming the number of plugs in the glove box.
 - A. Install two plugs in the rear side member hole or rocker inner hole as shown.
 - B. Install two plugs in the torque box hole or rocker inner hole as shown.

Figure 10.

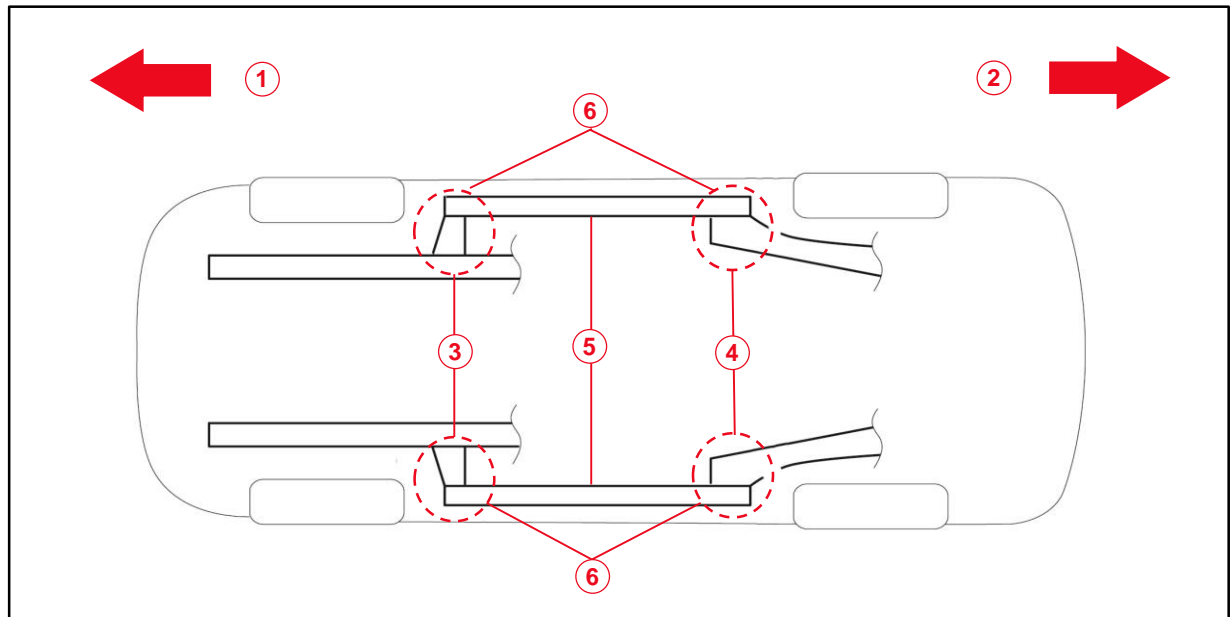

1	Front Side
2	Rear Side
3	Torque Box Hole or Rocker Inner Hole

4	Rear Side Member Hole or Rocker Inner Hole
5	Rocker Inner
6	Install Plug Here (if Applicable)

NOTICE

- The installation of these plugs is required to prevent rust.
- These plugs are stored in the glove box.
- The number of plugs may vary according to production locations in the same vehicle model.

2025 86 Pre-Delivery Service (PDS)

Tire Pressure Warning System (TPWS) Initialization

Refer to the applicable Owner’s Manual for the TPWS initialization procedure.

- [2025](#) 86:
Section 6-3 Maintenance and Care – Do-It-Yourself Maintenance – Tires – Initializing the Tire Pressure Warning System

NOTE

- To adjust the tire pressure correctly when the outside temperature is significantly colder than shop temperature, perform a Health Check using GTS+ and select the compensation tire pressure checkbox. Compensation pressures will display on the Health Check results screen. Adjust the tire pressure when the tires are cold.
- The spare tire does NOT have a TPWS sensor.

DCM Activation

The DCM (Data Communication Module) activation for 2025 model year 86 vehicles during shipping is different than for other Toyota model vehicles. A lit green LED may NOT be used to indicate the system’s operation upon arrival at the dealership, and this function MUST be confirmed.

1. Press and hold the “i” button for 30 – 60 seconds.
2. If the DCM has NOT previously been activated, the following will occur.
 - The LED light indicators will begin blinking red and green.
 - The LED light indicators will turn OFF.
 - The LED light indicators will turn green ONLY if successfully activated.

NOTE

If there are ANY DTCs present and/or other conditions present, refer to the applicable model and model year Repair Manual.

Figure 11.

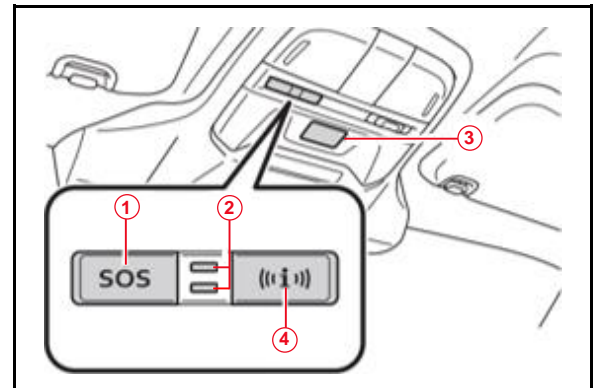

1	“SOS” Button
2	LED Light Indicators
3	Microphone
4	“i” Button

2025 86 Pre-Delivery Service (PDS)

DCM Activation (continued)

3. If the DCM has previously been activated, a visual indicator on the head unit will display “Roadside Assistance ...Connecting” along with a voice prompt, “Connecting to safety connect roadside assistance.”

NOTE

- If this occurs, press the “i” button again or the End Call icon on the head unit.
- No further action is necessary.