

GENERAL MOTORS  
DCS7210  
URGENT - DISTRIBUTE IMMEDIATELY

Date: May 2, 2025

Subject: REVISION: N242468490-01 - Service Update  
Missing Chassis Harness Plugs  
Revised Parts Table

Models: 2024 – 2025 Chevrolet Blazer EV

This bulletin is being revised to update the Parts table. Please discard all previous copies of N242468490.

END OF MESSAGE

# Service Update

## N242468490 Missing Chassis Harness Plugs



**Release Date:** May 2025

**Revision:** 01

**Revision Description:** This bulletin has been revised to update the Parts table. Please discard all previous copies of bulletin N242468490.

**Attention:** This service update includes vehicles in dealer inventory and customer vehicles that return to the dealership for any reason. This bulletin will expire at the end of the involved vehicle's New Vehicle Limited Warranty period.

For EV Involved Vehicles: The repairs outlined in this bulletin must only be completed at an authorized EV dealer and repairs must be performed by a technician who has successfully completed the applicable technical training required to perform this repair.

Make	Model	Model Year	
		From	To
Chevrolet	Blazer EV	2024	2025

Involved vehicles are marked "Open" on the Investigate Vehicle History screen in GM Global Warranty Management system. This site should always be checked to confirm vehicle involvement prior to beginning any required inspections and/or repairs.

<b>Condition</b>	Certain vehicles listed above may have missing cavity plugs from the rear chassis harness electrical connector.
<b>Correction</b>	Dealers are to inspect the rear chassis harness and replace missing harness plugs as necessary.

### Parts

Quantity	Part Name	Part No.
As Req'd	Terminated Lead (55 Way - Use in place of BLUE cavity plug)	84634921
As Req'd	Terminated Lead (55 Way - Use in place of RED cavity plug)	19371217
As Req'd	Terminated Lead (36 Way - Use in place of cavity plug)	19301750
As Req'd	Terminated Lead – All Others	*

\* Note: Use the VIN and the GM Electronic Parts Catalog (EPC) to determine which terminals to order.

**Reminder:** Parts may be removed from SPRINT and Retail Inventory Management (RIM) and be non-returnable. Dealers should review the affected parts to confirm RIM managed status. Parts may have quantity limiters in effect. **Due to the limited initial parts availability, dealers are encouraged not to order these parts for use as shelf stock.** Additionally, **some parts may ship as a pack of 5 so an order of 1 part will ship 5 pieces.** It is estimated that only a small percentage of involved vehicles will require terminal replacement, dealers are instructed to order parts accordingly.

### Warranty Information

Labor Operation	Description	Labor Time	Trans. Type	Net Item
9107859	Inspect Only – No Further Action Required	0.6	ZFAT	N/A
9107860	Reinstall or Replace Connector Cavity Plugs Add: To Replace Corroded Terminals	0.8 ST		

### Service Procedure

For Vehicles **WITHOUT X0D AND X0E**

**Important:** Failure to disconnect the 12V battery before proceeding can lead to blown fuses or cause additional vehicle issues.

**Warning:** Always ensure the Battery Maintenance Mode is inactive before disconnecting the low voltage 12 volt battery (or batteries). This mode can be active with the ignition off, regardless of whether the vehicle charging cord is plugged in or not. When this mode is active, the on-board high voltage battery charger(s) will energize the 12 volt battery cables and charge the 12 volt battery (or batteries). Disconnecting any battery cables while this mode is active may result in an electrical shock or a burn from hot battery cable leads.

1. Disconnect the low voltage battery. Refer to *Battery Negative Cable Disconnection and Connection* in SI.
2. Lift the vehicle. Refer to *Lifting and Jacking the Vehicle* in SI.

## Service Update

### N242468490 Missing Chassis Harness Plugs



3. Remove the Underbody Rear Air Rear Deflector. Refer to *Underbody Rear Air Rear Deflector Replacement – Rear* in SI.

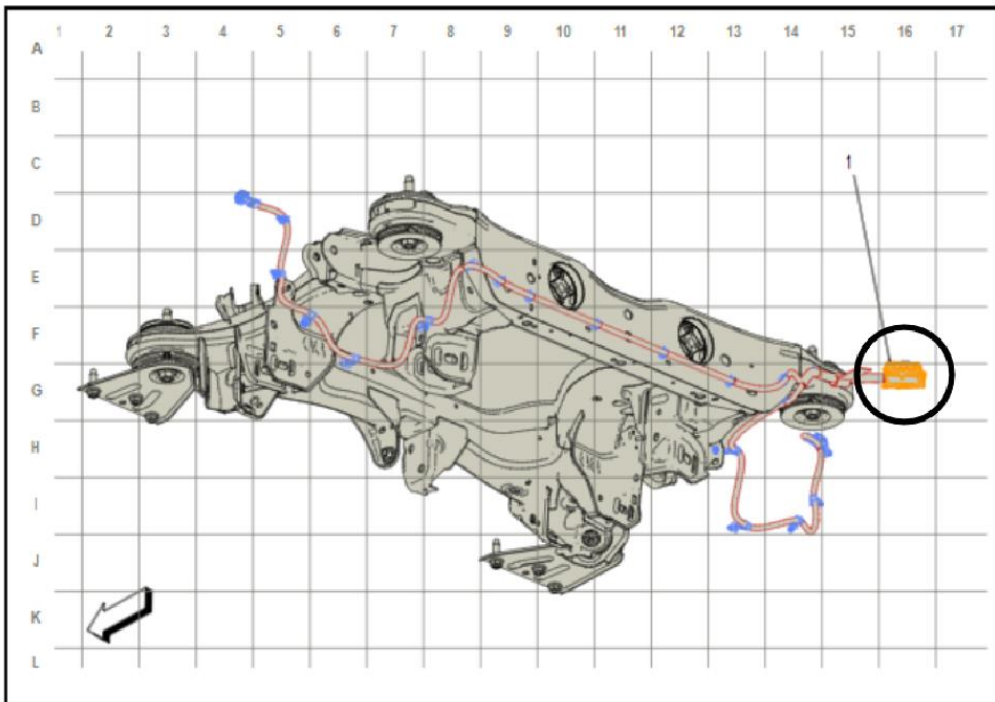

(1) X606 Body Wiring Harness to Chassis Wiring Harness

6778757

4. Locate and disconnect the X606 Body Wiring Harness to Chassis Harness Connector.
5. Verify there is no corrosion within the connector.
  - 5.1 If corrosion is found in either connector, replace the corroded terminals and thoroughly clean the connector. Refer to *X606 Body Wiring Harness to Chassis Wiring Harness* in SI for terminal location and proper tools. Refer to *Wire and Connector Repair* in SI for further instruction.
  - 5.2 If no corrosion is found: remove the plastic cover on the backside of the connector (if applicable) and proceed to the next step.

## Service Update

### N242468490 Missing Chassis Harness Plugs

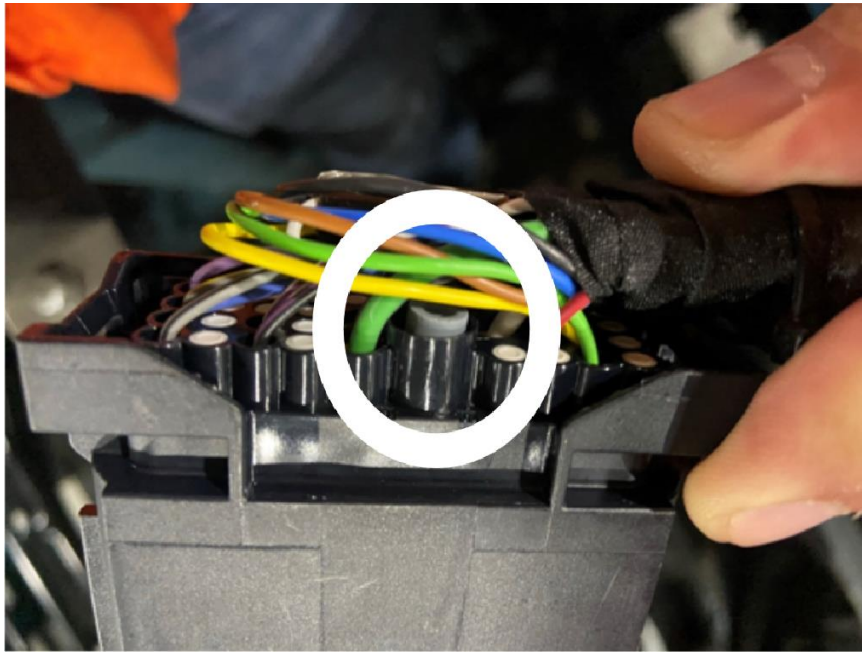

6779255

6. Inspect the large cavity plugs located within the X606 Body Wiring Harness to Chassis Harness Connector on the chassis harness.
  - 6.1 If the cavity plugs **PROTRUDE** from the connector body as shown in the above image, use a small round or flat bladed tool to press the cavity plug down into the cavity. Ensure the cavity plug is even on all sides and flush with the backside of the connector body.



6781676

- 6.2 If the cavity plugs are **MISSING** from the connector body, install the appropriate terminated lead into the empty cavity. Attach the splice sleeve included with the terminated lead, then apply heat to the splice sleeve to seal the blunt cut wire end. If a proper seal cannot be achieved with the included splice sleeve, heat shrink tubing may be used instead. Tape the newly added wire end to the existing harness. Refer to *Wire-to-Wire Repair* in SI for splice sleeve instructions.
  - 6.3 If the cavity plugs are **FLUSH** within the connector body, proceed to the next step.
7. Return the harness to its original location.
8. Reinstall the Underbody Rear Air Rear Deflector. Refer to *Underbody Rear Air Rear Deflector Replacement – Rear* in SI.
9. Lower the vehicle.

# Service Update

## N242468490 Missing Chassis Harness Plugs



10. Connect the low voltage battery. Refer to *Battery Negative Disconnection and Connection* in SI.
11. Using a scan tool, clear DTCs.

### FOR VEHICLES WITH RPO X0D AND X0E

**Important:** Failure to disconnect the 12V battery before proceeding can lead to blown fuses or cause additional vehicle issues.

**Warning:** Always ensure the Battery Maintenance Mode is inactive before disconnecting the low voltage 12 volt battery (or batteries). This mode can be active with the ignition off, regardless of whether the vehicle charging cord is plugged in or not. When this mode is active, the on-board high voltage battery charger(s) will energize the 12 volt battery cables and charge the 12 volt battery (or batteries). Disconnecting any battery cables while this mode is active may result in an electrical shock or a burn from hot battery cable leads.

1. Disconnect the low voltage battery. Refer to *Battery Negative Cable Disconnection and Connection* in SI.
2. Lift the vehicle. Refer to *Lifting and Jacking the Vehicle* in SI.
3. Remove the Underbody Rear Air Rear Deflector – Middle. Refer to *Underbody Rear Air Rear Deflector Replacement – Middle* in SI.

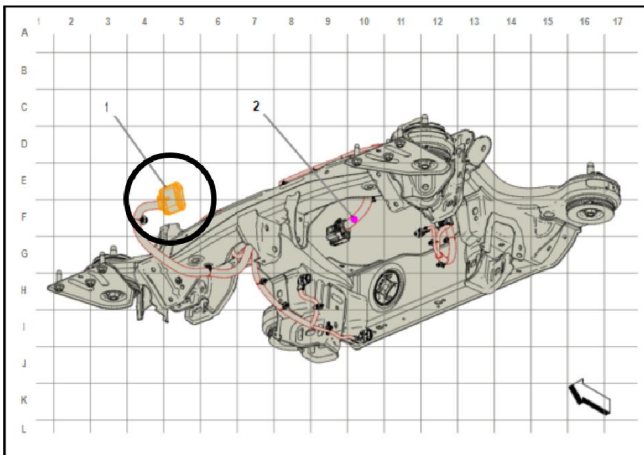

- (1) X610 Body Wiring Harness to Chassis Rear Wiring Harness (X0D / X0E)
- (2) J491 Chassis Rear Wiring Harness (X0D / X0E)

6780028

4. Locate and inspect X610 Body Wiring Harness to Chassis Rear Wiring Harness. Verify there is no corrosion within the connector.
  - 4.1 If corrosion is found at either connector, replace the corroded terminals and thoroughly clean the connector. Refer to *X610 Body Wiring Harness to Chassis Wiring Harness* in SI for terminal location and proper tools. Refer to *Wire and Connector Repair* in SI for further instruction.
  - 4.2 If no corrosion is found, clean and dry the connector and proceed to the next step.

## Service Update

### N242468490 Missing Chassis Harness Plugs

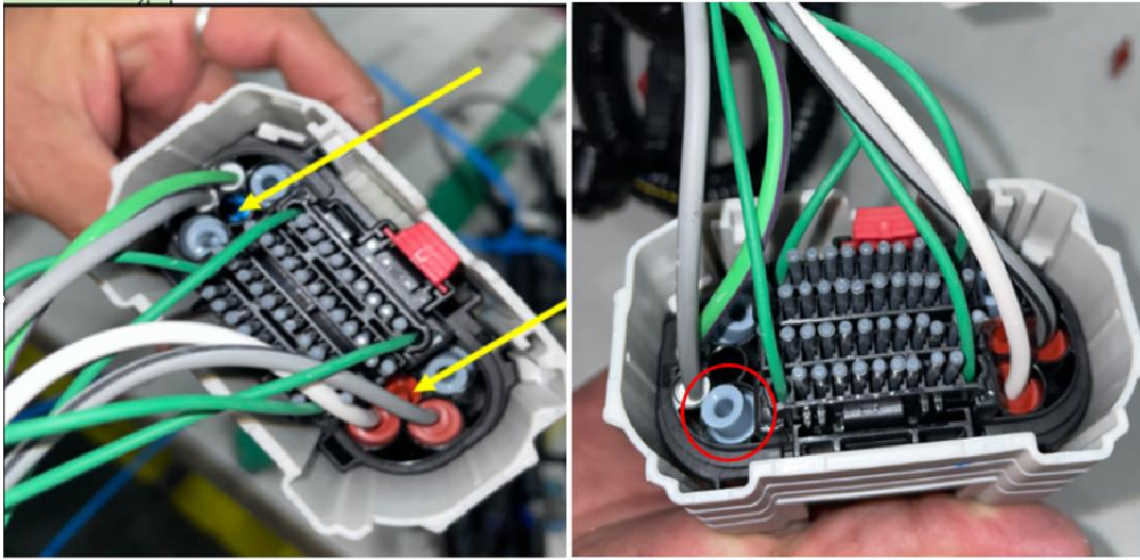

6781647

5. Inspect ALL blue and red cavity plugs to ensure they are seated flush and centered within the connector body.

5.1 If any of the cavity plugs **PROTRUDE** as indicated in the image above, use a small round or flat bladed tool to insert them correctly into the connector. Ensure the cavity plug seats flush and centered within the connector.



6781676

5.2 If the cavity plugs are **MISSING** from the connector body, install the appropriate terminated lead into the empty cavity. Attach the splice sleeve included with the terminated lead, then apply heat to the splice sleeve to seal the blunt cut wire end. If a proper seal cannot be achieved with the included splice sleeve, heat shrink tubing may be used instead. Tape the newly added wire end to the existing harness. Refer to *Wire-to-Wire Repair* in SI for splice sleeve instructions.

5.3 If all of the cavity plugs are **FLUSH** within the connector body, proceed to the next step.

6. Return the harness to its original location.

7. Reinstall the Underbody Rear Air Rear Deflector - Middle. Refer to *Underbody Rear Air Rear Deflector Replacement – Middle* in SI.

8. Lower the vehicle and connect the low voltage battery. Refer to *Battery Negative Disconnection and Connection* in SI.

9. Using a scan tool, clear DTCs.

## Service Update

### N242468490 Missing Chassis Harness Plugs



#### Dealer Responsibility

Whenever a vehicle subject to this service update enters your vehicle inventory or is in your facility for service in the future, and the vehicle is still covered under the New Vehicle Limited Warranty, you must take the steps necessary to be sure the service update correction has been made before selling or releasing the vehicle.

All new, used, GM Certified Pre-Owned (CPO), courtesy transportation vehicles, dealer shuttle vehicles, CarBravo, etc. in dealers' possession and subject to this field action must be held and inspected/repared per the service procedure of this bulletin before customers take possession of these vehicles. Involved vehicles must be held and not delivered to customers, dealer-traded, released to auction, used for demonstration, or any other purpose.

All GM Certified Pre-Owned (CPO) vehicles currently in the dealers' inventory within the SHIFT Digital system will be de-certified and must be held and remedied per the service procedure in this bulletin. Upon submitting an accepted/paid warranty transaction in the Global Warranty Management (GWM) system, the vehicle can be re-certified for sale within the SHIFT Digital system, or once again be used in the Courtesy Transportation Program.

#### Dealer Reports – For USA & Export

The Inventory tab of the Open Vehicle Report will contain Service Update Bulletin VINs that apply to this field action. This information is intended to assist dealers with the **PROMPT COMPLETION** of these vehicles. The Customer In-Service tab will not contain Service Update Bulletin VIN data because the intent of a Service Update Bulletin is to not inconvenience a customer with a special trip for service. Service Update Bulletins are to be completed when the customer is in for a regularly scheduled visit.

