

LEVELING AND STABILIZATION

Purpose

This document outlines the procedure for replacing the LED light card on a Titan Leveling Systems™ jack.

Safety

⚠ WARNING

Always support the trailer per the manufacturer's recommendations while working underneath it. Failure to do so may result in serious personal injury or death. NEVER use the leveling system to support the trailer while doing any work on the system or on the trailer itself.

⚠ CAUTION

Always wear eye protection when performing service, maintenance or installation procedures. Other safety equipment to consider would be hearing protection, gloves and possibly a full face shield, depending on the nature of the task.

Resources Required

- Philips screwdriver

Procedure

Light Removal

1. Remove the three Philips screws on the bottom of the jack cylinder assembly (Fig. 1A).
2. Loosen the two screws at the top of the jack cylinder cover (Fig. 3A).
3. Rotate the cover so that it is clear of the bottom of the jack cylinder (Fig. 2).
4. Disconnect the wiring harness located on the back side of the jack (Fig. 3B).
5. Remove the LED card (Fig. 4).

Fig. 1

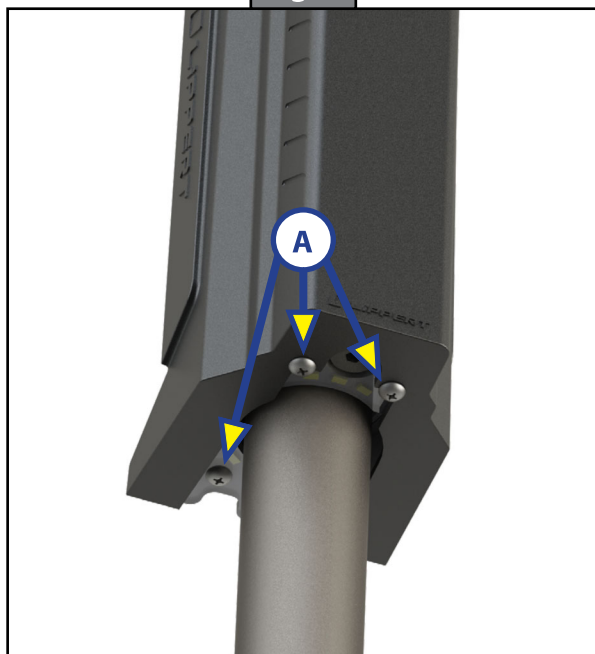

Fig. 2

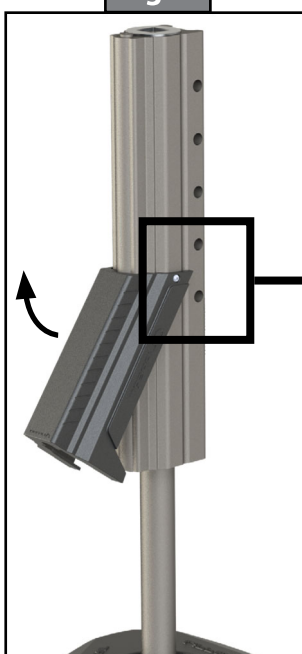
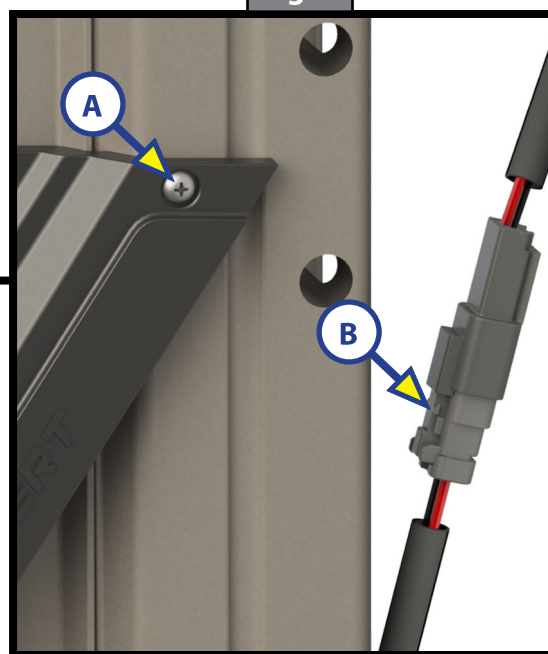

Fig. 3



LEVELING AND STABILIZATION

Light Installation

1. Position the new LED card on the jack body and secure with one screw on the rear side of the jack (Fig. 5).
2. Rotate the cover to its closed position and secure with the two remaining Philips screws (Fig. 6).
3. Connect the new LED card to the jack light harness (Fig. 3).
4. Tighten the two screws at the top of the jack cylinder cover (Fig. 3A).

Fig. 4

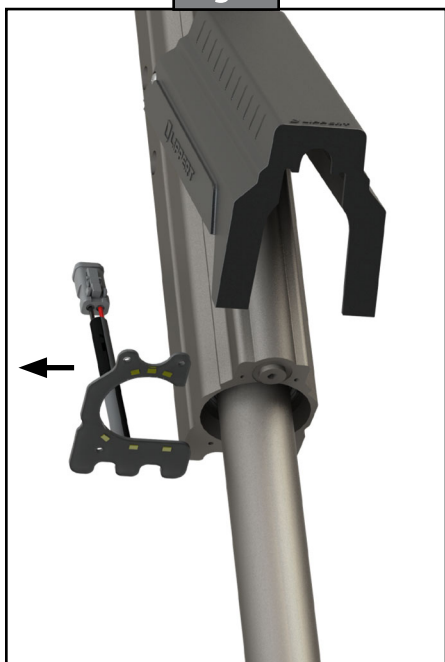

Fig. 5



Fig. 6

