

Charging Limit Setting Defaults to Full After Every Key Cycle

Service Category Engine/Hybrid System

Section Hybrid/Battery Control System

Market USA

Toyota Supports
ASE Certification 

Applicability

YEAR(S)	MODEL(S)	ADDITIONAL INFORMATION
2024	RZ300E, RZ450E	VDS(s): AAAAB, ABABB

Introduction

Some 2024 model year RZ 300e and RZ 450e vehicles may exhibit a condition where the charging limit setting defaults to full after every key cycle, removing the upper limit set by the customer. The electric converter unit assembly software logic has been modified to address this condition. Follow the Repair Procedure in this bulletin to address this condition.

Production Change Information

This bulletin applies to vehicles produced **BEFORE** the Production Change Effective VINs shown below.

MODEL	PLANT	DRIVETRAIN	PRODUCTION CHANGE EFFECTIVE VIN
RZ 300e	Motomachi	2WD	JTJABABB#RA006004
RZ 450e		AWD	JTJAAAAB#RA026775

Warranty Information

OP CODE	DESCRIPTION	TIME	OFP	T1	T2
EL2501	Reprogram the Electric Converter Unit Assy	0.7	G97A0-4####*	87	74

*Warranty claim MUST be submitted with the correct 10-digit OFP. Choose the correct OFP for the vehicle being repaired by searching for the parts in the Electronic Parts Catalog using the VIN filter.

APPLICABLE WARRANTY

- This repair is covered under the Lexus Electric Vehicle Drive Components Warranty. This warranty is in effect for 96 months or 100,000 miles, whichever occurs first, from the vehicle's in-service date.
- Warranty application is limited to occurrence of the specified condition described in this bulletin.

Charging Limit Setting Defaults to Full After Every Key Cycle

Parts Information

PART NUMBER	PART NAME	QTY
G97A0-#####	Unit Assy, Electric Converter w/Cap (ESU)	1

NOTE

The electric converter unit assembly (ESU) should NOT be replaced as part of the Repair Procedure.

Required Tools & Equipment

SPECIAL SERVICE TOOLS (SST)	PART NUMBER	QTY
DCA-8000 Battery Diagnostic Tool*	DCA-8000P T	1

*Essential SST.

NOTE

Additional SSTs may be ordered by calling 1-800-368-6787 or by visiting *Home – Service Resources – Lexus Special Service Tools (SSTs)*.

REQUIRED EQUIPMENT	SUPPLIER	PART NUMBER	QTY
Techstream ADVi*	ADE	TSADVUNIT	1
Techstream 2.0		TS2UNIT	
Techstream Lite		TSLITEPDLR01	
Techstream Lite (Green Cable)		TSLP2DLR01	

*Essential SST.

NOTE

- Only ONE of the Techstream units listed above is required.
- GTS+ Software version 2024.04.004.02 or later is required.
- Additional Techstream units may be ordered by calling Approved Dealer Equipment (ADE) at 1-800-368-6787 or by visiting *TIS – Diagnostics – Tools & Equipment – Techstream Order Portal*.
- Use Techstream or an approved J2534 interface to perform flash reprogramming updates. Visit techinfo.toyota.com for more information regarding J2534 reprogramming.

Charging Limit Setting Defaults to Full After Every Key Cycle

Calibration Information

MODEL	DRIVETRAIN	CALIBRATION ID		VDS
		PREVIOUS	NEW	
RZ 300e	2WD	892634238000	892634238100	ABABB
RZ 450e	AWD			AAAAB

Repair Procedure

1. Confirm the condition exists.
 - A. Go to *Settings – Charging – Charging limit*.
 - B. Select 80%.
 - C. Ready OFF.
 - D. Wait three minutes.
 - E. Ready ON.
 - F. Go back to *Settings – Charging – Charging limit*.

Figure 1.

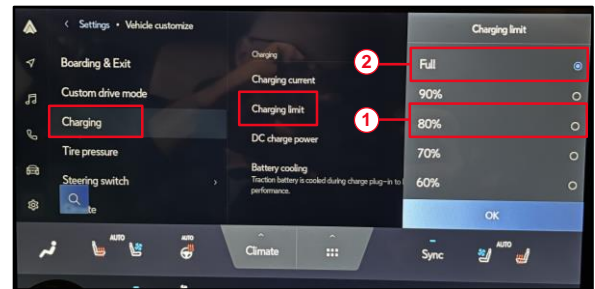

Did the charging limit setting default to Full after the key cycle?

- **YES** — Continue to step 2.
- **NO** — This bulletin does NOT apply. Continue diagnosis using the applicable Repair Manual.

1	80% Charging Limit Setting
2	Full Charging Limit Setting

2. Use GTS+ to confirm if the electric converter unit assembly calibration has been updated. Is the calibration ID listed in GTS+ the latest calibration?
 - **YES** — This bulletin does NOT apply. Continue diagnosis using the applicable Repair Manual.
 - **NO** — Continue to step 3.

Charging Limit Setting Defaults to Full After Every Key Cycle

Repair Procedure (continued)

3. Flash reprogram the electric converter unit assembly.

NOTE

- The battery diagnostic tool MUST be used in Power Supply Mode to maintain battery voltage at 13.5V while flash reprogramming the vehicle.
- For details on how to use the battery diagnostic station, refer to the [DCA-8000 Instruction Manual](#) located at *TIS – Diagnostics – Tools & Equipment – Battery Diagnostics*.

Follow the procedures outlined in Service Bulletin [L-SB-0036-22](#), *GTS+ ECU Flash Reprogramming With Security Signature*, and flash reprogram the electric converter unit assembly with the NEW calibration file update.

4. Using GTS+, clear ANY DTCs and test-drive the vehicle to confirm the condition has been addressed.

NOTE

After DTCs are cleared, be sure to IG OFF and let vehicle rest for no less than 30 seconds before Ready ON.