

Technical Service Bulletin

Topic	43 Air spring symbol lights up - DTC C118D01 Compressor for level control electrical error
Market area	United States 444 Volkswagen of America, Inc. (6444)
Brand	Audi
Transaction No.	2073034/8
Level	EH
Status	Released for publishing
Release date	Mar 12, 2025

Diagnostic trouble codes

Diagnostic address	Diagnostic trouble code	Fault symptom	Storage state
0074 - Chassis control	C118D01: Compressor for level control system Electrical malfunction		static
0074 - Chassis control	C118D01: Compressor for level control system Electrical malfunction		Intermittent

New customer code

Object of complaint	Complaint type	Position
information, navigation, communication, entertainment -> malfunction display symbols -> shock absorber control system malfunction display	functionality -> activates	
chassis -> damping\suspension regulation -> automatic damper adjustment	functionality -> operation sequence incorrect	
chassis -> damping\suspension regulation -> damper adjustment	functionality -> no function	
chassis -> level control system, pitch and roll compensation	functionality	
chassis -> damping\suspension regulation -> damper adjustment	functionality -> operation sequence incorrect	
chassis -> damping\suspension regulation -> automatic level control system	functionality -> no function	
chassis -> damping\suspension regulation -> level control system	functionality -> operation sequence incorrect	
information, navigation, communication, entertainment -> indicator display symbols -> driving dynamics performance indicator display	functionality -> does not activate	
information, navigation, communication, entertainment -> malfunction display symbols -> shock absorber control system malfunction display	functionality -> does not activate	
chassis -> damping\suspension regulation -> automatic damper adjustment	functionality -> no function	

New workshop code

Object of complaint	Complaint type	Position
chassis -> level control system, pitch and roll compensation -> level\damping control module	control modules, services -> with fault stored in the DTC memory	

Vehicle data

Audi Q5

Sales types

Type	MY	Brand	Designation	Engine code	Gearbox code	Final drive code
FY*	2023	A		*	*	*
FY*	2024	A		*	*	*
FY*	2025	A		*	*	*

PR numbers

PR numbers
?:with 1BK
?:or ?:with 1BY
?:or ?:with 2MA
?:or ?:with 2MB

Audi Q7/Q8

Sales types

Type	MY	Brand	Designation	Engine code	Gearbox code	Final drive code
4M*	2023	A		*	*	*
4M*	2024	A		*	*	*
4M*	2025	A		*	*	*

PR numbers

PR numbers
?:with 1BK
?:or ?:with 1BY
?:or ?:with 2MA
?:or ?:with 2MB

Audi A6/A7

Sales types

Type	MY	Brand	Designation	Engine code	Gearbox code	Final drive code
4A*	2023	A		*	*	*
4A*	2024	A		*	*	*
4A*	2025	A		*	*	*
4K*	2023	A		*	*	*
4K*	2024	A		*	*	*
4K*	2025	A		*	*	*

PR numbers

PR numbers
?:with 1BK

PR numbers
?:or ?:with 1BY
?:or ?:with 2MA
?:or ?:with 2MB

Audi A8

Sales types

Type	MY	Brand	Designation	Engine code	Gearbox code	Final drive code
4N*	2023	A		*	*	*
4N*	2024	A		*	*	*
4N*	2025	A		*	*	*

PR numbers

PR numbers
?:with 1BK
?:or ?:with 1BY
?:or ?:with 2MA
?:or ?:with 2MB

Audi e-tron / Q8 e-tron

Sales types

Type	MY	Brand	Designation	Engine code	Gearbox code	Final drive code
GE*	2023	A		*	*	*
GE*	2024	A		*	*	*
GE*	2025	A		*	*	*

PR numbers

PR numbers
?:with 1BK
?:or ?:with 1BY
?:or ?:with 2MA
?:or ?:with 2MB

Documents

Document name
master.xml



Connection offline

Technical Service Bulletin

Transaction No.: **2073034/8**

43 Air spring symbol lights up - DTC C118D01 Compressor for level control electrical error

Release date: Mar 12, 2025

Condition

REVISION HISTORY		
Revision	Date	Purpose
8	-	Revised <i>Warranty</i> (Modified Labor Operations)
7	02/21/2025	Revised <i>Warranty</i> (Modified Labor Operations) Revise <i>Service</i> (Added Note)
6	06/28/2024	Revise <i>Service</i> (Updated Procedure)

Customer states:

The message "*Air suspension: system fault*" is shown in the instrument cluster.

Workshop findings:

The following DTC is logged in the suspension control unit -J775- (diagnostic address 0074):

- **C118D01:** Compressor for level control electrical error.

Technical Background

Not applicable.

Production Solution

Not applicable.

Service

If no irregularities are found when checking the wiring/contacts at the air compressor and compressor electronics - J1135-, proceed as follows:

- Replace the control unit for compressor electronics -J1135- (**not the air compressor**).
- Please use part number **4M0.907.778**.

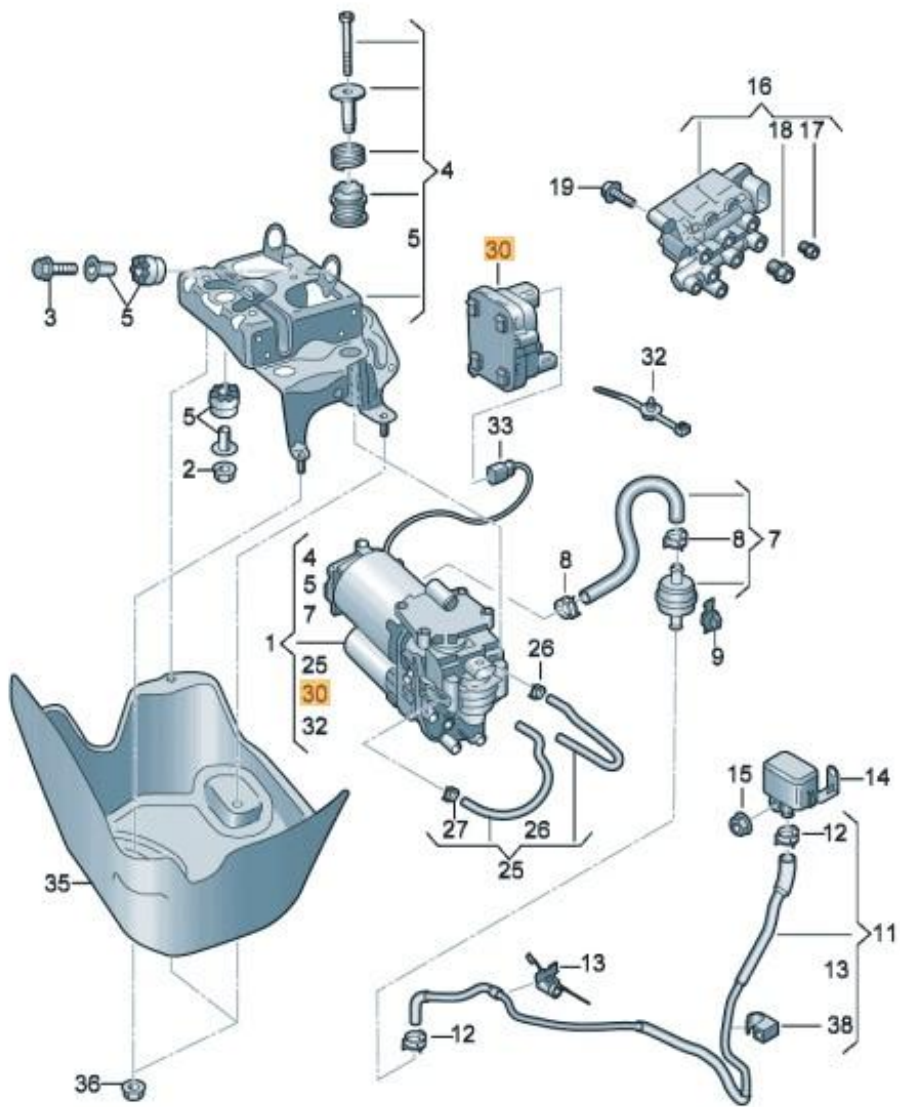

Figure 1. Compressor electronics control unit -J1135-.



Note: Try to reproduce the customer complaint (based on the description/cause of the issue), so that it can be clearly assigned to this TSB. The following repair must only be carried out if all the criteria (model/type, chassis number, engine/motor and gearbox code, PR number(s), part number, software version, code etc.) apply exactly. Otherwise, this solution will not eliminate the problem and repeat repairs may be necessary. In such a case, we may reject the warranty claim and charge back the cost of the parts.

Warranty

Claim Type:	<ul style="list-style-type: none"> If the vehicle is outside of any warranty, this Technical Service Bulletin is informational only.
Service Number:	4316
Damage Code:	0039

Labor Operations:	Remove and install control unit J1135	4316 19xx / 4316 55xx	See SRT with associated operations
	Check control unit (wires and connectors)	4316 0199	Please bill according to time required
	GFF	0150 0060	Time stated on the diagnostic protocol
	Road test prior to the service procedure	No allowance	0 TU
	Road test after the service procedure	No allowance	0 TU
Claim Comment:	As per TSB 2073034/8		

All warranty claims submitted for payment must be in accordance with the *Audi Warranty Policies and Procedures Manual*. Claims are subject to review or audit by Audi Warranty.

Required Parts and Tools

The part numbers mentioned in this TSB are different than the ones listed in ETKA. Only use parts listed in this TSB, this includes superseding part numbers!		
Part Number	Part Description	Quantity
See ETKA	Fasteners, Bolts, Nuts, and Screws as needed per the Repair Manual	See ETKA/ELSA
4M0.907.778	Control unit for compressor electronics J1135 (if necessary)	01

Additional Information

All parts and service references provided in this TSB (**2073034**) are subject to change and/or removal.

©2025 Audi of America, Inc. All rights reserved. The information contained in this document is based on the latest information available at the time of printing and is subject to the copyright and other intellectual property rights of Audi of America, Inc., its affiliated companies, and its licensors. All rights are reserved to make changes at any time without notice. No part of this document may be reproduced, stored in a retrieval system, or transmitted in any form or by any means, electronic, mechanical, photocopying, recording, or otherwise, nor may these materials be modified or reposted to other sites without the prior expressed written permission of the publisher.