

Technical Service Bulletin

Topic	91 SOS warning displayed in instrument cluster, DTCs B105313 and B153313 stored in the data bus diagnostic interface
Market area	United States 444 Volkswagen of America, Inc. (6444)
Brand	Audi
Transaction No.	2054630/3
Level	EH
Status	Released for publishing
Release date	Mar 6, 2025

Diagnostic trouble codes

Diagnostic address	Diagnostic trouble code	Fault symptom	Storage state
0019 - Data Bus OBD Interface	B105313: GSM antenna Open circuit		Intermittent
0019 - Data Bus OBD Interface	B105313: GSM antenna Open circuit		static
0019 - Data Bus OBD Interface	B153313: GSM antenna 2 Open circuit		Intermittent
0019 - Data Bus OBD Interface	B153313: GSM antenna 2 Open circuit		static

New customer code

Object of complaint	Complaint type	Position
information, navigation, communication, entertainment -> Online Services -> automatic emergency call -> automatic online emergency call	functionality -> operation sequence incorrect	
information, navigation, communication, entertainment -> Online Services -> automatic emergency call -> automatic online emergency call	control modules, services -> error message	
information, navigation, communication, entertainment -> Online Services -> automatic emergency call -> automatic online roadside assistance call	functionality -> no function	
information, navigation, communication, entertainment -> Online Services -> automatic emergency call -> automatic online roadside assistance call	functionality -> partially out of order	
information, navigation, communication, entertainment -> Online Services -> automatic emergency call -> automatic online roadside assistance call	control modules, services -> error message	
information, navigation, communication, entertainment -> Online Services -> automatic emergency call -> automatic online emergency call	functionality -> no function	
information, navigation, communication, entertainment -> Online Services -> automatic emergency call -> automatic online emergency call	functionality -> partially out of order	

Vehicle data

A4, A5, and Q5

Sales types

Type	MY	Brand	Designation	Engine code	Gearbox code	Final drive code
8W*	2017	A		*	*	*

Chassis numbers

Manufacturer	Filler	Type	Filler	MY	Factory	From	To	Prod from	Prod to
*	*	F4	*	H	N	000001	043557		
*	*	F4	*	H	A	000001	128700		

PR numbers

PR numbers
?:with IW1
?:or ?:with IW3
?:or ?:with IW5

Documents

Document name
master.xml

Condition

REVISION HISTORY		
Revision	Date	Purpose
3	-	Revised <i>Condition</i> (Updated verbiage) Revised <i>Production Solution</i> (added details per model) Revised <i>Service</i> (Modified repair instructions)
2	06/19/2020	Revised header (Added DTCs and updated VIN breaks) Revised <i>Warranty</i> (Updated Labor Operations)
1	04/26/2019	Initial publication

Customer states:

Yellow warning lamp for the SOS system (Figure 1) is shown in the instrument cluster with the message “Emergency call function: malfunction! Restricted functionality. Please contact Service”.



Figure 1. Yellow warning lamp.

Workshop findings:

One of the following DTCs is stored in the data bus on board diagnostic interface, J533 (address word 0019):

- **DTC B105313** “GSM antenna Open circuit”.

AND/OR

Only on vehicles with PR number IW3 or IW5 + 4GR or 4GY:

- **DTC B153313** “GSM antenna 2 Open circuit.”

The entries can be permanent or sporadic.

Technical Background

The cable-end contact on the emergency call aerial can get damaged when being connected.

Production Solution

Production and contact on aerial plug modified.

A4:

Ingolstadt plant:

From vehicle identification number: *F4 * H A 128700

From production date: 02/17/2017

Neckarsulm plant:

From vehicle identification number: *F4 * HN 043557

From production date: 10/18/2016

A5:

From vehicle identification number: F5 * H A 018466

From production date: 02/15/2017

Q5:

From vehicle identification number: FY * H 2 040274

From production date: 05/30/2017

Service

Explanation and assignment to event memory entries “GSM antenna open circuit” and “GSM antenna 2 open circuit”:

On vehicles with **PR number IW3 or IW5 + 4GR or 4GY**, an **additional** emergency call aerial is fitted alongside the standard aerial fitted in the dash panel.

The installation location of the additional aerial varies depending on the model (see ELSA under ***Vehicle electrics – Electrical system – Communication – Aerial systems – Removing and installing aerial for emergency call module R263/R322***).

Figure 2 shows the connections on the gateway for a vehicle with additional aerial:

- Arrow **A** shows the connection for the additional emergency call aerial. (**PR number: IW3 or IW5 + 4GR or 4GY**).
- Arrow **B** shows the connection for the aerial in the dash panel. (**PR number: IW3 or IW5**)

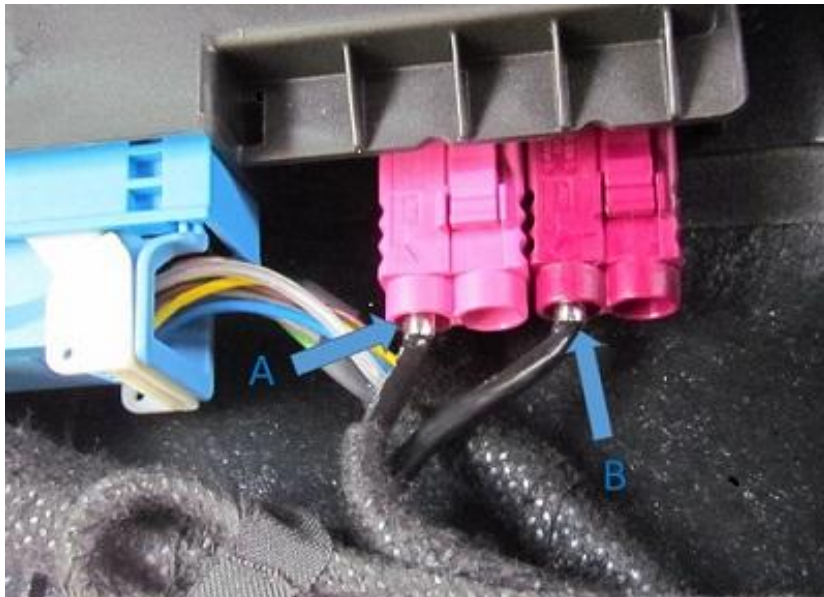

Figure 2. GSM antenna location reference at the data bus on board diagnostic interface, J533 (address word 0019).

The **assignment of the following event memory entries** to the aerials (A or B) may **vary depending on the number of aerials**. The following overview helps with assigning the event memory entries to the respective aerial wire:

Check Fakra connector emergency call aerial:

- If the **DTC “B105313 – GSM antenna open circuit”** is logged in vehicles **with or without** an additional aerial, the path must be checked at connection **A**.
- If the **DTC “B153313 – GSM antenna 2 open circuit”** is logged in vehicles **with** an additional aerial, the path must be checked at connection **B**.

Visual inspection and repair of Fakra connector on gateway:

The cables on the connector must not be under tension:

- If the cables are under tension, replace the contact to VAS 6720.
- Try to rout the cable to prevent the connector from being under tension, if necessary, extend the cable using VAS 6720.

Check the cables directly on the connector if the insulation displays signs of cracking (plastic insulation turns white when under tension):

- If you detect signs of cracking, replace the contact using VAS 6720.

Loose connector:

- Lock the connector and check that it is correctly locked by pulling it lightly.

If no visual irregularities can be detected on the aerial plug on the gateway, try and reproduce the complaint by lightly pressing on the aerial wire directly behind the aerial connector. If the complaint occurs during the check, replace the contact on the gateway control unit using VAS 6720 and extend the cable if it is under tension.

If no complaints can be determined on the gateway connector, check the connector TIM T2dkx (installation location see ELSA).

Only applies to the following DTC:

For vehicles **with or without** the additional aerial with the event memory entry **“B105313 – GSM antenna open circuit”**.

Check the wiring around the TIM central coupling point (designation from current wiring diagram), connector T2dkx (T2dkx installation location see ELSA current wiring diagram).

Images of damage:

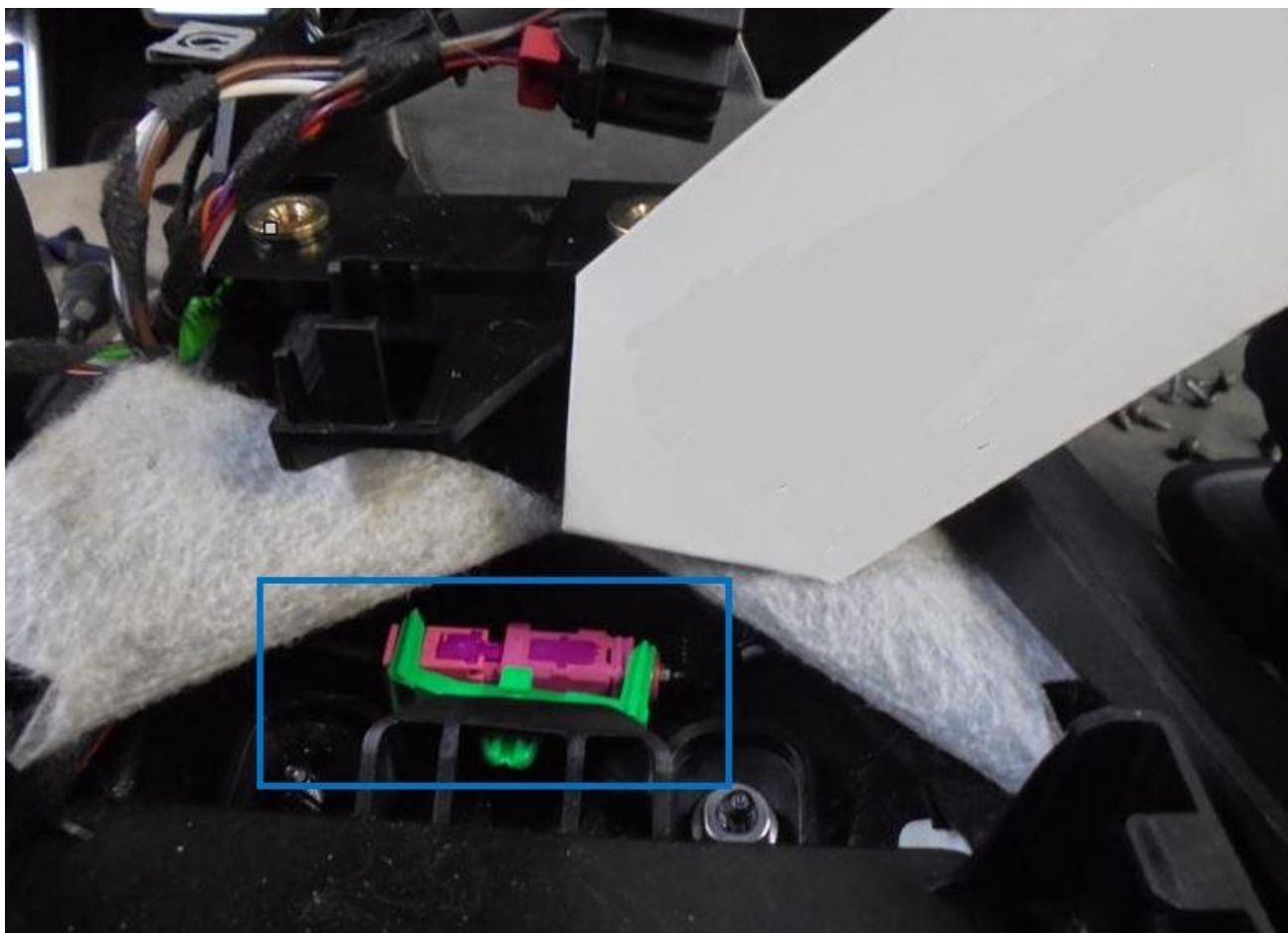

Figure 3. Loose plug on connector T2dx (see blue frame).

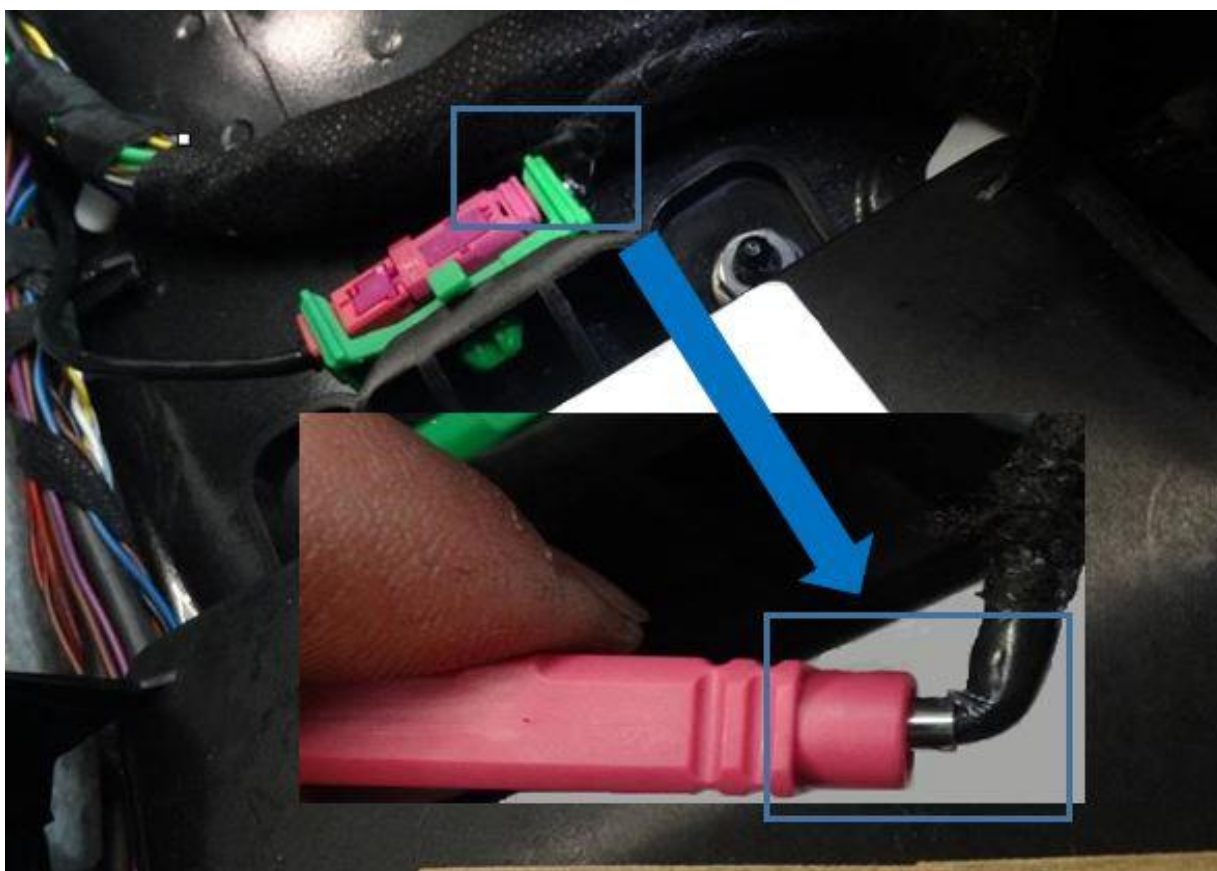

Figure 4. Kinked cable on the connector T2dkx (see zoomed in section, blue arrow).

If the cable is under tension or is kinked, replace both contacts on the connection using VAS 6720; if necessary, extend the cables using VAS 6720.

All known complaints occur mainly in the areas described above.

No visual irregularities on the wiring or the contacts:

If no visual irregularities can be found on the aerial plug of the gateway or the connector T2dkx, use VAS 6720 to replace the electrical connector on the gateway on the wiring harness side, and the connector on the aerial in the dash panel on the wiring harness side. The dash panel **must be** removed to do this.

Also connect the two replaced contacts on the gateway and on the aerial in the dash panel directly with a new aerial wire (without the connector T2dkx).

Rout the repair wire along the main wiring harness.



The information in the manual for VAS 6720 on how repairs on the emergency call aerial wires are prohibited and does not apply to repairs instructed by a TPI.

Warranty

Claim Type:	<ul style="list-style-type: none"> If the vehicle is outside any warranty, this Technical Service Bulletin is informational only. 		
Service Number:	9128		
Damage Code:	0023		
Labor Operations:	Remove and install rear seat bench	7249 1900	See SRT with associated operations
	Check cables on data bus diagnostic interface	9035 0199	10 TU
	Wiring harness repaired (depending on number of new contacts)	9709 41XX	See SRT with associated operations
	Centre console	6817 1900	See SRT with associated operations
	Check central wiring harness (central connector on coupling point)	9709 0199	10 TU
	Finish off wiring harness (route new cables)	9709 3399	Please bill according to time required. All work carried out must be clearly documented.
	A4, A5, and A5 Sportback:		
	Remove and install dash panel	7018 1999	330 TU
Q5:			

Diagnostic Time:	Remove and install dash panel	7018 1999	340 TU
	A5 Cabriolet:		
	Remove and install dash panel	7018 1999	390 TU
	GFF	0150 0060	Time stated on the diagnostic protocol
	Charge battery	2706 8950	See SRT with associated operations
Claim Comment:	As per TSB 2054630/3		

All warranty claims submitted for payment must be in accordance with the *Audi Warranty Policies and Procedures Manual*. Claims are subject to review or audit by Audi Warranty.

Additional Information

All parts and service references provided in this TSB (**2054630**) are subject to change and/or removal.

©2025 Audi of America, Inc. All rights reserved. The information contained in this document is based on the latest information available at the time of printing and is subject to the copyright and other intellectual property rights of Audi of America, Inc., its affiliated companies and its licensors. All rights are reserved to make changes at any time without notice. No part of this document may be reproduced, stored in a retrieval system, or transmitted in any form or by any means, electronic, mechanical, photocopying, recording, or otherwise, nor may these materials be modified or reposted to other sites without the prior expressed written permission of the publisher.