

Published  
ID: 102812

Message  
Target  
Options  
Approve / Deny

Clone

Request

### Communication

<b>Publish Dates</b> <ul style="list-style-type: none"><li>The Start Date is when the communication will be visible to dealers in DCMail.</li><li>The End Date is when the communication will no longer be visible to dealers in DCMail.</li><li><b>NOTE:</b> End Dates are limited to one (1) year from the Start Date. If you wish to lengthen the End Date, you may extend it at any time after publish.</li></ul>	<b>Start Date</b> 2/13/2025 7:00 AM <b>End Date</b> 3/6/2025 11:55 PM Note: All times are EST
---	---

Exit

<b>Title</b> What will display in DCMail for dealers to click on. <i>TIP: Keep titles short, but specific and eye catching.</i>	RAIL - FUEL
---	-------------

<b>Flagged for Reporting Agency</b>	NO
-------------------------------------	----

<b>Communication Summary</b> To increase search capability and visibility of your communication, please provide a brief summary or your message (140 characters max). This will display when dealers hover over your communication.	RAIL - FUEL
--	-------------

<b>Message</b> The body of your communication. Use the formatting toolbar above to format text, insert tables, pictures, and/or hyperlinks. Click Edit > Attach File to attach documents <b>IMPORTANT NOTES:</b> <ul style="list-style-type: none"><li>Pictures must have unique file names. If you receive an error message when uploading a picture, it means the file name has already been chosen. Simply change your file name and try again.</li><li>Communications cannot exceed more than 12MB; this includes images and text, and all attachments.</li></ul>	You have been identified as either having stock on hand or in transit to your dealership. Please check and return suspect stock of part number: CSSMZ465AA. Please refer to QIR attachment. Please return all parts back to your facing depot using Return Code 02, before 6th March 2025. For replacement place new orders. Return any open orders in process too. Direct questions regarding returns via email to <a href="mailto:mopardmail@stellantis.com">mopardmail@stellantis.com</a> .
--	--

Attachments

QIR\_English.pdf

#### File Attachment Information

File Size (MB)	File Name
0.19	QIR_English.pdf



Quality Inspection Request  
**RAIL - FUEL**  
Suspect Part Identification

13-Feb-2025

Part Number: CSSMZ465AA

Suspect parts : Each kit should have 1 of each 68148330AA and 68148329AB. Other included components are listed below.

Suspect packages may contain incorrect combination of rails.

PART SET-UP > PART LIST - EN GK		
Part Number*	CSSMZ465AA	Revision 001 <a href="#">PREV</a>
Noun Name-Description	RAIL - FUEL	
Part Status	RELEASED	Part
Line Up	25VA-MA	Service Rule/I
Year In/Out	2011 - 2021	Rev
<a href="#">INQUIRE</a>		
0871EW -INQUIRY COMPLETE		
EN GK	9 Records Found.	
COMPONENT PART	NOUN NAME-DESCRIPTION	QTY
68148330AA	RAIL - FUEL	001
68628211AA	BOLT AND WASHER - NONE	003
68334967AA	TUBE - FUEL INJECTOR SUPPLY	001
04578812AF	MODULE - PICKUP / LEVEL UNIT	001
68148333AA	O RING - FUEL INJECTOR	006
06511079AA	S TUD AND WASHER - TWO END	002
56365298AA	O RING - FUEL PUMP AND LEVEL UNIT	001
68148329AB	RAIL - FUEL	001
68139485AA	BOLT AND WASHER - NONE	004

## Quality Inspection Request

68148330AA

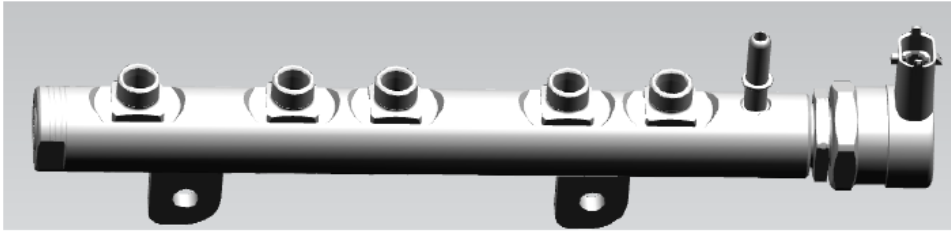

68148329AB

