

**Improper Handling of the Brake Calliper During Assembly Work on the Front Axle (215/23)**

**Change overview:**

Version	Date	Change
1	02/09/2024	<ul style="list-style-type: none"> <li>▪ First publication</li> </ul>
2	01/07/2025	<ul style="list-style-type: none"> <li>▪ Root cause adjusted</li> <li>▪ Action adjusted</li> <li>▪ Labor position and PCSS encryption added</li> </ul>

Model Line: **Macan (95B)**

Model Year: **As of 2014 up to 2018**

Concerns: **Brake calliper and brake hose on the front axle**

Cause: **Assembly work on the front axle when brake calliper is loose**

Root Cause: If a loosened brake calliper is not suspended in the wheel housing in accordance with the instructions in the Workshop Manual while performing further assembly work on the front axle, but is instead left loosely hanging on the brake hose, the brake hose gets pulled too tightly on the holder. This can result in the mounting sleeve on the brake hose slipping off and consequently the brake hose being pulled out of the holder. When reassembling the brake calliper, this can lead to contact between the brake hose and shock absorber.

Action: If a holder for the brake hose with the existing component status is mounted on the vehicle, replace it with a holder with the **new component status**.



**Information**

Holder for brake hose with the **existing component status** ⇒ *Holder for brake hose with the existing and new component status -1-* is replaced by a holder for brake hose with the **new component status** ⇒ *Holder for brake hose with the existing and new component status -2-* during any disassembly and assembly work of the brake calliper.

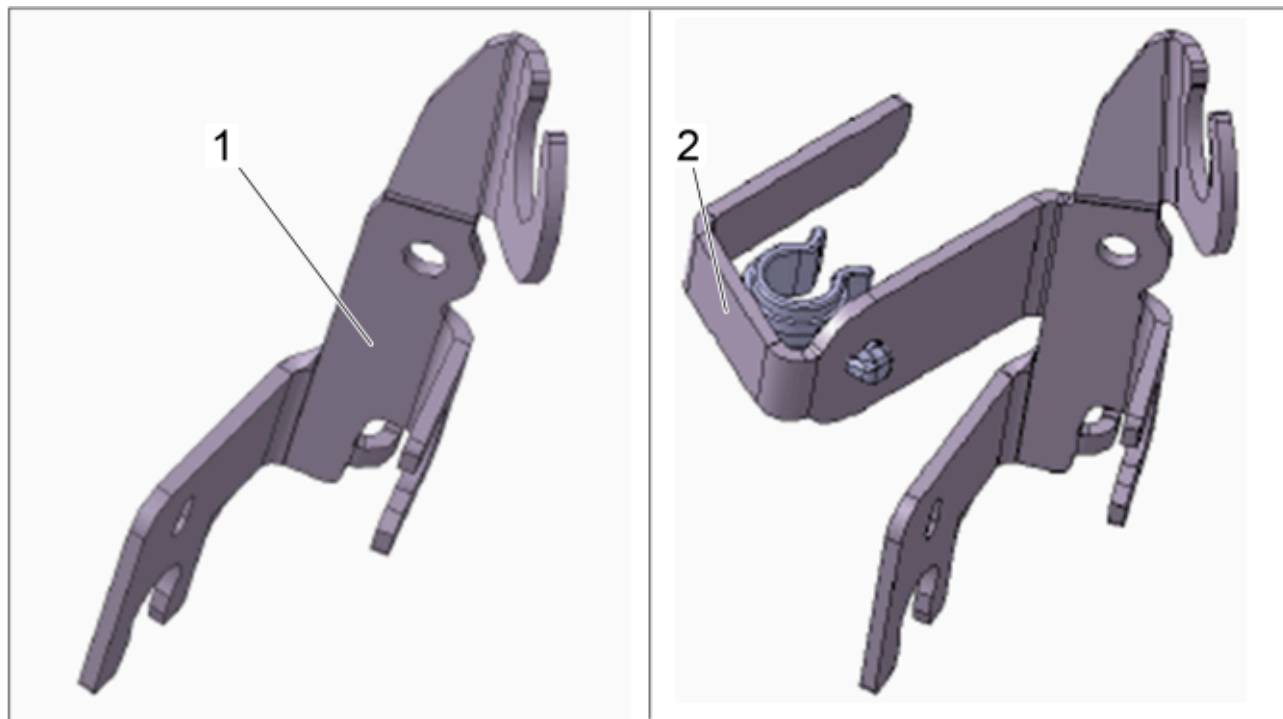

Holder for brake hose with the existing and new component status

- 1 – Holder for brake hose with the **existing** component status
- 2 – Holder for brake hose with the **new** component status

Observe and absolutely follow the instructions described in the Workshop Manual on ⇒ *Workshop Manual '473919 Removing and Installing the front brake calliper'* when disassembling/assembling the brake calliper.

#### NOTICE

##### Improper disassembly/assembly of the brake caliper

- **Risk of damage to the brake hose**
- ⇒ **Do not leave brake caliper hanging from the brake hose**
- ⇒ **Do not pull brake hose too tightly**
- ⇒ **Do not kink, crush or twist the brake hose**
- ⇒ **Suspending the brake caliper at a suitable position in the wheel housing**
- ⇒ **Checking brake hose routing after assembly work**

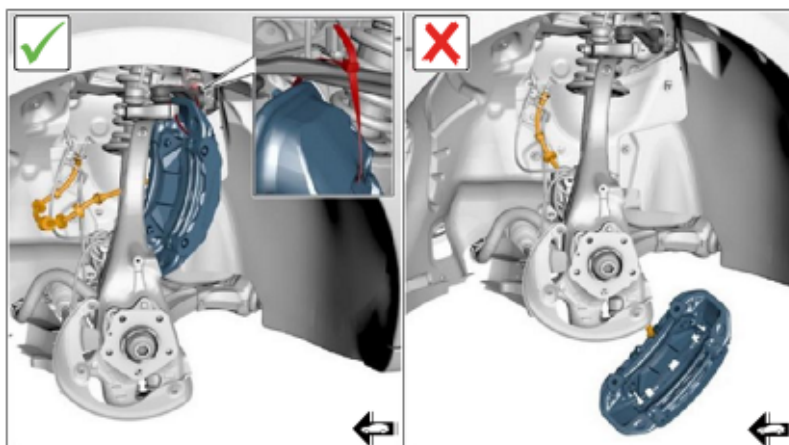

Suspend brake calliper in wheel housing

(✓)	Brake calliper correctly suspended at a suitable position in the wheel housing
(✗)	Brake calliper <b>not</b> suspended (risk of damage to the brake hose)

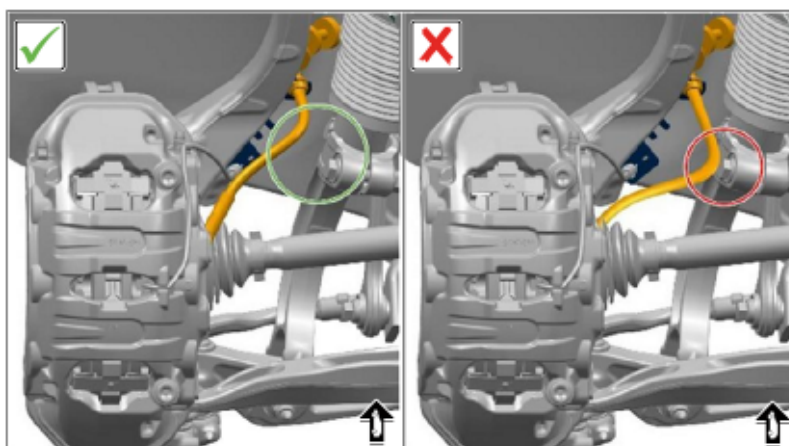

Routing of the brake hose on the holder for the brake hose with the old component status

(✓)	Line routing of the brake hose correct (brake hose has sufficient distance to the shock absorber)
(✗)	Line routing of the brake hose incorrect (brake hose does <b>not</b> have sufficient distance to the shock absorber)

**Required parts as needed**

Parts Info:	Part No.	Designation	Number
	95B971501B	⇒ Holder for left brake hose	1 piece
	95B971502B	⇒ Holder for right brake hose	1 piece

**Required tools as needed**

Tool:           ▪     Torque wrench, 6-50 Nm (4.5-37 ftlb.), e.g. **V.A.G 1331A - torque wrench, 6-50 Nm (4.5-37 ftlb.)**

**Replace holder for brake hose if necessary**

- Work Procedure: 1    Remove and dispose of holder for brake hose with the **existing component status**.
- 2    Install brake calliper **without** holder for brake hose.  
For work procedure, see: ⇒ *Workshop Manual '473919 Remove and install front brake calliper'*
- 3    Install holder ⇒ *Brake hose holder -1-* with the **new component status**.
- 3.1    Install the holder ⇒ *Brake hose holder -1-* by clipping the brake hose ⇒ *Brake hose holder -2-* onto the clip ⇒ *Brake hose holder -3-* behind the guide.
- 3.2    Screw-in and tighten screw ⇒ *Brake hose holder -4-*.

**Tightening torque 10 Nm**

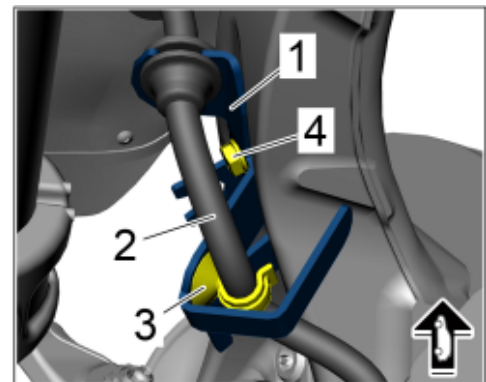

*Brake hose holder*

- 4 Fasten brake hose to holder ⇒ Brake hose holder -1-, clip-in wire harness ⇒ Electrical line to holder for brake hose -2- to holder ⇒ Electrical line to holder for brake hose -3-.

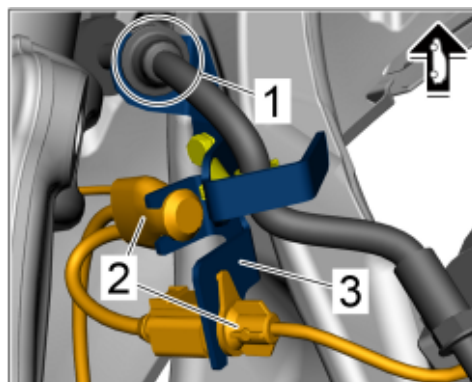

Electrical line to holder for brake hose

**Labor position and PCSS encryption**

Labor position:

APOS	Labor operation	I No.
47265600	Replace holder for brake hose	

PCSS encryption:

Location (FES5)	47102	Holder for brake hose
Damage type (SA4)	1027	incorrect position / location

**Important Notice:** Technical Bulletins issued by Porsche Cars North America, Inc. are intended only for use by professional automotive technicians who have attended Porsche service training courses. They are written to inform those technicians of conditions that may occur on some Porsche vehicles, or to provide information that could assist in the proper servicing of a vehicle. Porsche special tools may be necessary in order to perform certain operations identified in these bulletins. Use of tools and procedures other than those Porsche recommends in these bulletins may be detrimental to the safe operation of your vehicle, and may endanger the people working on it. Properly trained Porsche technicians have the equipment, tools, safety instructions, and know-how to do the job properly and safely. Part numbers listed in these bulletins are for reference only. The work procedures updated electronically in the Porsche PIWIS diagnostic and testing device take precedence and, in the event of a discrepancy, the work procedures in the PIWIS Tester are the ones that must be followed.

© 2025 Porsche Cars North America, Inc.