

☐

THIS REPAIR IS MOBILE FRIENDLY

MODEL

E-Series	Model Description	Production Date
G45	X3 Sports Activity Vehicle	June 20, 2024 – October 15, 2024
G60	5 Series Sedan	
G70	7 Series Sedan	
G90	M5 Sedan	
U10	X2 Sports Activity Coupe	
U11	X1 Sports Activity Vehicle	

SITUATION

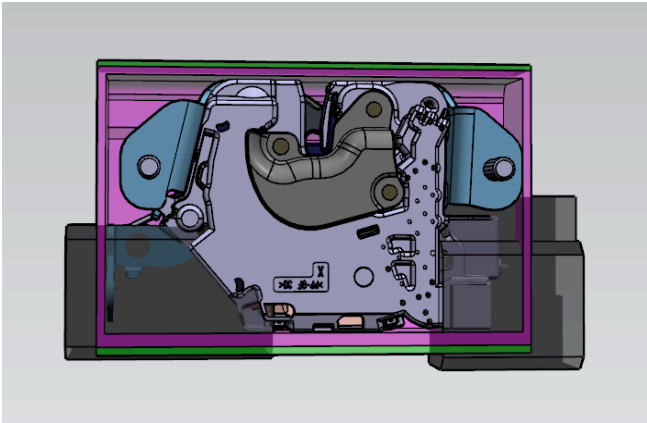

Due to changes in the opening mechanism of the trunk/tailgate latch, it is possible that the trunk/tailgate may not completely lock after closing it.

CORRECTION

Replace the trunk/tailgate latch.

PROCEDURE

Replace the latch that secures the trunk/tailgate following the repair instructions listed in ISTA/AIR 51 24 100.

PARTS INFORMATION

Use and invoice the part number below.

**Note: If the trunk’s latch cannot be replaced due to lack of parts availability, the customer must be informed of the pending reworking measure upon vehicle delivery. An appointment must be made with the customer for the reworking.**

Part Number	Description	Quantity
51 24 5 B53 9E4	Tailgate lock	1

Additionally, other materials and small parts that are not specified above, such as fluids, lubricants, one-time use screws, nuts, and seals, which must be replaced or installed (according to the ISTA repair instructions/ETK/AIR), are to be selected from the Electronic Parts Catalog, and/or other approved BMW Group’s resources according to the respective vehicle type. Invoiced these items separately under the Repair Code listed in this bulletin.

## CLAIM INFORMATION

Reimbursement for this Service Action will be via normal claim entry utilizing the applicable work package information below, and the part number listed above.

<b>Repair Code:</b>	<b>0051170600</b>	---
---------------------	-------------------	-----

Below are the special flat rate labor operation code choices for this action.

**Completion before the first vehicle delivery to a customer (New in-stock/No in-service date), or the vehicle is already in the workshop for another reason and/or repair.**

Work Pkg	Labor Operation	Description (Plusposition)	Labor Allowance
# 1	00 78 508	Renew tailgate lock	As applicable

Or:

**The vehicle arrives at your center and this Service Action shows open (No other Main work will be performed or claimed during this workshop visit).**

Work Pkg	Labor Operation	Description (Main work)	Labor Allowance
# 2	00 78 008	Renew tailgate lock	As applicable

Only one of the flat rate labor operation codes listed above can be used for claim submission and reimbursement. Also, only one Main work flat rate labor operation code can be claimed per workshop visit.

## Claim Repair Comments

Only reference the SIB number and the work package (Pkg) number performed in the technician's RO notes and in the claim comments (For example: B51 04 25 WP 1), unless otherwise required by State law.

## BMW Group's AIR Application Resource for Flat Rate Labor Operation Codes

To obtain the corresponding flat rate unit (FRU) allowance information from the BMW Group AIR application resource, start by entering the Chassis Number (last seven (7) characters of the VIN), and click on the "Search" icon. If the "Vehicle Selection" window displays two or more model possible vehicle choices, select the applicable Model, or enter the full VIN (17 characters) instead to proceed. Click on the "Flat Rate Units" button and enter a flat rate labor operation code number "without spaces" in the field to the right, click on the "Search" icon to display the corresponding listing of "Flat rate unit group details" that are available and their corresponding FRU allowances.

## FEEDBACK REGARDING THIS BULLETIN

Technical Feedback	To submit feedback for the technical topic of this bulletin: Submit your feedback in the rating box at the top of this bulletin
Warranty Feedback	To submit feedback for the CLAIMS section of this bulletin: Submit an IDS ticket to the Warranty Department, or use the chat available in the Warranty Documentation Portal
Parts Feedback	To submit feedback for the PARTS section of this bulletin: Submit an IDS ticket to the Parts Department

