



# Technical Service Bulletin

## 93 e-tron GE various warning messages in the cluster, electric motor leaking P0AA600

93 25 52 2073858/6 January 23, 2025. Supersedes Technical Service Bulletin Group 93 number 24-46 dated December 19, 2024 for reasons listed below.

| Model(s)  | Year                | VIN Range | Vehicle-Specific Equipment |
|---|---------------------|-----------|----------------------------|
| e-tron  | 2019<br>2021 – 2023 | All       | Not Applicable             |
| e-tron Sportback  | 2020 – 2023         |           |                            |
| Q8 e-tron, Q8 Sportback e-tron, S Q8 e-tron, and SQ8 Sportback e-tron | 2024 – 2025         |           |                            |

### Condition

| REVISION HISTORY |            |  |
|------------------|------------|--|
| Revision         | Date       | Purpose  |
| 6                | -          | Revised title (Updated title)                    |
| 5                | 12/19/2024 | Revised <i>Service</i> (Updated measure)         |
| 4                | 11/07/2024 | Revised <i>Warranty</i> (Added labor operations) |

### Customer states:

- A Drive System/Electrical System Malfunction message (Figure 1) appears in the in the instrument cluster; the warning may not be present at the time of inspection.



Figure 1. Warning lamp associated with message.

### Workshop findings:

The following DTC is stored in the *Battery manager control module -J840-*, (address word 008C):

- Hybrid/EV Battery Voltage System Isolation.



# Technical Service Bulletin

---

and/or

- During a workshop visit, an internal leak (e.g., coolant drip container is full; coolant leaking from active chamber on front or rear axle) has been determined on the electric drive motor.

## Technical Background 1

Electric drive motor damaged due to internal coolant leak.

## Production Solution

Not applicable.

## Service

**Check coolant leak and localize the source of the leak:**

**Only if the following information is given can it be assumed that the **electric drive motor is damaged** due to an internal coolant leak:**



**In this case, check the seal on the coolant expansion tank beforehand and re-secure it after performing any required work. Vehicles should never be operated without a correctly filled cooling system.**

**Rear axle (Figure 2):**

Drip container is overflowing:

Coolant leaking from active chamber.

Drip container is empty:

Coolant leaking from active chamber, particularly on vehicles with low mileage.



# Technical Service Bulletin

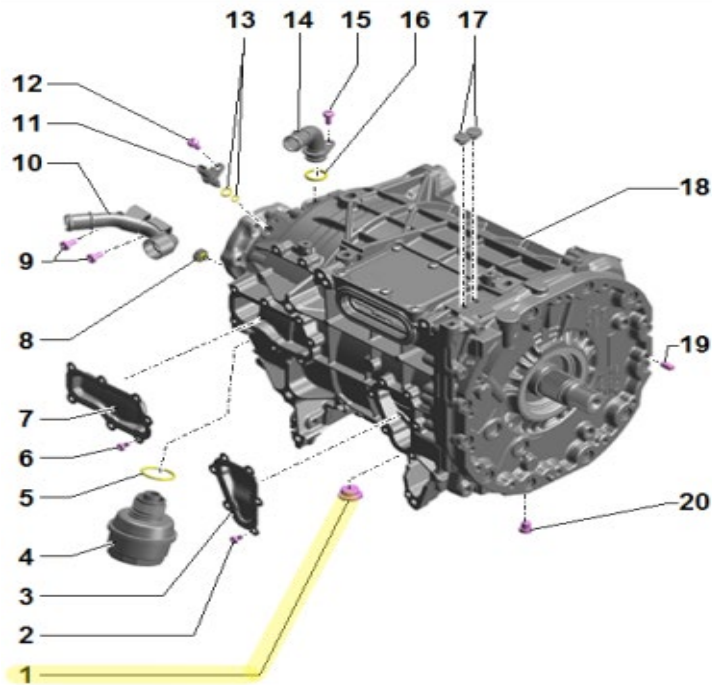

Figure 2: (1) Drain plug.

## Front axle (Figure 3):

Coolant leaking from active chamber.

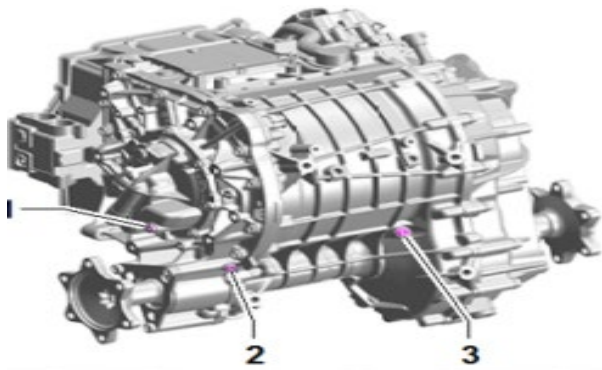

Figure 3: 1) Resolver cover: A few milliliters of coolant leakage is not an issue from a technical perspective. 2) Active chamber: No coolant may escape from the bores.

## **Caution:**

**The power electronics must not be replaced if the electric drive motor is leaking.**



# Technical Service Bulletin



If the power and control electronics for electric drive must be replaced as a group, then this must be billed separately (see warranty accounting instructions).

## Warranty

|                          |   |           |                                    |
|--------------------------|---|-----------|------------------------------------|
| <b>Claim Type:</b>       | <ul style="list-style-type: none"> <li>If the vehicle is outside of any warranty, this Technical Service Bulletin is informational only.</li> </ul> |           |                                    |
| <b>Service Number:</b>   | 9340 (If front electric drive motor was replaced)   |           |                                    |
| <b>Damage Code:</b>      | 0050  |           |                                    |
| <b>OR</b>                |   |           |                                    |
| <b>Service Number:</b>   | 9346 (If rear electric drive motor was replaced)  |           |                                    |
| <b>Damage Code:</b>      | 0050  |           |                                    |
| <b>OR</b>                |   |           |                                    |
| <b>Service Number:</b>   | 9350 (If the power and control electronics for electric drive were replaced; this must be billed separately)  |           |                                    |
| <b>Damage Code:</b>      | T055  |           |                                    |
| <b>Labor Operations:</b> | Check electric drive motor for front axle for leaks   | 9340 0199 | Bill according to time required    |
|                          | Check electric drive motor for rear axle for leaks  | 9346 0199 | Bill according to time required    |
|                          | Replace front drive motor   | 9340 55xx | See SRT with associated operations |
|                          | Replace electric drive motor for rear axle  | 9346 55xx | See SRT with associated operations |
|                          | Replace 2 electric drive motors for rear axle, e-tron S   | 9346 56xx | See SRT with associated operations |
|                          | Replace front power and control electronics for electric drive  | 9350 5599 | 80 TU                              |



# Technical Service Bulletin

|                       |   |              |  |
|-----------------------|---|--------------|--|
|                       | Replace rear power and control electronics for electric drive             | 9350 5599    | 80 TU                                  |
|                       | Replace 2 rear power and control electronics for electric drive, e-tron S | 9350 5699    | 110 TU                                 |
|                       | Deactivate and activate the high-voltage system                           | 9310 835X    | See SRT with associated operations     |
|                       | Charge battery  | 2706 8950    | See SRT with associated operations     |
|                       | GFF   | 0150 0060    | Time stated on the diagnostic protocol |
|                       | <del>Test drive before the</del>  | No Allowance | 0 TU                                   |
|                       | Section may remain blank.<br>e service procedure                          |              |  |
|                       | Test drive after the service procedure                                    | 0121 0004    | 10 TU                                  |
| <b>Claim Comment:</b> | As per TSB 2073858/6  |              |  |

All warranty claims submitted for payment must be in accordance with the *Audi Warranty Policies and Procedures Manual*. Claims are subject to review or audit by Audi Warranty.

## Additional Information

All parts and service references provided in this TSB (**2073858**) are subject to change and/or removal.

©2025 Audi of America, Inc. All rights reserved. The information contained in this document is based on the latest information available at the time of printing and is subject to the copyright and other intellectual property rights of Audi of America, Inc., its affiliated companies, and its licensors. All rights are reserved to make changes at any time without notice. No part of this document may be reproduced, stored in a retrieval system, or transmitted in any form or by any means, electronic, mechanical, photocopying, recording, or otherwise, nor may these materials be modified or reposted to other sites without the prior expressed written permission of the publisher.