



PROTERRA



TECHNICAL SERVICE BULLETIN

ISSUE DATE:	6-16-2021
SERVICE BULLETIN SUBJECT:	Upper Stanchion Mount Floor Cup Relief Retrofit
VINs or MODELS AFFECTED:	Service Specified Buses
COMPLETE BY:	Next Service Opportunity
SERVICE BULLETIN #:	SC-21-90
LABOR OPERATION CODE:	IR47Z

NOTICE! It is expected that this process will require 1 hour per bus. Please schedule appropriately to minimize vehicle downtime.

UPPER STANCHION MOUNT FLOOR CUP RELIEF RETROFIT

Retrofit Description:

This procedure updates the upper stanchion mount floor cups with a slip fitting to prevent cracking of other components.

Tools/Parts Required

Tools and Supplies Required:

- Ratchet
- 6mm Allen Socket
- 3/16-Inch Allen Socket
- Calibrated Torque Wrench
- UV Torque Marker
- Loctite 242/248

Kit Parts Required:

- 058365 KIT, RETROFIT, STANCHION CUP, FLOOR MOUNTED (Consisting of)
 - 139-7759 FITTING, FLANGED FLOOR, RUBBER INSERT CUP, YELLOW 2 EA
 - 139-7764 FITTING, FLANGED FLOOR, RUBBER INSERT CUP, GRAY 3 EA

Procedure

1. Complete the Proterra approved Lockout/Tagout procedure to make the bus safe for work.
2. This procedure will exchange the following parts.

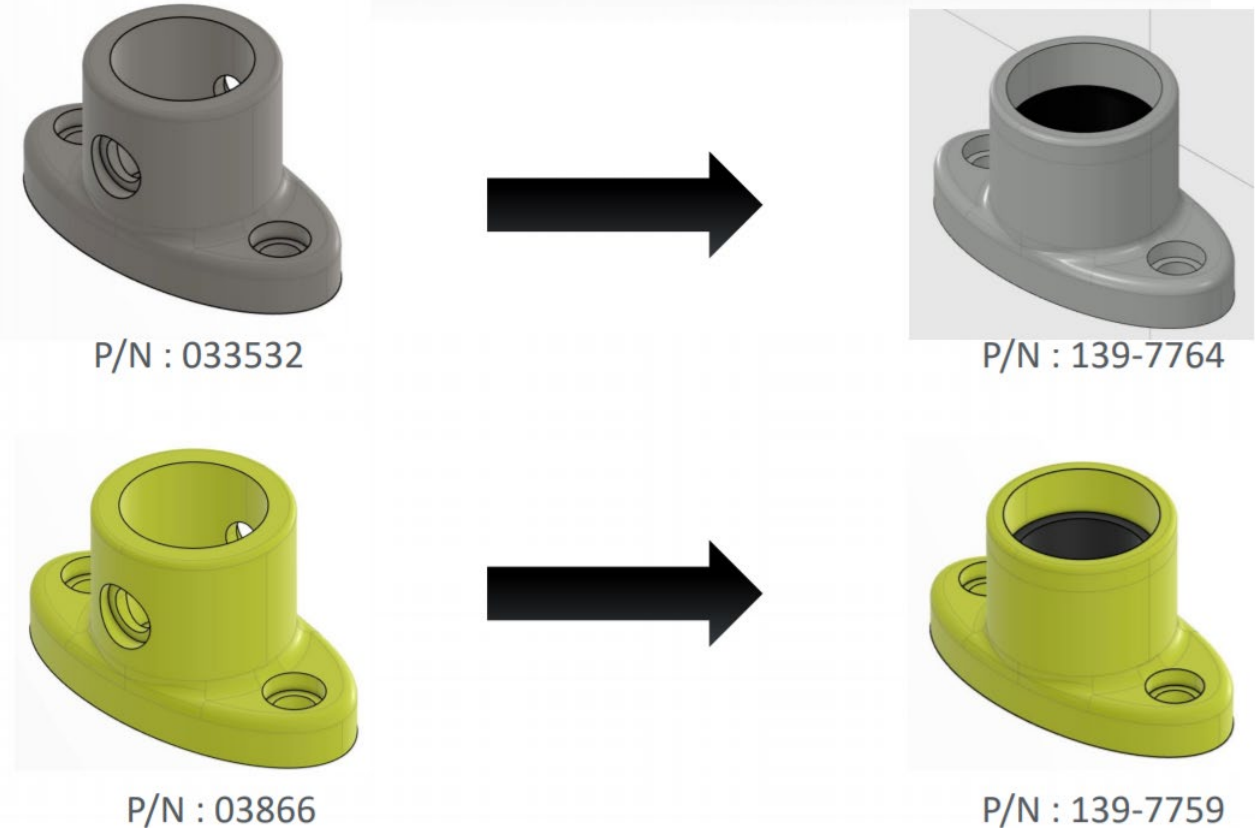

3. Using a Ratchet with a 3/16-Inch Allen Socket, remove the through bolts on the Stanchion Floor Cups shown on the Stanchions outlined in blue in the following illustration.

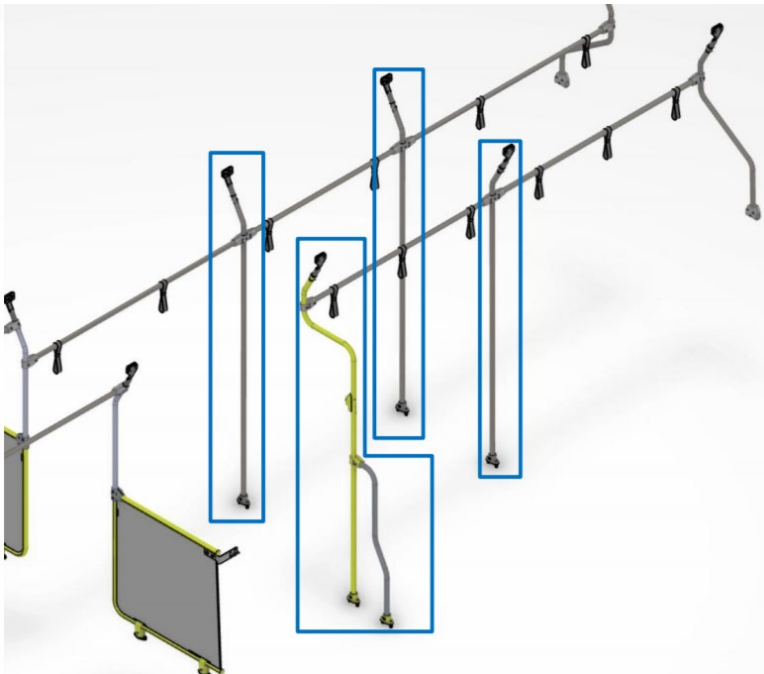

- Using a Ratchet with a 3/16-Inch Allen Socket, loosen the remaining fasteners on the Stanchions so that they may be removed from the Stanchion Floor Cups. Be careful not to disconnect or damage the wiring to the Stop Request Switches.
- Using a Ratchet with a 6mm Allen Socket, remove the Stanchion Floor Cups from the bus. They may be discarded. They will not be reused.
- Using the following illustration as a guide, place the Gray Cups (139-7764) in the locations shown by the green circles.

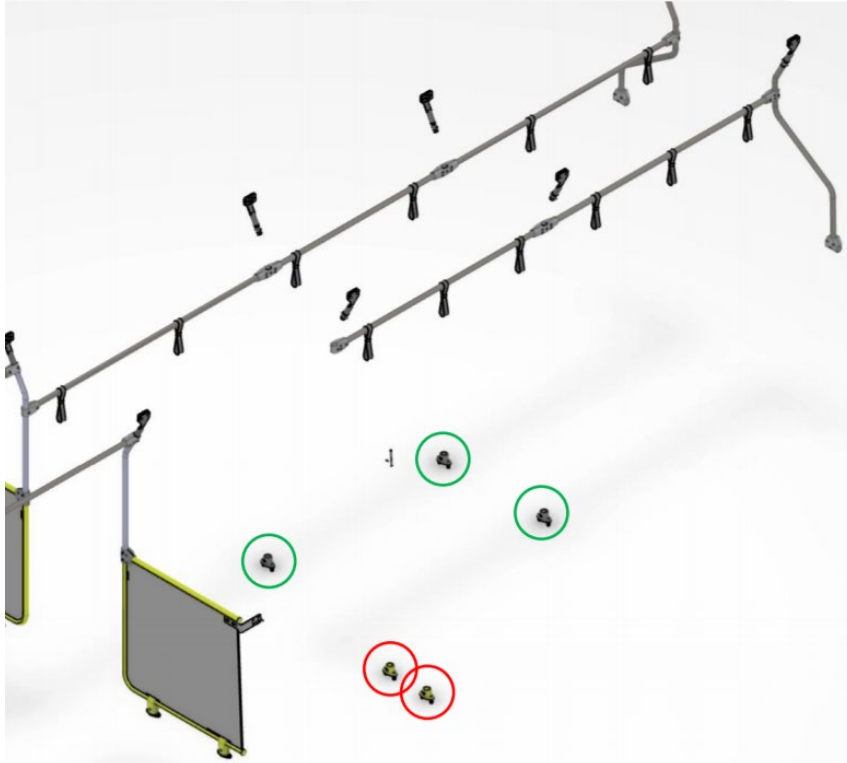

- Place the Yellow Cups (139-7759) in the position shown by the red circles.
- Apply Loctite 242/248 to the threads of the removed M8 bolts.
- Using a Ratchet with a 6mm Allen Socket, secure the Cups to the floor using the previously removed M8 Bolts.

- Using a Ratchet with a 6mm Allen Socket, reinstall the Stanchions and Fittings in the new Cups. There should be a 9 to 12 mm gap between the bottom of the Stanchion and the floor. Trimming may be required to achieve the desired gap. Apply Loctite 242/248 to the Stanchion Fasteners.

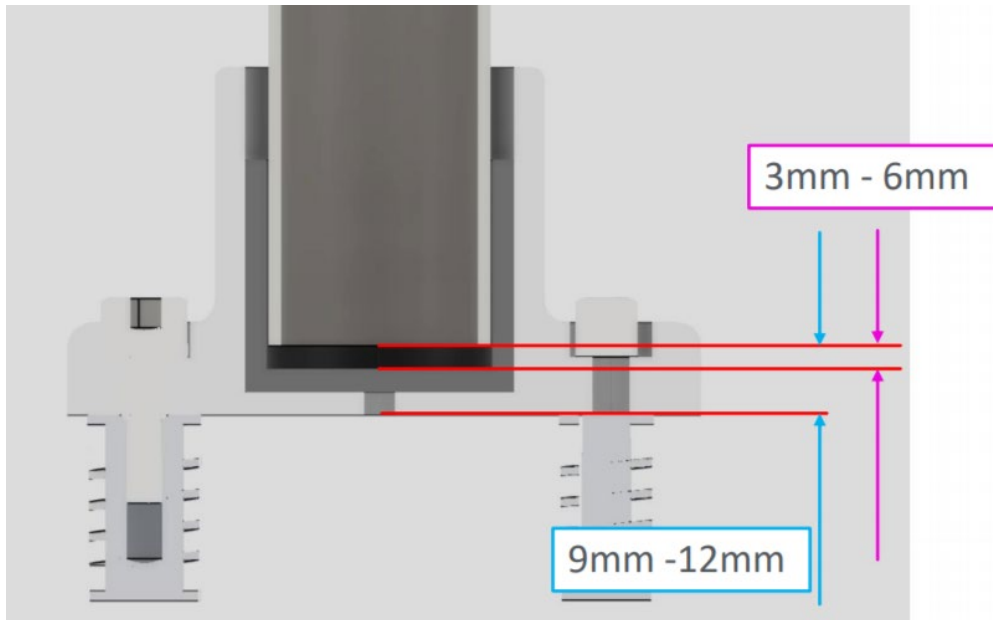

- Using a Calibrated Torque Wrench with a 6mm Allen Socket, **torque the fitting fasteners to 80 inch pounds.**
- Mark the properly torqued fasteners with a UV Torque Marker.
- Remove the Lockout/Tagout devices and return the bus to service.