



**PROTERRA**



# TECHNICAL SERVICE BULLETIN

<b>ISSUE DATE:</b>	2-3-2021
<b>SERVICE BULLETIN SUBJECT:</b>	Parker Ride Height Manifold Retrofit
<b>VINs or MODELS AFFECTED:</b>	Service Specified Buses
<b>COMPLETE BY:</b>	Next Service Opportunity
<b>SERVICE BULLETIN #:</b>	SC-21-19
<b>Labor Operation Code:</b>	SH43Z

**NOTICE! It is expected that this process will require 2 hours per bus. Please schedule appropriately to minimize vehicle downtime.**

## PARKER RIDE HEIGHT MANIFOLD RETROFIT

### Retrofit Description:

This procedure installs updated ride height manifolds for improved reliability.

## Tools/Parts Required

### Tools and Supplies Required:

- Ratchet
- Standard Combination Wrench Set
- 10mm Socket
- Calibrated Torque Wrench

### Parts Required:

- 128-2941    MANIFOLD, RIDE HEIGHT    2 EA

## Procedure:

1. Complete the Proterra approved Lockout/Tagout procedure to make the bus safe for work.
2. Working on the Streetside Rear of the bus, open the curbside hatch and open the three air valves shown in the following photograph to drain the air tanks.

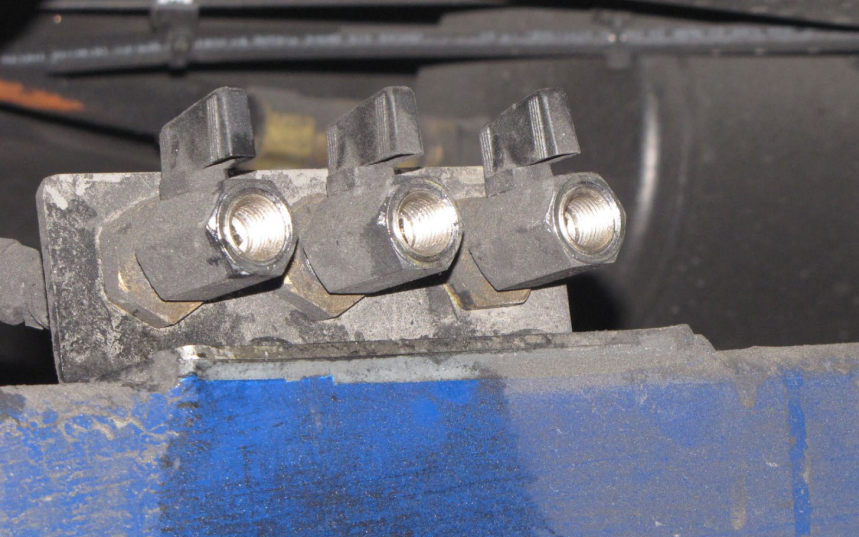

3. Using a Schrader Valve Tool, remove the four valve cores shown to drain the air bags.



4. Make notes or take photographs of the hose connections on the rear Ride Height Manifold shown in the following photograph so that they may be reconnected correctly.

5. Working underneath the rear of the bus, remove the installed Ride Height Manifold and Bracket (044173) using a 10mm Ratchet/Socket.

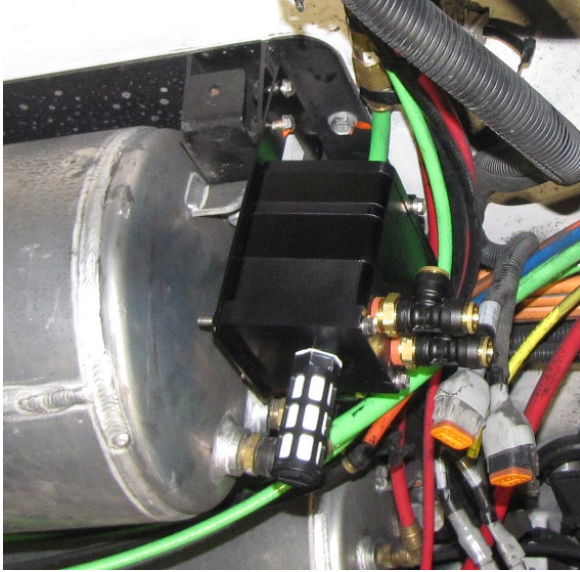

6. Using the following illustration as a guide, remove the fittings and Muffler (043348) from the original Ride Height Manifold and install them on the new Ride Height Manifold (128-2941). All threaded fittings should have Loctite 567 applied before installing them. The fittings should be torqued to 1-1/2 to 3 Turns past finger tight.

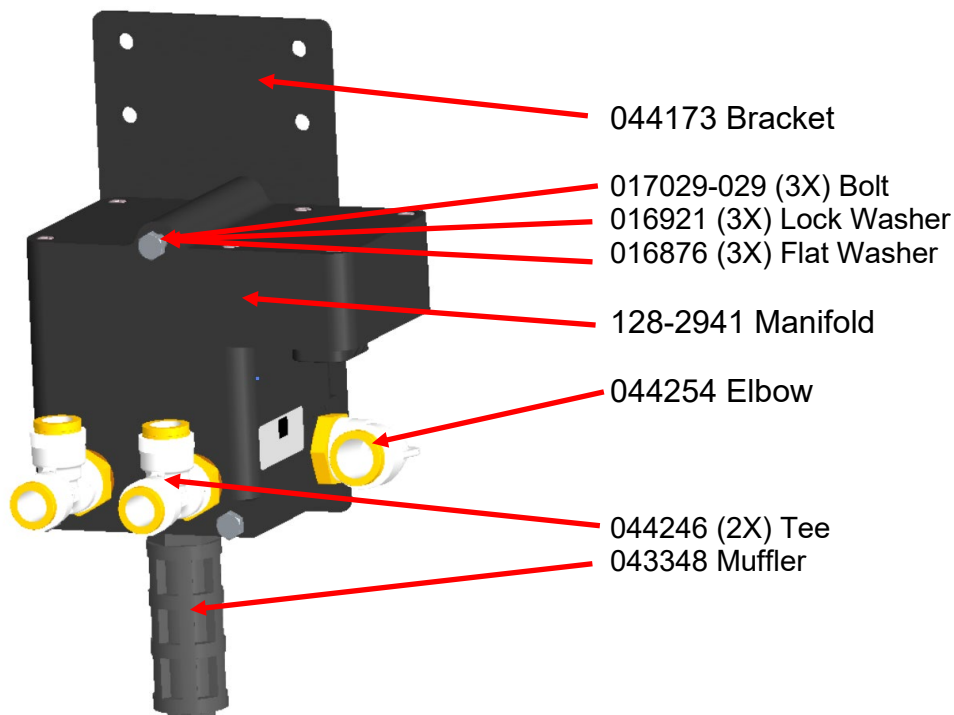

7. Using a 10mm Ratchet/Socket, reinstall the new Ride Height Manifold (128-2941) and Bracket (044173) back into the position where it was originally mounted.
8. Using a Calibrated Torque Wrench with a 10mm Socket, **torque the bolts to 93 Inch Pounds.**
9. Reconnect the hose connections using the photographs or notes taken earlier.

10. Working inside the bus at the Streetside Wheel Well, remove any panels necessary to access the original Ride Height Manifold installed behind the driver. The Mounting Bracket is shown in the following photograph.

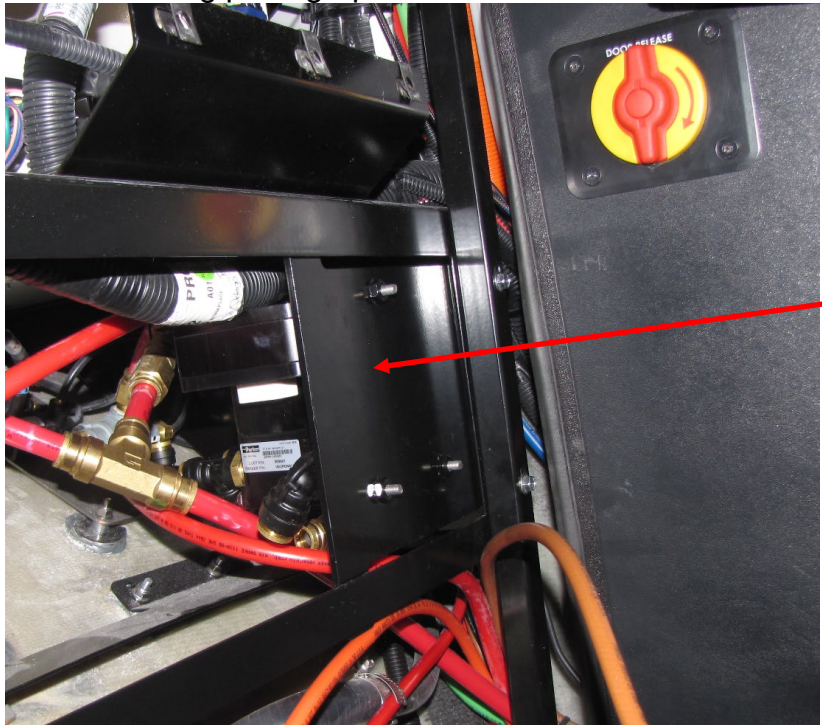

Valve Assembly

11. Make notes or take photographs of the hose connections on the rear Ride Height Manifold shown in the following photograph so that they may be reconnected correctly.

12. Using a 10mm Ratchet/Socket, remove the installed Ride Height Manifold and Bracket (044173).

13. Using the following illustration as a guide, remove the components from the original Ride Height Manifold and install them on the new Ride Height Manifold (128-2941). All threaded fittings should have Loctite 567 applied before installing them. The fittings should be torqued to 1-1/2 to 3 Turns past finger tight.

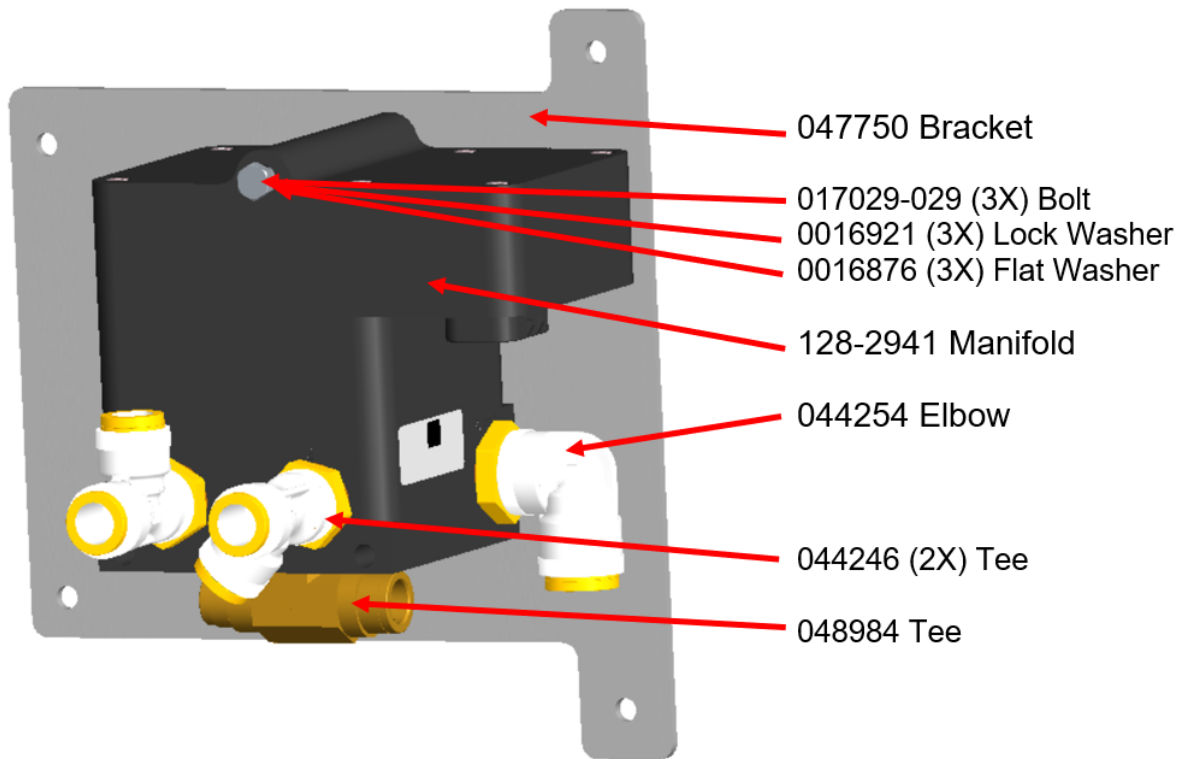

14. Using a 10mm Ratchet/Socket, reinstall the new Ride Height Manifold (128-2941) and Bracket (044173) back into the position where it was originally mounted.

15. Using a Calibrated Torque Wrench with a 10mm Socket, **torque the bolts to 93 Inch Pounds.**

16. Reconnect the hose connections using the photographs or notes taken earlier.

17. Using a Schrader Valve Tool, replace the valve cores that were removed earlier.



18. Close the valves that were opened earlier to drain the air system.

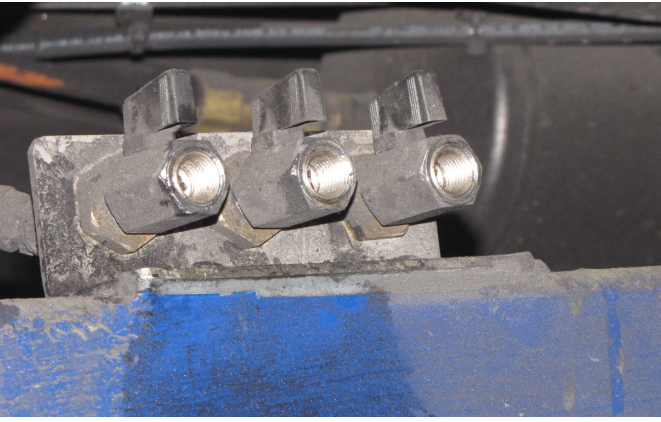

19. Remove the Lockout/Tagout devices and power on the bus.

20. Allow the bus to build air pressure until the compressor stops.

21. Verify that there are no air leaks. Repair any leaks that exist.

22. Return the bus to service.