



SIB 54 03 24

2025-01-13

CONVERTIBLE TOP DOES NOT OPEN/CLOSE

☐ THIS REPAIR IS MOBILE FRIENDLY**MODEL**

E-Series	Model Description	Production Date
G29	Z4 Roadster	After January 1, 2018 – January 19, 2024

SITUATION

The convertible top does not open or close.

Fault code: “805090 Functional limitation, timeout while opening/closing the convertible top” is stored.

CAUSE

The Hall effect sensor falls out of the convertible top linkage.

CORRECTION

Replace the Hall effect sensor.

PROCEDURE

1. Verify the customer complaint.
2. Connect an approved BMW battery charger and read fault codes out of the vehicle.

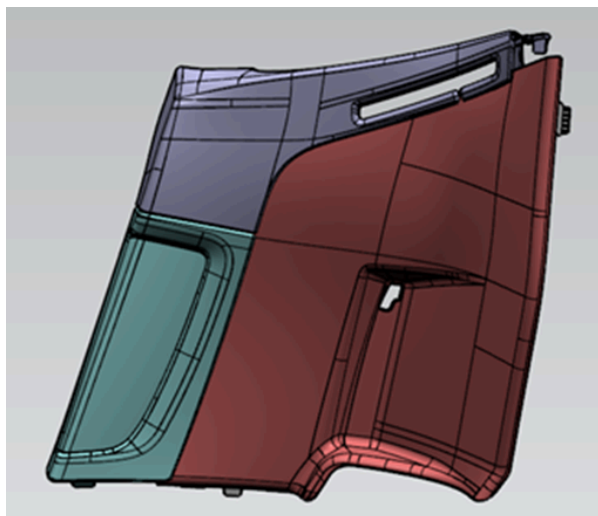

3. Remove the right rear door panel following the instructions listed in ISTA/AIR 51 43 000.

4. Replace the Hall effect sensor D (circled).

Note: Inspect the condition of the Hall effect sensor prior to removing/replacing

it.

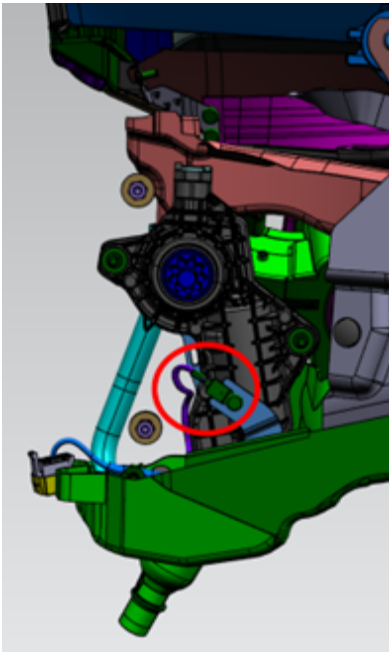
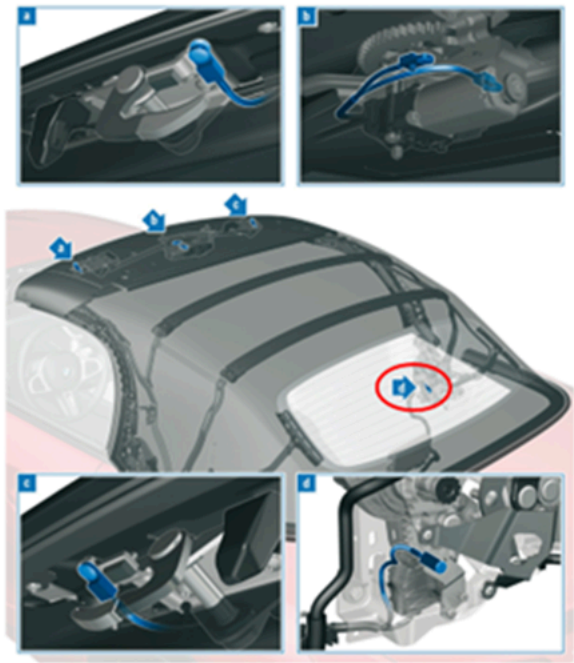

Photo is showing where the Hall effect sensor is located.

5. Once completed, the vehicle can be reassembled and the repair can be verified.

PARTS INFORMATION

Obtain and confirm the part numbers for your specific vehicle by entering the chassis number in either ETK or AIR which considers specific equipment and/or options.

Part Number	Description	Quantity
54 34 5 B65 108	Magnet, Hall effect sensor	1

Additionally, other materials and small parts that are not specified above, such as fluids, lubricants, one-time use screws, nuts, and seals, which must be replaced or installed (according to the ISTA repair instructions/ETK/AIR), are to be selected from the Electronic Parts Catalog, and/or other approved BMW Group’s resources according to the respective vehicle type. Invoiced these items separately under the Repair Code listed in this bulletin.

CLAIM INFORMATION

Covered under the terms of the BMW New Vehicle Limited Warranty for Passenger Cars and Light Trucks, or the BMW Certified Pre-Owned Program as described below.

Repair Code:	6130121500	Microswitch/sensor electromechanical/electrohydraulic convertible top Permanent malfunction
---------------------	-------------------	--

Obtain the flat rate unit (FRU) allowances for the following that applies.

Labor Operation	Description	Labor Allowance
00 00 006	Carrying out vehicle test (Main work)	As applicable
Or:		
00 00 556	Carrying out vehicle test (Plusposition)	As applicable
And:		
61 21 528	Supporting voltage of the vehicle electrical system / recharging vehicle battery	As applicable
And, as needed:		
61 00 006*	Carrying out vehicle diagnosis, ABL (Work time) (Including Inspecting the condition of the hall effect sensor)	WT FRU
Or:		
00 58 500*	Diagnosis Worktime Flat Rate	2 FRU
And:		
51 43 500	Removing and installing rear right-side trim panel (Plusposition)	As applicable
And:		
54 99 000	Additional work time to replace the hall effect sensor (Associated work)	3 FRU

If you are using a Main labor code for another repair, use the Plus code labor operation 00 00 556 instead of 00 00 006, or exclude them (including 61 21 528) when the Vehicle Test is included in another repair.

(*) Based on which one applies to your center, please refer to **SI B01 01 20** or **B01 07 20** for the applicable procedure for documenting, claiming, and explaining, on the RO and in the claim comments, your diagnosis work time (WT), job/repair work time (WT), and the vehicle repairs your center performed, unless otherwise required by State law.

BMW Group's AIR Application Resource for Flat Rate Labor Operation Codes

To obtain the corresponding flat rate unit (FRU) allowance information from the BMW Group AIR application resource, start by entering the Chassis Number (last seven (7) characters of the VIN), and click on the "Search" icon. If the "Vehicle Selection" window displays two or more model possible vehicle choices, select the applicable Model, or enter the full VIN (17 characters) instead to proceed. Click on the "Flat Rate Units" button and enter a flat rate labor operation code number "without spaces" in the field to the right, click on the "Search" icon to display the corresponding listing of "Flat rate unit group details" that are available and their corresponding FRU allowances.

FEEDBACK REGARDING THIS BULLETIN

Technical Feedback	To submit feedback for the technical topic of this bulletin: Submit your feedback in the rating box at the top of this bulletin
Warranty Feedback	To submit feedback for the CLAIMS section of this bulletin: Submit an IDS ticket to the Warranty Department, or use the chat available in the Warranty Documentation Portal
Parts Feedback	To submit feedback for the PARTS section of this bulletin: Submit an IDS ticket to the Parts Department

