



TECH TALK - VOLUME 283 NOVEMBER/DECEMBER 2024

INSIDE THIS ISSUE:

Technical Information - Page 1
TSB/TIN/ATIN Review - Page 12
Technical Training - Page 13
News & Notes - Page 14



HOLIDAYS

Christmas & Winter Shutdown

December 24, 2024-
January 1, 2025



2024 4th Quarter Technician Quiz - TQ042024

Available from October 1
- December 31, 2024

Dealer personnel must
successfully complete the
quiz **no later than:**
December 31, 2024



SPARE PART INFORMATION: Steering Wheel Remote Control Switch

AFFECTED VEHICLES:

2022-2024 Outlander
2023-2025 Outlander Plug-in Hybrid

Customers expressed concern that the Steering Switch did not have a press/click feeling or the switch would not return to its original position. Therefore, the internal structure and durability of the Steering Switch has been revised.

Please refer to the table below for the old and new part numbers.

37-010 STEERING WHEEL / -/-

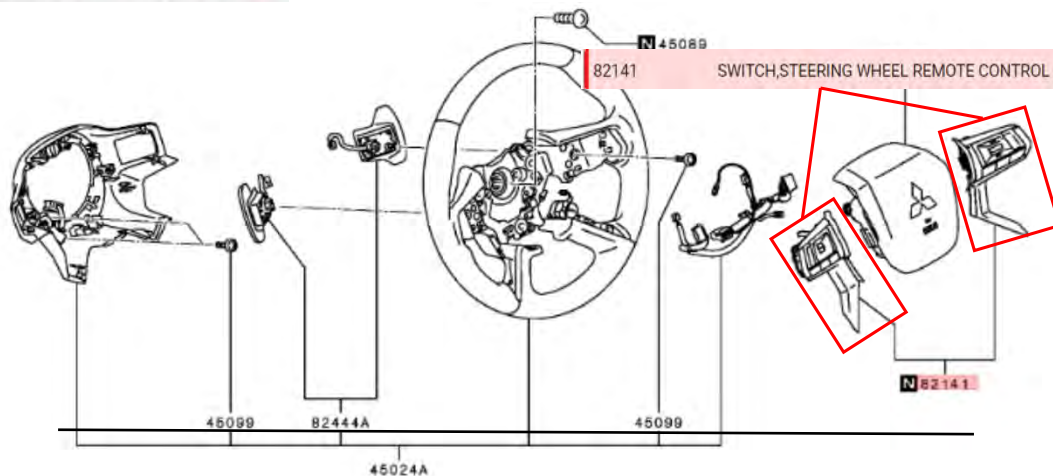

Part Name	Old Part Number	New Part Number
SWITCH, STEERING WHEEL REMOTE CONTROL	8616A121	8616A201
	8616A122	8616A204
	8616A123	8616A205
	8616A124	8616A206
	8616A134	8616A203



TECHNICAL INFORMATION: Electrical System Service Required Warning is on

AFFECTED VEHICLES:

Vehicles equipped with OSS except: 2022-2024 Outlander and 2023-2025 Outlander Plug-in Hybrid

CONCERN:

When a customer indicates that the warning [Electrical system service required (Fig.1)] appears (with DTC: B1135), there is a possibility that the warning message is caused by pressing the engine "Start/Stop" switch for more than three seconds. In this case, restarting the engine by pressing the center of the engine "Start/Stop" switch normally may resolve the problem, and if no warning message appears after restart, the vehicle can be operated.



Fig.1

CAUSE:

The starter motor will turn until the engine starts, even when the engine "Start/Stop" switch is pressed normally.

If the switch is pressed and held down until the engine starts, depending on the situation, there is a possibility that the switch is unintentionally not pressed all the way (or maybe pressed on the outer edge of the switch etc.) for more than three seconds, which may result in this warning(Fig.1) being displayed.

*If the warning remains after restarting the engine by pressing the center of engine "Start/Stop" switch once normally, you should perform trouble shooting according to the workshop manual.

Excerpt from Owner's Manual:

Engine switch

NOTE

- When operating the engine switch, press the switch all the way in. If the switch is not fully pressed, the engine may not start or the operation mode may not change. If the engine switch is pressed correctly, there is no need to hold the engine switch down.

Starting and stopping the engine

For vehicles equipped with the keyless operation system

- The operation mode can be in any mode to start the engine.
- The starter motor will be turning for up to approximately 15 seconds if the engine switch is released at once. Pressing the engine switch again while the starter motor is still turning will stop the starter motor. The starter motor will be turning for up to approximately 30 seconds while the engine switch is pressed.
If the engine does not start, wait for a while and then attempt to start the engine again. Trying repeatedly with the starter motor still turning will damage the starter mechanism.

TECHNICAL INFORMATION: Occupant Detection System Sensor

AFFECTED VEHICLES:

Vehicles equipped with occupant detection system: 2022-2024 Outlander
2023-2025 Outlander Plug-in Hybrid

This is to remind you that when you need a new occupant detection system sensor, please order a "PAD, SEAT CUSHION", not a "COVER, SEAT CUSHION". See illustration below.

The seat belt reminder sensor is located in the same position as in previous models.



Fig.1

Excerpt from Owner's Manual:

Occupant Detection System Sensor

- Occupant detection system sensor installed in the passenger seat cushion pad.
- Occupant detection system sensor transmits the passenger seat status (occupied or empty) to occupant detection system control unit.

①	Front seat belt buckle switch	②	Second seat belt buckle switch	③	Third seat belt buckle switch
④	Occupant detection system sensor*	⑤	Occupant detection system control unit	⑥	Seat belt reminder sensor assembly
⑦	Air bag diagnosis sensor unit Refer to Component Parts Location	⑧	Engine-ECU Refer to ENGINE-ECU REMOVAL AND INSTALLATION	⑨	BCM Refer to Component Parts Location
⑩	Combination meter				

*: Vehicle with occupant detection system control unit.

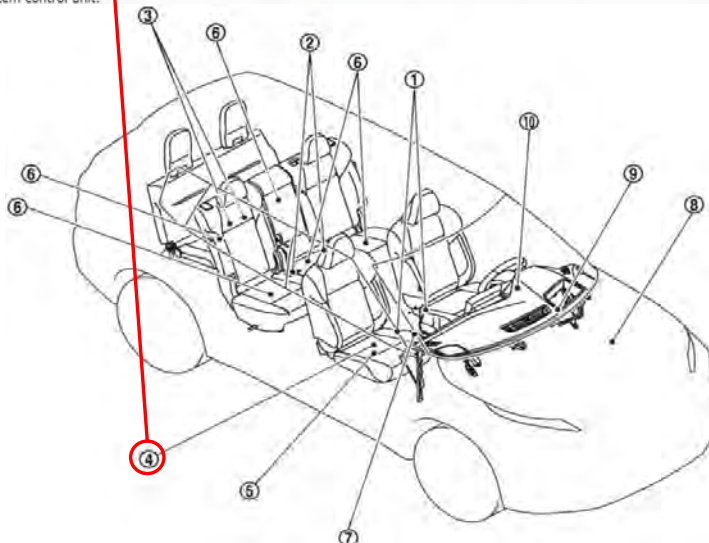

TECHNICAL INFORMATION: Warranty parts storage time reminder

AFFECTED VEHICLES: All

In order to provide high quality vehicles for customers, appropriate handling of warranty parts storage and return is an important role for countermeasure development and reducing the risk of additional field concerns. Part return notification is generally based on a request from Mitsubishi Motors Corporation or a supplier to investigate the replaced component. If this opportunity is missed due to scrapping prior to the required storage period, investigation of field concerns will be delayed.

All warranty replaced parts must be stored for **at least 30 days after the payment statement date**. The payment statement date is the end of the month in which the claim was paid as shown below.

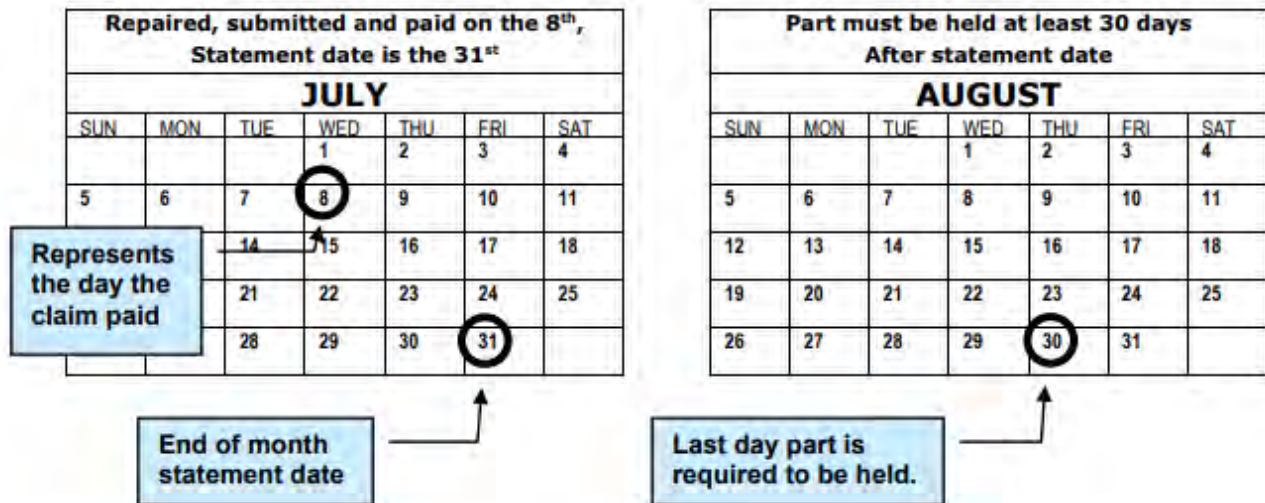

It is also critical that a dealership respond promptly to any part return request (part must be received within 12 calendar days from request date). Therefore, multiple employees (not only one person) should be responsible for keeping an eye out for notification through the Warranty Part Return Status screen. MMNA requests that dealers check for notifications on a daily basis.



TECHNICAL INFORMATION: Fuel - Hard to fill concerns

AFFECTED VEHICLES: All models except Outlander Plug-in Hybrid

In Tech Talk 271 we discussed a hard to fill concern due to a collapsed vent hose. In this article, we'll go a bit more in depth to help technicians diagnose the system due to that, and other causes. A concern of difficulty filling the vehicle with fuel, where the pump continuously shuts off, can be difficult to diagnose when there's not a good understanding of the Evaporative Emissions System and how the tank is vented during fueling. Damaged fuel nozzles, fuel flowing too quickly, or an improperly positioned fuel nozzle, can be eliminated by verifying the customer's concern using a known good fuel dispenser.

During fueling, as fuel is flowing from the nozzle into the tank, air being displaced by the rising fuel level flows through the rollover/float valve in the tank, into the vent hoses, then to the charcoal canister where hydrocarbons are captured for combustion during engine operation at the time of purge. The air being displaced by fuel entering the tank, after passing through the canister, escapes through the normally open vent valve, which is only closed during MFI-ECU controlled Evaporative System testing. Once the tank is full, the rollover/float valve (fig.1) closes, preventing fuel from entering the charcoal canister.

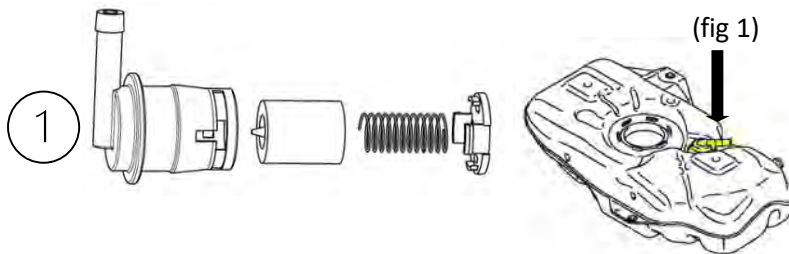

An additional hose referred to as a vent or signal hose (fig 2), allows some of the air to flow from either from the EVAP system or directly from the top of the tank (depending on the model), to the area just above the sensor tube on the filler nozzle (fig 3). Without this important component, fuel flow may not be smooth and may splash back at the nozzle sensor causing the filler nozzle to shut off.

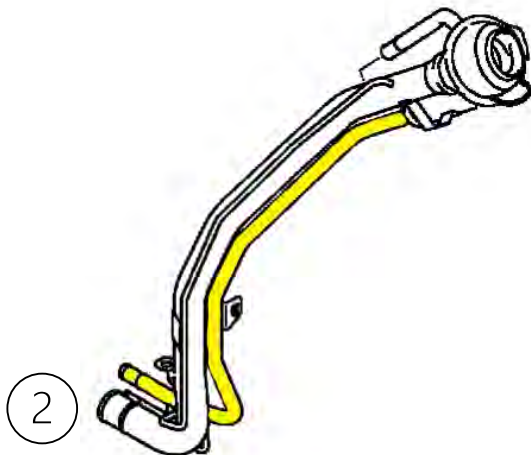

3



Fuel nozzle sensor tube

Once the tank is full and the float valve is closed, there is a tendency for fuel to rush up the filler neck causing a splash back effect more severe than what is required to shut the nozzle off. The point where the filler neck connects to the tank, is equipped with a short tube (located inside the tank) which incorporates a spring-loaded flap (fig 4) to stop the flow of fuel upwards.

4



In short, air is delivered to the area around the fuel nozzle to divert liquid away from the sensing tube on the fuel nozzle. Once fueling is complete, the air flow stops, and the smallest amount of liquid fuel is enough to shut off the nozzle. If air can't flow through the EVAP system, fuel can back up in the filler neck shutting off the nozzle. If air is unable to flow through the vent/sensor hose on the filler neck due to hose delamination or being clogged with debris, fuel may splash back against the sensor tube on the nozzle and shut it off.

TECHNICAL INFORMATION: Windshield Mounted Camera Position

AFFECTED VEHICLES: 2022-2024 Outlander

During the aiming process for the windshield mounted camera, technicians may encounter situations where the process does not complete. Verify that the camera is properly mounted to the windshield (OEM windshield recommended) and that all measurements are correct. Below is a list of error codes and possible causes which may prove helpful with additional diagnosis of the condition.

Displayed item	Possible cause	Service procedure	
Abnormally completed	0	Aiming completed (no error)	-
	1	Aiming status determination (SPI) protocol version mismatch	<ul style="list-style-type: none"> Turn the ignition switch to the ON from OFF. Accurately set target and perform camera aiming again. If abnormally completed again after aiming, replace front camera unit.
	2	Header CRC abnormality in SPI message	
	3	Object CRC abnormality in SPI message	
	4	Abnormality in "CLB Staf Run Mode" due to "Calibration static"	
	5	Aiming not completed within 5 seconds	Position the target appropriately again.
	6	Failure to activate aiming mode	Then perform the aiming again.
	7	Internal error during aiming	
	8	Bottom value threshold exceeded	Correct the input values of the parameters and carry out the aiming again.
	9	Aiming completion value is outside a certain range.	<ul style="list-style-type: none"> Correct the input parameters and carry out the aiming again. Ensure that the target is correctly placed and the front camera unit is correctly installed, then carry out the aiming again.
	18	<ul style="list-style-type: none"> Target not detected The distance between the target and the camera input during the aiming differs more than 50 % of the actual distance. 	<ul style="list-style-type: none"> Ensure that the front camera unit is correctly installed, then carry out the aiming again. Ensure that the hood is not open, then carry out the aiming again. Ensure that there is no obstruction on the windshield in front of the front camera unit, then carry out the aiming again. Brightly illuminate the targets, check that the targets are within the range of the front camera unit and that all targets are clearly visible, then carry out the aiming again. Ensure that the distance from the vehicle to the target is correct, then carry out the aiming again.

Displayed item	Possible cause	Service procedure	
Abnormally completed	19	Aiming result exceeds tolerances in the roll direction.	<ul style="list-style-type: none"> • Check that the input parameters are correct, then carry out the aiming again. • Ensure that the target is correctly placed and the front camera unit is correctly installed, then carry out the aiming again. • Check that there is no reflection of strong light on the target and that there is no object around the target that could be mistaken for the target, then carry out the aiming again.
	20	Aiming result exceeds the tolerances in the yaw/pitch direction.	
	21	Input parameters were not read correctly.	Correct the input parameters, then carry out the aiming again.
	22	Input parameters were not read correctly.	
	23	Target size is outside the recognizable range. (Target size is too small compared to the recognizable size.)	Position the target appropriately again. Then perform the aiming again.
	24	Aiming result exceeds the tolerances in the yaw direction.	
	25	Aiming result exceeds the tolerances in the pitch direction.	
	26	Too many targets	<ul style="list-style-type: none"> • Position the target appropriately again. • Check that there is no reflection of strong light on the target and that there is no object around the target that could be mistaken for the target, then carry out the aiming again.
	27	Malfunction of internal processes	<ul style="list-style-type: none"> • Turn the ignition switch to the ON from OFF. Accurately set target and perform camera aiming again. • If abnormally completed again after aiming, replace front camera unit.



TECHNICAL INFORMATION: Accessing Service Information

AFFECTED VEHICLES: All

Many technicians primarily use the TIR or Service Information Search function in MDL, but it is not the only source for information. The MDL/Service Tech Resources/Service & Owners Publications link is also a good resource.



If using Google Chrome a plug-in will be needed for the links to work. See highlighted area below. When using Firefox Mozilla, a plug in is not required.

Service & Owners Publications

NOTE!
You will need the Chrome PDF Viewer Extension to view the links to view Service Manuals properly.

Install the Chrome PDF viewer in a few steps below:
 1. Open Chrome and search "chrome pdf viewer"
 2. Click on the first result titled "PDF Viewer"
 3. Click on the PDF viewer extension page. Click on "Add to Chrome"
 4. A pop-up window will open asking if you want to "Add PDF Viewer" - Click on "Add extension"

That's it. The Chrome PDF viewer extension has been installed and you can now view service manuals properly.

2023 MODEL YEAR				
Model	Service Manual	Owner's Manual	Body Repair Manual	Technical Information Manual
Eclipse Cross	CD M5C00780000	T00M99017P Click Here for Electronic Links	M5P1100000	Not Available Separately. Order Service Manual CD M5C00780000
	CD M5C00780000	T00M99017P Click Here for Electronic Links	M5P1100000	Not Available Separately. Order Service Manual CD M5C00780000
Outlander Plug-In Hybrid	CD M5C00780000	T00M99017P Click Here for Electronic Links	M5P1100000	Not Available Separately. Order Service Manual CD M5C00780000
	CD M5C00780000	T00M99017P Click Here for Electronic Links	M5P1100000	Not Available Separately. Order Service Manual CD M5C00780000

2024 MODEL YEAR				
Model	Service Manual	Owner's Manual	Body Repair Manual	Technical Information Manual
Eclipse Cross	CD M5C00780000	T00M99017P Click Here for Electronic Links	M5P1100000	Not Available Separately. Order Service Manual CD M5C00780000
	CD M5C00780000	T00M99017P Click Here for Electronic Links	M5P1100000	Not Available Separately. Order Service Manual CD M5C00780000
Outlander	CD M5C00780000	T00M99017P Click Here for Electronic Links	M5P1100000	Not Available Separately. Order Service Manual CD M5C00780000
	CD M5C00780000	T00M99017P Click Here for Electronic Links	M5P1100000	Not Available Separately. Order Service Manual CD M5C00780000

The Model and year can be chosen when using the electronic version of the service manual.

you to view Screen Manuals properly.

That's it. The Chrome PDF viewer extension has been installed and you can now view Screen

2023 MODEL YEAR				
Model	Service Manual	Owner's Manual	Body Repair Manual	Technical Information Manual
Eclipse Cross	CD M5C00780000	T00M99017P Click Here for Electronic Links	M5P1100000	Not Available Separately. Order Service Manual CD M5C00780000
	CD M5C00780000	T00M99017P Click Here for Electronic Links	M5P1100000	Not Available Separately. Order Service Manual CD M5C00780000
Outlander Plug-In Hybrid	CD M5C00780000	T00M99017P Click Here for Electronic Links	M5P1100000	Not Available Separately. Order Service Manual CD M5C00780000
	CD M5C00780000	T00M99017P Click Here for Electronic Links	M5P1100000	Not Available Separately. Order Service Manual CD M5C00780000

2024 MODEL YEAR				
Model	Service Manual	Owner's Manual	Body Repair Manual	Technical Information Manual
Eclipse Cross	CD M5C00780000	T00M99017P Click Here for Electronic Links	M5P1100000	Not Available Separately. Order Service Manual CD M5C00780000
	CD M5C00780000	T00M99017P Click Here for Electronic Links	M5P1100000	Not Available Separately. Order Service Manual CD M5C00780000
Outlander	CD M5C00780000	T00M99017P Click Here for Electronic Links	M5P1100000	Not Available Separately. Order Service Manual CD M5C00780000
	CD M5C00780000	T00M99017P Click Here for Electronic Links	M5P1100000	Not Available Separately. Order Service Manual CD M5C00780000

Once in a service manual, the search function can be initiated by using CTL-F (see below). After typing the search word hit the enter or return key.

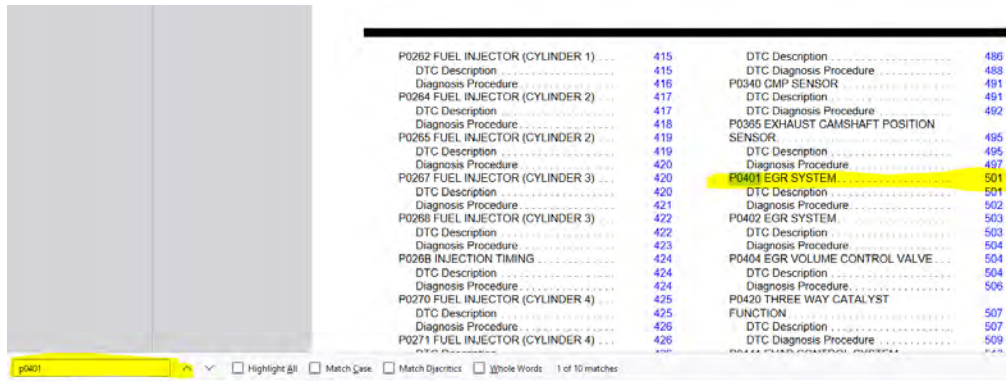

Another handy feature is the page layout that allows the wiring diagrams to be seen as if viewing a book.

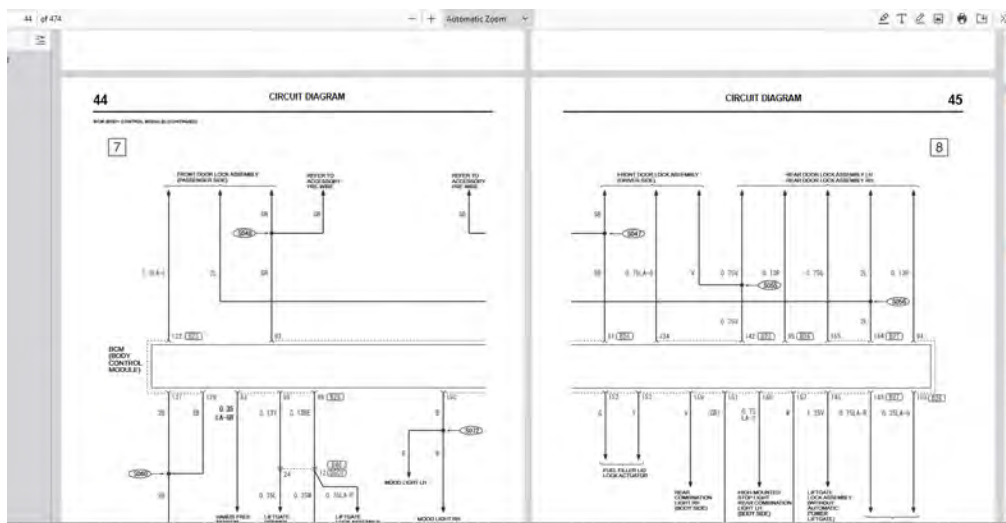
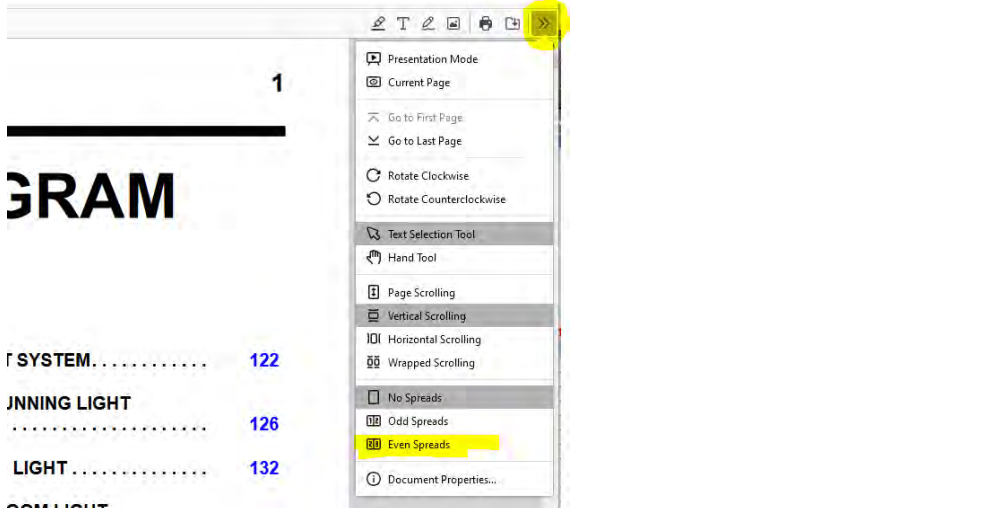

Additionally, specific page numbers can be accessed without scrolling through the entire manual by typing the number of the page requested in the box (top left corner).

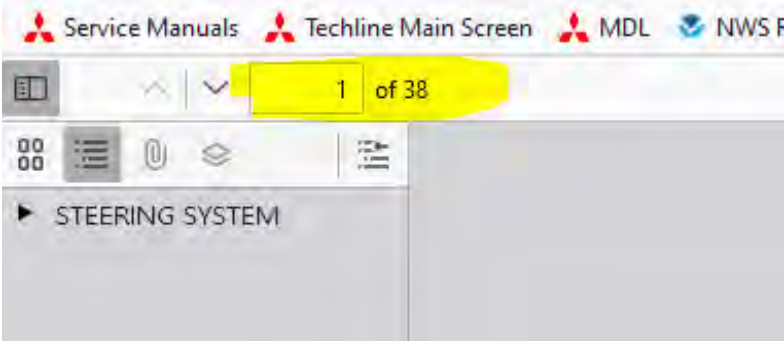



TSB/TIN/ATIN/SC/SRREVIEW

Since Tech Talk 282, the following bulletins have been published:

PUBLISH DATE	TSB/ATIN/TIN #	SUBJECT	MODELS
9/23/2024	TIN-23-SR-001B	ALLIANCE IN-VEHICLE INFOTAINMENT (A-IVI) OPERATION FAILURE - SAFETY RECALL CAMPAIGN - RENOTIFICATION	2022-2023 OUTLANDER & 2023 OUTLANDER PLUG-IN HYBRID
10/21/2024	TSB-24-00-008	GENERAL PDI PROCEDURES FOR 2025 MODELS (EXCEPT OUTLANDER PLUG-IN HYBRID)	2025 MODELS (EXCEPT OUTLANDER PLUG-IN HYBRID)
	TSB-24-51-002	ROOF RACK REMOVAL AND INSTALLATION - SMR	2018-2020 & 2022-2024 ECLIPSE CROSS
	TSB-24-52-001	HEADLINING PAD REMOVAL AND INSTALLATION - SMR	2024 OUTLANDER SPORT
	TSB-24-37-003	STEERING COLUMN SHAFT DISASSEMBLY AND ASSEMBLY - SMR	2014-2024 MIRAGE & 2017-2024 MIRAGE G4
	TSB-24-52-002	TORQUE CORRECTION FOR INSTRUMENT PANEL - SMR	2018-202 & 2022-2024 ECLIPSE CROSS
	TSB-24-00-003REV	GENERAL PDI PROCEDURES FOR 2025 OUTLANDER PLUG-IN HYBRID - REVISED	2025 OUTLANDER PLUG-IN HYBRID
	TIN-24-00-008	ARIZONA MOTOR VEHICLE DIVISION (MVD) - TAKATA RECALLS	2004-2007 LANCER, 2006-2009 RAIDER, & 2012-2017 I-MIEV
10/28/2024	TSB-24-00-006	TECHNICAL SPECIFICATIONS	2025 ECLIPSE CROSS
	TSB-24-00-007	NEW MODEL FEATURES AND SERVICE INFORMATION - 2025 ECLIPSE CROSS	2025 ECLIPSE CROSS
10/29/2024	TSB-24-54-008	DIAGNOSTIC PROCEDURE CORRECTION FOR e-CALL SYSTEM - SMR	2023-2025 OUTLANDER PLUG-IN HYBRID
	TSB-24-51-003	CORRECTION TO WINDSHIELD WIPER AND WASHER MAINTENANCE PROCEDURE - SMR	2018-2020 & 2022-2025 ECLIPSE CROSS

IMPORTANT

Affected new or used vehicle inventory must be repaired before the vehicle is sold or delivered. Dealers must check their vehicle inventory VINs on the Warranty Superscreen to verify whether the vehicle is involved in a recall campaign.

It is a violation of Federal Law for a dealer to sell or deliver a new motor vehicle or any new / used motor vehicle equipment (including a tire) covered by the notification under a sale or lease until the defect or non-compliance is remedied.





TECHNICAL TRAINING COURSE SCHEDULE

Atlanta Technical Training Center - Southeast Region
 801 Interstate West Parkway, Lithia Spring, GA 30122
 (770) 732-3000 Airport: Atlanta (ATL)

November '24				
Monday	Tuesday	Wednesday	Thursday	Friday
28		29	30	31
	CC1	CC1	CES	CES
4	5	6	7	8
			ADAS	ADAS
11	12	13	14	15
	MED4 V-ILT	STV4 V-ILT	EL1 V-ILT	EL1 V-ILT
18	19	20	21	22
	PHEVG2TT V-ILT	PHEVG2TT V-ILT	PHEVG2TT V-ILT	PHEVG2TT V-ILT
25	26	27	28	29

December '24				
Monday	Tuesday	Wednesday	Thursday	Friday
2	3	4	5	6
	ADAS	ADAS	CES	CES
9	10	11	12	13
	EECS	EECSA	EECS	EECS
16	17	18	19	20
	ER1	ER1	ER1	CVT F2F
23	24	25	26	27
30	31	1	2	3
			ADAS	ADAS

New Jersey Technical Training Center - Northeast Region
 516 Heron Drive, Swedesboro NJ 08085
 (856) 467-7100 Airport: Philadelphia (PHL)

November '24				
Monday	Tuesday	Wednesday	Thursday	Friday
28	29	30	31	1
	CES	CES	ADAS	ADAS
4	5	6	7	8
	EECS	EECS	EECS	EECS
11	12	13	14	15
	CES	CES	ADAS	ADAS
18	19	20	21	22
	ER1	ER1	ER1	CVT F2F
25	26	27	28	29

December '24				
Monday	Tuesday	Wednesday	Thursday	Friday
2	3	4	5	6
9	10	11	12	13
	ADAS	ADAS	CES	CES
16	17	18	19	20
	PHEVG2TT V-ILT	PHEVG2TT V-ILT	PHEVG2TT V-ILT	PHEVG2TT V-ILT
23	24	25	26	27
30	31	1	2	3
			ADAS	ADAS

Franklin Technical Training Center
 1552 Columbia Avenue, Franklin TN 37064
 (657) 238-2891 Airport: Nashville (BNA)

November '24				
Monday	Tuesday	Wednesday	Thursday	Friday
28	29	30	31	1
4	5	6	7	8
	MED4 V-ILT	STV4 V-ILT	EL1 V-ILT	EL1 V-ILT
11	12	13	14	15
18	19	20	21	22
25	26	27	28	29

December '24				
Monday	Tuesday	Wednesday	Thursday	Friday
2	3	4	5	6
	MED4	STV4	EL1	EL1
9	10	11	12	13
16	17	18	19	20
23	24	25	26	27
30	31	1	2	3

Course Title	Days	Code	Prerequisites
Engine & Emission Control Systems (ILT)	4	EECS	ES1W, EL1, STV4, MED4, ME3W
Engine Repair (ILT)	3	ER1	ES1W, EL1, STV4, MED4, ME3W
Climate Control (ILT)	2	CC1	ES1W, EL1, STV4, MED4, ME3W
Plug-In Hybrid Electric Vehicle (Virtual)	2	PHEVG2TT	EL1, STV4, MED4, DGPHEVWT
MED4 (Virtual)	1	MED4	ME3W
STV4 (Virtual)	1	STV4	No Prerequisites
Electrical Systems 1 (Virtual)	2	EL1	ES1W
Advanced Driver Assistance Systems (ILT)	2	ADAS21TT	ES1W, EL1, STV4, MED4, ME3W
Chassis Electrical Systems	2	CES22TT	EL1, STV4, MED4, ME3W, ES1W
CVT OVERHAUL PROCEDURES	1	CVT	STV4, MED4, EL1, ATFW
Brake Control System	2	BCS	MED4, STV4, EL1

Classes shaded in Green are (V-ILT) Virtual Instructor Led Training

MMNA technical on site training is not shaded

CVT Overhaul Procedures will be offered in two training formats.

1. CVT V-ILT online instructor-led.
2. CVT F2F in center training.





NEWS RELEASE

MITSUBISHI MOTORS NORTH AMERICA, INC.
Public Relations Department
4031 Aspen Grove Drive, Suite 650
Franklin, TN 37068

www.mitsubishicars.com

MITSUBISHI MOTORS ACQUIRES ITS OWN SHARES FROM NISSAN

TOKYO, Nov. 7, 2024 – Mitsubishi Motors Corporation (hereafter, Mitsubishi Motors) today announced that it has decided to acquire up to 149,028,300 shares (representing 10.02% of the total number of issued shares, excluding treasury shares) from Nissan Motor Co., Ltd. (hereafter, Nissan), reducing Nissan’s current 34.07% stake (506,620,577 shares) in Mitsubishi Motors.

At 8:45 a.m. on November 8, 2024, a consigned purchase order will be placed with the Tokyo Stock Exchange off-auction own share repurchase trading system (ToSTNeT-3) at the price of JPY 460.6 per share, which is the closing price (including final special quote) for today, November 7, 2024 (no changes to other transaction systems or transaction times will be made). The purchase order will be valid at the transaction time specified above.

In light of the recent trend to reduce cross-shareholdings, Mitsubishi Motors has decided to repurchase its own shares from Nissan Motor after considering ways to improve capital efficiency and expand shareholder returns.

Mitsubishi Motors and Nissan will continue their collaborative efforts to drive innovation and deliver exceptional value to their stakeholders. Together, the Alliance companies are actively engaged in high-value creation projects that respond to evolving industry trends.

