

**This document is uncontrolled when printed. Before use, check the Knowledge Base within the McLaren Retailer Portal to verify that this is the current version.**

# Wishbone Bushes Serviceability Guide

## Document Information

**Location:** Chassis

**Topic:** Wish bone bush inspection guide.

**Condition:** N/A **Diagnostic Trouble Codes:** N/A

## Measure

This is a guide on how to determine wishbone bush condition. Below are examples of what is acceptable wear to the bushes and what is unacceptable and must be replaced.

### Inspection 1. Physical checks

Check for excessive play / movement in the bushes.

If this is present, the bushes **must be** replaced.

### 2. Visual checks

Check for cracks and damage present on the rubber of the bush.

- If cracks **are not** present, the bushes **do not** need to be replaced. If
- cracks **are** present, the checks below must be carried out.

1. If the cracks are located on the thin rubber that surrounds the bush inner metals (**see image 1**); •

The bushes **do not** need to be replaced.

2. If the cracks are located anywhere on the main rubber body of the bushes (**see image 2**);

- If the cracks are surface level only and less than 1mm in depth, the bushes **do not** need to be replaced.
- If the cracks are deeper than 1mm in depth, the bushes **must be** replaced.

Image 1

Image 2

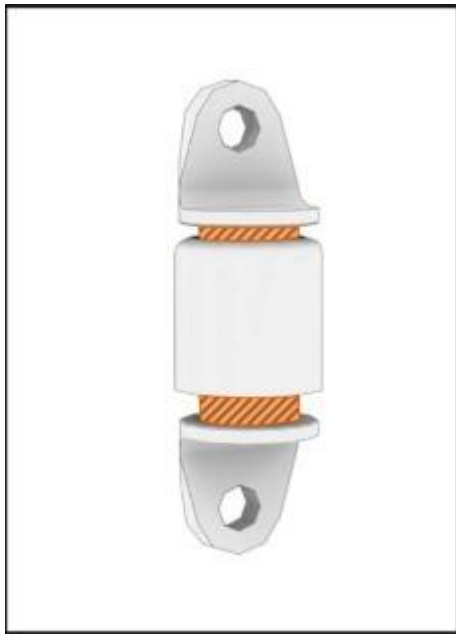

**Note**

If cracks can't be measured due to their location, visual judgement can be used instead. Examples of deep cracks are shown below.

Bushes with deep cracks as shown **must be** replaced.

Examples of deep rubber cracks.



**Note**

Light rubber debris is expected as the bushes progress through their useable life this is **not** a reason for replacement. See example below.



### **Note**

Depending on where and how the vehicle has been used, rubber peeling from the sides of the bush inner metals may occur.

Rubber peeling (as shown in the pictures below) does not impact the performance or the durability of the bushes, they **do not need** to be replaced.

Examples of rubber peeling.



**Note**

Dirt may accumulate on the front and rear faces of some wishbone bushes, as shown in the examples below.



(Example 1 - Bush outer metal dirt accumulation.)



(Example 2 - Bush outer metal dirt accumulation.)

This is **not corrosion** but rather dirt particles from the road that adhere to the exposed resin used during the rubber vulcanization process. This dirt does not impact the functionality of the bush and can be mostly removed with thorough cleaning if needed.

Bushes with dirt accumulation don't need to be replaced.

## Parts Information

Refer to SPC for Latest parts information.

## Attachments

N/A

**This document is uncontrolled when printed. Before use, check the Knowledge Base within the McLaren Retailer Portal to verify that this is the current version.**