

## Technical product information

<b>Topic</b>	Bentley Rotational Display (BRD) clashing with the switch pack during rotation
<b>Market area</b>	Bentley: worldwide (2WBE), China 796 VW Import Comp. Ltd (Vico), Beijing (6796)
<b>Brand</b>	Bentley
<b>Transaction No.</b>	2075740/1
<b>Level</b>	EH
<b>Status</b>	Approval
<b>Release date</b>	

### New customer code

Object of complaint	Complaint type	Position
information, navigation, communication, entertainment -> radio, navigation, MMI, hard drive device functions -> raise display	functionality -> without function / defect	
information, navigation, communication, entertainment -> radio, navigation, MMI, hard drive device functions -> retract display	functionality -> defective function sequence	

## Vehicle data

### New Continental GT / C and New Flying Spur

#### Sales types

Type	MY	Brand	Designation	Engine code	Gearbox code	Final drive code
Z23*	2025	E		*	*	*
Z24*	2025	E		*	*	*
Z32*	2025	E		*	*	*

## Documents

Document name
<a href="#">master.xml</a>

-----

Bentley Rotational Display (BRD) clashing with the switch pack during rotation

### Customer statement / workshop findings

Bentley Rotational Display (BRD) clashing with the MMI switch pack during rotation

### Technical background

Refer to the Measure section of this TPI

### Production change

Not applicable

### Measure

1) Conduct a visual inspection of all (3) BRD faces checking for any signs of clashing / damage at the locations shown in Figure 1 (POINT 1 and POINT 2)



Figure 1



**Should any issues be evident with the BRD faces or MMI switch pack the operative must raise a technical DISS query and await feedback before conducting any further work**

Or

- Should no issues be evident please continue with the remaining instructions

2) Referring to Rep.Gr 96 - Remove the MMI switch pack

3) Referring to Figure 2 - Cut (x2) of 3W0 800 865 1DJ (Brown tape)

- Ensure the surface of the BRD frame is clean - Apply the tape at the locations shown on left and right hand side of BRD frame (next to the switch pack locating pins)

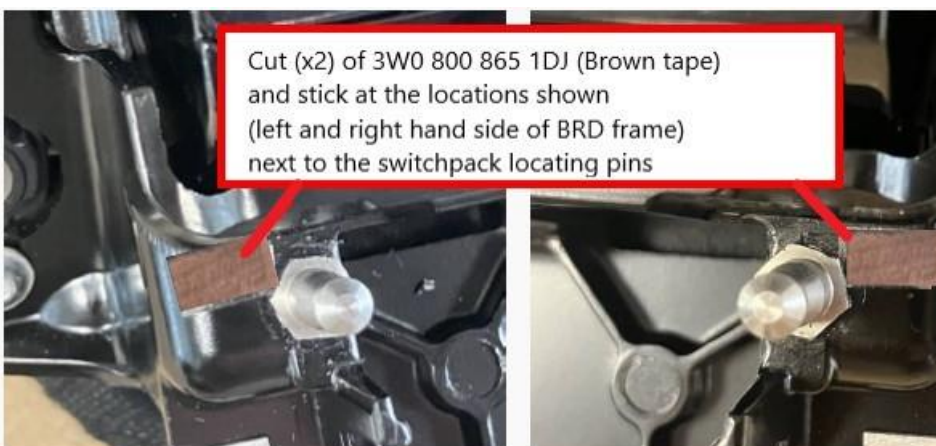
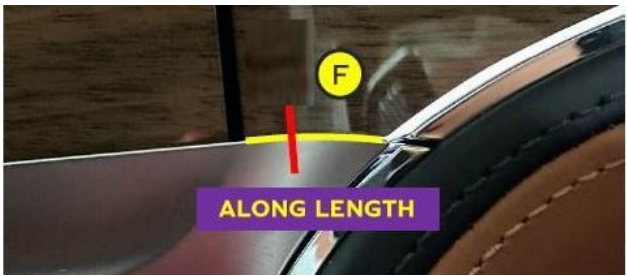

Figure 2

4) Refit the switch pack

5) Referring to Figure 3 - Measure the profile of the switch pack to confirm the correct tolerance has been achieved



MMI switch to facias.  
Overflush at nominal

**F** Max 3.0mm OF  
Nom. 2.0mm OF  
Min 1.0mm OF

Figure 3

- Should the required tolerance be achieved - Rotate the BRD with care to confirm the issue is resolved - If resolved no further action is required

**NOTICE**

In the event the issue is still evident or the required tolerance cannot be achieved please respond via the existing DISS query or raise a new technical DISS query

**Warranty accounting instructions**

Warranty type 110 or 910

Damage service number 91 10

Damage code 00 10

**Time to remove and refit the switch pack**

Labour operation code 91 10 19 01

Time 10 TU

**Time to cut and apply the tape**

Labour operation code 91 10 49 95

Time 10 TU

**Parts information**

x1 roll - 3W0 800 865 1DJ (Brown tape)