

## PORSCHE Front and Rear Cameras with QK3 Pre-Installation



### Information

Please pass all this information on to the customer.

Also give the customer a copy of the first pages of these Installation and Conversion Instructions, including the legal regulations.

Restrictions: **ONLY** approved for vehicles with "Dashcam pre-fitting (QK3)".

Model Year: **As of 2024**

Cause: **Retrofitting**



Figure 1

Note: The Porsche front camera (dashcam) is attached to the windscreen to the **LEFT** of the interior mirror/rain sensor (viewed in direction of travel ⇒ *Figure 1*).

The rear camera is installed at a specified position on the inside of the top center of the rear window (viewed in direction of travel).

Both cameras are connected to the vehicle electrical system.

They are ideal for making video recordings of driving situations and while parking. They can be configured and operated using a related app on your smartphone.

Recorded videos are stored on the supplied SD card and previous recordings are overwritten.

If the dashcam detects a shake/vibration or if the radar sensor is triggered, the recorded video is stored separately and not overwritten. Recordings can be downloaded directly from the SD card or via the app.



### Information

Important information for customers/customer service advisors:

- Ask customers to download and install the "Porsche Dashcam App" from the App Store (Apple or Google Play) on their device (smartphone/tablet) in advance.

For vehicle handover:

- Recommendation: If the vehicle is present, connect the Porsche front and rear camera WiFi to the vehicle WiFi (see also vehicle operating instructions ⇒ Porsche Connect).
- Together with the customer, check whether a firmware update via "Porsche Dashcam App" is necessary. Perform the firmware update together if necessary.
- Together with the customer, choose the "Region/State/Country" by selecting the relevant flag and format the SD card.

Further information for customers:

- The customer is responsible for choosing the right "Region/State/Country"!
- After crossing a national border: Update the "Region/State/Country" (see also conditions of use for this topic)!

Parts Info: **9Y0.044.951** ⇒ PORSCHE front and rear cameras, set

Always order at the same time:

<b>9Y0.044.955.A</b>	1 x	⇒ Front camera retainer plate assembly with wire harness – (360 mm)
<b>9Y0.044.956.D</b>	1 x	⇒ Wire harness for rear camera – 1500 mm
<b>N .017.131.16</b>	1 x	⇒ 5-amp fuse
<b>N .017.131.11</b>	1 x	⇒ 10-amp fuse

Parts List:



Figure 2

Parts included with PORSCHE front and rear cameras (9Y0.044.951 ⇒ Figure 2-1-7-), set:

— — — —	1 x	3M privacy film (front & rear camera) ⇒ Figure 2-1-
— — — —	1 x	Front camera ⇒ Figure 2-2-
— — — —	1 x	Micro SD memory card (32 GB, plugged into front camera) ⇒ Figure 2-3-
— — — —	1 x	Rear camera ⇒ Figure 2-4-
— — — —	1 x	PORSCHE dashcam operating instructions ⇒ Figure 2-5-
— — — —	6 x	Protective foam roll (Ø approx. 29 x 74) ⇒ Figure 2-6-
— — — —	12x	Tie-wrap, 145 x 3.6x 1.1 ⇒ Figure 2-7-
9Y0.044.955.A	1 x	Front camera retainer plate assembly with wire harness – 360 mm ⇒ Figure 2-8-
9Y0.044.956.D	1 x	Wire harness assembly for rear camera – 1500 mm ⇒ Figure 2-9-

Repair Kit: Order "Adhesive pad" repair kit **ONLY** when replacing the windscreen/rear window.

9Y0.044.931	1 x	"Adhesive pad" repair kit contains:
— — —	1 x	Adhesive pad for front camera retainer plate (grey) on backing sheet
— — —	1 x	Adhesive pad for rear camera (grey)
— — —	1 x	3M privacy film (front & rear camera) ⇒ <i>Figure 2-1-</i>

Technical Details:

- Video recording in Quad High Definition (QHD)
- Lens with polarisation filter to reduce reflections and improve colors and contrasts
- Audio recording (can be deactivated)
- Global positioning system (GPS) sensor
- Vibration sensor
- Radar sensor for video recording when an object is approaching the vehicle
- Bracket for the windscreen for fixed mounting on the vehicle
- Rear camera is permanently installed on the rear window

Material:

— — —	1 x	Wrapping / insulating tape (commercially available)
— — —	1 x	Cleaning cloth (commercially available)
— — —	1 x	Isopropanol (commercially available)

Tools: **P90999 - P90999 - Porsche Tester 4th generation**

Tablet, smartphone or PC with Internet access

Round file Ø at least 5 mm, Stanley knife, scraper

Marking pencil / chalk

Flashlight

Plastic squeegee

Assembly:

- 1 Preparatory work
  - 1.1 Connect battery charger. ⇒ *Technical Information '270689 Charge vehicle electrical system battery'*
  - 1.2 Front roof/rear-view mirror area (interior) ⇒ *Figure 3*

- 1.2.1 Remove the front roof console. ⇒ *Technical Information '708319 Removing and installing front roof console'*

- 1** – Roof console
- 2** – Rear-view mirror cover
- 3** – Sun visor holder (inside)
- A** – Front camera power supply pre-fitting position
- B** – Rear camera video signal pre-fitting position

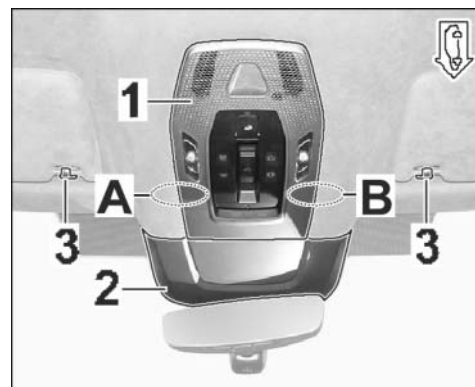

Figure 3

- 1.2.2 Remove (interior) rear-view mirror cover. ⇒ *Technical Information '682719 Removing and installing interior mirror'*

- 1.3 Rear lid area ⇒ *Figure 4*

- 1.3.1 Remove rear lid trim panel (lower). ⇒ *Technical Information '70871900 Removing and installing trim panel for rear lid'*

- 1** – Rear lid trim panel (lower)
- 2** – Rear lid trim panel (top)
- 3** – Rear lid trim panel (side) – left side

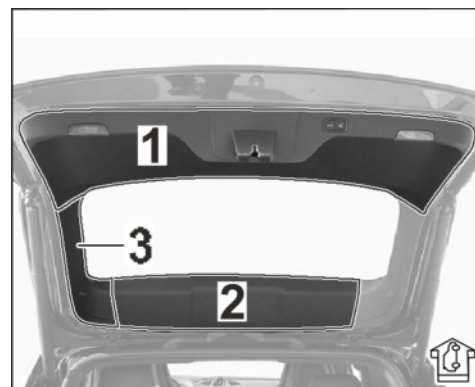

Figure 4

- 1.3.2 Remove rear lid trim panel (top). ⇒ *Technical Information '70871905 Remove and install trim panel for rear lid (upper)'*

- 1.3.3 Rear lid trim panel (side) – remove left side. ⇒ *Technical Information '70871901 Removing and installing trim panel for rear lid (side)'*

1.4 Luggage compartment area ⇒ *Figure 5*

- 1** – Trim panel on rear closing panel (inside)
- 2** – Trim panel on rear closing panel (outside)
- 3** – Luggage compartment trim (left)
- 4** – D-pillar trim panel (left)

1.4.1 Remove the rear luggage compartment side trim panel at the left. ⇒ *Figure 5-3-* ⇒ *Technical Information '700319 Removing and installing luggage compartment side trim panel'*

1.4.2 Remove left D-pillar trim panel. ⇒ *Figure 5-4-* ⇒ *Technical Information '706919 Removing and installing D-pillar trim panel'*

1.4.3 **ONLY** for luggage compartment partition net (3CX): Remove left (⇒ *Figure 6-1-*) / right suspension lugs on roof trim panel (rear). ⇒ *Technical Information '708419 Removing and installing roof trim panel'*

- 1** – Suspension lug (rear) – left
- 2** – Fastening clamps
- 3** – Rear lid grommet wire harness – left

1.4.4 Unclip fastening clamps (3 pieces) in the area of the rear roof trim panel (rear lid). ⇒ *Figure 6-2-* ⇒ *Technical Information '708419 Removing and installing roof trim panel'*

1.4.5 Unclip rear lid grommet wire harness – left side on rear lid and body. ⇒ *Figure 6-3-* ⇒ *Technical Information '972719 Remove and install wire harness for tailgate'*

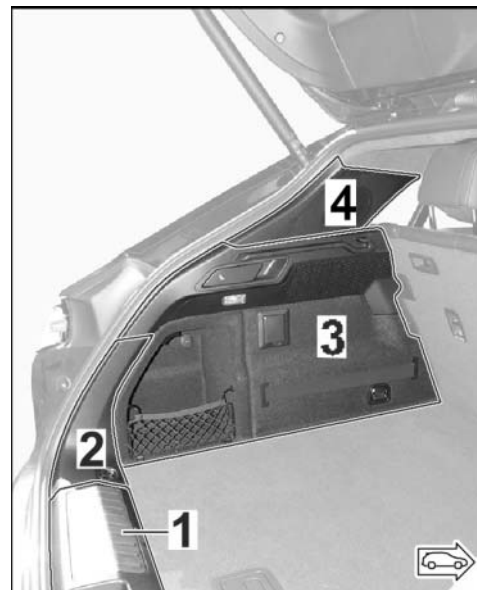

Figure 5

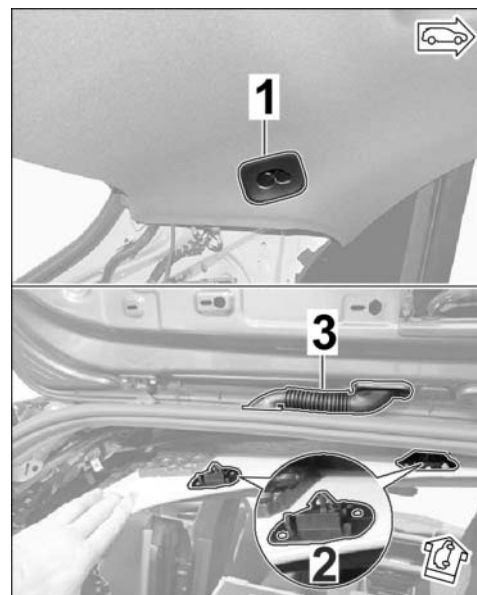

Figure 6

## 2 Installing front camera



### Information

Due to legal requirements, there are two different positions for the front camera depending on the country / market (see also work step from 2.1.2 and following).

- Position in Rest of World (RoW) = ... -RoW

Please note when positioning the front camera!

Overview of installation position ⇒ *Figure 7*

- 1 – Rain sensor
- 2 – Installation position of front camera
- 3 – Electric wire harness
- 4 – Power supply
- 5 – Rear camera connection (video signal)

- 2.1 Position front camera (dashcam) on wind-screen to the **LEFT** of interior mirror / rain sensor

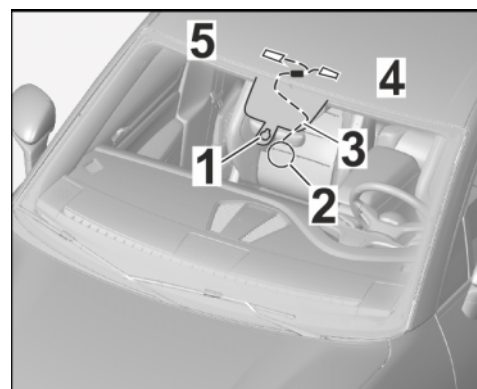

*Figure 7*

- 2.1.1 Install retainer plate with wire harness on the base of the front camera until the locking mechanism engages. ⇒ *Figure 8*

- 1 – Retainer plate with wire harness
- 2 – Front camera base

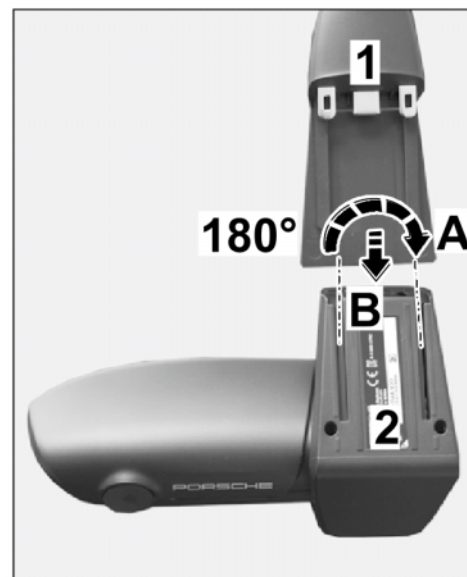

*Figure 8*

- 2.1.2 Trace outline of rain sensor on outside of windscreen using grease pencil / chalk. ⇒ *Figure 9-1-*

- 1 – Outline of rain sensor
- 2 – Outline of front camera base
- 3 – Interior mirror
- 4 – Front camera

**X-RoW** – 313 mm/ 12.32 in

**Z-RoW** – 27 mm/ 1.06 in

- 2.1.3 Copy dimensions X- and Z- on outside of windscreen according to country/market. ⇒ *Figure 9-top-*

**Rest of World (RoW):**

Dimension X-RoW = distance from lower edge of outline of front camera base to edge of roof:

**Length 313 mm/ 12.32 in**

Dimension Z-RoW = distance from inner edge of outline of front camera base to inner edge of outline of rain sensor (circle): **Length 27 mm/ 1.06 in**



**Information**

Observe the following points during positioning/alignment:

- Sufficient distance between front camera and interior mirror base: at least 5 mm/ 0.2 in.
- Get another person standing in front of the vehicle to check and confirm the horizontal alignment of the camera with the PORSCHE logo!

- 2.1.4 Position front camera with retainer plate in the vehicle at the marking on the windscreen. ⇒ *Figure 9-Arrows-*

- 2.1.5 Get another person to trace and shade in the outline of the retainer plate on the outside of the windscreen using a marking pencil/chalk.

- 2.1.6 Clean the inside of the windscreen in the bonding area for the retainer plate (shaded area) to remove any dust and grease.

- 2.2 Install front camera (dashcam) on the windscreen

**NOTICE**

**Adhesive films not prepared/installed correctly**

- **Damage to adhesive films**
- **Inadequate adhesion of adhesive films**

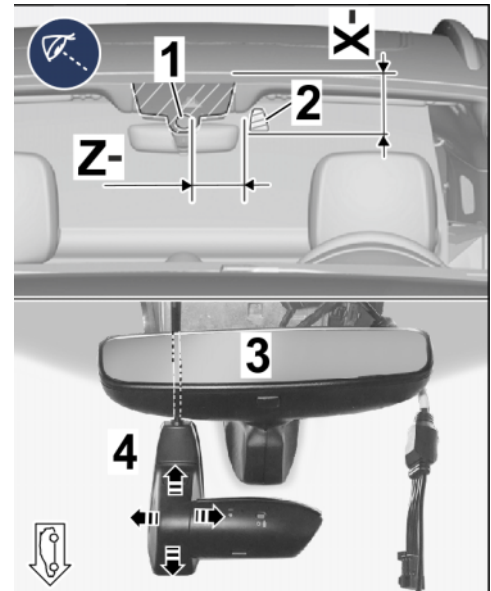

*Figure 9*



- ⇒ **Carefully clean the areas on which you intend to stick the film to ensure that all traces of oil, grease and silicone are completely removed.**
- ⇒ **Do not touch the bonding surfaces.**
- ⇒ **Object (adhesive film, vehicle, etc.) and ambient temperature: Minimum temperature 15°C / 59 °F.**

2.2.1 Pull 3M privacy film off the backing sheet. ⇒ *Figure 10-A-*

- 1** – 3M privacy film
- 2** – marked bonding surface
- 3** – Interior mirror base

2.2.2 Position 3M privacy film on marked bonding surface on windscreen. ⇒ *Figure 10-B-*

2.2.3 Carefully affix 3M privacy film using a plastic squeegee, starting from the center and moving towards the edge.

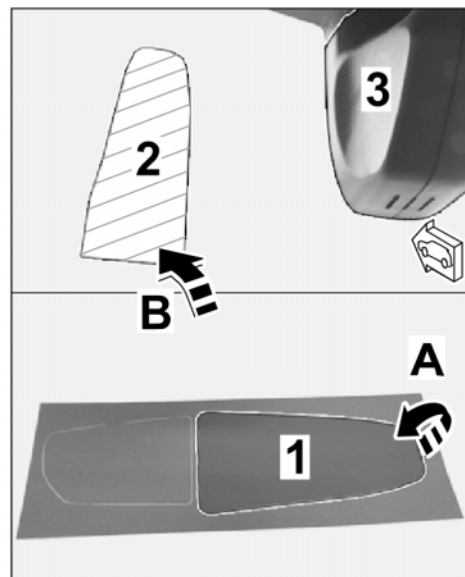

*Figure 10*

- 2.2.4 Pull protective film off the front camera retainer plate. ⇒ *Figure 11 -top-*

- 1 – Protective film
- 2 – Front camera
- 3 – 3M privacy film
- 4 – Interior mirror



#### Information

Observe the following points during positioning/alignment:

- Sufficient distance between front camera and interior mirror base: at least 5 mm/ 0.2 in.
- Get another person standing in front of the vehicle to check and confirm the horizontal alignment of the camera with the PORSCHE logo!

Align front camera with retainer plate symmetrically with respect to the 3M privacy film. ⇒ *Figure 11 -bottom-*

- 2.2.5 Press front camera with retainer plate firmly onto the 3M privacy film on the wind-screen.



#### Information

Route electric wire harness along existing wiring, if installed.

Make sure that safety components (airbags, etc.) are still working correctly!



*Figure 11*

## 2.3 Route and connect electric wire harness

Line routing ⇒ *Figure 12*:

- 1** – PORSCHE front camera
- 2** – Front camera mounting plate with wiring harness
- 3** – Power supply pre-fitting
- 4** – Rear camera pre-fitting
- blue** – Camera position for Germany (D)
- green** – Camera position for Rest of World (RoW)

- Front camera → left (viewed in direction of travel) past the driver assistance systems control unit (if installed) → under headliner frame → power supply pre-fitting → rear camera pre-fitting

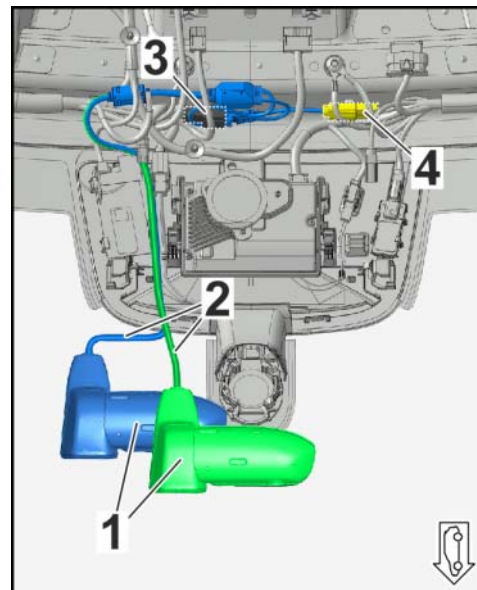

*Figure 12*

### 2.3.1 Expose power supply pre-fitting plug connections and rear camera pre-fitting at the roof console. ⇒ *Figure 13*

- 1** – Power supply pre-fitting
- 2** – Rear camera pre-fitting

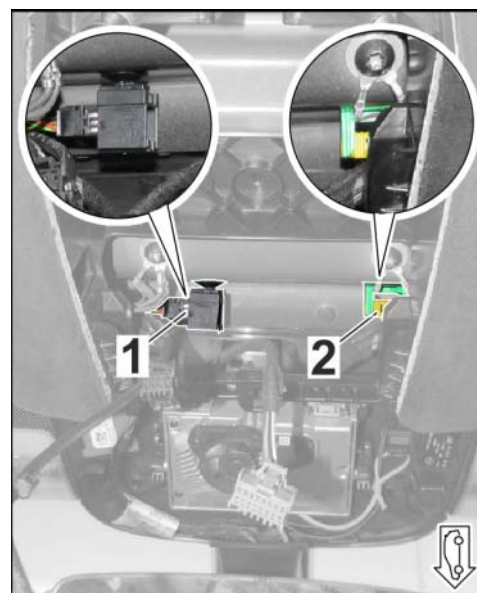

*Figure 13*

- 2.3.2 Guide front camera (dashcam) wiring harness to the left past the driver assistance systems control unit (if installed) under the headliner frame to the roof console. ⇒ *Figure 14*

- 1** – Power supply plug connection
- 2** – Rear camera plug connection
- 3** – Protective foam roll
- 4** – Wire harness on retainer plate / front camera

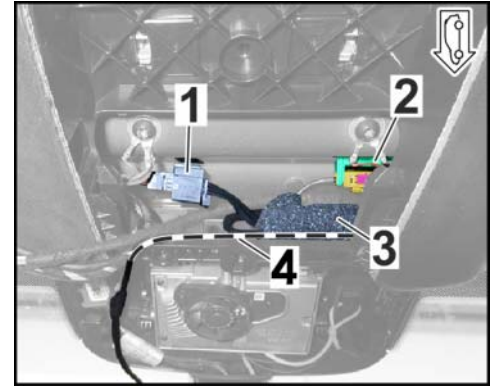

*Figure 14*

- 2.3.3 Slide protective foam roll (⇒ *Figure 14 -3-*) over plug connections. Slide further protective foam roll onto the lines if necessary.
- 2.3.4 Connect plug connection for power supply pre-fitting (roof console at the left in direction of travel). ⇒ *Figure 14 -1-*
- 2.3.5 Route rear camera link along existing lines to rear camera pre-fitting (roof console at the right in direction of travel).
- 2.3.6 Connect plug connection for the rear camera pre-fitting and re-install it in the holder. ⇒ *Figure 14 -2-*

- 2.4 Make groove for mounting plate wire harness rear-view mirror (interior) cover. ⇒ *Figure 15*

- 1** – Rear-view mirror (interior) cover
- 2** – Groove
- Ø – Groove diameter approx. 5 mm/ 0.2 in

- 2.4.1 Make groove (see marking on the inside ⇒ *Figure 15 -2-*) for wire harness retainer plate.
- 2.4.2 Check whether rear-view mirror cover can be installed/mounted on the overhead console and line routing.



*Figure 15*

- 2.5 Secure routed wire harness to existing lines/components in the vehicle with tie-wraps without tensile stress and so that no chafing occurs.

## 3 Installing rear camera

Overview of installation position of rear camera:

⇒ Figure 16

- 1 – Installation position of rear camera
- 2 – Electric wire harness
- 3 – Rear camera pre-fitting

### 3.1 Positioning rear camera on rear window.

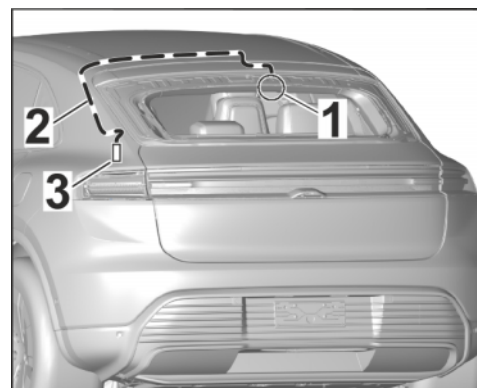

Figure 16

#### 3.1.1 Copying dimensions to rear window

- 1 – Rear window edge – top
- 2 – Vertical rear window symmetry axis
- 3 – Outline of rear camera base
- X – 225 mm/ 8.86 in
- Z – 54 mm/ 2.125 in

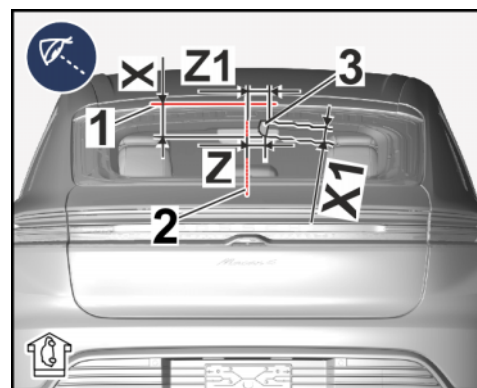

Figure 17

Dimension X = distance from upper rear window edge / rear camera base (lower right corner): **Length 225 mm/ 8.86 in**

Dimension Z = Distance from vertical symmetry axis rear window / rear camera base (lower right corner): **Length 54 mm/ 2.125 in**

Dimension X1 = Approximate height of rear camera base (lower to upper edge): **Length 54 mm/ 2.125 in**

Dimension Z1 = Distance from vertical symmetry axis rear window / rear camera base (upper right corner): **Length 57 mm/ 2.24 in**



#### Information

Observe the following points during positioning / alignment of the rear camera:

- Have a second person behind the vehicle check and confirm the horizontal alignment of the camera to the upper edge of the tailgate / spoiler!
- If necessary, correct the horizontal position by slightly turning the rear camera.

#### 3.1.2 Position rear camera in the vehicle at marking on rear window.

- 3.1.3 Do NOT close the tailgate. Have a second person trace and shade mounting plate outline on outside of rear window using grease pencil / chalk. ⇒ *Figure 17-3-*
- 3.2 Fixing privacy film
- 3.2.1 Clean bonding area for rear camera (marking) on inside of rear window to remove any dust and grease.
- 3.2.2 Peel backing sheet off 3M privacy film (rear camera).
- 3.2.3 Position and fix 3M privacy film on marked bonding surface on windscreen inside (⇒ *Figure 17-3-*).
- 3.2.4 Carefully affix 3M privacy film using a plastic squeegee, starting from the center and moving towards the edge.

- 3.3 Route rear camera wire harness from passenger compartment to rear lid. ⇒ *Figure 18*

- 1** – Wire harness for rear camera  
**2** – Grommet on rear lid (left)  
**3** – Rear lid trim

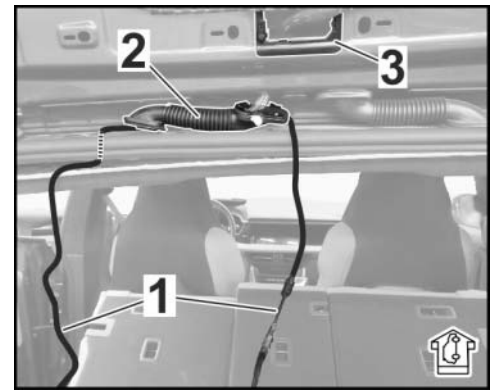

*Figure 18*

- 3.3.1 Carefully guide the rear camera wire harness plug through the rear lid wire harness grommet (left ⇒ *Figure 18-2-*) using aids.
- 3.3.2 Guide the rear camera wire harness plug through the wiring duct on the rear lid / rear lid trim (⇒ *Figure 18-3-*) to the rear window.
- 3.3.3 Install rear lid (left) wire harness grommet on rear lid and body. ⇒ *Technical Information '972719 Remove and install wire harness for tailgate'*
- 3.4 Installing rear camera on rear window

- 3.4.1 Insert wiring harness plug into rear camera (⇒ *Figure 19*) and position line in cable duct.

- 1** – Plug with wire harness  
**2** – Rear camera  
**3** – Cable duct  
**4** – Protective film

- 3.4.2 Peel protective film (⇒ *Figure 19-4-*) off the rear camera base.

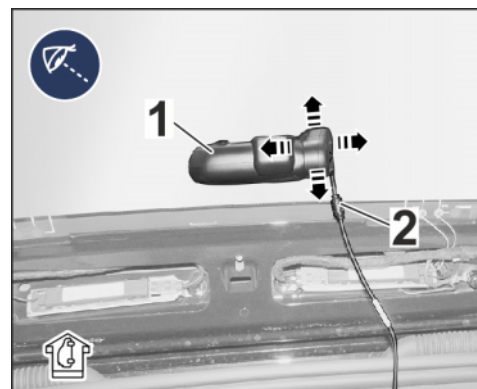

*Figure 19*

- 3.4.3 Align rear camera symmetrically to 3M privacy film on inside of rear window, install and press it firmly onto rear window. ⇒ *Figure 20 (similar)*

- 1 – Rear camera
- 2 – Plug with wire harness

- 3.5 Route and connect electric wire harness



*Figure 20 (similar)*

Line routing: ⇒ *Figure 21*

- 1 – Rear camera
  - 2 – Wire harness
  - 3 – Power supply
  - 4 – Video signal
  - 5 – Grommet on rear lid (left)
- Rear camera → rear window frame (top) → along existing cables in rear window frame → left rear lid wire harness grommet → along existing cables for pre-fitting power supply / rear camera video signal pre-fitting

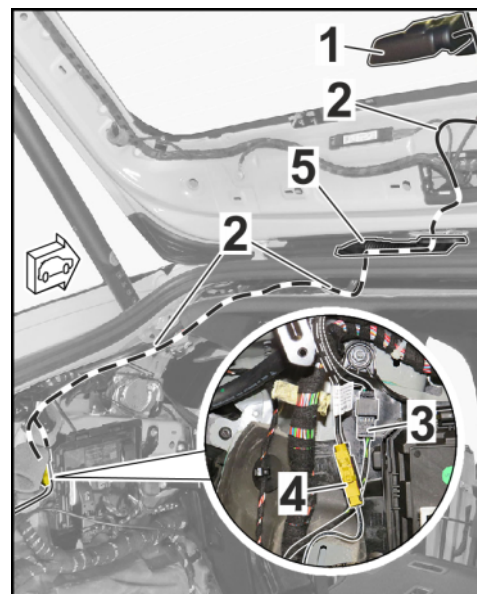

*Figure 21*

- 3.5.1 Route rear camera plug (power supply / video signal) along existing cables for pre-fitting in the vehicle (⇒ *Figure 21 -Magnifier-*).

- 3.5.2 Remove video signal connector from holder.

Establish the connection to the video signal pre-fitting and mount it in the plug-in connection holder. ⇒ *Figure 21 -4-*

- 3.5.3 Connect plug connection for power supply pre-fitting. ⇒ *Figure 21 -3-*

- 3.6 Protect the front and rear camera power supply with new fuses.



- 3.6.1 Open fuse holder A (front end).  
See also: ⇒ *Technical Information '978419 Removing and installing front end fuse carrier fuse box',*  
⇒ *Figure 22 (LHD vehicle)*

- 1 – Fuse holder A (front end)
- 2 – Slot 1

Check seating for slot 1 in fuse holder A (front end) for front & rear camera and protect with new fuse if necessary.

Fuse A1 **setpoint values 10 A**

Close fuse holder A (front end).

- 3.6.2 Open fuse holder for passenger compartment A-pillar on passenger side. See also: ⇒ *Technical Information '978419 Removing and installing A-pillar fuse carrier fuse box',* ⇒ *Figure 23 (LHD vehicle)*

- 1 – A-pillar fuse holder (passenger side)
- 2 – Fuse strip E
- 3 – Slot 12

Check seating for slot 12 (front & rear camera) and protect with new fuse if necessary.

Fuse E12: **Setpoint value 5 A**

Close fuse holder for passenger compartment A-pillar on passenger side.

- 3.7 Install rear lid trim (top). ⇒ *Technical Information '70871905 Remove and install trim panel for rear lid (upper)'*



Figure 22 (LHD vehicle)

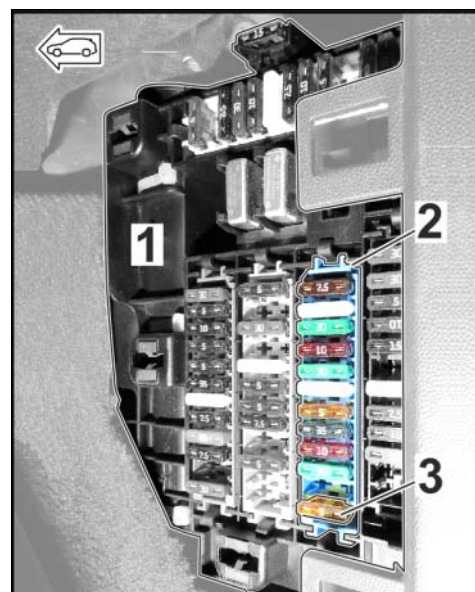

Figure 23 (LHD vehicle)



- 3.7.1 Temporarily install rear lid trim panel (top) in the area of the rear camera on the rear lid.

- 1 – Rear lid trim panel (top)
- 2 – Wire harness for rear camera
- 3 – Rear camera

Check that there is sufficient space for the rear camera wiring harness.

- 3.7.2 If not: Mark line routing on trim panel, note marking (⇒ *Figure 24 -Arrow-*) for cut-out on inner side.

- 3.7.3 Remove rear lid trim panel (top) and make a groove for the wire harness at the marking.

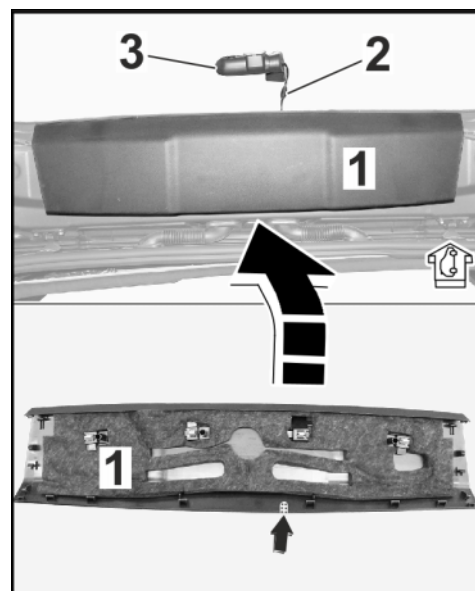

*Figure 24*

- 3.8 Pull excess line through the grommet to the vehicle roof and secure it to existing lines/components without chafing or tension.

Secure remaining wire harness in the vehicle to existing lines / components with tie-wraps without tensile stress and so that no chafing occurs.

## 4 Interior finishing work

- 4.1 Luggage compartment area: Secure roof trim panel and install all trim panels in reverse order.
- 4.2 Rear lid area: Install all trim panels in reverse order.
- 4.3 Front roof/rear-view mirror area (interior): Install all trim panels in reverse order.

Coding: 5 Coding PORSCHE front and rear cameras in dealer mode

#### 5.1 Preparatory work

- 1 – PORSCHE front camera
- 2 – Micro SD memory card (32 GB)
- 3 – Retainer plate
- 4 – Power button
- 5 – WiFi status LED display
- 6 – PRESS (release button)

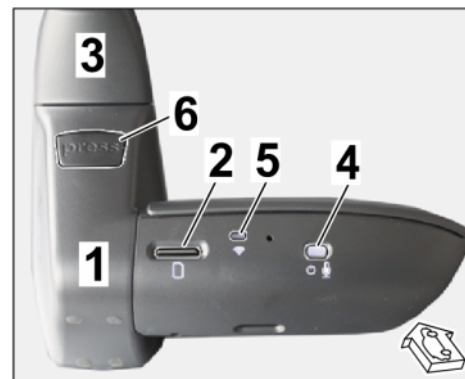

Figure 25

- 5.1.1 Remove micro SD memory card (32 GB, ⇒ *Figure 25 -2-*) from front camera card slot.
- 5.1.2 With ignition switched on, push front camera (dashcam ⇒ *Figure 25 -1-*) onto the mounting plate on the windscreen (⇒ *Figure 25 -3-*).
- 5.1.3 Press power button (⇒ *Figure 25 -4-*) for 10 seconds until you hear the second double-beep.
- 5.1.4 The front camera (dashcam) starts in Dealer mode: WiFi LED (⇒ *Figure 25 -5-*) lights up "yellow".

#### 5.2 Connect front camera (dashcam) to device (tablet, smartphone or PC)



##### Information

The "Dealer mode" network ID name ends with a "D". A password is **NOT** required!

The language setting can be changed by following the menu prompts after opening the first page.

- 5.2.1 Search available networks for Dealer mode WiFi.
- 5.2.2 Open Dealer mode on the device (tablet, smartphone or PC) using any browser.  
To do this, enter "**192.168.1.1/diagnostics**" in the browser's address line.
- 5.2.3 Displays in "Dealer mode" main menu:

Options: (⇒ *Figure 26*)

- 1 – Browser's address bar
- 2 – "Options" menu item

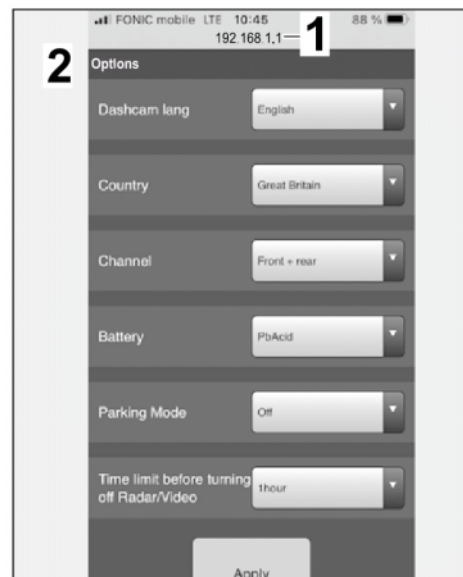
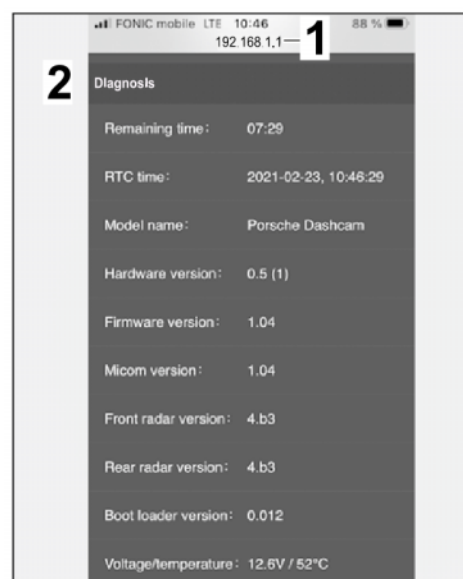

*Figure 26*

Diagnostics: (⇒ *Figure 27*)

- 1 – Browser's address bar
- 2 – "Diagnostics" menu item

- 5.3 Basic settings for front camera (dashcam) in the "Options" menu item" (⇒ *Figure 28*)



*Figure 27*

- 5.3.1 Change the default language  
"English" to the desired language:
- 1 – Default language "English"
  - 2 – German

For example: German  
(⇒ Figure 28)

- Up to 19 different languages can be selected.

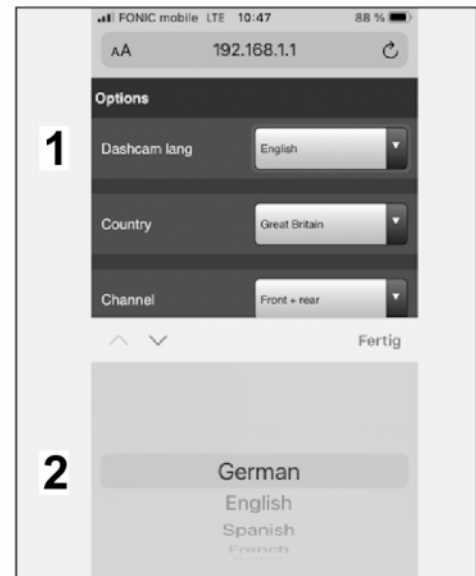

Figure 28



#### Information

If the relevant country is **NOT** displayed in the drop-down menu:  
Please select "Global".

- 5.3.2 Select the country (⇒ Figure 29).
- 1 – Serial number of front and rear cameras
  - 2 – Selected country
  - 3 – Great Britain

- Up to 48 countries are currently available for selection.
- The Country selection screen includes, for example: Units of measurement, frequencies and also legal regulations of the respective country.
- **Macan:** ⇒ Choose Region / State / Country by selecting the appropriate flag.

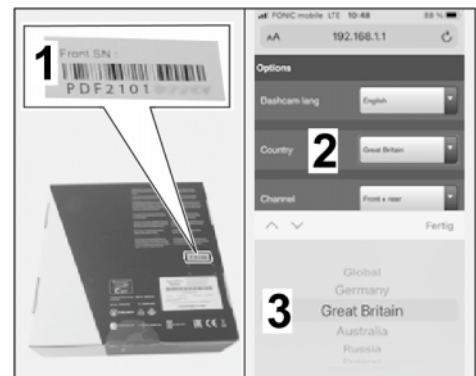
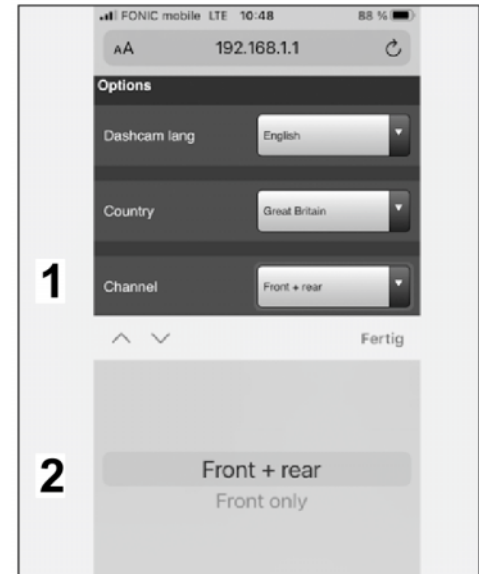

Figure 29

5.3.3 Select the required camera channel  
(⇒ *Figure 30*).

- 1 – Channel
  - 2 – Front + Rear
- **TEQUIPMENT:** ⇒ “Front + rear” is preset.



*Figure 30*



## Information

Check which vehicle electrical system battery is installed in the vehicle if necessary by entering the vehicle identification number (VIN) in the Porsche Central Service System (PCSS).

**Background:** The front camera shuts down if the correct battery voltage (switch-off threshold) is not reached over a period of 5 minutes.

- Switch-off threshold for lead-acid battery (PbAcid) = 11 V
- Switch-off threshold for lithium-ion battery (LiFePO) = 13 V

5.3.4 Select battery type (⇒ *Figure 31*)

- 1 – Battery
  - 2 – PbAcid
- Select the electrical system battery installed in the vehicle.
  - **Macan:** ⇒ Lead-acid battery (PbAcid)

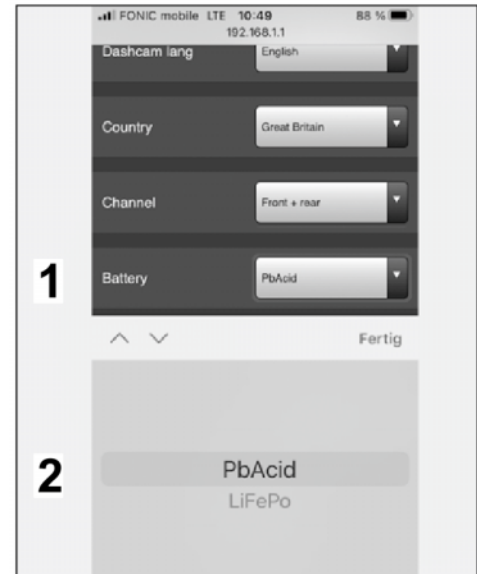
*Figure 31*5.3.5 Select Park mode (⇒ *Figure 32*)

- 1 – Park mode
  - 2 – From
- Depending on the approval for the respective vehicle.
  - **Macan:** ⇒ Select "Off".

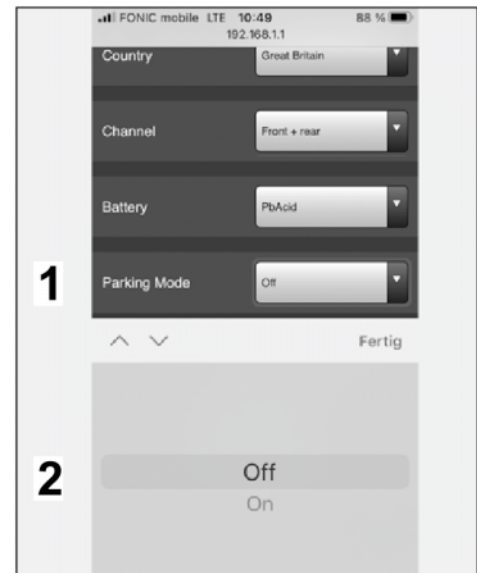
*Figure 32*

## 5.3.6 Select the time limit (⇒ Figure 33)

- 1 – Time limit until radar / video is switched off
  - 2 – 1 hour
- Turn off radar / video monitoring in Park mode (battery management). After the selected time limit, fast activation of the monitoring system ONLY occurs if the vehicle shakes/vibrates!
  - **Macan:** ⇒ Select "Off".

## 5.4 End Dealer mode (WiFi LED is still yellow)

5.4.1 Close browser and switch off ignition.

5.4.2 Pull the front camera (dashcam) off the retainer plate by pressing "PRESS" (release button).

5.4.3 Insert micro SD memory card (32 GB) in front camera (dashcam).

5.4.4 Install the front camera (dashcam) in the mounting plate.

5.5 The settings configured in **Step 5.3** are set when the ignition is switched on again.

5.6 Formatting micro SD memory card (32 GB)

5.6.1 Switch on ignition.

5.6.2 Press the power button quickly 6 times in a row within 3 seconds.

Announcements from front camera loudspeaker: "Formatting in progress." and "Formatting completed."

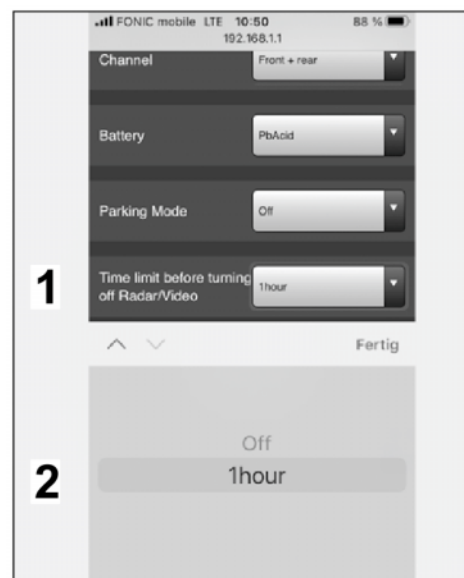

Figure 33

Assembly:

## 6 Follow-up actions

- 6.1 Read out the fault memory of all systems, work through any existing faults and erase the fault memory. ⇒ *Technical Information '033525 Performing/programming on-board diagnostic for vehicle handover'*
- 6.2 Disconnect the battery charger. ⇒ *Technical Information '270689 Charge vehicle electrical system battery'*
- 6.3 Vehicle handover to customer

**Information**

Please pass all this information on to the customer.

Also give the customer the PORSCHE dashcam operating instructions.

Also give the first 3 pages of these Installation and Conversion Instructions to the customer.

- 6.3.1 Download the app from the App Store to the customer's device (smartphone/tablet).
- 6.3.2 If the vehicle is present, connect the Porsche front & rear camera WiFi to the vehicle WiFi (see also vehicle operating instructions ⇒ Porsche Connect).
- 6.3.3 Select and set Region/State/Country (flag) in the app on the customer's smartphone/tablet.
- 6.3.4 Have the customer update firmware using the app.
- 6.3.5 Format micro SD memory card (32 GB).

91 63 23 40: –PORSCHE front and rear cameras (1x) retrofitted–

Labor time: **325 TU**

Includes: Install PORSCHE front camera (dashcam) on the windscreen, route and connect electrics;  
Install PORSCHE rear camera on the rear window, route and connect electrics;  
Format coding of the PORSCHE front and rear cameras in dealer mode and in the micro SD memory card,  
Read out fault memory, correct faults and delete them.

**Important Notice:** Technical Bulletins issued by Porsche Cars North America, Inc. are intended only for use by professional automotive technicians who have attended Porsche service training courses. They are written to inform those technicians of conditions that may occur on some Porsche vehicles, or to provide information that could assist in the proper servicing of a vehicle. Porsche special tools may be necessary in order to perform certain operations identified in these bulletins. Use of tools and procedures other than those Porsche recommends in these bulletins may be detrimental to the safe operation of your vehicle, and may endanger the people working on it. Properly trained Porsche technicians have the equipment, tools, safety instructions, and know-how to do the job properly and safely. Part numbers listed in these bulletins are for reference only. The work procedures updated electronically in the Porsche PIWIS diagnostic and testing device take precedence and, in the event of a discrepancy, the work procedures in the PIWIS Tester are the ones that must be followed.

© 2024 Porsche Cars North America, Inc.