

2025 Mirai Pre-Delivery Service (PDS)

Service Category General

Section Pre-Delivery Service

Market USA

Toyota Supports
 ASE Certification 

Applicability

YEAR(S)	MODEL(S)	ADDITIONAL INFORMATION
2025	Mirai	

Introduction

Pre-Delivery Service (PDS) is a critical step in satisfying our new car customers. Customer feedback indicates the following areas deserve special attention when performing PDS:

- Careful inspection for paint chips/scratches and body dents/dings.
- Proper operation of electrical accessories (including interior light, clock, and radio reset).
- Interior cleanliness.
- Proper function of mechanical systems.

Customer retention and proper maintenance of vehicles are, and have always been, a major focus for Toyota. To help remind customers that regular service is essential to the proper maintenance of the vehicle, dealers are required to install a service reminder sticker before delivery. By doing this, customers will be reminded to return to your dealership for service. Your current service reminder sticker may be used. (See PDS Check Sheet item 8 of “Final Inspection and Cleaning.”)

This bulletin contains the PDS procedures that apply specifically to 2025 model year Mirai vehicles.

Refer to [T-SB-0028-24](#), the universal *Check Sheet* that contains PDS steps that apply to all 2025 model year Toyota vehicles. To properly perform a complete PDS, you must complete all procedures contained in this TSB as well as the universal PDS Check Sheet.

In addition, if the vehicle is stored for over 30 days, refer to [T-SB-0023-24](#), *Long-Term Vehicle Storage Guidelines*.

2025 Mirai Pre-Delivery Service (PDS)

Introduction (continued)

Refer to the table below for a definition of terms that may be used in this bulletin.

Table 1.

TERM	ACRONYM	DEFINITION
Conventional Vehicle	CV	A vehicle with only a gasoline engine for propulsion
Electrified Vehicle	EV	A vehicle that utilizes a hybrid, plug-in hybrid, fuel cell, or battery electric system for propulsion
Hybrid Electric Vehicle	HEV	A vehicle with both a gasoline engine and a HV Battery
Plug-in Hybrid Electric Vehicle	PHEV	A vehicle with both a gasoline engine and a HV Battery that can be charged externally
Battery Electric Vehicle	BEV	A vehicle with only a HV Battery that can be charged externally
Fuel Cell Electric Vehicle	FCEV	A vehicle with both a hydrogen fuel cell and a HV Battery
State of Charge	SOC	The remaining capacity available in a battery
12-Volt	12V	Standard 12V battery used to power electrical systems separate from high voltage components
High Voltage	HV	HV Battery used to power the electrified vehicle

2025 Mirai Pre-Delivery Service (PDS)

Table of Contents

- [Warranty Policy](#)4
- [Warranty Information](#)4
- [Required Tools & Equipment](#)4
- [D/C Cut Fuse Installation](#)5
- [Front License Plate and Mounting Bracket Installation*](#)6
- [Front and Rear Emergency Towing Eyelet Removal and Hole Cover Installation](#)8
- [Front Wheel Opening Extension Pad Installation](#)10
- [Installation of Rubber Body Plugs](#)11
- [Tire Pressure Warning System \(TPWS\) Initialization](#)12
- [Head Unit System Reset](#).....12
- [Dealer Contact Information for Call Dealer Head Unit Function*](#)13
- [Navigation — Set Date & Time by GPS](#)13

*If applicable.

2025 Mirai Pre-Delivery Service (PDS)

Warranty Policy

If the need for additional repairs or adjustment is noted during PDS, the required service should be performed under warranty. Reimbursement will be managed under the warranty policy.

The Warranty Policy and Procedures Manual requires that you maintain the completed Check Sheet in the customer's file. If you cannot produce a completed form for each retailed vehicle upon TMS and/or Region/Distributor audit, the PDS payment amount will be subject to debit.

An additional Repair Order completed in conjunction with normal PDS MUST have time punch/flags for service. If multiple repairs are performed, separate time flags MUST be punched for each repair.

Warranty Information

OP CODE	DESCRIPTION	MODEL	TIME	OFF	T1	T2
001013	Pre-Delivery Service (PDS)	Mirai	1.2	–	–	–

Required Tools & Equipment

REQUIRED EQUIPMENT	SUPPLIER	PART NUMBER	QTY
Techstream ADVi*	ADE	TSADVUNIT	1
Techstream 2.0		TS2UNIT	
Techstream Lite		TSLITEPDLR01	
Techstream Lite (Green Cable)		TSLP2DLR01	

*Essential SST.

NOTE

- Only ONE of the Techstream units listed above is required.
- GTS+ Software version 2024.03.004.02 or later is required.
- Additional Techstream units may be ordered by calling Approved Dealer Equipment (ADE) at 1-800-368-6787 or by visiting *TIS – Diagnostics – Tools & Equipment – Techstream Order Portal*.

2025 Mirai Pre-Delivery Service (PDS)

D/C Cut Fuse Installation

To minimize battery discharge during transportation and storage, the D/C cut No. 1 and D/C cut No. 2 fuses (30A) have been removed at the assembly plant and temporarily stored in the blank space of the relay block in the engine compartment. During PDS, reinstall the D/C cut No. 1 and D/C cut No. 2 fuses (30A) to their original location and confirm ALL related Diagnostic Trouble Codes (DTCs) are cleared.

Remove the D/C cut No. 1 and D/C cut No. 2 fuses (30A) from the blank space of the relay block in the engine compartment and install the D/C cut No. 1 and D/C cut No. 2 fuses (30A) in the relay block as shown.

Figure 1.

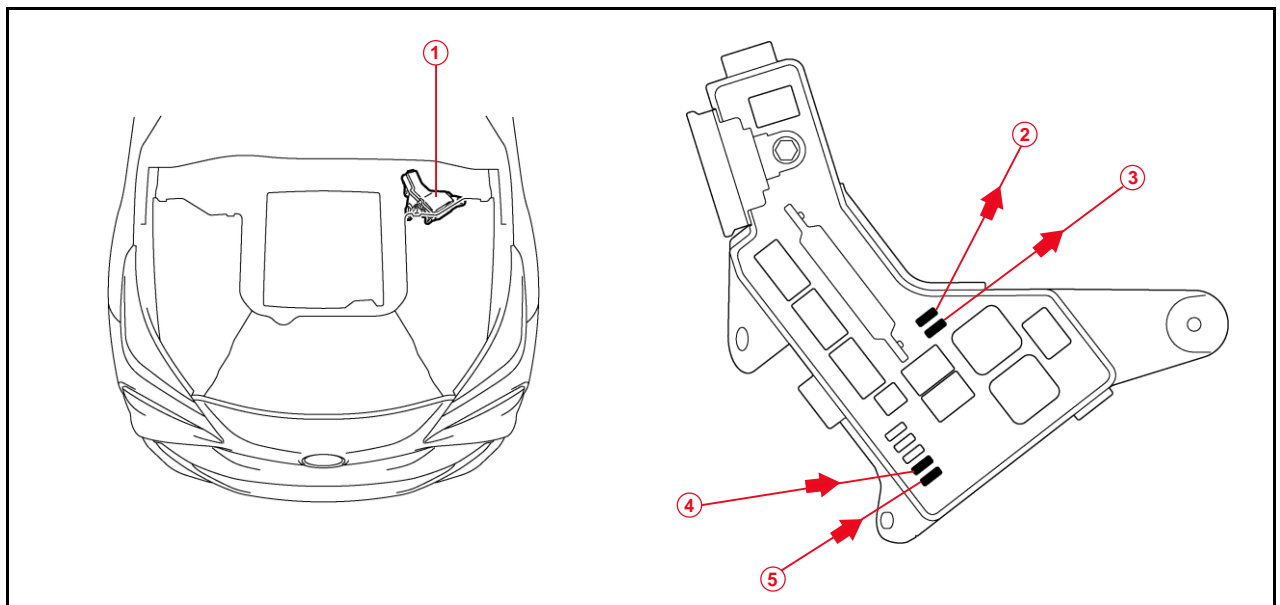

1	Relay Block
2	Remove D/C Cut No. 1 Fuse (30A)
3	Remove D/C Cut No. 2 Fuse (30A)

4	Install D/C Cut No. 1 Fuse (30A) (Original Location)
5	Install D/C Cut No. 2 Fuse (30A) (Original Location)

NOTE

- With the D/C cut fuses No. 1 and No. 2 (30A) removed, if ANY DTCs are detected when the ignition is turned ON during transportation, use Global Techstream Software (GTS+) to clear ALL DTCs AFTER ensuring that there are NO malfunctions.
- While the vehicle is stored at the dealership, disconnect the negative (-) battery terminal to prevent battery discharge. Refer to [T-SB-0021-24](#), *Battery Inspection and Maintenance During PDS*, for battery maintenance information.

2025 Mirai Pre-Delivery Service (PDS)

Front License Plate and Mounting Bracket Installation

The front license plate bracket and two self-tapping screws are stored in the vehicle. Follow this procedure to install the front license plate bracket and front license plate in states where it is required by law.

1. Align holes “A” of the mounting bracket with the dimples on the radiator lower grille.

NOTE

- Holes “A” are used for installation of the mounting bracket to the radiator grille.
- Holes “B” are used for the installation of the front license plate to the mounting bracket.

2. Screw the two self-tapping screws directly into the dimples to install the front license plate mounting bracket.

NOTICE

- Do NOT pre-drill holes in the dimples.
- Do NOT overtighten the self-tapping screws.

3. Install the mounting bracket to the radiator grille using two self-tapping screws.

Figure 2.

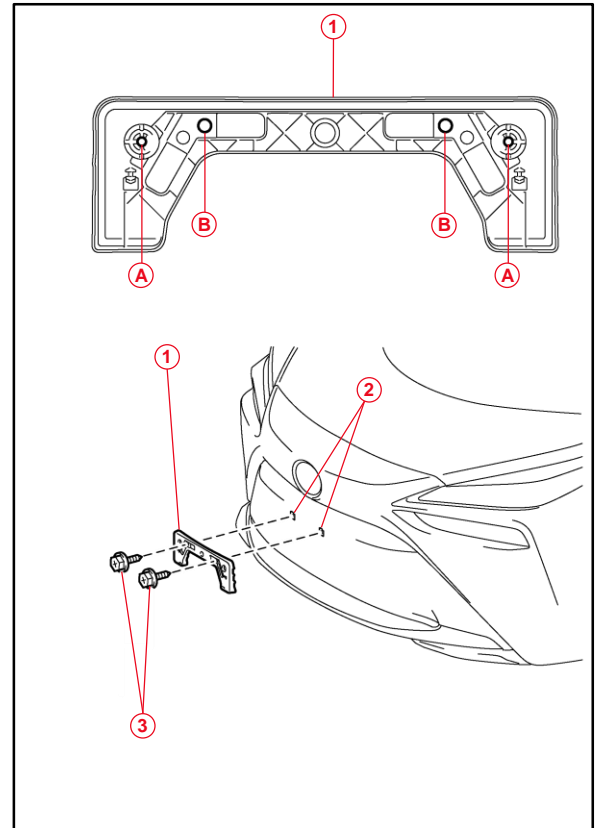

1	Mounting Bracket
2	Dimples
3	Self-tapping Screws
A	Holes “A” for Mounting Bracket
B	Holes “B” for License Plate

2025 Mirai Pre-Delivery Service (PDS)

Front License Plate and Mounting Bracket Installation (continued)

- Install the front license plate onto the mounting bracket using two noncorroding bolts with the following dimensions:

Length: 15.0 mm (0.59 in.)

Diameter: 6.0 mm (0.24 in.)

Figure 3.

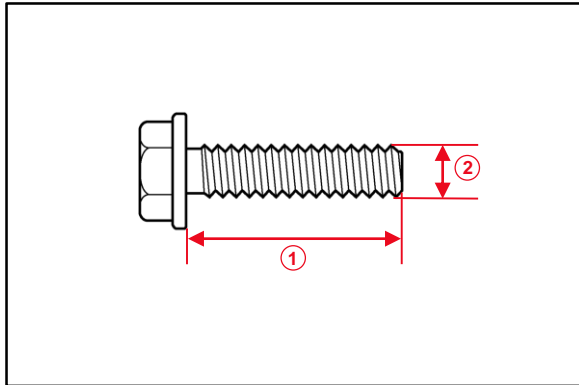

1	Length
2	Diameter

Figure 4.

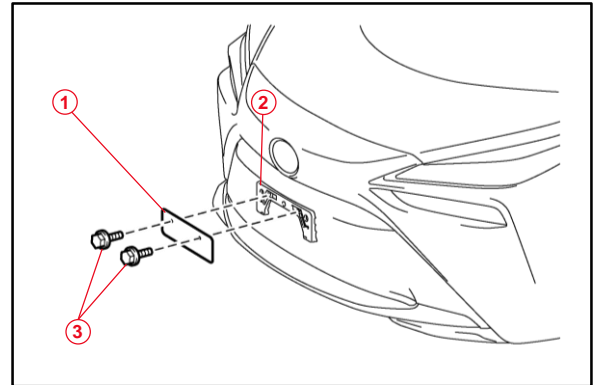

1	Front License Plate
2	Mounting Bracket
3	Bolts

2025 Mirai Pre-Delivery Service (PDS)

Front and Rear Emergency Towing Eyelet Removal and Hole Cover Installation

1. Remove the front and rear emergency towing eyelets from the front and rear bumpers by turning them counterclockwise.

HINT

If it is difficult to loosen the emergency towing eyelets, use a steel bar.

Figure 5.

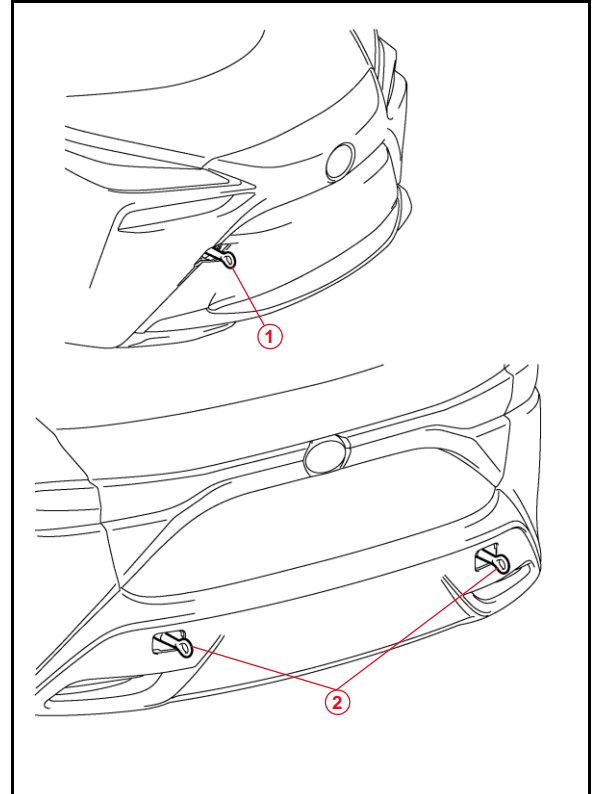

1	Front Emergency Towing Eyelet
2	Rear Emergency Towing Eyelets

2. Place the removed front emergency towing eyelet into the luggage tray in the luggage compartment.

HINT

Dispose of the other removed emergency towing eyelets.

Figure 6.

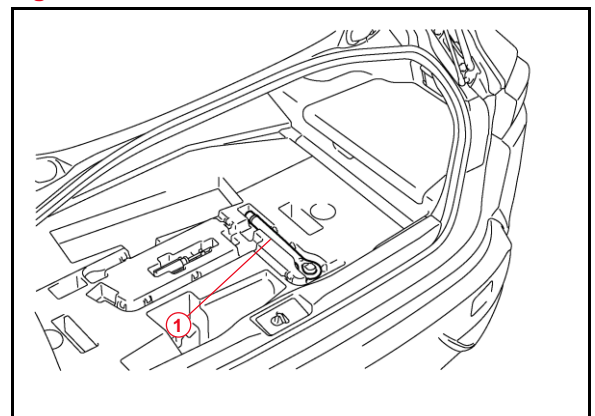

1	Front Emergency Towing Eyelet
----------	--------------------------------------

2025 Mirai Pre-Delivery Service (PDS)

Front and Rear Emergency Towing Eyelet Removal and Hole Cover Installation (continued)

3. Install the front and rear emergency towing eyelet hole covers, which are stored in the glove compartment, onto the front and rear bumpers.

A. Insert the arrow-shaped part “A” of the emergency towing eyelet hole covers into eyelet holes “B” as shown.

B. Install the front and rear emergency towing eyelet hole covers into the holes of the front and rear bumper.

Figure 7.

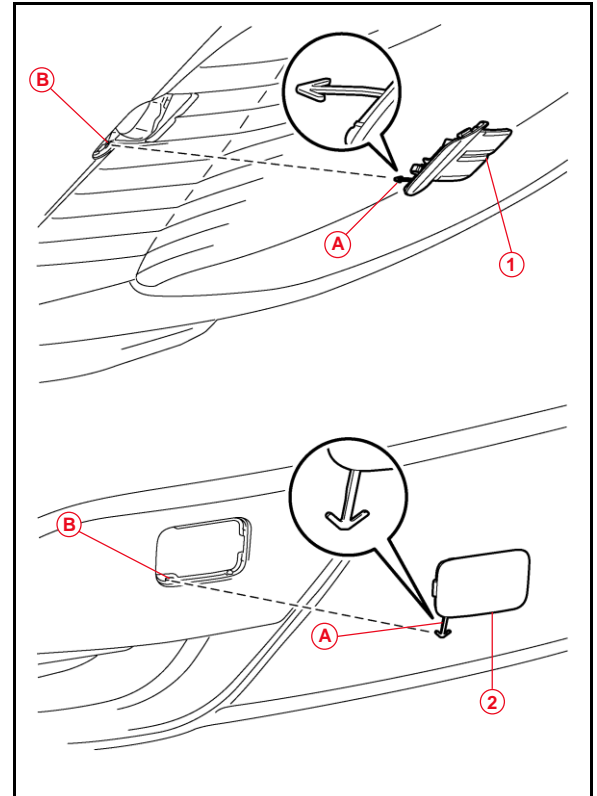

A	Arrow-shaped Part
B	Eyelet Hole
1	Front Emergency Towing Eyelet Hole Cover
2	Rear Emergency Towing Eyelet Hole Cover

2025 Mirai Pre-Delivery Service (PDS)

Front Wheel Opening Extension Pad Installation

The front wheel opening extension pad set (right and left front wheel opening extension pads and six self-tapping screws) is stored in the luggage compartment at the assembly plant to avoid damage in transit.

1. Hook the retainers of the left front wheel opening extension pad through the installation holes on the fender liner and temporarily place the left front wheel opening extension pad in the installation position.

HINT

There is a distinguishable mark on each pad.

2. Tighten the three self-tapping screws.
3. Repeat steps 1 and 2 for the right side.

Figure 8.

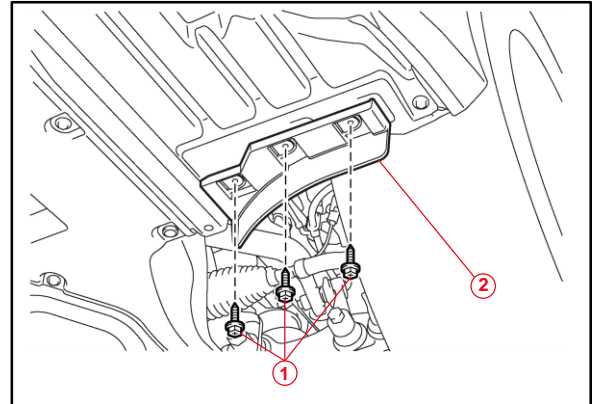

1	Self-tapping Screws
2	Front Wheel Opening Extension Pad

2025 Mirai Pre-Delivery Service (PDS)

Installation of Rubber Body Plugs

1. Confirm the number of plugs in the glove box. If two plugs are present, perform substep 2A ONLY. If four plugs are present, perform substep 2A AND substep 2B.
2. Install the plugs according to the instructions below by confirming the number of plugs in the glove box.
 - A. Install two plugs in the rear side member hole or rocker inner hole as shown.
 - B. Install two plugs in the torque box hole or rocker inner hole as shown.

Figure 9.

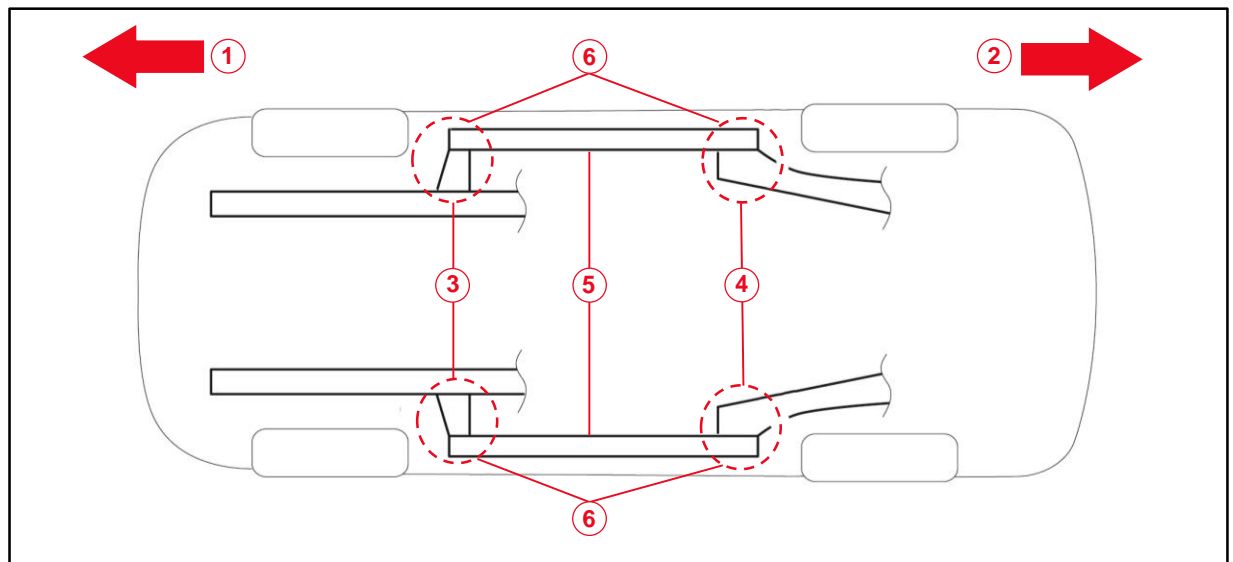

1	Front Side
2	Rear Side
3	Torque Box Hole or Rocker Inner Hole

4	Rear Side Member Hole or Rocker Inner Hole
5	Rocker Inner
6	Install Plug Here (if Applicable)

NOTICE

- The installation of these plugs is required to prevent rust.
- These plugs are stored in the glove box.
- The number of plugs may vary according to production locations in the same vehicle model.

2025 Mirai Pre-Delivery Service (PDS)

Tire Pressure Warning System (TPWS) Initialization

Refer to the applicable Repair Manual for the TPWS initialization procedure.

- [2025](#) Mirai:

Suspension – Tire Pressure Monitoring – Tire Pressure Warning System – Initialization

NOTE

To adjust the tire pressure correctly when the outside temperature is significantly colder than shop temperature, perform a Health Check using GTS+ and select the compensation tire pressure checkbox. Compensation pressures will display on the Health Check results screen. Adjust the tire pressure when the tires are cold.

Head Unit System Reset

Prior to vehicle delivery, confirm that the welcome screen with language options appears on the head unit display when the ignition is switched to the ON position. There may be instances in which the welcome screen with language options may NOT properly appear on the head unit display.

If the welcome screen showing language options is NOT displayed, complete the following steps:

1. Select the Settings option (gear icon).
2. Scroll down and select the Info & Security option.
3. The System Reset dialogue box will appear. Select Reset to confirm the resetting of the system.
4. Confirm that the welcome screen with language options is now displayed.

2025 Mirai Pre-Delivery Service (PDS)

Dealer Contact Information for Call Dealer Head Unit Function (Premium Audio Only)

Refer to the *Multimedia System Owner's Manual* to add dealer contact information.

- [2025](#) Mirai:
Section 2-9 Vehicle settings – Setting dealer information

Navigation — Set Date & Time by GPS

Prior to vehicle delivery, it is necessary to turn the Set Date & Time by GPS setting to the ON position.

1. Turn the engine switch (power switch) to the ON position (ON mode).
2. Navigate the following menus in the head unit: *Settings – General – Date & Time – Set date & time by GPS.*
3. Ensure the Set Date & Time by GPS function is set to the ON position.