

SS 1032998 M2 mirror wind noise

M2 mirror wind noise

Applicable Vehicles

All M2 platform

Symptoms

Excessive wind noise on both driver and passenger side, but more noticeable on the driver's side by the operator.

Issue

Wind noise across the upper mirror mounting bracket

Solution

Corrective action at this time is installation of part number 22-68384-000 into the upper mounting bracket drilling as per the attached document.

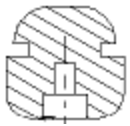
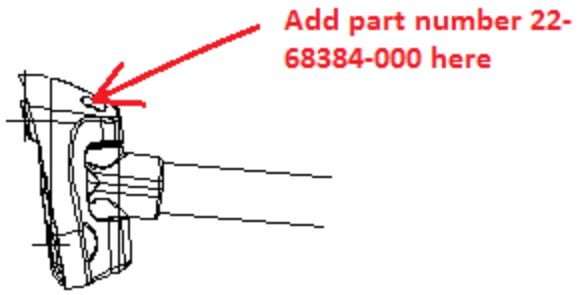

Part number 22-68384-000 cross sectional view



Labels :

M2

Add tags

0 Kudos

Comment

